



west virginia department of environmental protection

Office of Oil and Gas
601 57th Street, S.E.
Charleston, WV 25304
(304) 926-0450
fax: (304) 926-0452

Harold D. Ward, Cabinet Secretary
www.dep.wv.gov

Friday, July 19, 2024
PERMIT MODIFICATION APPROVAL
Horizontal 6A / New Drill

EQT PRODUCTION COMPANY
400 WOODCLIFF DR.

CANONSBURG, PA 15317

Re: Permit Modification Approval for JEFFERSONS N-7HU
47-103-03509-00-00

Modified Lateral

EQT PRODUCTION COMPANY

The Office of Oil and Gas has reviewed the attached permit modification for the above referenced permit. The attached modification has been approved and well work may begin. Please be reminded that the oil and gas inspector is to be notified twenty-four (24) hours before permitted well work is commenced.

If there are any questions, please feel free to contact me at (304) 926- 0450.

A handwritten signature in blue ink, appearing to read 'James A. Martin', is positioned above the printed name and title.

James A. Martin
Chief

Operator's Well Number: JEFFERSONS N-7HU
Farm Name: EDWARD H & JOAN E ESTEP
U.S. WELL NUMBER: 47-103-03509-00-00
Horizontal 6A New Drill
Date Modification Issued: 7/19/2024

Promoting a healthy environment.

07/19/2024



west virginia department of environmental protection

Oil and Gas Conservation Commission
601 57th Street SE, Charleston, WV 25304
304-414-1239

Randall M. Albert, Chairman
dep.wv.gov

July 3, 2024

Department of Environmental Protection
Office of Oil and Gas
Charleston, WV 25304

RE: Application for Deep Well Permit – API #47-103-03509

COMPANY: EQT Production Company

FARM: Edward H. Estep and Joan E. Estep Jeffersons N-7HU

COUNTY: Wetzel DISTRICT: Proctor QUAD: New Martinsville

The deep well review of the application for the above company is Approved to drill to the Point Pleasant for completion.

The applicant has complied with the provision of Chapter 22C-9, of the Code of West Virginia, nineteen hundred and thirty-one (1931), as amended, Oil and Gas Conservation Commission as follows:

1. Comments to Notice of Deviation filed? No.
2. Provided a certified copy of duly acknowledged and recorded consent and easement form from all surface owners? Yes
3. Provided a tabulation of all deep wells within one mile of the proposed location, including the API number of all deep wells: **yes
4. Provided a plat showing that the productive interval of the well meets the requirements of the Rules of the Commission W. Va. C.S.R. § 39-1-4.2.

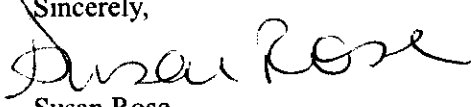
Sincerely,

Susan Rose
Administrator

**Burch Ridge S-6HU 47-051-02193; Burch Ridge S-7HU 47-051-02194; McMasters S-16HU 47-051-02497; Elmer N-14HU 47-103-03502; Jeffersons N-8HU 47-103-03510; Jeffersons N-9HU 47-103-03511; Jeffersons N-10HU 47-103-03512; Jeffersons N-11HU 47-103-03673; McMasters S-17HU 47-051-02498; McMasters S-18HU 47-051-02487; McMasters S-19HU 47-051-02488; Hillrock S-12HU 47-051-02272; Hillrock S-13HU 47-051-02273; Hillrock S-14HU 47-051-02262; Elmer N-13HU 47-103-03624; Elmer N-15HU 47-103-03536; Elmer N-16HU 47-103-03504; Elmer N-17HU 47-103-03505; Elmer N-18HU 47-103-03467

07/19/2024

STATE OF WEST VIRGINIA
DEPARTMENT OF ENVIRONMENTAL PROTECTION, OFFICE OF OIL AND GAS
WELL WORK PERMIT APPLICATION

1) Well Operator: EQT Production Company 306686 Wetzel Proctor New Martinsville
Operator ID County District Quadrangle

2) Operator's Well Number: N-7HU Well Pad Name: Jeffersons

3) Farm Name/Surface Owner: Edward H. & Joan E. Estep Public Road Access: CR 1/6 Palmer Ridge Rd.

4) Elevation, current ground: 1,217.5' (built) Elevation, proposed post-construction: 1,217.5' (built)

5) Well Type (a) Gas Oil Underground Storage
Other _____
(b) If Gas Shallow _____ Deep
Horizontal

6) Existing Pad: Yes or No Yes

7) Proposed Target Formation(s), Depth(s), Anticipated Thickness and Expected Pressure(s):
Point Pleasant, 11,482', 116', 10,386 psi

8) Proposed Total Vertical Depth: 11,482'

9) Formation at Total Vertical Depth: Point Pleasant

10) Proposed Total Measured Depth: 27,131'

11) Proposed Horizontal Leg Length: 15,255'

12) Approximate Fresh Water Strata Depths: 767'

13) Method to Determine Fresh Water Depths: Offset wells - 103-01761, 103-01794, 103-01795

14) Approximate Saltwater Depths: 1,652', 1,709'

15) Approximate Coal Seam Depths: 504'-506', 848'-850', 938'-942'

16) Approximate Depth to Possible Void (coal mine, karst, other): N/A

17) Does Proposed well location contain coal seams directly overlying or adjacent to an active mine? Yes _____ No

(a) If Yes, provide Mine Info: Name: _____
Depth: _____
Seam: _____
Owner: _____

WW-6B
(04/15)

API NO. 47- 103 - 03509
 OPERATOR WELL NO. N-7HU
 Well Pad Name: Jeffersons

18)

CASING AND TUBING PROGRAM

TYPE	Size (in)	New or Used	Grade	Weight per ft. (lb/ft)	FOOTAGE: For Drilling (ft)	INTERVALS: Left in Well (ft)	CEMENT: Fill-up (Cu. Ft.)/CTS
Conductor	30	New	BW	BW	120	120	259 ft ³ / CTS
Fresh Water	20	New	J-55	106.5	1013	1013	1629 ft ³ / CTS
Coal	13-3/8	New	J-55	54.5, 61	2497	2497 (2100'- 54.5#, 397'- 61#)	2000 ft ³ / CTS
Intermediate	9-5/8	New	P-110	47	10376	10376	4025 ft ³ / CTS
Production	5-1/2	New	P-110	23	27131	27131	5000' from surface
Tubing							
Liners							

TYPE	Size (in)	Wellbore Diameter (in)	Wall Thickness (in)	Burst Pressure (psi)	Anticipated Max. Internal Pressure (psi)	Cement Type	Cement Yield (cu. ft./k)
Conductor	30	36	1.0	2333	1866	Class A	1.20
Fresh Water	20	26	0.5	2410	1928	Class A	1.20
Coal	13-3/8	17-1/2	0.380, 0.430	2740, 3090	2192	Class A/L	1.04 - 1.20
Intermediate	9-5/8	12-1/4	0.472	9440	7552	Class A/H/L	1.04 - 1.20
Production	5-1/2	8-1/2	0.415	16500	13200	Class A/H/L	1.04 - 2.10
Tubing							
Liners							

PACKERS

RECEIVED
Office of Oil and Gas

Kind:				MAY 31 2024
Sizes:				WV Department of Environmental Protection
Depths Set:				

19) Describe proposed well work, including the drilling and plugging back of any pilot hole:

Continue drilling and complete a new horizontal well in the Utica / Point Pleasant Formation. Continue drilling the vertical, kick off and drill curve. Drill the lateral in the Utica / Point Pleasant. Cement casing.

20) Describe fracturing/stimulating methods in detail, including anticipated max pressure and max rate:

Hydraulic fracturing is completed in accordance with state regulations using water recycled from previously fractured wells and obtained from freshwater sources. This water is mixed with sand and a small percentage (less than 0.1%) of chemicals (including 15% Hydrochloric acid, friction reducer, biocide, and scale inhibitor), referred to in the industry as a "slickwater" completion. Maximum anticipated internal casing pressure is expected to be approximately 10,000 psi, maximum anticipated treating rates are expected to average approximately 100 bpm. Stage lengths vary from 150 to 300 feet. Average approximately 350,000 gallons of water per stage. Sand sizes vary from 100 mesh to 20/40 mesh. Average approximately 200,000-600,000 pounds of proppant per stage.

21) Total Area to be disturbed, including roads, stockpile area, pits, etc., (acres): 18.49 acres (built)

22) Area to be disturbed for well pad only, less access road (acres): 6.86 acres (built)

23) Describe centralizer placement for each casing string:

- Surface: Bow spring centralizers – One centralizer at the shoe and one spaced every 500’.
- Intermediate: Bow spring centralizers– One centralizer at the shoe and one spaced every 500’.
- Production: One solid body centralizer spaced every other joint from production casing shoe to landing point. One solid body centralizer spaced every joint from landing point to planned top of cement.

RECEIVED
Office of Oil and Gas

24) Describe all cement additives associated with each cement type:

Conductor: No additives
Surface: Calcium Chloride. Used to speed the setting of cement slurries
Intermediate: Calcium Chloride. Used to speed the setting of cement slurries.
Production: Calcium Carbonate, Fluid Loss, Extender, Dispersent, Viscosifier, Defoamer, POZ, Bonding Agent, Retarder,
Anti-Settling/Suspension Agent

MAY 31 2024
WV Department of
Environmental Protection

25) Proposed borehole conditioning procedures:

Surface: Circulate hole clean while rotating & reciprocating the drill string until cuttings diminish at surface.
Intermediate: Circulate hole clean while rotating & reciprocating the drill string until cuttings diminish at surface.
Production: Perform a cleanup cycle by pumping 3-8 bottoms up or until the shakers are clean. Check volume of cuttings coming across the shakers every 15 minutes.

*Note: Attach additional sheets as needed.



May 16, 2024

Mr. Taylor Brewer
West Virginia Department of Environmental Protection
Office of Oil and Gas
601 57th Street SE
Charleston, WV 25304

Re: Class L Cement Variance Request
Jefferson N-7HU Gas Well
Proctor District, Wetzel County

Dear Mr. Brewer,

EQT Production Company (EQT) has been notified by our cement providers that they will no longer be providing Class A cement. As a result of this, EQT is requesting the option to utilize Class L cement, if necessary, in place of Class A cement for its cement jobs.

The variance request from Legislative Rule 35CSR8, Section 9.2.h.8, related to the use of Class L Cement, was approved by the Office of Oil and Gas on September 13, 2022. A copy of the variance is included with this request.

If you have any questions, please do not hesitate to contact me at 724-746-9073.

Sincerely,

A handwritten signature in blue ink, appearing to read 'J. Zavatchan'.

John Zavatchan
Project Specialist - Permitting

Enc.

RECEIVED
Office of Oil and Gas
MAY 31 2024
WV Department of
Environmental Protection

07/19/2024



west virginia department of environmental protection

Office of Oil and Gas
601 57th Street, SE
Charleston, WV 25304
Phone (304) 926-0450

Harold D. Ward, Cabinet Secretary
dep.wv.gov

**BEFORE THE OFFICE OF OIL AND GAS
DEPARTMENT OF ENVIRONMENTAL PROTECTION
STATE OF WEST VIRGINIA**

**IN THE MATTER OF A VARIANCE FROM)
LEGISLATIVE RULE 35CSR4)
SECTION 11.5 AND LEGISLATIVE RULE)
35CSR8 SECTION 9.2.h.8.,)
RELATING TO THE CEMENTING)
OF OIL AND GAS WELLS)**

ORDER NO. 2022-14

RECEIVED
Office of Oil and Gas

MAY 31 2024

WV Department of
Environmental Protection

REPORT OF THE OFFICE

In response to industry requests, the West Virginia Department of Environmental Protection, Office of Oil and Gas has reviewed the proposed use of American Petroleum Institute (API) Class L cement to be used in place of API Class A cement for well construction.

FINDINGS OF FACT

1. On July 14, 2022, Northeast Natural Energy (NNE) submitted a variance request from Legislative Rule 35CSR8 Section 9.2.h.8., for the use of API Class L cement in place of API Class A cement, relating to the construction of horizontal wells.
2. Laboratory analysis submitted by NNE on July 14, 2022, indicates API Class L cement is comparable to API Class A cement and thereby satisfies the requirements of the West Virginia Code.
3. Contemporaneously, the Chief of the Office of Oil and Gas also chose to consider a variance to Legislative Rule 35CSR4 Section 11.5., for the use of API Class L cement in place of API Class A cement, relating to the construction of vertical wells.

4. On August 18, 2022, the Office of Oil and Gas provided public notice of acceptance of public comments on the variance consideration. During the 20-day public comment period, no comments were received.

CONCLUSIONS OF LAW

Pursuant to Article 6 and Article 6A, Chapter 22 of the Code of West Virginia, the Office of Oil and Gas has jurisdiction over the subject matter, and the persons interested therein, and jurisdiction to promulgate the hereinafter prescribed Order.

Pursuant to Legislative Rule 35CSR4, Section 18 and Legislative Rule 35CSR8, Section 14, the Chief of the Office of Oil and Gas may grant a variance from any requirement of these rules.

ORDER

It is ordered that the Class L cement product approved and monogrammed by API is approved for use in place of API Class A cement for well construction subject to the provisions of Legislative Rule 35CSR4 and Legislative Rule 35CSR8.

RECEIVED
Office of Oil and Gas

MAY 31 2024

Dated this, the 13th day of September, 2022.

WV Department of
Environmental Protection

IN THE NAME OF THE STATE OF WEST VIRGINIA

OFFICE OF OIL AND GAS
DEPARTMENT OF ENVIRONMENTAL PROTECTION
OF THE STATE OF WEST VIRGINIA

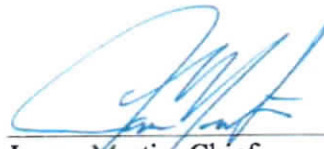

James Martin, Chief
Office of Oil and Gas

07/19/2024

WEST VIRGINIA GEOLOGICAL PROGNOSIS

Jeffersons
Jeffersons
S-002747

Drilling Objectives: Utica / Point Pleasant
County: Wetzel
Quad: New Martinsville
Elevation: 1230 KB
Recommended Azimuth: 150 Degrees

1217 GL

ESTIMATED FORMATION TOPS

Formation	Top (TVD)	Base (TVD)	Lithology	Comments
Fresh Water Zone	1	767		FW @ 1,767...
Washington Coal	504	506 Coal		Not mined - solid coal
Sewickley Coal	848	850 Coal		Not mined - solid coal
Pittsburgh Coal	938	942 Coal		Not mined - solid coal
Big Lime	2203	2294 Limestone		SW @ 1652.1709...
Big Injun	2294	2447 Sandstone		
Int. 1 csg pt	2497			
Weir	2545	3047 Sandstone		Not in Storage Zone
Gordon	3047	3107 Silty Sand		Offset Oil/Gas producer
Fifty Foot	3107	3228 Silty Sand		
Bayard	3228	5447 Silty Sand		
Alexander	5447	5888 Silty Sand		Base of Gordon & Benson Offset Well Perforations at 4522' TVD
Elks	5888	6392 Gray Shales and Silts		
Sonyea	6392	6484 Gray shale		Gas Show Possible
Middlesex	6484	6508 Shale		
Genesee	6508	6569 Gray shale interbedded		Gas Show Possible
Genesee	6569	6587 Black Shale		
Tully	6587	6619 Limestone		
Hamilton	6619	6664 Gray shale with some		Gas Show Possible
Marcellus	6664	6717 Black Shale		Very hard, resistant chert beds
Onondaga	6717	6877 Limestone		Base of Huntersville/Oriskany Offset Well Perforations at 6893' TVD
Needmore	6877	6950 Gray Shale		
Oriskany	6950	7025 Sandstone		Hard resistant Limestone
Helderberg	7025	7232 Limestone		
Keyser	7232	7329 Limestone		
Bass Island	7329	7417 Limestone/Dolomite		
Salina	7417	7640 Salt/Anhydrite/Dol/Sh		Potential fluid reactive and washout zones
-Top Salt	7640	8278 Salt/Anhydrite/Dol/Sh		Potential Loss Zone, Historical Drilling Issues
-Base Salt	8278	8466 Salt/Anhydrite/Dol/Sh		Potential Loss Zone, Historical Drilling Issues
Lockport	8466	8834 Limestone/Dolomite		
Rose Hill	8834	9205 Gray/GN/Red Shale		Unstable shale, Historical Drilling Issues
Packer Shell	9205	9314 Limestone interbed Sh		Very hard, resistant sandstone
Clinton	9314	9419 Sandstone/Quartzite		
Queenston	9419	10194 Red Shale		
Reedsville	10194	11314 Red/Gray Shale		
-Red/Gray Shale Transition	10311	10311 Red/Gray Shale		
Int. 2 csg pt	10344			
Utica	11314	11424 Black Shale		Gas / High Pressure Possible
Point Pleasant	11424	11507 Black SH/ interbed LS		Gas / High Pressure Possible
-Lateral Zone	11482			Start Lateral at 11482'
Trenton	11540	Limestone		

Top RR Base RR
No red rock reported on offsets

Target Thickness	116 feet
Max Anticipated Rock Pressure	10386 PSI

Comments:

Intermediate casing point is recommended beneath the Big Injun to shut off any water production from the Upper Devonian sands. Intermediate casing should be cemented into the surface casing per WV regulations.
The estimated landing point TVD is 11482', rig geologist may adjust landing point. After the well is landed, drill to reported bed dips/ geologists' recommendation. The geologic structure is estimated to be dipping up at 91-degrees.

RECOMMENDED CASING POINTS

Fresh Water/Coal	CSG OD	18 5/8	CSG DEPTH:	992	50 ft below Pittsburgh Coal. Will not
Intermediate 1:	CSG OD	13 3/8	CSG DEPTH:	2497	50 ft below Big Injun Base
Intermediate 2:	CSG OD	9 5/8	CSG DEPTH:	10344	150 ft below Reedsville
Production:	CSG OD	5 1/2	CSG DEPTH:	@ TD	

RECEIVED
 Office of Oil and Gas
 MAY 31 2024
 WV Department of Environmental Protection

EQT Production

Wellbore Diagram

Well: Jeffersons N-7HU
Pad: Jeffersons
Elevation: 1217' GL 1230' KB

County: Wetzel
State: West Virginia

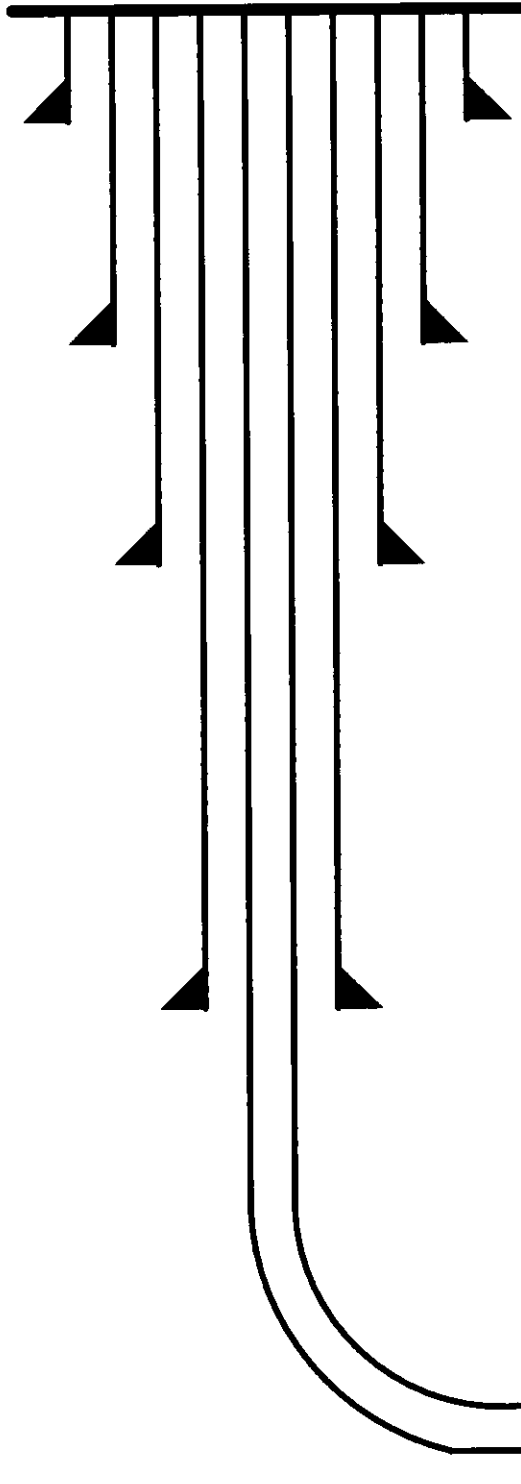

Conductor @ 120'

30", BW, BW cement to surface w/ Class A

Surface 0 @ 1,013'

20", 106.5#, J-55, cement to surface w/ Class A

Surface @ 2,497'

13-3/8", (2,100' - 54.5#), (397' - 61#), J-55, cement to surface w/ Class A/L

RECEIVED
Office of Oil and Gas

MAY 31 2024

WV Department of
Environmental Protection

Intermediate @ 10,376' MD / 10,344' TVD

9-5/8", 47#, P-110, cement to surface w/ Class A/H/L

Production @ 27,131' MD / 11,482' TVD

5-1/2", 23#, P-110, cement to 5,000' from surface w/ Class A/H/L

Formation: Utica / Point Pleasant

NOT TO SCALE

07/19/2024
Digitally signed by Stephen Mccoy
Stephen Mccoy
Date: 2024.05.08 09:26:39 -0400



May 16, 2024

Mr. Taylor Brewer
West Virginia Department of Environmental Protection
Office of Oil and Gas
601 57th Street SE
Charleston, WV 25304

Re: Casing on Jefferson N-7HU

Dear Mr. Brewer,

The 18-5/8" surface 0 casing was set by Tug Hill Operating at 1,013' KB, 246' below the deepest freshwater and 71' below the deepest coal.

The 13-3/8" surface casing will be set at 2,497' KB, 50' below the base of the Big Injun formation. Please note that WW-6B form shows the surface casing proposed to be set at 2,497' as a coal casing. The coal is protected by the Surface 0 casing shown on the WBD. This has been set by Tug Hill Operating.

If you have any questions, please do not hesitate to contact me at 724-746-9073.

Sincerely,

A handwritten signature in blue ink, appearing to read 'J. Zavatchan'.

John Zavatchan
Project Specialist - Permitting

Enc.

RECEIVED
Office of Oil and Gas
MAY 31 2024
WV Department of
Environmental Protection

07/19/2024

EQT Production
Hydraulic Fracturing Monitoring Plan
Pad ID: Jeffersons
County: Wetzel

May 8, 2024

RECEIVED
Office of Oil and Gas

MAY 31 2024

WV Department of
Environmental Protection

Purpose

The purpose of this pad-specific Hydraulic Fracturing Monitoring Plan is to identify and notify conventional well operators near EQT hydraulic fracturing in Wetzel County, WV prior to hydraulic fracturing at the following EQT wells on the Jeffersons pad: N-7HU, N-8HU, N-9HU, N-10HU and N-11HU.

Due to the requirements under 35CSR8 5.11, the permittee is required to review the area surrounding the proposed well pad so as to identify and evaluate potential conduits for unintended fracture propagation.

A report is required to be submitted along with a well work permit application.

The plan is being implemented as an additional safety measure to be utilized in conjunction with existing best management practices and emergency action plans for the site. These additional measures include coordination with well operators of the timing and location of the hydraulic fracturing, establishment of measures well operators should implement, and assurance that the OOG is notified of the timeline, as well as any issues that may arise during fracturing.

1. Communications with Well Operators

EQT, using available data (WV Geological Survey, WVDEP website, and IHS data service), has identified all known wells and well operators within 500 feet of this pad and the lateral sections that are known or could reasonably be expected to be within range of the fracture propagation. A map showing these wells along with a list of the wells and operators is included in **Attachment A**.

EQT will notify these operators of the hydraulic fracturing schedule for these wells, and coordinate with them throughout the fracturing process.

EQT will recommend to these operators at a minimum to:

1. Inspect their surface equipment prior to fracturing to establish integrity and establish pre-frac well conditions
2. Observe wells closely during and after fracturing and monitor for abnormal increases in water, gas or pressure
3. Inspect or install master valves or other necessary equipment for wellhead integrity capable of a pressure recommended by EQT
4. Notify the OOG and EQT if any changes in water, gas production, pressure, or other anomalies are identified

2. Reporting

EQT will provide information relating to the hydraulic fracturing schedule, communication with other operators, and ongoing monitoring of the work upon request of OOG or immediately in the event of any noted abnormalities.

RECEIVED
Office of Oil and Gas
MAY 31 2024
WV Department of
Environmental Protection

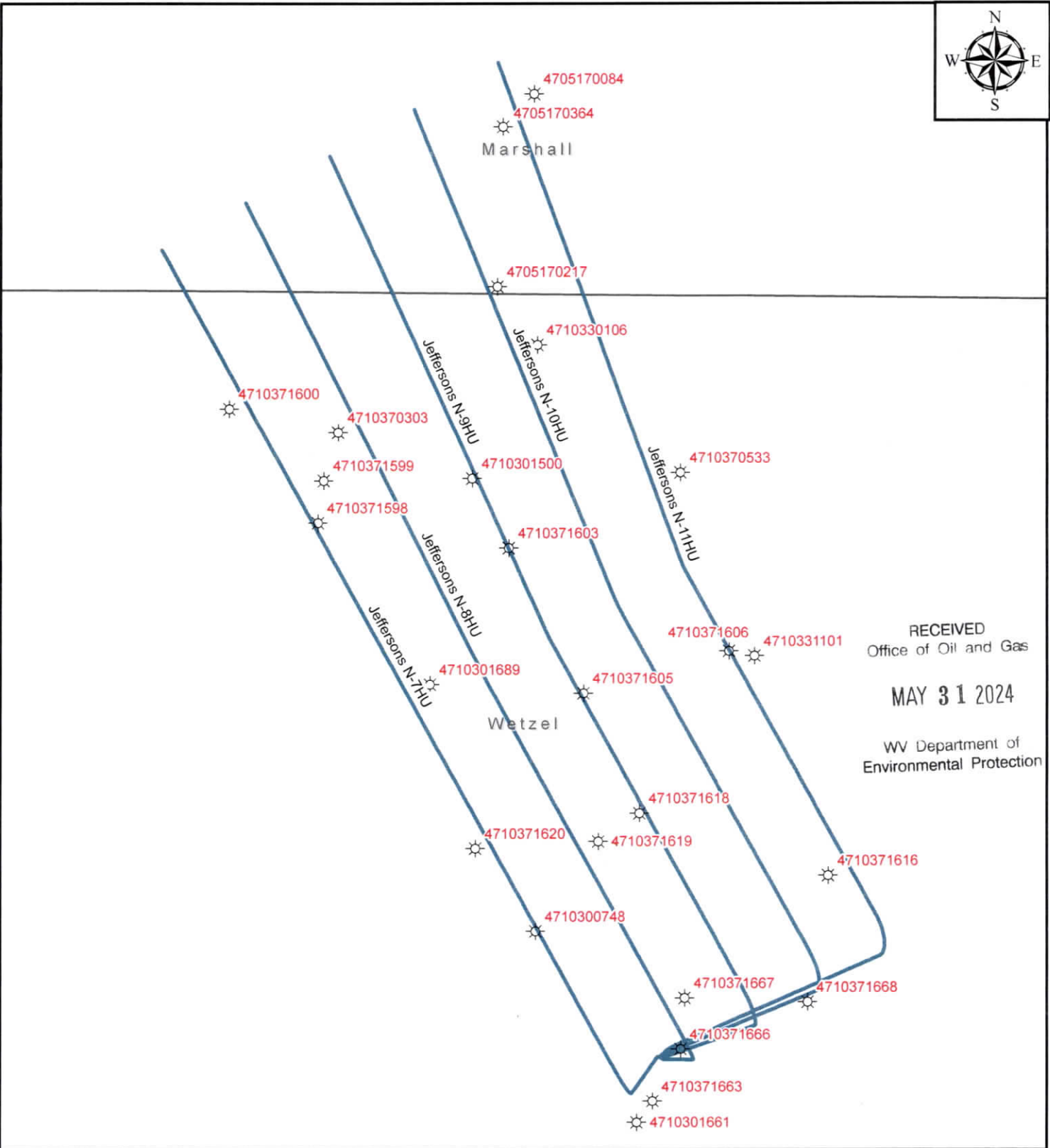
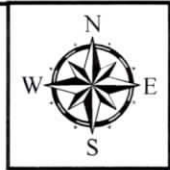

RECEIVED
Office of Oil and Gas
MAY 31 2024
WV Department of
Environmental Protection

EQT
EQT Corporation
625 Liberty Avenue
Pittsburgh, PA 15222

Jeffersons North

Vertical Offsets and Foreign Laterals within 500 Feet

Created By: Kellen Waltman Printed By: McClayO on 3/7/2024
Path: G:\users\olivia.judgins\Vertical Offset\GISWorking\GISWorking.aprx

Well Lateral_FM

Formation

- Genesee
- Marcellus
- Utica
- Jeffersons_Offset_Wells

Disclaimer:

This map is confidential and is to be used only for the express informational purposes for which it was created. Unauthorized use, copying, or dissemination is strictly prohibited. EQT does not warrant the accuracy of the location of any items shown on this map, including, but not limited to, any structures, well or pipeline facilities, property boundaries, topography, roadways, or waterways. The items shown on the map may not have been placed on the map using survey lines or GPS coordinates. The specific location of any of the map items should be determined by a field survey performed by a licensed surveyor upon consultation with EQT.

1,000 500 0 1,000
Feet
1:25,891

1:1,161,728

OH PA WV

07/19/2024

API_UW_12	ENVOperato	ENVWellSta	ENVWellTyp	InitialOps	Latitude	Longitude	ElevationG	ElevationK	MD_FT	TVD_FT	WellName	WellSymbol
47-103-70303-00	MANUFACTURERS LIGHT & HEAT CO	COMPLETED	UNREPORTED	MANUFACTURERS LIGHT&HEAT	39.71484	-80.7896	1165	0	0	2862	1	UNREPORTED-COMPLETED
47-103-71663-00	(N/A)	UNREPORTED	UNREPORTED	(N/A)	39.68475	-80.7706	1109	0	0	0	T V SMITH	UNREPORTED-UNREPORTED
47-103-71668-00	(N/A)	UNREPORTED	UNREPORTED	(N/A)	39.6894	-80.7616	1166	0	0	0	WILLIAM PALMER	UNREPORTED-UNREPORTED
47-103-71620-00	BP	UNREPORTED	UNREPORTED	BP	39.69607	-80.7812	1169	0	0	0	OSCAR ALLEN YOHO, JACKSON	UNREPORTED-UNREPORTED
47-103-01500-00	PERKINS OIL & GAS, INC.	PRODUCING	GAS	PERKINS OIL & GAS	39.71278	-80.7817	1262	1272	2827	2827	565	GAS-PRODUCING UNREPORTED-
47-103-70533-00	BP	UNREPORTED	UNREPORTED	BP	39.71325	-80.7695	1306	0	0	0	MARIA PARSONS	UNREPORTED-UNREPORTED
47-103-71616-00	BP	UNREPORTED	UNREPORTED	BP	39.69506	-80.7605	1290	0	0	0	JAMES PARSONS	UNREPORTED-UNREPORTED
47-103-71603-00	(N/A)	UNREPORTED	UNREPORTED	(N/A)	39.70973	-80.7795	1226	0	0	0	F M PARSONS	UNREPORTED-UNREPORTED
47-103-71667-00	(N/A)	UNREPORTED	UNREPORTED	(N/A)	39.68954	-80.7688	1163	0	0	0	WILLIAM PALMER	UNREPORTED-UNREPORTED
47-103-01689-00	PERKINS OIL & GAS, INC.	P & A	OTHER	PERKINS OIL & GAS	39.70347	-80.784	1113	1122	2846	2846	PARSONS 1220	OTHER-P & A UNREPORTED-
47-103-71619-00	BP	UNREPORTED	UNREPORTED	BP	39.69651	-80.774	1132	0	0	0	HENRY GARNER	UNREPORTED-UNREPORTED
47-103-71599-00	MANUFACTURERS LIGHT & HEAT CO	UNREPORTED	UNREPORTED	MANUFACTURERS LIGHT&HEAT	39.71263	-80.7904	1251	0	0	0	ICEY L COOPER	UNREPORTED-UNREPORTED
47-103-71605-00	(N/A)	UNREPORTED	UNREPORTED	(N/A)	39.70319	-80.775	1028	0	0	0	HENRY GARNER	UNREPORTED-UNREPORTED
47-103-71618-00	(N/A)	UNREPORTED	UNREPORTED	(N/A)	39.69782	-80.7716	1261	0	0	0	MESHACK YOHO HALL, OLAN H. L-	UNREPORTED-UNREPORTED
47-103-00748-00	TC ENERGY	P & A	GAS	COLUMBIA GAS TRANSMISSION	39.69245	-80.7776	1077	1086	2785	2785	1263	GAS-P & A UNREPORTED-
47-103-31101-00	MANUFACTURERS LIGHT & HEAT CO	UNREPORTED	UNREPORTED	MANUFACTURERS LIGHT&HEAT	39.70498	-80.765	1202	0	0	0	MESHACK YOHO	UNREPORTED-UNREPORTED
47-051-70364-00	(N/A)	UNREPORTED	UNREPORTED	(N/A)	39.72874	-80.7802	1227	0	0	0	G MCKINNEY	UNREPORTED-UNREPORTED
47-051-70217-00	TRI STATE OIL & GAS	UNREPORTED	UNREPORTED	TRI STATE O&G	39.72151	-80.7804	1237	0	0	0	J YOHO	UNREPORTED-UNREPORTED
47-103-71606-00	BP	UNREPORTED	UNREPORTED	BP	39.70522	-80.7665	1138	0	0	0	JAMES COZART	UNREPORTED-UNREPORTED
47-103-71666-00	(N/A)	UNREPORTED	UNREPORTED	(N/A)	39.68722	-80.769	1195	0	0	0	T V SMITH	UNREPORTED-UNREPORTED
47-103-30106-00	MANUFACTURERS LIGHT & HEAT CO	COMPLETED	DRY HOLE	MANUFACTURERS LIGHT&HEAT	39.7189	-80.778	1111	0	0	2717	JACOB YOHO	COMPLETED-UNREPORTED-
47-051-70084-00	WHEELING NATURAL GAS CO., THE	UNREPORTED	UNREPORTED	WHEELING NATURAL GAS CO., THE	39.73021	-80.7784	1214	0	2793	0	JAMES HENRY	UNREPORTED-UNREPORTED
47-103-71600-00	MANUFACTURERS LIGHT & HEAT CO	UNREPORTED	UNREPORTED	MANUFACTURERS LIGHT&HEAT	39.71583	-80.796	1052	0	0	0	GEORGE SMITH	UNREPORTED-UNREPORTED
47-103-71598-00	BP	UNREPORTED	UNREPORTED	BP	39.71075	-80.7907	1114	0	0	0	LUCIUS HOGE	UNREPORTED-UNREPORTED
47-103-01661-00	PERKINS OIL & GAS, INC.	P & A	OTHER	PERKINS OIL & GAS	39.68376	-80.7715	1188	1198	0	0	BRIGGS 1	OTHER-P & A

RECEIVED
Office of Oil and Gas
MAY 31 2024
WV Department of
Environmental Protection

JEFFERSONS N-7HU
UTICA UNIT - 392.87298± ACRES
EQT PRODUCTION COMPANY

NOTES

1. BORE PATH BASED ON GRID NORTH.
2. NO WATER WELLS WITHIN 250' OF WELL WERE FOUND, NO DWELLINGS WITHIN 625' OF PAD CENTER WERE FOUND.
3. OWNERSHIP TAKEN FROM PUBLIC RECORDS OF WETZEL COUNTY, WV IN MARCH, 2024. COORDINATES AND WELL TIES BASED UPON DIFFERENTIAL GPS MEASUREMENTS.
4. WELL LOCATION REFERENCES ARE BASED UPON THE MAGNETIC MERIDIAN.
5. ALL DEEP WELLS WITHIN 1,000' ARE SHOWN ON THIS PLAT.
6. BOUNDARIES ALONG ROADWAYS ARE BASED UPON MEMORANDUM BY DICKIE, MCCAMEY & CHILCOTE, P.C. FILE 0058304.0401147
7. L.P.1 & LTP ARE THE SAME POINT.

INSET "B"

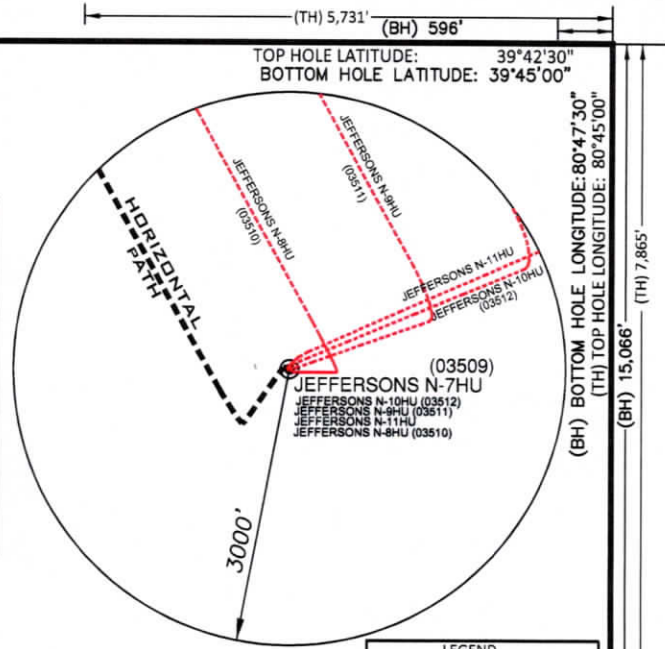

LEGEND

- LEASED TRACTS
- SURFACE TRACTS
- WELL LATERAL
- POINT PLEASANT LEGS
- UNIT BOUNDARY
- (A) LEASE # (SEE 6A1 FORM)
- 400' BORE PATH OFFSET
- 500' WELL BORE OFFSET
- (FTP) PROPOSED FIRST TAKE POINT
- (LTP) PROPOSED LAST TAKE POINT
- FORCED POOL TRACT

(+) DENOTES LOCATION ON UNITED STATES TOPOGRAPHIC MAPS

DETAIL SKETCH "A" N.T.S.

JEFFERSONS N-11HU (03512)
 JEFFERSONS N-10HU (03512)
 JEFFERSONS N-7HU (03509)
 JEFFERSONS N-9HU (03511)
 JEFFERSONS N-8HU (03510)

REFERENCES SCALE 1"=500'

JEFFERSONS N-7HU
 S 23°43' W 474.9'
 S 81°07' E 398.5'
 12" HICKORY

10" WHITE OAK

INSET "A"

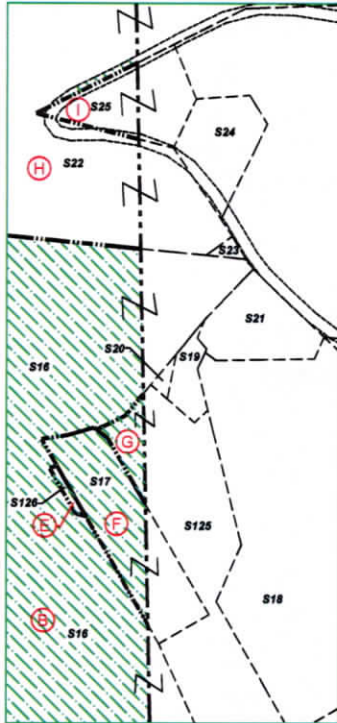

CURVE	CHORD BEARING	CHORD LENGTH	RADIUS	ARC LENGTH
C1	S 57°40' W	7.56'	8.61'	7.83'
C2	N 37°23' W	96.61'	878.21'	96.66'
C3	N 32°43' W	232.09'	3902.64'	232.12'
C4	N 30°02' W	272.57'	7135.88'	272.58'

LINE	BEARING	DISTANCE
L1	N 64°05' E	876.39'
L2	S 33°25' E	1081.63'
L3	N 19°13' W	11.37'
L4	N 89°03' W	39.93'
L5	S 35°18' W	737.63'
L6	S 57°31' W	3.49'
L7	N 65°45' W	13.38'
L8	N 45°34' W	27.27'

SURFACE HOLE
 UTM. NAD83, ZONE 17
 IN METERS
 N) 4,393,018.54
 E) 519,707.68

LANDING POINT 1
 UTM. NAD83, ZONE 17
 IN METERS
 N) 4,392,994.84
 E) 519,454.68

BOTTOM HOLE
 UTM. NAD83, ZONE 17
 IN METERS
 N) 4,397,022.02
 E) 517,133.63

FILE NUMBER _____
 DRAWING NUMBER: JEFFERSONS_N-7HU_PLAN1
 SCALE 1" = 2000'
 MINIMUM DEGREE OF ACCURACY 1/200
 PROVEN SOURCE OF ELEVATION SUBMETER MAPPING
GRADE GPS

I, THE UNDERSIGNED, HEREBY CERTIFY THAT THIS PLAT IS CORRECT TO THE BEST OF MY KNOWLEDGE AND BELIEF AND SHOWS ALL THE INFORMATION REQUIRED BY LAW AND THE RULES ISSUED AND PRESCRIBED BY THE DEPARTMENT OF ENVIRONMENTAL PROTECTION

David L Jackson

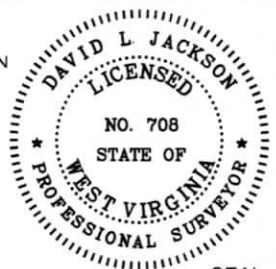

JACKSON SURVEYING INC.
 P.O. Box 1460
 Clarksburg, WV 26302
 304-623-5851

WVDEP
 OFFICE OF OIL & GAS
 601 57TH STREET, SE
 CHARLESTON, WV 25304

DATE: JULY 17, 2024
 OPERATORS WELL NO. JEFFERSONS N-7HU
 API WELL NO. 47-103-03509
 STATE WV COUNTY WETZEL PERMIT 03509

WELL TYPE: OIL ___ GAS X LIQUID INJECTION ___ WASTE DISPOSAL ___
 (IF "GAS") PRODUCTION X STORAGE ___ DEEP X SHALLOW ___
 LOCATION ELEVATION 1217.5' WATERSHED (HUC 10) FRENCH CREEK
 DISTRICT PROCTOR COUNTY WETZEL
 QUADRANGLE NEW MARTINSVILLE 7.5' LEASE NUMBER SEE WW-6A1 FORM

SURFACE OWNER EDWARD H. & JOAN E. ESTEP ACREAGE 92.302
 OIL & GAS ROYALTY OWNER JESTADT HOLDINGS LLC LEASE ACREAGE 92.302
 PROPOSED WORK: DRILL X CONVERT ___ DRILL DEEPER ___ REDRILL ___ FRACTURE OR STIMULATE X PLUG OFF OLD FORMATION ___
 PERFORATE NEW FORMATION ___ OTHER PHYSICAL CHANGE (SPECIFY) _____
 TARGET FORMATION POINT PLEASANT ESTIMATED DEPTH TVD: 11,482' TMD: 27,131'
 WELL OPERATOR EQT PRODUCTION COMPANY DESIGNATED AGENT JOSEPH C. MALLOW
 ADDRESS 400 WOODCLIFF DRIVE ADDRESS 427 MIDSTATE DRIVE
CANONSBURG, PA 15317 CLARKSBURG, WV 25301

COUNTY NAME PERMIT

07/19/2024

form wwg

JEFFERSONS N-7HU UTICA UNIT - 392.87298± ACRES EQT PRODUCTION COMPANY

LEGEND

- LEASE TRACTS
- - - SURFACE TRACTS
- - - WELL LATERAL
- - - POINT PLEASANT LEGS
- - - UNIT BOUNDARY
- (A) LEASE # (SEE 6A1 FORM)
- - - 400' BORE PATH OFFSET
- - - 500' WELL BORE OFFSET
- (FTP) PROPOSED FIRST TAKE POINT
- (LTP) PROPOSED LAST TAKE POINT
- ▨ FORCED POOL TRACT

SCALE 1" = 2000'

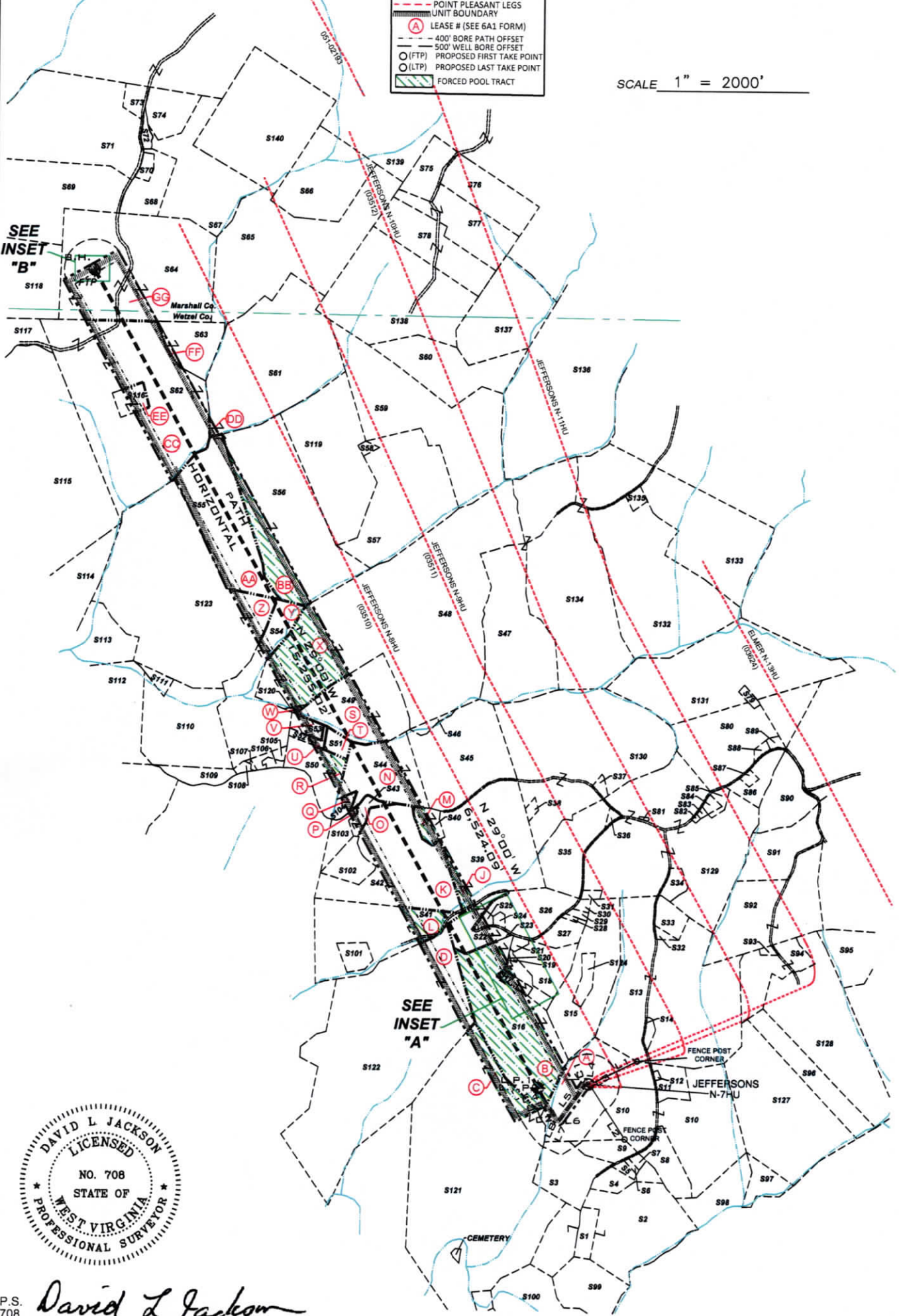

P.S. 708 *David L Jackson*

07/19/2024



OPERATOR'S
WELL #: JEFFERSONS N-7HU
DISTRICT: Proctor
COUNTY: Wetzel
STATE: WV
API #: 47-103-03509

WELL PLAT
PAGE 2 OF 4
DATE: 07/17/2024

form wwg

**JEFFERSONS N-7HU
UTICA UNIT - 392.87298± ACRES
EQT PRODUCTION COMPANY**

* FORCED POOLED TRACTS ARE HIGHLIGHTED

Parcels within Unit Boundary				
Tags	Number	Tax Map -Parcel	Surface Owner	Acres
A	S10	12-7-27	Edward H. & Juan C. Esler	92.302
B	S16	12-7-26	EQT TGH Exploration II, LLC	59.89
C	S121	12-7-40	EQT TGH Exploration II, LLC	175.55
D	S122	12-7-24	Lance C. & Minerva R. Davis	164.2
E	S126	12-7-62	Colby Dean Sidenstricker	0.065
F	S17	12-7-26.1	Colby Dean Sidenstricker	2.01
G	S125	12-7-61	Colby Dean Sidenstricker	4.203
H	S22	12-7-15	Kevin S & Meinda S Goff	22.63
I	S25	12-7-15.3	Billy Sweeney	1.26
J	S39	12-7-4.1	Robert Joseph Coleman	55.81
K	S42	12-7-3	Matthew Rohr & Wayne Raber	55.828
L	S41	12-7-14	Matthew Rohr & Wayne Raber	32.74
M	S40	12-7-59	Tanner Kelley	5
N	S44	12-7-3.2	Lisa M. Negele	28.47
O	S43	12-7-3.3	Robert Joseph Coleman	3.53
P	S103	12-7-3.5	Robert Joseph Coleman	5.422
Q	S104	12-7-3.1	Jud' L. Evans & Mark K. Mason, Jr.	3.192
R	S50	12-7-2	Jeremy W. & Shannon E. Hodgeson	19.8
S	S49	12-2-16	Laura Lee Cook	33
T	S51	12-2-15.1	Vivian A. Parsons, Et Al	5
U	S52	12-2-15.2	Charles Phillip Parsons	2
V	S53	12-2-15	Charles Phillip Parsons	3
W	S120		Midcap School	
X	S48	12-2-8	Laura Lee Richards Cook	185.125
Y	S54	12-2-7	Jonathan D. Amnah	44.5
Z	S123	12-1-20	Charles E. Fruhnapfel, Trustee of the Charles E. Fruhnapfel Living Trust, Dated October 3, 2017	126
AA	S55	12-2-1	James Cavine Benefel, III	49
BB	S56	12-2-2	Ruby Wood, Et Al	82
CC	S62	12-01-40	Mark W. Booth, Maggie Ann Rocwell & George E. Booth, Jr.	117
DD	S61	05-26-16	Heartwood Forestland Fund VII LP	82.5
EE	S116	12-1-41	Mark W. Booth, Maggie Ann Rocwell & George E. Booth, Jr.	5
FF	S63	12-2-24	Maggie Ann Rocwell, Mark W. Booth & George E. Booth, Jr.	13.1
GG	S64	05-26-18	Eric Jay Booth	94

Number	Tax Map -Parcel	Adjoining Parcels Ownership Table	Acres
S1	12-7-44.1	James Foster	5.054
S2	12-7-44	Chad J. & Velishia I. Shepherd	15.06
S3	12-7-42.4	Steven Mark Cecil, et al, Peggy Lou & Albert Cecil - L/E	17.333
S4	12-7-42.5	James D. Furbee, II	6.43
S5	12-7-42.2	April Fluharty	6.5
S6	12-7-42.3	James D. Furbee, II	0.528
S7	12-7-42.1	James D. Furbee, II	1.21
S8	12-7-27.2	Douglas I. & Patricia A. Pitts	10.73
S9	12-7-42	James D. Furbee, II	6.5
S11	12-7-27.1	Edward H. & Joan E. Estep	6.718
S12	12-7-43	Furbee Cemetery	1.11
S13	12-7-20	Jeffrey A. & Paula J. Gorby	104.72
S14	12-7-28	Palmer Cemetery	0.98
S15	12-7-19	Jeffery S. Underwood & Velvet K. Parks	41.4
S18	12-7-17	Jeffery S. Underwood & Velvet K. Parks	13.43
S19	12-7-17.2	EQT TGH Exploration II, LLC	0.35
S20	12-7-17.1	EQT TGH Exploration II, LLC	0.067
S21	12-7-16	Grant & Jennifer Throckmorton	1.1
S23	12-7-15.7	EQT TGH Exploration II, LLC	0.68
S24	12-7-15.2	Billy Sweeney	1.8
S26	12-7-15.1	Billy Sweeney	10.72
S27	12-7-15.6	Jeffery S. Underwood & Velvet K. Parks	5.923
S28	12-7-15.5	Jimmy L. & Sharon Sue Colvin	0.46
S29	12-7-15.4	Jimmy L. & Sharon Sue Colvin	0.97
S30	12-7-18	Cynthia Anne Parks Church	1
S31	12-7-7.6	Mary Ellen Stillwater	1.55
S32	12-7-20.2	Peter R. Tamborello & Annis E. Ponikvar	0.9
S33	12-7-20.1	Peter R. Tamborello & Annis E. Ponikvar	5.18
S34	12-7-7.4	Charles Lee & Betty J. Huggins	4
S35	12-7-5	Matthew D. Arrick	20.37

Number	Tax Map -Parcel	Adjoining Parcels Ownership Table	Acres
S36	12-7-6	Stacy E. Briner	0.25
S37	12-7-51	Jean J. Elter	1.25
S38	12-7-52	Brent J. & Sara L. Elter	1.025
S45	12-7-4	Rodney G. Elter	46.7
S46	12-2-8.1	Friend W. Parsons	0.5
S47	12-2-9	Laura Richards Cook	77
S57	12-2-4	Edith Salem & Lisa G. Larson	56.25
S58	12-2-4.1	Tyrone Sultzbach & Richard Wolf	1
S59	12-2-5	Clifford W. & Alberta B. Johnson	75.96
S60	12-2-6	Clifford W. & Alberta B. Johnson	36
S65	05-26-17	Heartwood Forestland Fund VII LP	82.56
S66	05-26-6	Heartwood Forestland Fund VII LP	36.17
S67	05-26-4.4	Otis F. & Glenda M. Rush	39.436
S68	05-26-4.1	Otis S. Rush, Et Ux	12.188
S69	05-26-19	Lois E. Booth & Eric Jay Booth	50
S70	05-26-4.3	Crystal & Randolph F. Matask	2.253
S71	05-26-4.5	Eric Jay Booth	74.388
S72	05-26-4.2	Otis S. Rush, et ux	1.58
S73	05-26-4	James R. & Melody A. Anderson	3.887
S74	05-26-4.1	Otis F. Rush Jr.	12.268
S75	05-26-23	Richard Joseph Otte	11.34
S76	05-26-9	Oliver Family Trust	21.75
S77	05-26-10	Oliver Family Trust	24.94
S78	05-26-14	Oliver Family Trust	27.56
S79	12-2-25	Michael K. & Rosetta A. Cozart	1.265
S80	12-2-20	Michael K. & Rosetta A. Cozart	34.063
S81	12-7-7.7	Robert C. Francis, Jr.	0.17
S82	12-7-7.3	Robert N. Edwards	0.24
S83	12-7-7.2	Robert N. Edwards	0.412
S84	12-7-7.1	Mark E. Elter	1.41
S85	12-7-7.5	Mark E. Elter	1.94
S86	12-7-8.1	Brian & Christine L. Nice	7.628
S87	12-7-8	Mark E. Elter	1.012
S88	12-2-20.1	Michael K. & Rosetta A. Cozart	1
S89	12-2-20.2	Michael K. Cozart	1.025
S90	12-7-9.1	James T. Eddy	17.47
S91	12-7-9	Michael J. & Alena R. Fayad	22.526
S92	12-7-21	Alena R. & Michael J. Fayad, III	58
S93	12-7-31.1	Michael J. Fayad III & Alena R. Fayad	0.808
S94	12-7-60	Michael J. Fayad III & Alena R. Fayad	8.203
S95	12-7-32.1	Charles & Judith Rose - L/E, Charles D. Rose, Jr. Et Al	18
S96	12-7-30	William C. Cross Jr. Irrev. Trust	19.75
S97	12-7-46	William C. Cross Jr. Irrev. Trust	9.53
S98	12-7-45	William C. Cross Jr. Irrev. Trust	17.24
S99	12-7-44.2	Danny E. & Jill L. McKinney	19.46
S100	12-12-9	Rickey A. Farley	17.175
S101	12-7-14.1	W VA Dept of Highways	3.49
S102	12-7-3.4	Dru W. Bills	8.253
S105	12-7-57	John D. Amnah	2.33
S106	12-7-58	John D. Amnah	1.03
S107	12-7-56	Staria K. Richmond	0.3
S108	12-7-1	Tammara & William J. Wetzel	1
S109	12-6-52	John D. Amnah	6.46
S110	12-1-34	John D. Amnah	38
S111	12-1-19	Steven Jack & Susan Hafer	36.5
S112	12-1-32	Baxter Farm, LLC	78.74
S113	12-1-31	Steven Jack & Susan Hafer	20
S114	12-1-19	Steven J. & Susan L. Hafer	36.5
S115	12-1-8	Benjamin J. Kocher	168.67
S117	12-1-8.1	Robert F. Rothlisberger	50.33
S118	05-27-24	Robert F. Rothlisberger	60.1
S119	12-02-03	Nelson M. & Mary D. Miller	51.72
S124	12-7-19-1	Grant & Jennifer Throckmorton	3.96
S127	12-7-29	William C. Cross Jr. Irrev. Trust	171
S128	12-7-31	William C. Cross Jr. Irrev. Trust	72.57
S129	12-7-7	EQT TGH Exploration II, LLC	117.27
S130	12-2-17	Randy F. Elter	97.75
S131	12-2-18	Michael K. & Rosetta A. Cozart	85.0513
S132	12-2-11	Beryl E. Mason	58.5
S133	12-2-12	Beryl E. Mason	59.9
S134	12-2-10	Laura Richards Cook	95
S135	12-2-11.1	Beryl E. Mason	1.7
S136	5-26-12	Marjorie Ann Stoneking - Life	153.989
S137	5-26-13	Marjorie Ann Stoneking - Life	40
S138	5-26-15	Oliver Family Trust	69
S139	5-26-7	Eastern Gas Transmission and Storage, Inc.	71
S140	5-26-5	Michael J. & Barbara L. Willey & Michelle E. Baker	65



P.S. 708 *David L Jackson*



07/19/2024

OPERATOR'S
WELL #: JEFFERSONS N-7HU
DISTRICT: Proctor
COUNTY: Wetzel
STATE: WV
API #: 47-103-03509

WELL PLAT
PAGE 3 OF 4
DATE: 07/17/2024

form. wv6

**JEFFERSONS N-7HU
UTICA UNIT - 392.87298± ACRES
EQT PRODUCTION COMPANY**

JEFFERSONS N-7HU				
TAG	LEASE ID	TMP	GRANTOR, LESSOR, ETC.	DEED BOOK/PAGE
A	242378002	12-7-27	Edward H. Estep and Joan Estep, husband and wife	OG 210A/205
B	242377002	12-7-26	Venable Royalty, Ltd. And V2, LP, et al.	OG 312A/410
C	242377002	12-7-40	Venable Royalty, Ltd. And V2, LP, et al.	OG 312A/410
D	244506003	12-7-24	Hammitt Land & Minerals, LLC, et al.	OG 263A/280
E	242377002	12-7-82	Venable Royalty, Ltd. And V2, LP, et al.	OG 312A/410
F	239208000	12-7-28.1	Jeffrey L. Mead, a single man, et al.	OG 238A/198
G	242377002	12-7-81	Venable Royalty, Ltd. And V2, LP, et al.	OG 312A/410
H	240516000	12-7-15	Rost Energy Company, Inc.	OG 268A/541
I	238803000	12-7-15.3	Philip H. Estep, a married man dealing in sole and separate property	OG 204A/164
J	240624000	12-7-4.1	R. Shane Goddard and Kathryn Goddard, husband and wife, et al.	OG 290A/122
K	240579000	12-7-3	Matthew Rohr, a married man dealing in his sole and separate property, remainderman, and Wayne Raber, a married man dealing in his sole and separate property, remainderman, et al.	OG 278A/810
L	242363017	12-7-14	Matthew Rohr, a married man dealing in his sole and separate property, et al.	OG 278A/814
M	218529001	12-7-59	The McCall 2016 Delaware Trust dated May 4, 2016, Elizabeth A. Beachell, Trustee, et al.	OG 277A/515
N	240579000	12-7-3.2	Matthew Rohr, a married man dealing in his sole and separate property, remainderman, and Wayne Raber, a married man dealing in his sole and separate property, remainderman, et al.	OG 278A/810
O	240579000	12-7-3.3	Matthew Rohr, a married man dealing in his sole and separate property, remainderman, and Wayne Raber, a married man dealing in his sole and separate property, remainderman, et al.	OG 278A/810
P	238703000	12-7-3.5	Robert Joseph Coleman, a single man, et al.	OG 202A/782
Q	240579000	12-7-3.1	Matthew Rohr, a married man dealing in his sole and separate property, remainderman, and Wayne Raber, a married man dealing in his sole and separate property, remainderman, et al.	OG 278A/810
R	119746008	12-7-2	R. Shane Goddard and Kathryn Goddard, husband and wife, et al.	OG 166A/432
S	239303000	12-2-16	Herbert L. Miller, aka Herbert Miller and Brenda S. Miller, husband and wife	OG 173A/673
T	242329004	12-2-15.1	Hammitt Land & Minerals, LLC, et al.	OG 263A/286
U	242329004	12-2-15.2	Hammitt Land & Minerals, LLC, et al.	OG 263A/286
V	242328001	12-2-15	Charles Philip Parsons, a single man, et al.	OG 221A/948
W	N/A	Midcap School	Unknown & Unlocatable	N/A
X	242409002	12-2-8	Hammitt Land & Minerals, LLC, et al.	OG 319A/368
Y	238958000	12-2-7	Betty Lou Goudy, a widow	OG 220A/884
Z	218528001	12-1-20	Shiben Estates, Inc., et al.	OG 277A/325
AA	173515001	12-2-1	Pathfinder Resources, LLC d/b/a Recon Pathfinder, LLC, et al.	OG 275A/203
BB	189409001	12-2-2	Chesapeake Appalachia, LLC, et al.	OG 157A/946
CC	242287004	12-1-40	Mark W. Booth, a married man dealing in his sole and separate property, et al.	OG 294A/154
DD	241687002	5-26-16	Venable Royalty, Ltd. and V14, LP, et al.	DB 1151/438
EE	242287004	12-1-41	Mark W. Booth, a married man dealing in his sole and separate property, et al.	OG 294A/154
FF	242287004	12-2-24	Mark W. Booth, a married man dealing in his sole and separate property, et al.	OG 294A/154
GG	241689003	5-26-18	Eric Jay Booth, a married man dealing in his sole and separate property, et al.	DB 953/268

JEFFERSONS N-7HU (Tracts Penetrated by Well Bore)				
TAG	LEASE ID	TMP	GRANTOR, LESSOR, ETC.	DEED BOOK/PAGE
A	242378002	12-7-27	Edward H. Estep and Joan Estep, husband and wife	OG 210A/205
B	242377002	12-7-26	Venable Royalty, Ltd. And V2, LP, et al.	OG 312A/410
H	240516000	12-7-15	Rost Energy Company, Inc.	OG 268A/541
K	240579000	12-7-3	Matthew Rohr, a married man dealing in his sole and separate property, remainderman, and Wayne Raber, a married man dealing in his sole and separate property, remainderman, et al.	OG 278A/810
L	242363017	12-7-14	Matthew Rohr, a married man dealing in his sole and separate property, et al.	OG 278A/814
N	240579000	12-7-3.2	Matthew Rohr, a married man dealing in his sole and separate property, remainderman, and Wayne Raber, a married man dealing in his sole and separate property, remainderman, et al.	OG 278A/810
O	240579000	12-7-3.3	Matthew Rohr, a married man dealing in his sole and separate property, remainderman, and Wayne Raber, a married man dealing in his sole and separate property, remainderman, et al.	OG 278A/810
S	239303000	12-2-16	Herbert L. Miller, aka Herbert Miller and Brenda S. Miller, husband and wife	OG 173A/673
T	242329004	12-2-15.1	Hammitt Land & Minerals, LLC, et al.	OG 263A/286
X	242409002	12-2-8	Hammitt Land & Minerals, LLC, et al.	OG 319A/368
Y	238958000	12-2-7	Betty Lou Goudy, a widow	OG 220A/884
Z	218528001	12-1-20	Shiben Estates, Inc., et al.	OG 277A/325
AA	173515001	12-2-1	Pathfinder Resources, LLC d/b/a Recon Pathfinder, LLC, et al.	OG 275A/203
CC	242287004	12-1-40	Mark W. Booth, a married man dealing in his sole and separate property, et al.	OG 294A/154
GG	241689003	5-26-18	Eric Jay Booth, a married man dealing in his sole and separate property, et al.	DB 953/268

* FORCED POOLED TRACTS ARE HIGHLIGHTED



P.S. 708 *David L Jackson*



OPERATOR'S
WELL #: JEFFERSONS N-7HU
DISTRICT: Proctor
COUNTY: Wetzel
STATE: WV
API #: 47-103-03509

07/19/2024
WELL PLAT
PAGE 4 OF 4
DATE: 07/17/2024

**INFORMATION SUPPLIED UNDER WEST VIRGINIA CODE
Chapter 22, Article 6A, Section 5(a)(5)
IN LIEU OF FILING LEASE(S) AND OTHER CONTINUING CONTRACT(S)**

Under the oath required to make the verification on page 1 of this Notice and Application, I depose and say that I am the person who signed the Notice and Application for the Applicant, and that –

- (1) the tract of land is the same tract described in this Application, partly or wholly depicted in the accompanying plat, and described in the Construction and Reclamation Plan;
- (2) the parties and recordation data (if recorded) for lease(s) or other continuing contract(s) by which the Applicant claims the right to extract, produce or market the oil or gas are as follows:

Lease Name or Number	Grantor, Lessor, etc.	Grantee, Lessee, etc.	Royalty	Book/Page
See attached list				

RECEIVED
Office of Oil and Gas

MAY 31 2024

WV Department of
Environmental Protection

**Acknowledgement of Possible Permitting/Approval
In Addition to the Office of Oil and Gas**

The permit applicant for the proposed well work addressed in this application hereby acknowledges the possibility of the need for permits and/or approvals from local, state, or federal entities in addition to the DEP, Office of Oil and Gas, including but not limited to the following:

- WV Division of Water and Waste Management
- WV Division of Natural Resources WV Division of Highways
- U.S. Army Corps of Engineers
- U.S. Fish and Wildlife Service
- County Floodplain Coordinator

The applicant further acknowledges that any Office of Oil and Gas permit in no way overrides, replaces, or nullifies the need for other permits/approvals that may be necessary and further affirms that all needed permits/approvals should be acquired from the appropriate authority before the affected activity is initiated.

Well Operator: EQT Production Company

By: John Zavatchan

Its: Permitting Specialist

Tag	Tax Parcel	Lease No.	Grantor, Lessor, etc.	Acres	Grantee, Lessee, etc.	Royalty	Book/Page
A	<u>12-7-27</u>	<u>242378002</u>	<u>Jestadt Holdings LLC</u> Edward H. Estep and Joan Estep, husband and wife TH Exploration, LLC	109.75 ac	TH Exploration, LLC EQT TGHL Exploration LLC	"at least 1/8th per WV Code 22-6-8"	OG 204A/134 Misc 154/899
B	<u>12-7-26</u>	<u>242377002</u>	<u>Venable Royalty, Ltd., et al.</u> Venable Royalty, Ltd. And V2, LP TH Exploration, LLC	244.49 ac	TH Exploration, LLC EQT TGHL Exploration LLC	"at least 1/8th per WV Code 22-6-8"	OG 312A/410 Misc 154/899
H	<u>12-7-15</u>	<u>240516000</u>	<u>Kevin S. Goff and Melinda S. Goff</u> Rost Energy Company, Inc. TH Exploration, LLC	151.184 ac	TH Exploration, LLC EQT TGHL Exploration LLC	"at least 1/8th per WV Code 22-6-8"	OG 269A/641 Misc 154/899
K	<u>12-7-3</u>	<u>240579000</u>	<u>Matthew Rohr, et al.</u> Matthew Rohr, a married man dealing in his sole and separate property, remainderman, and Wayne Raber, a married man dealing in his sole and separate property, remainderman, et al. TH Exploration, LLC	120 ac	TH Exploration, LLC EQT TGHL Exploration LLC	"at least 1/8th per WV Code 22-6-8"	OG 278A/810 Misc 154/899
L	<u>12-7-14</u>	<u>242363017</u>	<u>Matthew Rohr, et al.</u> Matthew Rohr, a married man dealing in his sole and separate property, et al. TH Exploration, LLC	42.25 ac	TH Exploration, LLC EQT TGHL Exploration LLC	"at least 1/8th per WV Code 22-6-8"	OG 278A/814 Misc 154/899
N	<u>12-7-3.2</u>	<u>240579000</u>	<u>Matthew Rohr, et al.</u> Matthew Rohr, a married man dealing in his sole and separate property, remainderman, and Wayne Raber, a married man dealing in his sole and separate property, remainderman, et al. TH Exploration, LLC	120 ac	TH Exploration, LLC EQT TGHL Exploration LLC	"at least 1/8th per WV Code 22-6-8"	OG 278A/810 Misc 154/899

<u>O</u>	<u>12-7-3.3</u>	<u>240579000</u>	<u>Matthew Rohr, et al.</u> Matthew Rohr, a married man dealing in his sole and separate property, remainderman, and Wayne Raber, a married man dealing in his sole and separate property, remainderman, et al. TH Exploration, LLC	120 ac	TH Exploration, LLC EQT TGHL Exploration LLC	"at least 1/8th per WV Code 22-6-8"	OG 278A/810 Misc 154/899
<u>S</u>	<u>12-2-16</u>	<u>239303000</u>	<u>Herbert L. Miller, aka Herbert Miller, and Brenda S. Miller</u> Herbert L. Miller, aka Herbert Miller and Brenda S. Miller, husband and wife Antero Resources Corporation TH Exploration, LLC	33 ac	Antero Resources Corporation TH Exploration, LLC EQT TGHL Exploration LLC	"at least 1/8th per WV Code 22-6-8"	OG 173A/673 OG 256A/812 Misc 154/899
<u>I</u>	<u>12-2-15.1</u>	<u>242329004</u>	<u>Hammett Land & Minerals, LLC, et al.</u> Hammett Land & Minerals, LLC TH Exploration, LLC	7 ac	TH Exploration, LLC EQT TGHL Exploration LLC	"at least 1/8th per WV Code 22-6-8"	OG 263A/286 Misc 154/899
<u>X</u>	<u>12-2-8</u>	<u>242409002</u>	<u>Hammett Land & Minerals, LLC, et al.</u> Hammett Land & Minerals, LLC TH Exploration, LLC	185 ac	TH Exploration, LLC EQT TGHL Exploration LLC	"at least 1/8th per WV Code 22-6-8"	OG 319A/368 Misc 154/899
<u>Y</u>	<u>12-2-7</u>	<u>238956000</u>	<u>Betty Lou Goudy</u> Betty Lou Goudy, a widow TH Exploration, LLC	44.50 ac	TH Exploration, LLC EQT TGHL Exploration LLC	"at least 1/8th per WV Code 22-6-8"	OG 220A/884 Misc 154/899
<u>Z</u>	<u>12-1-20</u>	<u>216526001</u>	<u>Shiben Estates, Inc., et al.</u> Shiben Estates, Inc.	126 ac	EQT Production Company	"at least 1/8th per WV Code 22-6-8"	OG 277A/325
<u>AA</u>	<u>12-2-1</u>	<u>173515001</u>	<u>Pathfinder Resources, LLC, et al.</u> Pathfinder Resources, LLC d/b/a Recon Pathfinder, LLC	49 ac	EQT Production Company	"at least 1/8th per WV Code 22-6-8"	OG 275A/203
<u>CC</u>	<u>12-1-40</u>	<u>242267004</u>	<u>Mark W. Booth, et al.</u> Mark W. Booth, a married man dealing in his sole and separate property TH Exploration, LLC	135.7 ac	TH Exploration, LLC EQT TGHL Exploration LLC	"at least 1/8th per WV Code 22-6-8"	OG 294A/154 Misc 154/899

GG

5-26-18

241689003

Eric Jay Booth, et al.

Eric Jay Booth, a married man dealing in his sole and separate property

TH Exploration, LLC

94 ac

TH Exploration, LLC

EQT TGH Exploration LLC

*at least 1/8th per
WV Code 22-6-8"

DB 953/258

Name Change 2/472



Force Pool Tract

Tag	Tax Parcel	Lease No.	Grantor, Lessor, etc.	Acres	Grantee, Lessee, etc.	Royalty	Book/Page
<u>C</u>	<u>12-7-40</u>	<u>242377002</u>	<u>Venable Royalty, Ltd., et al.</u> Venable Royalty, Ltd. And V2, LP TH Exploration, LLC	244.49 ac	TH Exploration, LLC EQT TGHL Exploration LLC	"at least 1/8th per WV Code 22-6-8"	OG 312A/410 Misc 154/899
<u>D</u>	<u>12-7-24</u>	<u>244506003</u>	<u>Hammett Land & Minerals, LLC, et al.</u> Hammett Land & Minerals, LLC TH Exploration, LLC	164.33 ac	TH Exploration, LLC EQT TGHL Exploration LLC	"at least 1/8th per WV Code 22-6-8"	OG 263A/280 Misc 154/899
<u>E</u>	<u>12-7-62</u>	<u>242377002</u>	<u>Venable Royalty, Ltd., et al.</u> Venable Royalty, Ltd. And V2, LP TH Exploration, LLC	244.49 ac	TH Exploration, LLC EQT TGHL Exploration LLC	"at least 1/8th per WV Code 22-6-8"	OG 312A/410 Misc 154/899
<u>F</u>	<u>12-7-26.1</u>	<u>239208000</u>	<u>Colby Dean Sidenstricker, et al.</u> Jeffrey L. Mead, a single man TH Exploration, LLC	2.010 ac	TH Exploration, LLC EQT TGHL Exploration LLC	"at least 1/8th per WV Code 22-6-8"	OG 239A/198 Misc 154/899
<u>G</u>	<u>12-7-61</u>	<u>242377002</u>	<u>Venable Royalty, Ltd., et al.</u> Venable Royalty, Ltd. And V2, LP TH Exploration, LLC	244.49 ac	TH Exploration, LLC EQT TGHL Exploration LLC	"at least 1/8th per WV Code 22-6-8"	OG 312A/410 Misc 154/899
<u>I</u>	<u>12-7-15.3</u>	<u>238803000</u>	<u>Philip H. Estep</u> Phillip H. Estep, a married man dealing in sole and separate property Phillip H. Estep TH Exploration, LLC	10.72 ac 13.06 ac	TH Exploration, LLC TH Exploration, LLC EQT TGHL Exploration LLC	"at least 1/8th per WV Code 22-6-8"	OG 204A/164 OG 209A/262 Misc 154/899
<u>J</u>	<u>12-7-4.1</u>	<u>240624000</u>	<u>R. Shane Goddard and Kathryn Goddard, et al.</u> R. Shane Goddard and Kathryn Goddard, husband and wife TH Exploration, LLC	472.7516 ac	TH Exploration, LLC EQT TGHL Exploration LLC	"at least 1/8th per WV Code 22-6-8"	OG 290A/122 Misc 154/899
<u>M</u>	<u>12-7-59</u>	<u>216529001</u>	<u>The McCall 2016 Delaware Trust dated May 4, 2016, et al.</u> The McCall 2016 Delaware Trust dated May 4, 2016, Elizabeth A. Beachell, Trustee	108.302 ac	EQT Production Company	"at least 1/8th per WV Code 22-6-8"	OG 277A/615

P	<u>12-7-3.5</u>	<u>238703000</u>	<u>Robert Joseph Coleman, et al.</u> Robert Joseph Coleman, a single man TH Exploration, LLC	5.422 ac	TH Exploration, LLC EQT TGHL Exploration LLC	"at least 1/8th per WV Code 22-6-8"	OG 202A/782 Misc 154/899
Q	<u>12-7-3.1</u>	<u>240579000</u>	<u>Matthew Rohr, et al.</u> Matthew Rohr, a married man dealing in his sole and separate property, remainderman, and Wayne Raber, a married man dealing in his sole and separate property, remainderman, et al. TH Exploration, LLC	120 ac	TH Exploration, LLC EQT TGHL Exploration LLC	"at least 1/8th per WV Code 22-6-8"	OG 278A/810 Misc 154/899
R	<u>12-7-2</u>	<u>119748008</u>	<u>R. Shane Goddard and Kathryn Goddard, et al.</u> R. Shane Goddard and Kathryn Goddard, husband and wife Stone Energy Corporation	96 ac	Stone Energy Corporation EQT Production Company	"at least 1/8th per WV Code 22-6-8"	OG 166A/432 OG 183A/305
U	<u>12-2-15.2</u>	<u>242329004</u>	<u>Hammett Land & Minerals, LLC, et al.</u> Hammett Land & Minerals, LLC TH Exploration, LLC	7 ac	TH Exploration, LLC EQT TGHL Exploration LLC	"at least 1/8th per WV Code 22-6-8"	OG 263A/286 Misc 154/899
V	<u>12-2-15</u>	<u>242328001</u>	<u>Charles Phillip Parsons, et al.</u> Charles Phillip Parsons, a single man TH Exploration, LLC	3 ac	TH Exploration, LLC EQT TGHL Exploration LLC	"at least 1/8th per WV Code 22-6-8"	OG 221A/648 Misc 154/899
W	<u>Midcap School</u>	<u>N/A</u>	<u>Board of Education of School in Proctor Township, Wetzel County, West Virginia</u> N/A	N/A	N/A		N/A
BB	<u>12-2-2</u>	<u>186409001</u>	<u>Stone Hill Minerals Holdings LLC, et al.</u> Chesapeake Appalachia, LLC SWN Production Company, LLC SWN Production Company, LLC Statoil USA Onshore Properties, Inc. Antero Exchange Properties LLC Antero Resources Corporation	82 ac of 5,994.63 ac	SWN Production Company, LLC Statoil USA Onshore Properties, Inc. Antero Exchange Properties, LLC Antero Exchange Properties, LLC Antero Resources Corporation EQT Production Company	"at least 1/8th per WV Code 22-6-8"	OG 157A/646 OG 158A/732 OG 177A/533 OG 177A/738 Corp. Book 13/311 OG 231A/59
DD	<u>5-26-16</u>	<u>241687002</u>	<u>Venable Royalty, Ltd., et al.</u> Venable Royalty, Ltd. and V14, LP TH Exploration, LLC	203.2325 ac	TH Exploration, LLC EQT TGHL Exploration LLC	"at least 1/8th per WV Code 22-6-8"	DB 1151/438 Name Change 2/472

EE **12-1-41** **242267004** **Mark W. Booth, et al.**
Mark W. Booth, a married man dealing in his sole and separate
property
TH Exploration, LLC 135.7 ac TH Exploration, LLC
EQT TGHL Exploration LLC "at least 1/8th per WV
Code 22-6-8" OG 294A/154
Misc 154/899

FF **12-2-24** **242267004** **Mark W. Booth, et al.**
Mark W. Booth, a married man dealing in his sole and separate
property
TH Exploration, LLC 135.7 ac TH Exploration, LLC
EQT TGHL Exploration LLC "at least 1/8th per WV
Code 22-6-8" OG 294A/154
Misc 154/899

Force Pool Tract

ASSIGNMENT AGREEMENT

This Assignment Agreement (this "Assignment") is made and entered into on August 22, 2023 (the "Closing Date"), by and between THQ Appalachia I, LLC, a Delaware limited liability company ("Upstream Assignor"), and THQ-XcL Holdings I, LLC, a Delaware limited liability company ("Midstream Assignor," and together with Upstream Assignor, "Assignors"), on the one hand, and EQT Production Company, a Pennsylvania corporation ("EPC"), EQT Acquisition HoldCo LLC, a Delaware limited liability company ("Upstream Assignee") and EQT Midstream HoldCo LLC, a Delaware limited liability company ("Midstream Assignee", and together with Upstream Assignee, "Assignees"), on the other hand. EPC, the Assignors and Assignees are each referred to in this Assignment individually as a "Party" and together as the "Parties." Capitalized terms used but not otherwise defined herein shall have the meanings set forth in that certain Amended and Restated Purchase Agreement, dated as of December 23, 2022 (as the same may be amended and/or amended and restated from time to time, the "Purchase Agreement"), by and among Assignors, the Companies, EQT Corporation, EPC and the other parties party thereto.

RECEIVED
Office of Oil and Gas

MAY 31 2024

RECITALS

WHEREAS, Upstream Assignor owns 100% of the issued and outstanding membership interests (such 100% of the issued and outstanding membership interests, the "Upstream Company Interests") of THQ Appalachia I Midco, LLC, a Delaware limited liability company (the "Upstream Company");

WV Department of Environmental Protection

WHEREAS, Midstream Assignor owns 100% of the issued and outstanding membership interests (such 100% of the issued and outstanding membership interests, the "Midstream Company Interests," and together with the Upstream Company Interests, the "Company Interests") of THQ-XcL Holdings I Midco, LLC, a Delaware limited liability company (the "Midstream Company," and together with Upstream Company, the "Companies");

WHEREAS, on December 23, 2022, Assignors, the Companies, EQT Corporation, EPC and the other parties party thereto, entered into the Purchase Agreement;

WHEREAS, pursuant to the Purchase Agreement, Assignors have agreed to sell, convey, transfer, assign and deliver to EPC, and EPC has agreed to purchase from Assignors and pay for, the Company Interests, in each case, subject to the terms and conditions of the Purchase Agreement;

WHEREAS, Upstream Assignee and Midstream Assignee are each wholly-owned subsidiaries of EPC;

WHEREAS, EPC desires to assign its right to acquire (i) the Upstream Company Interests to Upstream Assignee, and (ii) the Midstream Company Interests to Midstream Assignee; and

WHEREAS, the Assignees have agreed to accept the assignment of the respective Company Interests as further provided herein.

NOW, THEREFORE, in accordance with the Purchase Agreement, in consideration of the mutual covenants and agreements in this Assignment and for other good and valuable consideration, the receipt and sufficiency of which are hereby acknowledged, the Parties hereby agree as follows:

RECEIVED
Office of Oil and Gas

AGREEMENTS

MAY 31 2024

Section 1. ***Assignment.***

(a) Effective as of the Closing, and subject to the terms and conditions of this Assignment and the Purchase Agreement, Upstream Assignor hereby sells, conveys, transfers, assigns and delivers to Upstream Assignee the Upstream Company Interests, and Upstream Assignee hereby purchases and accepts the Upstream Company Interests. Upstream Assignor hereby withdraws as the sole member of the Upstream Company (and shall cease to have or exercise any right, title or interest in or to the Upstream Company Interests) and Upstream Assignee is hereby admitted as the sole member of the Upstream Company pursuant to the terms of its limited liability company agreement.

WV Department of
Environmental Protection

(b) Effective as of the Closing, and subject to the terms and conditions of this Assignment and the Purchase Agreement, Midstream Assignor hereby sells, conveys, transfers, assigns and delivers to Midstream Assignee the Midstream Company Interests, and Midstream Assignee hereby purchases and accepts the Midstream Company Interests. Midstream Assignor hereby withdraws as the sole member of the Midstream Company (and shall cease to have or exercise any right, title or interest in or to the Midstream Company Interests) and Midstream Assignee is hereby admitted as the sole member of the Midstream Company pursuant to the terms of its limited liability company agreement.

Section 2. ***Purchase Agreement.*** This Assignment is subject, in all respects, to the terms and conditions of the Purchase Agreement, and nothing contained in this Assignment is meant to enlarge, diminish or otherwise alter the terms and conditions of the Purchase Agreement or the Parties', the Companies' and the other parties' respective rights, duties, liabilities and obligations contained therein, which shall survive the execution and delivery of this Assignment pursuant to its terms. To the extent there is a conflict between this Assignment and the Purchase Agreement, the terms of the Purchase Agreement shall control.

Section 3. ***Further Cooperation.*** Subject to the terms and conditions of this Assignment and the Purchase Agreement, at any time or from time to time after the Closing Date, at any Party's reasonable request, each other Party shall take such other reasonable actions as such requesting Party may reasonably request, at such requesting Party's expense, in order to effectuate the transactions contemplated by this Assignment.

Section 4. ***Amendment.*** This Assignment may be amended, restated, supplemented or otherwise modified only by an instrument in writing executed by all Parties and expressly identified as an amendment, restatement, supplement or modification.

Section 5. ***Assignment.*** This Assignment may not be assigned by any Party without the prior written consent of the other Parties. Any assignment made without the consents required hereby shall be void. Subject to the foregoing provisions of this *Section 5*, the terms and

provisions of this Assignment shall be binding upon and inure to the benefit of the Parties and their respective successors and permitted assigns.

Section 6. **No Third Party Beneficiary.** The terms and conditions of this Assignment are intended solely for the benefit of the Parties and their respective successors and permitted assigns, and it is not the Parties' intention to confer third party beneficiary rights upon any other Person.

Section 7. **Severability.** If any term or other provision of this Assignment is invalid, illegal or incapable of being enforced by any Law or public policy, all other conditions and provisions of this Assignment shall nevertheless remain in full force and effect so long as the economic or legal substance of the transactions contemplated hereby is not affected in any adverse manner to any Party. Upon such determination that any term or other provision is invalid, illegal or incapable of being enforced, the Parties shall negotiate in good faith to modify this Assignment so as to effect the original intent of the Parties as closely as possible in an acceptable manner to the end that the transactions contemplated hereby are fulfilled to the extent possible.

Section 8. **Counterparts.** This Assignment may be executed in one or more counterparts, each of which, when executed, shall be deemed to be an original and all of which together shall constitute one and the same document. Each Party's delivery of any executed counterpart signature page by facsimile (or electronic .pdf format transmission) is as effective as executing and delivering this Assignment in the presence of the other Parties, and such signature shall be deemed binding for all purposes hereof, without delivery of an original signature being thereafter required.

Section 9. **Governing Law.** This Assignment and any claim, controversy or dispute arising under or related to this Assignment or the transactions contemplated hereby or the rights, duties and relationship of the Parties hereto, shall be governed by and construed and interpreted in accordance with the Laws of the State of Delaware, without giving effect to any conflicts of law principles (whether of the State of Delaware or any other jurisdiction) that would cause the application of the Laws of any jurisdiction other than the State of Delaware.

Section 10. **Deed; Bill of Sale; Assignment.** To the extent required and permitted by applicable Law, this Assignment shall also constitute a "deed," a "bill of sale" or an "assignment" of the Company Interests.

[Signature pages follow.]

RECEIVED
Office of Oil and Gas
MAY 31 2024
WV Department of
Environmental Protection

IN WITNESS WHEREOF, this Assignment has been duly executed by the Parties as of the Closing Date.

UPSTREAM ASSIGNOR:

THQ Appalachia I, LLC

By: 
Name: Michael G. Radler
Title: Chief Executive Officer

MIDSTREAM ASSIGNOR:

THQ-XcL Holdings I, LLC

By: 
Name: Michael G. Radler
Title: Chief Executive Officer

RECEIVED
Office of Oil and Gas

MAY 31 2024

WV Department of
Environmental Protection

EPC:

EQT Production Company

DocuSigned by:
By: Toby Rice
Name: Toby Z. Rice
Title: President

UPSTREAM ASSIGNEE:

EQT Acquisition HoldCo LLC

DocuSigned by:
By: Toby Rice
Name: Toby Z. Rice
Title: President

MIDSTREAM ASSIGNEE:

EQT Midstream HoldCo LLC

DocuSigned by:
By: Toby Rice
Name: Toby Z. Rice
Title: President

RECEIVED
Office of Oil and Gas

MAY 31 2024

WV Department of
Environmental Protection



May 16, 2024

Mr. Taylor Brewer
West Virginia Department of Environmental Protection
Office of Oil and Gas
601 57th Street SE
Charleston, WV 25304

Re: Jefferson N-7HU Gas Well
Permit Number 47-103-03509
Proctor District, Wetzel County, WV

Dear Mr. Brewer,

EQT Production Company is applying for a well work permit modification for the well referenced above. Upon information and belief, the Operator's lease and/ or other real property rights permit it to conduct drilling operations for the subject well in the location shown on the plat, including under any public roads that the well lateral crosses.

Sincerely,

A handwritten signature in blue ink, appearing to read 'J. Zavatchan'.

John Zavatchan
Project Specialist - Permitting

RECEIVED
Office of Oil and Gas

MAY 31 2024

WV Department of
Environmental Protection

07/19/2024

JEFFERSONS N-7HU
EQT PRODUCTION COMPANY

GRID NORTH

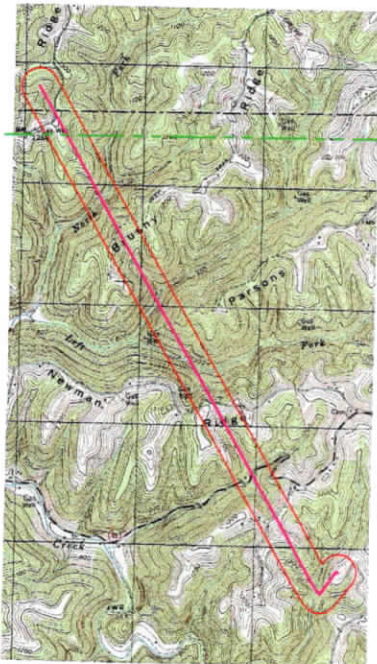
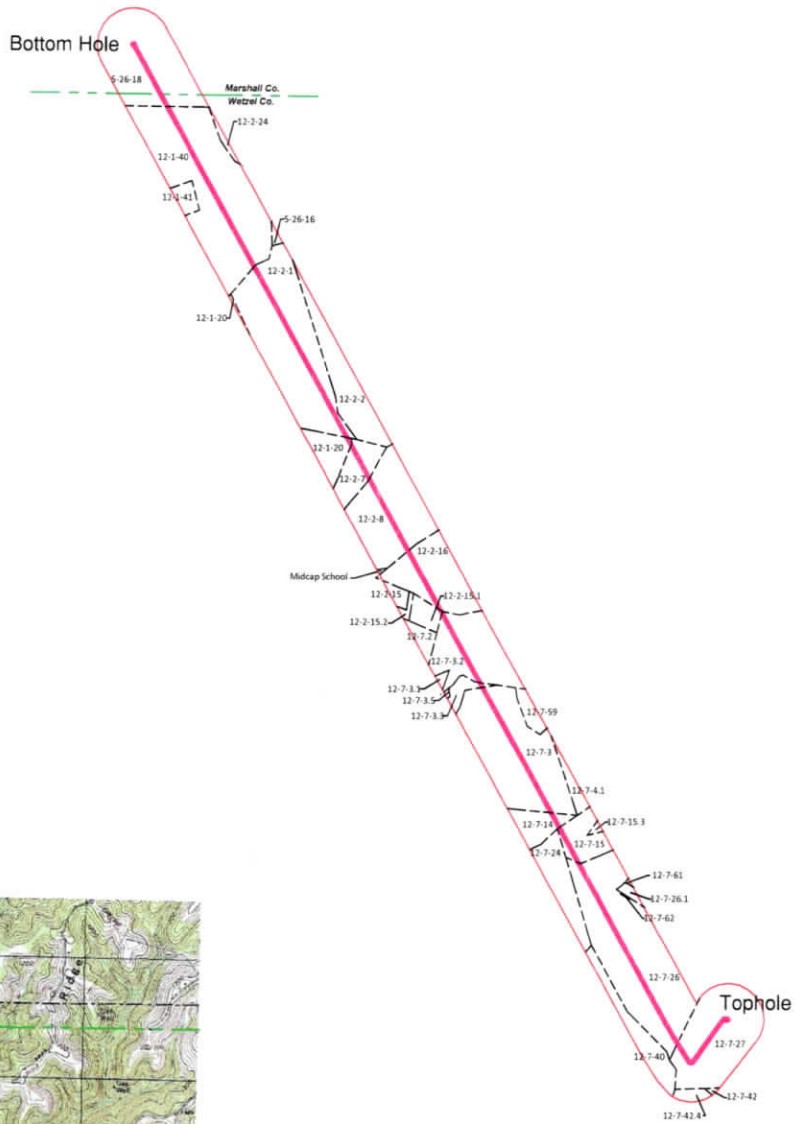

RECEIVED
Office of Oil and Gas
MAY 31 2024
WV Department of
Environmental Protection

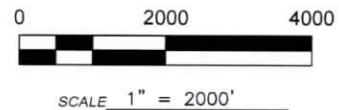

3/27/2024

- Utica Well
- 500' Buffer

JEFFERSON N-7HU
Operators within 500 Feet of Well Borehole

07/19/2024



May 15, 2024

Ms. Susan Rose
West Virginia Department of Environmental Protection
Office of Oil and Gas
601 57th Street SE
Charleston, WV 25304

Re: Jeffersons N-7HU

Subject: Proposed Voluntary Pooling and Unitization

Dear Ms. Rose,

EQT Production Company is authorized through either leases or other agreements, to unitize and pool all lands falling within the boundaries of the proposed voluntary unit included with this submission, except for the following tracts which we intend to force pool:

- 12-7-26
- 12-7-40
- 12-7-62
- 12-7-26.1
- 12-7-61
- 12-7-4.1
- 12-7-14
- 12-7-59
- 12-7-2
- Midcap School
- 12-2-8
- 12-2-2
- 12-2-24

If you have any questions, please do not hesitate to contact me at 724-746-9073.

Sincerely,

John Zavatchan
Permitting Specialist

Enc.

RECEIVED
Office of Oil and Gas

MAY 31 2024

WV Department of
Environmental Protection

07/19/2024

JEFFERSONS N-7HU
EQT PRODUCTION COMPANY

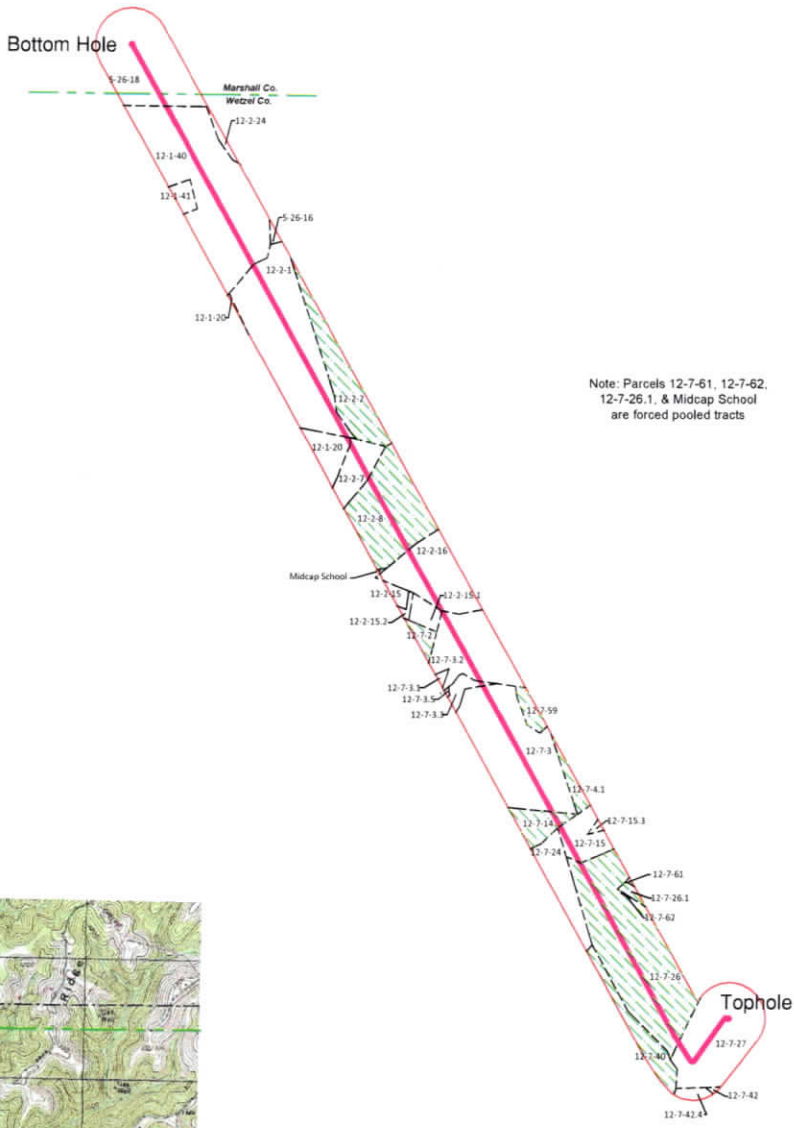

GRID NORTH

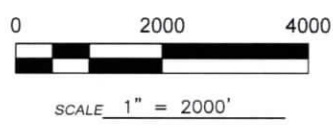
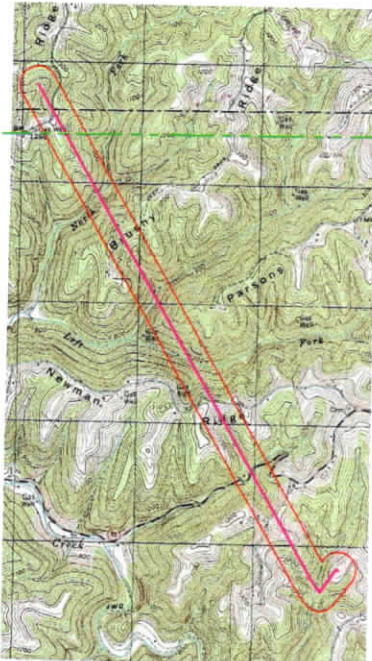

RECEIVED
Office of Oil and Gas
MAY 31 2024
WV Department of
Environmental Protection



5/03/2024

- Utica Well
- Force Pool
- 500' Buffer

JEFFERSON N-7HU
Operators within 500 Feet of Well Borehole

07/19/2024

**Operators within 500' of Well Boreholes
Jeffersons N - 7HU**

COUNTY	DISTRICT	TMP	MINERAL OWNER OR LESSEE	ADDRESS
Wetzel	Proctor	12-1-20	EQT TGH L EXPLORATION LLC	625 Liberty Avenue Suite 1700 Pittsburgh, PA 15222
Wetzel	Proctor	12-1-20	EQT PRODUCTION COMPANY	625 Liberty Avenue Suite 1700 Pittsburgh, PA 15222
Wetzel	Proctor	12-1-40	EQT TGH L EXPLORATION LLC	625 Liberty Avenue Suite 1700 Pittsburgh, PA 15222
Wetzel	Proctor	12-1-41	EQT TGH L EXPLORATION LLC	625 Liberty Avenue Suite 1700 Pittsburgh, PA 15222
Wetzel	Proctor	12-2-1	EQT PRODUCTION COMPANY	625 Liberty Avenue Suite 1700 Pittsburgh, PA 15222
Wetzel	Proctor	12-2-1	EQT TGH L EXPLORATION LLC	625 Liberty Avenue Suite 1700 Pittsburgh, PA 15222
Wetzel	Proctor	12-2-15	EQT TGH L EXPLORATION LLC	625 Liberty Avenue Suite 1700 Pittsburgh, PA 15222
Wetzel	Proctor	12-2-15.1	EQT TGH L EXPLORATION LLC	625 Liberty Avenue Suite 1700 Pittsburgh, PA 15222
Wetzel	Proctor	12-2-15.2	EQT TGH L EXPLORATION LLC	625 Liberty Avenue Suite 1700 Pittsburgh, PA 15222
Wetzel	Proctor	12-2-16	EQT TGH L EXPLORATION LLC	625 Liberty Avenue Suite 1700 Pittsburgh, PA 15222
Wetzel	Proctor	12-2-2	EQT PRODUCTION COMPANY	625 Liberty Avenue Suite 1700 Pittsburgh, PA 15222
Wetzel	Proctor	12-2-2	EQT TGH L EXPLORATION LLC	625 Liberty Avenue Suite 1700 Pittsburgh, PA 15222
Wetzel	Proctor	12-2-2	CHARLES D MILLIKEN	76 Neon Dr. Dallas, WV 26036
Wetzel	Proctor	12-2-2	ROBERT W MILLIKEN	249 Hytyre Farms Dr Gibsonia, PA 15044
Wetzel	Proctor	12-2-2	SUE M SCHAAD	455 Crestview Drive Lebanon, OH 45036
Wetzel	Proctor	12-2-2	THE KATHY F ICEMAN TRUST DTD 6/19/2012, THOMAS L ICEMAN, TRUSTEE	565 Baldwin Heights Circle Howard, OH 43028
Wetzel	Proctor	12-2-2	VIRGINIA ANN HAHN	6536 Greenwich Rd Westfield Center, OH 44251
Wetzel	Proctor	12-2-2	TRANSCENDENT RESOURCES, LLC	7 NE 6th street Suite 210 Oklahoma City, Oklahoma 73104 United States
Wetzel	Proctor	12-2-24	EQT TGH L EXPLORATION LLC	625 Liberty Avenue Suite 1700 Pittsburgh, PA 15222
Wetzel	Proctor	12-2-7	EQT TGH L EXPLORATION LLC	625 Liberty Avenue Suite 1700 Pittsburgh, PA 15222
				625 Liberty Avenue

RECEIVED
Office of Oil and Gas

MAY 31 2024

WV Department of
Environmental Protection

07/19/2024

**Operators within 500' of Well Boreholes
Jeffersons N - 7HU**

Wetzel	Proctor	12-2-8	PAM ISOM	71 Venable Rd Annville, KY 40447
Wetzel	Proctor	12-2-8	PATTY MASON NEALEANS	Unknown & Unlocatable
Wetzel	Proctor	12-2-8	REBECCA J. ANTIBUS AKA REBECCA J. HARRELL	533 N. Kalamazoo Ave. Marshall, MI 49068
Wetzel	Proctor	12-2-8	SHANNON HEMINGWAY	Unknown & Unlocatable
Wetzel	Proctor	12-7-14	EQT PRODUCTION COMPANY	625 Liberty Avenue Suite 1700 Pittsburgh, PA 15222
Wetzel	Proctor	12-7-14	EQT TGHL EXPLORATION LLC	625 Liberty Avenue Suite 1700 Pittsburgh, PA 15222
Wetzel	Proctor	12-7-14	CHERYL ANN COCHRAN	231 Gamble Lane Moundsville, WV 26041
Wetzel	Proctor	12-7-15	EQT TGHL EXPLORATION LLC	625 Liberty Avenue Suite 1700 Pittsburgh, PA 15222
Wetzel	Proctor	12-7-15.3	EQT TGHL EXPLORATION LLC	625 Liberty Avenue Suite 1700 Pittsburgh, PA 15222
Wetzel	Proctor	12-7-2	EQT PRODUCTION COMPANY	625 Liberty Avenue Suite 1700 Pittsburgh, PA 15222
Wetzel	Proctor	12-7-2	EQT TGHL EXPLORATION LLC	625 Liberty Avenue Suite 1700 Pittsburgh, PA 15222
Wetzel	Proctor	12-7-2	ANTERO RESOURCES CORPORATION	1615 Wynkoop St Denver, Colorado 80202
Wetzel	Proctor	12-7-2	ELK RANGE CO-INVEST, LLC	2850 N. Harwood St., 19th Floor Dallas, Texas 75201
Wetzel	Proctor	12-7-2	ELK RANGE ROYALTIES II LP	2110 Farrington St Dallas, TX 75207
Wetzel	Proctor	12-7-2	JOHN RICHARD NUZUM	2728 Cypress St. Columbia, SC 29205
Wetzel	Proctor	12-7-24	EQT TGHL EXPLORATION LLC	625 Liberty Avenue Suite 1700 Pittsburgh, PA 15222
Wetzel	Proctor	12-7-26	EQT TGHL EXPLORATION LLC	625 Liberty Avenue Suite 1700 Pittsburgh, PA 15222
Wetzel	Proctor	12-7-26	EQT PRODUCTION COMPANY	625 Liberty Avenue Suite 1700 Pittsburgh, PA 15222
Wetzel	Proctor	12-7-26	JOHN RICHARD NUZUM	2728 Cypress Street Columbia, SC 29205
Wetzel	Proctor	12-7-26.1	EQT TGHL EXPLORATION LLC	625 Liberty Avenue Suite 1700 Pittsburgh, PA 15222
Wetzel	Proctor	12-7-26.1	EQT PRODUCTION COMPANY	625 Liberty Avenue Suite 1700 Pittsburgh, PA 15222
Wetzel	Proctor	12-7-26.1	JOHN RICHARD NUZUM	2728 Cypress Street Columbia, SC 29205
Wetzel	Proctor	12-7-27	EQT TGHL EXPLORATION LLC	625 Liberty Avenue Suite 1700 Pittsburgh, PA 15222
Wetzel	Proctor	12-7-27	EQT PRODUCTION COMPANY	625 Liberty Avenue Suite 1700 Pittsburgh, PA 15222

RECEIVED
Office of Oil and Gas
MAY 31 2024

WV Department of
Environmental Protection

07/19/2024

**Operators within 500' of Well Boreholes
Jeffersons N - 7HU**

Wetzel	Proctor	12-7-3.2	EQT TGHL EXPLORATION LLC	625 Liberty Avenue Suite 1700 Pittsburgh, PA 15222
Wetzel	Proctor	12-7-3.3	EQT PRODUCTION COMPANY	625 Liberty Avenue Suite 1700 Pittsburgh, PA 15222
Wetzel	Proctor	12-7-3.3	EQT TGHL EXPLORATION LLC	625 Liberty Avenue Suite 1700 Pittsburgh, PA 15222
Wetzel	Proctor	12-7-3.5	EQT TGHL EXPLORATION LLC	625 Liberty Avenue Suite 1700 Pittsburgh, PA 15222
Wetzel	Proctor	12-7-3.5	EQT PRODUCTION COMPANY	625 Liberty Avenue Suite 1700 Pittsburgh, PA 15222
Wetzel	Proctor	12-7-4.1	EQT TGHL EXPLORATION LLC	625 Liberty Avenue Suite 1700 Pittsburgh, PA 15222
Wetzel	Proctor	12-7-4.1	EQT PRODUCTION COMPANY	625 Liberty Avenue Suite 1700 Pittsburgh, PA 15222
Wetzel	Proctor	12-7-4.1	NANCY K RUFENER	46520 Lengacher Rd Sardis, OH 43946
Wetzel	Proctor	12-7-4.1	ROBERT JOSEPH COLEMAN	2406 Newman Ridge Rd Proctor, WV 26055
Wetzel	Proctor	12-7-4.1	SANDRA A. DIETRICH AND PAUL E. DIETRICH	51446 Sykes Ridge RD., Clarington, OH 43915
Wetzel	Proctor	12-7-40	EQT TGHL EXPLORATION LLC	625 Liberty Avenue Suite 1700 Pittsburgh, PA 15222
Wetzel	Proctor	12-7-40	EQT PRODUCTION COMPANY	625 Liberty Avenue Suite 1700 Pittsburgh, PA 15222
Wetzel	Proctor	12-7-40	JOHN RICHARD NUZUM	2728 Cypress Street Columbia, SC 29205
Wetzel	Proctor	12-7-59	EQT PRODUCTION COMPANY	625 Liberty Avenue Suite 1700 Pittsburgh, PA 15222
Wetzel	Proctor	12-7-59	TANNER KELLY	2518 Newman Ridge Road Proctor, WA
Wetzel	Proctor	12-7-61	EQT TGHL EXPLORATION LLC	625 Liberty Avenue Suite 1700 Pittsburgh, PA 15222
Wetzel	Proctor	12-7-61	EQT PRODUCTION COMPANY	625 Liberty Avenue Suite 1700 Pittsburgh, PA 15222
Wetzel	Proctor	12-7-61	JOHN RICHARD NUZUM	2728 Cypress Street Columbia, SC 29205
Wetzel	Proctor	12-7-62	EQT TGHL EXPLORATION LLC	625 Liberty Avenue Suite 1700 Pittsburgh, PA 15222
Wetzel	Proctor	12-7-62	EQT PRODUCTION COMPANY	625 Liberty Avenue Suite 1700 Pittsburgh, PA 15222
Wetzel	Proctor	12-7-62	JOHN RICHARD NUZUM	2728 Cypress Street Columbia, SC 29205
Wetzel	Proctor	12-7-42	EQT TGHL EXPLORATION LLC	625 Liberty Avenue Suite 1700 Pittsburgh, PA 15222

RECEIVED
Office of Oil and Gas

MAY 31 2024

Department of
Environmental Protection

6/7/19/2024

**Operators within 500' of Well Boreholes
Jeffersons N - 7HU**

Marshall	Franklin	5-26-18	EQT TGH L EXPLORATION LLC	625 Liberty Avenue Suite 1700 Pittsburgh, PA 15222
Wetzel	Proctor	Midcap School	UNKNOWN & UNLOCATABLE	Unknown & Unlocatable

"For those parties identified as Missing or Address Unknown, the following actions were performed in pursuit of locating these individuals : A reasonable review of the records of the clerk of the county commission, the sheriff, the assessor, and the clerk of the circuit court in the county in which the interest is located, and includes unknown heirs, successors and assigns known to be alive; A reasonable inquiry in the vicinity of the owner's last known place of residence; A diligent inquiry into known interest owners in the same tract; and A reasonable review of available Internet resources commonly utilized by the industry."

RECEIVED
Office of Oil and Gas

MAY 31 2024

WV Department of
Environmental Protection

07/19/2024