

Antero Resources
Well No. Reader 1H
BHL MOD
 Antero Resources Corporation

Page 1 of 2



Proposed Well No. Reader Unit 1H

769' to Bottom Hole
 TOP HOLE LATITUDE 39 - 35 - 00
 BTM HOLE LATITUDE 39 - 32 - 30

Notes
 West Virginia Coordinate System of 1927, North Zone based upon Differential GPS Measurements. Well No. Reader Unit 1H Top Hole coordinates are N: 387,420.28' Latitude: 39°33'25.78" E: 1,652,803.30' Longitude: 80°43'53.14" Bottom Hole coordinates are N: 373,155.00' Latitude: 39°31'05.54" E: 1,658,354.40' Longitude: 80°42'39.82" UTM Zone 17, NAD 1983
 Top Hole Coordinates N: 4,378,651.775m E: 523,087.954m Bottom Hole Coordinates N: 4,374,334.009m E: 524,851.535m
 Plat orientation and corner and well references are based upon the grid north meridian. Well location references are based upon the magnetic meridian.

Well Location References (NTS)

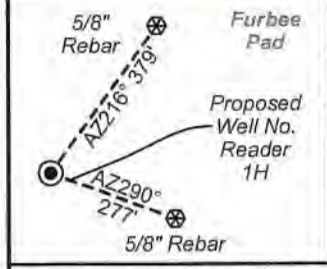

I, the undersigned, hereby certify that this plat is correct to the best of my knowledge and belief and shows all the information required by law and the rules issued and prescribed by the Department of Environmental Protection.

Bradley D. Miller
 Bradley D. Miller, P.S. 2167

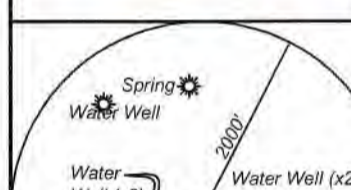

Note: 6 water wells and 3 springs were found within 2000' of proposed well. No occupied dwellings or buildings 2,500 square feet or larger used to house or shelter dairy cattle or poultry husbandry are located within 625' of the center of the well pad.

	Bearing	Dist.
L1	S 74°46' W	1,920.7'
L2	N 83°24' W	2,085.6'
L3	N 75°31' E	1,559.2'
L4	N 80°45' E	1,563.2'
L5	N 80°24' E	899.8'

- Legend**
- Proposed gas well
 - ⊗ Monument, as noted
 - ⊙ Existing Well, as noted
 - ⊛ Digitized Well, as noted
 - Creek or Drain
 - Road
 - Railroad Right-of-Way
 - Surface boundary (approx.)
 - Interior surface tracts (approx.)

FILE NO: 129-34-G-18
 DRAWING NO: Reader Unit 1H Well Plat
 SCALE: 1" = 2000'
 MINIMUM DEGREE OF ACCURACY: Submeter
 PROVEN SOURCE OF ELEVATION: WVDOT, Harrisville, WV

STATE OF WEST VIRGINIA
 DEPARTMENT OF ENVIRONMENTAL PROTECTION
OIL AND GAS DIVISION

DATE: August 4 20 22
 OPERATOR'S WELL NO. Reader Unit 1H
 API WELL NO. 47 - 103 - 03496
 STATE COUNTY PERMIT

WELL TYPE: OIL GAS LIQUID INJECTION WASTE DISPOSAL
 (IF GAS) PRODUCTION: STORAGE DEEP SHALLOW
 LOCATION: ELEVATION: Existing 1240' Proposed 1212' WATERSHED: Fishing Creek QUADRANGLE: Pine Grove
 DISTRICT: Green James COUNTY: Wetzel
 SURFACE OWNER: A. Sell Joshua R. Edgell, et al; Tribune Resources Minerals, LLC; AMP Fund II, LP (2); Shiben Estates, Inc. (4); BRC Appalachian Minerals I, LLC (2); ACREAGE: 58.1
 ROYALTY OWNER: James Allen Sell; Marilyn Halley Seeley; Josephine Brast, et al; George David Sell; LEASE NO: ACREAGE: 65.4875; 140.3333
 PROPOSED WORK: DRILL CONVERT DRILL DEEPER FRACTURE OR STIMULATE PLUG OFF OLD FORMATION
 PERFORATE NEW FORMATION OTHER PHYSICAL CHANGE IN WELL (SPECIFY) BHL_MOD
 PLUG AND ABANDON CLEAN OUT AND REPLUG TARGET FORMATION: Marcellus Shale ESTIMATED DEPTH: 7,600' TVD
 24,700' MD

WELL OPERATOR: Antero Resources Corporation DESIGNATED AGENT: Dianna Stamper - CT Corporation System
 ADDRESS: 1615 Wynkoop Street ADDRESS: 5400 D Big Tyler Road
 Denver, CO 80202 Charleston, WV 25313

08/26/2022



ID	TM-Par	Owner	Bk/Pg	Acres
1	17-12	James Allen Sell	370/148	58.10
2	17-1	James Allen Sell	370/148	15.35
3	13-70	Doris Ruth Haught, et al	W49/615	33.78
4	13-71	Charles R. & Kay L. Blair	387/577	63.11
5	17-60	Ross Bucher	411/765	79.00
6	17-54	James Allen Sell	370/148	25.50
7	17-17	James Allen Sell	370/148	70.00
8	17-26	Heartland Forest Land Fund VII, LP	431/936	75.50
9	17-37	Heartland Forest Land Fund VII, LP	431/936	5.00
10	17-48	Heartland Forest Land Fund VII, LP	431/936	20.00
11	17-38	Heartland Forest Land Fund VII, LP	431/936	60.00
12	17-47	George David Sell	351/473	40.00
13	17-35	Alfred Raymond Furbee, Sr. & Olive Gay Brown	333/638	60.00
14	20-5	Debbie Brown, et al	A96/679	45.00
15	20-14	Robert Bassett	371/32	126.74
16	20-7	Debra L. & Mary Jane Brown	437/718	0.80
17	20-6	Debbie Brown, et al	A96/679	6.00
18	20-14.3	Albert E. & Betty Jean Clutter	379/182	14.35
19	20-14.4	Matthew D. Bassett, et al	421/365	97.18
20	20-14.10	Bobbi Jean Bassett	432/506	11.54
21	20-14.2	Coastal Forest Resources Co.	444/105	37.40
22	20-14.7	Randy D. & Dori R. Ice	404/39	1.74
23	20-14.6	Randy D. & Dori R. Ice	404/39	2.06
24	20-14.8	Randy D. & Dori R. Ice	404/43	2.46
25	20-14.9	Randy D. & Dori R. Ice	404/39	53.33
26	20-20.1	Robert Bassett	371/32	0.44
27	20-14.5	Marsha C. Hamrick, et al	363/279	44.46
28	20-19	Coastal Forest Resources Co.	444/105	16.44
29	20-19.2	Coastal Forest Resources Co.	444/105	35.56
30	20-28	Coastal Forest Resources Co.	444/105	36.00
31	20-37	Coastal Forest Resources Co.	444/105	246.84

Leases	
A	James Allen Sell
B	Antero Minerals, LLC
C	Marilyn Halley Seeley
D	William R. Stalnaker
E	Shiben Estates, Inc.
F	Shiben Estates, Inc.
G	BRC Appalachian Minerals I, LLC
H	AMP Fund II, LP
I	AMP Fund II, LP
J	George David Sell
K	Shiben Estates, Inc.
L	BRC Appalachian Minerals I, LLC
M	Tribune Resources Minerals, LLC
N	Joshua R. Edgell, et al
O	Morris Mountaineer Oil & Gas LLC
P	Josephine Brast, et al
Q	Shiben Estates, Inc.

FILE NO: 129-34-G-18
 DRAWING NO: Reader Unit 1H Well Plat
 SCALE: 1" = 2000'
 MINIMUM DEGREE OF ACCURACY:
 Submeter
 PROVEN SOURCE OF ELEVATION:
 WVDOT, Harrisville, WV



DATE: August 4 20 22
 OPERATOR'S WELL NO. Reader Unit 1H
 API WELL NO. **MOD**
 47 — 103 — 03496
 STATE COUNTY PERMIT

WELL TYPE: OIL GAS LIQUID INJECTION WASTE DISPOSAL
 (IF GAS) PRODUCTION: STORAGE DEEP SHALLOW
 Proposed 1212'
 LOCATION: ELEVATION: Existing 1240' WATERSHED: Fishing Creek QUADRANGLE: Pine Grove
 DISTRICT: Green James COUNTY: Wetzel
 SURFACE OWNER: A. Sell Joshua R. Edgell, et al; Tribune Resources Minerals, LLC; AMP Fund II, LP (2); Shiben Estates, Inc. (4); BRC Appalachian Minerals I, LLC (2); ACREAGE: 58.1 264.75; 70; 75.5; 89; 50; 257; 72;
 ROYALTY OWNER: James Allen Sell; Marilyn Halley Seeley; Josephine Brast, et al; George David Sell; LEASE NO: _____ ACREAGE: 65.4875; 140.3333
 PROPOSED WORK: DRILL CONVERT DRILL DEEPER FRACTURE OR STIMULATE PLUG OFF OLD FORMATION
 PERFORATE NEW FORMATION OTHER PHYSICAL CHANGE IN WELL (SPECIFY) BHL_MOD 7,600' TVD
 PLUG AND ABANDON CLEAN OUT AND REPLUG TARGET FORMATION: Marcellus Shale ESTIMATED DEPTH: 24,700' MD

08/26/2022

WELL OPERATOR: Antero Resources Corporation DESIGNATED AGENT: Dianna Stamper - CT Corporation System
 ADDRESS: 1615 Wynkoop Street ADDRESS: 5400 D Big Tyler Road
 Denver, CO 80202 Charleston, WV 25313