

Antero Resources
Well No. Baldy 1H
As-Drilled
 Antero Resources Corporation



Top Hole Coordinates, As-drilled data, and information was provided by Antero Resources Corporation. Allegheny Surveys Inc. (ASI) is not certifying the data and information provided. ASI is not responsible for any errors or inaccuracies with the data and information that has been provided.

I, the undersigned, hereby certify that this plat is correct to the best of my knowledge and belief and shows all the information required by law and the rules issued and prescribed by the Department of Environmental Protection.

Bradley D. Miller
 Bradley D. Miller, P.S. 2167

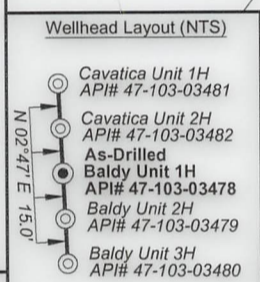
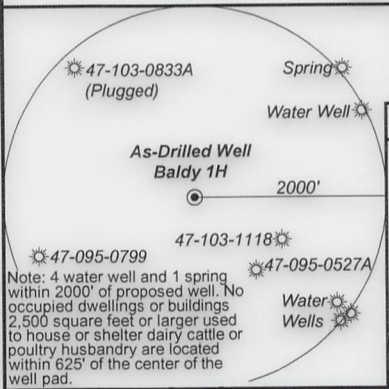
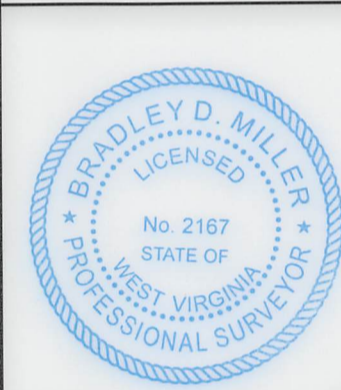

Legend

- Proposed gas well
- Monument, as noted
- Existing Well, as noted
- Digitized Well, as noted
- Creek or Drain
- Road
- County Line
- Surface boundary (approx.)
- Interior surface tracts (approx.)

Notes
 West Virginia Coordinate System of 1927, North Zone based upon Differential GPS Measurements.
 Well No. Baldy Unit 1H Top Hole coordinates are
 N: 376,193.98' Latitude: 39°31'33.63"
 E: 1,644,023.16' Longitude: 80°45'43.22"
 Bottom Hole coordinates are
 N: 394,242.56' Latitude: 39°34'31.18"
 E: 1,638,177.42' Longitude: 80°47'01.11"
 UTM Zone 17, NAD 1983
 Top Hole Coordinates Bottom Hole Coordinates
 N: 4,375,186.870m N: 4,380,655.734m
 E: 520,469.954m E: 518,597.433m
 Plat orientation and corner and well references are based upon the grid north meridian.
 Well location references are based upon the magnetic meridian.

Baldy Unit 1H As-Drilled POE Coordinates
 West Virginia Coordinate System of 1927, North Zone
 N: 376,525.76'
 E: 1,643,885.67'
 Latitude: 39°31'36.89"
 Longitude: 80°45'45.04"
 UTM Zone 17, NAD 1983
 N: 4,375,287.249m
 E: 520,426.384m

Bearing	Dist.
L1 S 40°31' E	1,973.1'
L2 S 22°42' W	1,667.5'
L3 S 51°25' W	2,093.7'
L4 S 67°37' W	1,952.2'

FILE NO: 109-34-G-18
 DRAWING NO: Baldy 1H As-Drilled
 SCALE: 1" = 2000'
 MINIMUM DEGREE OF ACCURACY: Submeter
 PROVEN SOURCE OF ELEVATION: CORS, Monroe County, OH

STATE OF WEST VIRGINIA
 DEPARTMENT OF ENVIRONMENTAL PROTECTION
OIL AND GAS DIVISION

DATE: February 22 2023
 OPERATOR'S WELL NO. Baldy Unit 1H
 API WELL NO
 47 - 103 - 03478
 STATE COUNTY PERMIT

WELL TYPE: OIL GAS LIQUID INJECTION WASTE DISPOSAL
 (IF GAS) PRODUCTION: STORAGE DEEP SHALLOW

LOCATION: ELEVATION: As-Built 1,206' WATERSHED: Fishing Creek QUADRANGLE: Porter Falls 17; 41.75; 39; 42;
 DISTRICT: Green Margaret COUNTY: Wayne 76; 46.875; 37; 53;
 SURFACE OWNER: Lancaster Edward D. & Heather M. Stewart; Susan J. Fair; Dale L. Fox; Thomas W. Lins; Linda Ice Long; ACREAGE: 39.00 34.17; 38; 32.56; 26;
 ROYALTY OWNER: Shiben Estates Inc. (3); Chesapeake Appalachia, LLC (3); Kenneth Stewart Keystone Trust (2); LEASE NO: ACREAGE: 60; 57.1; 26.5; 15; 69

PROPOSED WORK: DRILL CONVERT DRILL DEEPER FRACTURE OR STIMULATE PLUG OFF OLD FORMATION
 PERFORATE NEW FORMATION OTHER PHYSICAL CHANGE IN WELL (SPECIFY) As-Drilled 6,888' TVD
 PLUG AND ABANDON CLEAN OUT AND REPLUG TARGET FORMATION: Marcellus Shale ESTIMATED DEPTH: 25,744' MD

WELL OPERATOR: Antero Resources Corporation DESIGNATED AGENT: Kevin Ellis
 ADDRESS: 1615 Wynkoop Street ADDRESS: 535 White Oaks Blvd.
 Denver, CO 80202 Bridgeport, WV 26330

08/11/2023

Antero Resources
Well No. Baldy 1H
As-Drilled

Antero Resources Corporation

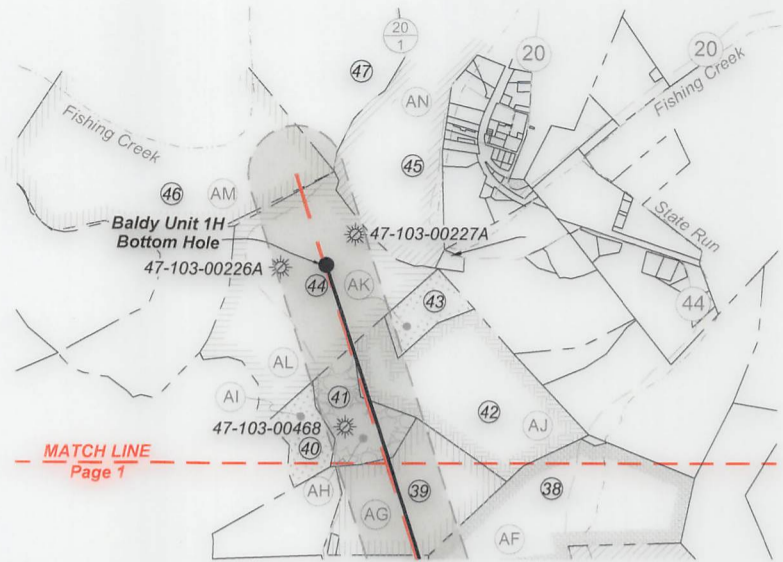

ID	TM-Par	Owner	Bk/Pg	Acres
1	19-31	Margaret Lancaster	333 / 440	39.00
2	12-27	Crystal A. Muzzy (Tyler Co.)	W69 / 226	60.91
3	-	Garrett Cemetery	85 / 62	1.80
4	12-25	Cecil & Margaret Lancaster	170 / 48	78.17
5	19-52	Joshua Highley	464 / 208	8.01
6	19-30	Richard R. & Mary J. Scyoc	452 / 177	13.00
7	19-21	Joshua Highley	464 / 208	41.75
8	19-23	Richard R. & Mary J. Scyoc	452 / 177	25.00
9	19-15	Joshua Highley	464 / 208	17.00
10	19-16	Richard R. & Mary J. Scyoc	443 / 336	73.96
11	19-13	Joshua Highley	464 / 208	5.00
12	19-14	Joshua Highley	419 / 822	6.00
13	19-12	Joshua Highley	464 / 208	17.17
14	19-22	John Sheldon Condit	309 / 312	24.25
15	19-5	Gregg Weis	297 / 608	6.50
16	16-75	Gregg John Weis	317 / 157	7.50
17	19-54	Susan J. Fair	378 / 97	59.75
18	16-59.1	Mark Goldstein	435 / 308	25.00
19	16-73	Gregg Weis	294 / 477	5.00
20	16-53	Edward D. & Heather M. Stewart	390 / 10	32.60
21	16-74	Mark I. Goldstein	431 / 532	6.00
22	16-52	RBMA, LLC	431 / 526	43.25
23	16-44	Kenneth E. Stewart Keystone Trust	424 / 821	46.30
24	16-37	Garrett S. Estate	316 / 248	61.00
25	16-36	Kenneth E. Stewart Keystone Trust	424 / 821	53.00
26	16-29	Kenneth E. Stewart Keystone Trust	424 / 821	53.50
27	16-20	Bonita Andrich, et al	W70 / 243	79.03
28	16-8	Wilber B. Dawson & Loretta P. Ueltschey	408 / 192	75.75
29	16-19	Eugene D., Jr. & Diane Mason	405 / 291	64.70
30	16-18	Cathy A. & Ernest E. Stewart	355 / 280	28.50
31	16-7	Wilbur B. Dawson & Loretta P. Ueltschey	408 / 192	54.50
32	16-2	Wilbur B. Dawson & Loretta P. Ueltschey	408 / 192	44.50
33	12-53	Robert E. Midcap	399 / 40	57.00
34	12-54	Jerri L. & Donald H. Satterfield, Jr.	399 / 108	54.72
35	12-45	Roger Dale Midcap	399 / 37	46.00
36	12-48	John W. & Rosalie M. Ueltschey	362 / 403	47.87
37	12-47	Linda K. Ice	447 / 793	26.25
38	12-39	Martin E. Rodgers	421 / 621	60.00
39	12-38	Roger D. & Tina S. Midcap	342 / 74	37.00
40	12-24	Jerome E. Staley	242 / 72	10.00
41	12-25	Jerome E. Staley	242 / 72	15.00
42	12-26	Martin E. Rodgers	419 / 493	50.40
43	12-26.1	Phillip Wiley	361 / 471	8.25
44	12-17	Charmaine A. & Heath C. Starkweather	427 / 930	69.00
45	7-50	Bradley W. & Kimberly Ueltschey	342 / 710	79.78
46	12-1	Bradley W. Ueltschey	476 / 310	78.13
47	7-38	Marikay G. Corliss	447 / 763	144.00

Leases	
A	Shiben Estates, Inc.
B	Randy Bradley
C	Shiben Estates, Inc.
D	Richard R. & Mary J. Scyoc
E	Shiben Estates, Inc.
F	Shiben Estates, Inc.
G	Allen Vincent Wilcox
H	Richard R. & Mary J. Scyoc
I	Antero Minerals, LLC
J	Susan J. Fair
K	Chesapeake Appalachia, LLC
L	Dale L. Fox
M	Joyce E. Henry
N	Antero Minerals, LLC
O	Edward D. & Heather M. Stewart
P	RBMA, LLC
Q	Thomas W. Lins
R	Harry I. Elson
S	Kenneth Stewart Keystone Trust
T	Kenneth Stewart Keystone Trust
U	Gladys E. Conley Trust
V	Ernest & Cathy Stewart 2019 Irrevocable Trust
W	Chesapeake Appalachia, LLC
X	Ernest & Cathy Stewart 2019 Irrevocable Trust
Y	Shiben Estates, Inc.
Z	Chesapeake Appalachia, LLC
AA	Robert E. & Michaelmary Midcap
AB	Five Star Resources
AC	Barbara Anne Amos King
AD	Ridgetop Royalties, LLC
AE	Linda Ice Long
AF	Paul H. Abel
AG	Chesapeake Appalachia, LLC
AH	Dennis B. Moore
AI	Jerome E. Staley
AJ	Ridgetop Royalties, LLC
AK	Phillip W. Wiley
AL	Charmaine A. Starkweather, et vir
AM	Stone Hill Minerals Holdings, LLC
AN	Bradley W. Ueltschey, et ux

FILE NO: 109-34-G-18
 DRAWING NO: Baldy 1H As-Drilled
 SCALE: 1" = 2000'
 MINIMUM DEGREE OF ACCURACY:
 Submeter
 PROVEN SOURCE OF ELEVATION:
 CORS, Monroe County, OH

STATE OF WEST VIRGINIA
 DEPARTMENT OF ENVIRONMENTAL PROTECTION
OIL AND GAS DIVISION

DATE: February 22 20 23
 OPERATOR'S WELL NO. Baldy Unit 1H
 API WELL NO
 47 - 103 - 03478
 STATE COUNTY PERMIT

WELL TYPE: OIL GAS LIQUID INJECTION WASTE DISPOSAL
 (IF GAS) PRODUCTION: STORAGE DEEP SHALLOW

LOCATION: ELEVATION: As-Built 1,206' WATERSHED: Fishing Creek QUADRANGLE: Porter Falls 17; 41.75; 39; 42;
 DISTRICT: Green Margaret Charmaine A. Starkweather, et vir; Paul H. Abel; COUNTY: Wetzel 76.46875; 37; 53;
 SURFACE OWNER: Lancaster Gladys E. Conley Trust; Robert E. & Michaelmary Midcap; Five Star Resources; 43.5; 119.03125; 87; 6;
 Edward D. & Heather M. Stewart; Susan J. Fair; Dale L. Fox; Thomas W. Lins; Linda Ice Long; ACREAGE: 39.00 34.17; 38; 32.56; 26;
 Ridgetop Royalties, LLC (2); Antero Minerals, LLC; Richard R. & Mary J. Scyoc; Dennis B. Moore; 46.5; 119.03125; 57;
 ROYALTY OWNER: Shiben Estates Inc. (3); Chesapeake Appalachia, LLC (3); Kenneth Stewart Keystone Trust (2); LEASE NO: ACREAGE: 60; 57.1; 26.5; 15; 69

PROPOSED WORK: DRILL CONVERT DRILL DEEPER FRACTURE OR STIMULATE PLUG OFF OLD FORMATION
 PERFORATE NEW FORMATION OTHER PHYSICAL CHANGE IN WELL (SPECIFY) As-Drilled 6,888' TVD
 PLUG AND ABANDON CLEAN OUT AND REPLUG TARGET FORMATION: Marcellus Shale ESTIMATED DEPTH: 25,744' MD

WELL OPERATOR: Antero Resources Corporation DESIGNATED AGENT: Kevin Ellis
 ADDRESS: 1615 Wynkoop Street ADDRESS: 535 White Oaks Blvd.
 Denver, CO 80202 Bridgeport, WV 26330

08/11/2023