

NOTES ON SURVEY

- COORDINATES SYSTEM IS LTM, NAD 83 DATUM, ZONE 17, U.S. FOOT AND WELL COORDINATES ESTABLISHED USING SURVEY GRADE GPS.
- SURFACE AND ROYALTY OWNER INFORMATION AND THEIR BOUNDARIES SHOWN HEREON WERE PLOTTED FROM DEEDS AND/OR TAX PARCEL MAPS PROVIDED BY CLIENT AND FIELD LOCATIONS.
- THIS PLAT DOES NOT REPRESENT A BOUNDARY SURVEY OF THE PARCELS SHOWN HEREON.
- NO DWELLINGS AND BUILDINGS WITHIN 625 FEET OF PROPOSED OF CENTER OF PAD.
- NO WATER WELLS OR DEVELOPED SPRINGS WITHIN 250 FEET OF PROPOSED WELL.
- NO PERENNIAL STREAMS, LAKES, PONDS, RESERVOIRS OR WETLANDS WITHIN 100 FEET OF THE LIMITS OF DISTURBANCE.
- NO NATURALLY PRODUCING TROUT STREAM WITHIN 300 FEET OF LIMITS OF DISTURBANCE.

- LEGEND**
- Plugged Well Location
 - Abandoned Well
 - Surface Tract Identification
 - Proposed Gas Well
 - Located Corner, as noted
 - Surface Tract Lines
 - Reference Line
 - Lease Boundary
 - Creek or Drain
 - County Line
 - WV County Route
 - WV State Route

(⊕) Denotes Location of Well on United States Topographic Maps



I, the undersigned, hereby certify that this plat is correct to the best of my knowledge and belief and shows all the information required by law and the regulations issued and prescribed by the Department of Environmental Protection

Thomas C. Smit
L. L. S. 687

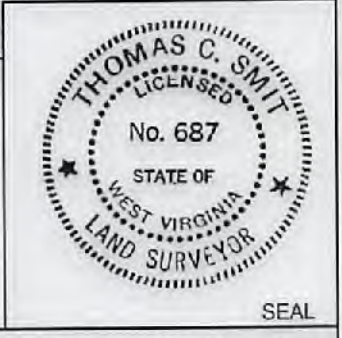

FILE NO:
DRAWING NO:
SCALE: 1" = 1000'
MINIMUM DEGREE OF ACCURACY: 1:2500
PROVEN SOURCE OF ELEVATION: SG-GPS (OPUS)



DATE: DECEMBER 20 20 21
OPERATORS WELL NO: Tesla 9H
API WELL NO: 47 - 103 - 03474
STATE COUNTY PERMIT

WELL TYPE: OIL GAS LIQUID INJECTION WASTE DISPOSAL
(IF GAS) PRODUCTION: STORAGE DEEP SHALLOW

LOCATION ELEVATION: 1333' WATERSHED: Fishing Creek QUADRANGLE: Glover Gap
DISTRICT: Grant COUNTY: Wetzel

SURFACE OWNER: Mike Ross Inc. & EQT Production Company ACREAGE: 47.3 ±
ROYALTY OWNER: William M. Peterson, Jr., et al. LEASE NO: Q129822000 ACREAGE: 4.564 ±

PROPOSED WORK: DRILL CONVERT DRILL DEEPER FRACTURE OR STIMULATE PLUG OFF OLD FORMATION
 PERFORATE NEW FORMATION OTHER PHYSICAL CHANGE IN WELL (SPECIFY)

PLUG AND ABANDON CLEAN OUT AND REPLUG TARGET FORMATION: Marcellus ESTIMATED DEPTH: 7,644'

WELL OPERATOR: EQT Production Company DESIGNATED AGENT: Joseph C Mallow
ADDRESS: 400 Woodcliff Drive ADDRESS: 115 Professional Place PO Box 280
Canonsburg, PA 15317 Bridgeport, WV 26330

Tesla 9H
Tesla
EQT Production Company

| Traffic ID | Tax Map No. | Parcel No. | County | District | Surface Tract Owner | Acres |
|------------|-------------|------------|--------|------------|-----------------------------------------|--------|
| 1 | 31 | 2.2 | Wetzel | Grant | H.L. Smith EST | 26.00 |
| 2 | 31 | 2.0 | Wetzel | Grant | Consolidation Coal Company | 29.00 |
| 3 | 31 | 1.0 | Wetzel | Grant | Mike Ross Inc. & EQT Production Company | 47.30 |
| 4 | 47 | 12.0 | Marion | Mannington | Amber M. Nichols | 73.75 |
| 5 | 47 | 12.0 | Marion | Mannington | George B & Cynthia Kovach | 75.56 |
| 6 | 25 | 44.0 | Wetzel | Grant | John E. Reppard EST & Mike Ross Inc. | 52.00 |
| 7 | 25 | 40.0 | Wetzel | Grant | Rosie Lee & Walter B. Smith | 57.50 |
| 8 | 25 | 39.0 | Wetzel | Grant | Rosie Lee & Walter B. Smith | 74.00 |
| 9 | 25 | 45.0 | Wetzel | Grant | Rosie Lee & Walter B. Smith | 0.54 |
| 10 | 30 | 12.0 | Wetzel | Grant | Joseph Rex Smith | 92.12 |
| 11 | 30 | 13.0 | Wetzel | Grant | Lee Brooks & Lisa Kay Brown | 75.00 |
| 12 | 30 | 37.0 | Wetzel | Grant | Jimmy D & Lynn Sharon Myers | 1.00 |
| 13 | 30 | 38.0 | Wetzel | Grant | Dalison Lumber INC | 137.80 |

| Lease | Owner | Acres |
|------------|---------------------------------------------|-----------|
| Q129822000 | William M. Peterson, Jr., et al. | 4,564 |
| Q121441000 | Stone Hill Mineral Holdings, LLC | 14,054.30 |
| Q136839001 | Brooks Lee Brown and Lisa Kay Brown, et al. | 74.05625 |

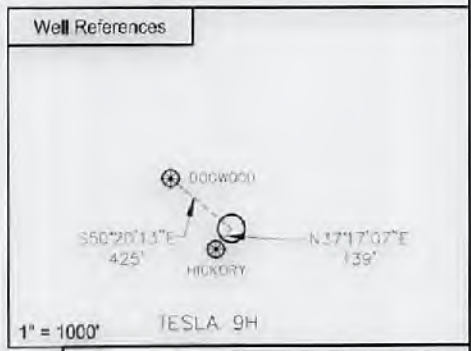
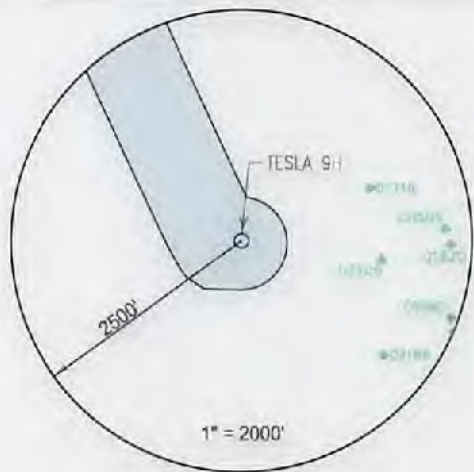

Notes:
 TESLA 9H coordinates are
 NAD 27 N: 370,534,316 E: 1,722,282,473
 NAD 27 Lat: 39.513157 Long: -80.484367
 NAD 83 UTM N: 4,373,861,055 E: 544,341,434

TESLA 9H Landing Point coordinates are
 NAD 27 N: 371,104,079 E: 1,721,755,706
 NAD 27 Lat: 39.514705 Long: -80.486253
 NAD 83 UTM N: 4,374,031,969 E: 544,178,363

TESLA 9H Bottom Hole coordinates are
 NAD 27 N: 372,703,870 E: 1,721,010,638
 NAD 27 Lat: 39.519075 Long: -80.488959
 NAD 83 UTM N: 4,374,515,577 E: 543,942,953

West Virginia Coordinates system of 1927 (North Zone)
 based upon Differential GPS Measurements
 Plat orientation, Corner and well ties are based upon
 the grid north meridian
 Well location references are based upon the grid north
 meridian.
 UTM coordinates are NAD83, Zone 17, Meters.

- TESLA PAD**
- TESLA 17H ○
 - TESLA 15H ○ ○ TESLA 16H
 - TESLA 13H ○ ○ TESLA 14H
 - TESLA 11H ○ ○ TESLA 12H
 - TESLA 9H ○ ○ TESLA 10H
 - TESLA 7H ○ ○ TESLA 8H
 - TESLA 5H ○ ○ TESLA 6H
 - TESLA 3H ○ ○ TESLA 4H
 - TESLA 1H ○ ○ TESLA 2H



I, the undersigned, hereby certify that this plat is correct to the best of my knowledge and belief and shows all the information required by law and the regulations issued and prescribed by the Department of Environmental Protection.

Thomas C. Smit
 L. L. S. 687



FILE NO: _____
 DRAWING NO: _____
 SCALE: 1" = 1000'
 MINIMUM DEGREE OF ACCURACY: 1:2500
 PROVEN SOURCE OF ELEVATION: NGS CORS Station



DATE: DECEMBER 20 20 21
 OPERATORS WELL NO: Tesla 9H
 API WELL NO: 47 - 103 - 03474
 STATE COUNTY PERMIT

WELL TYPE: OIL GAS LIQUID INJECTION WASTE DISPOSAL
 (IF GAS) PRODUCTION: STORAGE DEEP SHALLOW

LOCATION ELEVATION: 1333' WATERSHED: Fishing Creek QUADRANGLE: Glover Gap
 DISTRICT: Grant COUNTY: Wetzel

SURFACE OWNER: Mike Ross Inc. & EQT Production Company ACREAGE: 47.3 ±
 ROYALTY OWNER: William M. Peterson, Jr., et al. LEASE NO: Q129822000 ACREAGE: 4,564 ±

PROPOSED WORK: DRILL CONVERT DRILL DEEPER FRACTURE OR STIMULATE PLUG OFF OLD FORMATION
 PERFORATE NEW FORMATION OTHER PHYSICAL CHANGE IN WELL (SPECIFY)

PLUG AND ABANDON CLEAN OUT AND REPLUG TARGET FORMATION: Marcellus ESTIMATED DEPTH: 7,644'

WELL OPERATOR: EQT Production Company DESIGNATED AGENT: Joseph C Mallow
 ADDRESS: 400 Woodcliff Drive ADDRESS: 115 Professional Place PO Box 280
 Canonsburg, PA 15317 Bridgeport, WV 26330