

9,984' to Top Hole

1,941' to Bottom Hole

Antero Resources
Well No. Welder 1H
BHL MOD
Antero Resources Corporation



TOP HOLE LATITUDE 39 - 35 - 00
BTM HOLE LATITUDE 39 - 37 - 30

Notes
West Virginia Coordinate System of 1927, North Zone based upon Differential GPS Measurements.
Well No. Welder Unit 1H Top Hole coordinates are
N: 384,142.54' Latitude: 39°32'52.91"
E: 1,649,286.49' Longitude: 80°44'37.46"
Bottom Hole coordinates are
N: 401,066.72' Latitude: 39°35'36.69"
E: 1,645,015.20' Longitude: 80°45'24.79"
UTM Zone 17 NAD 1983
Top Hole Coordinates Bottom Hole Coordinates
N: 4,377,835.272m N: 4,382,773.679m
E: 522,033.144m E: 520,889.709m
Plat orientation and corner and well references are based upon the grid north meridian.
Well location references are based upon the magnetic meridian.

Notes:
Well No. Welder Unit 1H UTM Zone 17, NAD 1927
Top Hole Coordinates
N: 14,361,576.32'
E: 1,712,655.67'
Point of Entry Coordinates
N: 14,363,030.50'
E: 1,714,173.86'
Bottom Hole Coordinates
N: 14,378,434.54'
E: 1,708,903.61'

	Bearing	Dist.
L1	S 01°55' E	1,599.3'
L2	S 07°41' W	809.6'
L3	S 23°50' W	1,880.6'
L4	S 65°50' W	964.0'
L5	N 47°11' E	2,103.0'



I, the undersigned, hereby certify that this plat is correct to the best of my knowledge and belief and shows all the information required by law and the rules issued and prescribed by the Department of Environmental Protection.

Bradley D. Miller
Bradley D. Miller, P.S. 2167

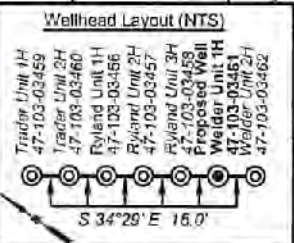

- Legend**
- Proposed gas well
 - Monument, as noted
 - Existing Well, as noted
 - Digitized Well, as noted
 - Creek or Drain
 - Road
 - Railroad
 - Surface boundary (approx.)
 - Interior surface tracts (approx.)

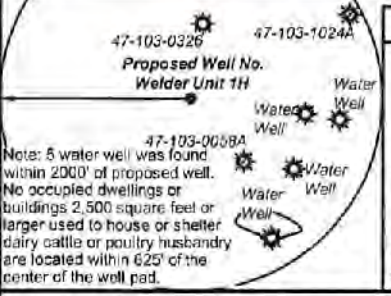

FILE NO: 135-34-G-18
DRAWING NO: Welder 1H BHL Mod
SCALE: 1" = 2000'
MINIMUM DEGREE OF ACCURACY: Submeter
PROVEN SOURCE OF ELEVATION: CORS, Monroe County, OH

STATE OF WEST VIRGINIA
DEPARTMENT OF ENVIRONMENTAL PROTECTION
OIL AND GAS DIVISION

DATE: January 7, 2022
OPERATOR'S WELL NO. Welder Unit 1H
API WELL NO
47 - 103 - 03461
STATE COUNTY PERMIT

WELL TYPE: OIL GAS LIQUID INJECTION WASTE DISPOSAL
(IF GAS) PRODUCTION: STORAGE DEEP SHALLOW

LOCATION: ELEVATION: Existing 1,175' Proposed 1,154' WATERSHED: Fishing Creek QUADRANGLE: Pine Grove 4,457; Porter Falls 47.5; 537; 1187.5; 75.6; 167,850; 50; 46.25; 42.25; 4,456; 119; 56.75; 57.38; 50.225; 3.65; 140; 43.5; 182

DISTRICT: Green Antero Resources CORPORATION COUNTY: Wayne 03/04/2022
SURFACE OWNER: Corporation ACREAGE: 47.5
ROYALTY OWNER: Pamela Ann Palmer Erlich; William R. Stalnaker; David E. Bowyer; Acropolis, Inc. LEASE NO: ACREAGE: 3.65; 140; 43.5; 182

PROPOSED WORK: DRILL CONVERT DRILL DEEPER FRACTURE OR STIMULATE PLUG OFF OLD FORMATION
 PERFORATE NEW FORMATION OTHER PHYSICAL CHANGE IN WELL (SPECIFY) BHL MOD
 PLUG AND ABANDON CLEAN OUT AND REPLUG TARGET FORMATION: Marcellus Shale ESTIMATED DEPTH: 7,400' TVD 26,200' MD

WELL OPERATOR: Antero Resources Corporation DESIGNATED AGENT: Dianna Stamper - CT Corporation System
ADDRESS: 1615 Wynkoop Street ADDRESS: 5400 D Big Tyler Road
Denver, CO 80202 Charleston, WV 25313

Antero Resources
Well No. Welder 1H
BHL MOD
 Antero Resources Corporation



Leases	
A	Pamela Ann Palmer Emch
B	BRC Appalachian Minerals I, LLC
C	William R. Stalnaker
D	David E. Bowyer
E	Acropolis, Inc.
F	Antero Minerals, LLC
G	Acropolis, Inc.
H	Dean H. Bucher
I	Linda Carol Gadd Leatham
J	Melody Rea Posey
K	Coastal Forest Resources Co.
L	Terry Lee Cummings
M	Betsy J. Westfall
N	BRC Appalachian Minerals I, LLC
O	Jeffrey D. Brown
P	Dwain Ray Brown
Q	WVDNR
R	Bounty Minerals, LLC
S	H. Dorn Higginbotham, et ux
T	WVDOH
U	David L. Anderson
V	BRC Appalachian Minerals I, LLC
W	Chesapeake Appalachia, LLC
X	Carolyn Jacobs Hampson
Y	P&P Fujimo LLC
Z	Linda Headlee Malone, et vir

ID	TM/Par	Owner	Bk/Pg	Acres
1	16-26	Antero Resources Corporation	474/713	47.50
2	16-25	Antero Resources Corporation	474/713	39.00
3	17-22	Perry D. Bucher	411/759	37.65
4	17-58	Pennie Baker	411/735	42.41
5	17-23	Michael Steven Blinkman	461/443	40.10
6	17-60	Ross Bucher	411/765	79.00
7	17-56	Pennie R. & Richard K. Bauer	366/273	1.63
8	17-15.1	Douglas Alan & Shirley Joann Bucher	442/718	12.41
9	17-59	Pennie Baker	446/344	12.51
10	17-15.8	Ross William Bucher, Jr.	411/785	0.37
11	17-15.7	Jeremy & Terry Bucher	365/108	7.37
12	16-16	Donald L. Smith II, et ux	451/925	60.75
13	17-15.6	Jeremy & Terry Bucher	365/108	4.14
14	17-15.5	Jeremy & Terry Bucher	427/509	2.13
15	16-13	Donald L. Smith II, et ux	451/925	35.00
16	13-69	Donald L. Mason	410/759	69.61
17	13-67	Gerold F. & Debra D. Richard	399/544	63.27
18	13-63.2	John R. & Jahnna S. Harter	437/873	2.87
19	13-55	John P. Workman, Jr.	W53/535	48.97
20	13-67.5	Julie A. & Aaron E. Hinderman	399/322	16.44
21	13-42	Brian K. & Rebecca A. Starkay	410/127	1.02
22	13-36	Coastal Forest Resources Co.	444/105	50.00
23	13-28	Coastal Forest Resources Co.	444/105	46.25
24	13-18	Coastal Forest Resources Co.	444/105	119.00
25	13-19	John F. Long Estate, et al	442/101	19.25
26	13-67	Raymond P. & Pamela J. Gaston	429/227	4.45
27	13-88	John F. Long Estate, et al	442/101	26.00
28	13-12.6	Dwain Ray Brown	421/897	15.00
29	13-2	Dwain Ray Brown	421/897	19.75
30	8-42	Dwain Ray Brown	421/897	22.00
31	8-38.9	H. Dorn Higginbotham & Janet L. Workman Higginbotham	363/197	5.00
32	8-38.1	David L. Anderson	340/578	2.25
33	8-47	Larrison Brothers, LLC	417/100	53.62
34	8-29	James L. Scott, Sr., et al	431/50	64.76
35	8-30	Michael L. & Erin M. Greathouse	363/91	76.00
36	8-46	John George	367/478	52.21
37	8-25	Jody Kay Rine, et al	435/542	130.00
38	8-21	BP Mineral Holdings II LLC & Somerset Minerals LP	425/427	43.50
39	8-20.3	Brent A. & Amy S. Boram	427/802	62.60
40	8-20.2	Loraine M. Williams	383/463	15.00

FILE NO: 135-34-G-18
 DRAWING NO: Welder 1H BHL Mod
 SCALE: 1" = 2000'
 MINIMUM DEGREE OF ACCURACY:
 Submeter
 PROVEN SOURCE OF ELEVATION:
 CORS, Monroe County, OH



DATE: January 7 20 22
 OPERATOR'S WELL NO. Welder Unit 1H
 API WELL NO
 47 - 103 - 03461
 STATE COUNTY PERMIT

WELL TYPE: OIL GAS LIQUID INJECTION WASTE DISPOSAL
 (IF GAS) PRODUCTION: STORAGE DEEP SHALLOW

LOCATION: ELEVATION: Existing 1,175' Proposed 1,154' WATERSHED: Fishing Creek QUADRANGLE: Pine Grove 4,457; Porter Falls 4,457; 47.5; 75.6; 137.650; 50; 46.25; 42.25; 4.456; 119; 56.75; 57.38; 50.225; 3.65; 140; 43.5; 182
 DISTRICT: Green Antero Resources Corporation
 SURFACE OWNER: Corporation
 ROYALTY OWNER: Pamela Ann Palmer Emch; William R. Stalnaker; David E. Bowyer; Acropolis, Inc.
 COUNTY: Wv
 ACREAGE: 47.5
 LEASE NO: ACREAGE:

PROPOSED WORK: DRILL CONVERT DRILL DEEPER FRACTURE OR STIMULATE PLUG OFF OLD FORMATION
 PERFORATE NEW FORMATION OTHER PHYSICAL CHANGE IN WELL (SPECIFY) BHL MOD
 PLUG AND ABANDON CLEAN OUT AND REPLUG TARGET FORMATION: Marcellus Shale ESTIMATED DEPTH: 7,400' TVD 26,200' MD

WELL OPERATOR: Antero Resources Corporation DESIGNATED AGENT: Dianna Stamper - CT Corporation System
 ADDRESS: 1615 Wynkoop Street ADDRESS: 5400 D Big Tyler Road
 Denver, CO 80202 Charleston, WV 25313

9,984' to Top Hole

1,941' to Bottom Hole

Page 1 of 2

Antero Resources
Well No. Welder 1H
BHL MOD
Antero Resources Corporation



TOP HOLE LATITUDE 39 - 35 - 00
BTM HOLE LATITUDE 39 - 37 - 30

Notes
West Virginia Coordinate System
of 1927, North Zone
based upon Differential GPS Measurements.
Well No. Welder Unit 1H Top Hole coordinates are
N: 384,142.54' Latitude: 39°32'52.91"
E: 1,649,266.49' Longitude: 80°44'37.46"
Bottom Hole coordinates are
N: 401,066.72' Latitude: 39°35'39.69"
E: 1,645,815.20' Longitude: 80°45'24.79"
UTM Zone 17, NAD 1983
Top Hole Coordinates Bottom Hole Coordinates
N: 4,377,635.272m N: 4,382,773.679m
E: 522,033.144m E: 520,889.709m
Plat orientation and corner and well references
are based upon the grid north meridian.
Well location references are based upon the magnetic
meridian.

TOP HOLE LONGITUDE 80 - 42 - 30
BTM HOLE LONGITUDE 80 - 45 - 00

Notes:
Well No. Welder Unit 1H
UTM Zone 17, NAD 1927
Top Hole Coordinates
N: 14,361,576.32'
E: 1,712,655.67'
Point of Entry Coordinates
N: 14,363,030.50'
E: 1,714,173.86'
Bottom Hole Coordinates
N: 14,378,434.54'
E: 1,708,903.61'

Bearing	Dist.
L1 S 81°55' E	1,599.3'
L2 S 07°41' W	809.6'
L3 S 23°50' W	1,880.6'
L4 S 65°60' W	964.0'
L5 N 47°11' E	2,103.0'

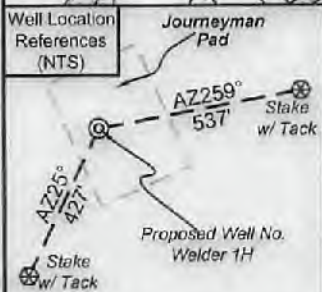

I, the undersigned, hereby certify that this plat is correct to the best of my knowledge and belief and shows all the information required by law and the rules issued and prescribed by the Department of Environmental Protection.

Bradley D. Miller, P.S. 2167

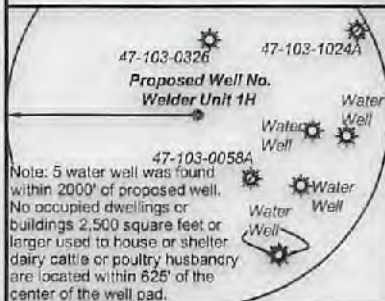
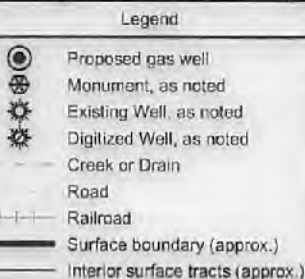
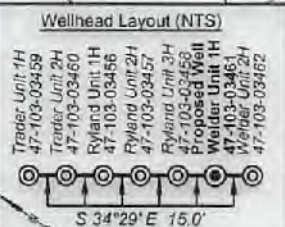

FILE NO: 135-34-G-18
DRAWING NO: Welder 1H BHL Mod
SCALE: 1" = 2000'
MINIMUM DEGREE OF ACCURACY: Submeter
PROVEN SOURCE OF ELEVATION: CORS, Monroe County, OH

STATE OF WEST VIRGINIA
DEPARTMENT OF ENVIRONMENTAL PROTECTION
OIL AND GAS DIVISION

DATE: January 7 2022
OPERATOR'S WELL NO. Welder Unit 1H
API WELL NO MOD
47 - 103 - 03461
STATE COUNTY PERMIT

WELL TYPE: OIL GAS LIQUID INJECTION WASTE DISPOSAL
(IF GAS) PRODUCTION: STORAGE DEEP SHALLOW
LOCATION: ELEVATION: Existing 1,175' Proposed 1,154' WATERSHED: Fishing Creek QUADRANGLE: TOP Hole: Pine Grove 4.457; BTM Hole: Porter Falls 47.5, 537, 11875;
DISTRICT: Green Antero Resources COUNTY: Wayne 47.5, 537, 11875;
SURFACE OWNER: Corporation ACREAGE: 47.5 42.25; 4.456; 119;
ROYALTY OWNER: Pamela Ann Palmer Emch; William R. Stainaker; David E. Bowyer; Acropolis, Inc. LEASE NO: ACREAGE: 3.85; 140; 43.5; 182
PROPOSED WORK: DRILL CONVERT DRILL DEEPER FRACTURE OR STIMULATE PLUG OFF OLD FORMATION
 PERFORATE NEW FORMATION OTHER PHYSICAL CHANGE IN WELL (SPECIFY) BHL MOD
 PLUG AND ABANDON CLEAN OUT AND REPLUG TARGET FORMATION: Marcellus Shale ESTIMATED DEPTH: 7,400' TVD 26,200' MD

WELL OPERATOR: Antero Resources Corporation DESIGNATED AGENT: Dianna Stamper - CT Corporation System
ADDRESS: 1615 Wynkoop Street ADDRESS: 5400 D Big Tyler Road
Denver, CO 80202 Charleston, WV 25313

11,161' to Bottom Hole

12,859' to Top Hole

03/04/2022

Antero Resources
Well No. Welder 1H
BHL MOD
 Antero Resources Corporation



Leases	
A	Pamela Ann Palmer Emch
B	BRC Appalachian Minerals I, LLC
C	William R. Stalnaker
D	David E. Bowyer
E	Acropolis, Inc.
F	Antero Minerals, LLC
G	Acropolis, Inc.
H	Dean H. Bucher
I	Linda Carol Gadd Leatham
J	Melody Ree Posey
K	Coastal Forest Resources Co.
L	Terry Lee Cummings
M	Betsy J. Westfall
N	BRC Appalachian Minerals I, LLC
O	Jeffrey D. Brown
P	Dwain Ray Brown
Q	WVDNR
R	Bounty Minerals, LLC
S	H. Dorn Higginbotham, et ux
T	WVDOH
U	David L. Anderson
V	BRC Appalachian Minerals I, LLC
W	Chesapeake Appalachia, LLC
X	Carolyn Jacobs Hampson
Y	P&P Fujimo LLC
Z	Linda Headlee Malone, et vir

ID	TM/Par	Owner	Bk/Pg	Acres
1	16-26	Antero Resources Corporation	474/713	47.50
2	16-25	Antero Resources Corporation	474/713	39.00
3	17-22	Perry D. Bucher	411/759	37.65
4	17-58	Pennie Baker	411/735	42.41
5	17-23	Michael Steven Blinkman	461/443	40.10
6	17-60	Ross Bucher	411/765	79.00
7	17-56	Pennie R. & Richard K. Bauer	366/273	1.63
8	17-15.1	Douglas Alan & Shirley Joann Bucher	442/718	12.41
9	17-59	Pennie Baker	446/344	12.51
10	17-15.8	Ross William Bucher, Jr.	411/765	0.37
11	17-15.7	Jeremy & Terry Bucher	365/108	7.37
12	16-16	Donald L. Smith II, et ux	451/925	60.75
13	17-15.6	Jeremy & Terry Bucher	365/108	4.14
14	17-15.5	Jeremy & Terry Bucher	427/509	2.13
15	16-13	Donald L. Smith II, et ux	451/925	35.00
16	13-69	Donald L. Mason	410/759	69.61
17	13-67	Gerold F. & Debra D. Richard	398/544	63.27
18	13-68.2	John R. & Jahnna S. Harter	437/873	2.87
19	13-55	John P. Workman, Jr.	W53/535	48.97
20	13-67.5	Julie A. & Aaron E. Hinderman	398/322	16.44
21	13-42	Brian K. & Rebecca A. Starkey	410/127	1.02
22	13-36	Coastal Forest Resources Co.	444/105	50.00
23	13-28	Coastal Forest Resources Co.	444/105	46.25
24	13-18	Coastal Forest Resources Co.	444/105	119.00
25	13-19	John F. Long Estate, et al	442/101	19.25
26	13-87	Raymond P. & Pamela J. Gaston	429/227	4.45
27	13-88	John F. Long Estate, et al	442/101	26.00
28	13-12.6	Dwain Ray Brown	421/897	15.00
29	13-2	Dwain Ray Brown	421/897	19.75
30	8-42	Dwain Ray Brown	421/897	22.00
31	8-38.9	H. Dorn Higginbotham & Janet L. Workman Higginbotham	363/197	5.00
32	8-38.1	David L. Anderson	340/578	2.25
33	8-47	Larrison Brothers, LLC	417/100	53.62
34	8-29	James L. Scott, Sr., et al	431/50	64.76
35	8-30	Michael L. & Erin M. Greathouse	363/91	76.00
36	8-46	John George	367/478	52.21
37	8-25	Jody Kay Rine, et al	435/542	130.00
38	8-21	BP Mineral Holdings II LLC & Somerset Minerals LP	425/427	43.50
39	8-20.3	Brent A. & Amy S. Boram	427/802	62.60
40	8-20.2	Loraine M. Williams	383/463	15.00

FILE NO: 135-34-G-18
 DRAWING NO: Welder 1H BHL Mod
 SCALE: 1" = 2000'
 MINIMUM DEGREE OF ACCURACY:
 Submeter
 PROVEN SOURCE OF ELEVATION:
 CORS, Monroe County, OH

STATE OF WEST VIRGINIA
 DEPARTMENT OF ENVIRONMENTAL PROTECTION
OIL AND GAS DIVISION

DATE: January 7, 2022
 OPERATOR'S WELL NO. Welder Unit 1H
 API WELL NO. ~~WHD~~
 47 - 103 - 03461
 STATE COUNTY PERMIT

WELL TYPE: OIL GAS LIQUID INJECTION WASTE DISPOSAL
 (IF GAS) PRODUCTION: STORAGE DEEP SHALLOW

LOCATION: ELEVATION: Existing 1,175' Proposed 1,154' WATERSHED: Fishing Creek QUADRANGLE: Pine Grove 4.457; Porter Falls 47.5; 537.11875; 75.6; 167.650; 59; 48.25; 42.25; 4.456; 119; 56.75; 57.38; 50.225; 3.65; 140; 43.5; 182

DISTRICT: Green Antero Resources CORPORATION COUNTY: Wayne
 SURFACE OWNER: Corporation ACREAGE: 47.5
 ROYALTY OWNER: Pamela Ann Palmer Emch; William R. Stalnaker; David E. Bowyer; Acropolis, Inc. LEASE NO: ACREAGE: 3.65; 140; 43.5; 182

PROPOSED WORK: DRILL CONVERT DRILL DEEPER FRACTURE OR STIMULATE PLUG OFF OLD FORMATION
 PERFORATE NEW FORMATION OTHER PHYSICAL CHANGE IN WELL (SPECIFY) BHL MOD
 PLUG AND ABANDON CLEAN OUT AND REPLUG TARGET FORMATION: Marcellus Shale ESTIMATED DEPTH: 7,400' TVD 26,200' MD

WELL OPERATOR: Antero Resources Corporation DESIGNATED AGENT: Dianna Stamper - CT Corporation System
 ADDRESS: 1615 Wynkoop Street ADDRESS: 5400 D Big Tyler Road
 Denver, CO 80202 Charleston, WV 25313