

10,019' to Top Hole

10,880' to Bottom Hole

LATITUDE 39 - 35 - 00

LONGITUDE 80 - 42 - 30

### Antero Resources Well No. Trader 2H

Antero Resources Corporation



ID	TMPer	Owner	Bk/Pg	Acres
1	16-26	Antero Resources Corporation	474/713	47.50
2	16-25	Antero Resources Corporation	474/713	39.00
3	17-22	Perry D. Bucher	411/759	37.65
4	17-58	Pennie Baker	411/735	42.41
5	17-15.1	Douglas Alan & Shirley Joann Bucher	442/718	12.41
6	16-16	Donald L. Smith II, et ux	451/925	60.75
7	15-15	Donald L. Smith II, et ux	451/925	36.45
8	16-13	Donald L. Smith II, et ux	451/925	35.00
9	16-4	Donald L. Smith II, et ux	451/925	36.00
10	13-67	Gerold F. & Debra D. Richard	398/544	63.27
11	13-67.3	Dana Stuart Straighl	368/19	1.42
12	13-67.4	William Patterson	331/588	0.24
13	13-67.1	Debra Dee Richard	342/502	1.13
14	13-67.5	Julie A. & Aaron E. Hinderman	398/322	16.44
15	13-55	John P. Workman, Jr	W53/535	48.97
16	13-36	Coastal Forest Resources Co.	444/105	50.00
17	13-41	Shari D. Burgess	432/665	95.08

**Notes**  
West Virginia Coordinate System of 1927, North Zone based upon Differential GPS Measurements. Well No. Tracer Unit 2H Top Hole coordinates are N: 384,191.99' Latitude: 39°32'53.39" E: 1,649,252.52' Longitude: 80°44'37.90" Bottom Hole coordinates are N: 390,111.44' Latitude: 39°33'51.79" E: 1,648,470.36' Longitude: 80°44'48.94" UTM Zone 17, NAD 1983  
Top Hole Coordinates: N: 4,377,650.184m E: 522,022.543m Bottom Hole Coordinates: N: 4,379,449.599m E: 521,754.215m  
Plat orientation and corner and well references are based upon the grid north meridian. Well location references are based upon the magnetic meridian.

Leases	
A	Pamela Ann Palmer Emch
B	BRC Appalachian Minerals I, LLC
C	William R. Stalnaker
D	David E. Bowyer
E	Dianna K. Howell
F	Melinda Debrner
G	Acropolis, Inc.
H	Acropolis, Inc.
I	Acropolis, Inc.
J	Linda Carol Gadd Leathman
K	Dean H. Bucher
L	P & P Fujfma, LLC
M	Melody Ree Posey

**Notes:**  
Well No. Tracer Unit 2H UTM Zone 17, NAD 1927  
Top Hole Coordinates: N: 14,361,625.18' E: 1,712,620.89'  
Point of Entry Coordinates: N: 14,362,780.23' E: 1,713,363.56'  
Bottom Hole Coordinates: N: 14,367,526.77' E: 1,711,740.33'

	Bearing	Dist.
L1	S 83°33' E	1,559.3'
L2	S 10°42' W	765.2'
L3	S 25°25' W	1,849.8'
L4	S 69°18' W	976.6'
L5	N 33°42' E	1,373.7'



I, the undersigned, hereby certify that this plat is correct to the best of my knowledge and belief and shows all the information required by law and the rules issued and prescribed by the Department of Environmental Protection.

*Bradley D. Miller*  
Bradley D. Miller, P.S. 2167

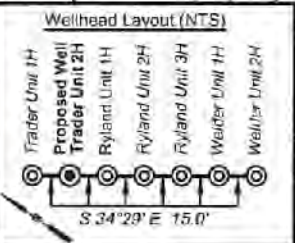

**Legend**

- Proposed gas well
- Monument, as noted
- Existing Well, as noted
- Digitized Well, as noted
- Creek or Drain
- Road
- Railroad
- Surface boundary (approx.)
- Interior surface tracts (approx.)

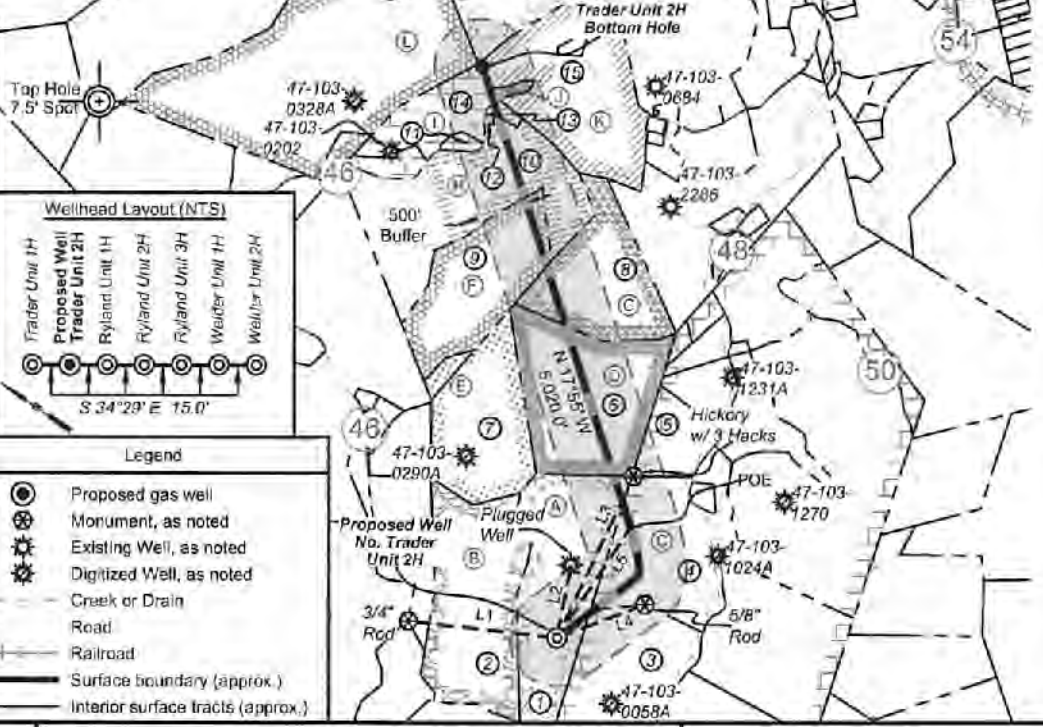
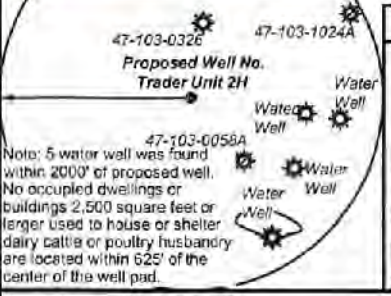

FILE NO: 133-34-G-18  
DRAWING NO: Trader 2H Well Plat  
SCALE: 1" = 2000'  
MINIMUM DEGREE OF ACCURACY: Submeter  
PROVEN SOURCE OF ELEVATION: CORS, Monroe County, OH

**STATE OF WEST VIRGINIA**  
DEPARTMENT OF ENVIRONMENTAL PROTECTION  
**OIL AND GAS DIVISION**

DATE: October 25 2021  
OPERATOR'S WELL NO. Trader Unit 2H  
API WELL NO  
47 - 103 - 3460 H6A  
STATE COUNTY PERMIT

WELL TYPE:  OIL  GAS  LIQUID INJECTION  WASTE DISPOSAL  
(IF GAS) PRODUCTION:  STORAGE  DEEP  SHALLOW  
LOCATION: ELEVATION: Existing 1,175' Proposed 1,154' WATERSHED: Fishing Creek QUADRANGLE: Pine Grove  
DISTRICT: Green Antero Resources COUNTY: Wayne  
SURFACE OWNER: Corporation Linda Carol Gadd Leathman, Dean H. Bucher, Melinda Debrner, DATE: 11/05/2021  
ROYALTY OWNER: Pamela Ann Palmer Emch, William R. Stalnaker, David E. Bowyer, Acropolis, Inc. (3) LEASE NO: ACREAGE: 47.5 537.11875; 47.5; 60.75; 35; 33; 45.5; 22; 50; 1.6  
PROPOSED WORK:  DRILL  CONVERT  DRILL DEEPER  FRACTURE OR STIMULATE  PLUG OFF OLD FORMATION  
 PERFORATE NEW FORMATION  OTHER PHYSICAL CHANGE IN WELL (SPECIFY)  
 PLUG AND ABANDON  CLEAN OUT AND REPLUG TARGET FORMATION: Marcellus Shale ESTIMATED DEPTH: 7,400' TVD 14,400' MD

WELL OPERATOR: Antero Resources Corporation DESIGNATED AGENT: Dianna Stamper - CT Corporation System  
ADDRESS: 1615 Wynkoop Street ADDRESS: 5400 D Big Tyler Road  
Denver, CO 80202 Charleston, WV 25313



**Antero Resources  
Well No. Trader 2H**

Antero Resources Corporation



ID	TM/Par	Owner	Bk/Pg	Acres
1	16-26	Antero Resources Corporation	474/713	47.50
2	16-25	Antero Resources Corporation	474/713	39.00
3	17-22	Perry D. Bucher	411/759	37.65
4	17-58	Pannie Baker	411/735	42.41
5	17-15.1	Douglas Alan & Shirley Joann Bucher	442/718	12.41
6	16-16	Donald L. Smith II, et ux	451/925	60.75
7	16-15	Donald L. Smith II, et ux	451/925	36.45
8	16-13	Donald L. Smith II, et ux	451/925	35.00
9	16-4	Donald L. Smith II, et ux	451/925	38.00
10	13-67	Gerold F. & Debra D. Richard	398/544	63.27
11	13-67.3	Dana Stuart Straight	368/19	1.42
12	13-67.4	William Patterson	331/588	0.24
13	13-67.1	Debra Dee Richard	342/502	1.13
14	13-67.5	Julie A. & Aaron E. Hinderman	398/322	16.44
15	13-55	John P. Workman, Jr.	W53/535	48.97
16	13-38	Coastal Forest Resources Co.	444/105	50.00
17	13-41	Shari D. Burgess	432/665	95.08

LATITUDE 39 - 35 - 00  
LONGITUDE 80 - 42 - 30

West Virginia Coordinate System of 1927, North Zone  
based upon Differential GPS Measurements.  
Well No. Trader Unit 2H Top Hole coordinates are  
N: 384,191.99' Latitude: 39°32'53.39"  
E: 1,649,252.52' Longitude: 80°44'37.90"  
Bottom Hole coordinates are  
N: 390,111.44' Latitude: 39°33'51.79"  
E: 1,648,470.36' Longitude: 80°44'48.94"  
UTM Zone 17, NAD 1983  
Top Hole Coordinates Bottom Hole Coordinates  
N: 4,377,650.164m N: 4,379,449.589m  
E: 522,022.543m E: 521,754.215m  
Plat orientation and corner and well references are based upon the grid north meridian.  
Well location references are based upon the magnetic meridian.

Leases	
A	Pamela Ann Palmer Emch
B	BRC Appalachian Minerals I, LLC
C	William R. Stalnaker
D	David E. Bowyer
E	Dianne K. Howell
F	Melinda Debner
G	Acropolis, Inc.
H	Acropolis, Inc.
I	Acropolis, Inc.
J	Linda Carol Gadd Leatham
K	Dean H. Bucher
L	P & P Fujimo, LLC
M	Melody Rea Posey

Notes:  
Well No. Trader Unit 2H  
UTM Zone 17, NAD 1927  
Top Hole Coordinates  
N: 14,361,625.18'  
E: 1,712,620.89'  
Point of Entry Coordinates  
N: 14,362,780.23'  
E: 1,713,363.56'  
Bottom Hole Coordinates  
N: 14,367,528.77'  
E: 1,711,740.33'

	Bearing	Dist.
L1	S 83°33' E	1,559.3'
L2	S 10°42' W	766.2'
L3	S 25°25' W	1,849.8'
L4	S 69°18' W	976.6'
L5	N 33°42' E	1,373.7'

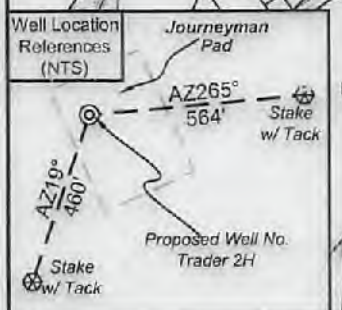

I, the undersigned, hereby certify that this plat is correct to the best of my knowledge and belief and shows all the information required by law and the rules issued and prescribed by the Department of Environmental Protection.

*Bradley D. Miller*  
Bradley D. Miller, P.S. 2167

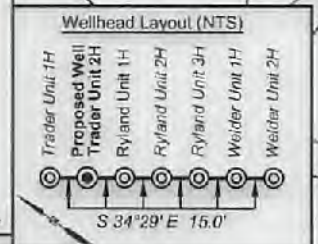
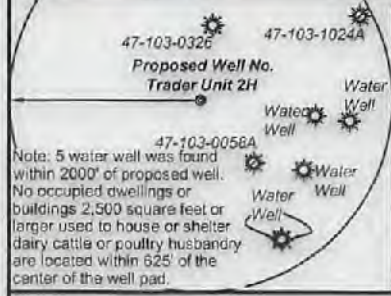

Legend

- Proposed gas well
- Monument, as noted
- Existing Well, as noted
- Digitized Well, as noted
- Creek or Drain
- Road
- Railroad
- Surface boundary (approx.)
- Interior surface tracts (approx.)

FILE NO: 133-34-G-18  
DRAWING NO: Trader 2H Well Plat  
SCALE: 1" = 2000'  
MINIMUM DEGREE OF ACCURACY: Submeter  
PROVEN SOURCE OF ELEVATION: CORS, Monroe County, OH

STATE OF WEST VIRGINIA  
DEPARTMENT OF ENVIRONMENTAL PROTECTION  
OIL AND GAS DIVISION

DATE: October 25 2021  
OPERATOR'S WELL NO. Trader Unit 2H  
API WELL NO  
47 - 103 - 0346016A  
STATE COUNTY PERMIT

WELL TYPE:  OIL  GAS  LIQUID INJECTION  WASTE DISPOSAL  
(IF GAS) PRODUCTION:  STORAGE  DEEP  SHALLOW

LOCATION: ELEVATION: Existing 1,175' Proposed 1,154' WATERSHED: Fishing Creek QUADRANGLE: Pine Grove  
DISTRICT: Green Antero Resources COUNTY: Wayne DATE: 11/05/2021  
SURFACE OWNER: Corporation ACREAGE: 47.5 537,11875; 47.5; 60.75; 35; 33;  
ROYALTY OWNER: Pamela Ann Palmer Emch; William R. Stalnaker; David E. Bowyer; Acropolis, Inc. (3) LEASE NO: ACREAGE: 45.5; 22; 50; 1.6

PROPOSED WORK:  DRILL  CONVERT  DRILL DEEPER  FRACTURE OR STIMULATE  PLUG OFF OLD FORMATION  
 PERFORATE NEW FORMATION  OTHER PHYSICAL CHANGE IN WELL (SPECIFY)  
 PLUG AND ABANDON  CLEAN OUT AND REPLUG TARGET FORMATION: Marcellus Shale ESTIMATED DEPTH: 7,400' TVD 14,400' MD

WELL OPERATOR: Antero Resources Corporation DESIGNATED AGENT: Dianna Stamper - CT Corporation System  
ADDRESS: 1615 Wynkoop Street ADDRESS: 5400 D Big Tyler Road  
Denver, CO 80202 Charleston, WV 25313



RECEIVED  
Office of Oil and Gas  
SEP 27 2021  
WV Department of  
Environmental Protection

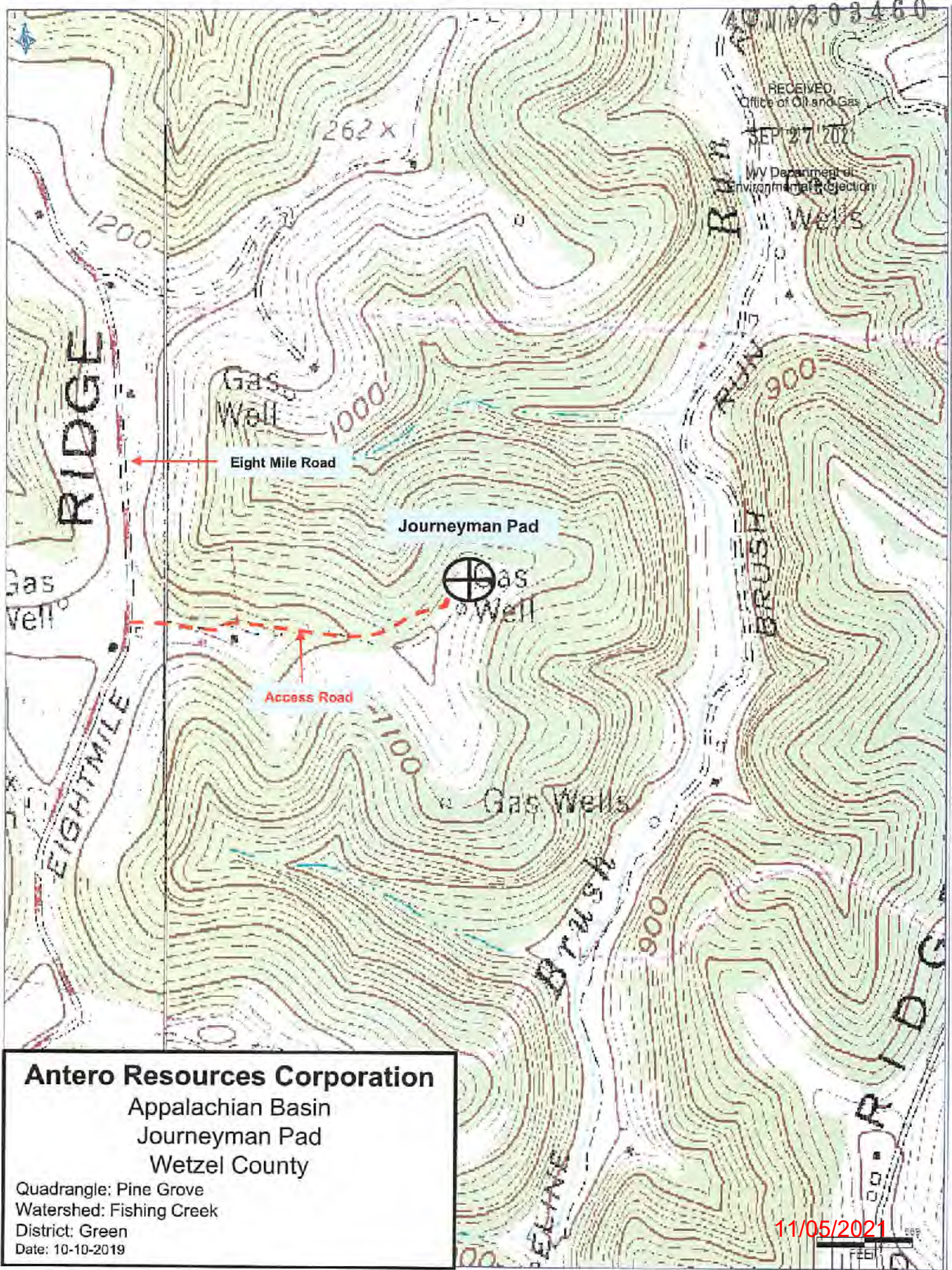

**Antero Resources Corporation**  
Appalachian Basin  
Journeyman Pad  
Wetzel County

Quadrangle: Pine Grove  
Watershed: Fishing Creek  
District: Green  
Date: 10-10-2019

11/05/2021

