

**Antero Resources**  
**Well No. Ryland 3H**  
**As-Drilled**  
 Antero Resources Corporation



Sheet 1 of 2

9,993' to Top Hole

4,580' to Bottom Hole

TOP HOLE LATITUDE 39 - 35 - 00  
 BTM HOLE LATITUDE 39 - 32 - 30

LONGITUDE 80 - 42 - 30

12,847' to Top Hole

**Notes**  
 West Virginia Coordinate System of 1927, North Zone based upon Differential GPS Measurements. Well No. Ryland Unit 3H Top Hole coordinates are  
 N: 384,154.68" Latitude: 39°32'53.03"  
 E: 1,649,277.71" Longitude: 80°44'37.57"  
 Bottom Hole coordinates are  
 N: 376,662.07" Latitude: 39°31'39.70"  
 E: 1,654,590.01" Longitude: 80°43'28.46"  
 UTM Zone 17, NAD 1983  
 Top Hole Coordinates Bottom Hole Coordinates  
 N: 4,377,638.925m N: 4,375,383.297m  
 E: 522,030.407m E: 523,686.877m  
 Plat orientation and corner and well references are based upon the grid north meridian.  
 Well location references are based upon the magnetic meridian.

Ryland Unit 3H As-Drilled POE Coordinates West Virginia Coordinate System of 1927, North Zone

N: 385,657.42"  
 E: 1,651,598.48"  
 Latitude: 39°33'08.20"  
 Longitude: 80°44'08.21"  
 UTM Zone 17, NAD 1983  
 N: 4,378,108.568m  
 E: 522,729.834m

	Bearing	Dist.
L1	S 82°19' E	1,588.9'
L2	S 08°26' W	798.8'
L3	S 24°13' W	1,873.1'
L4	S 66°42' W	967.2'

Top Hole Coordinates, As-drilled data, and information was provided by Antero Resources Corporation. Allegheny Surveys Inc. (ASI) is not certifying the data and information provided. ASI is not responsible for any errors or inaccuracies with the data and information that has been provided.

I, the undersigned, hereby certify that this plat is correct to the best of my knowledge and belief and shows all the information required by law and the rules issued and prescribed by the Department of Environmental Protection.

*Bradley D. Miller*  
 Bradley D. Miller, P.S. 2167

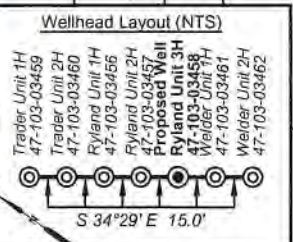

**Legend**

- Proposed gas well
- ⊗ Monument, as noted
- ⊙ Existing Well, as noted
- ⊙ Digitized Well, as noted
- Creek or Drain
- Road
- Railroad
- Surface boundary (approx.)
- Interior surface tracts (approx.)

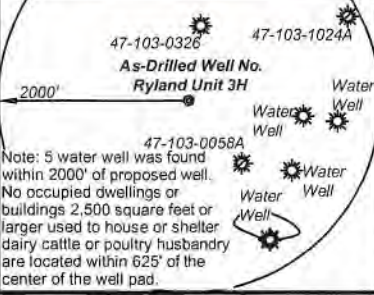

FILE NO: 278-34-G-17  
 DRAWING NO: Ryland 3H As-Drilled  
 SCALE: 1" = 1500'  
 MINIMUM DEGREE OF ACCURACY: Submeter  
 PROVEN SOURCE OF ELEVATION: CORS, Monroe County, OH

**STATE OF WEST VIRGINIA**  
 DEPARTMENT OF ENVIRONMENTAL PROTECTION  
**OIL AND GAS DIVISION**

DATE: December 6 2022  
 OPERATOR'S WELL NO. Ryland Unit 3H  
 API WELL NO  
 47 - 103 - 03458  
 STATE COUNTY PERMIT

WELL TYPE:  OIL  GAS  LIQUID INJECTION  WASTE DISPOSAL  
 (IF GAS) PRODUCTION:  STORAGE  DEEP  SHALLOW

LOCATION: ELEVATION: As-Built 1,154' WATERSHED: Fishing Creek QUADRANGLE: Pine Grove  
 DISTRICT: Green Antero Resources Corporation COUNTY: Wetzel 03/17/2023  
 SURFACE OWNER: Corporation Karen B. Mason; Waco Oil & Gas Company, Inc.; BRC Appalachian Minerals I, LLC; Barbara Barker, et vir; Debra L. Brown (2); Kevin Goff, et ux; Shibben Estates, Inc.; ACREAGE: 47.5 47.5; 537.11875; 50.5; 26; 26; 24;  
 ROYALTY OWNER: Pamela Ann Palmer Emch; William R. Stalnaker; Ridgetop Capital IV, LP; Lydia Sims; LEASE NO: ACREAGE: 20.65; 72; 89; 35.5

PROPOSED WORK:  DRILL  CONVERT  DRILL DEEPER  FRACTURE OR STIMULATE  PLUG OFF OLD FORMATION  
 PERFORATE NEW FORMATION  OTHER PHYSICAL CHANGE IN WELL (SPECIFY) As-Drilled  
 PLUG AND ABANDON  CLEAN OUT AND REPLUG TARGET FORMATION: Marcellus Shale ESTIMATED DEPTH: 7,033' TVD 17,325' MD

WELL OPERATOR: Antero Resources Corporation DESIGNATED AGENT: Kevin Ellis  
 ADDRESS: 1615 Wynkoop Street ADDRESS: 535 White Oaks Blvd.  
 Denver, CO 80202 Bridgeport, WV 26330



**Antero Resources**  
**Well No. Ryland 3H**  
**As-Drilled**  
 Antero Resources Corporation



Leases	
A	Pamela Ann Palmer Emch
B	BRC Appalachian Minerals I, LLC
C	William R. Stalnaker
D	Stone Hill Holdings, LLC
E	Ridgetop Capital IV, LP
F	Debra L. Brown
G	Debra L. Brown
H	Lydia Sims
I	Karen B. Mason
J	Shiben Estates, Inc.
K	Kevin Goff, et ux
L	Barbara Barker, et vir
M	BRC Appalachian Minerals I, LLC
N	Barbara Barker, et vir
O	Carl F. Fellows
P	Waco Oil & Gas Company Inc.
Q	Joan B. Hoge Trust

ID	TM/Par	Owner	Bk/Pg	Acres
1	16-26	Antero Resources Corporation	474/713	47.50
2	16-25	Antero Resources Corporation	474/713	39.00
3	17-22	Perry D. Bucher	411/759	37.65
4	17-58	Pennie Baker	411/735	42.41
5	17-56	Pennie R. & Richard K. Baker	366/273	1.63
6	17-15.1	Douglas Alan & Shirley Joann Bucher	442/718	12.41
7	17-15.7	Jeremy & Terry Bucher	365/108	7.37
8	17-15.8	Ross William Bucher, Jr.	411/765	0.37
9	17-59	Pennie Baker	446/344	12.50
10	17-60	Ross Bucher	411/765	79.00
11	17-23	Michael Steven Blinkman	461/443	40.10
12	17-16	James & Andrea Sell	417/40	25.75
13	17-24	Nola Parks	417/35	26.50
14	17-25	Nola Parks & Jonathan Sivert	417/35	25.00
15	17-33	Debra Lynn Brown	332/480	26.00
16	17-44	Debra Lynn Brown	362/474	26.00
17	17-34	Debra Lynn Brown	332/480	20.00
18	17-46	George David Sell	351/473	4.00
19	17-43	George David Sell, et al	206/184	124.50
20	17-45	George D. Sell, et al	W53/228	20.20
21	17-35	Alfred Raymond Furbee, Sr. & Olive Gay Brown	333/638	60.00
22	20-2	George David Sell	351/473	10.00
23	17-30	Alfred Raymond Furbee, Sr. & Olive Gay Brown	333/638	11.70
24	20-9	George David Sell	351/473	48.00
25	20-4	Nola J. Parks & Gloria C. Higgins	A100/689	25.50
26	20-5	Debbie Brown, et al	A96/679	4.00
27	20-13	Dallison Lumber Inc.	440/243	208.00

FILE NO: 278-34-G-17  
 DRAWING NO: Ryland 3H As-Drilled  
 SCALE: 1" = 1500'  
 MINIMUM DEGREE OF ACCURACY:  
 Submeter  
 PROVEN SOURCE OF ELEVATION:  
 CORS, Monroe County, OH



DATE: December 6 20 22  
 OPERATOR'S WELL NO. Ryland Unit 3H  
 API WELL NO  
 47 - 103 - 03458  
 STATE COUNTY PERMIT

WELL TYPE:  OIL  GAS  LIQUID INJECTION  WASTE DISPOSAL  
 (IF GAS) PRODUCTION:  STORAGE  DEEP  SHALLOW

LOCATION: ELEVATION: As-Built 1,154' WATERSHED: Fishing Creek QUADRANGLE: Pine Grove  
 DISTRICT: Green Antero Resources Corporation COUNTY: Wetzel 03/17/2023  
 SURFACE OWNER: Corporation Karen B. Mason; Waco Oil & Gas Company, Inc.; BRC Appalachian Minerals I, LLC; Barbara Barker, et vir; ACREAGE: 47.5 137.9125; 47.5; 537.11875; 50.5; 26; 26; 24;  
 ROYALTY OWNER: Pamela Ann Palmer Emch; William R. Stalnaker; Ridgetop Capital IV, LP; Lydia Sims; LEASE NO: ACREAGE: 20.65; 72; 89; 35.5  
 PROPOSED WORK:  DRILL  CONVERT  DRILL DEEPER  FRACTURE OR STIMULATE  PLUG OFF OLD FORMATION  
 PERFORATE NEW FORMATION  OTHER PHYSICAL CHANGE IN WELL (SPECIFY) As-Drilled 7,033' TVD  
 PLUG AND ABANDON  CLEAN OUT AND REPLUG TARGET FORMATION: Marcellus Shale ESTIMATED DEPTH: 17,325' MD

WELL OPERATOR: Antero Resources Corporation DESIGNATED AGENT: Kevin Ellis  
 ADDRESS: 1615 Wynkoop Street ADDRESS: 535 White Oaks Blvd.  
 Denver, CO 80202 Bridgeport, WV 26330