

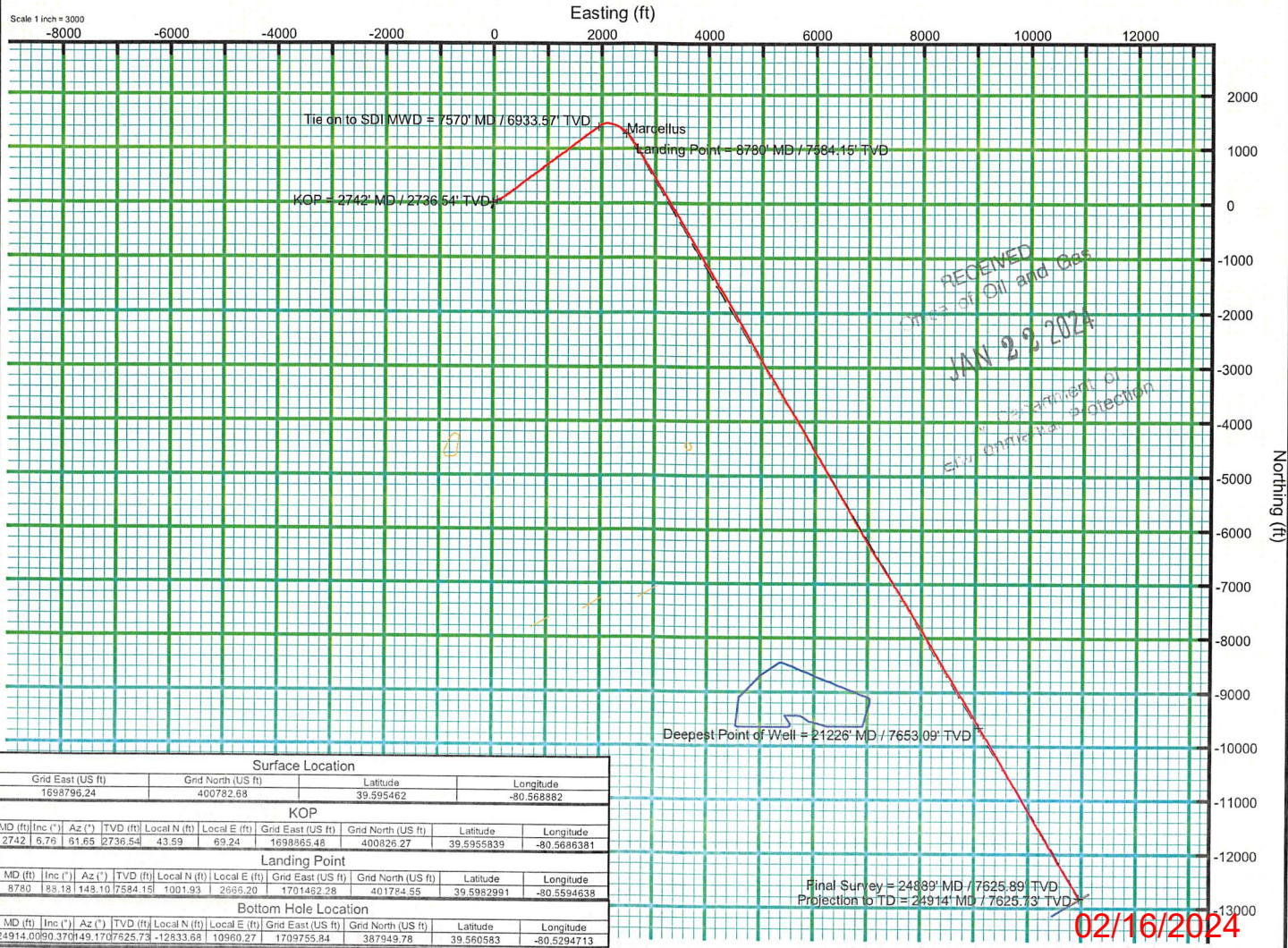

KB Elevation=1458 FT  
 Ground Elevation=1430 FT  
 All Survey Measurements were taken from KB Elevation

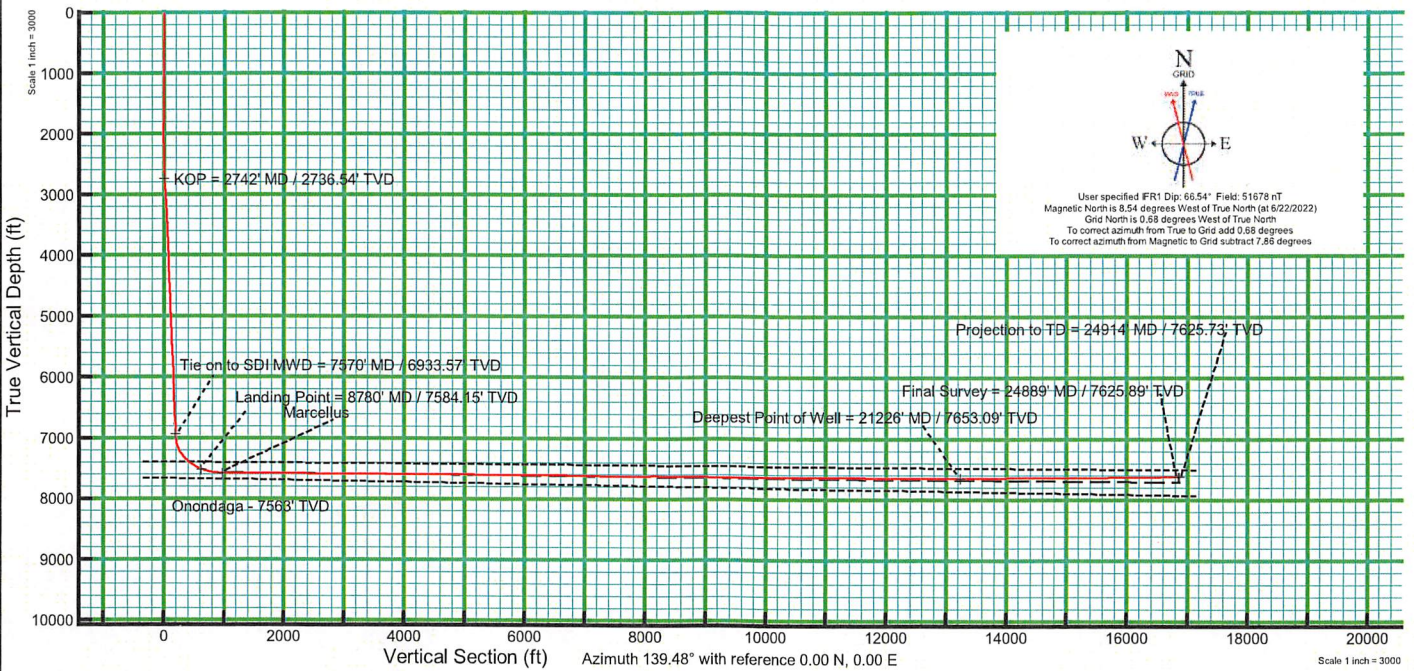

Surface Location									
Grid East (US ft)	Grid North (US ft)	Latitude	Longitude						
1698796.24	400782.68	39.595462	-80.568862						
KOP									
MD (ft)	Incl. (°)	Az. (°)	TVD (ft)	Local N (ft)	Local E (ft)	Grid East (US ft)	Grid North (US ft)	Latitude	Longitude
2742	6.76	61.65	2736.54	43.59	69.24	1698965.48	400826.27	39.5955839	-80.5686381
Landing Point									
MD (ft)	Incl. (°)	Az. (°)	TVD (ft)	Local N (ft)	Local E (ft)	Grid East (US ft)	Grid North (US ft)	Latitude	Longitude
8780	18.18	148.10	7584.15	1001.93	2666.20	1701462.28	401784.55	39.5982991	-80.5594638
Bottom Hole Location									
MD (ft)	Incl. (°)	Az. (°)	TVD (ft)	Local N (ft)	Local E (ft)	Grid East (US ft)	Grid North (US ft)	Latitude	Longitude
24914.0090	37.0149	170.7625	73.12833	6.68	10960.27	1709755.84	387949.78	39.560583	-80.5294713



# Actual Wellpath Report

BIG 245 114H AWP Proj: 24914'

Page 1 of 14

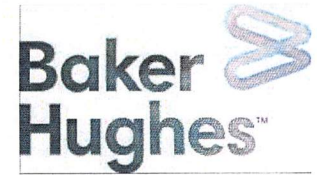

## REFERENCE WELLPATH IDENTIFICATION

Operator	EQT PRODUCTION COMPANY	Well	BIG 245 114H (L-004464)
Field	Wetzel	API	47-103-03446-00-00
Facility	Big 245 Pad	Wellbore	BIG 245 114H AWB
Slot	Slot #114		

## REPORT SETUP INFORMATION

Projection System	NAD27 / Lambert West Virginia SP, Northern Zone (4701), US feet	Software System	WellArchitect® 6.0
North Reference	Grid	User	Manajohj
Scale	0.999941	Report Generated	7/20/2022 at 12:06:11 PM
Convergence at slot	0.68° West	Database	WA_MPL_EASTERNUS_Defn

## WELLPATH LOCATION

	Local coordinates		Grid coordinates		Geographic coordinates	
	North[ft]	East[ft]	Easting[US ft]	Northing[US ft]	Latitude	Longitude
Slot Location	59.02	10.96	1698796.24	400782.68	39°35'43.6631"N	80°34'7.9750"W
Facility Reference Pt			1698785.28	400723.66	39°35'43.0785"N	80°34'8.1061"W
Field Reference Pt			1688243.35	385255.46	39°33'8.9436"N	80°36'20.3370"W

## WELLPATH DATUM

Calculation method	Minimum curvature	Patterson 292 (RKB) to Facility Vertical Datum	1458.00ft
Horizontal Reference Pt	Slot	Patterson 292 (RKB) to Mean Sea Level	1458.00ft
Vertical Reference Pt	Patterson 292 (RKB)	Patterson 292 (RKB) to Ground Level at Slot (Slot #114)	28.00ft
MD Reference Pt	Patterson 292 (RKB)	Section Origin	N 0.00, E 0.00 ft
Field Vertical Reference	Mean Sea Level	Section Azimuth	139.48°

RECEIVED  
Office of Oil and Gas

JAN 22 2024

WV Department of  
Environmental Protection



RECEIVED  
Office of Oil and Gas

JAN 22 2024

WV Department of  
Environmental Protection

# Actual Wellpath Report

BIG 245 114H AWP Proj: 24914'

Page 2 of 14

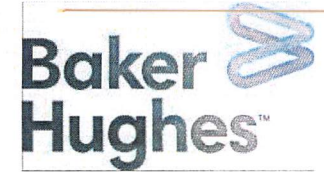

REFERENCE WELLPATH IDENTIFICATION			
Operator	EQT PRODUCTION COMPANY	Well	BIG 245 114H (L-004464)
Field	Wetzel	API	47-103-03446-00-00
Facility	Big 245 Pad	Wellbore	BIG 245 114H AWB
Slot	Slot #114		

## WELLPATH DATA (296 stations) † = interpolated, ‡ = extrapolated station

MD [ft]	Inclination [°]	Azimuth [°]	TVD [ft]	Vert Sect [ft]	North [ft]	East [ft]	Grid East [US ft]	Grid North [US ft]	Latitude	Longitude	Closure Dist [ft]	Closure Dir [°]	DLS [°/100ft]	Build Rate [°/100ft]	Turn Rate [°/100ft]
0.00†	0.000	234.660	0.00	0.00	0.00	0.00	1698796.24	400782.68	39°35'43.6631"N	80°34'7.9750"W	0.00	0.000	0.00	0.00	0.00
28.00	0.000	234.660	28.00	0.00	0.00	0.00	1698796.24	400782.68	39°35'43.6631"N	80°34'7.9750"W	0.00	0.000	0.00	0.00	0.00
115.00	0.350	234.660	115.00	-0.02	-0.15	-0.22	1698796.02	400782.53	39°35'43.6616"N	80°34'7.9778"W	0.27	234.660	0.40	0.40	0.00
215.00	0.360	231.610	215.00	-0.06	-0.53	-0.71	1698795.53	400782.15	39°35'43.6579"N	80°34'7.9840"W	0.89	233.578	0.02	0.01	-3.05
315.00	0.540	253.440	314.99	-0.27	-0.85	-1.41	1698794.83	400781.83	39°35'43.6545"N	80°34'7.9929"W	1.65	238.773	0.25	0.18	21.83
415.00	0.630	261.050	414.99	-0.75	-1.07	-2.40	1698793.84	400781.61	39°35'43.6522"N	80°34'8.0056"W	2.63	245.920	0.12	0.09	7.61
515.00	0.630	265.390	514.98	-1.36	-1.20	-3.50	1698792.74	400781.48	39°35'43.6508"N	80°34'8.0195"W	3.70	250.990	0.05	0.00	4.34
615.00	0.620	271.970	614.98	-2.04	-1.23	-4.58	1698791.66	400781.45	39°35'43.6504"N	80°34'8.0334"W	4.75	254.982	0.07	-0.01	6.58
715.00	0.610	268.210	714.97	-2.74	-1.23	-5.66	1698790.58	400781.45	39°35'43.6503"N	80°34'8.0471"W	5.79	257.753	0.04	-0.01	-3.76
815.00	0.620	269.230	814.97	-3.42	-1.25	-6.73	1698789.51	400781.43	39°35'43.6500"N	80°34'8.0608"W	6.85	259.463	0.01	0.01	1.02
915.00	0.280	282.370	914.96	-3.96	-1.21	-7.51	1698788.73	400781.47	39°35'43.6503"N	80°34'8.0708"W	7.61	260.871	0.35	-0.34	13.14
1015.00	0.180	231.800	1014.96	-4.16	-1.25	-7.87	1698788.37	400781.43	39°35'43.6498"N	80°34'8.0754"W	7.97	260.966	0.22	-0.10	-50.57
1115.00	0.180	248.220	1114.96	-4.22	-1.41	-8.14	1698788.10	400781.27	39°35'43.6483"N	80°34'8.0788"W	8.26	260.195	0.05	0.00	16.42
1215.00	0.080	233.650	1214.96	-4.28	-1.51	-8.34	1698787.90	400781.17	39°35'43.6473"N	80°34'8.0814"W	8.48	259.763	0.10	-0.10	-14.57
1234.00	0.170	246.850	1233.96	-4.28	-1.53	-8.38	1698787.86	400781.15	39°35'43.6471"N	80°34'8.0818"W	8.52	259.682	0.49	0.47	69.47
1254.00	0.230	123.590	1253.96	-4.26	-1.56	-8.37	1698787.87	400781.12	39°35'43.6467"N	80°34'8.0817"W	8.52	259.450	1.77	0.30	-616.30
1285.00	0.340	128.630	1284.96	-4.11	-1.65	-8.25	1698787.99	400781.03	39°35'43.6458"N	80°34'8.0802"W	8.41	258.681	0.36	0.35	16.26
1316.00	0.490	128.850	1315.96	-3.88	-1.79	-8.08	1698788.17	400780.89	39°35'43.6445"N	80°34'8.0779"W	8.27	257.488	0.48	0.48	0.71
1347.00	0.440	130.690	1346.96	-3.64	-1.95	-7.88	1698788.36	400780.73	39°35'43.6429"N	80°34'8.0754"W	8.12	256.085	0.17	-0.16	5.94
1379.00	0.340	135.040	1378.96	-3.42	-2.10	-7.72	1698788.52	400780.58	39°35'43.6415"N	80°34'8.0733"W	8.00	254.785	0.33	-0.31	13.59
1411.00	0.070	201.510	1410.96	-3.32	-2.19	-7.66	1698788.58	400780.49	39°35'43.6406"N	80°34'8.0726"W	7.97	254.080	1.00	-0.84	207.72
1442.00	0.170	323.550	1441.96	-3.35	-2.17	-7.70	1698788.54	400780.51	39°35'43.6408"N	80°34'8.0730"W	7.99	254.281	0.70	0.32	393.68
1473.00	0.600	317.610	1472.96	-3.56	-2.01	-7.83	1698788.41	400780.67	39°35'43.6424"N	80°34'8.0748"W	8.09	255.613	1.39	1.39	-19.16
1505.00	0.940	322.100	1504.95	-3.99	-1.68	-8.11	1698788.13	400781.00	39°35'43.6456"N	80°34'8.0783"W	8.28	258.304	1.08	1.06	14.03
1536.00	1.210	322.960	1535.95	-4.57	-1.22	-8.46	1698787.78	400781.46	39°35'43.6501"N	80°34'8.0829"W	8.55	261.818	0.87	0.87	2.77
1567.00	1.420	324.090	1566.94	-5.28	-0.64	-8.88	1698787.36	400782.04	39°35'43.6557"N	80°34'8.0884"W	8.91	265.853	0.68	0.68	3.65
1599.00	1.700	326.300	1598.93	-6.15	0.07	-9.38	1698786.86	400782.75	39°35'43.6627"N	80°34'8.0948"W	9.38	270.440	0.89	0.87	6.91
1630.00	1.830	327.380	1629.91	-7.10	0.87	-9.90	1698786.34	400783.55	39°35'43.6706"N	80°34'8.1016"W	9.94	275.031	0.43	0.42	3.48
1661.00	1.790	330.470	1660.90	-8.06	1.71	-10.41	1698785.83	400784.39	39°35'43.6788"N	80°34'8.1082"W	10.55	279.330	0.34	-0.13	9.97
1693.00	1.450	334.390	1692.89	-8.94	2.51	-10.83	1698785.41	400785.19	39°35'43.6867"N	80°34'8.1137"W	11.11	283.050	1.12	-1.06	12.25

JAN 22 2024

WV Department of  
Environmental Protection

# Actual Wellpath Report

BIG 245 114H AWP Proj: 24914'

Page 3 of 14

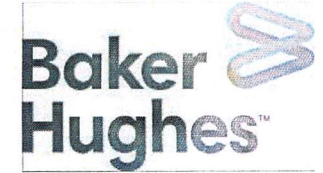

## REFERENCE WELLPATH IDENTIFICATION

Operator	EQT PRODUCTION COMPANY	Well	BIG 245 114H (L-004464)
Field	Wetzel	API	47-103-03446-00-00
Facility	Big 245 Pad	Wellbore	BIG 245 114H AWB
Slot	Slot #114		

## WELLPATH DATA (296 stations)

MD [ft]	Inclination [°]	Azimuth [°]	TVD [ft]	Vert Sect [ft]	North [ft]	East [ft]	Grid East [US ft]	Grid North [US ft]	Latitude	Longitude	Closure Dist [ft]	Closure Dir [°]	DLS [°/100ft]	Build Rate [°/100ft]	Turn Rate [°/100ft]
1724.00	1.170	344.270	1723.88	-9.61	3.17	-11.08	1698785.16	400785.85	39°35'43.6931"N	80°34'8.1171"W	11.53	285.953	1.16	-0.90	31.87
1755.00	0.990	353.550	1754.87	-10.12	3.74	-11.20	1698785.04	400786.42	39°35'43.6988"N	80°34'8.1186"W	11.81	288.462	0.81	-0.58	29.94
1787.00	0.850	355.040	1786.87	-10.54	4.25	-11.25	1698784.99	400786.93	39°35'43.7038"N	80°34'8.1194"W	12.03	290.695	0.44	-0.44	4.66
1816.00	0.720	1.040	1815.87	-10.85	4.65	-11.27	1698784.98	400787.33	39°35'43.7077"N	80°34'8.1196"W	12.19	292.413	0.53	-0.45	20.69
1848.00	0.650	13.620	1847.86	-11.11	5.02	-11.22	1698785.02	400787.70	39°35'43.7115"N	80°34'8.1191"W	12.29	294.122	0.52	-0.22	39.31
1879.00	0.680	34.770	1878.86	-11.26	5.35	-11.07	1698785.17	400788.03	39°35'43.7147"N	80°34'8.1173"W	12.30	295.771	0.79	0.10	68.23
1910.00	1.030	46.610	1909.86	-11.32	5.69	-10.77	1698785.48	400788.37	39°35'43.7181"N	80°34'8.1134"W	12.18	297.852	1.26	1.13	38.19
1941.00	1.650	49.060	1940.85	-11.34	6.17	-10.23	1698786.01	400788.85	39°35'43.7229"N	80°34'8.1066"W	11.94	301.115	2.01	2.00	7.90
1973.00	2.200	51.580	1972.83	-11.32	6.86	-9.40	1698786.84	400789.54	39°35'43.7298"N	80°34'8.0961"W	11.63	306.115	1.74	1.72	7.88
2004.00	2.920	50.490	2003.80	-11.28	7.73	-8.32	1698787.92	400790.41	39°35'43.7385"N	80°34'8.0825"W	11.36	312.883	2.33	2.32	-3.52
2036.00	3.670	51.930	2035.75	-11.22	8.88	-6.89	1698789.35	400791.56	39°35'43.7501"N	80°34'8.0643"W	11.24	322.202	2.36	2.34	4.50
2066.00	4.430	51.390	2065.67	-11.14	10.19	-5.22	1698791.02	400792.87	39°35'43.7633"N	80°34'8.0433"W	11.45	332.861	2.54	2.53	-1.80
2098.00	5.240	51.030	2097.56	-11.06	11.88	-3.12	1698793.12	400794.56	39°35'43.7802"N	80°34'8.0167"W	12.29	345.276	2.53	2.53	-1.12
2129.00	5.840	50.310	2128.41	-11.00	13.78	-0.81	1698795.43	400796.46	39°35'43.7992"N	80°34'7.9874"W	13.80	356.642	1.95	1.94	-2.32
2161.00	6.650	50.120	2160.22	-10.96	16.01	1.87	1698798.11	400798.69	39°35'43.8216"N	80°34'7.9536"W	16.12	6.649	2.53	2.53	-0.59
2192.00	7.030	50.530	2191.00	-10.90	18.37	4.71	1698800.95	400801.04	39°35'43.8452"N	80°34'7.9177"W	18.96	14.378	1.24	1.23	1.32
2224.00	7.330	52.850	2222.75	-10.75	20.84	7.85	1698804.09	400803.52	39°35'43.8700"N	80°34'7.8780"W	22.27	20.630	1.30	0.94	7.25
2256.00	7.420	56.620	2254.49	-10.37	23.21	11.20	1698807.44	400805.89	39°35'43.8938"N	80°34'7.8355"W	25.77	25.756	1.54	0.28	11.78
2287.00	7.390	61.760	2285.23	-9.70	25.26	14.63	1698810.87	400807.94	39°35'43.9145"N	80°34'7.7920"W	29.19	30.076	2.14	-0.10	16.58
2319.00	7.510	66.150	2316.96	-8.66	27.08	18.35	1698814.59	400809.75	39°35'43.9329"N	80°34'7.7447"W	32.71	34.130	1.82	0.38	13.72
2351.00	7.720	68.120	2348.68	-7.37	28.72	22.26	1698818.50	400811.40	39°35'43.9496"N	80°34'7.6951"W	36.34	37.775	1.05	0.66	6.16
2445.00	7.660	70.870	2441.83	-3.07	33.13	34.04	1698830.28	400815.81	39°35'43.9945"N	80°34'7.5453"W	47.50	45.775	0.40	-0.06	2.93
2540.00	7.140	75.460	2536.04	1.83	36.69	45.73	1698841.97	400819.36	39°35'44.0311"N	80°34'7.3964"W	58.63	51.265	0.83	-0.55	4.83
2630.00	7.230	77.080	2625.33	6.90	39.36	56.67	1698852.91	400822.03	39°35'44.0587"N	80°34'7.2572"W	68.99	55.220	0.25	0.10	1.80
2710.00	6.570	69.750	2704.75	10.82	42.07	65.87	1698862.11	400824.74	39°35'44.0866"N	80°34'7.1400"W	78.16	57.436	1.37	-0.82	-9.16
2742.00	6.760	61.650	2736.54	11.85	43.59	69.24	1698865.48	400826.27	39°35'44.1021"N	80°34'7.0972"W	81.82	57.807	2.99	0.59	-25.31
2774.00	7.610	58.440	2768.29	12.58	45.60	72.71	1698868.94	400828.27	39°35'44.1223"N	80°34'7.0532"W	85.82	57.907	2.94	2.66	-10.03
2805.00	8.980	58.490	2798.96	13.28	47.94	76.52	1698872.75	400830.61	39°35'44.1459"N	80°34'7.0049"W	90.29	57.934	4.42	4.42	0.16
2837.00	9.870	60.610	2830.53	14.20	50.59	81.04	1698877.27	400833.26	39°35'44.1726"N	80°34'6.9476"W	95.53	58.026	2.98	2.78	6.63
2869.00	10.220	64.890	2862.04	15.48	53.14	86.00	1698882.23	400835.82	39°35'44.1984"N	80°34'6.8846"W	101.09	58.288	2.58	1.09	13.38



RECEIVED  
Office of Oil and Gas

JAN 22 2024

WV Department of  
Natural Resources

# Actual Wellpath Report

BIG 245 114H AWP Proj: 24914'

Page 4 of 14

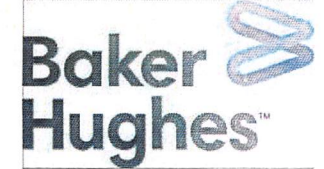

## REFERENCE WELLPATH IDENTIFICATION

Operator	EQT PRODUCTION COMPANY	Well	BIG 245 114H (L-004464)
Field	Wetzel	API	47-103-03446-00-00
Facility	Big 245 Pad	Wellbore	BIG 245 114H AWB
Slot	Slot #114		

## WELLPATH DATA (296 stations)

MD [ft]	Inclination [°]	Azimuth [°]	TVD [ft]	Vert Sect [ft]	North [ft]	East [ft]	Grid East [US ft]	Grid North [US ft]	Latitude	Longitude	Closure Dist [ft]	Closure Dir [°]	DLS [°/100ft]	Build Rate [°/100ft]	Turn Rate [°/100ft]
2901.00	10.340	65.870	2893.53	17.04	55.52	91.19	1698887.42	400838.19	39°35'44.2225"N	80°34'6.8187"W	106.76	58.667	0.66	0.37	3.06
2933.00	11.490	65.570	2924.95	18.74	58.01	96.71	1698892.95	400840.69	39°35'44.2478"N	80°34'6.7485"W	112.78	59.044	3.60	3.59	-0.94
2962.00	12.660	65.590	2953.31	20.42	60.52	102.24	1698898.47	400843.19	39°35'44.2732"N	80°34'6.6783"W	118.81	59.377	4.03	4.03	0.07
2993.00	13.650	65.510	2983.49	22.37	63.44	108.66	1698904.89	400846.11	39°35'44.3028"N	80°34'6.5967"W	125.82	59.723	3.19	3.19	-0.26
3087.00	15.140	64.590	3074.54	28.64	73.30	129.84	1698926.07	400855.98	39°35'44.4028"N	80°34'6.3276"W	149.10	60.553	1.60	1.59	-0.98
3180.00	16.780	62.650	3163.95	34.86	84.68	152.74	1698948.97	400867.36	39°35'44.5180"N	80°34'6.0369"W	174.64	60.994	1.85	1.76	-2.09
3275.00	18.240	58.540	3254.55	40.33	98.74	177.60	1698973.83	400881.42	39°35'44.6598"N	80°34'5.7215"W	203.21	60.927	2.01	1.54	-4.33
3369.00	19.290	55.860	3343.55	44.37	115.14	203.00	1698999.23	400897.81	39°35'44.8248"N	80°34'5.3995"W	233.38	60.440	1.45	1.12	-2.85
3459.00	20.000	55.410	3428.31	47.61	132.22	227.98	1699024.20	400914.89	39°35'44.9966"N	80°34'5.0831"W	263.54	59.888	0.81	0.79	-0.50
3554.00	21.250	55.020	3517.22	50.95	151.31	255.46	1699051.68	400933.98	39°35'45.1885"N	80°34'4.7350"W	296.91	59.361	1.32	1.32	-0.41
3648.00	22.680	54.880	3604.40	54.30	171.50	284.24	1699080.46	400954.17	39°35'45.3914"N	80°34'4.3704"W	331.97	58.894	1.52	1.52	-0.15
3742.00	26.130	54.830	3689.99	57.94	193.86	315.99	1699112.21	400976.53	39°35'45.6161"N	80°34'3.9682"W	370.72	58.471	3.67	3.67	-0.05
3837.00	29.090	54.860	3774.16	62.06	219.21	351.99	1699148.21	401001.87	39°35'45.8708"N	80°34'3.5123"W	414.66	58.087	3.12	3.12	0.03
3932.00	30.420	53.440	3856.63	65.88	246.83	390.19	1699186.41	401029.49	39°35'46.1482"N	80°34'3.0284"W	461.71	57.684	1.58	1.40	-1.49
4026.00	32.310	52.010	3936.89	68.63	276.47	429.11	1699225.32	401059.13	39°35'46.4457"N	80°34'2.5358"W	510.46	57.207	2.16	2.01	-1.52
4118.00	32.930	50.840	4014.38	70.31	307.39	467.88	1699264.09	401090.05	39°35'46.7559"N	80°34'2.0453"W	559.82	56.695	0.96	0.67	-1.27
4212.00	32.010	51.250	4093.69	71.69	339.12	507.12	1699303.33	401121.78	39°35'47.0741"N	80°34'1.5489"W	610.06	56.229	1.01	-0.98	0.44
4307.00	32.330	52.460	4174.10	73.79	370.36	546.90	1699343.10	401153.02	39°35'47.3875"N	80°34'1.0455"W	660.50	55.894	0.76	0.34	1.27
4402.00	33.170	53.830	4254.00	77.08	401.18	588.02	1699384.23	401183.83	39°35'47.6968"N	80°34'0.5249"W	711.84	55.696	1.18	0.88	1.44
4497.00	32.440	54.320	4333.85	81.20	431.38	629.70	1699425.90	401214.03	39°35'48.0002"N	80°33'59.9971"W	763.29	55.587	0.82	-0.77	0.52
4593.00	31.790	54.510	4415.16	85.59	461.07	671.20	1699467.40	401243.73	39°35'48.2985"N	80°33'59.4714"W	814.31	55.513	0.69	-0.68	0.20
4688.00	32.170	55.000	4495.74	90.22	490.11	712.29	1699508.49	401272.76	39°35'48.5903"N	80°33'58.9510"W	864.62	55.469	0.48	0.40	0.52
4783.00	32.830	55.430	4575.86	95.32	519.23	754.22	1699550.41	401301.88	39°35'48.8830"N	80°33'58.4199"W	915.66	55.455	0.74	0.69	0.45
4878.00	32.790	55.100	4655.71	100.51	548.56	796.52	1699592.71	401331.20	39°35'49.1778"N	80°33'57.8840"W	967.14	55.445	0.19	-0.04	-0.35
4974.00	31.600	52.800	4736.95	104.51	578.64	837.88	1699634.07	401361.28	39°35'49.4799"N	80°33'57.3602"W	1018.26	55.371	1.78	-1.24	-2.40
5070.00	31.400	51.310	4818.80	106.77	609.48	877.43	1699673.62	401392.12	39°35'49.7893"N	80°33'56.8597"W	1068.34	55.215	0.84	-0.21	-1.55
5165.00	31.730	50.690	4899.75	108.08	640.77	916.08	1699712.26	401423.42	39°35'50.1031"N	80°33'56.3708"W	1117.94	55.028	0.49	0.35	-0.65
5260.00	31.230	52.270	4980.77	109.81	671.67	954.88	1699751.07	401454.31	39°35'50.4130"N	80°33'55.8797"W	1167.45	54.877	1.02	-0.53	1.66
5354.00	32.040	53.340	5060.80	112.67	701.47	994.16	1699790.34	401484.11	39°35'50.7121"N	80°33'55.3825"W	1216.72	54.793	1.05	0.86	1.14
5450.00	32.510	53.800	5141.97	116.33	731.91	1035.41	1699831.58	401514.55	39°35'51.0178"N	80°33'54.8603"W	1267.97	54.744	0.55	0.49	0.48



RECEIVED  
Office of Oil and Gas

JAN 22 2024

WV Department of  
Environmental Protection

# Actual Wellpath Report

BIG 245 114H AWP Proj: 24914'

Page 5 of 14



REFERENCE WELLPATH IDENTIFICATION			
Operator	EQT PRODUCTION COMPANY	Well	BIG 245 114H (L-004464)
Field	Wetzel	API	47-103-03446-00-00
Facility	Big 245 Pad	Wellbore	BIG 245 114H AWB
Slot	Slot #114		

## WELLPATH DATA (296 stations)

MD [ft]	Inclination [°]	Azimuth [°]	TVD [ft]	Vert Sect [ft]	North [ft]	East [ft]	Grid East [US ft]	Grid North [US ft]	Latitude	Longitude	Closure Dist [ft]	Closure Dir [°]	DLS [°/100ft]	Build Rate [°/100ft]	Turn Rate [°/100ft]
5545.00	32.350	52.630	5222.15	119.65	762.42	1076.21	1699872.38	401545.05	39°35'51.3240"N	80°33'54.3437"W	1318.90	54.685	0.68	-0.17	-1.23
5640.00	32.560	52.360	5302.32	122.33	793.46	1116.65	1699912.82	401576.09	39°35'51.6355"N	80°33'53.8318"W	1369.85	54.604	0.27	0.22	-0.28
5734.00	32.080	52.880	5381.75	125.08	823.97	1156.58	1699952.75	401606.60	39°35'51.9417"N	80°33'53.3264"W	1420.07	54.533	0.59	-0.51	0.55
5828.00	31.710	54.220	5461.56	128.61	853.48	1196.53	1699992.70	401636.10	39°35'52.2380"N	80°33'52.8206"W	1469.73	54.500	0.85	-0.39	1.43
5923.00	32.390	54.790	5542.08	133.02	882.74	1237.57	1700033.74	401665.37	39°35'52.5321"N	80°33'52.3007"W	1520.14	54.500	0.78	0.72	0.60
6019.00	32.280	54.420	5623.20	137.61	912.49	1279.43	1700075.59	401695.11	39°35'52.8309"N	80°33'51.7705"W	1571.49	54.504	0.24	-0.11	-0.39
6111.00	33.040	54.470	5700.65	141.91	941.35	1319.82	1700115.98	401723.98	39°35'53.1209"N	80°33'51.2589"W	1621.14	54.502	0.83	0.83	0.05
6207.00	33.350	54.510	5780.98	146.50	971.88	1362.61	1700158.76	401754.50	39°35'53.4276"N	80°33'50.7170"W	1673.69	54.502	0.32	0.32	0.04
6302.00	31.880	52.810	5861.00	150.25	1002.21	1403.86	1700200.01	401784.83	39°35'53.7322"N	80°33'50.1947"W	1724.89	54.477	1.82	-1.55	-1.79
6396.00	31.830	51.360	5940.84	152.50	1032.69	1442.99	1700239.14	401815.31	39°35'54.0380"N	80°33'49.6994"W	1774.45	54.410	0.82	-0.05	-1.54
6489.00	32.500	52.850	6019.57	154.77	1063.10	1482.06	1700278.21	401845.71	39°35'54.3430"N	80°33'49.2049"W	1823.92	54.348	1.12	0.72	1.60
6581.00	32.770	52.930	6097.05	157.72	1093.03	1521.63	1700317.78	401875.64	39°35'54.6435"N	80°33'48.7040"W	1873.52	54.309	0.30	0.29	0.09
6673.00	32.460	53.550	6174.54	160.98	1122.71	1561.35	1700357.50	401905.32	39°35'54.9414"N	80°33'48.2011"W	1923.10	54.282	0.50	-0.34	0.67
6770.00	32.350	52.860	6256.44	164.35	1153.84	1602.98	1700399.12	401936.45	39°35'55.2540"N	80°33'47.6740"W	1975.07	54.253	0.40	-0.11	-0.71
6865.00	30.760	51.660	6337.39	166.78	1184.26	1642.30	1700438.44	401966.87	39°35'55.5592"N	80°33'47.1764"W	2024.75	54.205	1.80	-1.67	-1.26
6960.00	30.060	52.730	6419.32	169.05	1213.74	1680.29	1700476.43	401996.34	39°35'55.8549"N	80°33'46.6956"W	2072.81	54.158	0.93	-0.74	1.13
7053.00	31.640	52.370	6499.16	171.60	1242.74	1718.15	1700514.28	402025.34	39°35'56.1459"N	80°33'46.2164"W	2120.48	54.122	1.71	1.70	-0.39
7147.00	32.470	53.970	6578.83	174.82	1272.63	1758.08	1700554.21	402055.24	39°35'56.4461"N	80°33'45.7108"W	2170.36	54.100	1.26	0.88	1.70
7241.00	32.360	56.680	6658.18	179.95	1301.30	1799.51	1700595.64	402083.90	39°35'56.7342"N	80°33'45.1859"W	2220.72	54.128	1.55	-0.12	2.88
7333.00	33.550	57.630	6735.38	186.64	1328.43	1841.56	1700637.68	402111.03	39°35'57.0073"N	80°33'44.6529"W	2270.70	54.195	1.41	1.29	1.03
7428.00	33.960	55.900	6814.37	193.33	1357.36	1885.70	1700681.83	402139.96	39°35'57.2983"N	80°33'44.0933"W	2323.43	54.253	1.10	0.43	-1.82
7523.00	32.550	51.940	6893.82	197.39	1388.00	1927.80	1700723.92	402170.60	39°35'57.6060"N	80°33'43.5601"W	2375.49	54.246	2.72	-1.48	-4.17
7570.00	31.940	50.690	6933.57	198.19	1403.67	1947.38	1700743.50	402186.27	39°35'57.7632"N	80°33'43.3125"W	2400.54	54.216	1.92	-1.30	-2.66
7639.00	30.610	46.950	6992.55	197.80	1427.23	1974.34	1700770.46	402209.82	39°35'57.9991"N	80°33'42.9716"W	2436.19	54.137	3.41	-1.93	-5.42
7734.00	28.900	66.000	7075.20	203.28	1453.14	2013.08	1700809.19	402235.73	39°35'58.2597"N	80°33'42.4807"W	2482.76	54.176	10.08	-1.80	20.05
7829.00	34.930	82.000	7155.95	224.48	1466.30	2061.11	1700857.22	402248.89	39°35'58.3953"N	80°33'41.8691"W	2529.47	54.572	10.89	6.35	16.84
7924.00	38.800	94.490	7232.05	260.22	1467.75	2117.82	1700913.93	402250.34	39°35'58.4164"N	80°33'41.1449"W	2576.71	55.276	8.86	4.07	13.15
8020.00	44.290	107.470	7304.01	310.04	1455.30	2179.94	1700976.04	402237.89	39°35'58.3006"N	80°33'40.3495"W	2621.08	56.273	10.61	5.72	13.52
8115.00	50.600	112.180	7368.24	370.87	1431.46	2245.65	1701041.75	402214.05	39°35'58.0726"N	80°33'39.5065"W	2663.09	57.485	7.58	6.64	4.96
8209.00	54.960	117.100	7425.11	438.78	1400.19	2313.60	1701109.70	402182.78	39°35'57.7715"N	80°33'38.6338"W	2704.31	58.818	6.23	4.64	5.23



RECEIVED  
Office of Oil and Gas

JAN 22 2024

WV Department of  
Environmental Protection

# Actual Wellpath Report

BIG 245 114H AWP Proj: 24914'

Page 6 of 14



REFERENCE WELLPATH IDENTIFICATION			
Operator	EQT PRODUCTION COMPANY	Well	BIG 245 114H (L-004464)
Field	Wetzel	API	47-103-03446-00-00
Facility	Big 245 Pad	Wellbore	BIG 245 114H AWB
Slot	Slot #114		

## WELLPATH DATA (296 stations)

MD [ft]	Inclination [°]	Azimuth [°]	TVD [ft]	Vert Sect [ft]	North [ft]	East [ft]	Grid East [US ft]	Grid North [US ft]	Latitude	Longitude	Closure Dist [ft]	Closure Dir [°]	DLS [°/100ft]	Build Rate [°/100ft]	Turn Rate [°/100ft]
8305.00	61.410	126.080	7475.77	516.32	1357.36	2382.82	1701178.92	402139.95	39°35'57.3563"N	80°33'37.7431"W	2742.31	60.332	10.40	6.72	9.35
8400.00	68.120	133.630	7516.29	600.94	1302.25	2448.59	1701244.68	402084.85	39°35'56.8194"N	80°33'36.8947"W	2773.35	61.994	10.07	7.06	7.95
8495.00	74.930	140.630	7546.41	690.85	1236.23	2509.73	1701305.81	402018.83	39°35'56.1741"N	80°33'36.1037"W	2797.68	63.776	10.01	7.17	7.37
8590.00	81.190	147.060	7566.08	783.42	1161.23	2564.46	1701360.54	401943.84	39°35'55.4392"N	80°33'35.3933"W	2815.12	65.638	9.34	6.59	6.77
8685.00	84.390	147.280	7578.00	876.81	1082.04	2615.54	1701411.62	401864.66	39°35'54.6626"N	80°33'34.7288"W	2830.53	67.525	3.38	3.37	0.23
8780.00	88.180	148.100	7584.15	970.62	1001.93	2666.20	1701462.28	401784.55	39°35'53.8769"N	80°33'34.0696"W	2848.25	69.404	4.08	3.99	0.86
8875.00	89.420	147.060	7586.14	1064.65	921.76	2717.12	1701513.20	401704.39	39°35'53.0905"N	80°33'33.4071"W	2869.22	71.261	1.70	1.31	-1.09
8970.00	90.180	150.170	7586.47	1158.43	840.67	2766.59	1701562.66	401623.30	39°35'52.2949"N	80°33'32.7630"W	2891.50	73.098	3.37	0.80	3.27
9066.00	89.660	149.020	7586.61	1252.94	757.88	2815.18	1701611.24	401540.51	39°35'51.4823"N	80°33'32.1299"W	2915.41	74.933	1.31	-0.54	-1.20
9160.00	90.520	147.740	7586.46	1345.80	677.83	2864.46	1701660.52	401460.47	39°35'50.6971"N	80°33'31.4883"W	2943.57	76.687	1.64	0.91	-1.36
9256.00	89.450	148.020	7586.49	1440.77	596.53	2915.50	1701711.56	401379.17	39°35'49.8995"N	80°33'30.8241"W	2975.90	78.437	1.15	-1.11	0.29
9351.00	90.370	149.570	7586.64	1534.51	515.28	2964.72	1701760.78	401297.93	39°35'49.1023"N	80°33'30.1832"W	3009.16	80.140	1.90	0.97	1.63
9446.00	89.260	148.750	7586.94	1628.16	433.71	3013.42	1701809.47	401216.37	39°35'48.3019"N	80°33'29.5488"W	3044.47	81.810	1.45	-1.17	-0.86
9541.00	90.620	148.790	7587.04	1721.91	352.48	3062.67	1701858.72	401135.14	39°35'47.5048"N	80°33'28.9075"W	3082.89	83.435	1.43	1.43	0.04
9636.00	89.720	148.900	7586.76	1815.64	271.18	3111.82	1701907.87	401053.85	39°35'46.7071"N	80°33'28.2674"W	3123.61	85.019	0.95	-0.95	0.12
9731.00	90.770	148.350	7586.35	1909.43	190.08	3161.28	1701957.32	400972.75	39°35'45.9114"N	80°33'27.6235"W	3166.99	86.559	1.25	1.11	-0.58
9826.00	89.690	149.080	7585.97	2003.20	108.89	3210.61	1702006.65	400891.57	39°35'45.1148"N	80°33'26.9811"W	3212.46	88.057	1.37	-1.14	0.77
9921.00	89.350	148.930	7586.77	2096.88	27.46	3259.53	1702055.57	400810.14	39°35'44.3157"N	80°33'26.3440"W	3259.64	89.517	0.39	-0.36	-0.16
10017.00	89.880	147.600	7587.41	2191.75	-54.18	3310.02	1702106.06	400728.50	39°35'43.5148"N	80°33'25.6868"W	3310.47	90.938	1.49	0.55	-1.39
10112.00	89.880	147.870	7587.61	2285.77	-134.51	3360.74	1702156.77	400648.18	39°35'42.7268"N	80°33'25.0269"W	3363.43	92.292	0.28	0.00	0.28
10206.00	89.110	149.040	7588.44	2378.61	-214.62	3409.91	1702205.94	400568.08	39°35'41.9409"N	80°33'24.3868"W	3416.66	93.601	1.49	-0.82	1.24
10302.00	89.170	150.280	7589.88	2473.09	-297.46	3458.40	1702254.43	400485.24	39°35'41.1278"N	80°33'23.7550"W	3471.17	94.916	1.29	0.06	1.29
10397.00	89.690	148.560	7590.83	2566.65	-379.24	3506.72	1702302.75	400403.47	39°35'40.3253"N	80°33'23.1254"W	3527.17	96.172	1.89	0.55	-1.81
10491.00	89.510	148.590	7591.48	2659.47	-459.45	3555.73	1702351.75	400323.26	39°35'39.5383"N	80°33'22.4874"W	3585.29	97.363	0.19	-0.19	0.03
10586.00	89.970	149.070	7591.91	2753.21	-540.73	3604.90	1702400.92	400241.98	39°35'38.7407"N	80°33'21.8471"W	3645.23	98.531	0.70	0.48	0.51
10681.00	88.890	147.910	7592.86	2847.03	-621.72	3654.55	1702450.56	400161.00	39°35'37.9461"N	80°33'21.2008"W	3707.05	99.655	1.67	-1.14	-1.22
10777.00	88.710	150.440	7594.87	2941.63	-704.13	3703.73	1702499.74	400078.59	39°35'37.1374"N	80°33'20.5603"W	3770.06	100.764	2.64	-0.19	2.64
10872.00	89.880	149.290	7596.04	3035.06	-786.28	3751.41	1702547.42	399996.45	39°35'36.3311"N	80°33'19.9389"W	3832.93	101.838	1.73	1.23	-1.21
10967.00	89.630	147.050	7596.44	3128.96	-866.99	3801.51	1702597.52	399915.74	39°35'35.5393"N	80°33'19.2868"W	3899.13	102.847	2.37	-0.26	-2.36
11061.00	89.050	149.560	7597.53	3221.84	-946.96	3850.89	1702646.90	399835.78	39°35'34.7547"N	80°33'18.6441"W	3965.62	103.815	2.74	-0.62	2.67



RECEIVED  
Office of Oil and Gas

JAN 22 2024

# Actual Wellpath Report

BIG 245 114H AWP Proj: 24914'

Page 7 of 14

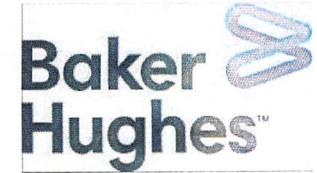

## REFERENCE WELLPATH IDENTIFICATION

Operator	EQT PRODUCTION COMPANY	Well	BIG 245 114H (L-004464)
Field	Wetzel	API	47-103-03446-00-00
Facility	Big 245 Pad	Wellbore	BIG 245 114H AWB
Slot	Slot #114		

## WELLPATH DATA (296 stations)

MD [ft]	Inclination [°]	Azimuth [°]	TVD [ft]	Vert Sect [ft]	North [ft]	East [ft]	Grid East [US ft]	Grid North [US ft]	Latitude	Longitude	Closure Dist [ft]	Closure Dir [°]	DLS [°/100ft]	Build Rate [°/100ft]	Turn Rate [°/100ft]
11157.00	90.180	149.110	7598.17	3316.42	-1029.53	3899.85	1702695.85	399753.21	39°35'33.9444"N	80°33'18.0064"W	4033.46	104.788	1.27	1.18	-0.47
11251.00	90.090	148.740	7597.95	3409.14	-1110.04	3948.37	1702744.37	399672.71	39°35'33.1544"N	80°33'17.3746"W	4101.44	105.703	0.41	-0.10	-0.39
11347.00	90.000	147.670	7597.88	3504.03	-1191.63	3998.95	1702794.95	399591.12	39°35'32.3539"N	80°33'16.7163"W	4172.72	106.593	1.12	-0.09	-1.11
11442.00	90.400	148.780	7597.54	3597.92	-1272.39	4048.98	1702844.97	399510.36	39°35'31.5616"N	80°33'16.0652"W	4244.20	107.445	1.24	0.42	1.17
11537.00	88.620	148.700	7598.36	3691.68	-1353.60	4098.27	1702894.26	399429.17	39°35'30.7648"N	80°33'15.4234"W	4316.02	108.278	1.88	-1.87	-0.08
11631.00	90.550	149.290	7599.04	3784.38	-1434.16	4146.69	1702942.67	399348.61	39°35'29.9743"N	80°33'14.7929"W	4387.69	109.078	2.15	2.05	0.63
11726.00	88.520	147.720	7599.81	3878.19	-1515.15	4196.31	1702992.29	399267.62	39°35'29.1796"N	80°33'14.1470"W	4461.47	109.853	2.70	-2.14	-1.65
11821.00	89.630	148.790	7601.34	3972.06	-1595.93	4246.29	1703042.27	399186.85	39°35'28.3871"N	80°33'13.4965"W	4536.29	110.598	1.62	1.17	1.13
11916.00	89.880	149.040	7601.75	4065.78	-1677.29	4295.34	1703091.31	399105.50	39°35'27.5888"N	80°33'12.8579"W	4611.20	111.330	0.37	0.26	0.26
12011.00	89.380	149.900	7602.36	4159.33	-1759.11	4343.59	1703139.57	399023.67	39°35'26.7857"N	80°33'12.2293"W	4686.29	112.047	1.05	-0.53	0.91
12106.00	90.150	148.630	7602.75	4252.95	-1840.77	4392.14	1703188.11	398942.03	39°35'25.9844"N	80°33'11.5969"W	4762.28	112.739	1.56	0.81	-1.34
12201.00	88.710	149.990	7603.70	4346.54	-1922.45	4440.63	1703236.59	398860.34	39°35'25.1828"N	80°33'10.9655"W	4838.90	113.409	2.08	-1.52	1.43
12296.00	90.740	149.840	7604.15	4439.97	-2004.65	4488.24	1703284.21	398778.15	39°35'24.3760"N	80°33'10.3449"W	4915.58	114.068	2.14	2.14	-0.16
12391.00	89.450	150.610	7604.00	4533.30	-2087.11	4535.42	1703331.38	398695.70	39°35'23.5666"N	80°33'9.7301"W	4992.60	114.711	1.58	-1.36	0.81
12486.00	90.620	149.640	7603.94	4626.66	-2169.48	4582.74	1703378.70	398613.33	39°35'22.7580"N	80°33'9.1134"W	5070.32	115.333	1.60	1.23	-1.02
12581.00	88.710	149.010	7604.49	4720.25	-2251.18	4631.20	1703427.16	398531.64	39°35'21.9562"N	80°33'8.4822"W	5149.35	115.924	2.12	-2.01	-0.66
12676.00	89.940	150.240	7605.61	4813.76	-2333.13	4679.23	1703475.19	398449.69	39°35'21.1519"N	80°33'7.8564"W	5228.64	116.501	1.83	1.29	1.29
12771.00	89.110	149.590	7606.40	4907.18	-2415.33	4726.85	1703522.80	398367.50	39°35'20.3450"N	80°33'7.2359"W	5308.20	117.066	1.11	-0.87	-0.68
12866.00	90.580	150.140	7606.66	5000.62	-2497.49	4774.54	1703570.49	398285.35	39°35'19.5386"N	80°33'6.6145"W	5388.29	117.613	1.65	1.55	0.58
12962.00	88.580	149.790	7607.36	5095.01	-2580.59	4822.59	1703618.54	398202.25	39°35'18.7229"N	80°33'5.9884"W	5469.63	118.151	2.11	-2.08	-0.36
13057.00	89.970	148.880	7608.56	5188.60	-2662.30	4871.04	1703666.98	398120.55	39°35'17.9211"N	80°33'5.3574"W	5551.11	118.659	1.75	1.46	-0.96
13151.00	88.220	149.890	7610.05	5281.18	-2743.18	4918.90	1703714.84	398039.67	39°35'17.1273"N	80°33'4.7340"W	5632.11	119.148	2.15	-1.86	1.07
13246.00	89.510	151.720	7611.93	5374.31	-2826.09	4965.23	1703761.16	397956.76	39°35'16.3133"N	80°33'4.1300"W	5713.17	119.647	2.36	1.36	1.93
13341.00	91.050	150.860	7611.46	5467.29	-2909.41	5010.86	1703806.79	397873.45	39°35'15.4952"N	80°33'3.5347"W	5794.25	120.140	1.86	1.62	-0.91
13436.00	90.990	148.270	7609.77	5560.80	-2991.29	5058.97	1703854.90	397791.57	39°35'14.6915"N	80°33'2.9080"W	5877.16	120.595	2.73	-0.06	-2.73
13531.00	89.260	148.360	7609.57	5654.67	-3072.13	5108.87	1703904.80	397710.74	39°35'13.8984"N	80°33'2.2586"W	5961.42	121.020	1.82	-1.82	0.09
13626.00	89.660	148.890	7610.46	5748.46	-3153.24	5158.33	1703954.25	397629.64	39°35'13.1026"N	80°33'1.6148"W	6045.76	121.437	0.70	0.42	0.56
13721.00	90.120	148.800	7610.64	5842.19	-3234.53	5207.48	1704003.40	397548.34	39°35'12.3048"N	80°33'0.9750"W	6130.25	121.846	0.49	0.48	-0.09
13816.00	89.380	149.800	7611.06	5935.80	-3316.22	5255.98	1704051.89	397466.66	39°35'11.5032"N	80°33'0.3434"W	6214.71	122.250	1.31	-0.78	1.05
13911.00	89.140	147.870	7612.29	6029.52	-3397.50	5305.13	1704101.05	397385.39	39°35'10.7056"N	80°32'59.7034"W	6299.79	122.636	2.05	-0.25	-2.03





RECEIVED  
Office of Oil and Gas

JAN 22 2024

WV Department of

# Actual Wellpath Report

BIG 245 114H AWP Proj: 24914'

Page 8 of 14



## REFERENCE WELLPATH IDENTIFICATION

Operator	EQT PRODUCTION COMPANY	Well	BIG 245 114H (L-004464)
Field	Wetzel	API	47-103-03446-00-00
Facility	Big 245 Pad	Wellbore	BIG 245 114H AWB
Slot	Slot #114		

## WELLPATH DATA (296 stations)

MD [ft]	Inclination [°]	Azimuth [°]	TVD [ft]	Vert Sect [ft]	North [ft]	East [ft]	Grid East [US ft]	Grid North [US ft]	Latitude	Longitude	Closure Dist [ft]	Closure Dir [°]	DLS [°/100ft]	Build Rate [°/100ft]	Turn Rate [°/100ft]
14006.00	89.200	150.500	7613.66	6123.14	-3479.07	5353.79	1704149.70	397303.82	39°35'9.9051"N	80°32'59.0698"W	6384.90	123.017	2.77	0.06	2.77
14100.00	91.290	149.540	7613.26	6215.55	-3560.49	5400.76	1704196.67	397222.41	39°35'9.1059"N	80°32'58.4578"W	6468.79	123.395	2.45	2.22	-1.02
14195.00	89.380	148.360	7612.70	6309.25	-3641.87	5449.75	1704245.66	397141.03	39°35'8.3073"N	80°32'57.8199"W	6554.62	123.753	2.36	-2.01	-1.24
14290.00	88.490	149.060	7614.47	6403.00	-3723.03	5499.08	1704294.99	397059.87	39°35'7.5109"N	80°32'57.1778"W	6640.85	124.099	1.19	-0.94	0.74
14385.00	88.890	150.370	7616.64	6496.46	-3805.05	5546.98	1704342.88	396977.87	39°35'6.7059"N	80°32'56.5539"W	6726.61	124.449	1.44	0.42	1.38
14480.00	90.580	148.860	7617.08	6589.97	-3886.99	5595.03	1704390.92	396895.93	39°35'5.9016"N	80°32'55.9280"W	6812.71	124.789	2.39	1.78	-1.59
14575.00	88.580	148.980	7617.78	6683.68	-3968.35	5644.06	1704439.96	396814.57	39°35'5.1033"N	80°32'55.2896"W	6899.51	125.111	2.11	-2.11	0.13
14670.00	89.480	147.930	7619.39	6777.50	-4049.30	5693.76	1704489.65	396733.63	39°35'4.3090"N	80°32'54.6429"W	6986.82	125.420	1.46	0.95	-1.11
14765.00	88.120	148.990	7621.38	6871.31	-4130.24	5743.44	1704539.33	396652.69	39°35'3.5148"N	80°32'53.9963"W	7074.32	125.721	1.81	-1.43	1.12
14860.00	88.490	151.150	7624.19	6964.65	-4212.53	5790.81	1704586.70	396570.41	39°35'2.7070"N	80°32'53.3790"W	7160.93	126.034	2.31	0.39	2.27
14955.00	90.370	150.420	7625.13	7057.80	-4295.44	5837.18	1704633.06	396487.51	39°35'1.8931"N	80°32'52.7745"W	7247.31	126.348	2.12	1.98	-0.77
15050.00	88.650	147.090	7625.94	7151.53	-4376.64	5886.44	1704682.32	396406.31	39°35'1.0962"N	80°32'52.1332"W	7335.20	126.631	3.95	-1.81	-3.51
15145.00	88.090	150.020	7628.65	7245.30	-4457.65	5935.98	1704731.85	396325.30	39°35'0.3014"N	80°32'51.4885"W	7423.37	126.905	3.14	-0.59	3.08
15240.00	89.660	149.560	7630.51	7338.74	-4539.73	5983.77	1704779.64	396243.23	39°34'59.4958"N	80°32'50.8660"W	7510.97	127.187	1.72	1.65	-0.48
15335.00	88.460	148.640	7632.07	7432.39	-4621.23	6032.55	1704828.42	396161.73	39°34'58.6959"N	80°32'50.2309"W	7599.17	127.454	1.59	-1.26	-0.97
15430.00	89.600	149.270	7633.68	7526.08	-4702.61	6081.53	1704877.40	396080.36	39°34'57.8973"N	80°32'49.5932"W	7687.62	127.713	1.37	1.20	0.66
15525.00	88.920	150.250	7634.91	7619.54	-4784.67	6129.37	1704925.24	395998.30	39°34'57.0918"N	80°32'48.9700"W	7775.75	127.976	1.26	-0.72	1.03
15620.00	91.320	150.020	7634.71	7712.90	-4867.05	6176.67	1704972.54	395915.93	39°34'56.2832"N	80°32'48.3537"W	7863.81	128.237	2.54	2.53	-0.24
15715.00	89.970	148.890	7633.64	7806.45	-4948.86	6224.95	1705020.81	395834.12	39°34'55.4803"N	80°32'47.7250"W	7952.43	128.485	1.85	-1.42	-1.19
15809.00	91.320	148.900	7632.58	7899.18	-5029.34	6273.51	1705069.36	395753.65	39°34'54.6905"N	80°32'47.0929"W	8040.59	128.718	1.44	1.44	0.01
15999.00	91.200	148.900	7628.40	8086.57	-5191.99	6371.62	1705167.47	395591.01	39°34'53.0944"N	80°32'45.8156"W	8219.14	129.175	0.06	-0.06	0.00
16094.00	89.230	148.100	7628.04	8180.39	-5272.98	6421.26	1705217.10	395510.02	39°34'52.2997"N	80°32'45.1697"W	8308.84	129.392	2.24	-2.07	-0.84
16189.00	90.250	150.530	7628.48	8273.98	-5354.67	6469.73	1705265.58	395428.33	39°34'51.4979"N	80°32'44.5385"W	8398.21	129.613	2.77	1.07	2.56
16284.00	88.030	148.610	7629.90	8367.49	-5436.57	6517.84	1705313.68	395346.44	39°34'50.6941"N	80°32'43.9120"W	8487.55	129.832	3.09	-2.34	-2.02
16379.00	88.460	151.520	7632.81	8460.82	-5518.85	6565.22	1705361.06	395264.17	39°34'49.8865"N	80°32'43.2947"W	8576.70	130.051	3.09	0.45	3.06
16474.00	89.480	151.590	7634.52	8553.71	-5602.37	6610.46	1705406.29	395180.66	39°34'49.0663"N	80°32'42.7046"W	8665.14	130.281	1.08	1.07	0.07
16569.00	90.520	150.030	7634.52	8646.85	-5685.30	6656.79	1705452.62	395097.73	39°34'48.2521"N	80°32'42.1006"W	8754.17	130.499	1.97	1.09	-1.64
16663.00	88.710	148.420	7635.15	8739.48	-5766.05	6704.88	1705500.71	395016.98	39°34'47.4595"N	80°32'41.4744"W	8843.23	130.695	2.58	-1.93	-1.71
16759.00	89.170	151.320	7636.93	8833.88	-5849.06	6753.06	1705548.88	394933.98	39°34'46.6447"N	80°32'40.8469"W	8933.94	130.897	3.06	0.48	3.02
16854.00	90.250	149.370	7637.41	8927.17	-5931.61	6800.06	1705595.88	394851.43	39°34'45.8343"N	80°32'40.2344"W	9023.57	131.098	2.35	1.14	-2.05



RECEIVED  
Office of Oil and Gas

JAN 22 2024

WV Department of

# Actual Wellpath Report

BIG 245 114H AWP Proj: 24914'

Page 9 of 14

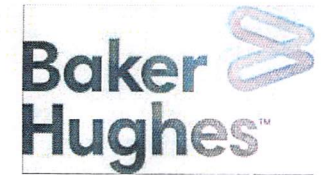

## REFERENCE WELLPATH IDENTIFICATION

Operator	EQT PRODUCTION COMPANY	Well	BIG 245 114H (L-004464)
Field	Wetzel	API	47-103-03446-00-00
Facility	Big 245 Pad	Wellbore	BIG 245 114H AWB
Slot	Slot #114		

## WELLPATH DATA (296 stations)

MD [ft]	Inclination [°]	Azimuth [°]	TVD [ft]	Vert Sect [ft]	North [ft]	East [ft]	Grid East [US ft]	Grid North [US ft]	Latitude	Longitude	Closure Dist [ft]	Closure Dir [°]	DLS [°/100ft]	Build Rate [°/100ft]	Turn Rate [°/100ft]
16949.00	88.920	148.680	7638.10	9020.85	-6013.06	6848.95	1705644.77	394769.99	39°34'45.0350"N	80°32'39.5980"W	9114.00	131.282	1.58	-1.40	-0.73
17044.00	89.630	150.410	7639.30	9114.38	-6094.94	6897.09	1705692.91	394688.11	39°34'44.2314"N	80°32'38.9710"W	9204.25	131.467	1.97	0.75	1.82
17139.00	89.510	149.990	7640.01	9207.72	-6177.38	6944.30	1705740.12	394605.68	39°34'43.4221"N	80°32'38.3558"W	9294.26	131.655	0.46	-0.13	-0.44
17234.00	89.420	149.550	7640.90	9301.19	-6259.45	6992.13	1705787.94	394523.61	39°34'42.6165"N	80°32'37.7329"W	9384.60	131.835	0.47	-0.09	-0.46
17329.00	89.850	149.920	7641.50	9394.67	-6341.50	7040.01	1705835.82	394441.57	39°34'41.8111"N	80°32'37.1093"W	9475.04	132.012	0.60	0.45	0.39
17424.00	90.950	147.740	7640.84	9488.40	-6422.78	7089.17	1705884.98	394360.29	39°34'41.0135"N	80°32'36.4694"W	9566.01	132.177	2.57	1.16	-2.29
17518.00	90.090	145.680	7639.99	9581.64	-6501.35	7140.76	1705936.57	394281.73	39°34'40.2430"N	80°32'35.7989"W	9657.02	132.316	2.37	-0.91	-2.19
17614.00	89.970	148.090	7639.94	9676.83	-6581.75	7193.21	1705989.01	394201.33	39°34'39.4545"N	80°32'35.1173"W	9749.95	132.458	2.51	-0.13	2.51
17708.00	90.770	148.130	7639.33	9769.76	-6661.56	7242.86	1706038.66	394121.53	39°34'38.6714"N	80°32'34.4713"W	9840.50	132.606	0.85	0.85	0.04
17803.00	89.050	146.870	7639.48	9863.83	-6741.67	7293.90	1706089.70	394041.42	39°34'37.8855"N	80°32'33.8077"W	9932.33	132.747	2.24	-1.81	-1.33
17898.00	89.780	146.830	7640.45	9958.04	-6821.21	7345.85	1706141.64	393961.89	39°34'37.1055"N	80°32'33.1325"W	10024.49	132.879	0.77	0.77	-0.04
17993.00	90.340	148.270	7640.35	10052.09	-6901.37	7396.82	1706192.61	393881.73	39°34'36.3191"N	80°32'32.4697"W	10116.42	133.015	1.63	0.59	1.52
18088.00	89.970	147.870	7640.09	10146.03	-6982.00	7447.07	1706242.85	393801.11	39°34'35.5281"N	80°32'31.8162"W	10208.19	133.154	0.57	-0.39	-0.42
18183.00	89.600	146.990	7640.45	10240.11	-7062.06	7498.21	1706293.99	393721.06	39°34'34.7428"N	80°32'31.1513"W	10300.28	133.284	1.00	-0.39	-0.93
18278.00	89.720	147.230	7641.01	10334.27	-7141.83	7549.79	1706345.57	393641.29	39°34'33.9603"N	80°32'30.4807"W	10392.55	133.409	0.28	0.13	0.25
18374.00	89.350	148.310	7641.79	10429.26	-7223.03	7600.99	1706396.76	393560.09	39°34'33.1637"N	80°32'29.8149"W	10485.57	133.539	1.19	-0.39	1.13
18469.00	89.510	148.240	7642.74	10523.14	-7303.83	7650.94	1706446.71	393479.29	39°34'32.3709"N	80°32'29.1651"W	10577.47	133.670	0.18	0.17	-0.07
18564.00	89.420	148.300	7643.62	10617.02	-7384.63	7700.90	1706496.67	393398.50	39°34'31.5781"N	80°32'28.5151"W	10669.43	133.799	0.11	-0.09	0.06
18659.00	89.880	148.800	7644.20	10710.83	-7465.67	7750.47	1706546.23	393317.46	39°34'30.7829"N	80°32'27.8702"W	10761.32	133.928	0.72	0.48	0.53
18754.00	88.920	148.100	7645.20	10804.66	-7546.62	7800.17	1706595.93	393236.52	39°34'29.9886"N	80°32'27.2235"W	10853.30	134.053	1.25	-1.01	-0.74
18850.00	89.940	149.390	7646.15	10899.40	-7628.68	7849.98	1706645.74	393154.46	39°34'29.1833"N	80°32'26.5754"W	10946.18	134.181	1.71	1.06	1.34
18944.00	89.690	148.340	7646.46	10992.14	-7709.14	7898.58	1706694.34	393074.01	39°34'28.3938"N	80°32'25.9428"W	11037.14	134.305	1.15	-0.27	-1.12
19039.00	89.660	148.820	7647.00	11085.94	-7790.21	7948.10	1706743.86	392992.95	39°34'27.5983"N	80°32'25.2985"W	11129.23	134.425	0.51	-0.03	0.51
19134.00	89.970	148.460	7647.30	11179.73	-7871.33	7997.54	1706793.29	392911.83	39°34'26.8022"N	80°32'24.6552"W	11221.34	134.544	0.50	0.33	-0.38
19229.00	89.820	149.280	7647.48	11273.46	-7952.65	8046.65	1706842.40	392830.52	39°34'26.0042"N	80°32'24.0160"W	11313.41	134.663	0.88	-0.16	0.86
19324.00	89.910	148.150	7647.70	11367.23	-8033.84	8095.99	1706891.73	392749.34	39°34'25.2075"N	80°32'23.3741"W	11405.59	134.779	1.19	0.09	-1.19
19419.00	90.060	148.330	7647.73	11461.12	-8114.61	8145.99	1706941.73	392668.57	39°34'24.4150"N	80°32'22.7236"W	11498.00	134.889	0.25	0.10	0.19
19514.00	89.780	148.910	7647.86	11554.91	-8195.71	8195.46	1706991.20	392587.47	39°34'23.6191"N	80°32'22.0799"W	11590.31	135.001	0.68	-0.29	0.61
19610.00	89.420	148.470	7648.53	11649.67	-8277.73	8245.34	1707041.08	392505.46	39°34'22.8143"N	80°32'21.4308"W	11683.60	135.112	0.59	-0.38	-0.46
19705.00	89.820	149.700	7649.16	11743.33	-8359.23	8294.15	1707089.88	392423.96	39°34'22.0145"N	80°32'20.7956"W	11775.81	135.224	1.36	0.42	1.29

# Actual Wellpath Report

BIG 245 114H AWP Proj: 24914'  
Page 10 of 14

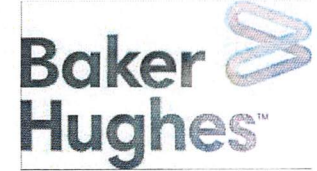

REFERENCE WELLPATH IDENTIFICATION			
Operator	EQT PRODUCTION COMPANY	Well	BIG 245 114H (L-004464)
Field	Wetzel	API	47-103-03446-00-00
Facility	Big 245 Pad	Wellbore	BIG 245 114H AWB
Slot	Slot #114		

## WELLPATH DATA (296 stations)

MD [ft]	Inclination [°]	Azimuth [°]	TVD [ft]	Vert Sect [ft]	North [ft]	East [ft]	Grid East [US ft]	Grid North [US ft]	Latitude	Longitude	Closure Dist [ft]	Closure Dir [°]	DLS [°/100ft]	Build Rate [°/100ft]	Turn Rate [°/100ft]
19799.00	89.780	148.080	7649.49	11836.07	-8439.71	8342.72	1707138.45	392343.49	39°34'21.2247"N	80°32'20.1635"W	11867.16	135.331	1.72	-0.04	-1.72
19894.00	89.140	149.610	7650.38	11929.79	-8521.00	8391.86	1707187.59	392262.20	39°34'20.4269"N	80°32'19.5240"W	11959.55	135.437	1.75	-0.67	1.61
19989.00	90.460	149.460	7650.71	12023.33	-8602.88	8440.03	1707235.75	392180.32	39°34'19.6232"N	80°32'18.8969"W	12051.71	135.547	1.40	1.39	-0.16
20085.00	89.660	148.300	7650.61	12118.04	-8685.06	8489.64	1707285.36	392098.15	39°34'18.8167"N	80°32'18.2512"W	12145.14	135.652	1.47	-0.83	-1.21
20180.00	90.430	147.880	7650.54	12211.97	-8765.71	8539.86	1707335.57	392017.51	39°34'18.0255"N	80°32'17.5981"W	12237.92	135.748	0.92	0.81	-0.44
20275.00	89.660	149.340	7650.46	12305.76	-8846.80	8589.34	1707385.05	391936.42	39°34'17.2297"N	80°32'16.9543"W	12330.55	135.846	1.74	-0.81	1.54
20370.00	89.910	148.790	7650.82	12399.43	-8928.29	8638.17	1707433.88	391854.94	39°34'16.4300"N	80°32'16.3187"W	12423.05	135.946	0.64	0.26	-0.58
20465.00	89.600	148.820	7651.23	12493.18	-9009.55	8687.38	1707483.09	391773.68	39°34'15.6326"N	80°32'15.6784"W	12515.69	136.043	0.33	-0.33	0.03
20560.00	89.850	148.460	7651.68	12586.96	-9090.67	8736.82	1707532.52	391692.57	39°34'14.8365"N	80°32'15.0352"W	12608.42	136.137	0.46	0.26	-0.38
20655.00	89.850	149.480	7651.93	12680.66	-9172.07	8785.79	1707581.49	391611.17	39°34'14.0376"N	80°32'14.3979"W	12701.06	136.232	1.07	0.00	1.07
20750.00	89.780	148.070	7652.24	12774.41	-9253.31	8835.03	1707630.73	391529.94	39°34'13.2404"N	80°32'13.7571"W	12793.81	136.325	1.49	-0.07	-1.48
20845.00	89.910	149.280	7652.50	12868.19	-9334.46	8884.42	1707680.12	391448.79	39°34'12.4441"N	80°32'13.1145"W	12886.62	136.415	1.28	0.14	1.27
20940.00	90.310	148.790	7652.31	12961.87	-9415.92	8933.30	1707728.99	391367.34	39°34'11.6446"N	80°32'12.4784"W	12979.34	136.507	0.67	0.42	-0.52
21035.00	89.570	148.480	7652.41	13055.66	-9497.04	8982.75	1707778.44	391286.22	39°34'10.8486"N	80°32'11.8351"W	13072.24	136.594	0.84	-0.78	-0.33
21130.00	89.820	149.580	7652.92	13149.34	-9578.49	9031.63	1707827.32	391204.78	39°34'10.0492"N	80°32'11.1989"W	13165.02	136.683	1.19	0.26	1.16
21226.00	89.970	149.850	7653.09	13243.81	-9661.39	9080.04	1707875.73	391121.88	39°34'9.2355"N	80°32'10.5685"W	13258.57	136.777	0.32	0.16	0.28
21321.00	90.460	150.140	7652.74	13337.22	-9743.66	9127.55	1707923.23	391039.62	39°34'8.4279"N	80°32'9.9498"W	13351.07	136.870	0.60	0.52	0.31
21416.00	90.430	149.980	7652.00	13430.60	-9825.98	9174.96	1707970.64	390957.31	39°34'7.6198"N	80°32'9.3323"W	13443.57	136.962	0.17	-0.03	-0.17
21511.00	90.060	148.920	7651.59	13524.16	-9907.79	9223.25	1708018.92	390875.50	39°34'6.8168"N	80°32'8.7037"W	13536.34	137.049	1.18	-0.39	-1.12
21606.00	90.580	149.670	7651.06	13617.77	-9989.47	9271.76	1708067.43	390793.83	39°34'6.0151"N	80°32'8.0723"W	13629.19	137.134	0.96	0.55	0.79
21701.00	89.820	150.420	7650.73	13711.16	-10071.77	9319.19	1708114.86	390711.52	39°34'5.2071"N	80°32'7.4546"W	13721.80	137.223	1.12	-0.80	0.79
21796.00	90.740	149.510	7650.27	13804.57	-10154.01	9366.74	1708162.41	390629.29	39°34'4.3998"N	80°32'6.8353"W	13814.48	137.309	1.36	0.97	-0.96
21891.00	90.370	149.680	7649.35	13898.09	-10235.94	9414.82	1708210.48	390547.36	39°34'3.5955"N	80°32'6.2094"W	13907.31	137.393	0.43	-0.39	0.10
21986.00	90.680	149.970	7648.48	13991.54	-10318.07	9462.57	1708258.23	390465.24	39°34'2.7894"N	80°32'5.5877"W	14000.10	137.476	0.45	0.33	0.31
22081.00	89.910	149.320	7647.99	14085.04	-10400.04	9510.57	1708306.23	390383.27	39°34'1.9847"N	80°32'4.9626"W	14092.97	137.558	1.06	-0.81	-0.68
22176.00	90.280	149.260	7647.83	14178.65	-10481.72	9559.09	1708354.74	390301.60	39°34'1.1831"N	80°32'4.3312"W	14186.00	137.636	0.39	0.39	-0.06
22272.00	89.660	150.680	7647.88	14273.05	-10564.83	9607.13	1708402.78	390218.50	39°34'0.3672"N	80°32'3.7055"W	14279.80	137.718	1.61	-0.65	1.48
22367.00	90.740	148.620	7647.55	14366.55	-10646.81	9655.13	1708450.78	390136.53	39°33'59.5625"N	80°32'3.0806"W	14372.75	137.796	2.45	1.14	-2.17
22462.00	90.310	150.280	7646.68	14460.10	-10728.61	9703.41	1708499.06	390054.72	39°33'58.7596"N	80°32'2.4521"W	14465.80	137.872	1.80	-0.45	1.75
22557.00	90.090	148.880	7646.35	14553.63	-10810.53	9751.51	1708547.16	389972.81	39°33'57.9555"N	80°32'1.8259"W	14558.83	137.948	1.49	-0.23	-1.47



# Actual Wellpath Report

BIG 245 114H AWP Proj: 24914'

Page 11 of 14

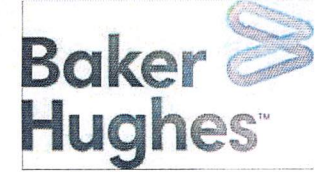

REFERENCE WELLPATH IDENTIFICATION			
Operator	EQT PRODUCTION COMPANY	Well	BIG 245 114H (L-004464)
Field	Wetzel	API	47-103-03446-00-00
Facility	Big 245 Pad	Wellbore	BIG 245 114H AWB
Slot	Slot #114		

**WELLPATH DATA (296 stations)** † = interpolated, ‡ = extrapolated station

MD [ft]	Inclination [°]	Azimuth [°]	TVD [ft]	Vert Sect [ft]	North [ft]	East [ft]	Grid East [US ft]	Grid North [US ft]	Latitude	Longitude	Closure Dist [ft]	Closure Dir [°]	DLS [°/100ft]	Build Rate [°/100ft]	Turn Rate [°/100ft]
22652.00	90.680	149.700	7645.71	14647.24	-10892.21	9800.03	1708595.67	389891.14	39°33'57.1538"N	80°32'1.1945"W	14651.98	138.021	1.06	0.62	0.86
22747.00	89.880	149.610	7645.24	14740.74	-10974.19	9848.02	1708643.66	389809.16	39°33'56.3491"N	80°32'0.5697"W	14745.04	138.096	0.85	-0.84	-0.09
22842.00	90.250	150.280	7645.14	14834.16	-11056.41	9895.60	1708691.23	389726.94	39°33'55.5419"N	80°31'59.9501"W	14838.03	138.171	0.81	0.39	0.71
22937.00	90.460	149.840	7644.55	14927.54	-11138.73	9943.01	1708738.64	389644.63	39°33'54.7337"N	80°31'59.3327"W	14931.00	138.246	0.51	0.22	-0.46
23032.00	90.430	149.780	7643.81	15021.00	-11220.85	9990.78	1708786.41	389562.52	39°33'53.9277"N	80°31'58.7107"W	15024.09	138.319	0.07	-0.03	-0.06
23127.00	90.400	149.710	7643.12	15114.48	-11302.90	10038.65	1708834.27	389480.47	39°33'53.1222"N	80°31'58.0875"W	15117.21	138.390	0.08	-0.03	-0.07
23221.00	90.620	149.110	7642.28	15207.07	-11383.82	10086.48	1708882.10	389399.56	39°33'52.3280"N	80°31'57.4649"W	15209.49	138.458	0.68	0.23	-0.64
23317.00	90.430	149.740	7641.40	15301.62	-11466.47	10135.31	1708930.93	389316.91	39°33'51.5167"N	80°31'56.8294"W	15303.74	138.526	0.69	-0.20	0.66
23412.00	90.460	149.220	7640.67	15395.17	-11548.30	10183.55	1708979.17	389235.08	39°33'50.7135"N	80°31'56.2014"W	15397.01	138.593	0.55	0.03	-0.55
23507.00	90.650	149.690	7639.75	15488.73	-11630.12	10231.83	1709027.45	389153.27	39°33'49.9104"N	80°31'55.5730"W	15490.32	138.660	0.53	0.20	0.49
23602.00	90.370	149.970	7638.90	15582.18	-11712.24	10279.57	1709075.19	389071.15	39°33'49.1042"N	80°31'54.9514"W	15583.53	138.727	0.42	-0.29	0.29
23697.00	90.220	148.800	7638.41	15675.76	-11794.00	10327.95	1709123.56	388989.40	39°33'48.3017"N	80°31'54.3217"W	15676.89	138.792	1.24	-0.16	-1.23
23792.00	91.450	149.710	7637.03	15769.37	-11875.64	10376.51	1709172.12	388907.77	39°33'47.5005"N	80°31'53.6898"W	15770.31	138.854	1.61	1.29	0.96
23887.00	90.180	149.860	7635.68	15862.83	-11957.72	10424.31	1709219.92	388825.69	39°33'46.6947"N	80°31'53.0674"W	15863.59	138.919	1.35	-1.34	0.16
23982.00	90.890	148.690	7634.79	15956.44	-12039.38	10472.85	1709268.45	388744.04	39°33'45.8932"N	80°31'52.4358"W	15957.04	138.981	1.44	0.75	-1.23
24076.00	90.770	148.210	7633.43	16049.28	-12119.48	10522.03	1709317.62	388663.95	39°33'45.1072"N	80°31'51.7962"W	16049.76	139.036	0.53	-0.13	-0.51
24171.00	90.340	147.340	7632.51	16143.28	-12199.84	10572.68	1709368.28	388583.59	39°33'44.3188"N	80°31'51.1377"W	16143.66	139.087	1.02	-0.45	-0.92
24266.00	90.620	148.680	7631.71	16237.22	-12280.41	10623.01	1709418.60	388503.03	39°33'43.5283"N	80°31'50.4834"W	16237.51	139.139	1.44	0.29	1.41
24361.00	90.400	148.460	7630.87	16331.02	-12361.46	10672.54	1709468.13	388421.97	39°33'42.7328"N	80°31'49.8390"W	16331.23	139.194	0.33	-0.23	-0.23
24456.00	90.580	148.170	7630.05	16424.89	-12442.30	10722.44	1709518.03	388341.14	39°33'41.9396"N	80°31'49.1902"W	16425.03	139.246	0.36	0.19	-0.31
24550.00	90.770	148.700	7628.95	16517.74	-12522.39	10771.64	1709567.23	388261.06	39°33'41.1537"N	80°31'48.5503"W	16517.82	139.298	0.60	0.20	0.56
24645.00	90.400	148.830	7627.98	16611.49	-12603.61	10820.90	1709616.48	388179.84	39°33'40.3566"N	80°31'47.9095"W	16611.53	139.352	0.41	-0.39	0.14
24741.00	90.520	148.640	7627.21	16706.24	-12685.67	10870.72	1709666.30	388097.79	39°33'39.5513"N	80°31'47.2614"W	16706.25	139.406	0.23	0.12	-0.20
24836.00	90.550	148.710	7626.32	16800.01	-12766.82	10920.11	1709715.69	388016.64	39°33'38.7549"N	80°31'46.6190"W	16800.01	139.458	0.08	0.03	0.07
24889.00	90.370	149.170	7625.89	16852.29	-12812.22	10947.46	1709743.03	387971.25	39°33'38.3093"N	80°31'46.2632"W	16852.29	139.488	0.93	-0.34	0.87
24914.00‡	90.370	149.170	7625.73	16876.93	-12833.68	10960.27	1709755.84	387949.78	39°33'38.0987"N	80°31'46.0965"W	16876.93	139.502	0.00	0.00	0.00

RECEIVED  
Office of Oil and Gas

JAN 22 2024

WV Department of  
Environmental Protection



# Actual Wellpath Report

BIG 245 114H AWP Proj: 24914'

Page 12 of 14

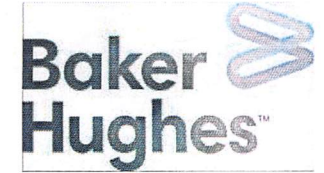

REFERENCE WELLPATH IDENTIFICATION			
Operator	EQT PRODUCTION COMPANY	Well	BIG 245 114H (L-004464)
Field	Wetzel	API	47-103-03446-00-00
Facility	Big 245 Pad	Wellbore	BIG 245 114H AWB
Slot	Slot #114		

HOLE & CASING SECTIONS - Ref Wellbore: BIG 245 114H AWB Ref Wellpath: BIG 245 114H AWP Proj: 24914'									
String/Diameter	Start MD [ft]	End MD [ft]	Interval [ft]	Start TVD [ft]	End TVD [ft]	Start N/S [ft]	Start E/W [ft]	End N/S [ft]	End E/W [ft]
17.5in Open Hole	28.00	1269.00	1241.00	28.00	1268.96	0.00	0.00	-1.60	-8.32
13.375in Casing Surface	28.00	1239.00	1211.00	28.00	1238.96	0.00	0.00	-1.53	-8.39
12.25in Open Hole	1269.00	2703.00	1434.00	1268.96	2697.80	-1.60	-8.32	41.79	65.11
9.625in Casing Intermediate	28.00	2681.00	2653.00	28.00	2675.95	0.00	0.00	40.98	62.68
8.75in Open Hole	2703.00	7648.00	4945.00	2697.80	7000.30	41.79	65.11	1430.30	1977.72
8.5in Open Hole	7648.00	24914.00	17266.00	7000.30	7625.73	1430.30	1977.72	-12833.68	10960.27
5.5in Casing Production	28.00	24884.00	24856.00	28.00	7625.93	0.00	0.00	-12807.92	10944.89

TARGETS								
Name	TVD [ft]	North [ft]	East [ft]	Grid East [US ft]	Grid North [US ft]	Latitude	Longitude	Shape
BIG 245 114H LP Rev-1	7574.00	1071.98	2613.76	1701409.84	401854.60	39°35'54.5630"N	80°33'34.7500"W	point
BIG 245 114H BHL Rev-1	7715.52	-12829.40	10966.89	1709762.46	387954.07	39°33'38.1417"N	80°31'46.0126"W	point
BIG 245 Hardline 7	9000.00	-12932.40	10795.46	1709591.04	387851.07	39°33'37.1044"N	80°31'48.1861"W	rectangle
	2D Rectangle 800 x 2.							
BIG 245 Temp 1 Rev-2	9000.00	-9119.02	7026.15	1705821.97	391664.22	39°34'14.3606"N	80°32'36.8742"W	polygon
	2D Polygon: dimensions not calculated							

RECEIVED  
Office of Oil and Gas

JAN 22 2024

WV Department of  
Environmental Protection



# Actual Wellpath Report

BIG 245 114H AWP Proj: 24914'

Page 13 of 14



## REFERENCE WELLPATH IDENTIFICATION

Operator	EQT PRODUCTION COMPANY	Well	BIG 245 114H (L-004464)
Field	Wetzel	API	47-103-03446-00-00
Facility	Big 245 Pad	Wellbore	BIG 245 114H AWB
Slot	Slot #114		

## WELLPATH COMPOSITION - Ref Wellbore: BIG 245 114H AWB Ref Wellpath: BIG 245 114H AWP Proj: 24914'

Start MD [ft]	End MD [ft]	Positional Uncertainty Model	Log Name/Comment	Wellbore	Survey Date
28.00	1234.00	Gyrodata 2015 - CT+WIR+ALC	01_ <17.5">Gyrodata [CT+WIR+ALC] (115'-1234')	BIG 245 114H AWB	6/1/2022
1234.00	2630.00	OWSG MWD rev2 - Standard	02_ <12.25">OWSG MWD REV.2 [STANDARD] (1234')(1254'- 2630')	BIG 245 114H AWB	6/1/2022
2630.00	7570.00	OWSG MWD rev2 - Standard	03_ <8.75"> OWSG MWD REV.2 [STANDARD] (2630')(2710'-7570')	BIG 245 114H AWB	6/1/2022
7570.00	24914.00	OWSG MWD rev2 + IFR1 + Multi-Station Correction	04_ <8.5">OWSG MWD REV.2 [IFR1+MSA] (7570')(7639'-24889')	BIG 245 114H AWB	6/1/2022

RECEIVED  
Office of Oil and Gas  
JAN 22 2024  
WV Department of  
Environmental Protection



# Actual Wellpath Report

BIG 245 114H AWP Proj: 24914'

Page 14 of 14



## REFERENCE WELLPATH IDENTIFICATION

Operator	EQT PRODUCTION COMPANY	Well	BIG 245 114H (L-004464)
Field	Wetzel	API	47-103-03446-00-00
Facility	Big 245 Pad	Wellbore	BIG 245 114H AWB
Slot	Slot #114		

## COMMENTS

### Wellpath general comments

API: 43103034460000

BH Job #: 111368352

Rig: Patterson 292

Duration: 06/24/2022 - 06/29/2022

01\_<17.5">Gyrodata [CT+WIR+ALC] (115'-1234')

02\_<12.25">OWSG MWD REV.2 [STANDARD] (1234')(1254'- 2630')

03\_<8.75"> OWSG MWD REV.2 [STANDARD] (2630')(2710'-7570')

04\_<8.5">OWSG MWD REV.2 [IFR1+MSA] (7570')(7639'-24889')

KOP = 2742' MD / 2736.54' TVD

Tie on to SDI MWD = 7570' MD / 6933.57' TVD

Marcellus

Landing Point = 8780' MD / 7584.15' TVD

Deepest Point of Well = 21226' MD / 7653.09' TVD

Final Survey = 24889' MD / 7625.89' TVD

Projection to TD = 24914' MD / 7625.73' TVD

RECEIVED  
Office of Oil and Gas  
JAN 22 2024  
WV Department of  
Environmental Protection