

I, the undersigned, hereby certify that this plat is correct to the best of my knowledge and belief and shows all the information required by law and the regulations issued and prescribed by the Department of Environmental Protection.

Ben B. Stoltz
P.S. 2092

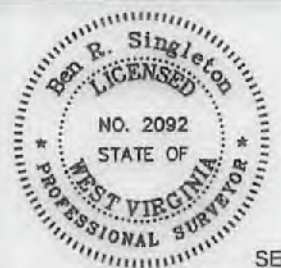

SEAL

FILE NO: 246-18
DRAWING NO: BIG245 112H
SCALE: 1" = 2000'
MINIMUM DEGREE OF ACCURACY: 1:2500
PROVEN SOURCE OF ELEVATION: NGS CORS Station

STATE OF WEST VIRGINIA
DEPARTMENT OF ENVIRONMENTAL PROTECTION
OIL AND GAS DIVISION

DATE: July 08 20 21
OPERATOR'S WELL NO.: BIG245 112H
API WELL NO: 164-47-103-03445
STATE COUNTY PERMIT

WELL TYPE: OIL GAS LIQUID INJECTION WASTE DISPOSAL
(IF GAS) PRODUCTION: STORAGE DEEP SHALLOW
LOCATION: ELEVATION: 1430' WATERSHED: Rockcamp Run of Willey Fork QUADRANGLE: Big Run
DISTRICT: Grant COUNTY: Wetzel
SURFACE OWNER: ET Blue Grass LLC ACREAGE: 136.93
ROYALTY OWNER: Shiben Estates, Inc., et al. LEASE NO: 125397 ACREAGE: 140
PROPOSED WORK: DRILL CONVERT DRILL DEEPER FRACTURE OR STIMULATE PLUG OFF OLD FORMATION
 PERFORATE NEW FORMATION OTHER PHYSICAL CHANGE IN WELL (SPECIFY)
 PLUG AND ABANDON CLEAN OUT AND REPLUG TARGET FORMATION: Marcellus ESTIMATED DEPTH: 7,548'

WELL OPERATOR: EQT Production Company DESIGNATED AGENT: Joseph C. Mallow
ADDRESS: 400 Woodcliff Drive ADDRESS: 115 Professional Place PO Box 280
Canonsburg, PA 15317 Bridgeport, WV 26330

08/20/2021

BIG245 112H
BIG245
EQT Production Company

Tract I.D.	Tax Map No.	Parcel No.	County	District	Surface Tract Owner	Acres
1	8	22	Wetzel	Grant	ET Blue Grass LLC	138.93
2	8	15	Wetzel	Grant	John Michael Byard	71.89
3	8	28	Wetzel	Grant	James A. Yoho	81.00
4	8	28	Wetzel	Grant	Mary Jane Byard	15.00
5	8	32	Wetzel	Grant	Joe Pigg	82.49
6	9	28	Wetzel	Grant	Sharilyn Snider	55.52
7	9	40	Wetzel	Grant	Sharilyn Snider	24.00
8	9	52	Wetzel	Grant	Norman Derby	61.51
9	14	8	Wetzel	Grant	Esther R. Coen	39.50
10	14	10	Wetzel	Grant	John W. Wycoff & Carolyn S. McGill	29.00
11	14	18	Wetzel	Grant	John W. Wycoff & Carolyn S. McGill	86.70
12	14	23	Wetzel	Grant	Equitrans LP	51.00
12	14	29	Wetzel	Grant	Dale C. Eastham, et al.	37.00
14	8	13.1	Wetzel	Grant	Duane M. Goodrich	3.56
15	8	7	Wetzel	Grant	James E. & Martin A. Stoneking	19.12
16	8	8	Wetzel	Grant	Wanda L. Byard	58.16
17	9	22	Wetzel	Grant	James A. Yoho	17.88
18	8	25	Wetzel	Grant	James A. Yoho	8.25
19	8	23	Wetzel	Grant	Dale K. Dolemy, et al.	70.81
20	8	11	Wetzel	Grant	Bonnie M. Heshome	53.50
21	9	53	Wetzel	Grant	Mary E. Wright, et al.	46.00
22	9	27	Wetzel	Grant	James A. Yoho	21.75
23	9	13	Wetzel	Grant	James A. Yoho	27.00
24	9	17	Wetzel	Grant	Leslie Welton	28.08
25	9	23	Wetzel	Grant	Stephen S. & Carolyn M. Gantz	119.00
26	9	29	Wetzel	Grant	William & Margaret Schaefer	47.00
27	8	53	Wetzel	Grant	H. Dom Higginbotham	198.21
28	8	28	Wetzel	Grant	James A. Yoho	23.25
29	9	40	Wetzel	Grant	Sharilyn Snider	24.00
30	8	54	Wetzel	Grant	Sharilyn Snider	20.00
31	9	53	Wetzel	Grant	Norman R. & Vivian L. Derby	32.00
32	9	52.1	Wetzel	Grant	Norman R. & Vivian L. Derby	1.00
33	9	55	Wetzel	Grant	Terril L. & Jason D. Beary	0.81
34	14	7	Wetzel	Grant	Norman Derby	53.00
35	9	54	Wetzel	Grant	Jack L. & Luanna C. Bamside	17.40
36	14	9	Wetzel	Grant	Leonard Rice	55.00
37	14	11	Wetzel	Grant	Thomas J. Parks, et al.	54.44
38	14	18	Wetzel	Grant	Coastal Forest Resources Company	138.08
39	14	17	Wetzel	Grant	John W. Wycoff & Carolyn S. McGill	3.20
40	14	16	Wetzel	Grant	John W. Wycoff & Carolyn S. McGill	1.50
41	14	22	Wetzel	Grant	John W. Wycoff & Carolyn S. McGill	48.00
42	14	25	Wetzel	Grant	Clara Snodgrass	35.88
43	14	21	Wetzel	Grant	EQT Production Company	19.20
44	14	28	Wetzel	Grant	EQT Production Company	50.50
45	14	37	Wetzel	Grant	EQT Production Company	36.80
46	14	29	Wetzel	Grant	ET Blue Grass, LLC	17.00
47	14	30	Wetzel	Grant	Equitrans LP	20.50
48	14	39.5	Wetzel	Grant	Dale C. Eastham, et al.	38.05
49	14	31	Wetzel	Grant	Donald D. Lusky Jr.	19.00
50	14	40	Wetzel	Grant	Donald D. Lusky Jr.	151.08

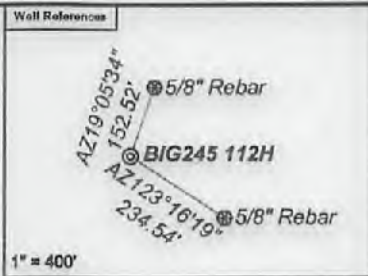

Notes:
BIG245 112H coordinates are
 NAD 27 N: 400,767.94 E: 1,698,793.49
 NAD 27 Lat: 39.595421 Long: -80.568891
 NAD 83 UTM N: 4,382,952.55 E: 537,031.80
BIG245 112H Landing Point coordinates are
 NAD 27 N: 401,339.59 E: 1,700,552.72
 NAD 27 Lat: 39.597048 Long: -80.562673
 NAD 83 UTM N: 4,383,135.67 E: 537,564.88
BIG245 112H Bottom Hole coordinates are
 NAD 27 N: 400,317.38 E: 1,701,166.95
 NAD 27 Lat: 39.594262 Long: -80.560450
 NAD 83 UTM N: 4,382,827.37 E: 537,757.20
 West Virginia Coordinate system of 1927 (North Zone)
 based upon Differential GPS Measurements.
 Plat orientation, corner and well ties are based upon
 the grid north meridian.
 Well location references are based upon the grid north
 meridian.
 UTM coordinates are NAD83, Zone 17, Meters.

- BIG245**
- ⊙ BIG245 114H
 - ⊙ BIG245 112H
 - ⊙ BIG245 110H
 - ⊙ BIG245 108H
 - ⊙ BIG245 106H
 - ⊙ BIG245 104H
 - ⊙ BIG245 102H
- 47-103-03234 ⊙ ⊙ 47-103-03235
 ⊙ 47-103-03236

Lease No.	Owner	Acres
169210000	Liberty Holding Company, Inc.	71.5
125372	Ryan C. Radtka, et al.	61

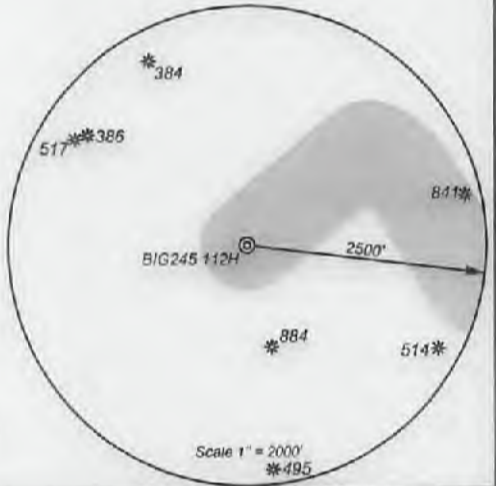

I, the undersigned, hereby certify that this plat is correct to the best of my knowledge and belief and shows all the information required by law and the regulations issued and prescribed by the Department of Environmental Protection.

Ben R. Singleton
 P.S. 2092

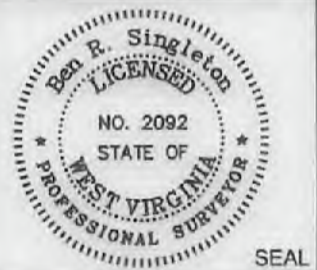

FILE NO: 246-18
 DRAWING NO: BIG245 112H
 SCALE: 1" = 2000'
 MINIMUM DEGREE OF ACCURACY: 1:2500
 PROVEN SOURCE OF ELEVATION: NGS CORS Station



DATE: July 08 20 21
 OPERATOR'S WELL NO.: BIG245 112H
 API WELL NO HGA
 47 - 103 - 03445
 STATE COUNTY PERMIT

WELL TYPE: OIL GAS LIQUID INJECTION WASTE DISPOSAL
 (IF GAS) PRODUCTION: STORAGE DEEP SHALLOW
 LOCATION: ELEVATION: 1430' WATERSHED Rockcamp Run of Willey Fork QUADRANGLE: Big Run
 DISTRICT: Grant COUNTY: Wetzel
 SURFACE OWNER: ET Blue Grass LLC ACREAGE: 138.93
 ROYALTY OWNER: Shiben Estates, Inc., et al. LEASE NO: 125397 ACREAGE: 140
 PROPOSED WORK: DRILL CONVERT DRILL DEEPER FRACTURE OR STIMULATE PLUG OFF OLD FORMATION
 PERFORATE NEW FORMATION OTHER PHYSICAL CHANGE IN WELL (SPECIFY)
 PLUG AND ABANDON CLEAN OUT AND REPLUG TARGET FORMATION: Marcellus ESTIMATED DEPTH: 7,548'

WELL OPERATOR: EQT Production Company DESIGNATED AGENT: Joseph C. Mallow
 ADDRESS: 400 Woodcliff Drive ADDRESS: 115 Professional Place PO Box 280
 Canonsburg, PA 15317 Bridgeport, WV 26330

08/20/2021

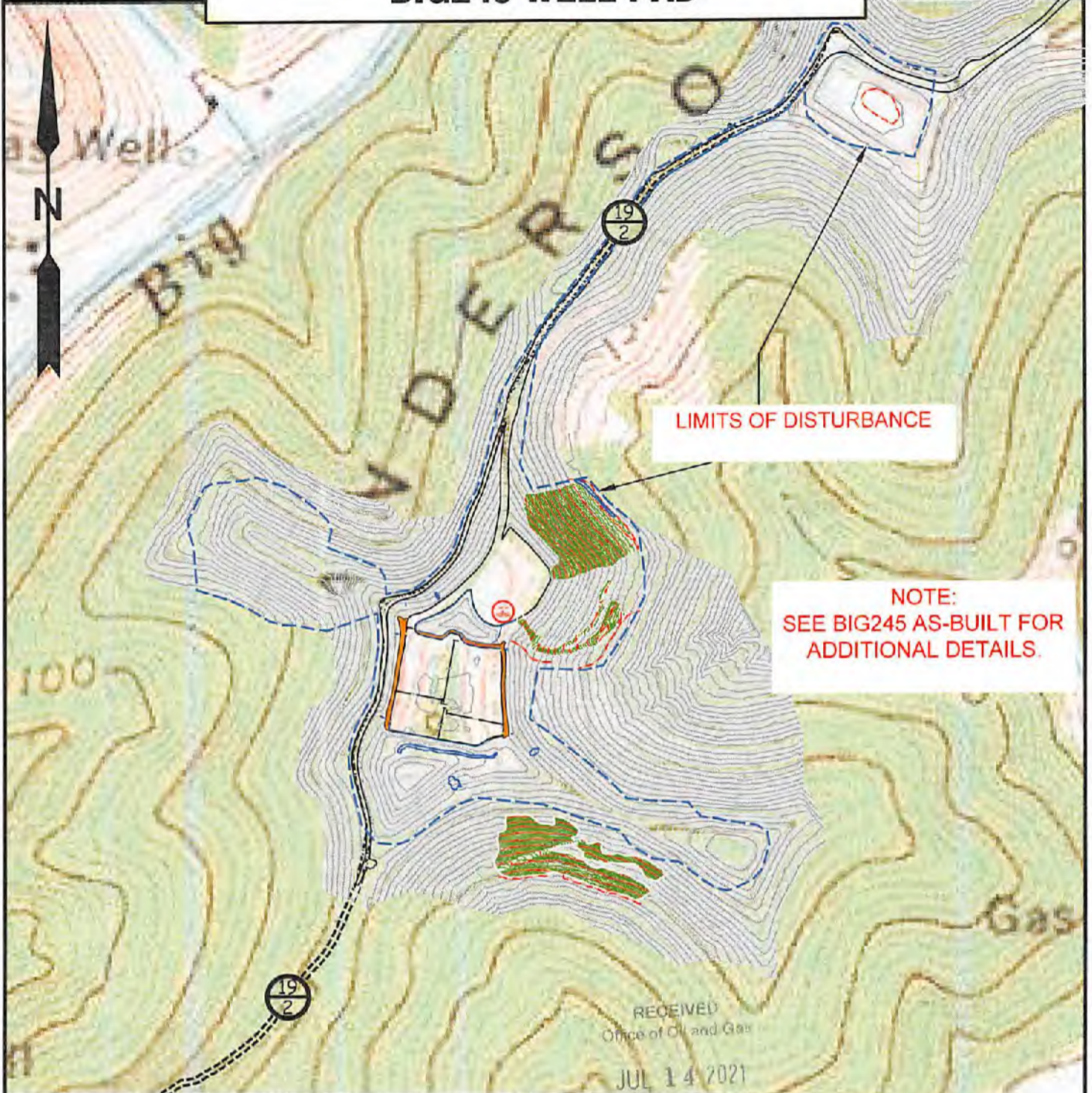

LIMITS OF DISTURBANCE

NOTE:
SEE BIG245 AS-BUILT FOR
ADDITIONAL DETAILS.

Detail Sketch for Proposed BIG245 Wells

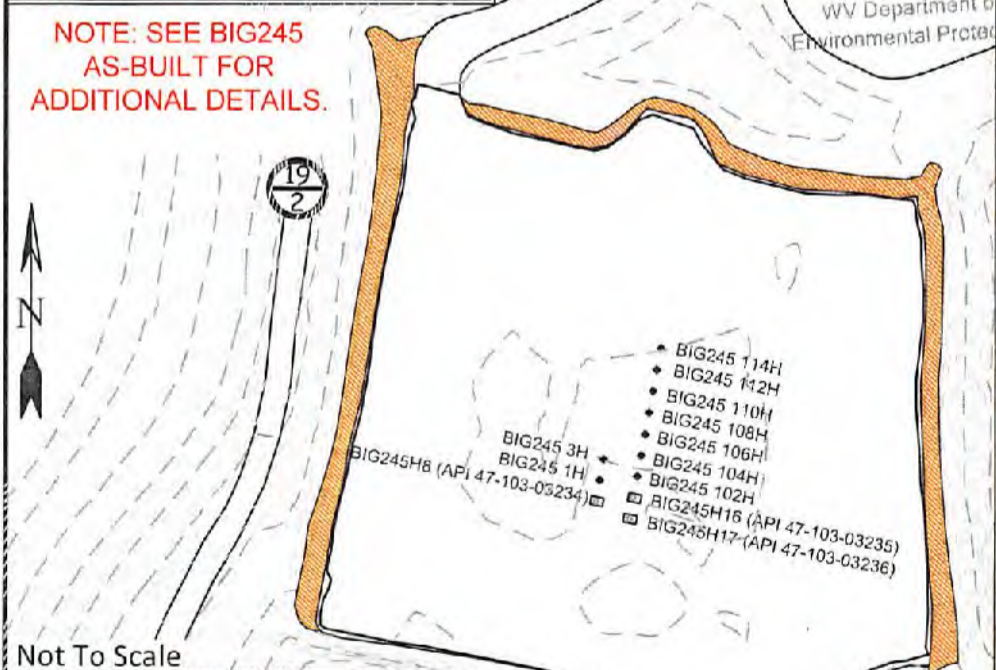

NOTE: SEE BIG245
AS-BUILT FOR
ADDITIONAL DETAILS.

- BIG245 114H
- BIG245 112H
- BIG245 110H
- BIG245 108H
- BIG245 106H
- BIG245 104H
- BIG245 102H
- BIG245 101H
- BIG245 3H
- BIG245 1H
- BIG245H8 (API 47-103-03234)
- BIG245H16 (API 47-103-03235)
- BIG245H17 (API 47-103-03236)

Not To Scale

08/20/2021



© 2010 SLS Environmental Services, Inc. All rights reserved. SLS is a registered service mark of SLS Environmental Services, Inc. SLS is a registered trademark of SLS Environmental Services, Inc. SLS is a registered trademark of SLS Environmental Services, Inc. SLS is a registered trademark of SLS Environmental Services, Inc.

TOPO SECTION OF BIG RUN 7.5'
USGS TOPO QUADRANGLE

SCALE: 1"=500'



DRAWN BY CPM	FILE NO. 7812	DATE 07-08-21	CADD FILE: 7812BIG245R2PLAN-R2.dwg
-----------------	------------------	------------------	---------------------------------------