

Haggard 8H  
Haggard  
EQT Production Company

Tract ID.	Tax Map No.	Parcel No.	County	District	Surface Tract Owner	Acres
1	10	36.0	Wetzel	Center	Amie Lee Henderson	45.50
2	10	37.0	Wetzel	Center	Amie Lee Henderson	14.50
3	10	52.0	Wetzel	Center	John G Miller ET AL	55.50
4	10	38.0	Wetzel	Center	Rusty Lee Morris	43.92
5	10	38.1	Wetzel	Center	David A & Mary A Morris	2.08
6	10	52.2	Wetzel	Center	John G Miller	3.02

Lease	Owner	Acres
186297001	Earnest Howard Cadle, et al.	95
110271016	Vivian Rine, a/k/a Vivian L. Rine, et al.	95.7
131545001	John G. Miller, et al.	55.495

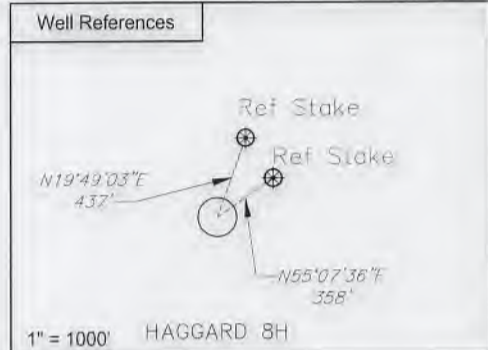
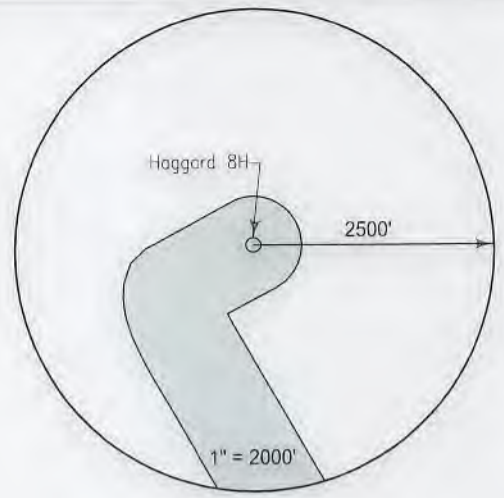

**Notes:**  
HAGGARD 8H coordinates are  
NAD 27 N: 422,366.002 E: 1,684,574.817  
NAD 27 Lat: 39.654239 Long: -80.620300  
NAD 83 UTM N: 4,389,460.196 E: 532,590.256

HAGGARD 8H Landing Point coordinates are  
NAD 27 N: 421,295.618 E: 1,683,929.416  
NAD 27 Lat: 39.651278 Long: -80.622544  
NAD 83 UTM N: 4,389,130.803 E: 532,399.059

HAGGARD 8H Bottom Hole coordinates are  
NAD 27 N: 419,376.334 E: 1,685,044.110  
NAD 27 Lat: 39.646047 Long: -80.618501  
NAD 83 UTM N: 4,388,551.753 E: 532,748.408

West Virginia Coordinates system of 1927 (North Zone)  
based upon Differential GPS Measurements  
Plat orientation, Corner and well ties are based upon  
the grid north meridian  
Well location references are based upon the grid north  
meridian.  
UTM coordinates are NAD83, Zone 17, Meters.

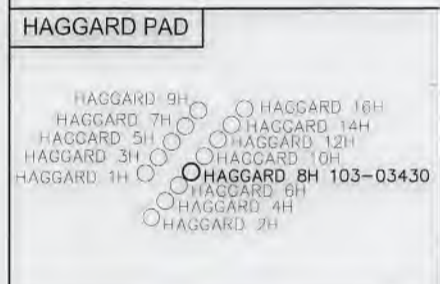

I, the undersigned, hereby certify that this plat is correct to the best of my knowledge and belief and shows all the information required by law and the regulations issued and prescribed by the Department of Environmental Protection.

*Thomas C. Smit*  
L. L. S. 687



FILE NO: W2192 (BK 65-61)  
DRAWING NO:  
SCALE: 1" = 1000'  
MINIMUM DEGREE OF ACCURACY:  
1:2500  
PROVEN SOURCE OF ELEVATION:  
NGS CORS Station



DATE: AUGUST 3 20 22  
OPERATORS WELL NO: Haggard 8H  
API WELL NO: 103 - 03430  
STATE COUNTY PERMIT

WELL TYPE:  OIL  GAS  LIQUID INJECTION  WASTE DISPOSAL  
(IF GAS) PRODUCTION:  STORAGE  DEEP  SHALLOW

LOCATION ELEVATION: 1512' WATERSHED: LOWER WEST VIRGINIA FORK FISH CREEK QUADRANGLE: LITTLETON  
DISTRICT: Center COUNTY: Wetzel

SURFACE OWNER: Amie Lee Henderson ACREAGE: 45.5 ±  
ROYALTY OWNER: Earnest Howard Cadle, et al. LEASE NO: 186297001 ACREAGE: 95 ±

PROPOSED WORK:  DRILL  CONVERT  DRILL DEEPER  FRACTURE OR STIMULATE  PLUG OFF OLD FORMATION  
 PERFORATE NEW FORMATION  OTHER PHYSICAL CHANGE IN WELL (SPECIFY)  
 PLUG AND ABANDON  CLEAN OUT AND REPLUG TARGET FORMATION: Marcellus ESTIMATED DEPTH: 7,618'

WELL OPERATOR: EQT Production Company DESIGNATED AGENT: Joseph C Mallow  
ADDRESS: 400 Woodcliff Drive ADDRESS: 427 Midstate Drive  
Canonsburg, PA 15317 Clarksburg, WV 26301

09/02/2022

Haggard 8H  
Haggard  
EQT Production Company



- NOTES ON SURVEY**
1. COORDINATES SYSTEM IS UTM, NAD 83 DATUM, ZONE 17, U.S. FOOT AND WELL COORDINATES ESTABLISHED USING SURVEY GRADE GPS.
  2. SURFACE AND ROYALTY OWNER INFORMATION AND THEIR BOUNDARIES SHOWN HEREON WERE PLOTTED FROM DEEDS AND/OR TAX PARCEL MAPS PROVIDED BY CLIENT AND FIELD LOCATIONS.
  3. THIS PLAT DOES NOT REPRESENT A BOUNDARY SURVEY OF THE PARCELS SHOWN HEREON.
  4. NO DWELLINGS AND BUILDINGS WITHIN 625 FEET OF PROPOSED CENTER OF PAD.
  5. NO WATER WELLS OR DEVELOPED SPRINGS WITHIN 250 FEET OF PROPOSED WELL.
  6. NO PERENNIAL STREAMS, LAKES, PONDS, RESERVOIRS OR WETLANDS WITHIN 100 FEET OF THE LIMITS OF DISTURBANCE.
  7. NO NATURALLY PRODUCING TROUT STREAM WITHIN 300 FEET OF LIMITS OF DISTURBANCE.

- LEGEND**
- ⊕ Active Well Location
  - ⊕ Proposed Well Location
  - ⊕ Suspended Well
  - ⊕ Surface Tract Identification
  - Proposed Gas Well
  - ⊕ Located Corner, as noted
  - Surface Tract Lines (Surveyed)
  - Surface Tract Lines (Tax Map)
  - Reference Line
  - Lease Boundary
  - Creek or Drain
  - 5 WV County Route
  - 5 WV State Route

(⊕) Denotes Location of Well on United States Topographic Maps



I, the undersigned, hereby certify that this plat is correct to the best of my knowledge and belief and shows all the information required by law and the regulations issued and prescribed by the Department of Environmental Protection.

*Thomas C. Smit*  
L. L. S. 687



SEAL

FILE NO: W2175 (BK 59-37)  
DRAWING NO:  
SCALE: 1" = 2000'  
MINIMUM DEGREE OF ACCURACY: 1:2500  
PROVEN SOURCE OF ELEVATION: NGS CORS Station



DATE: AUGUST 3 20 22  
OPERATORS WELL NO: Haggard 8H  
API WELL NO: 47 - 103 - 03430  
STATE COUNTY PERMIT

WELL TYPE:  OIL  GAS  LIQUID INJECTION  WASTE DISPOSAL  
(IF GAS) PRODUCTION:  STORAGE  DEEP  SHALLOW  
LOCATION ELEVATION: 1512' WATERSHED: LOWER WEST VIRGINIA FORK FISH CREEK QUADRANGLE: LITTLETON  
DISTRICT: Center COUNTY: Wetzel  
SURFACE OWNER: Amie Lee Henderson ACREAGE: 45.5 ±  
ROYALTY OWNER: Earnest Howard Cadle, et al. LEASE NO: 186297001 ACREAGE: 95 ±  
PROPOSED WORK:  DRILL  CONVERT  DRILL DEEPER  FRACTURE OR STIMULATE  PLUG OFF OLD FORMATION  
 PERFORATE NEW FORMATION  OTHER PHYSICAL CHANGE IN WELL (SPECIFY)  
 PLUG AND ABANDON  CLEAN OUT AND REPLUG TARGET FORMATION: Marcellus ESTIMATED DEPTH: 7,618'

09/02/2022

WELL OPERATOR: EQT Production Company DESIGNATED AGENT: Joseph C Mallow  
ADDRESS: 400 Woodcliff Drive ADDRESS: 427 Midstate Drive  
Canonsburg, PA 15317 Clarksburg, WV 26301