

Antero Resources
Well No. Orner 1H
As-Drilled
 Antero Resources Corporation



2,330' to Bottom Hole
 4,587' to Top Hole
TOP HOLE LATITUDE 39 - 32 - 30
BTM HOLE LATITUDE 39 - 30 - 00

Notes
 West Virginia Coordinate System of 1927, North Zone based upon Differential GPS Measurements.
 Well No. Orner Unit 1H Top Hole coordinates are
 N: 376,213.72' Latitude: 39°31'35.27"
 E: 1,654,577.78' Longitude: 80°43'28.54"
 Bottom Hole coordinates are
 N: 359,714.36' Latitude: 39°28'52.48"
 E: 1,656,612.42' Longitude: 80°42'59.72"
 UTM Zone 17, NAD 1983
 Top Hole Coordinates Bottom Hole Coordinates
 N: 4,375,246.641m N: 4,370,230.350m
 E: 523,685.425m E: 524,389.076m
 Plat orientation and corner and well references are based upon the grid north meridian.
 Well location references are based upon the magnetic meridian.

Top Hole Coordinates, As-drilled data, and information was provided by Antero Resources Corporation. Allegheny Surveys Inc. (ASI) is not certifying the data and information provided. ASI is not responsible for any errors or inaccuracies with the data and information that has been provided.

I, the undersigned, hereby certify that this plat is correct to the best of my knowledge and belief and shows all the information required by law and the rules issued and prescribed by the Department of Environmental Protection.

Bradley D. Miller
 Bradley D. Miller, P.S. 2167



Orner Unit 1H As-Drilled POE Coordinates
 West Virginia Coordinate System of 1927, North Zone
 N: 374,404.34'
 E: 1,651,815.66'
 Latitude: 39°31'17.01"
 Longitude: 80°44'03.47"
 UTM Zone 17, NAD 1983
 N: 4,374,681.331m
 E: 522,853.090m

	Bearing	Dist.
L1	S 10°09' E	1,525.2'
L2	S 21°45' W	1,790.0'
L3	N 69°18' W	928.9'
L4	N 18°02' W	1,340.1'

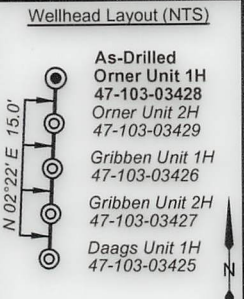

Legend

- Proposed gas well
- Monument, as noted
- Existing Well, as noted
- Digitized Well, as noted
- Creek or Drain
- Road
- Surface boundary (approx.)
- Interior surface tracts (approx.)

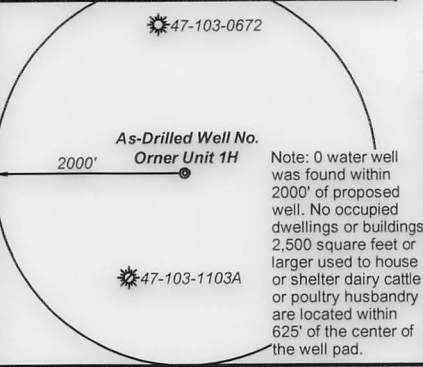

FILE NO: 329-34-G-17
 DRAWING NO: Orner 1H As-Drilled
 SCALE: 1" = 2000'
 MINIMUM DEGREE OF ACCURACY: Submeter
 PROVEN SOURCE OF ELEVATION: CORS, Monroe County, OH

STATE OF WEST VIRGINIA
 DEPARTMENT OF ENVIRONMENTAL PROTECTION
OIL AND GAS DIVISION

DATE: July 12 2022
 OPERATOR'S WELL NO. Orner Unit 1H
 API WELL NO
 47 - 103 - 03428
 STATE COUNTY PERMIT

WELL TYPE: OIL GAS LIQUID INJECTION WASTE DISPOSAL
 (IF GAS) PRODUCTION: STORAGE DEEP SHALLOW

LOCATION: ELEVATION: 1,308' WATERSHED: Fishing Creek QUADRANGLE: TH: Pine Grove BH: Center Point
 DISTRICT: Green Dallison COUNTY: Wetzel
 SURFACE OWNER: Lumber, Inc. Sharon Hoesey Seckman; Christian Engle, et ux; Tribune Resources Minerals, LLC (3); ACREAGE: 208
 ROYALTY OWNER: Joan B. Hoge Trust; Waco Oil & Gas Co. Inc.; Terry Bartrug; Sandra D. Derby; J.M. Mayfield, et al; Shiben Estates, Inc. (2); BRC Appalachian Minerals I, LLC (5); LEASE NO: ACREAGE: 204.7505; 80.725;

PROPOSED WORK: DRILL CONVERT DRILL DEEPER FRACTURE OR STIMULATE PLUG OFF OLD FORMATION
 PERFORATE NEW FORMATION OTHER PHYSICAL CHANGE IN WELL (SPECIFY) As-Drilled 7,211' TVD
 PLUG AND ABANDON CLEAN OUT AND REPLUG TARGET FORMATION: Marcellus Shale ESTIMATED DEPTH: 23,718' MD

WELL OPERATOR: Antero Resources Corporation DESIGNATED AGENT: Dianna Stamper - CT Corporation System
 ADDRESS: 1615 Wynkoop Street ADDRESS: 5400 D Big Tyler Road
 Denver, CO 80202 Charleston, WV 25313



Leases	
A	Joan B. Hoge Trust
B	Waco Oil & Gas Company Inc.
C	BRC Appalachian Minerals I, LLC
D	Terry Bartrug
E	BRC Appalachian Minerals I, LLC
F	BRC Appalachian Minerals I, LLC
G	Sandra D. Derby
H	William J. Walker
I	J.M. Mayfield, et al
J	Shiben Estates, Inc.
K	Shiben Estates, Inc.
L	BRC Appalachian Minerals I, LLC
M	J.W. & A.B. Haught
N	Christian Engle, et ux
O	Tribune Resources Minerals, LLC
P	BRC Appalachian Minerals I, LLC
Q	Tribune Resources Minerals, LLC
R	Tribune Resources Minerals, LLC
S	Kimberly A. Hoskins, et vir
T	Sharon Hosey Seckman
U	Tribune Resources Minerals, LLC
V	Tribune Resources Minerals, LLC
W	BRC Appalachian Minerals I LLC

ID	TM/Par	Owner	Bk/Pg	Acres
1	20-13	Dallison Lumber Inc.	440/243	208.00
2	20-12	Terry Bartrug	361/465	92.90
3	20-24	Lloyd Conley	355/553	89.00
4	20-16	Coastal Forest Resources Co.	444/105	75.50
5	20-30	Sandra D. Derby	384/585	21.50
6	20-40	Sandra D. Derby	384/585	3.50
7	20-31	Tony E. & Marion L. Crabtree	365/337	68.95
8	20-41	Sandra D. Derby	384/585	7.96
9	20-42	Sandra D. Derby	384/585	21.80
10	22-40	Robert L. Jr. & Donna Jones	436/692	16.00
11	22-5	Robert L. Jr. & Donna K. Jones	297/500	76.00
12	22-14.1	Tony E. & Marion L. Crabtree	365/337	41.80
13	22-6	Denzil W. Sloan	305/582	21.23
14	22-14	Denzil W. Sloan	305/582	9.47
15	22-18	Timothy L. & Vicki L. Glasscock	370/425	99.89
16	22-19	Coastal Forest Resources Co.	444/105	155.30
17	22-20	Lawrence J. Bish, et al	420/736	63.23
18	22-21.1	Thomas & Shawn Pratt	429/66	6.80
19	22-21.2	Thomas R. & Shon T. Pratt	312/697	23.00
20	22-34	Coastal Forest Resources Co.	444/105	172.91
21	22-28	Coastal Forest Resources Co.	444/105	77.10
22	22-27	Dominic J. & Delmer M. Kowalski	353/533	20.30
23	22-33	Dominic J. & Delmer M. Kowalski	353/533	20.30
24	3-11	Dominic J. & Delmer M. Kowalski	317/307	106.94
25	25-3	Coastal Forest Resources Co.	444/105	32.00
26	25-5	Christopher & Dennis Doyle	410/80	39.36
27	3-12	David Schulte, et al	WB14/440	80.73
28	25-12	Christopher & Dennis Doyle	410/80	9.50
29	25-13	Christopher & Dennis Doyle	410/80	38.50
30	25-10	Christopher & Dennis Doyle	410/80	13.00
31	25-14	Christopher & Dennis Doyle	410/80	11.00
32	25-15	Coastal Forest Resources Co.	444/105	2.30
33	25-16	Coastal Forest Resources Co.	444/105	139.57
34	3-13	William Blankenship	292/155	83.47

FILE NO: 329-34-G-17
 DRAWING NO: Orner 1H As-Drilled
 SCALE: 1" = 2000'
 MINIMUM DEGREE OF ACCURACY:
 Submeter
 PROVEN SOURCE OF ELEVATION:
 CORS, Monroe County, OH



DATE: July 12 2022
 OPERATOR'S WELL NO. Orner Unit 1H
 API WELL NO
 47 - 103 - 03428
 STATE COUNTY PERMIT

WELL TYPE: OIL GAS LIQUID INJECTION WASTE DISPOSAL
 (IF GAS) PRODUCTION: STORAGE DEEP SHALLOW

LOCATION: ELEVATION: 1,308' WATERSHED: Fishing Creek QUADRANGLE: TH: Pine Grove
 BH: Center Point
 DISTRICT: Green Dallison Sharon Hosey Seckman; COUNTY: Wetzel 200; 23.0; 137.9125;
 SURFACE OWNER: Lumber, Inc. Christian Engle, et ux; Tribune Resources Minerals, LLC (3); 92.904; 62.23125; 20;
 ROYALTY OWNER: Joan B. Hoge Trust; Waco Oil & Gas Co. Inc.; Terry Bartrug; Sandra D. Derby; J.M. Mayfield, et al; Shiben Estates, Inc. (2); BRC Appalachian Minerals I, LLC (5); ACREAGE: 208 76; 47.5; 25; 38.5; 89;
 LEASE NO: ACRES: 204.7505; 80.725; 9.25; 39; 244; 68.9563;
 PROPOSED WORK: DRILL CONVERT DRILL DEEPER FRACTURE OR STIMULATE PLUG OFF OLD FORMATION
 PERFORATE NEW FORMATION OTHER PHYSICAL CHANGE IN WELL (SPECIFY) As-Drilled 7.211' TVD
 PLUG AND ABANDON CLEAN OUT AND REPLUG TARGET FORMATION: Marcellus Shale ESTIMATED DEPTH: 23,718' MD

WELL OPERATOR: Antero Resources Corporation DESIGNATED AGENT: Dianna Stamper - CT Corporation System
 ADDRESS: 1615 Wynkoop Street ADDRESS: 5400 D Big Tyler Road
 Denver, CO 80202 Charleston, WV 25313