

2,278' to Bottom Hole

4,587' to Top Hole

TOP HOLE LATITUDE 39 - 32 - 30
BTM HOLE LATITUDE 39 - 30 - 00

LONGITUDE 80 - 42 - 30

5,537' to Top Hole

6,821' to Bottom Hole

Antero Resources
Well No. Orner 1H
BHL MOD
Antero Resources Corporation

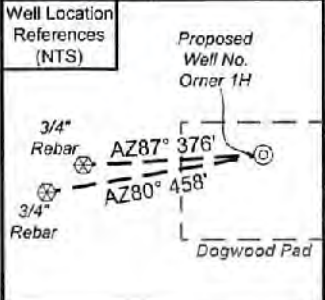

I, the undersigned, hereby certify that this plat is correct to the best of my knowledge and belief and shows all the information required by law and the rules issued and prescribed by the Department of Environmental Protection.

Bradley D. Miller
Bradley D. Miller, P.S. 2167



SEAL

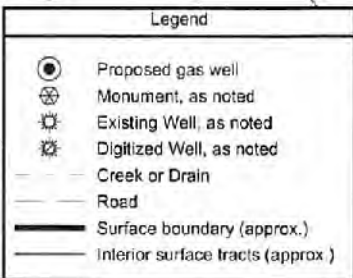
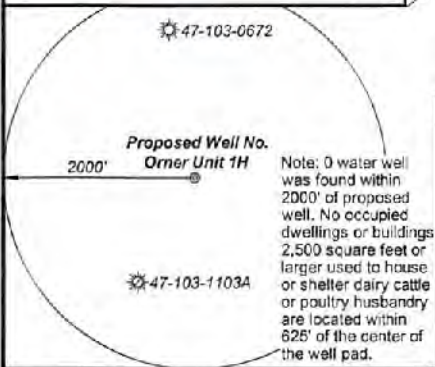

Notes
West Virginia Coordinate System of 1927, North Zone based upon Differential GPS Measurements.
Well No. Orner Unit 1H Top Hole coordinates are
N: 376,214.07' Longitude: 80°31'35.27"
E: 1,654,577.56' Longitude: 80°43'28.54"
Bottom Hole coordinates are
N: 359,724.37' Latitude: 39°28'52.58"
E: 1,656,665.11' Longitude: 80°42'59.05"
UTM Zone 17, NAD 1983
Top Hole Coordinates: Bottom Hole Coordinates
N: 4,375,246.746m N: 4,370,233.668m
E: 523,685.356m E: 524,405.078m
Plat orientation and corner and well references are based upon the grid north meridian.
Well location references are based upon the magnetic meridian.

Notes:
Well No. Orner Unit 1H
UTM Zone 17, NAD 1927
Top Hole Coordinates
N: 14,353,739.90'
E: 1,718,076.51'
Point of Entry Coordinates
N: 14,352,201.47'
E: 1,715,238.74'
Bottom Hole Coordinates
N: 14,337,292.86'
E: 1,720,438.16'

| | Bearing | Dist. |
|----|------------|----------|
| L1 | S 10°09' E | 1,524.8' |
| L2 | S 21°45' W | 1,789.7' |
| L3 | N 89°17' W | 929.3' |
| L4 | N 18°02' W | 1,340.5' |
| L5 | S 62°30' W | 3,229.1' |

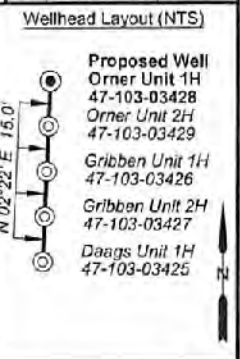

FILE NO: 329-34-G-17
DRAWING NO: Orner 1H BHL MOD
SCALE: 1" = 2000'
MINIMUM DEGREE OF ACCURACY: Submeter
PROVEN SOURCE OF ELEVATION: CORS, Monroe County, OH

STATE OF WEST VIRGINIA
DEPARTMENT OF ENVIRONMENTAL PROTECTION
OIL AND GAS DIVISION

DATE: October 1 2021
OPERATOR'S WELL NO. Orner Unit 1H
API WELL NO. **MO**
47 - 103 - 03428
STATE COUNTY PERMIT

WELL TYPE: OIL GAS LIQUID INJECTION WASTE DISPOSAL
(IF GAS) PRODUCTION: STORAGE DEEP SHALLOW

LOCATION: ELEVATION: 1,308' WATERSHED: Fishing Creek

QUADRANGLE: TH: Pine Grove BH: Center Point

DISTRICT: Green Dallison
SURFACE OWNER: Lumber, Inc.

Sharon Hoesy Seckman;
Christian Engle, et ux; Tribune Resources Minerals, LLC (3);
J.M. Mayfield, et al; Shiben Estates, Inc. (2); BRC Appalachian Minerals I, LLC (5);

COUNTY: **Wetzel**
ACREAGE: 208
ACREAGE: 204.7505; 80.725;

ROYALTY OWNER: Joan B. Hoge Trust; Waco Oil & Gas Co., Inc.; Terry Bartrug; Sandra D. Darby; LEASE NO: ACREAGE: 204.7505; 80.725;
PROPOSED WORK: DRILL CONVERT DRILL DEEPER FRACTURE OR STIMULATE PLUG OFF OLD FORMATION
 PERFORATE NEW FORMATION OTHER PHYSICAL CHANGE IN WELL (SPECIFY) BHL MOD

PLUG AND ABANDON CLEAN OUT AND REPLUG TARGET FORMATION: Marcellus Shale ESTIMATED DEPTH: 7,600' TVD 27,300' MD

WELL OPERATOR: Antero Resources Corporation
ADDRESS: 1615 Wynkoop Street
Denver, CO 80202

DESIGNATED AGENT: Dianna Stamper - CT Corporation System
ADDRESS: 5400 D Big Tyler Road
Charleston, WV 25313

11/05/2021

Antero Resources
Well No. Orner 1H
BHL MOD

Antero Resources Corporation



| Leases | |
|--------|---------------------------------|
| A | Joan B. Hoge Trust |
| B | Waco Oil & Gas Company Inc. |
| C | BRC Appalachian Minerals I, LLC |
| D | Terry Bartrug |
| E | BRC Appalachian Minerals I, LLC |
| F | BRC Appalachian Minerals I, LLC |
| G | Sandra D. Derby |
| H | William J. Walker |
| I | J.M. Mayfield, et al |
| J | Shiben Estates, Inc. |
| K | Shiben Estates, Inc. |
| L | BRC Appalachian Minerals I, LLC |
| M | J.W. & A.B. Haught |
| N | Christian Engle, et ux |
| O | Tribune Resources Minerals, LLC |
| P | BRC Appalachian Minerals I, LLC |
| Q | Tribune Resources Minerals, LLC |
| R | Tribune Resources Minerals, LLC |
| S | Kimberly A. Hoskins, et vir |
| T | Sharon Hosey Seckman |
| U | Tribune Resources Minerals, LLC |
| V | Tribune Resources Minerals, LLC |
| W | BRC Appalachian Minerals I LLC |

| ID | TM/Par | Owner | Bk/Pg | Acres |
|----|---------|---------------------------------|----------|--------|
| 1 | 20-13 | Dallison Lumber Inc. | 440/243 | 208.00 |
| 2 | 20-12 | Terry Bartrug | 361/465 | 92.90 |
| 3 | 20-24 | Lloyd Conley | 355/553 | 89.00 |
| 4 | 20-16 | Coastal Forest Resources Co. | 444/105 | 75.50 |
| 5 | 20-30 | Sandra D. Derby | 384/585 | 21.50 |
| 6 | 20-40 | Sandra D. Derby | 384/585 | 3.50 |
| 7 | 20-31 | Tony E. & Marion L. Crabtree | 365/337 | 68.95 |
| 8 | 20-41 | Sandra D. Derby | 384/585 | 7.96 |
| 9 | 20-42 | Sandra D. Derby | 384/585 | 21.80 |
| 10 | 22-40 | Robert L. Jr. & Donna Jones | 436/692 | 16.00 |
| 11 | 22-5 | Robert L. Jr. & Donna K. Jones | 297/500 | 76.00 |
| 12 | 22-14.1 | Tony E. & Marion L. Crabtree | 365/337 | 41.80 |
| 13 | 22-6 | Denzil W. Sloan | 305/582 | 21.23 |
| 14 | 22-14 | Denzil W. Sloan | 305/582 | 9.47 |
| 15 | 22-18 | Timothy L. & Vicki L. Glasscock | 370/425 | 99.89 |
| 16 | 22-19 | Coastal Forest Resources Co. | 444/105 | 155.30 |
| 17 | 22-20 | Lawrence J. Bish, et al | 420/736 | 63.23 |
| 18 | 22-21.1 | Thomas & Shawn Pratt | 429/66 | 6.80 |
| 19 | 22-21.2 | Thomas R. & Shen T. Pratt | 312/697 | 23.00 |
| 20 | 22-34 | Coastal Forest Resources Co. | 444/105 | 172.91 |
| 21 | 22-28 | Coastal Forest Resources Co. | 444/105 | 77.10 |
| 22 | 22-27 | Dominic J. & Delmer M. Kowalski | 353/533 | 20.30 |
| 23 | 22-33 | Dominic J. & Delmer M. Kowalski | 353/533 | 20.30 |
| 24 | 3-11 | Dominic J. & Delmer M. Kowalski | 317/307 | 106.94 |
| 25 | 25-3 | Coastal Forest Resources Co. | 444/105 | 32.00 |
| 26 | 25-5 | Christopher & Dennis Doyle | 410/80 | 39.36 |
| 27 | 3-12 | David Schulte, et al | WB14/440 | 60.73 |
| 28 | 25-12 | Christopher & Dennis Doyle | 410/80 | 9.50 |
| 29 | 25-13 | Christopher & Dennis Doyle | 410/80 | 38.50 |
| 30 | 25-10 | Christopher & Dennis Doyle | 410/80 | 13.00 |
| 31 | 25-14 | Christopher & Dennis Doyle | 410/80 | 11.00 |
| 32 | 25-15 | Coastal Forest Resources Co. | 444/105 | 2.30 |
| 33 | 25-16 | Coastal Forest Resources Co. | 444/105 | 139.57 |
| 34 | 3-13 | William Blankenship | 292/155 | 83.47 |

FILE NO: 329-34-G-17
 DRAWING NO: Orner 1H BHL MOD
 SCALE: 1" = 2000'
 MINIMUM DEGREE OF ACCURACY:
 Submeter
 PROVEN SOURCE OF ELEVATION:
 CORS, Monroe County, OH

STATE OF WEST VIRGINIA
 DEPARTMENT OF ENVIRONMENTAL PROTECTION
OIL AND GAS DIVISION

DATE: October 1 2021
 OPERATOR'S WELL NO. Orner Unit 1H
 API WELL NO **MOD**
 47 - 103 - 03428
 STATE COUNTY PERMIT

WELL TYPE: OIL GAS LIQUID INJECTION WASTE DISPOSAL
 (IF GAS) PRODUCTION: STORAGE DEEP SHALLOW

LOCATION: ELEVATION: 1,308' WATERSHED: Fishing Creek QUADRANGLE: TH: Pine Grova BH: Center Point
 DISTRICT: Green Dallison COUNTY: Wetzel 11/05/2021

SURFACE OWNER: Lumber, Inc. Sharon Hosey Seckman; Edward William Schulte; Christian Engle, et ux; Tribune Resources Minerals, LLC (2); J.M. Mayfield, et al; Shiben Estates, Inc. (2); BRC Appalachian Minerals I, LLC (5); ACREAGE: 208 76; 47.5; 25; 38.5; 89; 9.25; 39; 244; 88.9563;
 ROYALTY OWNER: Joan B. Hoge Trust; Waco Oil & Gas Co. Inc.; Terry Bartrug; Sandra D. Derby; LEASE NO: ACREAGE: 204.7505; 80.725;

PROPOSED WORK: DRILL CONVERT DRILL DEEPER FRACTURE OR STIMULATE PLUG OFF OLD FORMATION
 PERFORATE NEW FORMATION OTHER PHYSICAL CHANGE IN WELL (SPECIFY) BHL MOD
 PLUG AND ABANDON CLEAN OUT AND REPLUG TARGET FORMATION: Marcellus Shale ESTIMATED DEPTH: 7,600' TVD
27,300' MD

WELL OPERATOR: Antero Resources Corporation DESIGNATED AGENT: Dianna Stamper - CT Corporation System
 ADDRESS: 1615 Wynkoop Street ADDRESS: 5400 D Big Tyler Road
 Denver, CO 80202 Charleston, WV 25313

2,278' to Bottom Hole

4,587' to Top Hole

TOP HOLE LATITUDE 39 - 32 - 30
BTM HOLE LATITUDE 39 - 30 - 00

Notes
West Virginia Coordinate System of 1927, North Zone based upon Differential GPS Measurements.
Well No. Orner Unit 1H Top Hole coordinates are:
N: 376,214.07 Latitude: 39°31'35.27"
E: 1,654,577.56 Longitude: 80°43'26.54"
Bottom Hole coordinates are:
N: 359,724.37 Latitude: 39°28'52.58"
E: 1,656,685.11 Longitude: 80°42'59.05"
UTM Zone 17, NAD 1983
Top Hole Coordinates: Bottom Hole Coordinates
N: 4,375,246.746m N: 4,370,233.663m
E: 523,685.356m E: 524,405.078m
Plat orientation and corner and well references are based upon the grid north meridian.
Well location references are based upon the magnetic meridian.

LONGITUDE 80 - 42 - 30

5,537' to Top Hole
6,821' to Bottom Hole

Sheet 1 of 2

47-103-672

Proposed Well No. Orner Unit 1H

Antero Resources
Well No. Orner 1H
BHL MOD
Antero Resources Corporation



Well Location References (NTS)

Proposed Well No. Orner 1H

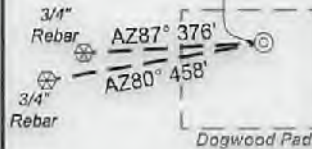

I, the undersigned, hereby certify that this plat is correct to the best of my knowledge and belief and shows all the information required by law and the rules issued and prescribed by the Department of Environmental Protection.

Bradley D. Miller, P.S. 2167



SEAL

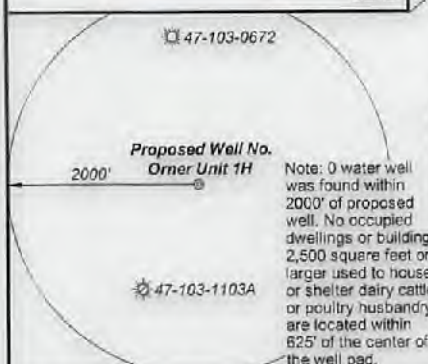

Note: 0 water well was found within 2000' of proposed well. No occupied dwellings or buildings 2,500 square feet or larger used to house or shelter dairy cattle or poultry husbandry are located within 625' of the center of the well pad.

Legend

- Proposed gas well
- Monument, as noted
- Existing Well, as noted
- Digitized Well, as noted
- Creek or Drain
- Road
- Surface boundary (approx.)
- Interior surface tracts (approx.)

Notes:
Well No. Orner Unit 1H
UTM Zone 17, NAD 1927
Top Hole Coordinates
N: 14,353,739.90
E: 1,718,076.51
Point of Entry Coordinates
N: 14,352,201.47
E: 1,715,238.74
Bottom Hole Coordinates
N: 14,337,292.96
E: 1,720,438.16

| Bearing | Dist. |
|---------------|----------|
| L1 S 10°09' E | 1,524.8' |
| L2 S 21°45' W | 1,789.7' |
| L3 N 69°17' W | 929.3' |
| L4 N 18°02' W | 1,340.5' |
| L5 S 62°30' W | 3,229.1' |

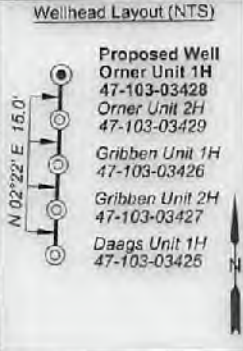

FILE NO: 329-34-G-17
DRAWING NO: Orner 1H BHL MOD
SCALE: 1" = 2000'
MINIMUM DEGREE OF ACCURACY: Submeter
PROVEN SOURCE OF ELEVATION: CORS, Monroe County, OH

STATE OF WEST VIRGINIA
DEPARTMENT OF ENVIRONMENTAL PROTECTION
OIL AND GAS DIVISION

DATE: October 1 2021
OPERATOR'S WELL NO. Orner Unit 1H
API WELL NO MOD
47 - 103 - 03428
STATE COUNTY PERMIT

WELL TYPE: OIL GAS LIQUID INJECTION WASTE DISPOSAL
(IF GAS) PRODUCTION: STORAGE DEEP SHALLOW
LOCATION: ELEVATION: 1,308' WATERSHED: Fishing Creek QUADRANGLE: Pine Grove
DISTRICT: Green Dallison Sharon Hosey Seckman; Christian Engle, et ux; Tribune Resources Minerals, LLC (3); J.M. Mayfield, et al; Shiben Estates, Inc. (2); BRC Appalachian Minerals I, LLC (5)
SURFACE OWNER: Lumber, Inc. COUNTY: Wayne
ROYALTY OWNER: Joan B. Hoge Trust; Waco Oil & Gas Co. Inc.; Terry Bartrug, Sandra D. Derby; LEASE NO: ACREAGE: 208
PROPOSED WORK: DRILL CONVERT DRILL DEEPER FRACTURE OR STIMULATE PLUG OFF OLD FORMATION
 PERFORATE NEW FORMATION OTHER PHYSICAL CHANGE IN WELL (SPECIFY) BHL MOD
 PLUG AND ABANDON CLEAN OUT AND REPLUG TARGET FORMATION: Marcellus Shale ESTIMATED DEPTH: 27,300' MD

WELL OPERATOR: Antero Resources Corporation DESIGNATED AGENT: Dianna Stamper - CT Corporation System
ADDRESS: 1615 Wynkoop Street ADDRESS: 5400 D Big Tyler Road
Denver, CO 80202 Charleston, WV 25313

Antero Resources
Well No. Orner 1H
BHL MOD

Antero Resources Corporation



| Leases | |
|--------|---------------------------------|
| A | Joan B. Hoge Trust |
| B | Waco Oil & Gas Company Inc. |
| C | BRC Appalachian Minerals I, LLC |
| D | Terry Bartrug |
| E | BRC Appalachian Minerals I, LLC |
| F | BRC Appalachian Minerals I, LLC |
| G | Sandra D. Derby |
| H | William J. Walker |
| I | J.M. Mayfield, et al |
| J | Shiben Estates, Inc. |
| K | Shiben Estates, Inc. |
| L | BRC Appalachian Minerals I, LLC |
| M | J.W. & A.B. Haught |
| N | Christian Engle, et ux |
| O | Tribune Resources Minerals, LLC |
| P | BRC Appalachian Minerals I, LLC |
| Q | Tribune Resources Minerals, LLC |
| R | Tribune Resources Minerals, LLC |
| S | Kimberly A. Hoskins, et vir |
| T | Sharon Hosey Seckman |
| U | Tribune Resources Minerals, LLC |
| V | Tribune Resources Minerals, LLC |
| W | BRC Appalachian Minerals I, LLC |

| ID | TM/Par | Owner | Bk/Pg | Acres |
|----|---------|---------------------------------|----------|--------|
| 1 | 20-13 | Dallison Lumber Inc. | 440/243 | 208.00 |
| 2 | 20-12 | Terry Bartrug | 361/485 | 92.90 |
| 3 | 20-24 | Lloyd Conley | 355/553 | 89.00 |
| 4 | 20-16 | Coastal Forest Resources Co. | 444/105 | 75.50 |
| 5 | 20-30 | Sandra D. Derby | 384/585 | 21.50 |
| 6 | 20-40 | Sandra D. Derby | 384/585 | 3.50 |
| 7 | 20-31 | Tony E. & Marion L. Crabtree | 365/337 | 68.95 |
| 8 | 20-41 | Sandra D. Derby | 384/585 | 7.96 |
| 9 | 20-42 | Sandra D. Derby | 384/585 | 21.80 |
| 10 | 22-40 | Robert L. Jr. & Donna Jones | 436/692 | 16.00 |
| 11 | 22-5 | Robert L. Jr. & Donna K. Jones | 297/500 | 76.00 |
| 12 | 22-14.1 | Tony E. & Marion L. Crabtree | 365/337 | 41.80 |
| 13 | 22-6 | Denzil W. Sloan | 305/582 | 21.23 |
| 14 | 22-14 | Denzil W. Sloan | 305/582 | 9.47 |
| 15 | 22-18 | Timothy L. & Vicki L. Glasscock | 370/425 | 99.89 |
| 16 | 22-19 | Coastal Forest Resources Co. | 444/105 | 155.30 |
| 17 | 22-20 | Lawrence J. Bish, et al | 420/736 | 63.23 |
| 18 | 22-21.1 | Thomas & Shawn Pratt | 429/66 | 6.80 |
| 19 | 22-21.2 | Thomas R. & Shon T. Pratt | 312/697 | 23.00 |
| 20 | 22-34 | Coastal Forest Resources Co. | 444/105 | 172.91 |
| 21 | 22-28 | Coastal Forest Resources Co. | 444/105 | 77.10 |
| 22 | 22-27 | Dominic J. & Delmer M. Kowalski | 353/533 | 20.30 |
| 23 | 22-33 | Dominic J. & Delmer M. Kowalski | 353/533 | 20.30 |
| 24 | 3-11 | Dominic J. & Delmer M. Kowalski | 317/307 | 106.94 |
| 25 | 25-3 | Coastal Forest Resources Co. | 444/105 | 32.00 |
| 26 | 25-5 | Christopher & Dennis Doyle | 410/80 | 39.96 |
| 27 | 3-12 | David Schulte, et al | WB14/440 | 80.73 |
| 28 | 25-12 | Christopher & Dennis Doyle | 410/80 | 9.50 |
| 29 | 25-13 | Christopher & Dennis Doyle | 410/80 | 38.50 |
| 30 | 25-10 | Christopher & Dennis Doyle | 410/80 | 13.00 |
| 31 | 25-14 | Christopher & Dennis Doyle | 410/80 | 11.00 |
| 32 | 25-15 | Coastal Forest Resources Co. | 444/105 | 2.30 |
| 33 | 25-16 | Coastal Forest Resources Co. | 444/105 | 139.57 |
| 34 | 3-13 | William Blankenship | 292/155 | 83.47 |

FILE NO: 329-34-G-17
 DRAWING NO: Orner 1H BHL MOD
 SCALE: 1" = 2000'
 MINIMUM DEGREE OF ACCURACY:
 Submeter
 PROVEN SOURCE OF ELEVATION:
 CORS, Monroe County, OH

STATE OF WEST VIRGINIA
 DEPARTMENT OF ENVIRONMENTAL PROTECTION
OIL AND GAS DIVISION

DATE: October 1 2021
 OPERATOR'S WELL NO. Orner Unit 1H
 API WELL NO **MAP**
 47 - 103 - 03428
 STATE COUNTY PERMIT

WELL TYPE: OIL GAS LIQUID INJECTION WASTE DISPOSAL
 (IF GAS) PRODUCTION: STORAGE DEEP SHALLOW
 LOCATION: ELEVATION: 1,308' WATERSHED: Fishing Creek QUADRANGLE: TH: Pine Grove BH: Center Point
 DISTRICT: Green Dallison COUNTY: Wayne
 SURFACE OWNER: Lumber, Inc. Sharon Hosey Seckman; Edward William Schulte; Christian Engle, et ux; Tribune Resources Minerals, LLC (2); J.M. Mayfield, et al; Shiben Estates, Inc. (2); BRC Appalachian Minerals I, LLC (5);
 ROYALTY OWNER: Joan B. Hoge Trust; Waco Oil & Gas Co. Inc.; Terry Bartrug; Sandra D. Derby; LEASE NO: ACREAGE: 208
 PROPOSED WORK: DRILL CONVERT DRILL DEEPER FRACTURE OR STIMULATE PLUG OFF OLD FORMATION
 PERFORATE NEW FORMATION OTHER PHYSICAL CHANGE IN WELL (SPECIFY) BHL MOD
 PLUG AND ABANDON CLEAN OUT AND REPLUG TARGET FORMATION: Marcellus Shale ESTIMATED DEPTH: 7,600' TVD 27,300' MD

WELL OPERATOR: Antero Resources Corporation DESIGNATED AGENT: Dianna Stamper - CT Corporation System
 ADDRESS: 1615 Wynkoop Street ADDRESS: 5400 D Big Tyler Road
 Denver, CO 80202 Charleston, WV 25313