

State of West Virginia
Department of Environmental Protection - Office of Oil and Gas
Well Operator's Report of Well Work

API 47 - 103 - 03425 County Wetzel District Green
Quad TH:Pine Grove BH: Center Point Pad Name Dogwood Field/Pool Name -----
Farm name Dallison Lumber, Inc Well Number Daags Unit 1H
Operator (as registered with the OOG) Antero Resources Corporation
Address 1615 Wynkoop Street City Denver State CO Zip 80202

As Drilled location NAD 83/UTM Attach an as-drilled plat, profile view, and deviation survey
Top hole Northing 4375228m Easting 523685m
Landing Point of Curve Northing 4375198.54m Easting 523732.69m
Bottom Hole Northing 4371982m Easting 524854m

Elevation (ft) 1308' GL Type of Well New Existing Type of Report Interim Final
Permit Type Deviated Horizontal Horizontal 6A Vertical Depth Type Deep Shallow
Type of Operation Convert Deepen Drill Plug Back Redrilling Rework Stimulate
Well Type Brine Disposal CBM Gas Oil Secondary Recovery Solution Mining Storage Other _____
Type of Completion Single Multiple Fluids Produced Brine Gas NGL Oil Other _____
Drilled with Cable Rotary

Drilling Media Surface hole Air Mud Fresh Water Intermediate hole Air Mud Fresh Water Brine
Production hole Air Mud Fresh Water Brine
Mud Type(s) and Additive(s)
Air - Foam & 4% KCL
Mud - Polymer

RECEIVED
Office of Oil and Gas
FEB 07 2023
WV Department of
Environmental Protection

Date permit issued 8/23/2021 Date drilling commenced 10/24/2021 Date drilling ceased 12/27/2021
Date completion activities began 2/5/2022 Date completion activities ceased 4/23/2022
Verbal plugging (Y/N) N/A Date permission granted N/A Granted by N/A

Please note: Operator is required to submit a plugging application within 5 days of verbal permission to plug

Freshwater depth(s) ft 539' Open mine(s) (Y/N) depths No
Salt water depth(s) ft 2341' Void(s) encountered (Y/N) depths No
Coal depth(s) ft 815' Cavern(s) encountered (Y/N) depths No
Is coal being mined in area (Y/N) No

APPROVED

Reviewed by: _____
3/17/2023

API 47- 103 - 03425 Farm name Dallison Lumber, Inc Well number Daags Unit 1H

| CASING STRINGS | Hole Size | Casing Size | Depth | New or Used | Grade wt/ft | Basket Depth(s) | Did cement circulate (Y/ N) * Provide details below* |
|---------------------------|---------------|-------------|--------|-------------|-------------|-----------------|---|
| Conductor | 24" | 20" | 80' | New | 94#, H-40 | N/A | Y |
| Surface | 17-1/2" | 13-3/8" | 635' | New | 54.5#, J-55 | N/A | Y |
| Coal | | | | | | | |
| Intermediate 1 | 12-1/4" | 9-5/8" | 2573' | New | 36#, J-55 | N/A | Y |
| Intermediate 2 | | | | | | | |
| Intermediate 3 | | | | | | | |
| Production | 8-3/4"/8-1/2" | 5-1/2" | 18529' | New | 20#, P-100 | N/A | Y |
| Tubing | | 2-3/8" | 7357' | | 4.7#, P-110 | | |
| Packer type and depth set | | N/A | | | | | |

Comment Details _____

| CEMENT DATA | Class/Type of Cement | Number of Sacks | Slurry wt (ppg) | Yield (ft ³ /sks) | Volume (ft ³) | Cement Top (MD) | WOC (hrs) |
|----------------|----------------------|------------------------------|-------------------------|------------------------------|---------------------------|--------------------------------|-----------|
| Conductor | Class A | 352 sx | 15.6 | 1.18 | 75 | 0' | 8 Hrs. |
| Surface | Class A | 790 sx | 15.8 | 1.20 | 163 | 0' | 8 Hrs. |
| Coal | | | | | | | |
| Intermediate 1 | Class A | 1070 sx | 15.8 | 1.16 | 220 | 0' | 8 Hrs. |
| Intermediate 2 | | | | | | | |
| Intermediate 3 | | | | | | | |
| Production | Class H | 792 sx (Lead) 3040 sx (Tail) | 13.5 (Lead), 15.2(Tail) | 1.4 (Lead), 1.18 (Tail) | 638 | ~500' into Intermediate Casing | 8 Hrs. |
| Tubing | | | | | | | |

Drillers TD (ft) 18879' MD, 7228' TVD (BHL), 7229' (Deepest Point Drilled) Loggers TD (ft) 18879' MD

Deepest formation penetrated Marcellus Plug back to (ft) N/A

Plug back procedure N/A

Kick off depth (ft) 6413'

Check all wireline logs run caliper density deviated/directional induction
 neutron resistivity gamma ray temperature sonic

Well cored Yes No Conventional Sidewall Were cuttings collected Yes No

DESCRIBE THE CENTRALIZER PLACEMENT USED FOR EACH CASING STRING _____

Conductor - 0

Surface - 1 above guide shoe, 1 above insert float, 1 every 4th joint to surface

Intermediate - 1 above float joint, 1 above float collar, 1 every 4th joint to surface

Production - 1 above float joint, 1 below float collar, 1 every 3rd joint to top of cement

WAS WELL COMPLETED AS SHOT HOLE Yes No DETAILS _____

WAS WELL COMPLETED OPEN HOLE? Yes No DETAILS _____

WERE TRACERS USED Yes No TYPE OF TRACER(S) USED N/A

APPROVED

03/17/2023
2/10/23

API 47- 103 - 03425 Farm name Dallison Lumber, Inc Well number Daags Unit 1H

| <u>PRODUCING FORMATION(S)</u> | <u>DEPTHS</u> | | |
|-------------------------------|--------------------|------------|------------------------------|
| <u>Marcellus</u> | <u>7113' (TOP)</u> | <u>TVD</u> | <u>7442' (TOP)</u> <u>MD</u> |
| _____ | _____ | _____ | _____ |
| _____ | _____ | _____ | _____ |

Please insert additional pages as applicable.

GAS TEST Build up Drawdown Open Flow OIL TEST Flow Pump

SHUT-IN PRESSURE Surface 2800 psi Bottom Hole --- psi DURATION OF TEST --- hrs

OPEN FLOW Gas 9702 mcfpd Oil 322 bpd NGL --- bpd Water 2602 bpd GAS MEASURED BY Estimated Orifice Pilot

| LITHOLOGY/ FORMATION | TOP DEPTH IN FT NAME TVD | BOTTOM DEPTH IN FT TVD | TOP DEPTH IN FT MD | BOTTOM DEPTH IN FT MD | DESCRIBE ROCK TYPE AND RECORD QUANTITY AND TYPE OF FLUID (FRESHWATER, BRINE, OIL, GAS, H ₂ S, ETC) |
|-------------------------|--------------------------------|------------------------------|--------------------------|-----------------------------|--|
|-------------------------|--------------------------------|------------------------------|--------------------------|-----------------------------|--|

***PLEASE SEE ATTACHED EXHIBIT 3**

| | | | | | |
|--|--|--|--|--|--|
| | | | | | |
| | | | | | |
| | | | | | |
| | | | | | |
| | | | | | |
| | | | | | |
| | | | | | |
| | | | | | |
| | | | | | |
| | | | | | |

Please insert additional pages as applicable.

Drilling Contractor H & P Drilling
Address 912 N Eagle Valley Rd City Howard State PA Zip 16841

Logging Company Nine Energy Services
Address 6500 West Fwy City Fort Worth State TX Zip 76116

Cementing Company Halliburton Energy Services
Address 3000 W. Sam Houston Pkwy City Houston State TX Zip 76114

Stimulating Company Halliburton
Address 3000 W. Sam Houston Pkwy City Houston State TX Zip 76114

Please insert additional pages as applicable.

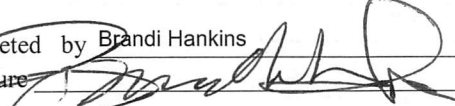
Completed by Brandi Hankins Telephone 304-842-9759
Signature  Title Completions Technician Date 2/2/23

Submission of Hydraulic Fracturing Chemical Disclosure Information Attach copy of FRACFOCUS Registry

Handwritten: 03/17/2023
Handwritten: 2/16/23

API 47-103-03425 Farm Name Dallison Lumber Inc Well Number Daags Unit 1H

| Stage No. | Perforation Date | Perforated from MD ft. | Perforated to MD ft. | Number of Perforations | Formations |
|-----------|------------------|------------------------|----------------------|------------------------|------------|
| 1 | 02/06/2022 | 18759 | 18715 | 32 | Marcellus |
| 2 | 02/06/2022 | 18676.6131 | 18511.6786 | 32 | Marcellus |
| 3 | 02/07/2022 | 18476.29167 | 18311.3571 | 32 | Marcellus |
| 4 | 02/07/2022 | 18275.97024 | 18111.0357 | 32 | Marcellus |
| 5 | 02/08/2022 | 18075.64881 | 17910.7143 | 32 | Marcellus |
| 6 | 02/08/2022 | 17875.32738 | 17710.3929 | 32 | Marcellus |
| 7 | 02/08/2022 | 17675.00595 | 17510.0714 | 32 | Marcellus |
| 8 | 02/08/2022 | 17474.68452 | 17309.75 | 32 | Marcellus |
| 9 | 02/09/2022 | 17274.3631 | 17109.4286 | 32 | Marcellus |
| 10 | 02/09/2022 | 17074.04167 | 16909.1071 | 32 | Marcellus |
| 11 | 02/09/2022 | 16873.72024 | 16708.7857 | 32 | Marcellus |
| 12 | 02/09/2022 | 16673.39881 | 16508.4643 | 32 | Marcellus |
| 13 | 02/10/2022 | 16473.07738 | 16308.1429 | 32 | Marcellus |
| 14 | 02/10/2022 | 16272.75595 | 16107.8214 | 32 | Marcellus |
| 15 | 02/10/2022 | 16072.43452 | 15907.5 | 32 | Marcellus |
| 16 | 02/10/2022 | 15872.1131 | 15707.1786 | 32 | Marcellus |
| 17 | 02/11/2022 | 15671.79167 | 15506.8571 | 32 | Marcellus |
| 18 | 02/11/2022 | 15471.47024 | 15306.5357 | 32 | Marcellus |
| 19 | 02/11/2022 | 15271.14881 | 15106.2143 | 32 | Marcellus |
| 20 | 02/11/2022 | 15070.82738 | 14905.8929 | 32 | Marcellus |
| 21 | 02/12/2022 | 14870.50595 | 14705.5714 | 32 | Marcellus |
| 22 | 02/12/2022 | 14670.18452 | 14505.25 | 32 | Marcellus |
| 23 | 02/12/2022 | 14469.8631 | 14304.9286 | 32 | Marcellus |
| 24 | 02/13/2022 | 14269.54167 | 14104.6071 | 32 | Marcellus |
| 25 | 02/13/2022 | 14069.22024 | 13904.2857 | 32 | Marcellus |
| 26 | 02/14/2022 | 13868.89881 | 13703.9643 | 32 | Marcellus |
| 27 | 02/14/2022 | 13668.57738 | 13503.6429 | 32 | Marcellus |
| 28 | 02/15/2022 | 13468.25595 | 13303.3214 | 32 | Marcellus |
| 29 | 02/15/2022 | 13267.93452 | 13103 | 32 | Marcellus |
| 30 | 02/16/2022 | 13067.6131 | 12902.6786 | 32 | Marcellus |
| 31 | 02/16/2022 | 12867.29167 | 12702.3571 | 32 | Marcellus |
| 32 | 02/17/2022 | 12666.97024 | 12502.0357 | 32 | Marcellus |
| 33 | 02/17/2022 | 12466.64881 | 12301.7143 | 32 | Marcellus |
| 34 | 02/18/2022 | 12266.32738 | 12101.3929 | 32 | Marcellus |
| 35 | 02/18/2022 | 12066.00595 | 11901.0714 | 32 | Marcellus |
| 36 | 02/19/2022 | 11865.68452 | 11700.75 | 32 | Marcellus |
| 37 | 02/19/2022 | 11665.3631 | 11500.4286 | 32 | Marcellus |
| 38 | 02/20/2022 | 11465.04167 | 11300.1071 | 32 | Marcellus |
| 39 | 02/20/2022 | 11264.72024 | 11099.7857 | 32 | Marcellus |
| 40 | 02/21/2022 | 11064.39881 | 10899.4643 | 32 | Marcellus |
| 41 | 02/21/2022 | 10864.07738 | 10699.1429 | 32 | Marcellus |
| 42 | 02/22/2022 | 10663.75595 | 10498.8214 | 32 | Marcellus |
| 43 | 02/22/2022 | 10463.43452 | 10298.5 | 32 | Marcellus |
| 44 | 02/23/2022 | 10263.1131 | 10098.1786 | 32 | Marcellus |
| 45 | 02/24/2022 | 10062.79167 | 9897.85714 | 32 | Marcellus |
| 46 | 02/24/2022 | 9862.470238 | 9697.53571 | 32 | Marcellus |
| 47 | 02/25/2022 | 9662.14881 | 9497.21429 | 32 | Marcellus |
| 48 | 02/26/2022 | 9461.827381 | 9296.89286 | 32 | Marcellus |
| 49 | 02/26/2022 | 9261.505952 | 9096.57143 | 32 | Marcellus |
| 50 | 02/27/2022 | 9061.184524 | 8896.25 | 32 | Marcellus |
| 51 | 02/28/2022 | 8860.863095 | 8695.92857 | 32 | Marcellus |
| 52 | 02/28/2022 | 8660.541667 | 8495.60714 | 32 | Marcellus |
| 53 | 03/01/2022 | 8460.220238 | 8295.28571 | 32 | Marcellus |
| 54 | 03/01/2022 | 8259.89881 | 8094.96429 | 32 | Marcellus |
| 55 | 03/02/2022 | 8059.577381 | 7894.64286 | 32 | Marcellus |
| 56 | 03/02/2022 | 7859.255952 | 7694.32143 | 32 | Marcellus |
| 57 | 03/03/2022 | 7658.934524 | 7494 | 32 | Marcellus |

RECEIVED
Office of Oil and Gas

FEB 07 2023

WV Department of
Environmental Protection

03/17/2023

EXHIBIT 2

| Stage No. | Stimulations Date | Avg Pump Rate | Avg Treatment Pressure (PSI) | Max Breakdown Pressure (PSI) | ISIP (PSI) | Amount of Proppant (lbs) | Amount of Water (bbls) | Amount of Nitrogen/ other (units) |
|-----------|-------------------|---------------|------------------------------|------------------------------|------------|--------------------------|------------------------|-----------------------------------|
| 1 | 02/06/2022 | 63.5 | 8542 | 6635 | 3589 | 174600 | 247300 | N/A |
| 2 | 02/06/2022 | 73.66 | 8335 | 6567 | 4239 | 408910 | 303609 | N/A |
| 3 | 02/07/2022 | 75.2 | 8338 | 6950 | 3895 | 410820 | 318185 | N/A |
| 4 | 02/07/2022 | 79.18 | 8481 | 5369 | 4308 | 412470 | 325320 | N/A |
| 5 | 02/08/2022 | 74.23 | 8447 | 6426 | 4225 | 411110 | 310533 | N/A |
| 6 | 02/08/2022 | 79.97 | 8589 | 6126 | 3953 | 417740 | 315457 | N/A |
| 7 | 02/08/2022 | 75.63 | 8633 | 8599 | 3842 | 407880 | 299497 | N/A |
| 8 | 02/08/2022 | 75.17 | 8520 | 5781 | 4006 | 411670 | 300819 | N/A |
| 9 | 02/09/2022 | 75.72 | 8590 | 7145 | 4141 | 414790 | 305217 | N/A |
| 10 | 02/09/2022 | 82.16 | 8766 | 5934 | 4207 | 413970 | 295779 | N/A |
| 11 | 02/09/2022 | 73.11 | 8795 | 8752 | 3656 | 410760 | 292132 | N/A |
| 12 | 02/09/2022 | 82.01 | 8770 | 8603 | 3894 | 416390 | 297782 | N/A |
| 13 | 02/10/2022 | 81.88 | 8749 | 7418 | 4119 | 415070 | 295475 | N/A |
| 14 | 02/10/2022 | 67.63 | 8682 | 8906 | 3971 | 413300 | 410535 | N/A |
| 15 | 02/10/2022 | 75.36 | 8666 | 8491 | 4162 | 394740 | 359218 | N/A |
| 16 | 02/10/2022 | 84.53 | 8653 | 7746 | 4084 | 411650 | 292330 | N/A |
| 17 | 02/11/2022 | 81.77 | 8766 | 6292 | 4413 | 414210 | 293258 | N/A |
| 18 | 02/11/2022 | 79.27 | 8663 | 6833 | 4103 | 398480 | 299536 | N/A |
| 19 | 02/11/2022 | 80.8 | 8548 | 8863 | 4122 | 411642 | 297855 | N/A |
| 20 | 02/11/2022 | 86.09 | 8704 | 8187 | 4221 | 410500 | 299511 | N/A |
| 21 | 02/12/2022 | 83.63 | 8787 | 6643 | 3966 | 393560 | 289218 | N/A |
| 22 | 02/12/2022 | 87.94 | 8714 | 8651 | 4023 | 411750 | 292598 | N/A |
| 23 | 02/12/2022 | 90.3 | 8750 | 7061 | 4351 | 407620 | 296809 | N/A |
| 24 | 02/13/2022 | 86.62 | 8665 | 8205 | 4358 | 411030 | 292268 | N/A |
| 25 | 02/13/2022 | 82.84 | 8696 | 8643 | 4146 | 406310 | 293467 | N/A |
| 26 | 02/14/2022 | 91.66 | 8629 | 8111 | 4221 | 407300 | 306102 | N/A |
| 27 | 02/14/2022 | 88.45 | 8547 | 7050 | 4131 | 415960 | 294242 | N/A |
| 28 | 02/15/2022 | 92 | 8675 | 8443 | 3999 | 408180 | 295438 | N/A |
| 29 | 02/15/2022 | 93.21 | 8756 | 7757 | 3783 | 408570 | 285914 | N/A |
| 30 | 02/16/2022 | 91.81 | 8322 | 7399 | 3990.89 | 397520 | 286352 | N/A |
| 31 | 02/16/2022 | 93.19 | 8503 | 7221 | 4376 | 409440 | 296110 | N/A |
| 32 | 02/17/2022 | 90.03 | 8544 | 8619 | 4502 | 411400 | 296941 | N/A |
| 33 | 02/17/2022 | 95.51 | 8794 | 6735 | 4083 | 415580 | 291301 | N/A |
| 34 | 02/18/2022 | 95.42 | 8557 | 7163 | 4059 | 396820 | 301043 | N/A |
| 35 | 02/18/2022 | 96.66 | 8762 | 7925 | 3994 | 394210 | 289882 | N/A |
| 36 | 02/19/2022 | 98.27 | 8808 | 7727 | 3944 | 398330 | 284363 | N/A |
| 37 | 02/19/2022 | 97.23 | 8592 | 7556 | 4119 | 412035 | 298543 | N/A |
| 38 | 02/20/2022 | 98.52 | 8774 | 7209 | 4110 | 399640 | 283431 | N/A |
| 39 | 02/20/2022 | 98.09 | 8640 | 7508 | 4006 | 394060 | 287881 | N/A |
| 40 | 02/21/2022 | 96.93 | 8696 | 8542 | 4179 | 401640 | 284376 | N/A |
| 41 | 02/21/2022 | 98.82 | 8761 | 7418 | 3987 | 415870 | 288172 | N/A |
| 42 | 02/22/2022 | 96.7 | 8479 | 5997 | 3984 | 417700 | 292040 | N/A |
| 43 | 02/22/2022 | 98.95 | 8752 | 7164 | 3808 | 417160 | 291103 | N/A |
| 44 | 02/23/2022 | 96.45 | 8539 | 6024 | 4131 | 395080 | 283755 | N/A |
| 45 | 02/24/2022 | 99.07 | 8359 | 7190 | 4175 | 202820 | 291506 | N/A |
| 46 | 02/24/2022 | 99.13 | 8415 | 7090 | 4053 | 193390 | 282923 | N/A |
| 47 | 02/25/2022 | 96.94 | 8191 | 6486 | 4738 | 215520 | 286028 | N/A |
| 48 | 02/26/2022 | 96.73 | 8225 | 7531 | 4287 | 196430 | 285991 | N/A |
| 49 | 02/26/2022 | 95.2 | 8031 | 7732 | 3680 | 198400 | 295353 | N/A |
| 50 | 02/27/2022 | 90.46 | 8300 | 6010 | 4060 | 189980 | 284858 | N/A |
| 51 | 02/28/2022 | 94.04 | 7773 | 6979 | 4426 | 194640 | 293047 | N/A |
| 52 | 02/28/2022 | 97.32 | 8026 | 6657 | 4181 | 202160 | 300265 | N/A |
| 53 | 03/01/2022 | 76.09 | 7428 | 5928 | 5710 | 177380 | 362122 | N/A |
| 54 | 03/01/2022 | 84.61 | 7863 | 8029 | 3632 | 202800 | 291403 | N/A |
| 55 | 03/02/2022 | 68.82 | 7514 | 6697 | 3748 | 179610 | 376760 | N/A |
| 56 | 03/02/2022 | 59.43 | 8310 | 7853 | 3498 | 197260 | 388640 | N/A |
| 57 | 03/03/2022 | 76.89 | 6959 | 6803 | 3620 | 198800 | 311608 | N/A |
| | AVG= | 86 | 8,480 | 7,322 | 4,091 | 20,276,657 | 17,211,201 | TOTAL |

RECEIVED
Office of Oil and Gas

FEB 07 2023

WV Department of
Environmental Protection

03/17/2023

EXHIBIT 3

| LITHOLOGY/ FORMATION | TOP DEPTH (TVD) | BOTTOM DEPTH (TVD) | TOP DEPTH (MD) | BOTTOM DEPTH (MD) |
|------------------------------------|-----------------|--------------------|----------------|-------------------|
| | From Surface | From Surface | From Surface | From Surface |
| Sandstone, tr shale | 100 | 310 | 100 | 310 |
| Shaly Siltstone, tr coal | 310 | 460 | 310 | 460 |
| Silty Sandstone, tr shale | 460 | 550 | 460 | 550 |
| Siltstone, tr coal | 550 | 670 | 550 | 670 |
| Sandstone | 670 | 790 | 670 | 790 |
| Siltstone, tr LS | 790 | 910 | 790 | 910 |
| Sandy Siltstone | 910 | 1,090 | 910 | 1,090 |
| Siltstone, tr LS | 1,090 | 1,270 | 1,090 | 1,270 |
| Sandstone, tr LS | 1,270 | 1,390 | 1,270 | 1,390 |
| Shaly Sandstone | 1,390 | 1,540 | 1,390 | 1,540 |
| Silty Sandstone, tr salt | 1,540 | 1,690 | 1,540 | 1,690 |
| Silty Sandstone, tr shale, tr coal | 1,690 | 1,990 | 1,690 | 1,990 |
| Sandy Siltstone, tr salt, tr shale | 1,990 | 2,192 | 1,990 | 2,222 |
| Big Lime | 2,222 | 2,744 | 2,192 | 2,744 |
| Fifty Foot Sandstone | 2,744 | 2,939 | 2,714 | 2,941 |
| Gordon | 2,939 | 3,168 | 2,911 | 3,174 |
| Fifth Sandstone | 3,168 | 3,214 | 3,144 | 3,220 |
| Bayard | 3,214 | 4,135 | 3,190 | 4,156 |
| Spechley | 4,135 | 4,280 | 4,126 | 4,305 |
| Balltown | 4,280 | 4,766 | 4,275 | 4,798 |
| Bradford | 4,766 | 5,314 | 4,768 | 5,353 |
| Benson | 5,314 | 5,730 | 5,323 | 5,775 |
| Alexander | 5,730 | 6,926 | 5,745 | 7,005 |
| Sycamore | 6,763 | 6,896 | 6,826 | 6,975 |
| Middlesex | 6,896 | 7,001 | 6,975 | 7,121 |
| Burkett | 7,001 | 7,034 | 7,121 | 7,177 |
| Tully | 7,034 | 7,113 | 7,177 | 7,442 |
| Marcellus | 7,113 | NA | 7,442 | NA |

*Please note Antero determines formation tops based on mud logs that are only run on one well on a multi-well pad. The measured depth (MD) data on subsequent wells may be slightly different due to the well's unique departure.

RECEIVED
Office of Oil and Gas

FEB 07 2023

WV Department of
Environmental Protection

03/17/2023

Hydraulic Fracturing Fluid Product Component Information Disclosure

| | |
|--------------------------------|------------------------------|
| Job Start Date: | 2/5/2022 |
| Job End Date: | 3/2/2022 |
| State: | West Virginia |
| County: | Wetzel |
| API Number: | 47-103-03425-00-00 |
| Operator Name: | Antero Resources Corporation |
| Well Name and Number: | DAAGS UNIT 1H |
| Latitude: | 39.52627200 |
| Longitude: | -80.72460600 |
| Datum: | NAD83 |
| Federal Well: | NO |
| Indian Well: | NO |
| True Vertical Depth: | 7,228 |
| Total Base Water Volume (gal): | 18,148,622 |
| Total Base Non Water Volume: | 0 |



Hydraulic Fracturing Fluid Composition:

| Trade Name | Supplier | Purpose | Ingredients | Chemical Abstract Service Number (CAS #) | Maximum Ingredient Concentration in Additive (% by mass)** | Maximum Ingredient Concentration in HF Fluid (% by mass)** | Comments |
|----------------|--------------|--------------|-------------|--|--|--|----------------|
| Produced Water | Halliburton | Base Fluid | | | | | |
| | | | Water | 7732-18-5 | 100.00000 | 86.79935 | Density = 8.50 |
| Ingredients | Listed Above | Listed Above | | | | | |
| | | | Water | 7732-18-5 | 100.00000 | 0.13511 | |

WV Department of Environmental Protection
 RECEIVED
 Office of Oil and Gas
 FEB 07 2023

SM
2/16/23

| | | | | | | | |
|-----------------------------------|--------------------|--------------------------|--|--------------|--|--|--|
| HYDROCHLORIC ACID, 22 BAUME | Halliburton | Solvent | | | | | |
| | | | | Listed Below | | | |
| FLUID Enviro-Syn HCR-7000-WL | Fluid Energy Group | Acid Replacement | | | | | |
| | | | | Listed Below | | | |
| Sand-Premium White-40/70 | Halliburton | Proppant | | | | | |
| | | | | Listed Below | | | |
| HAI-501 | Halliburton | Acid Corrosion Inhibitor | | | | | |
| | | | | Listed Below | | | |
| Excelerate LX-15 | Halliburton | Friction Reducer | | | | | |
| | | | | Listed Below | | | |
| MC B-8614A | MultiChem | Biocide | | | | | |
| | | | | Listed Below | | | |
| Sand-Common White-100 Mesh, SSA-2 | Halliburton | Proppant | | | | | |
| | | | | Listed Below | | | |
| WG-36 GELLING AGENT | Halliburton | Gelling Agent | | | | | |
| | | | | Listed Below | | | |

| | | | | | | | |
|--|-------------|---------|--|--------------|-----------|----------|--|
| OPTIFLO-II DELAYED RELEASE BREAKER | Halliburton | Breaker | | | | | |
| | | | | Listed Below | | | |
| Items above are Trade Names with the exception of Base Water . Items below are the individual ingredients. | | | | | | | |
| | | | Crystalline silica, quartz | 14808-60-7 | 100.00000 | 13.00098 | |
| | | | Complex Amine Compound | Proprietary | 60.00000 | 0.03986 | |
| | | | Hydrochloric acid | 7647-01-0 | 30.00000 | 0.02601 | |
| | | | Hydrotreated light petroleum distillate | 64742-47-8 | 30.00000 | 0.01993 | |
| | | | Guar gum | 9000-30-0 | 100.00000 | 0.00656 | |
| | | | Proprietary | Proprietary | 20.00000 | 0.00619 | |
| | | | Surfactant | Proprietary | 5.00000 | 0.00332 | |
| | | | Sobitan, mono-9- octadecenoate, (Z) | 1338-43-8 | 5.00000 | 0.00332 | |
| | | | Proprietary | Proprietary | 10.00000 | 0.00310 | |
| | | | Glutaraldehyde | 111-30-8 | 30.00000 | 0.00257 | |
| | | | Ethoxylated alcohols | Proprietary | 5.00000 | 0.00067 | |
| | | | Alkoxyated polyhydric alcohol | Proprietary | 1.00000 | 0.00066 | |
| | | | Organic chloride compound | Proprietary | 1.00000 | 0.00066 | |
| | | | Alkyl (C12-16) dimethylbenzyl ammonium chloride | 68424-85-1 | 5.00000 | 0.00043 | |
| | | | Ammonium persulfate | 7727-54-0 | 100.00000 | 0.00034 | |
| | | | Methanol | 67-56-1 | 100.00000 | 0.00016 | |
| | | | Oxylated phenolic resin | Proprietary | 30.00000 | 0.00010 | |
| | | | Ethanol | 64-17-5 | 1.00000 | 0.00009 | |
| | | | Mixture of dimer and trimer fatty acids of indefinite composition derived from tall oil | 61790-12-3 | 30.00000 | 0.00005 | |

RECEIVED
 Office of Oil and Gas
 - FEB 07 2023
 WV Department of
 Environmental Protection

| | | | | | | | |
|--|--|--|---------------------------|-------------|----------|---------|--|
| | | | Modified thiourea polymer | Proprietary | 30.00000 | 0.00005 | |
| | | | Hexadecene | 629-73-2 | 5.00000 | 0.00001 | |
| | | | Propargyl alcohol | 107-19-7 | 5.00000 | 0.00001 | |
| | | | Sodium hydroxide | 1310-73-2 | 0.01000 | 0.00001 | |
| | | | Nitrated acetate salt | Proprietary | 0.01000 | 0.00001 | |
| | | | Acrylamide | 79-06-1 | 0.01000 | 0.00001 | |
| | | | Organic salt #2 | Proprietary | 0.01000 | 0.00001 | |
| | | | Sodium glycolate | 2836-32-0 | 0.01000 | 0.00001 | |
| | | | Organic salt #1 | Proprietary | 0.01000 | 0.00001 | |
| | | | Formaldehyde | 50-00-0 | 0.01000 | 0.00001 | |
| | | | C.I. pigment Orange 5 | 3468-63-1 | 1.00000 | 0.00000 | |

* Total Water Volume sources may include various types of water including fresh water, produced water, and recycled water

** Information is based on the maximum potential for concentration and thus the total may be over 100%

*** If you are calculating a percentage of total ingredients do not add the water volume below the green line to the water volume above the green line

Note: For Field Development Products (products that begin with FDP), MSDS level only information has been provided.

Ingredient information for chemicals subject to 29 CFR 1910.1200(i) and Appendix D are obtained from suppliers Material Safety Data Sheets (MSDS)

785' to Bottom Hole

Sheet 1 of 2

4,588' to Top Hole
TOP HOLE LATITUDE 39 - 32 - 30
BTM HOLE LATITUDE 39 - 30 - 00

Antero Resources
Well No. Daags 1H
As-Drilled
Antero Resources Corporation



Daags Unit 1H As-Drilled
POE Coordinates
West Virginia
Coordinate System
of 1927, North Zone
N: 376,282.99'
E: 1,654,708.57'
Latitude: 39°31'35.97"
Longitude: 80°43'26.88"
UTM Zone 17, NAD 1983
N: 4,375,268.411m
E: 523,724.921m

BTM Hole
7.5' Spot

LONGITUDE 80 - 42 - 30
5,597' to Top Hole
1,086' to Bottom Hole

As-Drilled Well No. Daags Unit 1H

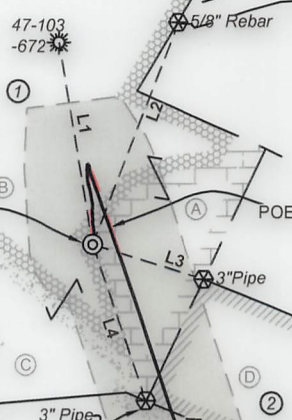

Top Hole Coordinates, As-drilled data, and information was provided by Antero Resources Corporation. Allegheny Surveys Inc. (ASI) is not certifying the data and information provided. ASI is not responsible for any errors or inaccuracies with the data and information that has been provided.

Notes
West Virginia Coordinate System of 1927, North Zone
based upon Differential GPS Measurements.
Well No. Daags Unit 1H Top Hole coordinates are
N: 376,153.71' Latitude: 39°31'34.67"
E: 1,654,575.48' Longitude: 80°43'28.56"
Bottom Hole coordinates are
N: 365,438.44' Latitude: 39°29'49.27"
E: 1,658,235.17' Longitude: 80°42'40.01"
UTM Zone 17, NAD 1983
Top Hole Coordinates Bottom Hole Coordinates
N: 4,375,228.346m N: 4,371,982.489m
E: 523,685.029m E: 524,854.365m
Plat orientation and corner and well references are based upon the grid north meridian.
Well location references are based upon the magnetic meridian.

I, the undersigned, hereby certify that this plat is correct to the best of my knowledge and belief and shows all the information required by law and the rules issued and prescribed by the Department of Environmental Protection.

Bradley D. Miller
Bradley D. Miller, P.S. 2167



| | Bearing | Dist. |
|----|------------|----------|
| L1 | S 09°41' E | 1,583.9' |
| L2 | S 21°07' W | 1,846.7' |
| L3 | N 72°53' W | 911.6' |
| L4 | N 18°58' W | 1,283.9' |

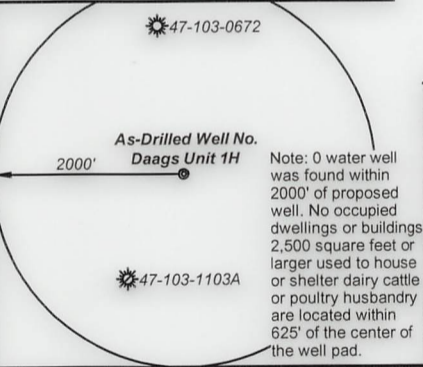

Legend

- Proposed gas well
- Monument, as noted
- Existing Well, as noted
- Digitized Well, as noted
- Creek or Drain
- Road
- Surface boundary (approx.)
- Interior surface tracts (approx.)

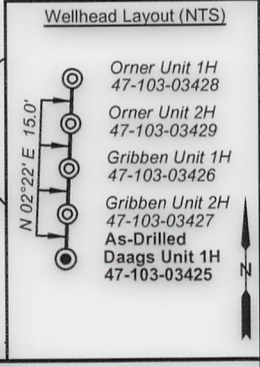

FILE NO: 325-34-G-17
DRAWING NO: Daags 1H As-Drilled
SCALE: 1" = 1500'
MINIMUM DEGREE OF ACCURACY: Submeter
PROVEN SOURCE OF ELEVATION: CORS, Monroe County, OH

STATE OF WEST VIRGINIA
DEPARTMENT OF ENVIRONMENTAL PROTECTION
OIL AND GAS DIVISION

DATE: July 12 20 22
OPERATOR'S WELL NO. Daags Unit 1H
API WELL NO
47 - 103 - 03425
STATE COUNTY PERMIT

WELL TYPE: OIL GAS LIQUID INJECTION WASTE DISPOSAL
(IF GAS) PRODUCTION: STORAGE DEEP SHALLOW

LOCATION: ELEVATION: 1,308' WATERSHED: Fishing Creek QUADRANGLE: TH: Pine Grove BH: Center Point
DISTRICT: Green Dallison COUNTY: Wetzel
SURFACE OWNER: Lumber, Inc. ACREAGE: 60.5
ROYALTY OWNER: Joan B. Hoge Trust; Waco Oil & Gas Co. Inc.; BRC Appalachian Minerals I, LLC; LEASE NO: ACREAGE: 15.51; 122.7; 13.25

PROPOSED WORK: DRILL CONVERT DRILL DEEPER FRACTURE OR STIMULATE PLUG OFF OLD FORMATION
 PERFORATE NEW FORMATION OTHER PHYSICAL CHANGE IN WELL (SPECIFY) As-Drilled
 PLUG AND ABANDON CLEAN OUT AND REPLUG TARGET FORMATION: Marcellus Shale ESTIMATED DEPTH: 18,879' MD

WELL OPERATOR: Antero Resources Corporation DESIGNATED AGENT: Dianna Stamper - CT Corporation System
ADDRESS: 1615 Wynkoop Street ADDRESS: 5400 D Big Tyler Road
Denver, CO 80202 Charleston, WV 25313

03/17/2023



| ID | TM/Par | Owner | Bk/Pg | Acres |
|----|---------|-------------------------------------|---------|--------|
| 1 | 20-13 | Dallison Lumber Inc. | 440/243 | 208.00 |
| 2 | 20-17 | Christopher N. Kise | 420/812 | 34.30 |
| 3 | 20-25 | Unknown Owner | ---/--- | 42.00 |
| 4 | 20-36 | Louisa Bassett | 165/304 | 1.50 |
| 5 | 20-35 | Louisa Bassett & Mrs. Irvin Bassett | 168/157 | 72.00 |
| 6 | 20-33 | David Edward Arthurs, et al | 347/49 | 26.50 |
| 7 | 20-32 | Tony E. & Marion L. Crabtree | 365/337 | 43.50 |
| 8 | 20-34 | Columbia Gas Transmission Corp. | 263/164 | 12.00 |
| 9 | 20-35 | Louisa Bassett & Mrs. Irvin Bassett | 168/157 | 62.00 |
| 10 | 22-8 | Robert P. & Carolyn J. Kocher | 291/332 | 42.12 |
| 11 | 22-9 | Coastal Forest Resources Co. | 444/105 | 94.80 |
| 12 | 22-17 | Gerald W. Dulaney | 364/110 | 58.20 |
| 13 | 22-16 | Dallison Lumber Inc. | 353/112 | 95.10 |
| 14 | 22-29 | Timothy L. Yoho | 377/411 | 50.00 |
| 15 | 22-22 | Everett F. & Linda Coen | 248/442 | 8.00 |
| 16 | 22-34.1 | Coastal Forest Resources Co. | 444/105 | 129.00 |
| 17 | 22-26 | San-dee N. Stradley, et al | 424/12 | 6.99 |
| 18 | 22-30 | Donna J. Nixon | W84/662 | 23.00 |
| 19 | 25-2 | Coastal Forest Resources Co. | 444/105 | 61.93 |
| 20 | 22-35 | Blue Racer Midstream, LLC | 471/226 | 2.25 |
| 21 | 22-36 | Sandra K. Brown | W58/552 | 28.80 |
| 22 | 22-37 | Sandra K. Brown | W58/552 | 27.00 |

| Leases | |
|--------|---|
| A | Joan B. Hoge Trust |
| B | Waco Oil & Gas Company Inc. |
| C | BRC Appalachian Minerals I, LLC |
| D | Morris Mountaineer Oil & Gas, LLC |
| E | Shiben Estates, Inc. |
| F | Franklin D. & Lilly M. Tennant |
| G | Shiben Estates, Inc. |
| H | Antero Minerals, LLC |
| I | S.A. Smith, et al |
| J | Lillie Blanche Smith Testamentary Trust |
| K | Joyce E. Henry Revocable Living Trust |
| L | Robert Okey Whiting |
| M | Tribune Resources Minerals, LLC |
| N | Lucius Hoge, et al |

FILE NO: 325-34-G-17
 DRAWING NO: Daags 1H As-Drilled
 SCALE: 1" = 1500'
 MINIMUM DEGREE OF ACCURACY: Submeter
 PROVEN SOURCE OF ELEVATION: CORS, Monroe County, OH



DATE: July 12 2022
 OPERATOR'S WELL NO. Daags Unit 1H
 API WELL NO
 47 - 103 - 03425
 STATE COUNTY PERMIT

WELL TYPE: OIL GAS LIQUID INJECTION WASTE DISPOSAL
 (IF GAS) PRODUCTION: STORAGE DEEP SHALLOW

LOCATION: ELEVATION: 1,308' WATERSHED: Fishing Creek QUADRANGLE: TH: Pine Grove
 DISTRICT: Green Dallison COUNTY: Wetzel BH: Center Point
 SURFACE OWNER: Lumber, Inc. Franklin D. & Lilly M. Tennant; Morris Mountaineer Oil & Gas, LLC; Tribune Resources Minerals, LLC; Antero Minerals, LLC; Joyce E. Henry Revocable Living Trust; Lucius Hoge, et al; Shiben Estates, Inc. (2); S.A. Smith, et al; ACREAGE: 60.5
 ROYALTY OWNER: Joan B. Hoge Trust; Waco Oil & Gas Co. Inc.; BRC Appalachian Minerals I, LLC; LEASE NO: ACREAGE: 15.51; 122.7; 13.25

PROPOSED WORK: DRILL CONVERT DRILL DEEPER FRACTURE OR STIMULATE PLUG OFF OLD FORMATION
 PERFORATE NEW FORMATION OTHER PHYSICAL CHANGE IN WELL (SPECIFY) As-Drilled 7,228' TVD
 PLUG AND ABANDON CLEAN OUT AND REPLUG TARGET FORMATION: Marcellus Shale ESTIMATED DEPTH: 18,879' MD

WELL OPERATOR: Antero Resources Corporation DESIGNATED AGENT: Dianna Stamper - CT Corporation System
 ADDRESS: 1615 Wynkoop Street ADDRESS: 5400 D Big Tyler Road
 Denver, CO 80202 Charleston, WV 25313

03/17/2023