

9,285' to Bottom Hole

1,535' to Top Hole

TOP HOLE LATITUDE 39 - 35 - 00
BTM HOLD LATITUDE 39 - 32 - 30

TOP HOLE LONGITUDE 80 - 45 - 00
BTM HOLE LONGITUDE 80 - 42 - 30

12,165' to Top Hole

7,525' to Bottom Hole

Antero Resources
Well No. Peeler 2H
BHL MOD
Antero Resources Corporation



Notes
West Virginia Coordinate System of 1927, North Zone
based upon Differential GPS Measurements.
Well No. Peeler Unit 2H Top Hole coordinates are
N: 384,882.18' Latitude: 39°32'59.77"
E: 1,645,999.13' Longitude: 80°45'19.56"
Bottom Hole coordinates are
N: 374,292.03' Latitude: 39°31'15.64"
E: 1,649,852.47' Longitude: 80°44'28.50"
UTM Zone 17, NAD 1983
Top Hole Coordinates: Bottom Hole Coordinates
N: 4,377,843.864m N: 4,374,837.116m
E: 521,027,886m E: 522,255.550m
Plat orientation and corner and well references are based upon the grid north meridian.
Well location references are based upon the magnetic meridian.

Notes:
Well No. Peeler Unit 2H
UTM Zone 17, NAD 1927
Top Hole Coordinates
N: 14,362,260.76'
E: 1,709,357.53'
Point of Entry Coordinates
N: 14,362,316.95'
E: 1,709,728.23'
Bottom Hole Coordinates
N: 14,351,739.93'
E: 1,713,385.73'

	Bearing	Dist.
L1	S 41°16' E	2,681.7'
L2	S 45°01' W	1,507.5'
L3	N 64°19' W	984.5'
L4	N 37°39' W	833.9'
L5	N 82°20' E	375.1'

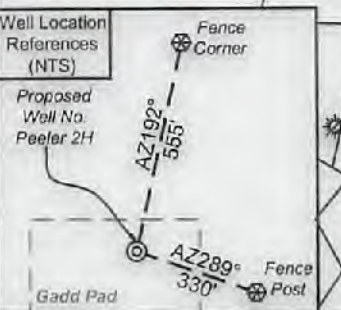

I, the undersigned, hereby certify that this plat is correct to the best of my knowledge and belief and shows all the information required by law and the rules issued and prescribed by the Department of Environmental Protection.

Kevin S. James

Kevin S. James, P.S. 2305

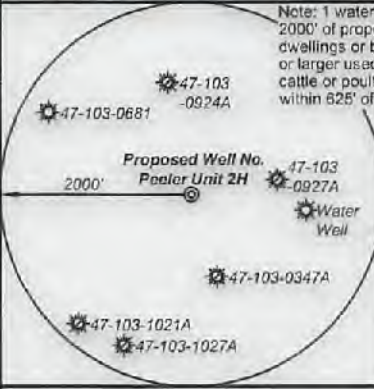

Note: 1 water well was found within 2000' of proposed well. No occupied dwellings or buildings 2,500 square feet or larger used to house or shelter dairy cattle or poultry husbandry are located within 825' of the center of the well pad.

Legend

- Proposed gas well
- Monument, as noted
- Existing Well, as noted
- Digitized Well, as noted
- Creek or Drain
- Road
- Surface boundary (approx.)
- Interior surface tracts (approx.)
- Railroad

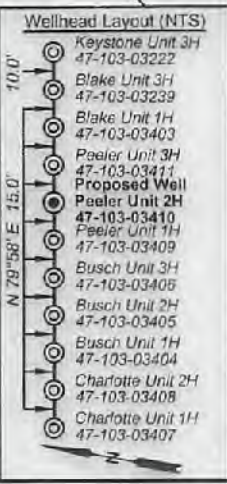

FILE NO: 326-34-G-17
DRAWING NO: Peeler 2H Well Plat
SCALE: 1" = 1500'
MINIMUM DEGREE OF ACCURACY: Submeter
PROVEN SOURCE OF ELEVATION: CORS, Monroe County, OH

STATE OF WEST VIRGINIA
DEPARTMENT OF ENVIRONMENTAL PROTECTION
OIL AND GAS DIVISION

DATE: July 15 2021
OPERATOR'S WELL NO. Peeler Unit 2H
API WELL NO MOD
47 - 103 - 03410
STATE COUNTY PERMIT

WELL TYPE: OIL GAS LIQUID INJECTION WASTE DISPOSAL
(IF GAS) PRODUCTION: STORAGE DEEP SHALLOW

LOCATION: ELEVATION: As-Built 1,223.6' WATERSHED: Fishing Creek QUADRANGLE: Top Hole: Porter Falls; BTM Hole: Pine Grove

DISTRICT: Green William L. & Thomas J. Jacoboni Revocable Trust Agreement; Faye Ann Skinner, et al; David E. Bowyer; COUNTY: Wayne 08/06/2021
SURFACE OWNER: Delores J. Gadd Stone Hill Minerals Holdings, Inc.; Edwin D. & Jane C. Michael; H. Dom Higginbotham; ACREAGE: 60.5
ROYALTY OWNER: Ellen W. & Mark L. VanDyne; Shiben Estates, Inc.; John W. Bertram; Acropolis, Inc. LEASE NO: ACREAGE: 83.25, 50, 32.25

PROPOSED WORK: DRILL CONVERT DRILL DEEPER FRACTURE OR STIMULATE PLUG OFF OLD FORMATION
 PERFORATE NEW FORMATION OTHER PHYSICAL CHANGE IN WELL (SPECIFY) BHL MOD
 PLUG AND ABANDON CLEAN OUT AND REPLUG TARGET FORMATION: Marcellus Shale ESTIMATED DEPTH: 7,500' TVD; 20,200' MD

WELL OPERATOR: Antero Resources Corporation DESIGNATED AGENT: Dianna Stamper - CT Corporation System
ADDRESS: 1615 Wynkoop Street ADDRESS: 5400 D Big Tyler Road
Denver, CO 80202 Charleston, WV 25313



ID	TM/Par	Owner	Bk/Pg	Acres
1	16-22	William L. & Dolores J. Gadd	348/169	60.50
2	16-30	William L. & Dolores J. Gadd	348/169	14.00
3	16-31	William L. & Dolores J. Gadd	348/169	2.65
4	16-10	Loren & Shirley Haught	444/434	100.48
5	16-23	Kenneth E. Butler	331/110	50.97
6	16-23.1	Wetzel County Public Service District 1	433/851	0.23
7	16-32	Fox Cemetery	50/137	1.17
8	16-33	William M. Greenawalt & Lee A. Niezgoda	387/1	11.80
9	16-40	William M. Greenawalt & Lee A. Niezgoda	387/1	18.00
10	16-41	James C. Henthorne	367/673	46.00
11	16-57	Lee A. Niezgoda	402/90	1.06
12	16-47	William M. Greenawalt & Lee A. Niezgoda	387/1	12.00
13	16-58	Mark & Michael Difiore	406/241	97.80
14	16-64	Mark & Michael Difiore	406/241	6.60
15	16-71	Michael L. & Tina M. Adams	437/722	30.50
16	19-8.1	Edwin D. & Jane C. Michael	275/42	36.84
17	19-8.2	Edwin D. & Jane C. Michael	275/42	22.00
18	19-8.3	Edwin D. & Jane C. Michael	275/42	24.50
19	19-18.1	Edwin D. & Jane Michael	364/565	8.00
20	19-17	John R. & Mary Ann Horner	416/653	47.55
21	19-18	Ronald L. & Sharon Christenson Family Trust	439/377	30.00
22	19-27	Ronald L. & Sharon Christenson Family Trust	439/377	25.00
23	19-28	Ronald L. & Sharon Christenson Family Trust	439/377	28.25
24	20-16	Coastal Forest Resources Co.	444/105	75.50
25	19-42	Sharon M. & Ronald L. Christenson	363/101	22.50
26	19-48.1	Teresa & Michael L. Bassett	423/982	2.00
27	19-47	Suzann M. Stoehr, et al	WB48/422	80.00
28	19-48	Teresa & Michael L. Bassett	423/982	51.00
29	19-49	Michael L. & Teresa Bassett	386/315	32.25

Leases	
A	Shiben Estates, Inc.
B	Ellen W. & Mark L. VanDyne
C	John W. Bertram
D	BRC Appalachian Minerals I, LLC
E	Gordon Cummings
F	Eight Mile Ridge Church of Christ
G	Nancy Tice
H	Reita Jane Hall
I	Acropolis, Inc.
J	Clyde Robert Kennedy
K	Emma Lee Rino
L	BRC Appalachian Minerals I, LLC
M	David E. Bowyer
N	Stone Hill Minerals Holdings, Inc.
O	Edwin D. & Jane C. Michael
P	Edwin D. Michael, et ux
Q	H. Dom Higginbotham
R	Thomas J. Jacoboni Revocable Trust Agreement
S	Faye Ann Skinner, et al
T	Christenson Family Trust
U	BRC Appalachian Minerals I, LLC
V	Deborah A. Beaver
W	Suzann Marie Stoehr, et al
X	BRC Appalachian Minerals I, LLC
Y	Waco Oil & Gas Co. Inc.

FILE NO: 326-34-G-17
 DRAWING NO: Peeler 2H Well Plat
 SCALE: 1" = 1500'
 MINIMUM DEGREE OF ACCURACY:
 Submeter
 PROVEN SOURCE OF ELEVATION:
 CORS, Monroe County, OH

STATE OF WEST VIRGINIA
 DEPARTMENT OF ENVIRONMENTAL PROTECTION
OIL AND GAS DIVISION

DATE: July 15 2021
 OPERATOR'S WELL NO. Peeler Unit 2H
 API WELL NO **MOD**
 47 - 103 - 03410
 STATE COUNTY PERMIT

WELL TYPE: OIL GAS LIQUID INJECTION WASTE DISPOSAL
 (IF GAS) PRODUCTION: STORAGE DEEP SHALLOW

LOCATION: ELEVATION: As-Built 1,223.8' WATERSHED: Fishing Creek QUADRANGLE: BTM Hole: Pine Grove
 DISTRICT: Green William L. & Thomas J. Jacoboni Revocable Trust Agreement; Faye Ann Skinner, et al; David E. Bowyer; COUNTY: **08/06/2021**
 SURFACE OWNER: Delores J. Gadd Stone Hill Minerals Holdings, Inc.; Edwin D. & Jane C. Michael; H. Dom Higginbotham; ACREAGE: 60.5
 ROYALTY OWNER: Ellen W. & Mark L. VanDyne; Shiben Estates, Inc.; John W. Bertram; Acropolis, Inc. LEASE NO: ACREAGE: 83.25; 50; 32.25

PROPOSED WORK: DRILL CONVERT DRILL DEEPER FRACTURE OR STIMULATE PLUG OFF OLD FORMATION
 PERFORATE NEW FORMATION OTHER PHYSICAL CHANGE IN WELL (SPECIFY) BHL MOD
 PLUG AND ABANDON CLEAN OUT AND REPLUG TARGET FORMATION: Marcellus Shale ESTIMATED DEPTH: 7,500' TVD 20,200' MD

WELL OPERATOR: Antero Resources Corporation DESIGNATED AGENT: Dianna Stamper - CT Corporation System
 ADDRESS: 1615 Wynkoop Street ADDRESS: 5400 D Big Tyler Road
 Denver, CO 80202 Charleston, WV 25313

9,285' to Bottom Hole

1,535' to Top Hole

TOP HOLE LATITUDE 39 - 35 - 00
BTM HOLD LATITUDE 39 - 32 - 30

TOP HOLE LONGITUDE 80 - 45 - 00
BTM HOLE LONGITUDE 80 - 42 - 30

12,165' to Top Hole

7,525' to Bottom Hole

Antero Resources
Well No. Peeler 2H
BHL MOD
Antero Resources Corporation



Notes
West Virginia Coordinate System of 1927, North Zone
based upon Differential GPS Measurements.
Well No. Peeler Unit 2H Top Hole coordinates are
N: 384,882.18' Latitude: 39°32'59.77"
E: 1,645,999.13' Longitude: 80°45'19.56"
Bottom Hole coordinates are
N: 374,292.03' Latitude: 39°31'15.64"
E: 1,649,852.47' Longitude: 80°44'28.50"
UTM Zone 17, NAD 1983
Top Hole Coordinates: Bottom Hole Coordinates
N: 4,377,843.664m N: 4,374,637.116m
E: 521,027,866m E: 522,255,550m
Plate orientation and corner and well references are based upon the grid north meridian.
Well location references are based upon the magnetic meridian.

Notes:
Well No. Peeler Unit 2H
UTM Zone 17, NAD 1927
Top Hole Coordinates
N: 14,362,260.76'
E: 1,709,357.53'
Point of Entry Coordinates
N: 14,362,316.95'
E: 1,709,728.23'
Bottom Hole Coordinates
N: 14,351,739.93'
E: 1,713,365.73'

	Bearing	Dist.
L1	S 41°16' E	2,581.7'
L2	S 45°01' W	1,507.5'
L3	N 64°19' W	984.5'
L4	N 37°39' W	833.9'
L5	N 82°20' E	375.1'

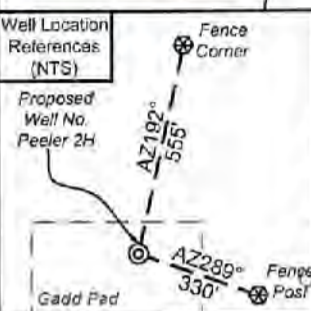

I, the undersigned, hereby certify that this plat is correct to the best of my knowledge and belief and shows all the information required by law and the rules issued and prescribed by the Department of Environmental Protection

Kevin S. James

Kevin S. James, P.S. 2305

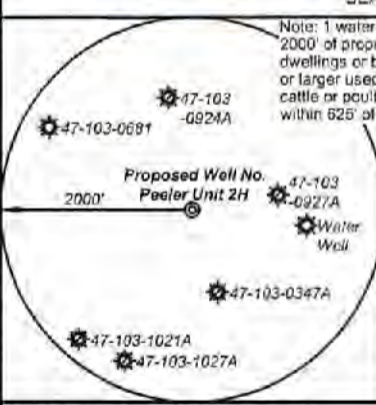

Legend

- Proposed gas well
- Monument, as noted
- Existing Well, as noted
- Digitized Well, as noted
- Creek or Drain
- Road
- Surface boundary (approx.)
- Interior surface tracts (approx.)
- Railroad

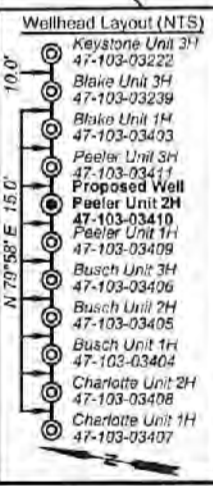

FILE NO: 326-34-G-17
DRAWING NO: Peeler 2H Well Plat
SCALE: 1" = 1500'
MINIMUM DEGREE OF ACCURACY: Submeter
PROVEN SOURCE OF ELEVATION: CORS, Monroe County, OH

STATE OF WEST VIRGINIA
DEPARTMENT OF ENVIRONMENTAL PROTECTION
OIL AND GAS DIVISION

DATE: July 15 2021
OPERATOR'S WELL NO. Peeler Unit 2H
API WELL NO **47-103-03410**
STATE COUNTY PERMIT

WELL TYPE: OIL GAS LIQUID INJECTION WASTE DISPOSAL
(IF GAS) PRODUCTION: STORAGE DEEP SHALLOW

LOCATION: ELEVATION: As-Built 1,223.8' WATERSHED: Fishing Creek QUADRANGLE: Top Hole: Porter Falls; BTM Hole: Pine Grove

DISTRICT: Green William L. & SURFACE OWNER: Delores J. Gadd Thomas J. Jacoboni Revocable Trust Agreement; Faye Ann Skinner, et al; David E. Bowyer; Stone Hill Minerals Holdings, Inc.; Edwin D. & Jane C. Michael; H. Dorn Higginbotham; Gordon Cummings; Reita Jane Hall; Clyda Robert Kennedy; Deborah A. Beaver; BRC Appalachian Minerals I, LLC (3); Eight Mile Ridge Church of Christ; Royalty Owner: Ellen W. & Mark L. VanDyne; Shiben Estates, Inc.; John W. Bertram; Acropolis, Inc. LEASE NO: ACREAGE: 60.5 7,500' TVD ESTIMATED DEPTH: 20,200' MD

PROPOSED WORK: DRILL CONVERT DRILL DEEPER FRACTURE OR STIMULATE PLUG OFF OLD FORMATION
 PERFORATE NEW FORMATION OTHER PHYSICAL CHANGE IN WELL (SPECIFY) BHL MOD

PLUG AND ABANDON CLEAN OUT AND REPLUG TARGET FORMATION: Marcellus Shale

WELL OPERATOR: Antero Resources Corporation DESIGNATED AGENT: Dianna Stamper - CT Corporation System
ADDRESS: 1615 Wynkoop Street ADDRESS: 5400 D Big Tyler Road
Denver, CO 80202 Charleston, WV 25313



ID	TM/Par	Owner	Bk/Pg	Acres
1	16-22	William L. & Delores J. Gadd	348/169	60.50
2	16-30	William L. & Delores J. Gadd	348/169	14.00
3	16-31	William L. & Delores J. Gadd	348/169	2.65
4	16-10	Loren & Shirley Haught	444/434	100.48
5	16-23	Kenneth E. Butler	331/110	50.97
6	16-23.1	Welzel County Public Service District 1	433/851	0.23
7	16-32	Fox Cemetery	50/137	1.17
8	16-33	William M. Greenawalt & Lee A. Niezgoda	387/1	11.80
9	16-40	William M. Greenawalt & Lee A. Niezgoda	387/1	18.00
10	16-41	James C. Henthorne	367/673	46.00
11	16-57	Lee A. Niezgoda	402/90	1.06
12	16-47	William M. Greenawalt & Lee A. Niezgoda	387/1	12.00
13	16-58	Mark & Michael Difiore	406/241	97.80
14	16-64	Mark & Michael Difiore	406/241	6.60
15	16-71	Michael L. & Tina M. Adams	437/722	30.50
16	19-3.1	Edwin D. & Jane C. Michael	275/42	36.84
17	19-8.2	Edwin D. & Jane C. Michael	275/42	22.00
18	19-8.3	Edwin D. & Jane C. Michael	275/42	24.50
19	19-18.1	Edwin D. & Jane Michael	364/565	8.00
20	19-17	John R. & Mary Ann Horner	416/853	47.55
21	19-18	Ronald L. & Sharon Christenson Family Trust	439/377	30.00
22	19-27	Ronald L. & Sharon Christenson Family Trust	439/377	25.00
23	19-28	Ronald L. & Sharon Christenson Family Trust	439/377	28.25
24	20-16	Coastal Forest Resources Co.	444/105	75.50
25	19-42	Sharon M. & Ronald L. Christenson	363/101	22.50
26	19-48.1	Teresa & Michael L. Bassett	423/982	2.00
27	19-47	Suzann M. Stoehr, et al	WB48/422	80.00
28	19-48	Teresa & Michael L. Bassett	423/982	51.00
29	19-49	Michael L. & Teresa Bassett	386/315	32.25

Leases	
A	Shiben Estates, Inc.
B	Ellen W. & Mark L. VanDyne
C	John W. Bertram
D	BRC Appalachian Minerals I, LLC
E	Gordon Cummings
F	Eight Mile Ridge Church of Christ
G	Nancy Tice
H	Reita Jane Hall
I	Acropolis, Inc.
J	Clyde Robert Kennedy
K	Emma Lee Rine
L	BRC Appalachian Minerals I, LLC
M	David E. Bowyer
N	Stone Hill Minerals Holdings, Inc.
O	Edwin D. & Jane C. Michael
P	Edwin D. Michael, et ux
Q	H. Dorn Higginbotham
R	Thomas J. Jacoboni Revocable Trust Agreement
S	Faye Ann Skinner, et al
T	Christenson Family Trust
U	BRC Appalachian Minerals I, LLC
V	Deborah A. Beaver
W	Suzann Marie Stoehr, et al
X	BRC Appalachian Minerals I, LLC
Y	Waco Oil & Gas Co. Inc.

RECEIVED
 Office of Oil and Gas
 JUL 21 2021
 WV Department of Environmental Protection

FILE NO: 326-34-G-17
 DRAWING NO: Peeler 2H Well Plat
 SCALE: 1" = 1500'
 MINIMUM DEGREE OF ACCURACY:
 Submeter
 PROVEN SOURCE OF ELEVATION:
 CORS, Monroe County, OH

STATE OF WEST VIRGINIA
 DEPARTMENT OF ENVIRONMENTAL PROTECTION
OIL AND GAS DIVISION



DATE: July 15 2021
 OPERATOR'S WELL NO. Peeler Unit 2H
 API WELL NO MOD
 47 - 103 - 03410
 STATE COUNTY PERMIT

WELL TYPE: OIL GAS LIQUID INJECTION WASTE DISPOSAL
 (IF GAS) PRODUCTION: STORAGE DEEP SHALLOW

LOCATION: ELEVATION: As-Built 1,223.8' WATERSHED: Fishing Creek QUADRANGLE: Top Hole: Porter Falls
 Bottom Hole: Pine Grove
 DISTRICT: Green William L. & Delores J. Gadd Thomas J. Jacoboni Revocable Trust Agreement; Faye Ann Skinner, et al; David E. Bowyer; COUNTY: West Virginia
 SURFACE OWNER: Delores J. Gadd Stone Hill Minerals Holdings, Inc.; Edwin D. & Jane C. Michael; H. Dorn Higginbotham; Gordon Cummings; Reita Jane Hall; Clyde Robert Kennedy; Deborah A. Beaver; ACREAGE: 60.5
 ROYALTY OWNER: Ellen W. & Mark L. VanDyne; Shiben Estates, Inc.; John W. Bertram; Acropolis, Inc. LEASE NO: ACREAGE: 83.25; 50; 32.25

PROPOSED WORK: DRILL CONVERT DRILL DEEPER FRACTURE OR STIMULATE PLUG OFF OLD FORMATION
 PERFORATE NEW FORMATION OTHER PHYSICAL CHANGE IN WELL (SPECIFY) BHL MOD
 PLUG AND ABANDON CLEAN OUT AND REPLUG TARGET FORMATION: Marcellus Shale ESTIMATED DEPTH: 7,500' TVD
 20,200' MD

WELL OPERATOR: Antero Resources Corporation DESIGNATED AGENT: Dianna Stamper - CT Corporation System
 ADDRESS: 1615 Wynkoop Street ADDRESS: 5400 D Big Tyler Road
 Denver, CO 80202 Charleston, WV 25313