

1,591' to Top Hole

7,696' to Bottom Hole

LATITUDE 39 - 35 - 00

LONGITUDE 80 - 45 - 00

**Antero Resources**  
**Well No. Busch 1H**  
**BHL MOD**  
Antero Resources Corporation

Sheet 1 of 3

Busch Unit 1H  
Bottom Hole

BTM Hole  
7.5' Spot

See Detail  
Page 2



**Notes**  
West Virginia Coordinate System of 1927, North Zone based upon Differential GPS Measurements.

Well No. Busch Unit 1H Top Hole coordinates are  
N: 384,871.72' Latitude: 39°32'59.66"  
E: 1,645,940.05' Longitude: 80°45'20.31"

Bottom Hole coordinates are  
N: 396,870.36' Latitude: 39°34'55.43"  
E: 1,639,997.90' Longitude: 80°46'38.30"

UTM Zone 17, NAD 1983

Top Hole Coordinates Bottom Hole Coordinates  
N: 4,377,840.376m N: 4,381,404.656m  
E: 521,009.920m E: 519,139.735m

Plat orientation and corner and well references are based upon the grid north meridian.  
Well location references are based upon the magnetic meridian.

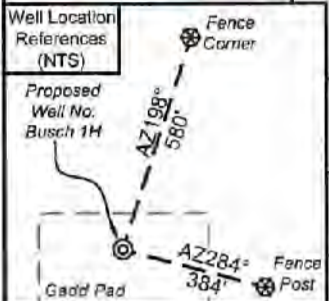

I, the undersigned, hereby certify that this plat is correct to the best of my knowledge and belief and shows all the information required by law and the rules issued and prescribed by the Department of Environmental Protection.

*Bradley D. Miller*  
Bradley D. Miller, P.S. 2167



SEAL

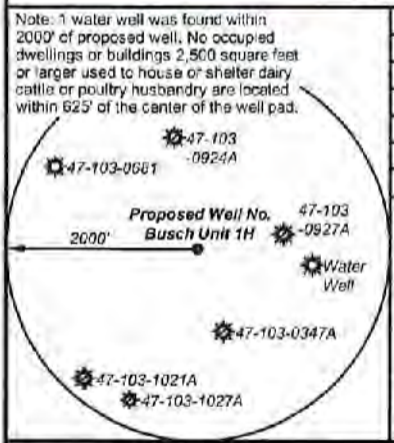

	Bearing	Dist.
L1	S 40°07' E	2,551.1'
L2	S 46°16' W	1,557.1'
L3	N 66°16' W	1,033.8'
L4	N 41°11' W	863.4'
L5	S 77°00' W	1,969.8'

- Legend**
- Proposed gas well
  - Monument, as noted
  - Existing Well, as noted
  - Digitized Well, as noted
  - Creek or Drain
  - Road
  - Surface boundary (approx.)
  - Interior surface tracts (approx.)
  - Railroad Right-of-Way

**Notes:**  
Well No. Busch Unit 1H  
UTM Zone 17, NAD 1927

Top Hole Coordinates  
N: 14,362,249.31'  
E: 1,709,298.65'

Point of Entry Coordinates  
N: 14,361,774.10'  
E: 1,707,387.71'

Bottom Hole Coordinates  
N: 14,373,843.18'  
E: 1,703,162.44'

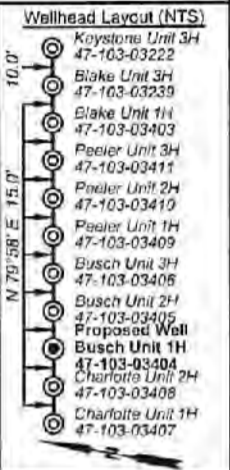

FILE NO: 235-34-G-17  
DRAWING NO: Busch 1H Well Plat  
SCALE: 1" = 1500'  
MINIMUM DEGREE OF ACCURACY: Submeter  
PROVEN SOURCE OF ELEVATION: CORS, Monroe County, OH

**STATE OF WEST VIRGINIA**  
DEPARTMENT OF ENVIRONMENTAL PROTECTION  
**OIL AND GAS DIVISION**

DATE: July 19 2021  
OPERATOR'S WELL NO. Busch Unit 1H  
API WELL NO. MOD  
47 - 103 - 03404  
STATE COUNTY PERMIT

WELL TYPE:  OIL  GAS  LIQUID INJECTION  WASTE DISPOSAL  
(IF GAS) PRODUCTION:  STORAGE  DEEP  SHALLOW

LOCATION: ELEVATION: As-Built 1,223.8' WATERSHED: Fishing Creek QUADRANGLE: Porter Falls  
DISTRICT: Green William L. & SURFACE OWNER: Delores J. Gadd COUNTY: Wayne  
ROYALTY OWNER: Shiban Estates, Inc.; Gladys E. Conley Trust; Chesapeake Appalachia, LLC. LEASE NO: ACREAGE: 60.5  
PROPOSED WORK:  DRILL  CONVERT  DRILL DEEPER  FRACTURE OR STIMULATE  PLUG OFF OLD FORMATION  
 PERFORATE NEW FORMATION  OTHER PHYSICAL CHANGE IN WELL (SPECIFY) BHL MOD  
 PLUG AND ABANDON  CLEAN OUT AND REPLUG TARGET FORMATION: Marcellus Shale ESTIMATED DEPTH: 7,400' TVD 23,100' MD

WELL OPERATOR: Antero Resources Corporation DESIGNATED AGENT: Dianna Stamper - CT Corporation System  
ADDRESS: 1615 Wynkoop Street ADDRESS: 5400 D Big Tyler Road  
Denver, CO 80202 Charleston, WV 25313

08/06/2021

**Antero Resources  
Well No. Busch 1H  
BHL MOD**

Antero Resources Corporation

Sheet 2 of 3



Leases	
A	Shiben Estates, Inc.
B	BRC Appalachian Minerals I LLC
C	John W. Bertram
D	David A. Dickey
E	Sandra Rose Conley
F	Richard Lee Tennant, et ux
G	Harry I. Elson
H	Chesapeake Appalachia, LLC
I	Gladys E. Conley Trust
J	Mildred Caseman
K	Sielger Family Trust
L	Chesapeake Appalachia, LLC
M	Loretta Paulette Ueltschy
N	Donald E. Dawson, et ux
O	Lee & Hall Royalties
P	Richard B. Dallison, et ux
Q	Paul H. Abel
R	Ridgetop Royalties, LLC
S	Ridgetop Royalties, LLC
T	Leslie A. Lively
U	Bounty Minerals, LLC
V	Robert D. Loy, et ux
W	Beulah I. Snider
X	Emma Ruth Taylor
Y	Leslie A. Lively
Z	Antero Minerals
AA	Richards Resources
AB	WVDNR
AC	San-Dee N. Stradley
AD	Michelle R. Mason
AE	OPEN
AF	Phillip Willey
AG	Antero Minerals
AH	Jeffrey J. Ellis
AI	Joyce Cain
AJ	Barbara Sue Thomas
AK	SanDee Nieboer Stradley
AL	Roberta Lyn Sommerville
AM	Steven J. Melott
AN	Joyce Cain
AO	OPEN
AP	Allen G. Cain, et ux
AQ	Rodney Dale Weekley, et ux
AR	Jodie J. Dawson
AS	Raymond E. Lasure, et ux
AT	Kimberly A. Miller
AU	Rodney Dale Weekley, et ux
AV	Amelia Ann Bocher & Roy L. Vancamp
AW	Leo E. Bassett, et ux
AX	David Wilson
AY	Peggy Ann Dawson Supplemental Needs Trust
AZ	John R. Morgan
BA	James David Alawine
BB	Elwood L. & Carmen Y. Blake
BC	John R. Morgan
BD	Michelle R. Mason
BE	Allen G. Morgan
BF	CSX Transportation
BG	David E. Bowyer
BH	CSX Transportation

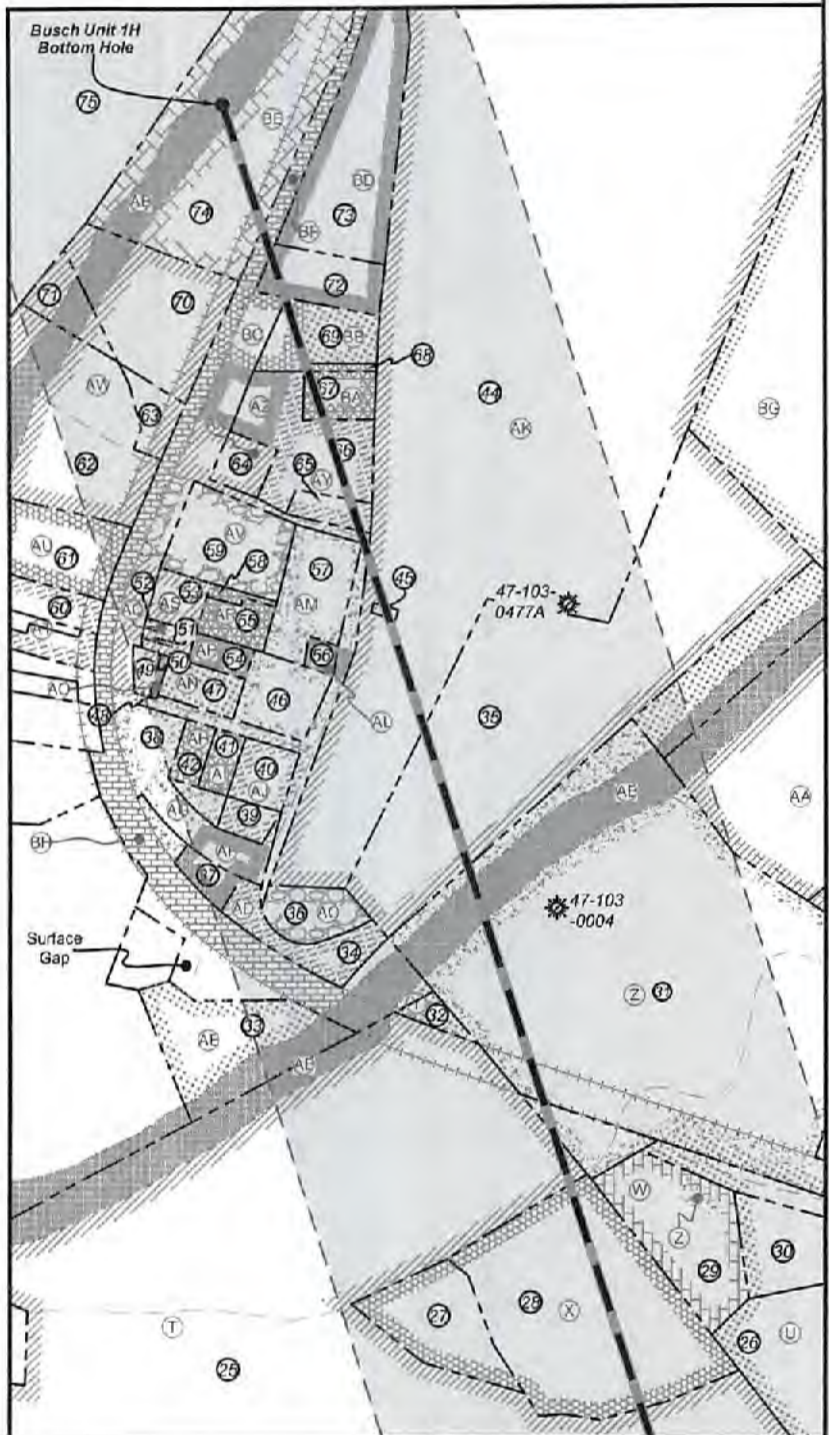

FILE NO: 235-34-G-17  
 DRAWING NO: Busch 1H Well Plat  
 SCALE: 1" = 1500'  
 MINIMUM DEGREE OF ACCURACY: Submeter  
 PROVEN SOURCE OF ELEVATION: CORS, Monroe County, OH

**STATE OF WEST VIRGINIA**  
 DEPARTMENT OF ENVIRONMENTAL PROTECTION  
**OIL AND GAS DIVISION**

DATE: July 19 2021  
 OPERATOR'S WELL NO. Busch Unit 1H  
 API WELL NO MOD  
47 - 103 - 03404  
 STATE COUNTY PERMIT

WELL TYPE:  OIL  GAS  LIQUID INJECTION  WASTE DISPOSAL  
 (IF GAS) PRODUCTION:  STORAGE  DEEP  SHALLOW

LOCATION: ELEVATION: As-Built 1,223.8' WATERSHED: Fishing Creek QUADRANGLE: Porter Falls  
 DISTRICT: Green William L. & SURFACE OWNER: Delores J. Gadd COUNTY: West Virginia  
 ROYALTY OWNER: Shiben Estates, Inc.; Gladys E. Conley Trust; Chesapeake Appalachia, LLC; LEASE NO: \_\_\_\_\_ ACREAGE: 60.5  
 PROPOSED WORK:  DRILL  CONVERT  DRILL DEEPER  FRACTURE OR STIMULATE  PLUG OFF OLD FORMATION  
 PERFORATE NEW FORMATION  OTHER PHYSICAL CHANGE IN WELL (SPECIFY) BHL MOD  
 PLUG AND ABANDON  CLEAN OUT AND REPLUG TARGET FORMATION: Marcellus Shale ESTIMATED DEPTH: 23,100' MD

WELL OPERATOR: Antero Resources Corporation DESIGNATED AGENT: Dianna Stamper - CT Corporation System  
 ADDRESS: 1615 Wynkoop Street ADDRESS: 5400 D Big Tyler Road  
Denver, CO 80202 Charleston, WV 25313

08/06/2021



ID	TM/Par	Owner	Bk/Pg	Acres	ID	TM/Par	Owner	Bk/Pg	Acres
1	16-22	William L. & Delores J. Gadd	348/169	60.50	40	31-16	Barbara Sue Thomas	457/139	0.30
2	16-31	William L. & Delores J. Gadd	348/169	2.65	41	31-15	Carl J. Lancaster Est.	WB66/516	0.17
3	16-23	Kenneth E. Butler	331/110	50.97	42	31-14	Jeffrey J. Ellis	466/868	0.17
4	16-30	William L. & Delores J. Gadd	348/169	14.00	43	12-11	Timothy L. & Michael A. McDiffitt	385/189	131.34
5	16-47	William M. Greenawalt & Lea A. Niezgoda	387/1	12.00	44	7-53	Easterling Trust	446/376	32.98
					45	31-9	Columbia Gas Trans Corp.	263/164	0.02
6	16-38	Silas Tennant	137/85	15.50	46	31-11	Steven J. Melott	420/137	---
7	16-37	Garrett S. Estate	316/248	61.00	47	31-28	Carl J. Lancaster Est.	WB66/516	0.28
8	16-21.1	Mildred E. Caseman	WB45/396	15.00	48	31-26.1	Michael or Melissa Scyoc	461/631	0.06
9	16-21	Mildred E. Caseman	WB45/396	40.00	49	31-26	Raymond E. & Catherine H. Lasure	249/435	0.09
10	16-21.2	Mildred E. Caseman	WB45/396	20.06	50	31-25	Raymond E. & Catherine H. Lasure	259/151	0.03
11	16-20	Bonita Andrich, et al	WB70/243	79.03	51	31-24	Raymond E. & Catherine H. Lasure	249/435	0.03
12	16-8	Wilbur B. Dawson & Loretta P. Ueltschy	408/192	75.75	52	31-12	Rodney Dale Weekley	302/79	0.03
13	16-21.3	Mildred E. Caseman	WB45/396	12.00	53	31-12.2	Raymond E. & Catherine H. Lasure	249/435	0.28
14	16-21.4	Mildred E. Caseman	WB45/396	1.00	54	31-12.3	Allen G. & Joyce E. Cain	316/133	0.16
15	16-3	Wilbur B. Dawson & Loretta P. Ueltschy	408/192	49.80	55	31-12.1	Jody J. Dawson	344/149	0.25
16	16-3.1	Donald E. & Carolyn L. Dawson	332/114	10.00	56	31-10	M E Church	134/457	0.08
17	12-55	Bradley W. Ueltschy	330/37	100.00	57	31-8	Steven J. Melott	420/400	0.75
18	12-49	John W. & Rosalie M. Ueltschy	362/403	86.55	58	31-7.1	Jody J. Dawson	344/149	0.06
19	12-50	Richard B. & Jaynee C. Dallison	399/288	37.00	59	31-7	Danny R. & Christina F. Booher	285/134	0.80
20	12-39	Martin E. Rodgers	421/621	60.00	60	31-27.1	Kimbarly A. Miller	406/527	0.15
21	12-26	Martin E. Rodgers	419/493	50.40	61	31-27	Rodney D. Weekley	302/79	1.40
22	12-40	Martin E. Rodgers	421/621	60.00	62	31-23	Lee E. & Charlotte D. Bassett	395/29	1.42
23	12-30	Martin E. Rodgers	363/413	51.06	63	31-22	Lee E. & Charlotte D. Bassett	395/29	0.50
24	12-27	Martin E. Rodgers	363/413	3.08	64	31-6	The Peggy Ann Dawson Supplemental Needs Trust	471/214	0.23
25	12-18	Leslie A. Lively	387/229	39.63					
26	12-20.1	Jerome E. II & Benita K. Staley	415/329	13.34	65	31-5	The Peggy Ann Dawson Supplemental Needs Trust	471/214	0.25
27	12-18.2	Charles A. Loy	331/320	1.18					
28	12-18.1	Martha R. Campbell	254/495	3.37	66	31-4	The Peggy Ann Dawson Supplemental Needs Trust	471/214	0.98
29	12-19	Beulah I. Snider	WB45/396	1.30					
30	12-20	Bonnie Ueltschy	WB70/248	0.75	67	31-4.1	James David Alawine	479/446	0.50
31	12-5	Columbia Gas Trans Corp.	263/164	11.70	68	31-4.3	James David Alawine	479/446	0.05
32	31-20	B&O RR Co.	---	0.14	69	31-4.2	Elwood & Carman Y. Blake	371/617	0.58
33	31-35	Kenneth Scyoc, et al	AP10/559	1.10	70	31-21	Lee E. & Charlotte D. Bassett	395/29	2.50
34	31-19	Paul Abel Trust	329/377	0.66	71	31-23.1	Lee E. & Charlotte D. Bassett	395/29	0.33
35	12-4	Easterling Trust	448/376	7.16	72	31-1	Elwood & Carman Y. Blake	371/649	0.39
36	12-3	Easterling Trust	448/376	0.50	73	7-52	Ronnie Lee Powers	340/248	1.00
37	31-18	Philip Wiley	379/245	0.33	74	7-51	Shawn C. Stackpole	408/622	4.12
38	31-13	Clair Phillip Dawson, Jr.	471/210	0.25	75	7-50	Bradley W. & Kimberly Ueltschy	342/710	79.78
39	31-17	Barbara Sue Thomas	457/139	0.17					



**STATE OF WEST VIRGINIA**  
 DEPARTMENT OF ENVIRONMENTAL PROTECTION  
**OIL AND GAS DIVISION**

FILE NO: 235-34-G-17  
 DRAWING NO: Busch 1H Well Plat  
 SCALE: 1" = 1500'  
 MINIMUM DEGREE OF ACCURACY:  
Submeter  
 PROVEN SOURCE OF ELEVATION:  
CORS, Monroe County, OH

DATE: July 19 2021  
 OPERATOR'S WELL NO. Busch Unit 1H  
 API WELL NO M0D  
47 — 103 — 03404  
 STATE COUNTY PERMIT

WELL TYPE:  OIL  GAS  LIQUID INJECTION  WASTE DISPOSAL  
 (IF GAS) PRODUCTION:  STORAGE  DEEP  SHALLOW

LOCATION: ELEVATION: As-Built 1,223.6' WATERSHED: Fishing Creek QUADRANGLE: Porter Falls  
 DISTRICT: Green William L. & SURFACE OWNER: Delores J. Gadd COUNTY: Wetzel  
 ROYALTY OWNER: Shiben Estates, Inc.; Gladys E. Conley Trust; Chesapeake Appalachia, LLC. LEASE NO: \_\_\_\_\_ ACREAGE: \_\_\_\_\_  
 PROPOSED WORK:  DRILL  CONVERT  DRILL DEEPER  FRACTURE OR STIMULATE  PLUG OFF OLD FORMATION  
 PERFORATE NEW FORMATION  OTHER PHYSICAL CHANGE IN WELL (SPECIFY) BHL MOD  
 PLUG AND ABANDON  CLEAN OUT AND REPLUG TARGET FORMATION: Marcellus Shale ESTIMATED DEPTH: 7,400' TVD  
23,100' MD

WELL OPERATOR: Antero Resources Corporation DESIGNATED AGENT: Dianna Stamper - CT Corporation System  
 ADDRESS: 1615 Wynkoop Street ADDRESS: 5400 D Big Tyler Road  
Denver, CO 80202 Charleston, WV 25313

1.4193; 11.438; 49.8;  
 39.62; 3.07; 5.07; 60.6;  
 150; 10; 1.15; 40.16;  
 1.275; 4.55; 13.28; 4.125;  
 2.5; 0.55; 0.40; 0.36961;  
 0.406;  
**08/06/2021**

1,591' to Top Hole

7,696' to Bottom Hole

LATITUDE 39 - 35 - 00

LONGITUDE 80 - 45 - 00

Antero Resources  
Well No. Busch 1H  
BHL MOD  
Antero Resources Corporation

Sheet 1 of 3

Busch Unit 1H  
Bottom Hole

BTM Hole  
7.5' Spot

See Detail  
Page 2

Notes

West Virginia Coordinate System  
of 1927, North Zone  
based upon Differential GPS Measurements.  
Well No. Busch Unit 1H Top Hole coordinates are  
N: 384,871.72' Latitude: 39°32'59.68"  
E: 1,645,940.05' Longitude: 80°45'20.31"  
Bottom Hole coordinates are  
N: 396,670.36' Latitude: 39°34'55.43"  
E: 1,639,997.90' Longitude: 80°48'38.30"  
UTM Zone 17, NAD 1983  
Top Hole Coordinates Bottom Hole Coordinates  
N: 4,377,840.376m N: 4,381,404.656m  
E: 521,009.920m E: 519,139.735m  
Plat orientation and corner and well references  
are based upon the grid north meridian.  
Well location references are based upon the magnetic  
meridian.



Well Location  
References  
(NTS)

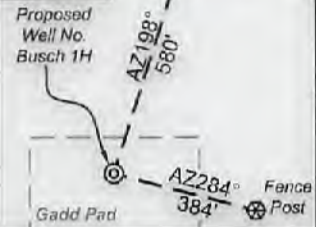

I, the undersigned, hereby certify that this  
plat is correct to the best of my  
knowledge and belief and shows all the  
information required by law and the rules  
issued and prescribed by the  
Department of Environmental Protection.

*Bradley D. Miller*

Bradley D. Miller, P.S. 2167



SEAL

Note: 1 water well was found within  
2000' of proposed well. No occupied  
dwellings or buildings 2,500 square feet  
or larger used to house or shelter dairy  
cattle or poultry husbandry are located  
within 625' of the center of the well pad.

	Bearing	Dist.
L1	S 40°07' E	2,551.1'
L2	S 46°16' W	1,557.1'
L3	N 66°16' W	1,033.8'
L4	N 41°11' W	863.4'
L5	S 77°00' W	1,969.8'

Legend

- Proposed gas well
- Monument, as noted
- Existing Well, as noted
- Digitized Well, as noted
- Creek or Drain
- Road
- Surface boundary (approx.)
- Interior surface tracts (approx.)
- Railroad Right-of-Way



FILE NO: 235-34-G-17  
DRAWING NO: Busch 1H Well Plat  
SCALE: 1" = 1500'  
MINIMUM DEGREE OF ACCURACY:  
Submeter  
PROVEN SOURCE OF ELEVATION:  
CORS, Monroe County, OH

STATE OF WEST VIRGINIA  
DEPARTMENT OF ENVIRONMENTAL PROTECTION  
OIL AND GAS DIVISION

DATE: July 19 20 21  
OPERATOR'S WELL NO. Busch Unit 1H  
API WELL NO. 47 - 103 - 03404  
STATE COUNTY PERMIT

WELL TYPE:  OIL  GAS  LIQUID INJECTION  WASTE DISPOSAL  
(IF GAS) PRODUCTION:  STORAGE  DEEP  SHALLOW  
LOCATION: ELEVATION: As-Built 1,223.8' WATERSHED: Fishing Creek QUADRANGLE: Porter Falls  
DISTRICT: Green William L. & SURFACE OWNER: Delores J. Gadd COUNTY: Wayne  
ROYALTY OWNER: Shiben Estates, Inc.; Gladys E. Conley Trust; Chesapeake Appalachia, LLC. LEASE NO: ACREAGE: 60.5  
PROPOSED WORK:  DRILL  CONVERT  DRILL DEEPER  FRACTURE OR STIMULATE  PLUG OFF OLD FORMATION  
 PERFORATE NEW FORMATION  OTHER PHYSICAL CHANGE IN WELL (SPECIFY) BHL MOD  
 PLUG AND ABANDON  CLEAN OUT AND REPLUG TARGET FORMATION: Marcellus Shale ESTIMATED DEPTH: 23,100' MD

WELL OPERATOR: Antero Resources Corporation DESIGNATED AGENT: Dianna Stamper - CT Corporation System  
ADDRESS: 1615 Wynkoop Street ADDRESS: 5400 D Big Tyler Road  
Denver, CO 80202 Charleston, WV 25313

08/06/2021

12,176' to Top Hole

**Antero Resources**  
**Well No. Busch 1H**  
**BHL MOD**  
 Antero Resources Corporation



Leases	
A	Shiben Estates, Inc.
B	BRC Appalachian Minerals I LLC
C	John W. Bertram
D	David A. Dickey
E	Sandra Rose Conley
F	Richard Lee Tennant, et ux
G	Harry I. Elson
H	Chesapeake Appalachia, LLC
I	Gladys E. Conley Trust
J	Mildred Caseman
K	Sietger Family Trust
L	Chesapeake Appalachia, LLC
M	Loretta Paulette Ueltschy
N	Donald E. Dawson, et ux
O	Lee & Hall Royalties
P	Richard B. Dallison, et ux
Q	Paul H. Abel
R	Ridgetop Royalties, LLC
S	Ridgetop Royalties, LLC
T	Leslie A. Lively
U	Bounty Minerals, LLC
V	Robert D. Loy, et ux
W	Beulah I. Snider
X	Emma Ruth Taylor
Y	Leslie A. Lively
Z	Antero Minerals
AA	Richards Resources
AB	WVDNR
AC	San-Dee N. Stradley
AD	Michelle R. Mason
AE	OPEN
AF	Phillip Wiley
AG	Antero Minerals
AH	Jeffrey J. Ellis
AI	Joyce Cain
AJ	Barbara Sue Thomas
AK	SanDee Nieboer Stradley
AL	Roberta Lyn Sommerville
AM	Steven J. Melott
AN	Joyce Cain
AO	OPEN
AP	Allen G. Cain, et ux
AQ	Rodney Dale Weekley, et ux
AR	Jodie J. Dawson
AS	Raymond E. Lasure, et ux
AT	Kimberly A. Miller
AU	Rodney Dale Weekley, et ux
AV	Amelia Ann Bocher & Roy L. Vancamp
AW	Lee E. Bassett, et ux
AX	David Wilson
AY	Peggy Ann Dawson Supplemental Needs Trust
AZ	John R. Morgan
BA	James David Alawine
BB	Elwood L. & Carmen Y. Blake
BC	John R. Morgan
BD	Michelle R. Mason
BE	Allen G. Morgan
BF	CSX Transportation
BG	David E. Bowyer
BH	CSX Transportation

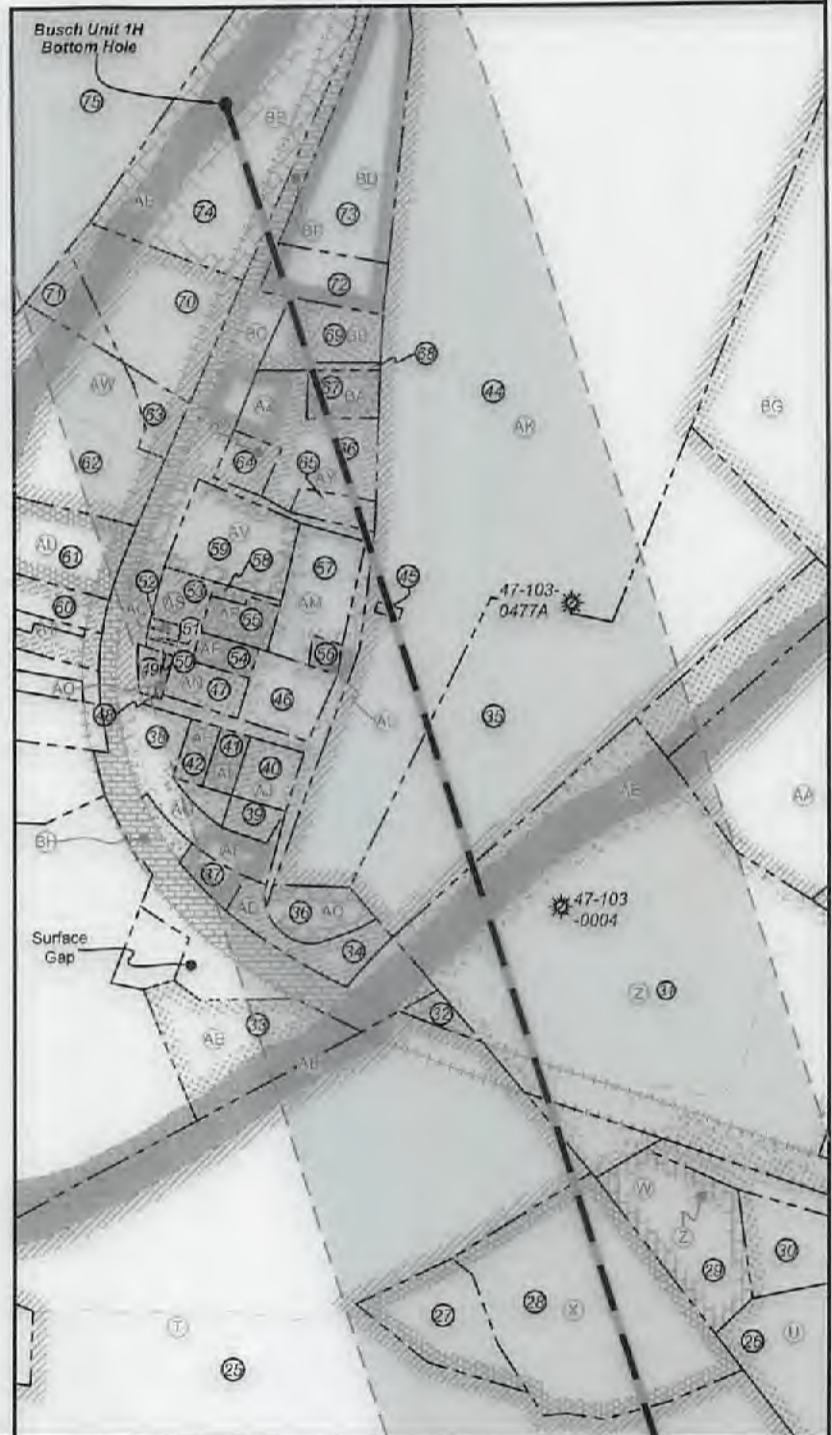

FILE NO: 235-34-G-17  
 DRAWING NO: Busch 1H Well Plat  
 SCALE: 1" = 1500'  
 MINIMUM DEGREE OF ACCURACY:  
 Submeter  
 PROVEN SOURCE OF ELEVATION:  
 CORS, Monroe County, OH

**STATE OF WEST VIRGINIA**  
 DEPARTMENT OF ENVIRONMENTAL PROTECTION  
**OIL AND GAS DIVISION**

DATE: July 19 2021  
 OPERATOR'S WELL NO. Busch Unit 1H  
 API WELL NO **Mod**  
 47 - 103 - 03404  
 STATE COUNTY PERMIT

WELL TYPE:  OIL  GAS  LIQUID INJECTION  WASTE DISPOSAL  
 (IF GAS) PRODUCTION:  STORAGE  DEEP  SHALLOW

LOCATION: ELEVATION: As-Built 1,223.8' WATERSHED: Fishing Creek QUADRANGLE: Porter Falls  
 DISTRICT: Green William L. & SURFACE OWNER: Delores J. Gadd COUNTY: Wayne ACREAGE: 60.5  
 ROYALTY OWNER: Shiben Estates, Inc.; Gladys E. Conley Trust; Chesapeake Appalachia, LLC; LEASE NO: \_\_\_\_\_ ACREAGE: \_\_\_\_\_

PROPOSED WORK:  DRILL  CONVERT  DRILL DEEPER  FRACTURE OR STIMULATE  PLUG OFF OLD FORMATION  
 PERFORATE NEW FORMATION  OTHER PHYSICAL CHANGE IN WELL (SPECIFY) BHL MOD  
 PLUG AND ABANDON  CLEAN OUT AND REPLUG TARGET FORMATION: Marcellus Shale ESTIMATED DEPTH: 7,400' TVD  
23,100' MD

WELL OPERATOR: Antero Resources Corporation DESIGNATED AGENT: Dianna Stamper - GT Corporation System  
 ADDRESS: 1615 Wynkoop Street ADDRESS: 5400 D Big Tyler Road  
Denver, CO 80202 Charleston, WV 25313



ID	TM/Par	Owner	Bk/Pg	Acres	ID	TM/Par	Owner	Bk/Pg	Acres
1	16-22	William L. & Delores J. Gadd	348/169	60.50	40	31-16	Barbara Sue Thomas	457/139	0.30
2	16-31	William L. & Delores J. Gadd	348/169	2.65	41	31-15	Carl J. Lancaster Est.	WB66/516	0.17
3	16-23	Kenneth E. Butler	331/110	50.97	42	31-14	Jeffrey J. Ellis	466/868	0.17
4	16-30	William L. & Delores J. Gadd	348/169	14.00	43	12-11	Timothy L. & Michael A. McDifitt	385/189	131.34
5	16-47	William M. Greenawalt & Lee A. Niezgoda	387/1	12.00	44	7-53	Easterling Trust	446/376	32.98
6	16-38	Silas Tennant	137/85	15.50	45	31-9	Columbia Gas Trans Corp.	263/164	0.02
7	16-37	Garrett S. Estate	316/248	61.00	46	31-11	Steven J. Melott	420/137	---
8	16-21.1	Mildred E. Caseman	WB45/396	15.00	47	31-28	Carl J. Lancaster Est.	WB66/516	0.28
9	16-21	Mildred E. Caseman	WB45/396	40.00	48	31-26.1	Michael or Melissa Soyoc	461/681	0.06
10	16-21.2	Mildred E. Caseman	WB45/396	20.06	49	31-26	Raymond E. & Catherine H. Lasure	249/435	0.09
11	16-20	Bonita Andrich, et al	WB70/243	79.03	50	31-25	Raymond E. & Catherine H. Lasure	258/151	0.03
12	16-8	Wilbur B. Dawson & Loretta P. Ueltschy	408/192	75.75	51	31-24	Raymond E. & Catherine H. Lasure	249/435	0.03
13	16-21.3	Mildred E. Caseman	WB45/396	12.00	52	31-12	Rodney Dale Weekley	302/79	0.03
14	16-21.4	Mildred E. Caseman	WB45/396	1.00	53	31-12.2	Raymond E. & Catherine H. Lasure	249/435	0.28
15	16-3	Wilbur B. Dawson & Loretta P. Ueltschy	408/192	49.80	54	31-12.3	Allen G. & Joyce E. Cain	316/133	0.16
16	16-3.1	Donald E. & Carolyn L. Dawson	332/114	10.00	55	31-12.1	Jody J. Dawson	344/149	0.25
17	12-55	Bradley W. Ueltschy	330/37	100.00	56	31-10	M E Church	134/457	0.08
18	12-49	John W. & Rosalie M. Ueltschy	362/403	86.55	57	31-8	Steven J. Melott	420/400	0.75
19	12-50	Richard B. & Jaynee C. Dallison	399/286	37.00	58	31-7.1	Jody J. Dawson	344/149	0.06
20	12-39	Martin E. Rodgers	421/621	60.00	59	31-7	Danny R. & Christina F. Booher	285/134	0.80
21	12-26	Martin E. Rodgers	419/493	50.40	60	31-27.1	Kimberly A. Miller	406/527	0.15
22	12-40	Martin E. Rodgers	421/621	60.00	61	31-27	Rodney D. Weekley	302/79	1.40
23	12-30	Martin E. Rodgers	363/413	51.08	62	31-23	Lee E. & Charlotte D. Bassett	395/29	1.42
24	12-27	Martin E. Rodgers	363/413	3.08	63	31-22	Lee E. & Charlotte D. Bassett	395/29	0.50
25	12-18	Leslie A. Lively	387/229	39.63	64	31-6	The Peggy Ann Dawson Supplemental Needs Trust	471/214	0.23
26	12-20.1	Jerome E. II & Benita K. Staley	415/329	13.34	65	31-5	The Peggy Ann Dawson Supplemental Needs Trust	471/214	0.25
27	12-18.2	Charles A. Loy	331/320	1.18	66	31-4	The Peggy Ann Dawson Supplemental Needs Trust	471/214	0.98
28	12-18.1	Martina R. Campbell	254/495	3.37	67	31-4.1	James David Alawine	479/448	0.50
29	12-19	Beulah I. Snider	WB45/396	1.30	68	31-4.3	James David Alawine	479/448	0.05
30	12-20	Bonnie Ueltschy	WB70/248	0.75	69	31-4.2	Elwood & Carman Y. Blake	371/617	0.58
31	12-5	Columbia Gas Trans Corp.	263/164	11.70	70	31-21	Lee E. & Charlotte D. Bassett	395/29	2.50
32	31-20	B&O RR Co.	---	0.14	71	31-23.1	Lee E. & Charlotte D. Bassett	395/29	0.33
33	31-35	Kenneth Soyoc, et al	AP10/559	1.10	72	31-1	Elwood & Carman Y. Blake	371/649	0.39
34	31-19	Paul Abel Trust	328/377	0.66	73	7-52	Ronnie Lee Powers	340/248	1.00
35	12-4	Easterling Trust	446/376	7.16	74	7-51	Shawn C. Stackpole	406/622	4.12
36	12-3	Easterling Trust	446/376	0.50	75	7-50	Bradley W. & Kimberly Ueltschy	342/710	79.78
37	31-18	Phillip Wiley	379/245	0.33					
38	31-13	Clair Phillip Dawson, Jr.	471/210	0.25					
39	31-17	Barbara Sue Thomas	457/139	0.17					

FILE NO: 235-34-G-17  
 DRAWING NO: Busch 1H Well Plat  
 SCALE: 1" = 1500'  
 MINIMUM DEGREE OF ACCURACY:  
 Submeter  
 PROVEN SOURCE OF ELEVATION:  
 CORS, Monroe County, OH



DATE: July 19 20 21  
 OPERATOR'S WELL NO. Busch Unit 1H  
 API WELL NO. **MOD**  
 47 - 103 - 03404  
 STATE COUNTY PERMIT

WELL TYPE:  OIL  GAS  LIQUID INJECTION  WASTE DISPOSAL  
 (IF GAS) PRODUCTION:  STORAGE  DEEP  SHALLOW

LOCATION: ELEVATION: As-Built 1,223.8' WATERSHED: Fishing Creek QUADRANGLE: Porter Falls

DISTRICT: Green William L. & SURFACE OWNER: Delores J. Gadd COUNTY: West Virginia  
 ROYALTY OWNER: Shiben Estates, Inc., Gladys E. Conley Trust, Chesapeake Appalachia, LLC. ACREAGE: 60.5  
 LEASE NO: \_\_\_\_\_ ACREAGE: \_\_\_\_\_

PROPOSED WORK:  DRILL  CONVERT  DRILL DEEPER  FRACTURE OR STIMULATE  PLUG OFF OLD FORMATION  
 PERFORATE NEW FORMATION  OTHER PHYSICAL CHANGE IN WELL (SPECIFY) BHL MOD  
 PLUG AND ABANDON  CLEAN OUT AND REPLUG TARGET FORMATION: Marcellus Shale ESTIMATED DEPTH: 23,100' MD

WELL OPERATOR: Antero Resources Corporation DESIGNATED AGENT: Dianna Stamper - CT Corporation System  
 ADDRESS: 1615 Wynkoop Street ADDRESS: 5400 D Big Tyler Road  
Denver, CO 80202 Charleston, WV 25313

14193; 11438; 49.6;  
 3962; 5107; 60.5;  
 190; 10; 1.16; 40.16;  
 1.279; 4.55; 13.28; 4.125;  
 2.6; 0.65; 0.40; 0.86961;  
 0.406;