

Antero Resources
Well No. Busch 1H
 Antero Resources Corporation



ID	TM/Par	Owner	Bk/Pg	Acres
1	16-22	William L. & Delores J. Gadd	348/169	60.50
2	16-31	William L. & Delores J. Gadd	348/169	2.65
3	16-23	Kenneth E. Butler	331/110	50.97
4	16-30	William L. & Delores J. Gadd	348/169	14.00
5	16-47	William M. Greenawalt & Lee A. Niezgodka	387/1	12.00
6	16-38	Silas Tennant	137/85	15.50
7	16-37	Garrett S. Estate	316/248	61.00
8	16-21.1	Mildred E. Caseman	WB45/396	15.00
9	16-21	Mildred E. Caseman	WB45/396	40.00
10	16-21.2	Mildred E. Caseman	WB45/396	20.06
11	16-20	Bonita Andrich, et al	WB70/243	79.03
12	16-8	Wilbur B. Dawson & Loretta P. Uellschy	408/192	75.75
13	16-21.3	Mildred E. Caseman	WB45/396	12.00
14	16-21.4	Mildred E. Caseman	WB45/396	1.00

Leases	
A	Shiben Estates, Inc.
B	BRC Appalachian Minerals I LLC
C	John W. Bertram
D	Ellen W. & Mark L. VanDyne
E	Sandra Rose Conley
F	Richard Lee Tennant, et ux
G	Harry I. Elson
H	Chesapeake Appalachia, LLC
I	Gladys E. Conley Trust
J	Mildred Caseman
K	Sielger Family Trust
L	Chesapeake Appalachia, LLC

Notes
 West Virginia Coordinate System of 1927, North Zone based upon Differential GPS Measurements.
 Well No. Busch Unit 1H Top Hole coordinates are
 N: 384,871.72' Latitude: 39°32'59.66"
 E: 1,645,940.05' Longitude: 80°45'20.31"
 Bottom Hole coordinates are
 N: 385,852.75' Latitude: 39°33'09.01"
 E: 1,643,480.61' Longitude: 80°45'51.88"
 UTM Zone 17, NAD 1983
 Top Hole Coordinates Bottom Hole Coordinates
 N: 4,377,840.376m N: 4,378,126.727m
 E: 521,009.920m E: 520,255.658m
 Plat orientation and corner and well references are based upon the grid north meridian.
 Well location references are based upon the magnetic meridian.

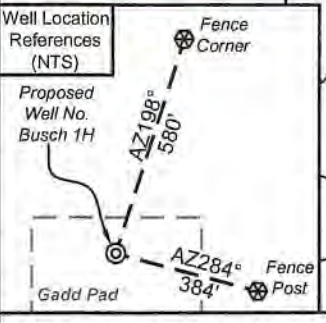

Notes:
 Well No. Busch Unit 1H UTM Zone 17, NAD 1927
 Top Hole Coordinates
 N: 14,362,249.31'
 E: 1,709,298.65'
 Point of Entry Coordinates
 N: 14,362,269.37'
 E: 1,707,140.12'
 Bottom Hole Coordinates
 N: 14,363,188.84'
 E: 1,706,824.01'

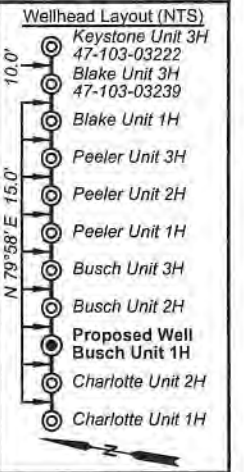

I, the undersigned, hereby certify that this plat is correct to the best of my knowledge and belief and shows all the information required by law and the rules issued and prescribed by the Department of Environmental Protection.

Bradley D. Miller
 Bradley D. Miller, P.S. 2167

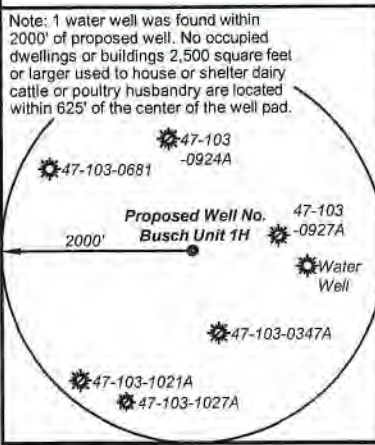

	Bearing	Dist.
L1	S 40°07' E	2,551.1'
L2	S 46°16' W	1,557.1'
L3	N 66°16' W	1,033.8'
L4	N 41°11' W	863.4'
L5	N 88°31' W	2,159.3'

- Legend**
- Proposed gas well
 - Monument, as noted
 - Existing Well, as noted
 - Digitized Well, as noted
 - Creek or Drain
 - Road
 - Surface boundary (approx.)
 - Interior surface tracts (approx.)
 - Railroad Right-of-Way

FILE NO: 235-34-G-17
 DRAWING NO: Busch 1H Well Plat
 SCALE: 1" = 1500'
 MINIMUM DEGREE OF ACCURACY: Submeter
 PROVEN SOURCE OF ELEVATION: CORS, Monroe County, OH

STATE OF WEST VIRGINIA
 DEPARTMENT OF ENVIRONMENTAL PROTECTION
OIL AND GAS DIVISION

DATE: April 28 2021
 OPERATOR'S WELL NO. Busch Unit 1H
 API WELL NO
 47 - 103 - 03404
 STATE COUNTY PERMIT

WELL TYPE: OIL GAS LIQUID INJECTION WASTE DISPOSAL
 (IF GAS) PRODUCTION: STORAGE DEEP SHALLOW

LOCATION: ELEVATION: As-Built 1,223.8' WATERSHED: Fishing Creek QUADRANGLE: Porter Falls
 DISTRICT: Green William L. & SURFACE OWNER: Delores J. Gadd COUNTY: Wetzel 06/18/2021
 ACREAGE: 60.5
 ROYALTY OWNER: Shiben Estates, Inc.; Gladys E. Conley Trust. LEASE NO: ACREAGE: 119.03125; 60.5
 PROPOSED WORK: DRILL CONVERT DRILL DEEPER FRACTURE OR STIMULATE PLUG OFF OLD FORMATION
 PERFORATE NEW FORMATION OTHER PHYSICAL CHANGE IN WELL (SPECIFY) 7,400' TVD
 PLUG AND ABANDON CLEAN OUT AND REPLUG TARGET FORMATION: Marcellus Shale ESTIMATED DEPTH: 11,600' MD

WELL OPERATOR: Antero Resources Corporation DESIGNATED AGENT: Dianna Stamper - CT Corporation System
 ADDRESS: 1615 Wynkoop Street ADDRESS: 5400 D Big Tyler Road
 Denver, CO 80202 Charleston, WV 25313

