

State of West Virginia
Department of Environmental Protection - Office of Oil and Gas
Well Operator's Report of Well Work

API 47 - 103 - 03404 County Wetzel District Green
Quad Porter Falls Pad Name Gadd Field/Pool Name -----
Farm name William & Delores Gadd Well Number Busch 1H
Operator (as registered with the OOG) Antero Resources Corporation
Address 1615 Wynkoop Street City Denver State CO Zip 80202

As Drilled location NAD 83/UTM Attach an as-drilled plat, profile view, and deviation survey
Top hole Northing 4377840m Easting 521009m
Landing Point of Curve Northing 4377748.83m Easting 520376.28m
Bottom Hole Northing 4381404m Easting 519141m

Elevation (ft) 1223' GL Type of Well New Existing Type of Report Interim Final
Permit Type Deviated Horizontal Horizontal 6A Vertical Depth Type Deep Shallow
Type of Operation Convert Deepen Drill Plug Back Redrilling Rework Stimulate
Well Type Brine Disposal CBM Gas Oil Secondary Recovery Solution Mining Storage Other _____
Type of Completion Single Multiple Fluids Produced Brine Gas NGL Oil Other _____
Drilled with Cable Rotary

Drilling Media Surface hole Air Mud Fresh Water Intermediate hole Air Mud Fresh Water Brine
Production hole Air Mud Fresh Water Brine
Mud Type(s) and Additive(s)
Air - Foam & 4% KCL
Mud - Polymer

Date permit issued 6/14/2021 Date drilling commenced 7/20/2021 Date drilling ceased 9/30/2021
Date completion activities began 12/10/2021 Date completion activities ceased 1/26/2022
Verbal plugging (Y/N) N/A Date permission granted N/A Granted by N/A

Please note: Operator is required to submit a plugging application within 5 days of verbal permission to plug

Freshwater depth(s) ft 350' Open mine(s) (Y/N) depths No **08/12/2022**
Salt water depth(s) ft 1917' Void(s) encountered (Y/N) depths No
Coal depth(s) ft 971' Cavern(s) encountered (Y/N) depths No
Is coal being mined in area (Y/N) No

Reviewed by:

WR-35
Rev. 8/23/13

API 47-103 - 03404 Farm name William & Delores Gadd Well number Busch 1H

CASING STRINGS	Hole Size	Casing Size	Depth	New or Used	Grade wt/ft	Basket Depth(s)	Did cement circulate (Y/N) * Provide details below*
Conductor	24"	20"	80'	New	94#, H-40	N/A	Y
Surface	17-1/2"	13-3/8"	436'	New	54.5#, J-55	N/A	Y
Coal							
Intermediate 1	12-1/4"	9-5/8"	2602'	New	36#, J-55	N/A	Y
Intermediate 2							
Intermediate 3							
Production	8-3/4"/8-1/2"	5-1/2"	20295'	New	20#, P-100	N/A	Y
Tubing		2-3/8"	7377'		4.7#, P-110		
Packer type and depth set		N/A					

Comment Details _____

CEMENT DATA	Class/Type of Cement	Number of Sacks	Slurry wt (ppg)	Yield (ft ³ /sks)	Volume (ft ³)	Cement Top (MD)	WOC (hrs)
Conductor	Class A	252 sx	15.6	1.18	54	0'	8 Hrs.
Surface	Class A	570 sx	15.8	1.20	118	0'	8 Hrs.
Coal							
Intermediate 1	Class A	1040 sx	15.8	1.17	191	0'	8 Hrs.
Intermediate 2							
Intermediate 3							
Production	Class H	792 sx (Lead) 3360 sx (Tail)	13.5 (Lead), 15.2(Tail)	1.4 (Lead), 1.32 (Tail)	705	~500' into Intermediate Casing	8 Hrs.
Tubing							

Drillers TD (ft) 20345' MD, 6934' TVD (BHL), 6966' (Deepest Point Drilled) Loggers TD (ft) 20345' MD
 Deepest formation penetrated Marcellus Plug back to (ft) N/A
 Plug back procedure N/A

Kick off depth (ft) 6495'

Check all wireline logs run caliper density deviated/directional induction
 neutron resistivity gamma ray temperature sonic

Well cored Yes No Conventional Sidewall Were cuttings collected Yes No

DESCRIBE THE CENTRALIZER PLACEMENT USED FOR EACH CASING STRING _____
 Conductor - 0
 Surface - 1 above guide shoe, 1 above insert float, 1 every 4th joint to surface
 Intermediate - 1 above float joint, 1 above float collar, 1 every 4th joint to surface
 Production - 1 above float joint, 1 below float collar, 1 every 3rd joint to top of cement

WAS WELL COMPLETED AS SHOT HOLE Yes No DETAILS _____ **08/12/2022**

WAS WELL COMPLETED OPEN HOLE? Yes No DETAILS _____

WERE TRACERS USED Yes No TYPE OF TRACER(S) USED N/A

API 47- 103 - 03404 Farm name William & Delores Gadd Well number Busch 1H

PRODUCING FORMATION(S)	DEPTHS		
	DEPTH	TVD	MD
Marcellus	6890' (TOP)		7425' (TOP)

Please insert additional pages as applicable.

GAS TEST Build up Drawdown Open Flow OIL TEST Flow Pump

SHUT-IN PRESSURE Surface 2800 psi Bottom Hole --- psi DURATION OF TEST --- hrs

OPEN FLOW Gas 10211 mcfpd Oil 512 bpd NGL --- bpd Water 585 bpd GAS MEASURED BY Estimated Orifice Pilot

LITHOLOGY/ FORMATION	TOP		BOTTOM		DESCRIBE ROCK TYPE AND RECORD QUANTITY AND TYPE OF FLUID (FRESHWATER, BRINE, OIL, GAS, H ₂ S, ETC)
	DEPTH IN FT	DEPTH IN FT	DEPTH IN FT	DEPTH IN FT	
	NAME	TVD	MD	MD	

***PLEASE SEE ATTACHED EXHIBIT 3**

Please insert additional pages as applicable.

Drilling Contractor H & P Drilling
Address 912 N Eagle Valley Rd City Howard State PA Zip 16841

Logging Company Nine Energy Services
Address 6500 West Fwy City Fort Worth State TX Zip 76116

Cementing Company Halliburton Energy Services
Address 3000 W. Sam Houston Pkwy City Houston State TX Zip 76114

Stimulating Company Halliburton Energy Services
Address 3000 W. Sam Houston Pkwy City Houston State TX Zip 76114 08/12/2022

Please insert additional pages as applicable.

Completed by Brandi Harkins Telephone 304-842-9759
Signature  Title Completions Technician Date 8/1/22

API 47-103-03404 Farm Name William & Delores Gadd Well Number Busch Unit 1H

Stage No.	Perforation Date	Perforated from MD ft.	Perforated to MD ft.	Number of Perforations	Formations
1	12/10/2021	20234.1	20189.7	36	Marcellus
2	12/10/2021	20148.18714	19932.31	36	Marcellus
3	12/10/2021	19893.99714	19678.12	36	Marcellus
4	12/11/2021	19639.80714	19423.93	36	Marcellus
5	12/11/2021	19385.61714	19169.74	36	Marcellus
6	12/11/2021	19131.42714	18915.55	36	Marcellus
7	12/11/2021	18877.23714	18661.36	36	Marcellus
8	12/12/2021	18623.04714	18407.17	36	Marcellus
9	12/12/2021	18368.85714	18152.98	36	Marcellus
10	12/12/2021	18114.66714	17898.79	36	Marcellus
11	12/12/2021	17860.47714	17644.6	36	Marcellus
12	12/13/2021	17606.28714	17390.41	36	Marcellus
13	12/13/2021	17352.09714	17136.22	36	Marcellus
14	12/13/2021	17097.90714	16882.03	36	Marcellus
15	12/13/2021	16843.71714	16627.84	36	Marcellus
16	12/14/2021	16589.52714	16373.65	36	Marcellus
17	12/14/2021	16335.33714	16119.46	36	Marcellus
18	12/14/2021	16081.14714	15865.27	36	Marcellus
19	12/15/2021	15826.95714	15611.08	36	Marcellus
20	12/15/2021	15572.76714	15356.89	36	Marcellus
21	12/15/2021	15318.57714	15102.7	36	Marcellus
22	12/16/2021	15064.38714	14848.51	36	Marcellus
23	12/16/2021	14810.19714	14594.32	36	Marcellus
24	12/17/2021	14556.00714	14340.13	36	Marcellus
25	12/17/2021	14301.81714	14085.94	36	Marcellus
26	12/18/2021	14047.62714	13831.75	36	Marcellus
27	12/18/2021	13793.43714	13577.56	36	Marcellus
28	12/18/2021	13539.24714	13323.37	36	Marcellus
29	12/19/2021	13285.05714	13069.18	36	Marcellus
30	12/19/2021	13030.86714	12814.99	36	Marcellus
31	12/19/2021	12776.67714	12560.8	36	Marcellus
32	12/20/2021	12522.48714	12306.61	36	Marcellus
33	12/20/2021	12268.29714	12052.42	36	Marcellus
34	12/20/2021	12014.10714	11798.23	36	Marcellus
35	12/21/2021	11759.91714	11544.04	36	Marcellus
36	12/21/2021	11505.72714	11289.85	36	Marcellus
37	12/21/2021	11251.53714	11035.66	36	Marcellus
38	12/21/2021	10997.34714	10781.47	36	Marcellus
39	12/22/2021	10743.15714	10527.28	36	Marcellus
40	12/22/2021	10488.96714	10273.09	36	Marcellus
41	12/22/2021	10234.77714	10018.9	36	Marcellus
42	12/23/2021	9980.587143	9764.71	36	Marcellus
43	12/23/2021	9726.397143	9510.52	36	Marcellus
44	12/24/2021	9472.207143	9256.33	36	Marcellus
45	12/24/2021	9218.017143	9002.14	36	Marcellus
46	12/24/2021	8963.827143	8747.95	36	Marcellus
47	12/25/2021	8709.637143	8493.76	36	Marcellus
48	12/25/2021	8455.447143	8239.57	36	Marcellus
49	12/26/2021	8201.257143	7985.38	36	Marcellus
50	12/26/2021	7947.067143	7731.19	36	Marcellus
51	12/26/2021	7692.877143	7477	36	Marcellus

08/12/2022

API 47-103-03404 Farm Name William & Delores Gadd Well Number Busch Unit 1H

EXHIBIT 2

Stage No.	Stimulations Date	Avg Pump Rate	Avg Treatment Pressure (PSI)	Max Breakdown Pressure (PSI)	ISIP (PSI)	Amount of Proppant (lbs)	Amount of Water (bbls)	Amount of Nitrogen/ other (units)
1	12/10/2021	67.74	8846	8663	4420	195620	258363	N/A
2	12/10/2021	86.59	8710	5706	4464	512010	399569	N/A
3	12/10/2021	86.37	8854	7752	4884	516080	390942	N/A
4	12/11/2021	87.37	8831	7557	4954	498180	382554	N/A
5	12/11/2021	86.33	8569	5792	4898	498620	383680	N/A
6	12/11/2021	87.02	8735	5463	4486	517540	404562	N/A
7	12/11/2021	84.93	8796	8341	4385	498290	367266	N/A
8	12/12/2021	90.71	8760	8065	4873	499540	365903	N/A
9	12/12/2021	87.93	8717	6077	4555	503060	391106	N/A
10	12/12/2021	81.87	8665	6849	4245	518360	371480	N/A
11	12/12/2021	91.65	8773	8502	4434	517970	371676	N/A
12	12/13/2021	92.18	8777	8706	4800	519370	378119	N/A
13	12/13/2021	87.51	8817	8382	4348	499550	363932	N/A
14	12/13/2021	78.96	8558	6134	4610	507350	364808	N/A
15	12/13/2021	90.57	8820	8841	4641	514600	370198	N/A
16	12/14/2021	92.1	8820	8922	4743	514720	375406	N/A
17	12/14/2021	90.77	8776	8135	4639	513220	379449	N/A
18	12/14/2021	92.1	8850	7896	4762	503310	360560	N/A
19	12/15/2021	93.11	8797	8461	4757	502050	361241	N/A
20	12/15/2021	95.62	8720	8600	4856	517200	375199	N/A
21	12/15/2021	91.5	8856	8820	4600	511200	365224	N/A
22	12/16/2021	89.33	8823	7379	4659	500600	361480	N/A
23	12/16/2021	87.62	8521	6763	4577	506425	365879	N/A
24	12/17/2021	67.47	8627	7508	4384	506380	442031	N/A
25	12/17/2021	90.29	8816	8223	4257	506650	368524	N/A
26	12/18/2021	89.43	8846	8592	4588	504190	377731	N/A
27	12/18/2021	94.09	8779	7819	4521	502110	365550	N/A
28	12/18/2021	96.86	8770	8520	4415	500460	365051	N/A
29	12/19/2021	97.26	8812	6144	4598	501940	364044	N/A
30	12/19/2021	96.41	8676	7801	4589	522210	373222	N/A
31	12/19/2021	98.05	8769	8257	4355	501110	362426	N/A
32	12/20/2021	98.74	8738	8541	4006	503540	361413	N/A
33	12/20/2021	97.87	8807	7573	4436	521630	374432	N/A
34	12/20/2021	98.25	8686	8610	4635	521660	372796	N/A
35	12/21/2021	98.4	8770	8948	4471	501870	358993	N/A
36	12/21/2021	97.25	8717	7354	4226	507330	365886	N/A
37	12/21/2021	97.24	8713	7467	4481	521730	373321	N/A
38	12/21/2021	97.51	8713	6539	4455	502320	361658	N/A
39	12/22/2021	92.6	8311	5701	4426	506730	362574	N/A
40	12/22/2021	97.74	8503	7337	4380	518500	371907	N/A
41	12/22/2021	94.65	8699	7032	4414	515580	369323	N/A
42	12/23/2021	95.41	8642	6544	4770	517090	366477	N/A
43	12/23/2021	95.61	8587	7151	4128	506830	364728	N/A
44	12/24/2021	96.83	8412	6714	4401	498300	359715	N/A
45	12/24/2021	97.02	8571	7201	4541	513020	367111	N/A
46	12/24/2021	97.96	8368	5588	4368	519480	366380	N/A
47	12/25/2021	98.42	8411	6927	4237	521240	367338	N/A
48	12/25/2021	97.93	8083	6609	4238	504120	356752	N/A
49	12/26/2021	98.33	8281	5467	3902	512100	360671	N/A
50	12/26/2021	98.63	8089	6594	4591	505790	359580	N/A
51	12/26/2021	97.98	7964	5401	4242	505180	357465	N/A
	AVG=	92	8,658	7,411	4,503	25,653,955	18,825,695	TOTAL

08/12/2022

API 47-103-03404 Farm Name William & Delores Gadd Well Number Busch Unit 1H

EXHIBIT 3

LITHOLOGY/ FORMATION	TOP DEPTH (TVD)	BOTTOM DEPTH (TVD)	TOP DEPTH (MD)	BOTTOM DEPTH (MD)
	From Surface	From Surface	From Surface	From Surface
Sandstone	75	210	75	210
Silty Sandstone	210	240	210	240
Shaly sandstone	240	270	240	270
Silty Sandstone	270	420	270	420
Shaly sandstone	420	490	420	490
Silty Sandstone	490	600	490	600
Shale	600	810	600	810
Silty Sandstone	810	1,070	810	1,070
Shale w/coal interbeds	1,070	1,230	1,070	1,230
Sandy shale	1,230	1,320	1,230	1,320
Shale	1,320	1,410	1,320	1,410
Sandy shale	1,410	1,710	1,410	1,710
Shaly sandstone	1,710	2,130	1,710	2,204
Big Lime	2,160	2,586	2,174	2,656
Fifty Foot Sandstone	2,586	2,756	2,626	2,836
Gordon	2,756	3,006	2,806	3,101
Fifth Sandstone	3,006	3,054	3,071	3,151
Bayard	3,054	4,014	3,121	4,162
Speechley	4,014	4,136	4,132	4,291
Balltown	4,136	4,601	4,261	4,781
Bradford	4,601	5,154	4,751	5,365
Benson	5,154	5,567	5,335	5,802
Alexander	5,567	6,721	5,772	7,069
Sycamore	6,575	6,691	6,891	7,039
Middlesex	6,691	6,787	7,039	7,183
Burkett	6,787	6,818	7,183	7,241
Tully	6,818	6,890	7,241	7,425
Marcellus	6,890	NA	7,425	NA

*Please note Antero determines formation tops based on mud logs that are only run on one well on a multi-well pad. The measured depth (MD) data on subsequent wells may be slightly different due to the well's unique departure.

08/12/2022

Hydraulic Fracturing Fluid Product Component Information Disclosure

Job Start Date:	12/10/2021
Job End Date:	12/26/2021
State:	West Virginia
County:	Wetzel
API Number:	47-103-03404-00-00
Operator Name:	Antero Resources Corporation
Well Name and Number:	BUSCH UNIT 1H
Latitude:	39.54990600
Longitude:	-80.75564200
Datum:	WGS84
Federal Well:	NO
Indian Well:	NO
True Vertical Depth:	6,966
Total Base Water Volume (gal):	19,623,634
Total Base Non Water Volume:	0



Hydraulic Fracturing Fluid Composition:

Trade Name	Supplier	Purpose	Ingredients	Chemical Abstract Service Number (CAS #)	Maximum Ingredient Concentration in Additive (% by mass)**	Maximum Ingredient Concentration in HF Fluid (% by mass)**	Comments
Produced Water	Halliburton	Base Fluid					
			Water	7732-18-5	100.00000	86.55355	Density = 8.50
Ingredients	Listed Above	Listed Above					
			Water	7732-18-5	100.00000	0.05742	

HAI-501	Halliburton	Acid Corrosion Inhibitor					
				Listed Below			
Exceletrate LX-15	Halliburton	Friction Reducer					
				Listed Below			
HYDROCHLORIC ACID, 22 BAUME	Halliburton	Solvent					
				Listed Below			
Sand-Common White-100 Mesh, SSA-2	Halliburton	Proppant					
				Listed Below			
WG-36 GELLING AGENT	Halliburton	Gelling Agent					
				Listed Below			
MC B-8614A	MultiChem	Biocide					
				Listed Below			
FLUID Enviro-Syn HCR-7000-WL	Fluid Energy Group	Acid Replacement					
				Listed Below			
Sand-Premium White-30/70	Halliburton	Proppant					
				Listed Below			

OPTIFLO-II DELAYED RELEASE BREAKER	Halliburton	Breaker					
				Listed Below			
Items above are Trade Names with the exception of Base Water . Items below are the individual ingredients.							
			Crystalline silica, quartz	14808-60-7	100.00000	13.31194	
			Complex Amine Compound	Proprietary	60.00000	0.03125	
			Hydrotreated light petroleum distillate	64742-47-8	30.00000	0.01563	
			Proprietary	Proprietary	20.00000	0.01047	
			Hydrochloric acid	7647-01-0	30.00000	0.00536	
			Proprietary	Proprietary	10.00000	0.00523	
			Guar gum	9000-30-0	100.00000	0.00379	
			Sorbitan, mono-9- octadecenoate, (Z)	1338-43-8	5.00000	0.00260	
			Surfactant	Proprietary	5.00000	0.00260	
			Glutaraldehyde	111-30-8	30.00000	0.00249	
			Ethoxylated alcohols	Proprietary	5.00000	0.00052	
			Organic chloride compound	Proprietary	1.00000	0.00052	
			Alkoxylated polyhydric alcohol	Proprietary	1.00000	0.00052	
			Alkyl (C12-16) dimethylbenzyl ammonium chloride	68424-85-1	5.00000	0.00041	
			Ammonium persulfate	7727-54-0	100.00000	0.00011	
			Ethanol	64-17-5	1.00000	0.00008	
			Methanol	67-56-1	100.00000	0.00003	
			Oxylated phenolic resin	Proprietary	30.00000	0.00003	
			Modified thiourea polymer	Proprietary	30.00000	0.00001	

			Mixture of dimer and trimer fatty acids of indefinite composition derived from tall oil	61790-12-3	30.00000	0.00001	
			Nitrated acetate salt	Proprietary	0.01000	0.00001	
			Sodium hydroxide	1310-73-2	0.01000	0.00001	
			Organic salt #1	Proprietary	0.01000	0.00001	
			Organic salt #2	Proprietary	0.01000	0.00001	
			Sodium glycolate	2836-32-0	0.01000	0.00001	
			Acrylamide	79-06-1	0.01000	0.00001	
			Formaldehyde	50-00-0	0.01000	0.00001	
			Propargyl alcohol	107-19-7	5.00000	0.00000	
			Hexadecene	629-73-2	5.00000	0.00000	
			C.I. pigment Orange 5	3468-63-1	1.00000	0.00000	

* Total Water Volume sources may include various types of water including fresh water, produced water, and recycled water

** Information is based on the maximum potential for concentration and thus the total may be over 100%

*** If you are calculating a percentage of total ingredients do not add the water volume below the green line to the water volume above the green line

Note: For Field Development Products (products that begin with FDP), MSDS level only information has been provided.

Ingredient information for chemicals subject to 29 CFR 1910.1200(i) and Appendix D are obtained from suppliers Material Safety Data Sheets (MSDS)

1,591' to Top Hole

7,690' to Bottom Hole

LATITUDE 39 - 35 - 00

LONGITUDE 80 - 45 - 00

Antero Resources
Well No. Busch 1H
As-Drilled
Antero Resources Corporation

Sheet 1 of 3

Busch Unit 1H
Bottom Hole

BTM Hole
7.5' Spot

See Detail
Page 2

Notes

West Virginia Coordinate System
of 1927, North Zone
based upon Differential GPS Measurements.
Well No. Busch Unit 1H Top Hole coordinates are
N: 384,871.79' Latitude: 39°32'59.66"
E: 1,645,939.77' Longitude: 80°45'20.31"
Bottom Hole coordinates are
N: 396,670.25' Latitude: 39°34'55.43"
E: 1,640,004.65' Longitude: 80°46'38.22"
UTM Zone 17, NAD 1983
Top Hole Coordinates Bottom Hole Coordinates
N: 4,377,840.396m N: 4,381,404.657m
E: 521,009.834m E: 519,141.792m
Plat orientation and corner and well references
are based upon the grid north meridian.
Well location references are based upon the magnetic
meridian.



Top Hole Coordinates,
As-drilled data, and information
was provided by Antero
Resources Corporation. Allegany Surveys Inc. (ASI) is
not certifying the data and
information provided. ASI is not
responsible for any errors or
inaccuracies with the data and
information that has been
provided.

I, the undersigned, hereby certify that this
plat is correct to the best of my
knowledge and belief and shows all the
information required by law and the rules
issued and prescribed by the
Department of Environmental Protection.

Bradley D. Miller
Bradley D. Miller, P.S. 2167



SEAL

Note: 1 water well was found within
2000' of proposed well. No occupied
dwellings or buildings 2,500 square feet
or larger used to house or shelter dairy
cattle or poultry husbandry are located
within 625' of the center of the well pad.

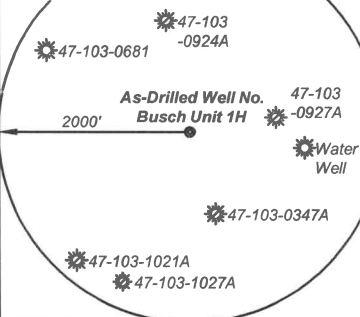

	Bearing	Dist.
L1	S 40°07' E	2,550.9'
L2	S 46°17' W	1,557.2'
L3	N 66°16' W	1,034.1'
L4	N 41°11' W	863.6'

- Legend
- Proposed gas well
 - Monument, as noted
 - Existing Well, as noted
 - Digitized Well, as noted
 - Creek or Drain
 - Road
 - Surface boundary (approx.)
 - Interior surface tracts (approx.)
 - Railroad Right-of-Way

Busch Unit 1H As-Drilled
POE Coordinates
West Virginia
Coordinate System
of 1927, North Zone
N: 384,431.66'
E: 1,644,017.37'
Latitude: 39°32'55.04"
Longitude: 80°45'44.77"
UTM Zone 17, NAD 1983
N: 4,377,696.515m
E: 520,426.396m

Wellhead Layout (NTS)

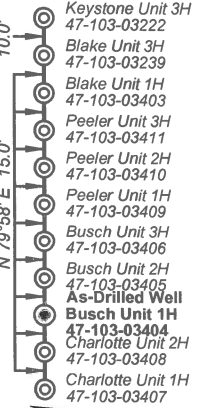

12,176' to Top Hole

FILE NO: 235-34-G-17
DRAWING NO: Busch 1H As-Drilled
SCALE: 1" = 1500'
MINIMUM DEGREE OF ACCURACY:
Submeter
PROVEN SOURCE OF ELEVATION:
CORS, Monroe County, OH

STATE OF WEST VIRGINIA
DEPARTMENT OF ENVIRONMENTAL PROTECTION
OIL AND GAS DIVISION

DATE: March 16 2022
OPERATOR'S WELL NO. Busch Unit 1H
API WELL NO
47 - 103 - 03404
STATE COUNTY PERMIT

WELL TYPE: OIL GAS LIQUID INJECTION WASTE DISPOSAL
(IF GAS) PRODUCTION: STORAGE DEEP SHALLOW

LOCATION: ELEVATION: As-Built 1,223.8' WATERSHED: Fishing Creek QUADRANGLE: Porter Falls
DISTRICT: Green William L. & SURFACE OWNER: Delores J. Gadd COUNTY: Wetzel
ROYALTY OWNER: Shiben Estates, Inc.; Gladys E. Conley Trust; Chesapeake Appalachia, LLC. LEASE NO: ACREAGE: 60.5
PROPOSED WORK: DRILL CONVERT DRILL DEEPER FRACTURE OR STIMULATE PLUG OFF OLD FORMATION
 PERFORATE NEW FORMATION OTHER PHYSICAL CHANGE IN WELL (SPECIFY) As-Drilled
 PLUG AND ABANDON CLEAN OUT AND REPLUG TARGET FORMATION: Marcellus Shale ESTIMATED DEPTH: 20,345' MD

PROPOSED WORK: DRILL CONVERT DRILL DEEPER FRACTURE OR STIMULATE PLUG OFF OLD FORMATION
 PERFORATE NEW FORMATION OTHER PHYSICAL CHANGE IN WELL (SPECIFY) As-Drilled
 PLUG AND ABANDON CLEAN OUT AND REPLUG TARGET FORMATION: Marcellus Shale ESTIMATED DEPTH: 20,345' MD

WELL OPERATOR: Antero Resources Corporation DESIGNATED AGENT: Dianna Stamper - CT Corporation System
ADDRESS: 1615 Wynkoop Street ADDRESS: 5400 D Big Tyler Road
Denver, CO 80202 Charleston, WV 25313

08/12/2022

6,934' TVD

Antero Resources
Well No. Busch 1H
As-Drilled
 Antero Resources Corporation



Leases	
A	Shiben Estates, Inc.
B	BRC Appalachian Minerals I LLC
C	John W. Bertram
D	David A. Dickey
E	Sandra Rose Conley
F	Richard Lee Tennant, et ux
G	Harry I. Elson
H	Chesapeake Appalachia, LLC
I	Gladys E. Conley Trust
J	Mildred Caseman
K	Sielger Family Trust
L	Chesapeake Appalachia, LLC
M	Loretta Paulette Ueltschy
N	Donald E. Dawson, et ux
O	Lee & Hall Royalties
P	Richard B. Dallison, et ux
Q	Paul H. Abel
R	Ridgetop Royalties, LLC
S	Ridgetop Royalties, LLC
T	Leslie A. Lively
U	Bounty Minerals, LLC
V	Robert D. Loy, et ux
W	Beulah I. Snider
X	Emma Ruth Taylor
Y	Leslie A. Lively
Z	Antero Minerals
AA	Richards Resources
AB	WVDNR
AC	San-Dee N. Stradley
AD	Michelle R. Mason
AE	OPEN
AF	Phillip Wiley
AG	Antero Minerals
AH	Jeffrey J. Ellis
AI	Joyce Cain
AJ	Barbara Sue Thomas
AK	SanDee Nieboer Stradley
AL	Roberta Lyn Sommerville
AM	Steven J. Melott
AN	Joyce Cain
AO	OPEN
AP	Allen G. Cain, et ux
AQ	Rodney Dale Weekley, et ux
AR	Jodie J. Dawson
AS	Raymond E. Lasure, et ux
AT	Kimberly A. Miller
AU	Rodney Dale Weekley, et ux
AV	Amelia Ann Booher & Roy L. Vancamp
AW	Lee E. Bassett, et ux
AX	David Wilson
AY	Peggy Ann Dawson Supplemental Needs Trust
AZ	John R. Morgan
BA	James David Alawine
BB	Elwood L. & Carmen Y. Blake
BC	John R. Morgan
BD	Michelle R. Mason
BE	Allen G. Morgan
BF	CSX Transportation
BG	David E. Bowyer
BH	CSX Transportation

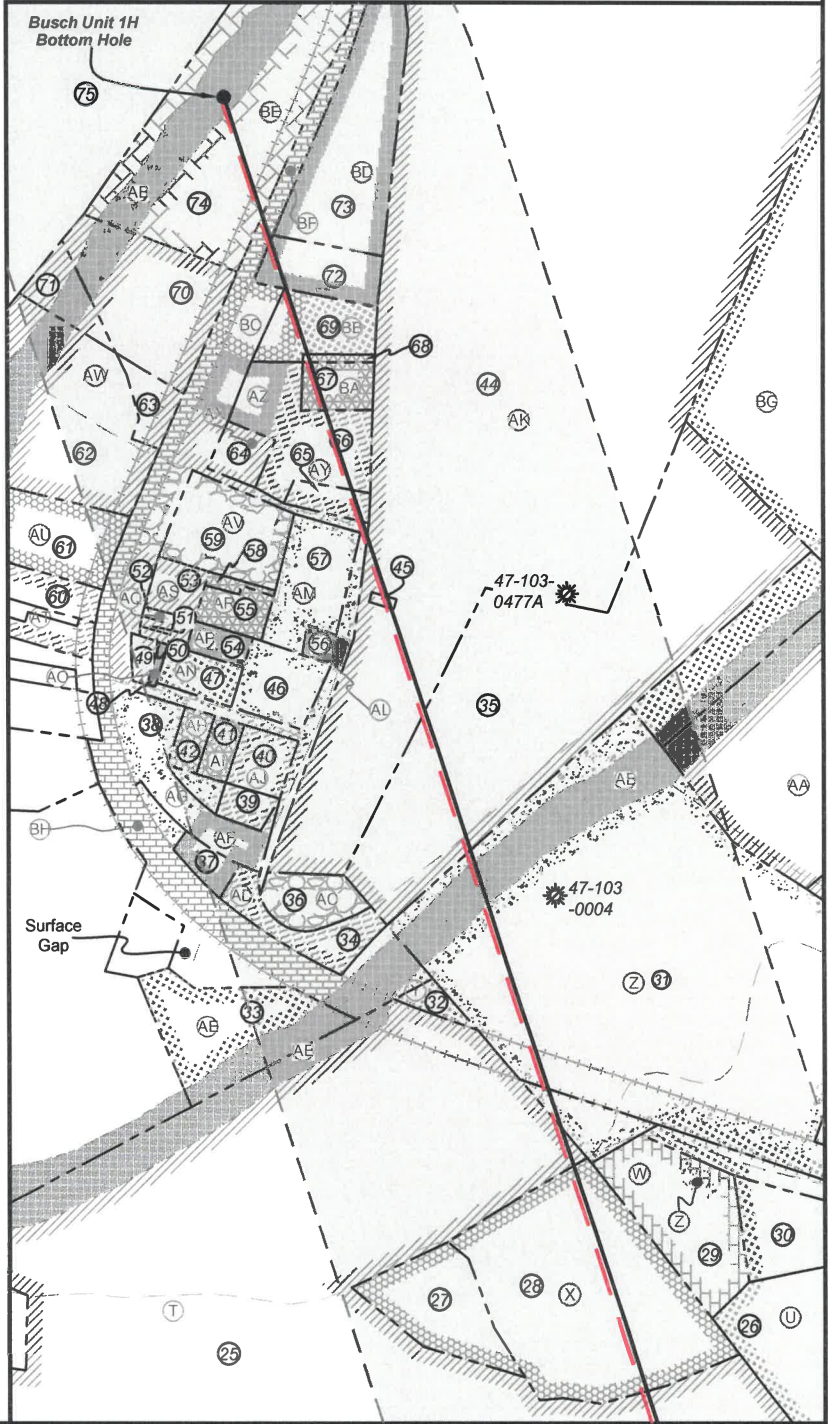

FILE NO: 235-34-G-17
 DRAWING NO: Busch 1H As-Drilled
 SCALE: 1" = 1500'
 MINIMUM DEGREE OF ACCURACY: Submeter
 PROVEN SOURCE OF ELEVATION: CORS, Monroe County, OH

STATE OF WEST VIRGINIA
 DEPARTMENT OF ENVIRONMENTAL PROTECTION
OIL AND GAS DIVISION

DATE: March 16 2022
 OPERATOR'S WELL NO. Busch Unit 1H
 API WELL NO
47 - 103 - 03404
 STATE COUNTY PERMIT

WELL TYPE: OIL GAS LIQUID INJECTION WASTE DISPOSAL
 (IF GAS) PRODUCTION: STORAGE DEEP SHALLOW

LOCATION: ELEVATION: As-Built 1,223.8' WATERSHED: Fishing Creek QUADRANGLE: Porter Falls
 DISTRICT: Green William L. & SURFACE OWNER: Delores J. Gadd COUNTY: Wetzel
 ROYALTY OWNER: Shiben Estates, Inc.; Gladys E. Conley Trust; Chesapeake Appalachia, LLC; LEASE NO: _____ ACREAGE: 60.5
 PROPOSED WORK: DRILL CONVERT DRILL DEEPER FRACTURE OR STIMULATE PLUG OFF OLD FORMATION
 PERFORATE NEW FORMATION OTHER PHYSICAL CHANGE IN WELL (SPECIFY) As-Drilled
 PLUG AND ABANDON CLEAN OUT AND REPLUG TARGET FORMATION: Marcellus Shale ESTIMATED DEPTH: 20,345' MD

WELL OPERATOR: Antero Resources Corporation DESIGNATED AGENT: Dianna Stamper - CT Corporation System
 ADDRESS: 1615 Wynkoop Street ADDRESS: 5400 D Big Tyler Road
Denver, CO 80202 Charleston, WV 25313

08/12/2022

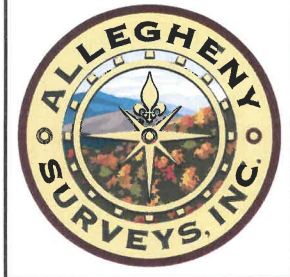

ID	TM/Par	Owner	Bk/Pg	Acres	ID	TM/Par	Owner	Bk/Pg	Acres
1	16-22	William L. & Delores J. Gadd	348/169	60.50	40	31-16	Barbara Sue Thomas	457/139	0.30
2	16-31	William L. & Delores J. Gadd	348/169	2.65	41	31-15	Carl J. Lancaster Est.	WB66/516	0.17
3	16-23	Kenneth E. Butler	331/110	50.97	42	31-14	Jeffrey J. Ellis	466/868	0.17
4	16-30	William L. & Delores J. Gadd	348/169	14.00	43	12-11	Timothy L. & Michael A. McDiffitt	385/189	131.34
5	16-47	William M. Greenawalt & Lee A. Niezgoda	387/1	12.00	44	7-53	Easterling Trust	446/376	32.98
					45	31-9	Columbia Gas Trans Corp.	263/164	0.02
6	16-38	Silas Tennant	137/85	15.50	46	31-11	Steven J. Melott	420/137	---
7	16-37	Garrett S. Estate	316/248	61.00	47	31-28	Carl J. Lancaster Est.	WB66/516	0.28
8	16-21.1	Mildred E. Caseman	WB45/396	15.00	48	31-26.1	Michael or Melissa Scyoc	461/681	0.06
9	16-21	Mildred E. Caseman	WB45/396	40.00	49	31-26	Raymond E. & Catherine H. Lasure	249/435	0.09
10	16-21.2	Mildred E. Caseman	WB45/396	20.06	50	31-25	Raymond E. & Catherine H. Lasure	258/151	0.03
11	16-20	Bonita Andrich, et al	WB70/243	79.03	51	31-24	Raymond E. & Catherine H. Lasure	249/435	0.03
12	16-8	Wilbur B. Dawson & Loretta P. Ueltschy	408/192	75.75	52	31-12	Rodney Dale Weekley	302/779	0.03
13	16-21.3	Mildred E. Caseman	WB45/396	12.00	53	31-12.2	Raymond E. & Catherine H. Lasure	249/435	0.28
14	16-21.4	Mildred E. Caseman	WB45/396	1.00	54	31-12.3	Allen G. & Joyce E. Cain	316/133	0.16
15	16-3	Wilbur B. Dawson & Loretta P. Ueltschy	408/192	49.80	55	31-12.1	Jody J. Dawson	344/149	0.25
16	16-3.1	Donald E. & Carolyn L. Dawson	332/114	10.00	56	31-10	M E Church	134/457	0.08
17	12-55	Bradley W. Ueltschy	330/37	100.00	57	31-8	Steven J. Melott	420/400	0.75
18	12-49	John W. & Rosalie M. Ueltschey	362/403	86.55	58	31-7.1	Jody J. Dawson	344/149	0.06
19	12-50	Richard B. & Jaynee C. Dallison	399/288	37.00	59	31-7	Danny R. & Christina F. Booher	285/134	0.80
20	12-39	Martin E. Rodgers	421/621	60.00	60	31-27.1	Kimberly A. Miller	406/527	0.15
21	12-26	Martin E. Rodgers	419/493	50.40	61	31-27	Rodney D. Weekley	302/779	1.40
22	12-40	Martin E. Rodgers	421/621	60.00	62	31-23	Lee E. & Charlotte D. Bassett	395/29	1.42
23	12-30	Martin E. Rogers	363/413	51.08	63	31-22	Lee E. & Charlotte D. Bassett	395/29	0.50
24	12-27	Martin E. Rogers	363/413	3.08	64	31-6	The Peggy Ann Dawson Supplemental Needs Trust	471/214	0.23
25	12-18	Leslie A. Lively	387/229	39.63	65	31-5	The Peggy Ann Dawson Supplemental Needs Trust	471/214	0.25
26	12-20.1	Jerome E. II & Benita K. Staley	415/329	13.34	66	31-4	The Peggy Ann Dawson Supplemental Needs Trust	471/214	0.98
27	12-18.2	Charles A. Loy	331/320	1.18	67	31-4.1	James David Alawine	479/448	0.50
28	12-18.1	Martha R. Campbell	254/495	3.37	68	31-4.3	James David Alawine	479/448	0.05
29	12-19	Beulah I. Snider	WB45/396	1.30	69	31-4.2	Elwood & Carman Y. Blake	371/617	0.58
30	12-20	Bonnie Ueltschy	WB70/248	0.75	70	31-21	Lee E. & Charlotte D. Bassett	395/29	2.50
31	12-5	Columbia Gas Trans Corp.	263/164	11.70	71	31-23.1	Lee E. & Charlotte D. Bassett	395/29	0.33
32	31-20	B&O RR Co.	---	0.14	72	31-1	Elwood & Carman Y. Blake	371/649	0.39
33	31-35	Kenneth Scyoc, et al	AP10/559	1.10	73	7-52	Ronnie Lee Powers	340/248	1.00
34	31-19	Paul Abel Trust	328/377	0.66	74	7-51	Shawn C. Stackpole	406/622	4.12
35	12-4	Easterling Trust	446/376	7.16	75	7-50	Bradley W. & Kimberly Ueltschy	342/710	79.78
36	12-3	Easterling Trust	446/376	0.50					
37	31-18	Phillip Wiley	379/245	0.33					
38	31-13	Clair Phillip Dawson, Jr.	471/210	0.25					
39	31-17	Barbara Sue Thomas	457/139	0.17					

FILE NO: 235-34-G-17
 DRAWING NO: Busch 1H As-Drilled
 SCALE: 1" = 1500'
 MINIMUM DEGREE OF ACCURACY:
Submeter
 PROVEN SOURCE OF ELEVATION:
CORS, Monroe County, OH

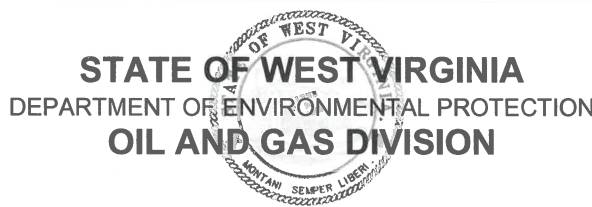

DATE: March 16 2022
 OPERATOR'S WELL NO. Busch Unit 1H
 API WELL NO
47 - 103 - 03404
 STATE COUNTY PERMIT

WELL TYPE: OIL GAS LIQUID INJECTION WASTE DISPOSAL
 (IF GAS) PRODUCTION: STORAGE DEEP SHALLOW

LOCATION: ELEVATION: As-Built 1,223.8' WATERSHED: Fishing Creek QUADRANGLE: Porter Falls
 DISTRICT: Green William L. & Delores J. Gadd COUNTY: Wetzel **08/12/2022**
 SURFACE OWNER: Delores J. Gadd ACREAGE: 60.5
 ROYALTY OWNER: Shiben Estates, Inc.; Gladys E. Conley Trust; Chesapeake Appalachia, LLC. LEASE NO: _____ ACREAGE: _____
SanDee Nieboer Stradley; Michelle R. Mason; WVDNR; CSX Transportation, Inc.; James David Alawine; John R. Morgan; Elwood L. & Carmen Y. Blake; Allen G. Morgan; Emma Ruth Taylor; Steven J. Melott; Peggy Ann Dawson Supplemental Needs Trust; Paul H. Abel; Ridgeway Royalties, LLC (2); Leslie A. Lively; Lee & Hall Royalties; Antero Minerals; Donald E. Dawson, et ux; Loretta Paulette Ueltschy;

PROPOSED WORK: DRILL CONVERT DRILL DEEPER FRACTURE OR STIMULATE PLUG OFF OLD FORMATION
 PERFORATE NEW FORMATION OTHER PHYSICAL CHANGE IN WELL (SPECIFY) As-Drilled
 PLUG AND ABANDON CLEAN OUT AND REPLUG TARGET FORMATION: Marcellus Shale ESTIMATED DEPTH: 20,345' MD 6,934' TVD

WELL OPERATOR: Antero Resources Corporation DESIGNATED AGENT: Dianna Stamper - CT Corporation System
 ADDRESS: 1615 Wynkoop Street ADDRESS: 5400 D Big Tyler Road
Denver, CO 80202 Charleston, WV 25313