

1,502' to Top Hole

5,095' to Bottom Hole

LATITUDE 39 - 35 - 00

LONGITUDE 80 - 45 - 00

12,159' to Top Hole

Antero Resources
Well No. Blake 1H
BHL MOD
Antero Resources Corporation



Blake Unit 1H
Bottom Hole

BTM Hole
7.5' Spot

Notes

West Virginia Coordinate System
of 1927, North Zone
based upon Differential GPS Measurements.
Well No. Blake Unit 1H Top Hole coordinates are
N: 384,887.42' Latitude: 39°32'59.82"
E: 1,646,028.67' Longitude: 80°45'19.18"
Bottom Hole coordinates are
N: 396,710.36' Latitude: 39°34'56.19"
E: 1,642,600.55' Longitude: 80°46'05.07"
UTM Zone 17, NAD 1983
Top Hole Coordinates Bottom Hole Coordinates
N: 4,377,845.611m N: 4,381,430.103m
E: 521,036.839m E: 519,932.448m
Plat orientation and corner and well references
are based upon the grid north meridian.
Well location references are based upon the magnetic
meridian.

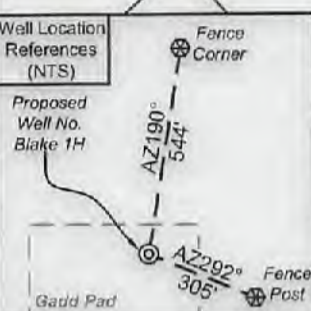

I, the undersigned, hereby certify that this
plat is correct to the best of my
knowledge and belief and shows all the
information required by law and the rules
issued and prescribed by the
Department of Environmental Protection.

Kevin S. James

Kevin S. James, P.S. 2305



SEAL

Note: 1 water well was found within
2000' of proposed well. No occupied
dwellings or buildings 2,500 square feet
or larger used to house or shelter dairy
cattle or poultry husbandry are located
within 625' of the center of the well pad.

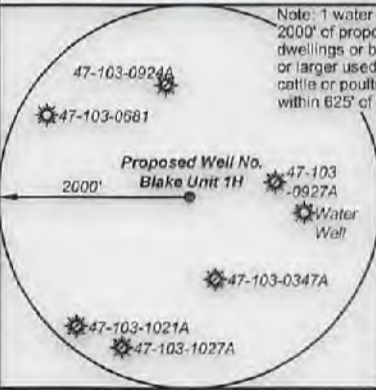

Legend

	Proposed gas well
	Monument, as noted
	Existing Well, as noted
	Digitized Well, as noted
	Creek or Drain
	Road
	Surface boundary (approx.)
	Interior surface tracts (approx.)
	Railroad

Notes:
Well No. Blake Unit 1H
UTM Zone 17, NAD 1927
Top Hole Coordinates
N: 14,362,266.49'
E: 1,709,386.97'
Point of Entry Coordinates
N: 14,362,458.22'
E: 1,709,819.84'
Bottom Hole Coordinates
N: 14,374,026.62'
E: 1,705,763.19'

Bearing	Dist.
L1 S 41°50' E	2,597.4'
L2 S 44°21' W	1,483.0'
L3 N 63°16' W	960.3'
L4 N 35°47' W	820.4'
L5 N 67°17' E	472.8'

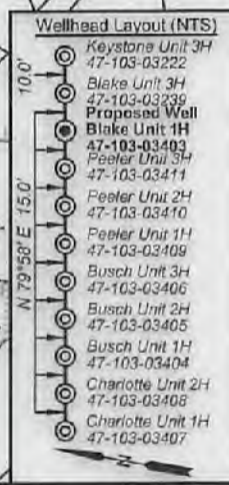

FILE NO: 233-34-G-17
DRAWING NO: Blake 1H Well Plat MOD
SCALE: 1" = 1500'
MINIMUM DEGREE OF ACCURACY:
Submeter
PROVEN SOURCE OF ELEVATION:
CORS, Monroe County, OH

STATE OF WEST VIRGINIA
DEPARTMENT OF ENVIRONMENTAL PROTECTION
OIL AND GAS DIVISION

DATE: July 14 2021
OPERATOR'S WELL NO. Blake Unit 1H
API WELL NO
47 - 103 - 03403
STATE COUNTY PERMIT

WELL TYPE: OIL GAS LIQUID INJECTION WASTE DISPOSAL
(IF GAS) PRODUCTION: STORAGE DEEP SHALLOW
LOCATION: ELEVATION: As-Built 1,223.8' WATERSHED: Fishing Creek QUADRANGLE: Porter Falls
DISTRICT: Green William L. & SURFACE OWNER: Delores J. Gadd
WVDNR: CNX Transportation, Inc.; Rita Cain Sherman; Bounty Minerals, LLC; Kenneth Gary Himelrick, et ux; Richard Resources; Chesapeake Appalachia, LLC (2); James Gail Morgan, Jr.; Donald VanDyke; BRC Appalachian Minerals I, LLC; Thomas E. Morris; P&P Fuljmo, LLC
ROYALTY OWNER: Shiben Estates, Inc. (2); David A. Dickey; John W. Bertram; Gordon Cummings; LEASE NO: ACREAGE: 46; 113.53; 36; 138
PROPOSED WORK: DRILL CONVERT DRILL DEEPER FRACTURE OR STIMULATE PLUG OFF OLD FORMATION
 PERFORATE NEW FORMATION OTHER PHYSICAL CHANGE IN WELL (SPECIFY) BHL MOD
 PLUG AND ABANDON CLEAN OUT AND REPLUG TARGET FORMATION: Marcellus Shale ESTIMATED DEPTH: 7,400' TVD
21,300' MD

WELL OPERATOR: Antero Resources Corporation DESIGNATED AGENT: Dianna Stamper - CT Corporation System
ADDRESS: 1615 Wynkoop Street ADDRESS: 5400 D Big Tyler Road
Denver, CO 80202 Charleston, WV 25313

Antero Resources
Well No. Blake 1H
BHL MOD
 Antero Resources Corporation



ID	TMP/Par	Owner	Bk/Pg	Acres
1	16-22	William L. & Delores J. Gadd	348/169	60.50
2	16-30	William L. & Delores J. Gadd	348/169	14.00
3	16-31	William L. & Delores J. Gadd	348/169	2.65
4	16-23	Kenneth E. Butler	331/110	50.97
5	16-23.1	Wetzel County Public Service District 1	433/851	0.23
6	16-10	Loren & Shirley Haught	444/434	100.48
7	16-21.3	Mildred E. Caseman	WB45/396	12.00
8	16-9	Richard A. & Susan L. Gardner	341/281	66.50
9	16-10.2	Loren & Shirley Haught	422/699	6.78
10	12-56	Ronald K. Burgess	WB25/275	69.37
11	12-55	Bradley W. Ueltschy	330/37	100.00
12	13-86	William C. & Alice Raye Burgess	278/483	11.13
13	13-41	Shari D. Burgess	432/665	95.08
14	12-41	Robert W. & Bradley W. Ueltschy	341/281	29.00
15	12-51	James Gail Morgan, Jr.	300/3	60.00
16	13-27	Donald P. Vandyke & Mark L. Vandyke	410/241	123.80
17	12-42.2	Donald P. Vandyke & Mark L. Vandyke	410/241	1.00
18	12-42	Donald P. Vandyke & Mark L. Vandyke	410/241	29.65
19	12-58	Donald P. Vandyke & Mark L. Vandyke	426/472	46.00
20	12-33	Kevin E. & Carol L. Cunningham	397/533	84.68
21	12-32	Donald P. Vandyke & Mark L. Vandyke	410/241	38.00
22	12-31	Bruce Allen Lawhorne, et al	419/878	40.00
23	12-12	Jenny L. Dinsmore & Mary E. Carpenter	452/85	33.75
24	12-11	Timothy L. & Michael A. McDiffitt	385/189	131.34
25	8-35	George Woolfer	286/203	1.00
26	8-36.1	Agnes M. Ice	367/290	2.00
27	8-36	Holbert W. Carrel Sr.	416/390	72.68

Leases	
A	Shiben Estates, Inc.
B	David A. Dickey
C	John W. Bertram
D	BRC Appalachian Minerals I, LLC
E	Gordon Cummings
F	Sielger Family Trust
G	Thomas E. Morris
H	Lee & Hall Royalties
I	Chesapeake Appalachia, LLC
J	P&P Fujimo, LLC
K	Bradley Warren Ueltschy
L	James Gail Morgan, Jr.
M	Shiben Estates, Inc.
N	WV Division of Natural Resources
O	Donald VanDyke
P	Donald VanDyke
Q	Stone Hill Minerals Holdings, LLC
R	Bounty Minerals, LLC
S	Kenneth Gary Himelrick, et ux
T	Rita Cain Sherman
U	Richards Resources
V	CSX Transportation, Inc.

FILE NO: 233-34-G-17
 DRAWING NO: Blake 1H Well Plat MOD
 SCALE: 1" = 1500'
 MINIMUM DEGREE OF ACCURACY:
 Submeter
 PROVEN SOURCE OF ELEVATION:
 CORS, Monroe County, OH

STATE OF WEST VIRGINIA
 DEPARTMENT OF ENVIRONMENTAL PROTECTION
OIL AND GAS DIVISION

DATE: July 14 2021
 OPERATOR'S WELL NO. Blake Unit 1H
 API WELL NO
 47 - 103 - 03403
 STATE COUNTY PERMIT

WELL TYPE: OIL GAS LIQUID INJECTION WASTE DISPOSAL
 (IF GAS) PRODUCTION: STORAGE DEEP SHALLOW

LOCATION: ELEVATION: As-Built 1,223.8' WATERSHED: Fishing Creek QUADRANGLE: Porter Falls
 DISTRICT: Green William L. & Delores J. Gadd WVDNR; CNX Transportation, Inc.; Rita Cain Sherman; COUNTY: Wayne 3,415.2; 40; 57.38;
 SURFACE OWNER: Delores J. Gadd Chesapeake Appalachia, LLC (2); James Gail Morgan, Jr.; Donald VanDyke; ACREAGE: 14.0 66.5; 100.925; 80;
 ROYALTY OWNER: Shiben Estates, Inc. (2); David A. Dickey; John W. Bertram; Gordon Cummings; LEASE NO: ACREAGE: 46; 113.53; 36; 139
 BRC Appalachian Minerals I, LLC; Thomas E. Morris; P&P Fujimo, LLC

PROPOSED WORK: DRILL CONVERT DRILL DEEPER FRACTURE OR STIMULATE PLUG OFF OLD FORMATION
 PERFORATE NEW FORMATION OTHER PHYSICAL CHANGE IN WELL (SPECIFY) BHL MOD
 PLUG AND ABANDON CLEAN OUT AND REPLUG TARGET FORMATION: Marcellus Shale ESTIMATED DEPTH: 7,400' TVD
 21,300' MD

WELL OPERATOR: Antero Resources Corporation DESIGNATED AGENT: Dianna Stamper - CT Corporation System
 ADDRESS: 1615 Wynkoop Street ADDRESS: 5400 D Big Tyler Road
 Denver, CO 80202 Charleston, WV 25313

1,502' to Top Hole

5,095' to Bottom Hole

LATITUDE 39 - 35 - 00

LONGITUDE 80 - 45 - 00

Antero Resources
Well No. Blake 1H
BHL MOD
Antero Resources Corporation



Blake Unit 1H
Bottom Hole

BTM Hole
7.5' Spot

Notes

West Virginia Coordinate System
of 1927, North Zone
based upon Differential GPS Measurements.
Well No. Blake Unit 1H Top Hole coordinates are
N: 384,887.42' Latitude: 39°32'59.82"
E: 1,646,028.67' Longitude: 80°45'19.18"
Bottom Hole coordinates are
N: 386,710.38' Latitude: 39°34'56.19"
E: 1,642,600.55' Longitude: 80°46'05.07"
UTM Zone 17, NAD 1983
Top Hole Coordinates Bottom Hole Coordinates
N: 4,377,845.611m N: 4,381,430.108m
E: 521,036.839m E: 519,932.446m
Plat orientation and corner and well references
are based upon the grid north meridian.
Well location references are based upon the magnetic
meridian.

Well Location
References
(NTS)



I, the undersigned, hereby certify that this
plat is correct to the best of my
knowledge and belief and shows all the
information required by law and the rules
issued and prescribed by the
Department of Environmental Protection

Kevin S. James

Kevin S. James, P.S. 2305



RECEIVED
JUL 21 2021
Department of
Environmental Protection

0.9197 Acres
1.4955 Acres

Notes:
Well No. Blake Unit 1H
UTM Zone 17, NAD 1927
Top Hole Coordinates
N: 14,362,266.49'
E: 1,709,386.97'
Point of Entry Coordinates
N: 14,362,456.22'
E: 1,709,819.84'
Bottom Hole Coordinates
N: 14,374,026.62'
E: 1,705,763.19'

	Bearing	Dist.
L1	S 41°50' E	2,597.4'
L2	S 44°21' W	1,483.0'
L3	N 63°16' W	960.3'
L4	N 35°47' W	820.4'
L5	N 67°17' E	472.8'

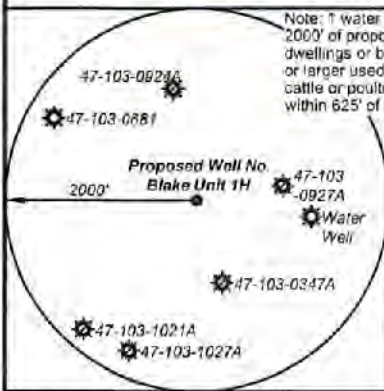

Note: 1 water well was found within
2000' of proposed well. No occupied
dwellings or buildings 2,500 square feet
or larger used to house or shelter dairy
cattle or poultry husbandry are located
within 625' of the center of the well pad.

Legend

- Proposed gas well
- Monument, as noted
- Existing Well, as noted
- Digitized Well, as noted
- Creek or Drain
- Road
- Surface boundary (approx.)
- Interior surface tracts (approx.)
- Railroad

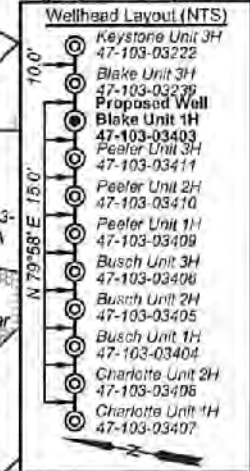

FILE NO: 233-34-G-17
DRAWING NO: Blake 1H Well Plat MOD
SCALE: 1" = 1500'
MINIMUM DEGREE OF ACCURACY:
Submeter
PROVEN SOURCE OF ELEVATION:
CORS, Monroe County, OH

STATE OF WEST VIRGINIA
DEPARTMENT OF ENVIRONMENTAL PROTECTION
OIL AND GAS DIVISION

DATE: July 14 2021
OPERATOR'S WELL NO. Blake Unit 1H
API WELL NO
47 - 103 - 03403
STATE COUNTY PERMIT

WELL TYPE: OIL GAS LIQUID INJECTION WASTE DISPOSAL
(IF GAS) PRODUCTION: STORAGE DEEP SHALLOW
LOCATION: ELEVATION: As-Built 1,223.8' WATERSHED: Fishing Creek QUADRANGLE: Porter Falls
DISTRICT: Green William L. & SURFACE OWNER: Delores J. Gadd WVDNR: CNX Transportation, Inc.; Rita Cain Sherman; Bounty Minerals, LLC; Kenneth Gary Himelrick, et ux; Richard Resources; Chesapeake Appalachia, LLC (2); James Gail Morgan, Jr.; Donald VanDyke; BRC Appalachian Minerals I, LLC; Thomas E. Morris; P&P Fujimo, LLC COUNTY: Wayne
ROYALTY OWNER: Shiben Estates, Inc. (2); David A. Dickey; John W. Bertram; Gordon Cummings. LEASE NO: ACREAGE: 46; 113.53; 36; 136. ACREAGE: 14.0
PROPOSED WORK: DRILL CONVERT DRILL DEEPER FRACTURE OR STIMULATE PLUG OFF OLD FORMATION
 PERFORATE NEW FORMATION OTHER PHYSICAL CHANGE IN WELL (SPECIFY) BHL MOD
 PLUG AND ABANDON CLEAN OUT AND REPLUG TARGET FORMATION: Marcellus Shale ESTIMATED DEPTH: 7,400' TVD 21,300' MD

WELL OPERATOR: Antero Resources Corporation DESIGNATED AGENT: Dianna Stamper - CT Corporation System
ADDRESS: 1615 Wynkoop Street ADDRESS: 6400 D Big Tyler Road
Denver, CO 80202 Charleston, WV 25313

12,169' to Top Hole

Antero Resources
Well No. Blake 1H
BHL MOD
 Antero Resources Corporation



RECEIVED
 Office of Oil and Gas
JUL 21 2021
 WV Department of
 Environmental Protection

ID	TM/Par	Owner	Bk/Pg	Acres
1	16-22	William L. & Delores J. Gadd	348/169	60.50
2	16-30	William L. & Delores J. Gadd	348/169	14.00
3	16-31	William L. & Delores J. Gadd	348/169	2.65
4	18-23	Kenneth E. Butler	331/110	50.97
5	16-23.1	Wetzel County Public Service District 1	433/851	0.23
6	16-10	Loren & Shirley Haught	444/434	100.48
7	16-21.3	Mildred E. Caseman	WB45/396	12.00
8	16-9	Richard A. & Susan L. Gardner	341/281	66.50
9	16-10.2	Loren & Shirley Haught	422/699	6.78
10	12-56	Ronald K. Burgess	WB25/275	69.37
11	12-55	Bradley W. Ueltschy	330/37	100.00
12	13-96	William C. & Alice Raye Burgess	278/483	11.13
13	13-41	Shari D. Burgess	432/665	95.08
14	12-41	Robert W. & Bradley W. Ueltschy	341/261	29.00
15	12-51	James Gail Morgan, Jr.	300/3	60.00
16	13-27	Donald P. Vandyke & Mark L. Vandyke	410/241	123.60
17	12-42.2	Donald P. Vandyke & Mark L. Vandyke	410/241	1.00
18	12-42	Donald P. Vandyke & Mark L. Vandyke	410/241	29.65
19	12-58	Donald P. Vandyke & Mark L. Vandyke	425/472	46.00
20	12-33	Kevin E. & Carol L. Cunningham	397/533	84.68
21	12-32	Donald P. Vandyke & Mark L. Vandyke	410/241	38.00
22	12-31	Bruce Allen Lawhorne, et al	419/876	40.00
23	12-12	Jenny L. Dinsmore & Mary E. Carpenter	452/85	33.76
24	12-11	Timothy L. & Michael A. McDiffitt	385/189	131.34
25	8-35	George Woolfer	286/203	1.00
26	8-36.1	Agnes M. Ice	367/290	2.00
27	8-36	Holbert W. Carrel Sr.	416/390	72.68

Leases	
A	Shiben Estates, Inc.
B	David A. Dickey
C	John W. Bertram
D	BRC Appalachian Minerals I, LLC
E	Gordon Cummings
F	Stelger Family Trust
G	Thomas E. Morris
H	Lee & Hall Royalties
I	Chesapeake Appalachia, LLC
J	P&P Fujimo, LLC
K	Bradley Warren Ueltschy
L	James Gail Morgan, Jr.
M	Shiben Estates, Inc.
N	WV Division of Natural Resources
O	Donald VanDyke
P	Donald VanDyke
Q	Stone Hill Minerals Holdings, LLC
R	Bounty Minerals, LLC
S	Kenneth Gary Himeirick, et ux
T	Rita Cain Sherman
U	Richards Resources
V	CSX Transportation, Inc.

FILE NO: 233-34-G-17
 DRAWING NO: Blake 1H Well Plat MOD
 SCALE: 1" = 1500'
 MINIMUM DEGREE OF ACCURACY:
Submeter
 PROVEN SOURCE OF ELEVATION:
CORS, Monroe County, OH

STATE OF WEST VIRGINIA
 DEPARTMENT OF ENVIRONMENTAL PROTECTION
OIL AND GAS DIVISION



DATE: July 14 2021
 OPERATOR'S WELL NO. Blake Unit 1H
 API WELL NO
47 — 103 — 03403
 STATE COUNTY PERMIT

WELL TYPE: OIL GAS LIQUID INJECTION WASTE DISPOSAL
 (IF GAS) PRODUCTION: STORAGE DEEP SHALLOW

LOCATION: ELEVATION: As-Built 1,223.8' WATERSHED: Fishing Creek QUADRANGLE: Porter Falls
 DISTRICT: Green William L. & Wetzel COUNTY: Wetzel 08/06/2021
 SURFACE OWNER: Delores J. Gadd BRC Appalachian Minerals I, LLC; Kenneth Gary Himeirick, et ux; Richard Resources; Chesapeake Appalachia, LLC (2); James Gail Morgan, Jr.; Donald VanDyke; ACREAGE: 14.0 3,4152; 40; 57.38;
 ROYALTY OWNER: Shiben Estates, Inc. (2); David A. Dickey; John W. Bertram; Gordon Cummings; LEASE NO: _____ ACREAGE: 46; 113.53; 36; 138 402; 265; 2.65;
50.97; 110.31;
66.5; 100.925; 80;
80; 123.8; 67.65;

PROPOSED WORK: DRILL CONVERT DRILL DEEPER FRACTURE OR STIMULATE PLUG OFF OLD FORMATION
 PERFORATE NEW FORMATION OTHER PHYSICAL CHANGE IN WELL (SPECIFY) BHL MOD
 PLUG AND ABANDON CLEAN OUT AND REPLUG TARGET FORMATION: Marcellus Shale ESTIMATED DEPTH: 7,400' TVD
21,300' MD

WELL OPERATOR: Antero Resources Corporation DESIGNATED AGENT: Dianna Stamper - CT Corporation System
 ADDRESS: 1615 Wynkoop Street ADDRESS: 5400 D Big Tyler Road
Denver, CO 80202 Charleston, WV 25313