



west virginia department of environmental protection

Office of Oil and Gas
601 57th Street, S.E.
Charleston, WV 25304
(304) 926-0450
fax: (304) 926-0452

Harold D. Ward, Cabinet Secretary
www.dep.wv.gov

Monday, August 2, 2021
PERMIT MODIFICATION APPROVAL
Horizontal 6A / New Drill

ANTERO RESOURCES CORPORATION
1615 WYNKOOP STREET

DENVER, CO 80202

Re: Permit Modification Approval for BLAKE UNIT 1H
47-103-03403-00-00

Lateral Extension

ANTERO RESOURCES CORPORATION

The Office of Oil and Gas has reviewed the attached permit modification for the above referenced permit. The attached modification has been approved and well work may begin. Please be reminded that the oil and gas inspector is to be notified twenty-four (24) hours before permitted well work is commenced.

If there are any questions, please feel free to contact me at (304) 926- 0450.



James A. Martin
Chief

Operator's Well Number: BLAKE UNIT 1H
Farm Name: WILLIAM L. & DELORES J. GADD
U.S. WELL NUMBER: 47-103-03403-00-00
Horizontal 6A New Drill
Date Modification Issued: August 2, 2021

Promoting a healthy environment.

08/06/2021

CH# 23/411
5000⁰⁰
7/8/21

STATE OF WEST VIRGINIA
DEPARTMENT OF ENVIRONMENTAL PROTECTION, OFFICE OF OIL AND GAS
WELL WORK PERMIT APPLICATION

1) Well Operator: Antero Resources Corpora 494507062 103-Wetzel Green ✓ Porters Falls 7.5'
Operator ID County District Quadrangle

2) Operator's Well Number: Blake Unit 1H MOD ✓ Well Pad Name: Gadd Pad ✓

3) Farm Name/Surface Owner: William L. & Delores J. Gadd Public Road Access: Eightmile Road

4) Elevation, current ground: 1223.8' Elevation, proposed post-construction: ~1223.8

5) Well Type (a) Gas X Oil _____ Underground Storage _____

Other _____

(b) If Gas Shallow X Deep _____

Horizontal X

RECEIVED
Office of Oil and Gas

JUL 29 2021

WV Department of
Environmental Protection

6) Existing Pad: Yes or No Yes

7) Proposed Target Formation(s), Depth(s), Anticipated Thickness and Expected Pressure(s):
Marcellus Shale: 7400' TVD, Anticipated Thickness- 55 feet, Associated Pressure- 2850#

8) Proposed Total Vertical Depth: 7400' TVD

9) Formation at Total Vertical Depth: Marcellus

10) Proposed Total Measured Depth: 21300' ✓

11) Proposed Horizontal Leg Length: 12265'

12) Approximate Fresh Water Strata Depths: 350' ✓

13) Method to Determine Fresh Water Depths: 47-095-02266

14) Approximate Saltwater Depths: 1887', 1917'

15) Approximate Coal Seam Depths: 656', 971'

16) Approximate Depth to Possible Void (coal mine, karst, other): None Anticipated

17) Does Proposed well location contain coal seams directly overlying or adjacent to an active mine? Yes _____ No X

(a) If Yes, provide Mine Info: Name: _____
Depth: _____
Seam: _____
Owner: _____

18)

CASING AND TUBING PROGRAM

TYPE	Size (in)	New or Used	Grade	Weight per ft. (lb/ft)	FOOTAGE: For Drilling (ft)	INTERVALS: Left in Well (ft)	CEMENT: Fill-up (Cu. Ft.)/CTS
Conductor	20"	New	H-40	94#	80	80	CTS, 86 Cu. Ft.
Fresh Water	13-3/8"	New	J-55	54.5#	400 *see #19	400 *see #19	CTS, 556 Cu. Ft.
Coal	9-5/8"	New	J-55	36#	2500	2500	CTS, 1018 Cu. Ft.
Intermediate							
Production	5-1/2"	New	P-110	23#	21300	21300 ✓	5449 Cu. Ft
Tubing	2-3/8"	New	N-80	4.7#			
Liners							

Bryan Harris
7-28-21

TYPE	Size (in)	Wellbore Diameter (in)	Wall Thickness (in)	Burst Pressure (psi)	Anticipated Max. Internal Pressure (psi)	Cement Type	Cement Yield (cu. ft./k)
Conductor	20"	24"	0.438"	1530	50	Class A	~1.18
Fresh Water	13-3/8"	17-1/2"	0.38"	2730	1000	Class A	~1.18
Coal	9-5/8"	12-1/4"	0.352"	3520	1500	Class A	~1.18
Intermediate							
Production	5-1/2"	8-3/4" & 8-1/2"	0.415"	12,630	2500	Lead-HPOZ & Tail-H	H/POZ-1.44 & H-1.8
Tubing	2-3/8"	4.778"	0.19"	11,200			
Liners							

RECEIVED
Office of Oil and Gas

JUL 29 2021

WV Department of
Environmental Protection

PACKERS

Kind:	N/A			
Sizes:	N/A			
Depths Set:	N/A			

19) Describe proposed well work, including the drilling and plugging back of any pilot hole:

Drill a new horizontal shallow well into the Marcellus Shale.

*Antero will be air drilling the fresh water string which makes it difficult to determine when fresh water is encountered. Therefore, we have built in a buffer for the casing setting depth which helps to ensure that all fresh water zones are covered.

20) Describe fracturing/stimulating methods in detail, including anticipated max pressure and max rate:

Antero plans to pump Slickwater into the Marcellus Shale formation in order to ready the well for production. The fluid will be comprised of approximately 99 percent water and sand, with less than 1 percent special-purpose additives as shown in the attached "List of Anticipated Additives Used for Fracturing or Stimulating Well."

Anticipated Max Pressure - 9300 lbs
Anticipated Max Rate - 80 bpm

21) Total Area to be disturbed, including roads, stockpile area, pits, etc., (acres): 34.10 acres

22) Area to be disturbed for well pad only, less access road (acres): 17.00 acres

23) Describe centralizer placement for each casing string:

Conductor: no centralizers
Surface Casing: one centralizer 10' above the float shoe, one on the insert float collar and one every 4th joint spaced up the hole to surface.
Intermediate Casing: one centralizer above float joint, one centralizer 5' above float collar and one every 4th collar to surface.
Production Casing: one centralizer at shoe joint and one every 3 joints to top of cement in intermediate casing.

24) Describe all cement additives associated with each cement type:

Conductor: no additives, Class A cement.
Surface: Class A cement with 2-3% calcium chloride and 1/4 lb of flake
Intermediate: Class A cement with 1/4 lb of flake, 5 gallons of clay treat
Production: Lead cement- 50/50 Class H/Poz + 1.5% salt + 1% C-45 + 0.5% C-16a + 0.2% C-12 + 0.45% C-20 + 0.05% C-51
Production: Tail cement- Class H + 45 PPS Calcium Carbonate + 1.0% FL-160 + 0.2% ACGB-47 + 0.05% ACSA-51 + 0.2% ACR-20

25) Proposed borehole conditioning procedures:

*Note: Attach additional sheets as needed.

RECEIVED
Oil and Gas
JUL 21 2021
WV Department of
Environmental Protection



47103025730000

Blake Unit 1H

RECEIVED
Office of Oil and Gas
JUL 21 2021
WV Department of
Environmental Protection



Antero Resources Corporation

Blake Unit 1H - AOR



WELL SYMBOLS
Gas Well

July 15, 2021

08/06/2021

UWI (APINum)	Well Name	Well Number	Operator	Hlst Oper	TD	Perforated Interval (shallowest, deepest)	Perforated Formation(s)	Producible Formation(s) not perf'd
47103025730000	WEEKLEY UNIT 1	1H	EQT PRODUCTION CO	STONE ENERGY CORP	10,470		Marcellus	

RECEIVED
Office of Oil and Gas
JUL 21 2021
WV Department of
Environmental Protection

**INFORMATION SUPPLIED UNDER WEST VIRGINIA CODE
Chapter 22, Article 6A, Section 5(a)(5)
IN LIEU OF FILING LEASE(S) AND OTHER CONTINUING CONTRACT(S)**

Under the oath required to make the verification on page 1 of this Notice and Application, I depose and say that I am the person who signed the Notice and Application for the Applicant, and that –

- (1) the tract of land is the same tract described in this Application, partly or wholly depicted in the accompanying plat, and described in the Construction and Reclamation Plan;
- (2) the parties and recordation data (if recorded) for lease(s) or other continuing contract(s) by which the Applicant claims the right to extract, produce or market the oil or gas are as follows:

	<u>Grantor, lessor, etc.</u>	<u>Grantee, lessee, etc.</u>	<u>Royalty</u>	<u>Book/Page</u>
A	<u>Shiben Estates Inc. Lease (TM 16 PCL 22)</u> Shiben Estates Inc.	Antero Resources Corporation	1/8+	0176/0467
C	<u>John W. Bertram Lease</u> John W. Bertram	Antero Resources Corporation	1/8+	0184/0660
D	<u>BRC Appalachian Minerals LLC Lease</u> BRC Appalachian Minerals LLC Chesapeake Appalachia LLC SWN Production Company Antero Exchange Properties LLC	Chesapeake Appalachia LLC SWN Production Company Antero Exchange Properties LLC Antero Resources Corporation	Assignment Assignment Assignment Merger	0103/0470 0157/0540 0177/0533 0013/0311
E	<u>Gordon Cummings Lease</u> Gordon Cummings	Antero Resources Corporation	1/8+	0193/0001
G	<u>Thomas E. Morris Lease</u> Thomas E. Morris	Antero Resources Corporation	1/8+	0162/0479
I	<u>Chesapeake Appalachian LLC Lease</u> Chesapeake Appalachian LLC SWN Production Company Antero Exchange Properties LLC	SWN Production Company Antero Exchange Properties LLC Antero Resources Corporation	1/8 Assignment Merger	0157/0640 0177/0533 0013/0311
J	<u>P&P Fujlmo LLC Lease</u> P&P Fujlmo LLC	Antero Resources Corporation	1/8+	0179/0606
L	<u>James Gail Morgan Jr. Lease</u> Chesapeake Appalachian LLC SWN Production Company Antero Exchange Properties LLC	SWN Production Company Antero Exchange Properties LLC Antero Resources Corporation	Assignment Assignment Merger	0157/0640 0177/0533 0013/0311
M	<u>Shiben Estates Inc. Lease (TM 13 PCL 27)</u> Shiben Estates Inc.	Antero Resources Corporation	1/8+	0176/0467
N	<u>WV Division of Natural Resources Lease</u> WV Division of Natural Resources	Antero Resources Corporation	1/8+	0206/0420
Q	<u>Stone Hill Minerals Holdings Lease</u> Stone Hill Minerals Holdings	Antero Resources Corporation	1/8	0212/0378

RECEIVED
Office of Oil and Gas
JUL 21 2021
WV Department of Environmental Protection

*Partial Assignments to Antero Resources Corporation include 100% rights to extract, produce and market the oil and gas from the Marcellus and any other formations completed with this well.

INFORMATION SUPPLIED UNDER WEST VIRGINIA CODE
Chapter 22, Article 6A, Section 5(a)(5)
IN LIEU OF FILING LEASE(S) AND OTHER CONTINUING CONTRACT(S)

Under the oath required to make the verification on page 1 of this Notice and Application, I depose and say that I am the person who signed the Notice and Application for the Applicant, and that –

(1) the tract of land is the same tract described in this Application, partly or wholly depicted in the accompanying plat, and described in the Construction and Reclamation Plan;

(2) the parties and recordation data (if recorded) for lease(s) or other continuing contract(s) by which the Applicant claims the right to extract, produce or market the oil or gas are as follows:

	Grantor, lessor, etc.	Grantee, lessee, etc.	Royalty	Book/Page
R	<u>Bounty Minerals Lease</u> Bounty Minerals	Antero Resources Corporation	1/8+	0188/0511
P	<u>Donald VanDyke Lease</u> Donald VanDyke Stone Energy Corporation EQT Production Company	Stone Energy Corporation EQT Production Company Antero Resources Corporation	1/8+ Assignment Assignment	108A/916 183A/305 230A/801
S	<u>Kenneth Gary Himelrick et ux Lease</u> Kenneth Gary Himelrick et ux	Antero Resources Corporation	1/8+	166A/162
V	<u>CSX Transportation Inc Lease</u> CSX Transportation Inc	Antero Resources Corporation	1/8	166A/162
T	<u>Rita Cain Sherman Lease</u> Rita Cain Sherman Central Michigan Exploration LLC Stone Energy Corporation EQT Production Company	Central Michigan Exploration LLC Stone Energy Corporation EQT Production Company Antero Resources Corporation	1/8 Assignment Assignment Assignment	103A/381 102A/869 183A/305 230A/801

*Partial Assignments to Antero Resources Corporation include 100% rights to extract, produce and market the oil and gas from the Marcellus and any other formations completed with this well.

**INFORMATION SUPPLIED UNDER WEST VIRGINIA CODE
Chapter 22, Article 6A, Section 5(a)(5)
IN LIEU OF FILING LEASE(S) AND OTHER CONTINUING CONTRACT(S)**

Under the oath required to make the verification on page 1 of this Notice and Application, I depose and say that I am the person who signed the Notice and Application for the Applicant, and that –

- (1) the tract of land is the same tract described in this Application, partly or wholly depicted in the accompanying plat, and described in the Construction and Reclamation Plan;
- (2) the parties and recordation data (if recorded) for lease(s) or other continuing contract(s) by which the Applicant claims the right to extract, produce or market the oil or gas are as follows:

Lease Name or Number	Grantor, Lessor, etc.	Grantee, Lessee, etc.	Royalty	Book/Page
Richards Resources Lease	Richards Resources	Antero Resources Corporation	1/8+	173A/109

*Partial Assignments to Antero Resources Corporation include 100% rights to extract, produce and market the oil and gas from the Marcellus and any other formations completed with this well.

RECEIVED
Office of Oil and Gas
JUL 21 2021
WV Department of
Environmental Protection

**Acknowledgement of Possible Permitting/Approval
In Addition to the Office of Oil and Gas**

The permit applicant for the proposed well work addressed in this application hereby acknowledges the possibility of the need for permits and/or approvals from local, state, or federal entities in addition to the DEP, Office of Oil and Gas, including but not limited to the following:

- WV Division of Water and Waste Management
- WV Division of Natural Resources WV Division of Highways
- U.S. Army Corps of Engineers
- U.S. Fish and Wildlife Service
- County Floodplain Coordinator

The applicant further acknowledges that any Office of Oil and Gas permit in no way overrides, replaces, or nullifies the need for other permits/approvals that may be necessary and further affirms that all needed permits/approvals should be acquired from the appropriate authority before the affected activity is initiated.

Well Operator: Antero Resources Corporation
 By: Tim Rady
 Its: VP of Land

1,502' to Top Hole

5,095' to Bottom Hole

LATITUDE 39 - 35 - 00

LONGITUDE 80 - 45 - 00

12,159' to Top Hole

Antero Resources Well No. Blake 1H BHL MOD

Antero Resources Corporation



Blake Unit 1H
Bottom Hole

BTM Hole
7.5' Spot

Notes

West Virginia Coordinate System of 1927, North Zone based upon Differential GPS Measurements.

Well No. Blake Unit 1H Top Hole coordinates are
 N: 384,887.42' Latitude: 39°32'59.82"
 E: 1,646,028.67' Longitude: 80°45'19.18"

Bottom Hole coordinates are
 N: 396,710.36' Latitude: 39°34'56.19"
 E: 1,642,600.55' Longitude: 80°46'05.07"

UTM Zone 17, NAD 1983
 Top Hole Coordinates: Bottom Hole Coordinates
 N: 4,377,845.611m N: 4,381,430.103m
 E: 521,036.839m E: 519,932.448m

Plat orientation and corner and well references are based upon the grid north meridian.
 Well location references are based upon the magnetic meridian.

47-103-0144A

47-103-0477A

47-103-0036A

47-103-0122A

47-103-0326A

47-103-0086

47-103-0715A

47-103-1122A

47-103-0924A

47-103-0681

47-103-0926A

47-103-0927A

47-103-1021A

47-103-0347A

Wellhead Layout (NTS)

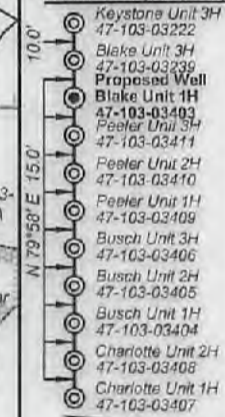

Note: 1 water well was found within 2000' of proposed well. No occupied dwellings or buildings 2,500 square feet or larger used to house or shelter dairy cattle or poultry husbandry are located within 625' of the center of the well pad.

- Legend**
- Proposed gas well
 - Monument, as noted
 - Existing Well, as noted
 - Digitized Well, as noted
 - Creek or Drain
 - Road
 - Surface boundary (approx.)
 - Interior surface tracts (approx.)
 - Railroad

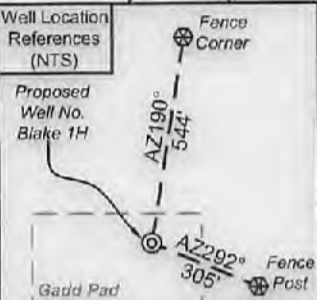

I, the undersigned, hereby certify that this plat is correct to the best of my knowledge and belief and shows all the information required by law and the rules issued and prescribed by the Department of Environmental Protection.

Kevin S. James

Kevin S. James, P.S. 2305



SEAL

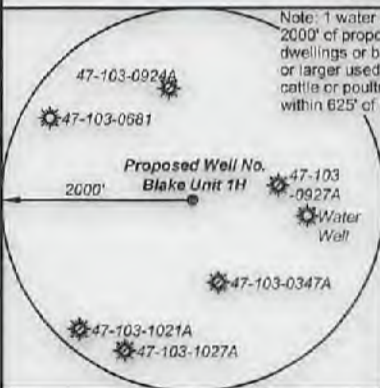

FILE NO: 233-34-G-17
 DRAWING NO: Blake 1H Well Plat MOD
 SCALE: 1" = 1500'
 MINIMUM DEGREE OF ACCURACY: Submeter
 PROVEN SOURCE OF ELEVATION: CORS, Monroe County, OH

STATE OF WEST VIRGINIA
 DEPARTMENT OF ENVIRONMENTAL PROTECTION
 OIL AND GAS DIVISION

DATE: July 14, 2021
 OPERATOR'S WELL NO. Blake Unit 1H
 API WELL NO
 47 - 103 - 03403
 STATE COUNTY PERMIT

WELL TYPE: OIL GAS LIQUID INJECTION WASTE DISPOSAL
 (IF GAS) PRODUCTION: STORAGE DEEP SHALLOW

LOCATION: ELEVATION: As-Built 1,223.8' WATERSHED: Fishing Creek QUADRANGLE: Porter Falls
 DISTRICT: Green William L. & SURFACE OWNER: Delores J. Gadd WVDNR: CNX Transportation, Inc.; Rita Cain Sherman; Bounty Minerals, LLC; Kenneth Gary Himelrick, et ux; Richard Resources; Chesapeake Appalachia, LLC (2); James Gail Morgan, Jr.; Donald VanDyke; BRC Appalachian Minerals I, LLC; Thomas E. Morris; P&P Fuljmo, LLC COUNTY: Wayne
 ROYALTY OWNER: Shiben Estates, Inc. (2); David A. Dickey; John W. Bertram; Gordon Cummings; LEASE NO: ACREAGE: 46; 113.53; 36; 138 ACREAGE: 14.0
 PROPOSED WORK: DRILL CONVERT DRILL DEEPER FRACTURE OR STIMULATE PLUG OFF OLD FORMATION
 PERFORATE NEW FORMATION OTHER PHYSICAL CHANGE IN WELL (SPECIFY) BHL MOD
 PLUG AND ABANDON CLEAN OUT AND REPLUG TARGET FORMATION: Marcellus Shale ESTIMATED DEPTH: 7,400' TVD 21,300' MD

WELL OPERATOR: Antero Resources Corporation DESIGNATED AGENT: Dianna Stamper - CT Corporation System
 ADDRESS: 1615 Wynkoop Street ADDRESS: 5400 D Big Tyler Road
 Denver, CO 80202 Charleston, WV 25313

Antero Resources
Well No. Blake 1H
BHL MOD
 Antero Resources Corporation



ID	TMP/Par	Owner	Bk/Pg	Acres
1	16-22	William L. & Delores J. Gadd	348/169	60.50
2	16-30	William L. & Delores J. Gadd	348/169	14.00
3	16-31	William L. & Delores J. Gadd	348/169	2.65
4	16-23	Kenneth E. Butler	331/110	50.97
5	16-23.1	Wetzel County Public Service District 1	433/851	0.23
6	16-10	Loren & Shirley Haught	444/434	100.48
7	16-21.3	Mildred E. Caseman	WB45/396	12.00
8	16-9	Richard A. & Susan L. Gardner	341/281	66.50
9	16-10.2	Loren & Shirley Haught	422/699	6.78
10	12-56	Ronald K. Burgess	WB25/275	69.37
11	12-55	Bradley W. Ueltschy	330/37	100.00
12	13-86	William C. & Alice Raye Burgess	278/483	11.13
13	13-41	Shari D. Burgess	432/665	95.08
14	12-41	Robert W. & Bradley W. Ueltschy	341/281	29.00
15	12-51	James Gail Morgan, Jr.	300/3	60.00
16	13-27	Donald P. Vandyke & Mark L. Vandyke	410/241	123.80
17	12-42.2	Donald P. Vandyke & Mark L. Vandyke	410/241	1.00
18	12-42	Donald P. Vandyke & Mark L. Vandyke	410/241	29.65
19	12-58	Donald P. Vandyke & Mark L. Vandyke	426/472	46.00
20	12-33	Kevin E. & Carol L. Cunningham	397/533	84.68
21	12-32	Donald P. Vandyke & Mark L. Vandyke	410/241	38.00
22	12-31	Bruce Allen Lawhorne, et al	419/878	40.00
23	12-12	Jenny L. Dinsmore & Mary E. Carpenter	452/85	33.75
24	12-11	Timothy L. & Michael A. McDiffitt	385/189	131.34
25	8-35	George Woolfer	286/203	1.00
26	8-36.1	Agnes M. Ice	367/290	2.00
27	8-36	Holbert W. Carrel Sr.	416/390	72.68

Leases	
A	Shiben Estates, Inc.
B	David A. Dickey
C	John W. Bertram
D	BRC Appalachian Minerals I, LLC
E	Gordon Cummings
F	Sielger Family Trust
G	Thomas E. Morris
H	Lee & Hall Royalties
I	Chesapeake Appalachia, LLC
J	P&P Fujimo, LLC
K	Bradley Warren Ueltschy
L	James Gail Morgan, Jr.
M	Shiben Estates, Inc.
N	WV Division of Natural Resources
O	Donald VanDyke
P	Donald VanDyke
Q	Stone Hill Minerals Holdings, LLC
R	Bounty Minerals, LLC
S	Kenneth Gary Himelrick, et ux
T	Rita Cain Sherman
U	Richards Resources
V	CSX Transportation, Inc.

FILE NO: 233-34-G-17
 DRAWING NO: Blake 1H Well Plat MOD
 SCALE: 1" = 1500'
 MINIMUM DEGREE OF ACCURACY:
 Submeter
 PROVEN SOURCE OF ELEVATION:
 CORS, Monroe County, OH

STATE OF WEST VIRGINIA
 DEPARTMENT OF ENVIRONMENTAL PROTECTION
OIL AND GAS DIVISION

DATE: July 14 2021
 OPERATOR'S WELL NO. Blake Unit 1H
 API WELL NO
 47 - 103 - 03403
 STATE COUNTY PERMIT

WELL TYPE: OIL GAS LIQUID INJECTION WASTE DISPOSAL
 (IF GAS) PRODUCTION: STORAGE DEEP SHALLOW

LOCATION: ELEVATION: As-Built 1,223.8' WATERSHED: Fishing Creek QUADRANGLE: Porter Falls
 DISTRICT: Green William L. & WVDNR; CNX Transportation, Inc.; Rita Cain Sherman; COUNTY: Wayne 3,415.2; 40; 57.38;
 SURFACE OWNER: Delores J. Gadd Bounty Minerals, LLC; Kenneth Gary Himelrick, et ux; Richard Resources; 66.5; 103.25; 2.65;
 ROYALTY OWNER: Shiben Estates, Inc. (2); David A. Dickey; John W. Bertram; Gordon Cummings; Chesapeake Appalachia, LLC (2); James Gail Morgan, Jr.; Donald VanDyke; ACREAGE: 14.0 50.97; 110.31;
 BRC Appalachian Minerals I, LLC; Thomas E. Morris; P&P Fujimo, LLC 66.5; 100.925; 80;
 LEASE NO: _____ ACREAGE: 46; 113.53; 36; 139 80; 123.8; 67.65;

PROPOSED WORK: DRILL CONVERT DRILL DEEPER FRACTURE OR STIMULATE PLUG OFF OLD FORMATION
 PERFORATE NEW FORMATION OTHER PHYSICAL CHANGE IN WELL (SPECIFY) BHL MOD 7,400' TVD
 PLUG AND ABANDON CLEAN OUT AND REPLUG TARGET FORMATION: Marcellus Shale ESTIMATED DEPTH: 21,300' MD

WELL OPERATOR: Antero Resources Corporation DESIGNATED AGENT: Dianna Stamper - CT Corporation System
 ADDRESS: 1615 Wynkoop Street ADDRESS: 5400 D Big Tyler Road
 Denver, CO 80202 Charleston, WV 25313

1,502' to Top Hole

5,095' to Bottom Hole

LATITUDE 39 - 35 - 00

LONGITUDE 80 - 45 - 00

Antero Resources
Well No. Blake 1H
BHL MOD
Antero Resources Corporation



Blake Unit 1H
Bottom Hole

BTM Hole
7.5' Spot

Notes

West Virginia Coordinate System
of 1927, North Zone
based upon Differential GPS Measurements.
Well No. Blake Unit 1H Top Hole coordinates are
N: 384,887.42' Latitude: 39°32'59.82"
E: 1,646,028.67' Longitude: 80°45'19.18"
Bottom Hole coordinates are
N: 386,710.38' Latitude: 39°34'56.19"
E: 1,642,600.55' Longitude: 80°46'05.07"
UTM Zone 17, NAD 1983
Top Hole Coordinates Bottom Hole Coordinates
N: 4,377,845.611m N: 4,381,430.108m
E: 521,036.839m E: 519,932.446m
Plat orientation and corner and well references
are based upon the grid north meridian.
Well location references are based upon the magnetic
meridian.

Well Location
References
(NTS)



0.9197 Acres
1.4955 Acres

Notes:
Well No. Blake Unit 1H
UTM Zone 17, NAD 1927
Top Hole Coordinates
N: 14,362,266.49'
E: 1,709,386.97'
Point of Entry Coordinates
N: 14,362,456.22'
E: 1,709,819.84'
Bottom Hole Coordinates
N: 14,374,026.62'
E: 1,705,763.19'

	Bearing	Dist.
L1	S 41°50' E	2,597.4'
L2	S 44°21' W	1,483.0'
L3	N 63°16' W	960.3'
L4	N 35°47' W	820.4'
L5	N 67°17' E	472.8'

I, the undersigned, hereby certify that this
plat is correct to the best of my
knowledge and belief and shows all the
information required by law and the rules
issued and prescribed by the
Department of Environmental Protection

Kevin S. James

Kevin S. James, P.S. 2305



Note: 1 water well was found within
2000' of proposed well. No occupied
dwellings or buildings 2,500 square feet
or larger used to house or shelter dairy
cattle or poultry husbandry are located
within 625' of the center of the well pad.

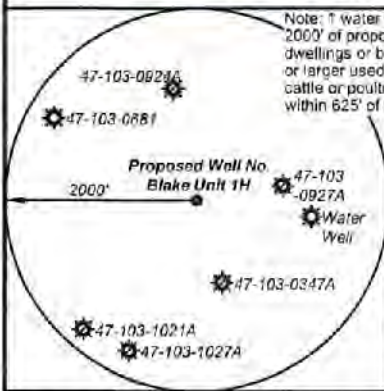

- Legend
- Proposed gas well
 - Monument, as noted
 - Existing Well, as noted
 - Digitized Well, as noted
 - Creek or Drain
 - Road
 - Surface boundary (approx.)
 - Interior surface tracts (approx.)
 - Railroad

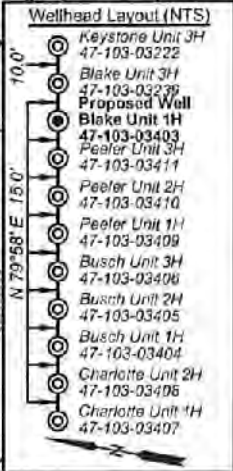

FILE NO: 233-34-G-17
DRAWING NO: Blake 1H Well Plat MOD
SCALE: 1" = 1500'
MINIMUM DEGREE OF ACCURACY:
Submeter
PROVEN SOURCE OF ELEVATION:
CORS, Monroe County, OH

STATE OF WEST VIRGINIA
DEPARTMENT OF ENVIRONMENTAL PROTECTION
OIL AND GAS DIVISION

DATE: July 14 2021
OPERATOR'S WELL NO. Blake Unit 1H
API WELL NO
47 - 103 - 03403
STATE COUNTY PERMIT

WELL TYPE: OIL GAS LIQUID INJECTION WASTE DISPOSAL
(IF GAS) PRODUCTION: STORAGE DEEP SHALLOW
LOCATION: ELEVATION: As-Built 1,223.8' WATERSHED: Fishing Creek QUADRANGLE: Porter Falls
DISTRICT: Green William L. & SURFACE OWNER: Delores J. Gadd WVDNR: CNX Transportation, Inc.; Rita Cain Sherman; Bounty Minerals, LLC; Kenneth Gary Himelrick, et ux; Richard Resources; Chesapeake Appalachia, LLC (2); James Gail Morgan, Jr.; Donald VanDyke; BRC Appalachian Minerals I, LLC; Thomas E. Morris; P&P Fujimo, LLC COUNTY: West Virginia
ROYALTY OWNER: Shiben Estates, Inc. (2); David A. Dickey; John W. Bertram; Gordon Cummings. LEASE NO: ACREAGE: 46; 113.53; 36; 136. ACREAGE: 14.0
PROPOSED WORK: DRILL CONVERT DRILL DEEPER FRACTURE OR STIMULATE PLUG OFF OLD FORMATION
 PERFORATE NEW FORMATION OTHER PHYSICAL CHANGE IN WELL (SPECIFY) BHL MOD
 PLUG AND ABANDON CLEAN OUT AND REPLUG TARGET FORMATION: Marcellus Shale ESTIMATED DEPTH: 21,300' MD 7,400' TVD

WELL OPERATOR: Antero Resources Corporation DESIGNATED AGENT: Dianna Stamper - CT Corporation System
ADDRESS: 1615 Wynkoop Street ADDRESS: 6400 D Big Tyler Road
Denver, CO 80202 Charleston, WV 25313

Antero Resources
Well No. Blake 1H
BHL MOD
 Antero Resources Corporation



RECEIVED
 Office of Oil and Gas
JUL 21 2021
 WV Department of
 Environmental Protection

ID	TM/Par	Owner	Bk/Pg	Acres
1	16-22	William L. & Delores J. Gadd	348/169	60.50
2	16-30	William L. & Delores J. Gadd	348/169	14.00
3	16-31	William L. & Delores J. Gadd	348/169	2.65
4	18-23	Kenneth E. Butler	331/110	50.97
5	16-23.1	Wetzel County Public Service District 1	433/851	0.23
6	16-10	Loren & Shirley Haught	444/434	100.48
7	16-21.3	Mildred E. Caseman	WB45/396	12.00
8	16-9	Richard A. & Susan L. Gardner	341/281	66.50
9	16-10.2	Loren & Shirley Haught	422/699	6.78
10	12-56	Ronald K. Burgess	WB25/275	69.37
11	12-55	Bradley W. Ueltschy	330/37	100.00
12	13-96	William C. & Alice Raye Burgess	278/483	11.13
13	13-41	Shari D. Burgess	432/665	95.08
14	12-41	Robert W. & Bradley W. Ueltschy	341/261	29.00
15	12-51	James Gail Morgan, Jr.	300/3	60.00
16	13-27	Donald P. Vandyke & Mark L. Vandyke	410/241	123.60
17	12-42.2	Donald P. Vandyke & Mark L. Vandyke	410/241	1.00
18	12-42	Donald P. Vandyke & Mark L. Vandyke	410/241	29.65
19	12-58	Donald P. Vandyke & Mark L. Vandyke	425/472	46.00
20	12-33	Kevin E. & Carol L. Cunningham	397/533	84.68
21	12-32	Donald P. Vandyke & Mark L. Vandyke	410/241	38.00
22	12-31	Bruce Allen Lawhorne, et al	419/876	40.00
23	12-12	Jenny L. Dinsmore & Mary E. Carpenter	452/85	33.76
24	12-11	Timothy L. & Michael A. McDiffitt	385/189	131.34
25	8-35	George Woolfer	286/203	1.00
26	8-36.1	Agnes M. Ice	367/290	2.00
27	8-36	Holbert W. Carrel Sr.	416/390	72.68

Leases	
A	Shiben Estates, Inc.
B	David A. Dickey
C	John W. Bertram
D	BRC Appalachian Minerals I, LLC
E	Gordon Cummings
F	Stelger Family Trust
G	Thomas E. Morris
H	Lee & Hall Royalties
I	Chesapeake Appalachia, LLC
J	P&P Fujimo, LLC
K	Bradley Warren Ueltschy
L	James Gail Morgan, Jr.
M	Shiben Estates, Inc.
N	WV Division of Natural Resources
O	Donald VanDyke
P	Donald VanDyke
Q	Stone Hill Minerals Holdings, LLC
R	Bounty Minerals, LLC
S	Kenneth Gary Himeirick, et ux
T	Rita Cain Sherman
U	Richards Resources
V	CSX Transportation, Inc.

FILE NO: 233-34-G-17
 DRAWING NO: Blake 1H Well Plat MOD
 SCALE: 1" = 1500'
 MINIMUM DEGREE OF ACCURACY:
Submeter
 PROVEN SOURCE OF ELEVATION:
CORS, Monroe County, OH

STATE OF WEST VIRGINIA
 DEPARTMENT OF ENVIRONMENTAL PROTECTION
OIL AND GAS DIVISION



DATE: July 14 2021
 OPERATOR'S WELL NO. Blake Unit 1H
 API WELL NO
47 — 103 — 03403
 STATE COUNTY PERMIT

WELL TYPE: OIL GAS LIQUID INJECTION WASTE DISPOSAL
 (IF GAS) PRODUCTION: STORAGE DEEP SHALLOW

LOCATION: ELEVATION: As-Built 1,223.8' WATERSHED: Fishing Creek QUADRANGLE: Porter Falls
 DISTRICT: Green William L. & Wetzel COUNTY: Wetzel 08/06/2021
 SURFACE OWNER: Delores J. Gadd Bounty Minerals, LLC; Kenneth Gary Himeirick, et ux; Richard Resources;
Chesapeake Appalachia, LLC (2); James Gail Morgan, Jr.; Donald VanDyke; ACREAGE: 14.0 66.5; 100.925; 80;
 ROYALTY OWNER: Shiben Estates, Inc. (2); David A. Dickey; John W. Bertram; Gordon Cummings; LEASE NO: _____ ACREAGE: 46; 113.53; 36; 138
BRC Appalachian Minerals I, LLC; Thomas E. Morris; P&P Fujimo, LLC

PROPOSED WORK: DRILL CONVERT DRILL DEEPER FRACTURE OR STIMULATE PLUG OFF OLD FORMATION
 PERFORATE NEW FORMATION OTHER PHYSICAL CHANGE IN WELL (SPECIFY) BHL MOD
 PLUG AND ABANDON CLEAN OUT AND REPLUG TARGET FORMATION: Marcellus Shale ESTIMATED DEPTH: 7,400' TVD
21,300' MD

WELL OPERATOR: Antero Resources Corporation DESIGNATED AGENT: Dianna Stamper - CT Corporation System
 ADDRESS: 1615 Wynkoop Street ADDRESS: 5400 D Big Tyler Road
Denver, CO 80202 Charleston, WV 25313



Stansberry, Wade A <wade.a.stansberry@wv.gov>

Expedited Modification H6A Horizontal Well Work Permit (API: 47-103-03403)

1 message

Stansberry, Wade A <wade.a.stansberry@wv.gov>

Tue, Aug 3, 2021 at 7:26 AM

To: Mallory Stanton <mstanton@anteroresources.com>, Dani DeVito <ddevito@shalepro.com>

Cc: "Harris, Bryan O" <bryan.o.harris@wv.gov>, Scott Lemley <slemley@wvassessor.com>

I have attached a copy of the newly issued well permit number "BLAKE UNIT 1H", API (47-103-03403). This will serve as your copy.

If you have any questions, then please contact us here at the Office of Oil and Gas

Thank you

Wade A. Stansberry

Environmental Resource Specialist 3

West Virginia Department of Environmental Protection

Office of Oil & Gas

601 57th St. SE

Charleston, WV 25304

(304) 926-0499 ext. 41115

(304) 926-0452 fax

Wade.A.Stansberry@wv.gov

 **47-103-03403 - mod.pdf**
1031K

08/06/2021