

NOTES ON SURVEY

- COORDINATES SYSTEM IS UTM, NAD 83 DATUM, ZONE 17, U.S. FOOT AND WELL COORDINATES ESTABLISHED USING SURVEY GRADE GPS.
- SURFACE AND ROYALTY OWNER INFORMATION AND THEIR BOUNDARIES SHOWN HEREON WERE PLOTTED FROM DEEDS AND/OR TAX PARCEL MAPS PROVIDED BY CLIENT AND FIELD LOCATIONS.
- THIS PLAT DOES NOT REPRESENT A BOUNDARY SURVEY OF THE PARCELS SHOWN HEREON.
- NO DWELLINGS AND BUILDINGS WITHIN 625 FEET OF PROPOSED OF CENTER OF PAD.
- NO WATER WELLS OR DEVELOPED SPRINGS WITHIN 250 FEET OF PROPOSED WELL.
- NO PERENNIAL STREAMS, LAKES, PONDS, RESERVOIRS OR WETLANDS WITHIN 100 FEET OF THE LIMITS OF DISTURBANCE.
- NO NATURALLY PRODUCING TROUT STREAM WITHIN 300 FEET OF LIMITS OF DISTURBANCE.

- LEGEND**
- ⊕ Active Well Location
 - ⊕ Plugged Well Location
 - ⊕ Abandoned Well
 - ① Surface Tract Identification
 - Proposed Gas Well
 - ⊗ Located Corner, as noted
 - Surface Tract Lines (Surveyed)
 - Surface Tract Lines (Tax Map)
 - Reference Line
 - Lease Boundary
 - Creek or Drain
 - ⑤ WV County Route
 - ⑤ WV State Route

(⊕) Denotes Location of Well on United States Topographic Maps



I, the undersigned, hereby certify that this plat is correct to the best of my knowledge and belief and shows all the information required by law and the regulations issued and prescribed by the Department of Environmental Protection.

Thomas C. Smit
L. L. S. 687

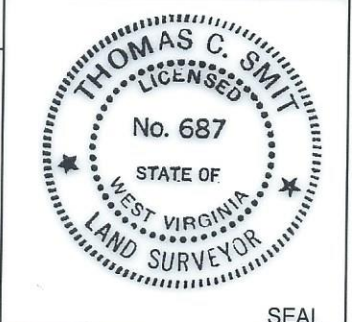

FILE NO:
DRAWING NO:
SCALE: 1" = 2000'
MINIMUM DEGREE OF ACCURACY: 1:2500
PROVEN SOURCE OF ELEVATION: NGS CORS Station

STATE OF WEST VIRGINIA
DEPARTMENT OF ENVIRONMENTAL PROTECTION
OIL AND GAS DIVISION

DATE: JUNE 21 20 23
OPERATORS WELL NO: Cash 1H
API WELL NO: 47 - 103 - 03398
STATE COUNTY PERMIT

WELL TYPE: OIL GAS LIQUID INJECTION WASTE DISPOSAL
(IF GAS) PRODUCTION: STORAGE DEEP SHALLOW

LOCATION ELEVATION: 1488' WATERSHED: Little Fishing Creek QUADRANGLE: Littleton
DISTRICT: Center COUNTY: Wetzel

SURFACE OWNER: John R. & Phyllis R. Bohrer ACREAGE: 121.18±
ROYALTY OWNER: Green Dot Farm, Inc., et al. LEASE NO: 215535 ACREAGE: 121.18±

PROPOSED WORK: DRILL CONVERT DRILL DEEPER FRACTURE OR STIMULATE PLUG OFF OLD FORMATION
 PERFORATE NEW FORMATION OTHER PHYSICAL CHANGE IN WELL (SPECIFY)

PLUG AND ABANDON CLEAN OUT AND REPLUG TARGET FORMATION: Marcellus ESTIMATED DEPTH: 7,575'

WELL OPERATOR: EQT Production Company DESIGNATED AGENT: Joseph C Mallow
ADDRESS: 400 Woodcliff Drive ADDRESS: 427 Midstate Drive
Canonsburg, PA 15317 Clarksburg, WV 26301

07/21/2023

Cash 1H
Cash
EQT Production Company

Tract ID.	Tax Map No.	Parcel No.	County	District	Surface Tract Owner	Acres
1	15	58.0	Wetzel	Center	John R. & Phyllis R. Bohrer	52.95
2	19	8.0	Wetzel	Center	Charles O. & Sherlene J. Phillips	89.94
3	19	7.0	Wetzel	Center	Brandi L. Briggs & Sharon Sue Long	67.11
4	15	45.0	Wetzel	Center	No Info	17.94
5	15	44.0	Wetzel	Center	John R. & Phyllis R. Bohrer	43.80
6	15	30.0	Wetzel	Center	Owen E. & Saloma D. Schmucker	25.75
7	15	17.0	Wetzel	Center	Jonathan W White	41.50
8	15	28.0	Wetzel	Center	Owen E. & Saloma D. Schmucker	29.00
9	15	14.0	Wetzel	Center	Owen E. & Saloma D. Schmucker	1.00
10	15	13.0	Wetzel	Center	Owen E. & Saloma D. Schmucker	0.44
11	15	15.0	Wetzel	Center	Owen E. & Saloma D. Schmucker	10.12
12	15	11.0	Wetzel	Center	Owen E. & Saloma D. Schmucker	9.80
13	15	9.0	Wetzel	Center	Kenneth R. McCall	8.02
14	15	8.0	Wetzel	Center	David W. & Rachel M. Morris	25.00
15	14	10.0	Wetzel	Center	Johnny Kenneth & Debrah K. Greathouse	122.00
16	11	29.0	Wetzel	Center	Edward M., II & Judith Q. Kauffman, Jeffrey M. Kauffman and Jennifer M. Stake	42.50
17	11	28.0	Wetzel	Center	Patrick L Morris	36.90
18	10	57.0	Wetzel	Center	Patrick L Morris	38.00
19	10	44.0	Wetzel	Center	Danny C. Briggs and Diana L. Briggs	22.20
20	10	43.0	Wetzel	Center	Louise Maxine & Jack Morris	22.76
21	10	30.1	Wetzel	Center	Patrick J & Cinthia E Anderson	6.51
22	10	30.0	Wetzel	Center	Noel Anderson	43.49

Lease	Owner	Acres
215535	Green Dot Farm, Inc., etal.	121.18 ac
120250	Jeanne Anne Lambert etal.	150 ac
110102	Acropolis, Inc., etal.	43.8 ac
136368	Owen E. Schmucker and Saloma D. Schmucker, etal.	77.41875 ac
120326004	Owen E. Schmucker and Saloma D. Schmucker, etal.	52.45 ac
174986	Ronald Richard Morris, Sr., etal.	10.122 ac
103122	William B. Francik and Pamela S. Francik, Trustees of the William B. and Pamela S. Francik Joint Revocable Living Trust dated 2/12/2018, etal.	8.9 ac
120326015	Mary Colleen Olson, etal.	125.1625 ac
216185	Drilling Appalachian Corporation, etal.	122 ac
218160	Green Dot Farm, Inc.	45.14 ac
131242	Green Dot Farm, Inc., etal.	36.9 ac
168019	Green Dot Farm, Inc., etal.	38 ac
119576	Green Dot Farm, Inc., etal.	47.5 ac
226208	Dewey David Kushaney, etal.	50 ac

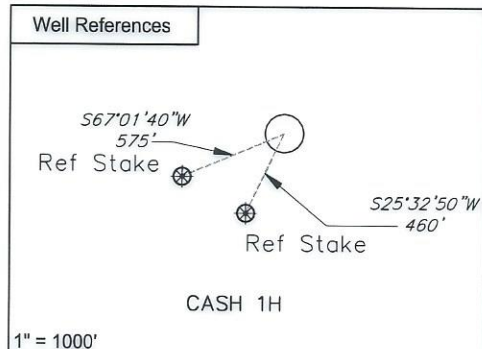
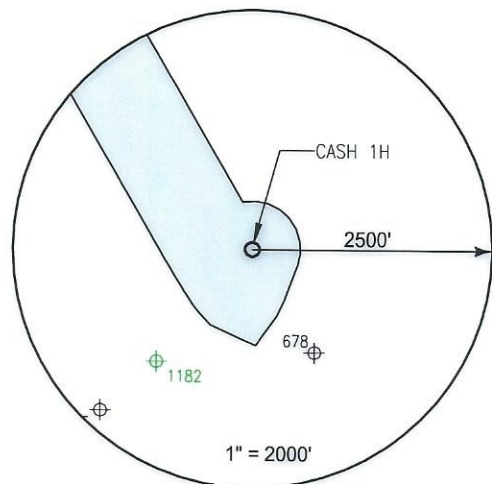

Notes:
 CASH 1H coordinates are
 NAD 27 N: 413,402.914 E: 1,694,689.297
 NAD 27 Lat: 39.629973 Long: -80.583995
 NAD 83 UTM N: 4,386,781.032 E: 535,717.278

CASH 1H Landing Point coordinates are
 NAD 27 N: 413,572.682 E: 1,694,196.636
 NAD 27 Lat: 39.630423 Long: -80.585752
 NAD 83 UTM N: 4,386,830.244 E: 535,566.319

CASH1H Bottom Hole coordinates are
 NAD 27 N: 424,227.608 E: 1,688,008.391
 NAD 27 Lat: 39.659466 Long: -80.608187
 NAD 83 UTM N: 4,390,044.853 E: 533,626.899

West Virginia Coordinates system of 1927 (North Zone)
 based upon Differential GPS Measurements
 Plat orientation, Corner and well ties are based upon
 the grid north meridian
 Well location references are based upon the grid north
 meridian.
 UTM coordinates are NAD83, Zone 17, Meters.

CASH PAD

- CASH 12H ○
- CASH 10H ○
- CASH 8H ○
- CASH 6H ○
- CASH 4H ○
- CASH 2H ○
- CASH 7H 47-103-03522
- CASH 5H 47-103-03523
- CASH 3H 47-103-03524
- CASH 1H 47-103-03398



I, the undersigned, hereby certify that this plat is correct to the best of my knowledge and belief and shows all the information required by law and the regulations issued and prescribed by the Department of Environmental Protection.

Thomas C. Smit
 L. L. S. 687

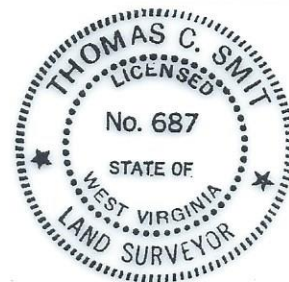

SEAL

FILE NO: _____
 DRAWING NO: _____
 SCALE: 1" = 1000'
 MINIMUM DEGREE OF ACCURACY:
 1:2500
 PROVEN SOURCE OF ELEVATION:
 NGS CORS Station

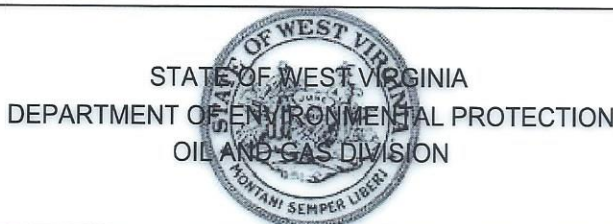

DATE: JUNE 21 20 23
 OPERATORS WELL NO: Cash 1H
 API WELL NO
 47 - 103 - 03398
 STATE COUNTY PERMIT

WELL TYPE: OIL GAS LIQUID INJECTION WASTE DISPOSAL
 (IF GAS) PRODUCTION: STORAGE DEEP SHALLOW
 LOCATION ELEVATION: 1488' WATERSHED: Little Fishing Creek QUADRANGLE: Littleton
 DISTRICT: Center COUNTY: Wetzel
 SURFACE OWNER: John R. & Phyllis R. Bohrer ACREAGE: 52.95 ±
 ROYALTY OWNER: Green Dot Farm, Inc., etal. LEASE NO: 215535 ACREAGE: 121.18 ±
 PROPOSED WORK: DRILL CONVERT DRILL DEEPER FRACTURE OR STIMULATE PLUG OFF OLD FORMATION
 PERFORATE NEW FORMATION OTHER PHYSICAL CHANGE IN WELL (SPECIFY)
 PLUG AND ABANDON CLEAN OUT AND REPLUG TARGET FORMATION: Marcellus ESTIMATED DEPTH: 7,575'

07/21/2023

WELL OPERATOR: EQT Production Company DESIGNATED AGENT: Joseph C Mallow
 ADDRESS: 400 Woodcliff Drive ADDRESS: 427 Midstate Drive
 Canonsburg, PA 15317 Clarksburg, WV 26301