

WW-7  
8-30-06



West Virginia Department of Environmental Protection  
Office of Oil and Gas  
**WELL LOCATION FORM: GPS**

API: 47-103-70721 WELL NO.: 7363

FARM NAME: O.P. MCINTYRE

RESPONSIBLE PARTY NAME: WEST VIRGINIA LAND RESOURCES INC.

COUNTY: WETZEL DISTRICT: GRANT

QUADRANGLE: WALLACE W.VA

SURFACE OWNER: COASTAL FOREST RESOURCES CO.

ROYALTY OWNER: \_\_\_\_\_

UTM GPS NORTHING: 4,371,006 m

UTM GPS EASTING: 543,090 m GPS ELEVATION: 421 m (1381')

The Responsible Party named above has chosen to submit GPS coordinates in lieu of preparing a new well location plat for a plugging permit or assigned API number on the above well. The Office of Oil and Gas will not accept GPS coordinates that do not meet the following requirements:

1. Datum: NAD 1983, Zone: 17 North, Coordinate Units: meters, Altitude: height above mean sea level (MSL) – meters.
2. Accuracy to Datum – 3.05 meters
3. Data Collection Method:

Survey grade GPS \_\_\_\_\_ : Post Processed Differential \_\_\_\_\_  
 \_\_\_\_\_ Real-Time Differential \_\_\_\_\_  
 Mapping Grade GPS X : Post Processed Differential X  
 \_\_\_\_\_ Real-Time Differential \_\_\_\_\_

RECEIVED  
Office of Oil and Gas

MAR 17 2021

WV Department of  
Environmental Protection

4. Letter size copy of the topography map showing the well location.

I the undersigned, hereby certify this data is correct to the best of my knowledge and belief and shows all the information required by law and the regulations issued and prescribed by the Office of Oil and Gas.

[Signature]  
Signature

Professional Surveyor  
Title

JANUARY 25, 2021  
Date

UNITED STATES  
DEPARTMENT OF THE INTERIOR  
GEOLOGICAL SURVEY

4883 1/2 SE  
(BIG RUN)

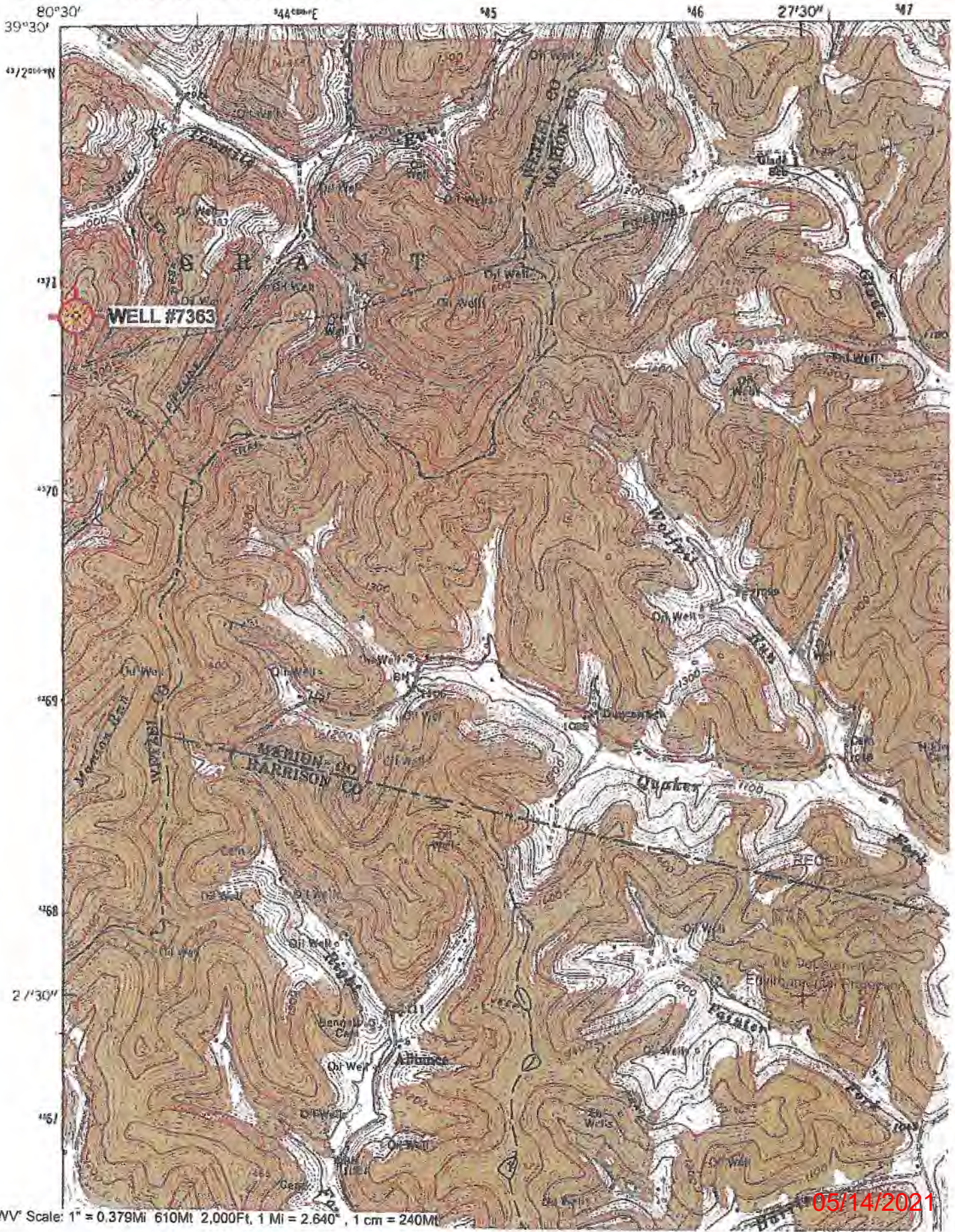

Wallace; WV Scale: 1" = 0.379Mi 610Ml 2,000Ft, 1 Mi = 2,640' , 1 cm = 240Ml

05/14/2021