

I, the undersigned, hereby certify that this plat is correct to the best of my knowledge and belief and shows all the information required by law and the regulations issued and prescribed by the Department of Environmental Protection.

Ben R. Singleton

P.S. 2092



FILE NO: 289-16
 DRAWING NO: Prine 11H
 SCALE: 1" = 2000'
 MINIMUM DEGREE OF ACCURACY: 1:2500
 PROVEN SOURCE OF ELEVATION: NGS CORS Station

STATE OF WEST VIRGINIA
 DEPARTMENT OF ENVIRONMENTAL PROTECTION
OIL AND GAS DIVISION

DATE: June 12 20 20
 OPERATOR'S WELL NO.: Prine 11H
 API WELL NO 46A
 47 - 103 - 03359
 STATE COUNTY PERMIT

WELL TYPE: OIL GAS LIQUID INJECTION WASTE DISPOSAL
 (IF GAS) PRODUCTION: STORAGE DEEP SHALLOW
 LOCATION: ELEVATION: 1335' WATERSHED Tributary of Bear Run QUADRANGLE: Littleton
 DISTRICT: Center COUNTY: Wetzel
 SURFACE OWNER: Howard M. Henderson ACREAGE: 112
 ROYALTY OWNER: Jamie Joe Prine, et al LEASE NO: 870370 ACREAGE: 111
 PROPOSED WORK: DRILL CONVERT DRILL DEEPER FRACTURE OR STIMULATE PLUG OFF OLD FORMATION
 PERFORATE NEW FORMATION OTHER PHYSICAL CHANGE IN WELL (SPECIFY)
 PLUG AND ABANDON CLEAN OUT AND REPLUG TARGET FORMATION: Marcellus ESTIMATED DEPTH: 7,500'

WELL OPERATOR: EQT Production Company DESIGNATED AGENT: Joseph C. Mallow
 ADDRESS: 400 Woodcliff Drive ADDRESS: 115 Professional Place PO Box 280
 Canonsburg, PA 15317 Bridgeport, WV 26330

**Prine 11H
LIT53
EQT Production Company**

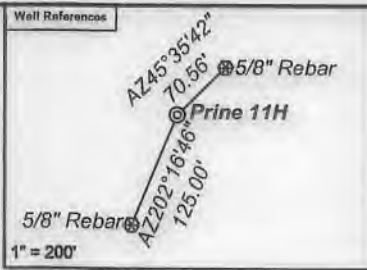

Notes:
Prine 11H coordinates are
NAD 27 N: 427,885.94 E: 1,697,694.98
NAD 27 Lat: 39.669832 Long: -80.573939
NAD 83 UTM N: 4,391,208.78 E: 536,559.50
Prine 11H Landing Point coordinates are
NAD 27 N: 430,095.90 E: 1,699,472.29
NAD 27 Lat: 39.675957 Long: -80.567719
NAD 83 UTM N: 4,391,891.13 E: 537,089.77
Prine 11H Bottom Hole coordinates are
NAD 27 N: 434,287.32 E: 1,695,280.87
NAD 27 Lat: 39.687326 Long: -80.582789
NAD 83 UTM N: 4,393,146.73 E: 535,791.51
West Virginia Coordinate system of 1927 (North Zone)
based upon Differential GPS Measurements.
Plat orientation, corner and well lies are based upon
the grid north meridian.
Well location references are based upon the grid north
meridian.
UTM coordinates are NAD83, Zone 17, Meters.

Tract I.D.	Tax Map No.	Parcel No.	County	District	Surface Tract Owner	Acres
1	8	43	Wetzel	Center	Howard M. Henderson	112.00
2	8	44	Wetzel	Center	William D. Henderson	65.00
3	8	45	Wetzel	Center	Howard Henderson	5.50
4	8	31.1	Wetzel	Center	Howard Henderson	18.43
5	8	53	Wetzel	Center	Ashley Murphy, et al.	20.38
6	8	31	Wetzel	Center	Howard Henderson	64.78
7	8	29	Wetzel	Center	Howard M. & William D. Henderson	57.00
8	8	28	Wetzel	Center	Matthew J. Rice	108.00
9	8	11	Wetzel	Center	Howard M. Henderson	91.50
10	8	8	Wetzel	Center	Lillian M. Pitzer & Jason L. Wright	57.00
11	8	7	Wetzel	Center	EQT Production Company	150.00
12	8	3.1	Wetzel	Center	Dalison Lumber Inc	15.68
13	8	2	Wetzel	Center	EQT Production Company	72.43
14	5	24	Wetzel	Center	EQT Production Company	12.50
15	8	1	Wetzel	Center	EQT Production Company	81.50
16	5	15	Wetzel	Center	Howard M. Henderson	228.00
17	5	23	Wetzel	Center	Robert Long, et al.	172.50
18	11	9	Wetzel	Center	Howard M. Henderson	10.10
19	11	8	Wetzel	Center	James S. & Margie L. Montgomery	52.00
20	11	0.1	Wetzel	Center	Larry L. & Lois J. Daem	04.50
21	11	6	Wetzel	Center	Ray S. & Timmy R. Sapp	90.50
22	11	6.2	Wetzel	Center	Roger L. & Sandra K. Wade	4.00
23	8	42	Wetzel	Center	Jeffrey P. & Howard M. Henderson	67.00
24	8	55	Wetzel	Center	Ashley Murphy, et al.	9.43
25	8	47	Wetzel	Center	Howard M. Henderson	14.75
26	8	46	Wetzel	Center	Howard M. Henderson	13.20
27	8	52	Wetzel	Center	Ashley Murphy, et al.	3.35
28	6	31	Wetzel	Clay	Howard M. Henderson	8.20
29	8	59	Wetzel	Center	Ashley Murphy, et al.	47.25
30	8	30	Wetzel	Center	Howard M. Henderson	18.00
31	8	24	Wetzel	Center	Charles P. & Franny F. Wade	10.44
32	8	27	Wetzel	Center	Evan H. & Janet L. Backinger	1.80
33	8	12	Wetzel	Center	Howard Henderson	42.65
34	8	13	Wetzel	Center	Howard M. Henderson	9.50
35	8	14	Wetzel	Center	Howard M. Henderson	9.50
36	8	5	Wetzel	Center	Howard Henderson	56.00
37	8	4	Wetzel	Center	Howard M. Henderson	80.23
38	8	28	Wetzel	Center	Evan H. & Janet L. Backinger	0.25
39	8	25	Wetzel	Center	Evan H. & Janet L. Backinger	0.44
40	8	17	Wetzel	Center	Evan H. & Janet L. Backinger	91.00
41	8	10	Wetzel	Center	Howard M. Henderson	100 x 250
42	8	3	Wetzel	Center	Howard M. Henderson	36.00
43	8	16	Wetzel	Center	Evan H. & Janet L. Backinger	79.30
44	8	36	Wetzel	Center	Kenneth J. Hollobaugh	87.00
45	8	6	Wetzel	Center	David Wood	44.00
46	5	20	Wetzel	Center	Howard M. Henderson	125.14
47	5	27	Wetzel	Center	Howard M. Henderson	8.00
48	5	28	Wetzel	Center	Terry L. Riler	162.00
49	5	16	Wetzel	Center	Jack A. & Laura A. Cartwright	37.80
50	5	6	Wetzel	Center	None	None
51	5	5	Wetzel	Center	William E. & William J. Renner	5.10
52	5	4	Wetzel	Center	William E. Renner	149.54
53	5	14	Wetzel	Center	Benjamin E. Varber	224.00
54	5	22	Wetzel	Center	Mike Ross Inc	103.75

Lease No.	Owner	Acres
870415	Howard Henderson, et al.	189
870525	Nancy E. Jolliffe, et al.	5.5
870424	Nancy E. Jolliffe	26
871343	Thomas J. Iacaboni, et al.	4.75
1028831	AMP Fund III, LP, et al.	132.6
870258	Glen E. Burnette, Jr., et al.	59
870417	Sherry Lynn Chefren, et al.	108
870244	Howard Henderson, et al.	91.5
870188	Carol Louise Saunik Ellringham	57
870035	Stone Hill Minerals Holdings, LLC, et al.	150
1041918	Ronald R. Reiter, et al.	26.89
870431	Lisa Koon, et al.	47.25

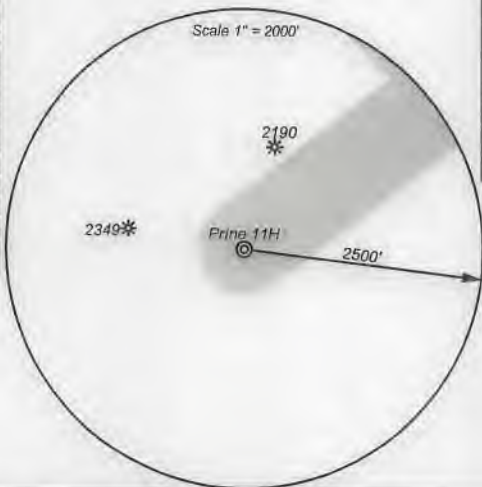
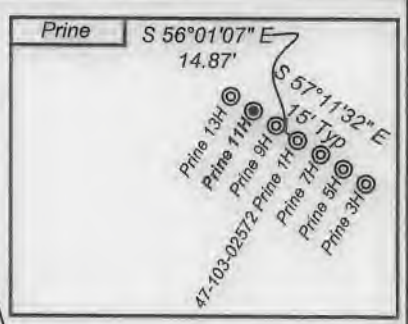

- ⊙ Proposed Gas Well
- Located Corner, as noted
- Surface Tract Lines
- Reference Line
- Lease Boundary
- Creek or Drain
- Ⓢ WV County Route
- Ⓢ WV State Route



I, the undersigned, hereby certify that this plat is correct to the best of my knowledge and belief and shows all the information required by law and the regulations issued and prescribed by the Department of Environmental Protection.

Ben R. Singleton
P.S. 2092



FILE NO: 289-16
DRAWING NO: Prine 11H
SCALE: 1" = 2000'
MINIMUM DEGREE OF ACCURACY: 1:2500
PROVEN SOURCE OF ELEVATION: NGS CORS Station

STATE OF WEST VIRGINIA
DEPARTMENT OF ENVIRONMENTAL PROTECTION
OIL AND GAS DIVISION

DATE: June 12 20 20
OPERATOR'S WELL NO.: Prine 11H
API WELL NO: HGA
47 - 103 - 03359
STATE COUNTY PERMIT

WELL TYPE: OIL GAS LIQUID INJECTION WASTE DISPOSAL
(IF GAS) PRODUCTION: STORAGE DEEP SHALLOW
LOCATION: ELEVATION: 1335' WATERSHED Tributary of Bear Run QUADRANGLE: Littleton
DISTRICT: Center COUNTY: Wetzel
SURFACE OWNER: Howard M. Henderson ACREAGE: 112
ROYALTY OWNER: Jamie Joe Prine, et al LEASE NO: 870370 ACREAGE: 111
PROPOSED WORK: DRILL CONVERT DRILL DEEPER FRACTURE OR STIMULATE PLUG OFF OLD FORMATION
 PERFORATE NEW FORMATION OTHER PHYSICAL CHANGE IN WELL (SPECIFY)
 PLUG AND ABANDON CLEAN OUT AND REPLUG TARGET FORMATION: Marcellus ESTIMATED DEPTH: 7,500'

WELL OPERATOR: EQT Production Company DESIGNATED AGENT: Joseph C. Mallow
ADDRESS: 400 Woodcliff Drive ADDRESS: 115 Professional Place PO Box 280
Canonsburg, PA 15317 Bridgeport, WV 26330