

I, the undersigned, hereby certify that this plat is correct to the best of my knowledge and belief and shows all the information required by law and the regulations issued and prescribed by the Department of Environmental Protection.

Ben R. Singleton

P.S. 2092

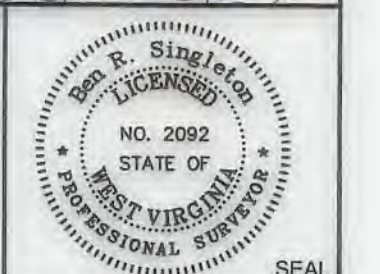

FILE NO: 289-16
 DRAWING NO: Prine 9H
 SCALE: 1" = 2000'
 MINIMUM DEGREE OF ACCURACY: 1:2500
 PROVEN SOURCE OF ELEVATION: NGS CORS Station

STATE OF WEST VIRGINIA
 DEPARTMENT OF ENVIRONMENTAL PROTECTION
OIL AND GAS DIVISION

DATE: January 25 20 21
 OPERATOR'S WELL NO.: Prine 9H
 API WELL NO
 47 - 103 - 03358
 STATE COUNTY PERMIT

WELL TYPE: OIL GAS LIQUID INJECTION WASTE DISPOSAL
 (IF GAS) PRODUCTION: STORAGE DEEP SHALLOW
 LOCATION: ELEVATION: 1335' WATERSHED Tributary of Bear Run QUADRANGLE: Littleton
 DISTRICT: Center COUNTY: Wetzel
 SURFACE OWNER: Howard M. Henderson ACREAGE: 112
 ROYALTY OWNER: Jamie Joe Prine, et al. LEASE NO: 870370 ACREAGE: 111
 PROPOSED WORK: DRILL CONVERT DRILL DEEPER FRACTURE OR STIMULATE PLUG OFF OLD FORMATION
 PERFORATE NEW FORMATION OTHER PHYSICAL CHANGE IN WELL (SPECIFY)
 PLUG AND ABANDON CLEAN OUT AND REPLUG TARGET FORMATION: Marcellus ESTIMATED DEPTH: 7,489'

WELL OPERATOR: EQT Production Company DESIGNATED AGENT: Joseph C. Mallow
 ADDRESS: 400 Woodcliff Drive ADDRESS: 115 Professional Place PO Box 280
 Canonsburg, PA 15317 Bridgeport, WV 26330

**Prine 9H
LIT53
EQT Production Company**

Tract I.D.	Tax Map No.	Parcel No.	County	District	Surface Tract Owner	Acres
1	8	43	Wetzel	Center	Howard M. Henderson	112.00
2	8	44	Wetzel	Center	William D. Henderson	85.00
3	8	45	Wetzel	Center	Howard Henderson	5.50
4	8	31.1	Wetzel	Center	Howard Henderson	18.43
5	8	31	Wetzel	Center	Howard Henderson	84.76
6	8	29	Wetzel	Center	Howard M. & Wilian D. Henderson	57.80
7	8	28	Wetzel	Center	Matthew J. Rice	108.00
8	8	27	Wetzel	Center	Evan H. & Janet L. Backinger	1.80
9	8	26	Wetzel	Center	Evan H. & Janet L. Backinger	0.25
10	8	24	Wetzel	Center	Charles P. & Franny P. Wade	10.44
11	8	25	Wetzel	Center	Evan H. & Janet L. Backinger	0.44
12	8	17	Wetzel	Center	Evan H. & Janet L. Backinger	91.00
13	8	7	Wetzel	Center	EQT Production Company	160.00
14	8	2	Wetzel	Center	EQT Production Company	72.43
15	8	1	Wetzel	Center	EQT Production Company	81.50
16	5	23	Wetzel	Center	Robert Long, et al.	172.50
17	5	14	Wetzel	Center	Benjamin E. Yarber	224.00
18	11	9	Wetzel	Center	Howard M. Henderson	10.10
19	11	8	Wetzel	Center	James B. & Margie L. Montgomery	52.00
20	11	8.1	Wetzel	Center	Larry L. & Lois J. Deem	94.50
21	11	6	Wetzel	Center	Ray S. & Timmy R. Sapp	90.50
22	11	6.2	Wetzel	Center	Roger L. & Sandra K. Wade	4.00
23	8	42	Wetzel	Center	Jeffrey P. & Howard M. Henderson	67.00
24	8	55	Wetzel	Center	Ashley Murphy, et al.	9.43
25	8	47	Wetzel	Center	Howard M. Henderson	14.75
26	8	46	Wetzel	Center	Howard M. Henderson	13.20
27	8	53	Wetzel	Center	Ashley Murphy, et al.	29.38
28	8	30	Wetzel	Center	Howard M. Henderson	18.00
29	8	12	Wetzel	Center	Howard Henderson	42.65
30	8	59	Wetzel	Center	Ashley Murphy, et al.	47.25
31	8	11	Wetzel	Center	Howard M. Henderson	91.50
32	8	8	Wetzel	Center	Lillian M. Pitzer & Jason L. Wright	57.00
33	8	40.1	Wetzel	Center	Robert E. Dorsey, Sr.	38.00
34	8	21	Wetzel	Center	Charles P. & Franny P. Wade	3.00
35	8	22	Wetzel	Center	William R. White	0.66
36	8	23	Wetzel	Center	William R. White, et al.	0.58
37	8	20	Wetzel	Center	William R. White	2.87
38	8	18.1	Wetzel	Center	Kenneth R. Morris, et al.	0.10
39	8	18	Wetzel	Center	William R. White	1.00
40	8	19	Wetzel	Center	William R. White	0.66
41	8	16	Wetzel	Center	Evan H. & Janet L. Backinger	79.30
42	8	36	Wetzel	Center	Kenneth J. Hollibaugh	87.00
43	8	8	Wetzel	Center	David Wood	44.00
44	8	3.1	Wetzel	Center	Dalison Lumber Inc	15.86
45	8	3	Wetzel	Center	Howard M. Henderson	38.00
46	5	24	Wetzel	Center	EQT Production Company	12.50
47	5	15	Wetzel	Center	Howard M. Henderson	228.00
48	5	22	Wetzel	Center	Mike Ross Inc	103.78
49	4	32	Wetzel	Center	James L. Musgrave, et al.	127.72
50	5	2.1	Wetzel	Center	Susan Miller, et al.	66.25
51	5	13	Wetzel	Center	Susan Miller, et al.	80.00
52	5	2	Wetzel	Center	Susan Miller, et al.	40.00
53	5	3.1	Wetzel	Center	Larry G. & Jana L. Rine	68.80
54	5	3.2	Wetzel	Center	Larry G. & Jana L. Rine	62.40
55	5	4	Wetzel	Center	William E. Renner	149.54

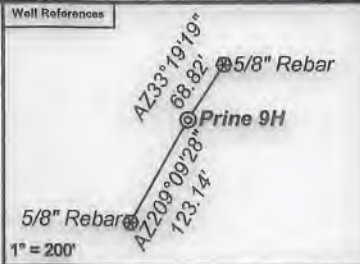

Notes:
 Prine 9H coordinates are
 NAD 27 N: 427,877.81 E: 1,697,707.59
 NAD 27 Lat: 39.669810 Long: -80.573894
 NAD 83 UTM N: 4,391,206.36 E: 536,563.38
 Prine 9H Landing Point coordinates are
 NAD 27 N: 429,388.83 E: 1,698,765.22
 NAD 27 Lat: 39.673993 Long: -80.570201
 NAD 83 UTM N: 4,391,672.10 E: 536,877.94
 Prine 9H Bottom Hole coordinates are
 NAD 27 N: 438,907.89 E: 1,689,246.15
 NAD 27 Lat: 39.699809 Long: -80.604432
 NAD 83 UTM N: 4,394,523.67 E: 533,929.48
 West Virginia Coordinate system of 1927 (North Zone)
 based upon Differential GPS Measurements.
 Plat orientation, corner and well ties are based upon
 the grid north meridian.
 Well location references are based upon the grid north
 meridian.
 UTM coordinates are NAD83, Zone 17, Meters.

Lease No.	Owner	Acres
870415 ✓	Howard Henderson, et al.	189
870525 ✓	Nancy E. Jolliffe, et al.	5.5
870424 ✓	Nancy E. Jolliffe	26
870258 ✓	Glen E. Burnette, Jr., et al.	59
870417 ✓	Sherry Lynn Chefron, et al.	108
1018014 ✓	Dorothy L. Barrett, et al.	2,237.5
1044156 ✓	Dorothy L. Barrett, et al.	0.25
1044935	Margaret D. Sole, et al.	19.44
870395 ✓	Brian R. Morgan, et al.	170
870035 ✓	Stone Hill Minerals Holdings, LLC, et al.	150
877947 ✓	EQT Production Company, et al.	222
870368 ✓	Sandra Estes, et al.	81.5 & 12.5 of 288.54
871183 ✓	Oakey Ray Long & Joyce Lee Long, et al.	172.5
1032919 ✓	Benjamin Yarber, et ux.	136.595184 of 224
870188 ✓	Carol Louise Saunik Eltringham	57

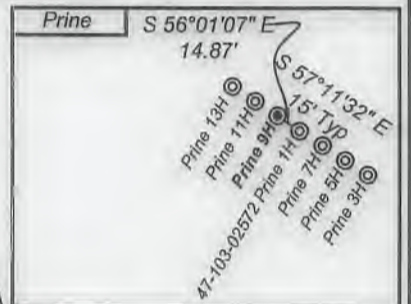
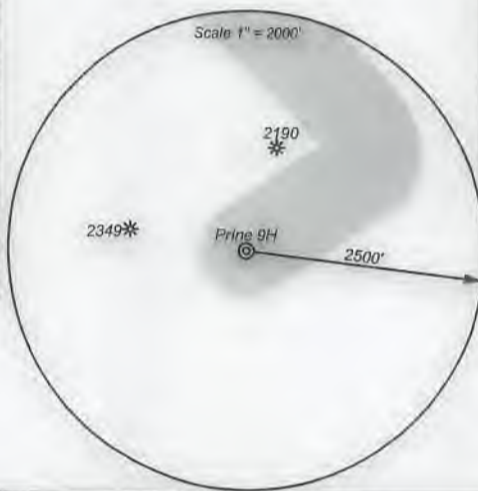

- ⊙ Proposed Gas Well
- Located Corner, as noted
- Surface Tract Lines
- Reference Line
- Lease Boundary
- Creek or Drain
- ⊖ WV County Route
- ⊖ WV State Route



I, the undersigned, hereby certify that this plat is correct to the best of my knowledge and belief and shows all the information required by law and the regulations issued and prescribed by the Department of Environmental Protection.

Ben R. Singleton
 P.S. 2092

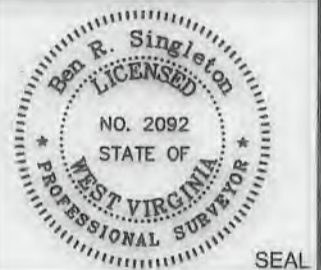

FILE NO: 289-16
 DRAWING NO: Prine 9H
 SCALE: 1" = 2000'
 MINIMUM DEGREE OF ACCURACY:
 1:2500
 PROVEN SOURCE OF ELEVATION:
 NGS CORS Station



DATE: January 25 20 21
 OPERATOR'S WELL NO.: Prine 9H
 API WELL NO
 47 - 103 - 03358
 STATE COUNTY PERMIT

WELL TYPE: OIL GAS LIQUID INJECTION WASTE DISPOSAL
 (IF GAS) PRODUCTION: STORAGE DEEP SHALLOW
 LOCATION: ELEVATION: 1335' WATERSHED Tributary of Bear Run QUADRANGLE: Littleton
 DISTRICT: Center COUNTY: Wetzel
 SURFACE OWNER: Howard M. Henderson ACREAGE: 112
 ROYALTY OWNER: Jamie Joe Prine, et al. LEASE NO: 870370 ACREAGE: 111
 PROPOSED WORK: DRILL CONVERT DRILL DEEPER FRACTURE OR STIMULATE PLUG OFF OLD FORMATION
 PERFORATE NEW FORMATION OTHER PHYSICAL CHANGE IN WELL (SPECIFY)
 PLUG AND ABANDON CLEAN OUT AND REPLUG TARGET FORMATION: Marcellus ESTIMATED DEPTH: 7,489'

WELL OPERATOR: EQT Production Company DESIGNATED AGENT: Joseph C. Mallow
 ADDRESS: 400 Woodcliff Drive ADDRESS: 115 Professional Place PO Box 280
 Canonsburg, PA 15317 Bridgeport, WV 26330