



west virginia department of environmental protection

Office of Oil and Gas
601 57th Street, S.E.
Charleston, WV 25304
(304) 926-0450
fax: (304) 926-0452

Harold D. Ward, Cabinet Secretary
www.dep.wv.gov

Wednesday, March 3, 2021
PERMIT MODIFICATION APPROVAL
Horizontal 6A / New Drill

EQT PRODUCTION COMPANY
625 LIBERTY AVE., SUITE 1700
PITTSBURGH, PA 15222

Re: Permit Modification Approval for PRINE 9H
47-103-03358-00-00

Extend Lateral Length. Updated Leases.

EQT PRODUCTION COMPANY

The Office of Oil and Gas has reviewed the attached permit modification for the above referenced permit. The attached modification has been approved and well work may begin. Please be reminded that the oil and gas inspector is to be notified twenty-four (24) hours before permitted well work is commenced.

If there are any questions, please feel free to contact me at (304) 926- 0450.

A handwritten signature in blue ink, appearing to read 'James A. Martin', is positioned above the printed name and title.

James A. Martin
Chief

Operator's Well Number: PRINE 9H
Farm Name: HOWARD M HENDERSON
U.S. WELL NUMBER: 47-103-03358-00-00
Horizontal 6A New Drill
Date Modification Issued: 03/03/2021

Promoting a healthy environment.

STATE OF WEST VIRGINIA
DEPARTMENT OF ENVIRONMENTAL PROTECTION, OFFICE OF OIL AND GAS
WELL WORK PERMIT APPLICATION

1) Well Operator: EQT Production Company 306686 Wetzel Center Littleton
Operator ID County District Quadrangle

2) Operator's Well Number: 9H Well Pad Name: Prine

3) Farm Name/Surface Owner: Howard M. Henderson Public Road Access: CR 8/7

4) Elevation, current ground: 1,335' (built) Elevation, proposed post-construction: 1,335'

5) Well Type (a) Gas Oil Underground Storage

Other

(b) If Gas Shallow Deep

Horizontal

6) Existing Pad: Yes or No Yes

DMAH 1/21/21

7) Proposed Target Formation(s), Depth(s), Anticipated Thickness and Expected Pressure(s):
Marcellus, 7,489', 48', 2,620 psi

8) Proposed Total Vertical Depth: 7,489'

9) Formation at Total Vertical Depth: Marcellus

10) Proposed Total Measured Depth: 21,674' ✓

11) Proposed Horizontal Leg Length: 13,462' ✓

12) Approximate Fresh Water Strata Depths: 143' ✓

13) Method to Determine Fresh Water Depths: Offset Wells - 47-103-02572, 47-103-02349, 47-103-02190, 47-103-02189, 47-103-02244 ✓

14) Approximate Saltwater Depths: 1,976', 2,110'

15) Approximate Coal Seam Depths: 842'-845', 1,071'-1,075', 1,180'-1,185', 602'-613' ^{103-02572-WR-35}

16) Approximate Depth to Possible Void (coal mine, karst, other): N/A

17) Does Proposed well location contain coal seams directly overlying or adjacent to an active mine? Yes No

(a) If Yes, provide Mine Info: Name: _____

Depth: _____

Seam: _____

Owner: _____

RECEIVED
Office of Oil and Gas

JAN 29 2021

WV Department of
Environmental Protection

18)

CASING AND TUBING PROGRAM

TYPE	<u>Size (in)</u>	<u>New or Used</u>	<u>Grade</u>	<u>Weight per ft. (lb/ft)</u>	<u>FOOTAGE: For Drilling (ft)</u>	<u>INTERVALS: Left in Well (ft)</u>	<u>CEMENT: Fill-up (Cu. Ft.)/CTS</u>
Conductor	26	New	A-500	85.6	40	40 ✓	98 ft ³ / CTS
Fresh Water	13 3/8	New	J-55	54.5	1319	1319 ✓	1240 ft ³ / CTS
Coal							
Intermediate	9 5/8	New	P-110	40	2884	2884 ✓	1097 ft ³ / CTS
Production	5 1/2	New	P-110	20	21674	21674 ✓	500' above intermediate casing
Tubing							
Liners							

DWH 1/21/21

TYPE	<u>Size (in)</u>	<u>Wellbore Diameter (in)</u>	<u>Wall Thickness (in)</u>	<u>Burst Pressure (psi)</u>	<u>Anticipated Max. Internal Pressure (psi)</u>	<u>Cement Type</u>	<u>Cement Yield (cu. ft./k)</u>
Conductor	26	30	0.312	1050	18	Class A	1.18
Fresh Water	13 3/8	17 1/2	0.380	2730	2184	Class A	1.13
Coal							
Intermediate	9 5/8	12 3/8	0.395	7900	6320	Class A	1.18
Production	5 1/2	8 1/2	0.361	14360	11488	Class A/H	1.04 - 2.098
Tubing							
Liners							

PACKERS

Kind:				
Sizes:				
Depths Set:				

RECEIVED
 Office of Oil and Gas
 JAN 29 2021
 WV Department of
 Environmental Protection

19) Describe proposed well work, including the drilling and plugging back of any pilot hole:

This well has been topset. EQT will continue drilling the curve. Drill the lateral in the Marcellus. Cement casing.

RECEIVED
Office of Oil and Gas

JAN 29 2021

WV DEPARTMENT OF
Environmental Protection

DWAH 1/21/21

20) Describe fracturing/stimulating methods in detail, including anticipated max pressure and max rate:

Hydraulic fracturing is completed in accordance with state regulations using water recycled from previously fractured wells and obtained from freshwater sources. This water is mixed with sand and a small percentage (less than 0.1%) of chemicals (including 15% Hydrochloric acid, friction reducer, biocide, and scale inhibitor), referred to in the industry as a "slickwater" completion. Maximum anticipated internal casing pressure is expected to be approximately 10,000 psi, maximum anticipated treating rates are expected to average approximately 100 bpm. Stage lengths vary from 150 to 300 feet. Average approximately 350,000 gallons of water per stage. Sand sizes vary from 100 mesh to 20/40 mesh. Average approximately 200,000-600,000 pounds of proppant per stage.

21) Total Area to be disturbed, including roads, stockpile area, pits, etc., (acres): 4.89 Acres (built)

22) Area to be disturbed for well pad only, less access road (acres): 1.79 Acres (built)

23) Describe centralizer placement for each casing string:

- Surface: Bow spring centralizers – One centralizer at the shoe and one spaced every 500’.
- Intermediate: Bow spring centralizers– One centralizer at the shoe and one spaced every 500’.
- Production: One solid body centralizer spaced every joint from production casing shoe to KOP

24) Describe all cement additives associated with each cement type:

Conductor: Class A no additives
Surface: Calcium Chloride. Used to speed the setting of cement slurries
Intermediate: Calcium Chloride. Used to speed the setting of cement slurries.
Production: Calcium Carbonate, Fluid Loss, Extender, Dispersent, Viscosifier, Defoamer, POZ, Bonding Agent, Retarder, Anti-Settling/Suspension Agent

25) Proposed borehole conditioning procedures:

Surface: Circulate hole clean while rotating & reciprocating the drill string until cuttings diminish at surface.
Intermediate: Circulate hole clean while rotating & reciprocating the drill string until cuttings diminish at surface.
Production: Perform a cleanup cycle by pumping 3-8 bottoms up or until the shakers are clean. Check volume of cuttings coming across the shakers every 15 minutes.

*Note: Attach additional sheets as needed.

EQT Production

Wellbore Diagram

Well: Prine 9H
Pad: Prine
Elevation: 1336' GL 1349' KB

County: Wetzel
State: West Virginia

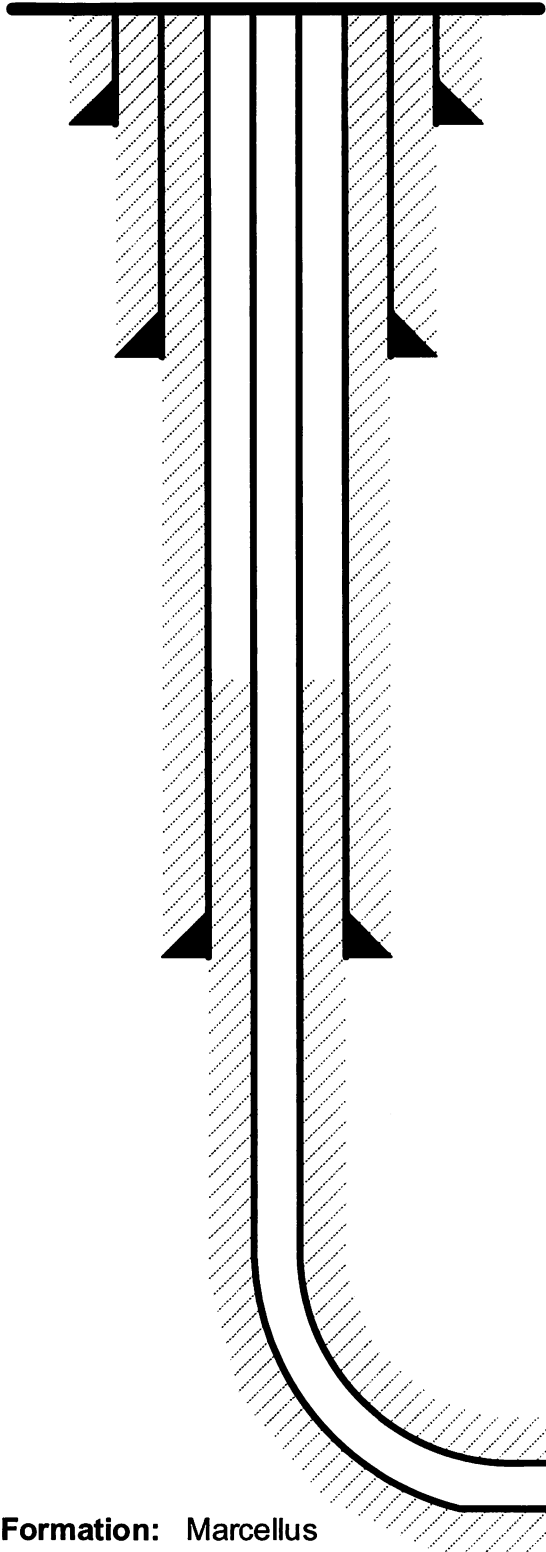

Conductor @ 40'

26", 85.6#, A-500, cement to surface w/ Class A

Surface @ 1,319'

13-3/8", 54.5#, J-55, cement to surface w/ Class A

RECEIVED
Office of Oil and Gas

JAN 29 2021

WV Department of
Environmental Protection

Intermediate @ 2,884'

9-5/8", 40#, P-110, cement to surface w/ Class A

DMH 1/21/21

Production @ 21,674' MD / 7,489' TVD

5-1/2", 20#, P-110, cement to 500' inside 9-5/8" w/ Class A/H

Formation: Marcellus

NOT TO SCALE

**Prine 9H
LIT53
EQT Production Company**

Tract I.D.	Tax Map No.	Parcel No.	County	District	Surface Tract Owner	Acres
1	8	43	Wetzel	Center	Howard M. Henderson	112.00
2	8	44	Wetzel	Center	William D. Henderson	85.00
3	8	45	Wetzel	Center	Howard Henderson	5.50
4	8	31.1	Wetzel	Center	Howard Henderson	18.43
5	8	31	Wetzel	Center	Howard Henderson	84.76
6	8	29	Wetzel	Center	Howard M. & Wilian D. Henderson	57.80
7	8	28	Wetzel	Center	Matthew J. Rice	108.00
8	8	27	Wetzel	Center	Evan H. & Janet L. Backinger	1.80
9	8	26	Wetzel	Center	Evan H. & Janet L. Backinger	0.25
10	8	24	Wetzel	Center	Charles P. & Franny P. Wade	10.44
11	8	25	Wetzel	Center	Evan H. & Janet L. Backinger	0.44
12	8	17	Wetzel	Center	Evan H. & Janet L. Backinger	91.00
13	8	7	Wetzel	Center	EQT Production Company	160.00
14	8	2	Wetzel	Center	EQT Production Company	72.43
15	8	1	Wetzel	Center	EQT Production Company	81.50
16	5	23	Wetzel	Center	Robert Long, et al.	172.50
17	5	14	Wetzel	Center	Benjamin E. Yarber	224.00
18	11	9	Wetzel	Center	Howard M. Henderson	10.10
19	11	8	Wetzel	Center	James B. & Margie L. Montgomery	52.00
20	11	8.1	Wetzel	Center	Larry L. & Lois J. Dean	94.50
21	11	6	Wetzel	Center	Ray S. & Timmy R. Sapp	90.50
22	11	6.2	Wetzel	Center	Roger L. & Sandra K. Wade	4.00
23	8	42	Wetzel	Center	Jeffrey P. & Howard M. Henderson	67.00
24	8	55	Wetzel	Center	Ashley Murphy, et al.	9.43
25	8	47	Wetzel	Center	Howard M. Henderson	14.75
26	8	46	Wetzel	Center	Howard M. Henderson	13.20
27	8	53	Wetzel	Center	Ashley Murphy, et al.	29.38
28	8	30	Wetzel	Center	Howard M. Henderson	18.00
29	8	12	Wetzel	Center	Howard Henderson	42.65
30	8	59	Wetzel	Center	Ashley Murphy, et al.	47.25
31	8	11	Wetzel	Center	Howard M. Henderson	91.50
32	8	8	Wetzel	Center	Lillian M. Pitzer & Jason L. Wright	57.00
33	8	40.1	Wetzel	Center	Robert E. Dorsey, Sr.	38.00
34	8	21	Wetzel	Center	Charles P. & Franny P. Wade	3.00
35	8	22	Wetzel	Center	William R. White	0.66
36	8	23	Wetzel	Center	William R. White, et al.	0.58
37	8	20	Wetzel	Center	William R. White	2.87
38	8	18.1	Wetzel	Center	Kenneth R. Morris, et al.	0.10
39	8	18	Wetzel	Center	William R. White	1.00
40	8	19	Wetzel	Center	William R. White	0.66
41	8	16	Wetzel	Center	Evan H. & Janet L. Backinger	79.30
42	8	36	Wetzel	Center	Kenneth J. Hollibaugh	87.00
43	8	8	Wetzel	Center	David Wood	44.00
44	8	3.1	Wetzel	Center	Dalison Lumber Inc	15.86
45	8	3	Wetzel	Center	Howard M. Henderson	38.00
46	5	24	Wetzel	Center	EQT Production Company	12.50
47	5	15	Wetzel	Center	Howard M. Henderson	228.00
48	5	22	Wetzel	Center	Mike Ross Inc	103.78
49	4	32	Wetzel	Center	James L. Musgrave, et al.	127.72
50	5	2.1	Wetzel	Center	Susan Miller, et al.	69.25
51	5	13	Wetzel	Center	Susan Miller, et al.	80.00
52	5	2	Wetzel	Center	Susan Miller, et al.	40.00
53	5	3.1	Wetzel	Center	Larry G. & Jana L. Rine	68.80
54	5	3.2	Wetzel	Center	Larry G. & Jana L. Rine	62.40
55	5	4	Wetzel	Center	William E. Renner	149.54

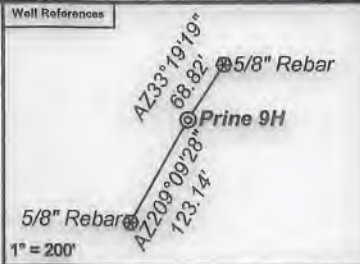

Notes:
 Prine 9H coordinates are
 NAD 27 N: 427,877.81 E: 1,697,707.59
 NAD 27 Lat: 39.669810 Long: -80.573894
 NAD 83 UTM N: 4,391,206.36 E: 536,563.38
 Prine 9H Landing Point coordinates are
 NAD 27 N: 429,388.83 E: 1,698,765.22
 NAD 27 Lat: 39.673993 Long: -80.570201
 NAD 83 UTM N: 4,391,672.10 E: 536,877.94
 Prine 9H Bottom Hole coordinates are
 NAD 27 N: 438,907.89 E: 1,689,246.15
 NAD 27 Lat: 39.699809 Long: -80.604432
 NAD 83 UTM N: 4,394,523.67 E: 533,929.48
 West Virginia Coordinate system of 1927 (North Zone)
 based upon Differential GPS Measurements.
 Plat orientation, corner and well ties are based upon
 the grid north meridian.
 Well location references are based upon the grid north
 meridian.
 UTM coordinates are NAD83, Zone 17, Meters.

Lease No.	Owner	Acres
870415 ✓	Howard Henderson, et al.	189
870525 ✓	Nancy E. Jolliffe, et al.	5.5
870424 ✓	Nancy E. Jolliffe	26
870258 ✓	Glen E. Burnette, Jr., et al.	59
870417 ✓	Sherry Lynn Chefron, et al.	108
1018014 ✓	Dorothy L. Barrett, et al.	2,237.5
1044156 ✓	Dorothy L. Barrett, et al.	0.25
1044935 ✓	Margaret D. Sole, et al.	19.44
870395 ✓	Brian R. Morgan, et al.	170
870035 ✓	Stone Hill Minerals Holdings, LLC, et al.	150
877947 ✓	EQT Production Company, et al.	222
870368 ✓	Sandra Estes, et al.	81.5 & 12.5 of 288.54
871183 ✓	Oakey Ray Long & Joyce Lee Long, et al.	172.5
1032919 ✓	Benjamin Yarber, et ux.	136.595184 of 224
870188 ✓	Carol Louise Saunik Eltringham	57

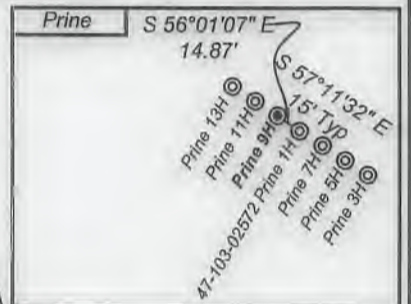
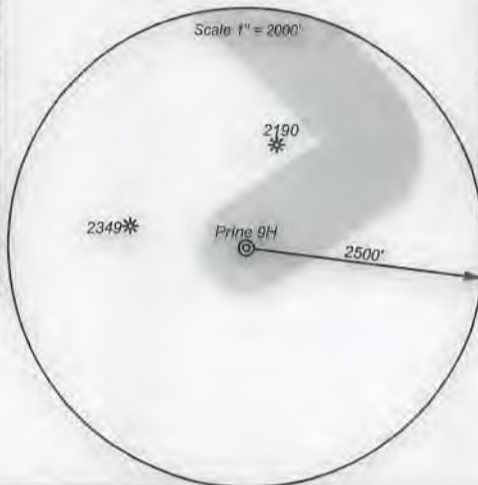

- ⊙ Proposed Gas Well
- Located Corner, as noted
- Surface Tract Lines
- Reference Line
- Lease Boundary
- Creek or Drain
- ⊖ WV County Route
- ⊖ WV State Route



I, the undersigned, hereby certify that this plat is correct to the best of my knowledge and belief and shows all the information required by law and the regulations issued and prescribed by the Department of Environmental Protection.

Ben R. Singleton
 P.S. 2092



SEAL

FILE NO: 289-16
 DRAWING NO: Prine 9H
 SCALE: 1" = 2000'
 MINIMUM DEGREE OF ACCURACY:
 1:2500
 PROVEN SOURCE OF ELEVATION:
 NGS CORS Station

STATE OF WEST VIRGINIA
 DEPARTMENT OF ENVIRONMENTAL PROTECTION
OIL AND GAS DIVISION

DATE: January 25 20 21
 OPERATOR'S WELL NO.: Prine 9H
 API WELL NO
 47 - 103 - 03358
 STATE COUNTY PERMIT

WELL TYPE: OIL GAS LIQUID INJECTION WASTE DISPOSAL
 (IF GAS) PRODUCTION: STORAGE DEEP SHALLOW
 LOCATION: ELEVATION: 1335' WATERSHED Tributary of Bear Run QUADRANGLE: Littleton
 DISTRICT: Center COUNTY: Wetzel
 SURFACE OWNER: Howard M. Henderson ACREAGE: 112
 ROYALTY OWNER: Jamie Joe Prine, et al. LEASE NO: 870370 ACREAGE: 111
 PROPOSED WORK: DRILL CONVERT DRILL DEEPER FRACTURE OR STIMULATE PLUG OFF OLD FORMATION
 PERFORATE NEW FORMATION OTHER PHYSICAL CHANGE IN WELL (SPECIFY)
 PLUG AND ABANDON CLEAN OUT AND REPLUG TARGET FORMATION: Marcellus ESTIMATED DEPTH: 7,489'

WELL OPERATOR: EQT Production Company DESIGNATED AGENT: Joseph C. Mallow
 ADDRESS: 400 Woodcliff Drive ADDRESS: 115 Professional Place PO Box 280
 Canonsburg, PA 15317 Bridgeport, WV 26330

**INFORMATION SUPPLIED UNDER WEST VIRGINIA CODE
Chapter 22, Article 6A, Section 5(a)(5)
IN LIEU OF FILING LEASE(S) AND OTHER CONTINUING CONTRACT(S)**

Under the oath required to make the verification on page 1 of this Notice and Application, I depose and say that I am the person who signed the Notice and Application for the Applicant, and that –

- (1) the tract of land is the same tract described in this Application, partly or wholly depicted in the accompanying plat, and described in the Construction and Reclamation Plan;
- (2) the parties and recordation data (if recorded) for lease(s) or other continuing contract(s) by which the Applicant claims the right to extract, produce or market the oil or gas are as follows:

Lease Name or Number	Grantor, Lessor, etc.	Grantee, Lessee, etc.	Royalty	Book/Page
----------------------	-----------------------	-----------------------	---------	-----------

See Attached

**Acknowledgement of Possible Permitting/Approval
In Addition to the Office of Oil and Gas**

The permit applicant for the proposed well work addressed in this application hereby acknowledges the possibility of the need for permits and/or approvals from local, state, or federal entities in addition to the DEP, Office of Oil and Gas, including but not limited to the following:

- WV Division of Water and Waste Management
- WV Division of Natural Resources WV Division of Highways
- U.S. Army Corps of Engineers
- U.S. Fish and Wildlife Service
- County Floodplain Coordinator

The applicant further acknowledges that any Office of Oil and Gas permit in no way overrides, replaces, or nullifies the need for other permits/approvals that may be necessary and further affirms that all needed permits/approvals should be acquired from the appropriate authority before the affected activity is initiated.

Well Operator: EQT Production Company 

By: John Zavatchan

Its: Project Specialist - Permitting

RECEIVED
Office of Oil and Gas

JAN 29 2021

RECEIVED
Office of Oil and Gas

JAN 29 2021

WV Department of Environmental Protection

WV Department of Environmental Protection

Lease No.	Grantor, Lessor, etc.	Grantee, Lessee, etc.	Royalty	Book/Page
1) ✓ 870370	Jamie Joe Prine, et al. Lloyd Joe Prine and Betty M. Prine, h/w Drilling Appalachian Corporation Drilling Appalachian Corporation Grenadier Energy Partners, LLC Statoil USA Onshore Properties Inc.	Drilling Appalachian Corporation Grenadier Energy Partners, LLC Statoil USA Onshore Properties Inc. Statoil USA Onshore Properties Inc. EQT Production Company	"at least 1/8th per WV Code 22-6-8"	OG 85A/380 OG 124A/9 & 136A/538 OG 138A/54 OG 138A/1 OG 175A/707
2) 6 ✓ 870415	Howard Henderson, et al. Maxine Henderson Drilling Appalachian Corporation Drilling Appalachian Corporation Grenadier Energy Partners, LLC Statoil USA Onshore Properties Inc.	Drilling Appalachian Corporation Grenadier Energy Partners, LLC Statoil USA Onshore Properties Inc. Statoil USA Onshore Properties Inc. EQT Production Company	"at least 1/8th per WV Code 22-6-8"	OG 85A/306 OG 124A/9 & 136A/538 OG 138A/54 OG 138A/1 OG 175A/707
3) ✓ 870525	Nancy E. Jolliffe, et al. Joe Jolliffe Drilling Appalachian Corporation Drilling Appalachian Corporation Grenadier Energy Partners, LLC Statoil USA Onshore Properties Inc.	Drilling Appalachian Corporation Grenadier Energy Partners, LLC Statoil USA Onshore Properties Inc. Statoil USA Onshore Properties Inc. EQT Production Company	"at least 1/8th per WV Code 22-6-8"	OG 101A/387 OG 103A/88 & 135A/350 OG 138A/54 OG 138A/1 OG 175A/707
4) ✓ 870424	Nancy E. Jolliffe Joe B. Jolliffe Drilling Appalachian Corporation Drilling Appalachian Corporation Grenadier Energy Partners, LLC Statoil USA Onshore Properties Inc.	Drilling Appalachian Corporation Grenadier Energy Partners, LLC Statoil USA Onshore Properties Inc. Statoil USA Onshore Properties Inc. EQT Production Company	"at least 1/8th per WV Code 22-6-8"	OG 101A/134 OG 103A/88 & 135A/350 OG 138A/54 OG 138A/1 OG 175A/707

RECEIVED
 Office of Oil and Gas
 JAN 29 2021
 WV Department of
 Environmental Protection

5) ✓ 870258 Glen E. Burnette, Jr., et al.

Glen E. Burnette, Jr.
Drilling Appalachian Corporation
Drilling Appalachian Corporation
Grenadier Energy Partners, LLC
Statoil USA Onshore Properties Inc.

Drilling Appalachian Corporation
Grenadier Energy Partners, LLC
Statoil USA Onshore Properties Inc.
Statoil USA Onshore Properties Inc.
EQT Production Company

"at least 1/8th per
WV Code 22-6-8"

OG 86A/473
OG 124A/9 & 136A/538
OG 138A/54
OG 138A/1
OG 175A/707

7) ✓ 870417 Sherry Lynn Chefren, et al.

Sherry Lynn Chefren
Drilling Appalachian Corporation
Drilling Appalachian Corporation
Grenadier Energy Partners, LLC
Statoil USA Onshore Properties Inc.

Drilling Appalachian Corporation
Grenadier Energy Partners, LLC
Statoil USA Onshore Properties Inc.
Statoil USA Onshore Properties Inc.
EQT Production Company

"at least 1/8th per
WV Code 22-6-8"

OG 86A/352
OG 124A/9 & 136A/538
OG 138A/54
OG 138A/1
OG 175A/707

WV Department of
Environmental Protection

JAN 29 2021

RECEIVED
Office of Oil and Gas

10) ✓ 1044935 Margaret D. Sole, et al.

Margaret D. Sole, a widow

EQT Production Company

"at least 1/8th per
WV Code 22-6-8"

OG246A/867

8:9) ✓ 1018014 Dorothy L. Barrett, et al.

Dorothy L. Barrett, a widow

EQT Production Company

"at least 1/8th per
WV Code 22-6-8"

OG 179A/537

12) ✓ 870395 Brian R. Morgan, et al.

Teaunna Morgan
Drilling Appalachian Corporation
Drilling Appalachian Corporation
Grenadier Energy Partners, LLC
Statoil USA Onshore Properties Inc.

Drilling Appalachian Corporation
Grenadier Energy Partners, LLC
Statoil USA Onshore Properties Inc.
Statoil USA Onshore Properties Inc.
EQT Production Company

"at least 1/8th per
WV Code 22-6-8"

OG 109A/909
OG 110A/821 & 135A/356
OG 138A/54
OG 138A/1
OG 175A/707

13) ✓ **870035** Stone Hill Minerals Holdings, LLC, et al.

Stone Hill Minerals Holdings, LLC

EQT Production Company

"at least 1/8th per
WV Code 22-6-8"

OG 180A/52

15) ✓ **870368** Sandra Estes, et al.

Sandra Estes

EQT Production Company

"at least 1/8th per
WV Code 22-6-8"

OG 237A/561

13 & 14) ✓ **877947** EQT Production Company, et al.

Evan H. Backinger and Janet L. Backinger, both single
Statoil USA Onshore Properties Inc.; Statoil Pipelines LLC

Statoil Pipelines LLC
EQT Production Company

Fee

DB 447/569
DB 457/267

16) ✓ **871183** Oakey Ray Long and Joyce Lee Long, et al.

Oakey Ray Long and Joyce Lee Long, h/w
Statoil USA Onshore Properties Inc.

Statoil USA Onshore Properties Inc.
EQT Production Company

"at least 1/8th per
WV Code 22-6-8"

OG 164A/184
OG 175A/707

17) ✓ **1032919** Benjamin Yarber, et ux.

Benjamin Yarber and Maria Yarber, h/w
Drilling Appalachian Corporation
Chesapeake Appalachia, L.L.C.
Chesapeake Appalachia, L.L.C.
Statoil USA Onshore Properties Inc.
SWN Exchange Title Holder LLC
SWN Production Company, LLC
Antero Exchange Properties LLC
Antero Resources Corporation

WV Department of
Environmental Protection

JAN 29 2021

RECEIVED
Office of Oil and Gas

Drilling Appalachian Corporation
Chesapeake Appalachia, L.L.C.
Statoil USA Onshore Properties Inc.
SWN Production Company, LLC
SWN Exchange Title Holder LLC
SWN Production Company, LLC
Antero Exchange Properties LLC
Antero Resources Corporation
EQT Production Company

"at least 1/8th per
WV Code 22-6-8"

OG 92A/544
OG 103A/187
OG 124A/437
OG 157A/540
OG 158A/801
Corp. Book 13/296
OG 177A/533
Corp. Book 13/311
OG 208A/605

32)



870188

Carol Louise Saunik Eltringham

A. Karl Saunik
Drilling Appalachian Corporation
Drilling Appalachian Corporation
Grenadier Energy Partners, LLC
Statoil USA Onshore Properties Inc.

Drilling Appalachian Corporation
Grenadier Energy Partners, LLC
Statoil USA Onshore Properties Inc.
Statoil USA Onshore Properties Inc.
EQT Production Company

"at least 1/8th per
WV Code 22-6-8"

OG 102A/430
OG 103A/88 & 135A/350
OG 138A/54
OG 138A/1
OG 175A/707

11)



1044156

Dorothy L. Barrett, et al

Dorothy L. Barrett, widow

EQT Production Company

"at least 1/8th per
WV Code 22-6-8"

OG 239A/631

RECEIVED
Office of Oil and Gas
JAN 29 2021
WV Department of
Environmental Protection

✓ **870417 Sherry Lynn Chefren, et al.**

Sherry Lynn Chefren
Drilling Appalachian Corporation
Drilling Appalachian Corporation
Grenadier Energy Partners, LLC
Statoil USA Onshore Properties Inc.

Drilling Appalachian Corporation
Grenadier Energy Partners, LLC
Statoil USA Onshore Properties Inc.
Statoil USA Onshore Properties Inc.
EQT Production Company

"at least 1/8th per
WV Code 22-6-8"

OG 86A/352
OG 124A/9 & 136A/538
OG 138A/54
OG 138A/1
OG 175A/707

Not on plat
or well
bore

✓ **870244 Howard Henderson, et al.**

Maxine Henderson
Drilling Appalachian Corporation
Drilling Appalachian Corporation
Grenadier Energy Partners, LLC
Statoil USA Onshore Properties Inc.

Drilling Appalachian Corporation
Grenadier Energy Partners, LLC
Statoil USA Onshore Properties Inc.
Statoil USA Onshore Properties Inc.
EQT Production Company

"at least 1/8th per
WV Code 22-6-8"

OG 86A/282
OG 124A/9 & 136A/538
OG 138A/54
OG 138A/1
OG 175A/707

WV Department of
Environmental Protection

JAN 29 2021

RECEIVED
Oil, Gas and Gas

✓ **870188 Carol Louise Saunik Eltringham**

A. Karl Saunik
Drilling Appalachian Corporation
Drilling Appalachian Corporation
Grenadier Energy Partners, LLC
Statoil USA Onshore Properties Inc.

Drilling Appalachian Corporation
Grenadier Energy Partners, LLC
Statoil USA Onshore Properties Inc.
Statoil USA Onshore Properties Inc.
EQT Production Company

"at least 1/8th per
WV Code 22-6-8"

OG 102A/430
OG 103A/88 & 135A/350
OG 138A/54
OG 138A/1
OG 175A/707

✓ **877947 EQT Production Company, et al.**

Evan H. Backinger and Janet L. Backinger, both single
Statoil USA Onshore Properties Inc.; Statoil Pipelines LLC

Statoil Pipelines LLC
EQT Production Company

Fee

DB 447/569
DB 457/267

✓ **870035 Stone Hill Minerals Holdings, LLC, et al.**

Stone Hill Minerals Holdings, LLC

EQT Production Company

"at least 1/8th per
WV Code 22-6-8"

OG 180A/52

✓ **870368 Sandra Estes, et al.**

Sandra Estes

EQT Production Company

"at least 1/8th per
WV Code 22-6-8"

OG 237A/561



EQT PRODUCTION COMPANY
400 Woodcliff Drive | Canonsburg, PA 15317
P: 724-746-9073 | www.eqt.com

January 28, 2021

Via FedEx Overnight

West Virginia Department of Environmental Protection
Office of Oil and Gas
601 57th Street, S.E.
Charleston, WV 25304

RE: Well Work Permit Modification Application
Prine 9H Well
Permit Number 47-103-03358-00-00
Center District
Wetzel County, WV

WVDEP Recipient,

Attached please find following information to modify the existing Well Work Permit for this well:

- Completed Form WW-6B and supporting documents, approved by the Oil and Gas Inspector
- Revised Well Bore Diagram
- Well Location Plat
- Completed Form WW-6A1 and supporting documentation

EQT is proposing to extend the lateral from the previously permitted length.

EQT Production trusts that if any portion of the submitted documentation is found to be inadequate for processing the permit, notification will be made to our Permitting department at your earliest convenience. It is EQT Production's intent to cooperate fully to provide any additional requested documentation and clarification in a timely manner such that permitting proceeds in a predictable and logical manner.

Best Regards,

John Zavatchan
Project Specialist – Permitting
jzavatchan@eqt.com
724-746-9073

RECEIVED
Office of Oil and Gas
JAN 29 2021
WV Department of
Environmental Protection

RECEIVED
Office of Oil and Gas
JAN 29 2021
WV Department of
Environmental Protection

* Parcels not associated with well bore

VOLD

* **870648** Delorse A. Horner, et al.

"at least 1/8th per
WV Code 22-6-8"

Charles E. Horner & Delorse A. Horner, h/w, &
John M. Horner & Teresa L. Horner, h/w
Grenadier Energy Partners, LLC
Drilling Appalachian Corporation
Grenadier Energy Partners, LLC
Statoil USA Onshore Properties Inc.

Grenadier Energy Partners, LLC
Drilling Appalachian Corporation
Statoil USA Onshore Properties Inc.
Statoil USA Onshore Properties Inc.
EQT Production Company

OG 135A/341
OG 135A/538
OG 138A/54
OG 138A/1
OG 175A/707

* **871183** Oakey Ray Long and Joyce Lee Long, et al.

"at least 1/8th per
WV Code 22-6-8"

Oakey Ray Long and Joyce Lee Long, h/w
Statoil USA Onshore Properties Inc.

Statoil USA Onshore Properties Inc.
EQT Production Company

OG 164A/184
OG 175A/707

* **1041918** Ronald R. Reiter, et al.

"at least 1/8th per
WV Code 22-6-8"

Ronald R. Reiter, married, dealing in his sole and separate property

EQT Production Company

OG 232A/537

* **870431** Lisa Koon, et al.

"at least 1/8th per
WV Code 22-6-8"

Lisa Koon, a single woman
Drilling Appalachian Corporation
Drilling Appalachian Corporation
Grenadier Energy Partners, LLC
Statoil USA Onshore Properties Inc.

Drilling Appalachian Corporation
Grenadier Energy Partners, LLC
Statoil USA Onshore Properties Inc.
Statoil USA Onshore Properties Inc.
EQT Production Company

OG 103A/143
OG 106A/11 & 135A/344
OG 138A/54
OG 138A/1
OG 175A/707

* **1046873** Coastal Forest Resources Company

"at least 1/8th per
WV Code 22-6-8"

Coastal Forest Resources Company d/b/a
Coastal Timberlands Company, collectively f/k/a
Coastal Lumber Company

EQT Production Company

OG 252A/598

RECEIVED
Office of Oil and Gas
JAN 29 2021
WV Department of
Environmental Protection