

- Proposed Gas Well
- Located Corner, as noted
- Surface Tract Lines
- Reference Line
- Lease Boundary
- Creek or Drain
- WV County Route
- WV State Route

(⊙) Denotes Location of Well on United States Topographic Maps



I, the undersigned, hereby certify that this plat is correct to the best of my knowledge and belief and shows all the information required by law and the regulations issued and prescribed by the Department of Environmental Protection.

Ben R. Singleton
P.S. 2092



SEAL

FILE NO: 289-16
DRAWING NO: Prine 7H
SCALE: 1" = 2000'
MINIMUM DEGREE OF ACCURACY: 1:2500
PROVEN SOURCE OF ELEVATION: NGS CORS Station

STATE OF WEST VIRGINIA
DEPARTMENT OF ENVIRONMENTAL PROTECTION
OIL AND GAS DIVISION

DATE: March 30 20 21
OPERATOR'S WELL NO.: Prine 7H
API WELL NO MDD
47 - 103 - 03357
STATE COUNTY PERMIT

WELL TYPE: OIL GAS LIQUID INJECTION WASTE DISPOSAL
(IF GAS) PRODUCTION: STORAGE DEEP SHALLOW
LOCATION: ELEVATION: 1335' WATERSHED: Tributary of Bear Run QUADRANGLE: Littleton
DISTRICT: Center COUNTY: Wetzel
SURFACE OWNER: Howard M. Henderson ACREAGE: 112
ROYALTY OWNER: Jamie Joe Prine, et al. LEASE NO: 870370 ACREAGE: 111
PROPOSED WORK: DRILL CONVERT DRILL DEEPER FRACTURE OR STIMULATE PLUG OFF OLD FORMATION
 PERFORATE NEW FORMATION OTHER PHYSICAL CHANGE IN WELL (SPECIFY)
 PLUG AND ABANDON CLEAN OUT AND REPLUG TARGET FORMATION: Marcellus ESTIMATED DEPTH: 7,489'

04/09/2021

WELL OPERATOR: EQT Production Company DESIGNATED AGENT: Joseph C. Mallow
ADDRESS: 400 Woodcliff Drive ADDRESS: 115 Professional Place PO Box 280
Canonsburg, PA 15317 Bridgeport, WV 26330

**Prine 7H
LIT53
EQT Production Company**

Tract I.D.	Tax Map No.	Parcel No.	County	District	Surface Tract Owner	Acres
1	8	43	Wetzel	Center	Howard M. Henderson	112.00
2	8	44	Wetzel	Center	William D. Henderson	85.00
3	7	7	Wetzel	Center	Charles D. Wood	108.27
4	7	6.1	Wetzel	Center	Rickey A. & Catal A. Yeater	149.00
5	8	31	Wetzel	Center	Howard Henderson	84.75
6	8	20	Wetzel	Center	Howard M. & William D. Henderson	57.00
7	8	28	Wetzel	Center	Matthew J. Rice	108.00
8	8	27	Wetzel	Center	Evan H. & Janet L. Backinger	1.80
9	8	26	Wetzel	Center	Evan H. & Janet L. Backinger	0.25
10	8	24	Wetzel	Center	Charles P. & Franny P. Wade	19.44
11	8	25	Wetzel	Center	Evan H. & Janet L. Backinger	0.44
12	8	17	Wetzel	Center	Evan H. & Janet L. Backinger	91.00
13	8	7	Wetzel	Center	EQT Production Company	180.00
14	8	2	Wetzel	Center	EQT Production Company	72.43
15	8	1	Wetzel	Center	EQT Production Company	81.50
16	5	23	Wetzel	Center	Robert Long, et al.	172.50
17	5	14	Wetzel	Center	Benjamin E. Yeater	224.00
18	11	9	Wetzel	Center	Howard M. Henderson	10.10
19	11	8	Wetzel	Center	James B. & Margie L. Montgomery	92.00
20	11	8.1	Wetzel	Center	Larry L. & Lois J. Deem	94.50
21	11	6	Wetzel	Center	Ray S. & Timmy R. Sapp	90.50
22	11	6.2	Wetzel	Center	Roger L. & Sandra K. Wade	4.00
23	8	42	Wetzel	Center	Jeffrey P. & Howard M. Henderson	67.00
24	8	65	Wetzel	Center	Ashley Murphy, et al.	9.43
25	8	47	Wetzel	Center	Howard M. Henderson	14.75
26	7	6	Wetzel	Center	Wallace J. Doiron	192.21
27	4	35	Wetzel	Center	Shwe Long	34.25
28	8	30	Wetzel	Center	Howard M. Henderson	18.00
29	4	35.7	Wetzel	Center	Robert L. Long, et al.	15.00
30	8	11	Wetzel	Center	Howard M. Henderson	91.50
31	8	8	Wetzel	Center	Lillian M. Pitzer & Jason L. Wright	57.00
32	8	40.1	Wetzel	Center	Robert E. Dorsey, Sr.	38.00
33	8	21	Wetzel	Center	Charles P. & Franny P. Wade	3.00
34	8	22	Wetzel	Center	William R. White	0.86
35	8	23	Wetzel	Center	William R. White, et al.	0.50
36	8	20	Wetzel	Center	William R. White	2.87
37	8	18.1	Wetzel	Center	Kenneth R. Morris, et al.	0.10
38	6	18	Wetzel	Center	William R. White	1.00
39	8	19	Wetzel	Center	William R. White	0.58
40	8	16	Wetzel	Center	Evan H. & Janet L. Backinger	70.30
41	8	36	Wetzel	Center	Kenneth J. Hollobaugh	87.00
42	8	8	Wetzel	Center	David Wood	44.00
43	8	3.1	Wetzel	Center	Dallison Lumber Inc.	15.68
44	5	24	Wetzel	Center	EQT Production Company	12.50
45	5	15	Wetzel	Center	Howard M. Henderson	228.00
46	5	22	Wetzel	Center	Mike Ross Inc.	103.75
47	4	52	Wetzel	Center	James L. Musgrave, et al.	127.72
48	5	21	Wetzel	Center	Susan Miller, et al.	69.25
49	5	13	Wetzel	Center	Susan Miller, et al.	80.00
50	5	2	Wetzel	Center	Susan Miller, et al.	40.00
51	5	3.1	Wetzel	Center	Larry G. & Jana L. Rine	88.80
52	5	3.2	Wetzel	Center	Larry G. & Jana L. Rine	62.40
53	5	4	Wetzel	Center	William E. Renner	149.54

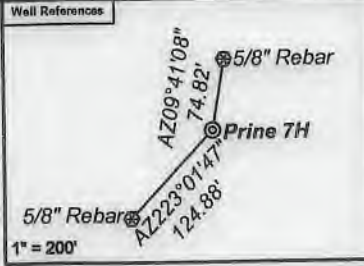

Notes:
 Prine 7H coordinates are
 NAD 27 N: 427,861.56 E: 1,697,732.81
 NAD 27 Lat: 39.669766 Long: -80.573804
 NAD 83 UTM N: 4,391,201.54 E: 536,571.15
 Prine 7H Landing Point coordinates are
 NAD 27 N: 431,298.76 E: 1,695,441.14
 NAD 27 Lat: 39.679127 Long: -80.582091
 NAD 83 UTM N: 4,392,237.04 E: 535,855.51
 Prine 7H Bottom Hole coordinates are
 NAD 27 N: 438,666.46 E: 1,688,073.45
 NAD 27 Lat: 39.699107 Long: -80.608589
 NAD 83 UTM N: 4,394,444.14 E: 533,573.43
 West Virginia Coordinate system of 1927 (North Zone)
 based upon Differential GPS Measurements.
 Plat orientation, corner and well ties are based upon
 the grid north meridian.
 Well location references are based upon the grid north
 meridian.
 UTM coordinates are NAD83, Zone 17, Meters.

Lease No.	Owner	Acres
870415	Howard Henderson, et al.	189
870417	Sherry Lynn Chefred, et al.	108
1044935	Margaret D. Sole, et al.	19.44
1018020	Jack Anderson, et ux., et al.	1.56
870395	Brian R. Morgan, et al.	170
870035	Stone Hill Minerals Holdings, LLC, et al.	150
1017365	Sandra Estes, et al.	81.5 & 12.5 of 288.54
871183	Oakey Ray Long and Joyce Lee Long, et al.	172.5
877781	David & Imogene Wood	44
1043134	Kathleen O'Grady, a/k/a Nancy O'Grady	103.75
1032919	Benjamin Yarber, et ux.	136.595184 of 224
1018012	June M. Morris, et al.	0.10
1018011	Diana Dawn Van Horn, et al.	2.87
1018040	Ronald White, et ux., et al.	5,625/10,000
01-5-21	Susan Miller, et al.	69.25

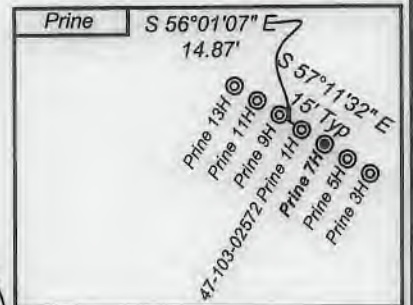
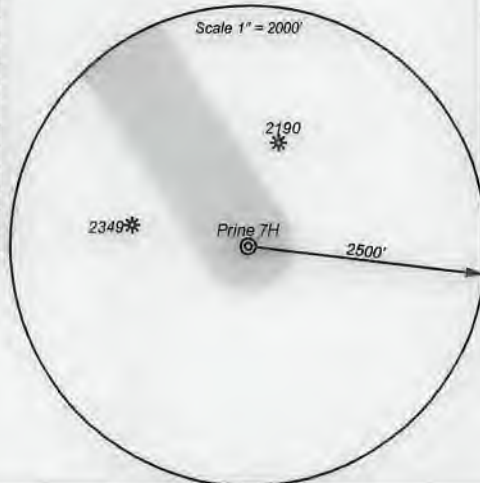

- ⊙ Proposed Gas Well
- Located Corner, as noted
- Surface Tract Lines
- Reference Line
- Lease Boundary
- Creek or Drain
- Ⓢ WV County Route
- Ⓢ WV State Route



I, the undersigned, hereby certify that this plat is correct to the best of my knowledge and belief and shows all the information required by law and the regulations issued and prescribed by the Department of Environmental Protection.

Ben R. Singleton

P.S. 2092



SEAL

FILE NO: 289-16
 DRAWING NO: Prine 7H
 SCALE: 1" = 2000'
 MINIMUM DEGREE OF ACCURACY: 1:2500
 PROVEN SOURCE OF ELEVATION: NGS CORS Station

STATE OF WEST VIRGINIA
 DEPARTMENT OF ENVIRONMENTAL PROTECTION
OIL AND GAS DIVISION

DATE: March 30 20 21
 OPERATOR'S WELL NO.: Prine 7H
 API WELL NO. MND
 47 - 103 - 03357
 STATE COUNTY PERMIT

WELL TYPE: OIL GAS LIQUID INJECTION WASTE DISPOSAL
 (IF GAS) PRODUCTION: STORAGE DEEP SHALLOW
 LOCATION: ELEVATION: 1335' WATERSHED: Tributary of Bear Run QUADRANGLE: Littleton
 DISTRICT: Center COUNTY: Wetzel
 SURFACE OWNER: Howard M. Henderson ACREAGE: 112
 ROYALTY OWNER: Jamie Joe Prine, et al. LEASE NO: 870370 ACREAGE: 111
 PROPOSED WORK: DRILL CONVERT DRILL DEEPER FRACTURE OR STIMULATE PLUG OFF OLD FORMATION
 PERFORATE NEW FORMATION OTHER PHYSICAL CHANGE IN WELL (SPECIFY)
 PLUG AND ABANDON CLEAN OUT AND REPLUG TARGET FORMATION: Marcellus ESTIMATED DEPTH: 7,489'

WELL OPERATOR: EQT Production Company DESIGNATED AGENT: Joseph C. Mallow
 ADDRESS: 400 Woodcliff Drive ADDRESS: 115 Professional Place PO Box 280
 Canonsburg, PA 15317 Bridgeport, WV 26330

04/09/2021