

- Proposed Gas Well
- Located Corner, as noted
- Surface Tract Lines
- Reference Line
- Lease Boundary
- Creek or Drain
- WV County Route
- WV State Route

() Denotes Location of Well on United States Topographic Maps



I, the undersigned, hereby certify that this plat is correct to the best of my knowledge and belief and shows all the information required by law and the regulations issued and prescribed by the Department of Environmental Protection.

Ben R. Singleton
P.S. 2092



FILE NO: 289-16
DRAWING NO: Prine 13H
SCALE: 1" = 2000'
MINIMUM DEGREE OF ACCURACY: 1:2500
PROVEN SOURCE OF ELEVATION: NGS CORS Station

STATE OF WEST VIRGINIA
DEPARTMENT OF ENVIRONMENTAL PROTECTION
OIL AND GAS DIVISION

DATE: April 3 20 20
OPERATOR'S WELL NO.: Prine 13H
API WELL NO. W.A
47 - 103 - 03343
STATE COUNTY PERMIT

WELL TYPE: OIL GAS LIQUID INJECTION WASTE DISPOSAL
(IF GAS) PRODUCTION: STORAGE DEEP SHALLOW
LOCATION: ELEVATION: 1335' WATERSHED Tributary of Bear Run QUADRANGLE: Littleton
DISTRICT: Center COUNTY: Wetzel
SURFACE OWNER: Howard M. Henderson ACREAGE: 112
ROYALTY OWNER: Jamie Joe Prine, et al. LEASE NO: 870370 ACREAGE: 111
PROPOSED WORK: DRILL CONVERT DRILL DEEPER FRACTURE OR STIMULATE PLUG OFF OLD FORMATION
 PERFORATE NEW FORMATION OTHER PHYSICAL CHANGE IN WELL (SPECIFY) _____
 PLUG AND ABANDON CLEAN OUT AND REPLUG TARGET FORMATION: Marcellus ESTIMATED DEPTH: _____

WELL OPERATOR: EQT Production Company DESIGNATED AGENT: Joseph C. Mallow
ADDRESS: 400 Woodcliff Drive ADDRESS: 115 Professional Place PO Box 280
Canonsburg, PA 15317 Bridgeport, WV 26330

**Prine 13H
LIT53
EQT Production Company**

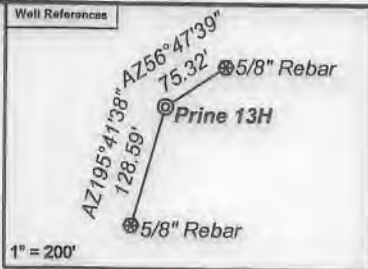

Notes:
 Prine 13H coordinates are
 NAD 27 N: 427,894.07 E: 1,697,662.38
 NAD 27 Lat: 39.669854 Long: -80.573984
 NAD 83 UTM N: 4,391,211.19 E: 536,555.62
 Prine 13H Landing Point coordinates are
 NAD 27 N: 430,802.98 E: 1,700,179.35
 NAD 27 Lat: 39.877921 Long: -80.565237
 NAD 83 UTM N: 4,392,110.15 E: 537,301.60
 Prine 13H Bottom Hole coordinates are
 NAD 27 N: 439,230.63 E: 1,691,751.71
 NAD 27 Lat: 39.700779 Long: -80.595542
 NAD 83 UTM N: 4,394,634.77 E: 534,691.20
 West Virginia Coordinate system of 1927 (North Zone)
 based upon Differential GPS Measurements.
 Plat orientation, corner and well ties are based upon
 the grid north meridian.
 Well location references are based upon the grid north
 meridian.
 UTM coordinates are NAD83, Zone 17, Meters.

Tract I.D.	Tax Map No.	Parcel No.	County	District	Surface Tract Owner	Acres
1	8	43	Wetzel	Center	Howard M. Henderson	112.00
2	8	44	Wetzel	Center	William D. Henderson	65.00
3	8	45	Wetzel	Center	Howard Henderson	5.50
4	8	31.1	Wetzel	Center	Howard Henderson	16.43
5	8	53	Wetzel	Center	Ashley Murphy, et al.	20.38
6	8	31	Wetzel	Center	Howard Henderson	64.76
7	8	28	Wetzel	Center	Howard M. & William D. Henderson	57.00
8	8	28	Wetzel	Center	Matthew J. Rice	108.00
9	8	11	Wetzel	Center	Howard M. Henderson	91.50
10	8	8	Wetzel	Center	Lillian M. Pitzer & Jason L. Wright	57.00
11	8	7	Wetzel	Center	EQT Production Company	150.00
12	8	3.1	Wetzel	Center	Dallport Lumber Inc	15.66
13	8	2	Wetzel	Center	EQT Production Company	72.43
14	5	24	Wetzel	Center	EQT Production Company	12.50
15	8	1	Wetzel	Center	EQT Production Company	81.50
16	5	15	Wetzel	Center	Howard M. Henderson	226.00
17	5	23	Wetzel	Center	Robert Long, et al.	172.50
18	11	9	Wetzel	Center	Howard M. Henderson	10.10
19	11	8	Wetzel	Center	James B. & Margie L. Montgomery	52.00
20	11	6.1	Wetzel	Center	Larry L. & Lois J. Deem	94.50
21	11	8	Wetzel	Center	Ray S. & Timmy R. Sapp	60.50
22	11	6.2	Wetzel	Center	Roger L. & Sandra K. Wade	4.00
23	8	42	Wetzel	Center	Jeffrey R. & Howard M. Henderson	67.00
24	8	55	Wetzel	Center	Ashley Murphy, et al.	9.43
25	8	47	Wetzel	Center	Howard M. Henderson	14.75
26	8	46	Wetzel	Center	Howard M. Henderson	13.20
27	8	52	Wetzel	Center	Ashley Murphy, et al.	3.35
28	8	31	Wetzel	Clay	Howard M. Henderson	8.20
29	8	39	Wetzel	Center	Ashley Murphy, et al.	47.25
30	8	30	Wetzel	Center	Howard M. Henderson	18.00
31	5	56	Wetzel	Clay	Riverside Development Association	61.76
32	8	27	Wetzel	Center	Evan H. & Janet L. Backinger	1.80
33	8	12	Wetzel	Center	Howard Henderson	42.65
34	8	13	Wetzel	Center	Howard M. Henderson	9.50
35	8	14	Wetzel	Center	Howard M. Henderson	9.50
36	8	5	Wetzel	Center	Howard Henderson	56.00
37	8	4	Wetzel	Center	Howard M. Henderson	60.23
38	8	26	Wetzel	Center	Evan H. & Janet L. Backinger	0.25
39	8	25	Wetzel	Center	Evan H. & Janet L. Backinger	0.44
40	8	17	Wetzel	Center	Evan H. & Janet L. Backinger	01.00
41	8	10	Wetzel	Center	Howard M. Henderson	190 x 250
42	8	3	Wetzel	Center	Howard M. Henderson	38.00
43	8	80	Wetzel	Center	James B. Burch	11.00
44	5	3.2	Wetzel	Center	Larry G. & Jana L. Rine	62.40
45	8	6	Wetzel	Center	David Wood	44.00
46	5	26	Wetzel	Center	Howard M. Henderson	125.14
47	5	3.1	Wetzel	Center	Larry G. & Jana L. Rine	68.60
48	5	28	Wetzel	Center	Terry L. Riter	162.00
49	5	16	Wetzel	Center	Jack A. & Laura A. Cartwright	37.80
50	5	8	Wetzel	Center	None	None
51	5	8	Wetzel	Center	William E. & William J. Renner	5.10
52	5	4	Wetzel	Center	William E. Renner	149.54
53	5	14	Wetzel	Center	Benjamin E. Yarber	234.00
54	5	22	Wetzel	Center	Mike Ross Inc	103.75
55	5	2	Wetzel	Center	Susan Miller, et al.	40.00
56	5	13	Wetzel	Center	Susan Miller, et al.	60.00
57	5	21	Wetzel	Center	Susan Miller, et al.	69.25
58	4	52	Wetzel	Center	James L. Musgrave, et al.	127.72
59	8	51	Wetzel	Center	Howard M. Henderson	4.00
60	8	50	Wetzel	Center	Howard M. Henderson	0.75

Lease No.	Owner	Acres
870415	Howard Henderson, et al.	189
870525	Nancy E. Jolliffe	5.5
870424	Nancy E. Jolliffe, et al.	26
871343	Thomas J. Iacoboni, et al.	4.75
1028831	AMP Fund III, LP, et al.	132.6
870431	Mary Kathleen Moore, et al.	52
870258	Glen E. Burnette, Jr., et al.	59
1043253	BRC Minerals, LP & BRC Appalachian Minerals I LLC, et al.	59
870244	Howard Henderson, et al.	91.5
870188	Carol Louise Saunik Eltringham	57
870163	Howard Henderson, et al.	321.79
870524	Green Dot Farm, Inc.	12
1041918	Ronald R. Reiter, et al.	26.89
877947	EQT Production Company, et al.	72
870648	Delorse A. Horner, et al.	226
871183	Oakey Ray Long & Joyce Lee Long, et al.	172.5
1032919	Benjamin Yarber, et ux.	136.595184 of 224

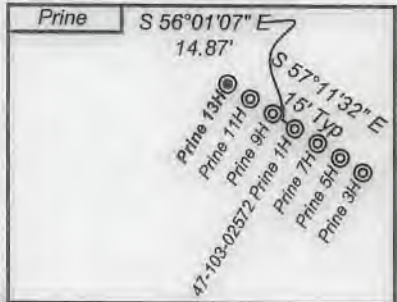
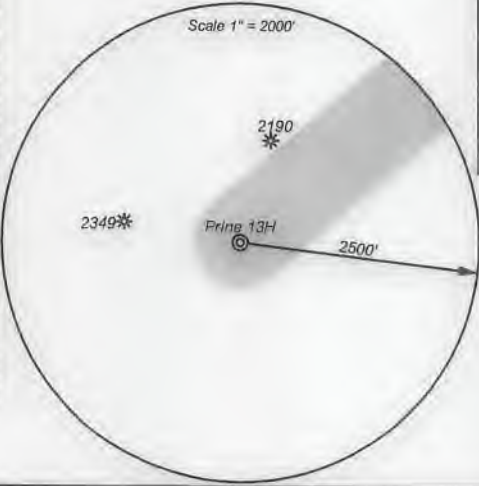

- ⊙ Proposed Gas Well
- Located Corner, as noted
- Surface Tract Lines
- Reference Line
- Lease Boundary
- Creek or Drain
- ⊙ WV County Route
- ⊙ WV State Route



I, the undersigned, hereby certify that this plat is correct to the best of my knowledge and belief and shows all the information required by law and the regulations issued and prescribed by the Department of Environmental Protection.

Ben R. Singleton
 P.S. 2092

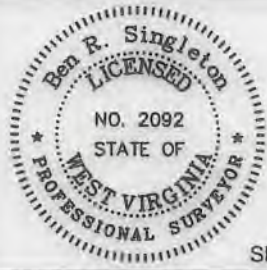

FILE NO: 289-16
 DRAWING NO: Prine 13H
 SCALE: 1" = 2000'
 MINIMUM DEGREE OF ACCURACY: 1:2500
 PROVEN SOURCE OF ELEVATION: NGS CORS Station



DATE: April 3 20 20
 OPERATOR'S WELL NO.: Prine 13H
 API WELL NO: 46A
 47 - 103 - 03343
 STATE COUNTY PERMIT

WELL TYPE: OIL GAS LIQUID INJECTION WASTE DISPOSAL
 (IF GAS) PRODUCTION: STORAGE DEEP SHALLOW
 LOCATION: ELEVATION: 1335' WATERSHED: Tributary of Bear Run QUADRANGLE: Littleton
 DISTRICT: Center COUNTY: Wetzel
 SURFACE OWNER: Howard M. Henderson ACREAGE: 112
 ROYALTY OWNER: Jamie Joe Prine, et al. LEASE NO: 870370 ACREAGE: 111
 PROPOSED WORK: DRILL CONVERT DRILL DEEPER FRACTURE OR STIMULATE PLUG OFF OLD FORMATION
 PERFORATE NEW FORMATION OTHER PHYSICAL CHANGE IN WELL (SPECIFY) _____
 PLUG AND ABANDON CLEAN OUT AND REPLUG TARGET FORMATION: Marcellus ESTIMATED DEPTH: _____

WELL OPERATOR: EQT Production Company DESIGNATED AGENT: Joseph C. Mallow
 ADDRESS: 400 Woodcliff Drive ADDRESS: 115 Professional Place PO Box 280
 Canonsburg, PA 15317 Bridgeport, WV 26330