

Latitude

1.20s
1.64w

Longitude

Topo Location

7.5' Loc. _____ 15' Loc. _____
(calc.) _____

Company Perrus Oil & Gas

Farm S.M. Shriver #1

15' Quad _____
(sec.)

7.5' Quad Hundred

District Church

WELL LOCATION PLAT

County 103 **Permit** 30151

Survey

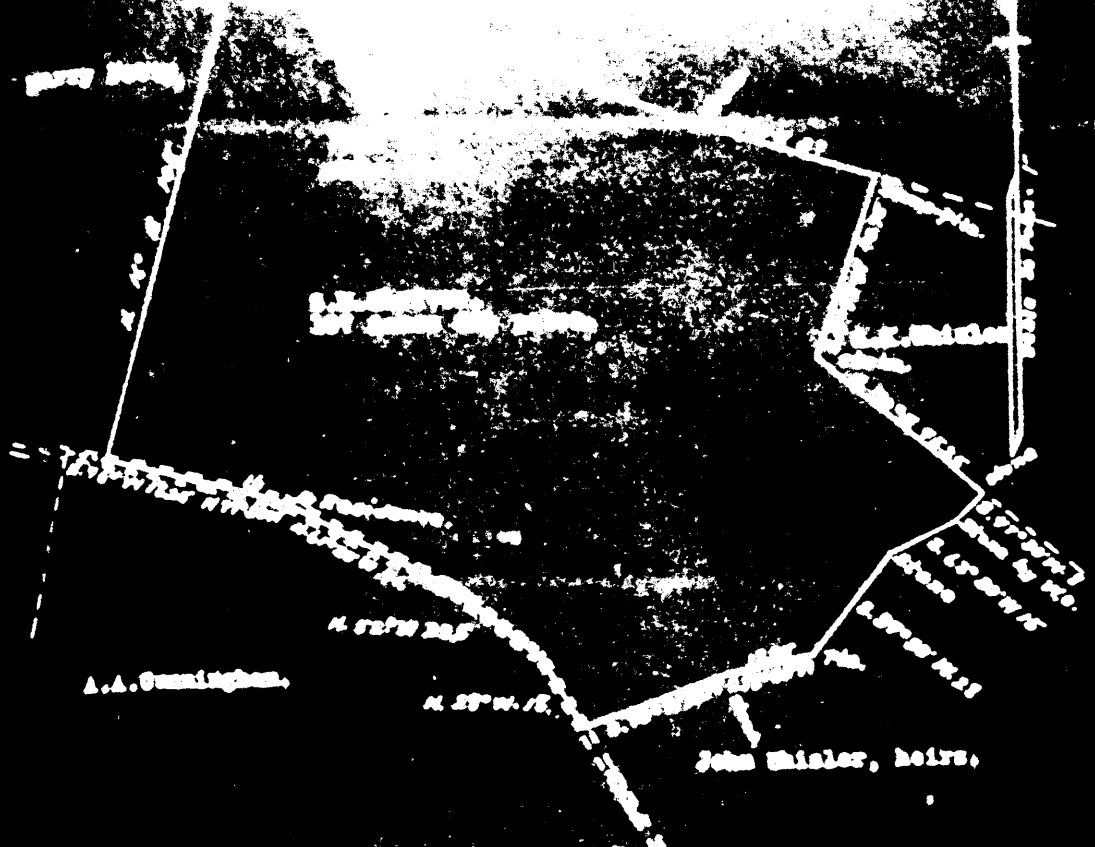

A.A. Cunningham.

John Whisler, heirs.

WITNESS'S CERTIFICATION

I, the undersigned hereby certify that this map is correct and shows all the information to the best of my knowledge and belief, required by the oil and gas section of the Mining Laws of West Virginia.

A. L. Headley
Surveyor, W. Va.

Acknowledged before me a Notary Public, in and for Monongalia County, West Virginia, this 15th day of June, 1936.
My commission expires

Chas. H. Hill

[Signature]

6-15-36

103-151A

Sol M. Shriver No. 1 Well (30G)

Church District, Wetzel Co., W. Va.; on hill northeast of West Virginia Fork of Fish Creek 1.2 miles southeast of Cottontown; completed March 13, 1909; by Pure Oil Co.; elevation, 1445' B.

	Top. Feet.	Bottom. Feet.
Conductor	0	16
Coal, <u>Pittsburgh</u>	1320	1328
Sand, <u>Big Dunkard (Mahoning), Burning Springs (Upper Freeport), and Gas Sand (Lower Freeport)</u>	1795	2040
Sand, <u>Maxton (none)</u>	--	--
Sand, <u>Big Injun (gas, 2573-2584'; water, 2637-2697'; exhausted to 5 or 6 bbl. in 24 hrs.)</u>	2527	2815
Sand, <u>Fifty-foot</u>	3253	3258
Sand, <u>Thirty-foot (oil, 3353-3363')</u>	3337	3365
Total depth		3365

10" casing, 360' (pulled); 8" csg., 1735'; 6 5/8" csg., 2545'.

Shot March 23, 1909, by C.C. Fisher with 30 quarts at 3352-3363'; 9 7/8 feet of shell; no anchor.

Thirty-foot Sand oil well; 5 to 10 bbl.

1930-31
 1931-32
 1932-33

Name	Class	Condition	Water	1930-31	1931-32	1932-33
Phg. Coal	Black	Soft		1280	1328	267
Mg. Injun sand		Hard		2227	2315	266
Gentle		Hard		3253	3258	5 ft.
Gordon Stray		Hard	011 3353	3337	3345	28 ft. 3345

2000
 Well was not drilled at
 2000
 Well was not drilled at
 2000
 Well was not drilled at
 2000
 Well was not drilled at