

- ⊙ Proposed Gas Well
- Located Corner, as noted
- Surface Tract Lines
- - - Reference Line
- Lease Boundary
- Creek or Drain
- Ⓢ WV County Route
- Ⓦ WV State Route

(⊙) Denotes Location of Well on United States Topographic Maps



*I, the undersigned, hereby certify that this plat is correct to the best of my knowledge and belief and shows all the information required by law and the regulations issued and prescribed by the Department of Environmental Protection.*

*Ben B. Stoltz*  
P.S. 2092

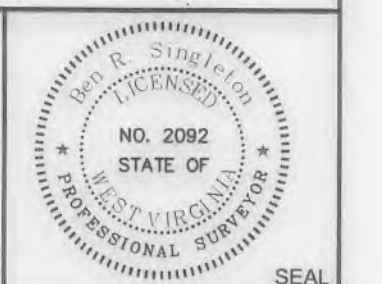

FILE NO: 33-15  
DRAWING NO: 33-15 BIG333H12  
SCALE: 1" = 2000'  
MINIMUM DEGREE OF ACCURACY: 1:2500  
PROVEN SOURCE OF ELEVATION: NGS CORS Station

**STATE OF WEST VIRGINIA**  
DEPARTMENT OF ENVIRONMENTAL PROTECTION  
**OIL AND GAS DIVISION**

DATE: February 19 20 19  
OPERATOR'S WELL NO.: BIG333H12  
API WELL NO  
47 - 103 - 03294  
STATE COUNTY PERMIT

WELL TYPE:  OIL  GAS  LIQUID INJECTION  WASTE DISPOSAL  
(IF GAS) PRODUCTION:  STORAGE  DEEP  SHALLOW  
LOCATION: ELEVATION: As-Built - 1451' WATERSHED Aauty Run of South Fork Fishing Creek QUADRANGLE: Big Run  
DISTRICT: Grant COUNTY: Wetzel  
SURFACE OWNER: Coastal Forest Resources Co., d/b/a Coastal Timberlands Co. ACREAGE: 283.6±  
ROYALTY OWNER: Equitrans, Inc. LEASE NO: 190015 ACREAGE: 285±  
PROPOSED WORK:  DRILL  CONVERT  DRILL DEEPER  FRACTURE OR STIMULATE  PLUG OFF OLD FORMATION  
 PERFORATE NEW FORMATION  OTHER PHYSICAL CHANGE IN WELL (SPECIFY) \_\_\_\_\_  
 PLUG AND ABANDON  CLEAN OUT AND REPLUG TARGET FORMATION: Marcellus ESTIMATED DEPTH: 7,643'

WELL OPERATOR: EQT Production Company DESIGNATED AGENT: Jason Ranson  
ADDRESS: 2400 Ansys Drive, Suite 200 ADDRESS: 115 Professional Place PO Box 280  
Canonsburg, PA 15317 Bridgeport, WV 26330

**BIG333H12**  
**BIG333**  
**EQT Production Company**

Tract I.D.	Tax Map No.	Parcel No.	County	District	Surface Tract Owner	Acres
1	23	13	Wetzel	Grant	Coastal Forest Resources Co.	283.60
2	23	12	Wetzel	Grant	Larry Larew, et al.	104.80
3	23	9	Wetzel	Grant	Larry Larew, et al.	31.50
4	23	4	Wetzel	Grant	Dallison Lumber, Inc.	36.10
5	23	5	Wetzel	Grant	Al Wyatt Hairs	174.68
6	23	14	Wetzel	Grant	Richard B. Dallison, et al.	879.30
7	26	8	Wetzel	Grant	Joseph W. Carlin	112.00
8	26	6	Wetzel	Grant	Joseph W. Carlin	190.74
9	23	11.4	Wetzel	Grant	Richard & Roxanne Funk, et al.	88.21
10	23	8	Wetzel	Grant	Richard & Roxanne Funk, et al.	113.61
11	23	3	Wetzel	Grant	Dallison Lumber, Inc.	15.00
12	23	2	Wetzel	Grant	Billy Dewayne Arnolds, Jr.	38.80
13	17	14	Wetzel	Grant	Coastal Forest Resources Co.	1627.60
14	22	44	Wetzel	Grant	Lydle Martyn & Sharon Irvin	88.15
15	23	7	Wetzel	Grant	Marcus E. & Linda S. Derby	3.19
16	23	7.1	Wetzel	Grant	Dallison Lumber, Inc.	49.65
17	23	6	Wetzel	Grant	Dallison Lumber, Inc.	46.62
18	23	1	Wetzel	Grant	Billy Dewayne Arnolds, Jr.	16.50

**Notes:**  
 BIG333H12 coordinates are  
 NAD 27 N: 375,155.21 E: 1,692,007.92  
 NAD 27 Lat: 39.524882 Long: -80.591864  
 NAD 83 UTM N: 4,375,114.78 E: 535,094.39  
 BIG333H12 Landing Point coordinates are  
 NAD 27 N: 373,529.56 E: 1,689,965.91  
 NAD 27 Lat: 39.520351 Long: -80.599032  
 NAD 83 UTM N: 4,374,609.10 E: 534,480.51  
 BIG333H12 Bottom Hole coordinates are  
 NAD 27 N: 377,722.70 E: 1,692,007.92  
 NAD 27 Lat: 39.531803 Long: -80.605524  
 NAD 83 UTM N: 4,375,877.52 E: 533,916.93  
 West Virginia Coordinate system of 1927 (North Zone)  
 based upon Differential GPS Measurements.  
 Plat orientation, corner and well ties are based upon  
 the grid north meridian.  
 Well location references are based upon the grid north  
 meridian.  
 UTM coordinates are NAD83, Zone 17, Meters.

04/26/2019

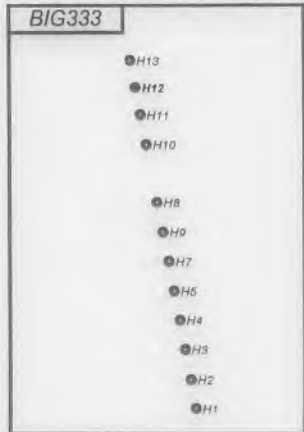

Lease No.	Acres	Owner
991908	104.8	Brian C. Fox, et al.
872882	436	Shiben Estates



- ⊙ Proposed Gas Well
- Located Corner, as noted
- Surface Tract Lines
- Reference Line
- Lease Boundary
- Creek or Drain
- Ⓢ WV County Route
- Ⓢ WV State Route

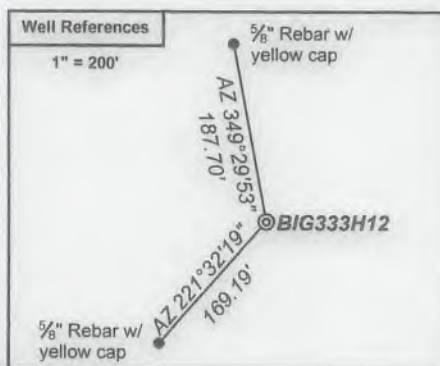

*I, the undersigned, hereby certify that this plat is correct to the best of my knowledge and belief and shows all the information required by law and the regulations issued and prescribed by the Department of Environmental Protection.*

*Ben R. Singleton*  
 P.S. 2092



FILE NO: 33-15  
 DRAWING NO: 33-15 BIG333H12  
 SCALE: 1" = 2000'  
 MINIMUM DEGREE OF ACCURACY: 1:2500  
 PROVEN SOURCE OF ELEVATION: NGS CORS Station



DATE: February 19 20 19  
 OPERATOR'S WELL NO.: BIG333H12  
 API WELL NO  
 47 - 103 - 03294  
 STATE COUNTY PERMIT

WELL TYPE:  OIL  GAS  LIQUID INJECTION  WASTE DISPOSAL  
 (IF GAS) PRODUCTION:  STORAGE  DEEP  SHALLOW  
 LOCATION: ELEVATION: As-Built - 1451' WATERSHED Aunty Run of South Fork Fishing Creek QUADRANGLE: Big Run  
 DISTRICT: Grant COUNTY: Wetzel  
 SURFACE OWNER: Coastal Forest Resources Co., d/b/a Coastal Timberlands Co. ACREAGE: 283.6±  
 ROYALTY OWNER: Equitrans, Inc. LEASE NO: 190015 ACREAGE: 285±  
 PROPOSED WORK:  DRILL  CONVERT  DRILL DEEPER  FRACTURE OR STIMULATE  PLUG OFF OLD FORMATION  
 PERFORATE NEW FORMATION  OTHER PHYSICAL CHANGE IN WELL (SPECIFY) \_\_\_\_\_  
 PLUG AND ABANDON  CLEAN OUT AND REPLUG TARGET FORMATION: Marcellus ESTIMATED DEPTH: 7,643'

WELL OPERATOR: EQT Production Company DESIGNATED AGENT: Jason Ranson  
 ADDRESS: 2400 Ansys Drive, Suite 200 ADDRESS: 115 Professional Place PO Box 280  
Canonsburg, PA 15317 Bridgeport, WV 26330