

Latitude: 39°42'30" ← BOTTOM HOLE 4232'

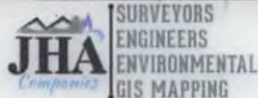

SURVEYORS ENGINEERS ENVIRONMENTAL GIS MAPPING
www.jhacompanies.com
68911 Vineyard Road
St. Clairsville, Ohio 43980
740-895-8188

SURFACE HOLE
Latitude: 39°42'30"

8935'

2197'
BOTTOM HOLE Longitude: -80°42'30"

Longitude: -80°40'00" SURFACE HOLE 7064'

NOTES ON SURVEY

- COORDINATE SYSTEM IS UTM NAD 83 DATUM, ZONE 17, U.S. FOOT AND WELL COORDINATES ESTABLISHED USING SURVEY GRADE GPS.
- SURFACE AND ROYALTY OWNER INFORMATION AND THEIR BOUNDARIES SHOWN HEREON WERE PLOTTED FROM DEEDS AND/OR TAX PARCEL MAPS PROVIDED BY CLIENT AND/OR FIELD LOCATIONS.
- THIS PLAT DOES NOT REPRESENT A BOUNDARY SURVEY OF THE PARCELS SHOWN HEREON.
- NO DWELLINGS OR BUILDINGS WITHIN 825 FEET OF PROPOSED CENTER OF PAD.
- NO PERENNIAL STREAMS, LAKES, PONDS, RESERVOIRS OR WETLANDS WITHIN 100 FEET OF THE LIMITS OF DISTURBANCE.
- NO NATURALLY PRODUCING TROUT STREAM WITHIN 300 FEET OF THE LIMITS OF DISTURBANCE.
- NO WATER WELLS OR DEVELOPED SPRINGS WITHIN 250 FEET OF PROPOSED WELL.

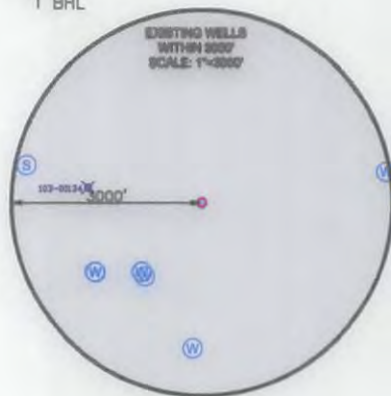

LINE	BEARING	DISTANCE
L1	N 21°11'12" W	1084.72'
L2	S 10°23'29" W	300.72'

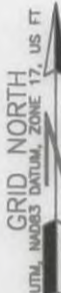

LOCATION	UTM (NAD83, ZONE 17, METERS)
SURFACE HOLE LOCATION (SHL):	NORTHING: 4393243.05 EASTING: 525887.20
LANDING POINT (LPL):	NORTHING: 4393169.68 EASTING: 525591.39
BOTTOM HOLE LOCATION (BHL):	NORTHING: 4394738.40 EASTING: 523723.00

I, THE UNDERSIGNED, HEREBY CERTIFY THAT THIS PLAT IS CORRECT TO THE BEST OF MY KNOWLEDGE AND BELIEF AND SHOWS ALL THE INFORMATION REQUIRED BY LAW AND REGULATIONS ISSUED AND PRESCRIBED BY THE DEPARTMENT OF ENVIRONMENTAL PROTECTION.

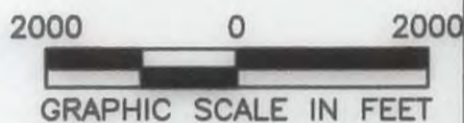

P.S. 891 *RSK 9-14-17*

COMPANY: **SWN** Production Company, LLC

(+) DENOTES LOCATION OF WELL ON UNITED STATES TOPOGRAPHIC MAPS WVDEP OFFICE OF OIL & GAS 601 57TH STREET CHARLESTON, WV 25034	MINIMUM DEGREE OF ACCURACY: 1/200 PROVEN SOURCE OF ELEVATION: SURVEY GRADE GPS (NAVD 88, US FT)	OPERATOR'S WELL #: MARGARET SUE KELLEY WTZ 1H API WELL #: 47 103 03194 STATE COUNTY PERMIT
	WELL TYPE: OIL <input type="checkbox"/> WASTE DISPOSAL <input type="checkbox"/> PRODUCTION <input checked="" type="checkbox"/> DEEP <input type="checkbox"/> GAS <input checked="" type="checkbox"/> LIQUID INJECTION <input type="checkbox"/> STORAGE <input type="checkbox"/> SHALLOW <input checked="" type="checkbox"/>	WATERSHED: FISH CREEK DISTRICT: PROCTOR COUNTY: WETZEL SURFACE OWNER: MARGARET SUE KELLEY OIL & GAS ROYALTY OWNER: BLAKE REALTY, L.L.C.

DRILL <input checked="" type="checkbox"/> DRILL DEEPER <input type="checkbox"/> REDRILL <input type="checkbox"/> FRACTURE OR STIMULATE <input checked="" type="checkbox"/> PLUG OFF OLD FORMATION <input type="checkbox"/> PERFORATE NEW FORMATION <input type="checkbox"/> CONVERT <input type="checkbox"/> PLUG & ABANDON <input type="checkbox"/> CLEAN OUT & REPLUG <input type="checkbox"/> OTHER CHANGE <input type="checkbox"/> (SPECIFY)	TARGET FORMATION: MARCELLUS ESTIMATED DEPTH: 7,171 TVD 15,567 TMD
---	--

WELL OPERATOR: SWN PRODUCTION COMPANY, LLC ADDRESS: P.O. BOX 1300 CITY: JANE LEW STATE: WV ZIP CODE: 26378	DESIGNATED AGENT: DEE SOUTHALL ADDRESS: P.O. BOX 1300 CITY: JANE LEW STATE: WV ZIP CODE: 26378
--	--

LEGEND: ○ PROPOSED SURFACE HOLE / BOTTOM HOLE * EXISTING / PRODUCING WELLHEAD LPL: LANDING POINT LOCATION W EXISTING WATER WELL S EXISTING SPRING	— SURVEYED BOUNDARY - - - DRILLING UNIT = = = LEASE BOUNDARY — PROPOSED PATH	REVISIONS: DATE: 09-14-2017 DRAWN BY: M.SNIDER SCALE: 1" = 2000' DRAWING NO: 2016-622 WELL LOCATION PLAT
---	---	--

JHA
Companies
SURVEYORS
ENGINEERS
ENVIRONMENTAL
GIS MAPPING
www.jhacompanies.com
68011 Vineyard Road
St. Clairsville, Ohio 43950
740-695-6100

MARSHALL CO
WETZEL CO

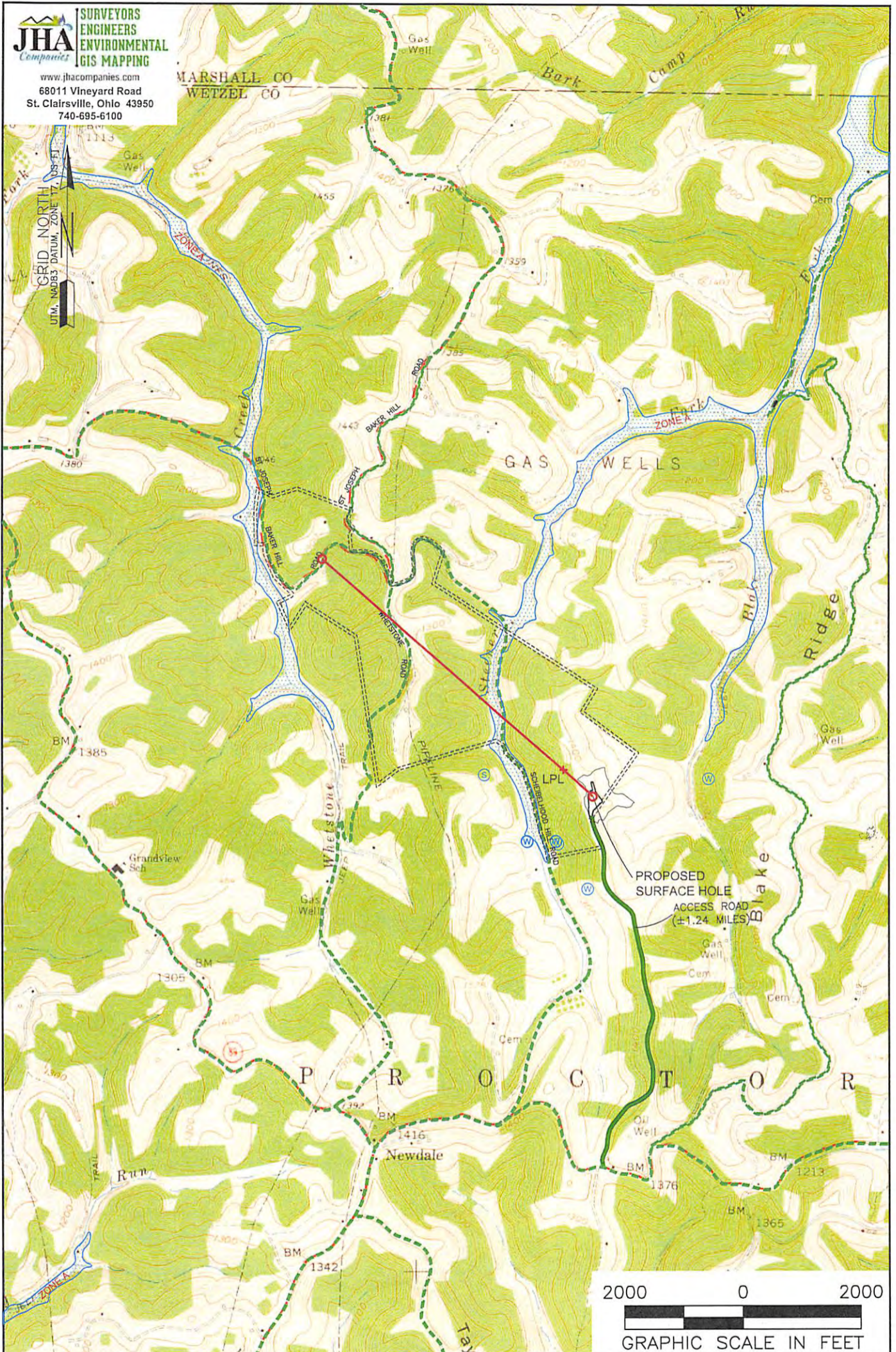

NOTES ON SURVEY

1. SURFACE AND ROYALTY OWNER INFORMATION AND THEIR BOUNDARIES SHOWN HEREON WERE PLOTTED FROM DEEDS AND/OR TAX PARCEL MAPS PROVIDED BY CLIENT AND/OR FIELD LOCATIONS.
2. THIS PLAT DOES NOT REPRESENT A BOUNDARY SURVEY OF THE PARCELS SHOWN HEREON.
4. ALL INSETS ARE GRID NORTH UNLESS OTHERWISE DEPICTED.

LEGEND:

- PROPOSED SURFACE HOLE / BOTTOM HOLE
- ⊗ EXISTING / PRODUCING WELLHEAD
- LPL* LANDING POINT LOCATION
- ⊙ FLOOD PLAIN
- ACCESS ROAD
- - - PUBLIC ROAD
- ACCESS ROAD TO SURFACE HOLE
- ===== LEASE BOUNDARY
- PROPOSED PATH

DATE OF OIL AND GAS WELLS 16 2017

WELL OPERATOR: SWN PRODUCTION COMPANY, LLC	WELL (FARM) NAME: MARGARET SUE KELLEY WTZ	WELL # 3H	SERIAL # XXXX
ADDRESS: P.O. BOX 1300 JANE LEW, WV 26378	COUNTY - CODE WETZEL - 103	DISTRICT; PROCTOR	
SURFACE OWNER: MARGARET SUE KELLEY	USGS 7 1/2 QUADRANGLE MAP NAME WILEVILLE, WV		

10/18/2017