



west virginia department of environmental protection

Office of Oil and Gas
601 57th Street, S.E.
Charleston, WV 25304
(304) 926-0450
fax: (304) 926-0452

Harold D. Ward, Cabinet Secretary
www.dep.wv.gov

Monday, February 7, 2022
WELL WORK PLUGGING PERMIT
Horizontal 6A Plugging

EQT PRODUCTION COMPANY
625 LIBERTY AVE., SUITE 1700
PITTSBURGH, PA 15222

Re: Permit approval for BIG177H2
47-103-03188-00-00

This well work permit is evidence of permission granted to perform the specified well work at the location described on the attached pages and located on the attached plat, subject to the provisions of Chapter 22 of the West Virginia Code of 1931, as amended, and all rules and regulations promulgated thereunder, and to any additional specific conditions and provisions outlined in the pages attached hereto. Notification shall be given by the operator to the Oil and Gas Inspector at least 24 hours prior to the construction of roads, locations, and/or pits for any permitted work. In addition, the well operator shall notify the same inspector 24 hours before any actual well work is commenced and prior to running and cementing casing. Spills or emergency discharges must be promptly reported by the operator to 1-800-642-3074 and to the Oil and Gas Inspector.

Upon completion of the plugging well work, the above named operator will reclaim the site according to the provisions of WV Code 22-6-30. Please be advised that form WR-38, Affidavit of Plugging and Filling Well, is to be submitted to this office within 90 days of completion of permitted well work, as should form WR-34 Discharge Monitoring Report within 30 days of discharge of pits, if applicable. Failure to abide by all statutory and regulatory provisions governing all duties and operations hereunder may result in suspension or revocation of this permit and, in addition, may result in civil and/or criminal penalties being imposed upon the operators.

Per 35 CSR 4-5.2.g this permit will expire in two (2) years from the issue date unless permitted well work is commenced. If there are any questions, please feel free to contact me at (304) 926- 0450.

A blue ink signature of James A. Martin.

James A. Martin
Chief

Operator's Well Number: BIG177H2
Farm Name: COASTAL FOREST RESOURCES
U.S. WELL NUMBER: 47-103-03188-00-00
Horizontal 6A Plugging
Date Issued: 2/7/2022

PERMIT CONDITIONS

West Virginia Code § 22-6-11 allows the Office of Oil and Gas to place specific conditions upon this permit. Permit conditions have the same effect as law. Failure to adhere to the specified permit conditions may result in enforcement action.

CONDITIONS

1. All pits must be lined with a minimum of 20 mil thickness synthetic liner.
2. In the event of an accident or explosion causing loss of life or serious personal injury in or about the well or while working on the well, the well operator or its contractor shall give notice, stating the particulars of the accident or explosion, to the oil and gas inspector and the Chief within twenty-four (24) hours.
3. Well work activities shall not constitute a hazard to the safety of persons.

4710303188P

WW-4B
Rev. 2/01

1) Date September 2, 2021
2) Operator's Well No. BIG177 H2
3) API Well No. 47-103 - 03188

STATE OF WEST VIRGINIA
DEPARTMENT OF ENVIRONMENTAL PROTECTION
OFFICE OF OIL AND GAS

APPLICATION FOR A PERMIT TO PLUG AND ABANDON

4) Well Type: Oil ___ / Gas X / Liquid injection ___ / Waste disposal ___ /
(If "Gas, Production ___ or Underground storage ___) Deep ___ / Shallow X

5) Location: Elevation 806' Watershed Fishing Creek
District Grant County Wetzel Quadrangle Big Run

6) Well Operator EQT Production Company 7) Designated Agent Joseph C. Mallow
Address 400 Woodcliff Drive Address 115 Professional Place
Canonsburg PA 15317 Bridgeport WV 26330

8) Oil and Gas Inspector to be notified Name Bryan Harris
Address PO Box 157
Volga, WV 26238
9) Plugging Contractor Name R&J
Address 1087 Raccoon Road
Hueysville, KY 41640

10) Work Order: The work order for the manner of plugging this well is as follows:
See Attachments for details and procedures.

2/6/22
OK gwm
RECEIVED
Office of Oil and Gas
SEP 13 2021
WV Department of
Environmental Protection

Notification must be given to the district oil and gas inspector 24 hours before permitted work can commence.

Work order approved by inspector Bryan Harris Date 9/8/21

02/11/2022

BIG177 2H
 Wetzel Co., WV
 HZ Marcellus well
 API # 47-103-03188-00
 BY: Tyler Mizgorski
 DATE: 8/19/2021

CURRENT STATUS:

Elevation @ 811'
 26" conductor @ 80' Cemented to Surface
 13 3/8" casing @ 768' Cemented to Surface
 9 5/8" casing @ 2,730' Cemented to Surface
 5 1/2" casing @ 17530' Calculated Cement top of 705'

Well not completed

Fresh water @ 185', 295', 495', 621'
 Coal Show @ 115', 168', 446', 510'
 Salt Water @ 1150', 1157', 1465'
 Gas Show @ None Reported
 Oil Show @ None Reported

- 1) Notify Inspector **Bryan Harris**, (304) 553-6087, Brvan.O.Harris@wv.gov, 24 hours prior to commencing operations.
- 2) Check and record pressure on all casings, notify Engineer of recorded pressures.
- 3) Install 10k wireline BOP. Test BOP's and stack to regs. P/U install 10k lubricator. (Call 8hrs before, will need crane truck)
- 4) Equalize lubricator, if necessary and RIH w/ gauge ring to 9,472 and set a CIBP @9,452' MD above the Marcellus TVD. Do not set plug in collar. If unable to get to set depth, EQT office will call DEP to discuss options.
- 5) Hook up pump truck and pressure test lines to 8000 psi. (Call pump truck 8hrs before)
- 6) POOH w/ wireline and load well with 6% gel if not full. Perform CIT with pump truck to 2000 psi. Ensure leak-off is not more than 10% in thirty minutes per regulation.
- 7) RIH and set second CIBP 10' above the first @9,442' MD
- 8) POOH w/ wireline and load well with 6% gel if not full. Perform CIT with pump truck to 2000 psi. Ensure leak-off is not more than 10% in thirty minutes per regulation.
- 9) RIH with Renegade segmented bond log and pull log from CIBP to surface
- 10) TIH with tubing to CIBP.
- 11) Pump 1500' Class A cement plug, 9442' to 7942' Pump 500' of cement and pull 500' of tubing 2 times. Pump last 500' section and pull tubing 700' and reverse circulate with fresh water if need be.
- 12) Let cement dry for 8 hours Tag up on cement. If cement top is at 5,368' or close POOH with tubing to 2900'
- 13) Set a 300' CIA cement plug 2900' to 2600'. TOOH 300' Reverse circulate full hole volume. TOOH 300' (Safety Plug)
- 14) Let cement dry for 8 hours. Tag up on cement. If cement top is at 2600' or close POOH with tubing
- 15) Free Point 5 1/2" casing. Cut Casing @freepoint ~705' using jet cutter. Estimated freepoint @705. TOOH 5 1/2" Casing.
- 16) Set a 850' CIA Cement plug 150'in/700' out of casing cut 850' to Surface
- 17) Let cement dry for 8 hours.
- 18) Set Monument above ground to WV-DEP Specifications

OK
 J. W. M.

RECEIVED
 Office of Oil and Gas

FEB 1 2022

WV Department of
 Environmental Protection

02/11/2022

4710303188

Well Operator's Report of Well Work



Where energy meets innovation.

Well Number: BIG177H2 (511408)

API: 47 - 103 - 03188

Submission: Initial Amended

Notes:

RECEIVED
Office of Oil and Gas

SEP 13 2021

WV Department of
Environmental Protection

02/11/2022

State of West Virginia
Department of Environmental Protection - Office of Oil and Gas
Well Operator's Report of Well Work

RECEIVED
Office of Oil and Gas

SEP 13 2021

WV Department of
Environmental Protection

API 47 - 103 - 03188 County WETZEL District GRANT
 Quad BIG RUN Pad Name BIG177 Field/Pool Name N/A
 Farm name COASTAL FOREST RESOURCES CO. d/b/a COASTAL TIMBERLANDS CO. Well Number BIG177H2 (511408)
 Operator (as registered with the OOG) EQT Production Company
 Address 625 LIBERTY AVENUE, SUITE 1700 City PITTSBURGH State PA Zip 15222

As Drilled location NAD 83/UTM Attach an as-drilled plat, profile view, and deviation survey
 Top hole Northing 4,381,511.069 Easting 535,727.877
 Landing Point of Curve Northing 4,381,847.171 Easting 534,551.542
 Bottom Hole Northing 4,383,953.092 Easting 533,377.871

Elevation (ft) 811' GL Type of Well New Existing Type of Report Interim Final
 Permit Type Deviated Horizontal Horizontal 6A Vertical Depth Type Deep Shallow
 Type of Operation Convert Deepen Drill Plug Back Redrilling Rework Stimulate
 Well Type Brine Disposal CBM Gas Oil Secondary Recovery Solution Mining Storage Other _____
 Type of Completion Single Multiple Fluids Produced Brine Gas NGL Oil Other _____
 Drilled with Cable Rotary

Drilling Media Surface hole Air Mud Fresh Water Intermediate hole Air Mud Fresh Water Brine
 Production hole Air Mud Fresh Water Brine

Mud Type(s) and Additive(s) Synthetic Based Mud 12.3 ppg, barium sulfate, salt, lime, organophilic clay, gibsonite, anionic emulsifier, polyamide emulsifier, organic polymeric viscosifier, oil soluble sulfonated surfactant, surfactant, thinner, calcium carbonate, wianut shells, cellulose, blend of deformable latex polymers

Date permit issued 08/29/2017 Date drilling commenced 12/20/2018 Date drilling ceased 6/09/2019
 Date completion activities began _____ Date completion activities ceased _____
 Verbal plugging (Y/N) N Date permission granted N/A Granted by N/A

Please note: Operator is required to submit a plugging application within 5 days of verbal permission to plug

Freshwater depth(s) ft 185,295,495,621 Open mine(s) (Y/N) depths N
 Salt water depth(s) ft 1150,1157,1465 Void(s) encountered (Y/N) depths N
 Coal depth(s) ft 115,168,446, 510 Cavern(s) encountered (Y/N) depths N
 Is coal being mined in area (Y/N) N

Reviewed by:
02/11/2022

API 47-103 - 03188 Farm name COASTAL FOREST RESOURCES CO. d/b/a COASTAL TIMBERLANDS CO. Well number BIG177H2 (511408)

CASING STRINGS	Hole Size	Casing Size	Depth	New or Used	Grade wt/ft	Basket Depth(s)	Did cement circulate (Y/N) * Provide details below*
Conductor	30"	26"	80'	NEW	A-500 85.6#	N/A	Y
Surface	17-1/2"	13-3/8"	768'	NEW	J-55 54.5#	474'	Y
Coal							
Intermediate 1	12-3/8"	9-5/8"	2730'	NEW	A-500 40#	N/A	Y
Intermediate 2							
Intermediate 3							
Production	8-3/4" & 8-1/2"	5 1/2"	17530	NEW	HPP-110 20#	N/A	N
Tubing							
Packer type and depth set							

Comment Details Production Cement job has calculated TOC of 705' MD, which is greater than 500' TVD above the producing formation. No issues during cement job.

CEMENT DATA	Class/Type of Cement	Number of Sacks	Slurry wt (ppg)	Yield (ft ³ /sks)	Volume (ft ³)	Cement Top (MD)	WOC (hrs)
Conductor	CLASS A	166	15.6	1.18	196	0	8+
Surface	CLASS A	780	16.0	1.13	881	0	8
Coal							
Intermediate 1	CLASS H	1166	16.8	1.02	1189	0	8
Intermediate 2							
Intermediate 3							
Production	CLASS A	3625	15.2	1.09	3951	705	8+
Tubing							

Drillers TD (ft) 17543 ' MD Loggers TD (ft) N/A
 Deepest formation penetrated MARCELLUS Plug back to (ft) N/A
 Plug back procedure N/A

RECEIVED
Office of Oil and Gas

SEP 13 2021

Kick off depth (ft) 4942' MD

WV Department of Environmental Protection

Check all wireline logs run caliper density deviated/directional induction
 neutron resistivity gamma ray temperature sonic

Well cored Yes No Conventional Sidewall Were cuttings collected Yes No

DESCRIBE THE CENTRALIZER PLACEMENT USED FOR EACH CASING STRING CONDUCTOR: NONE

SURFACE: ON SHOE TRACK AND EVERY 500' FEET TO SURFACE

INTERMEDIATE: ON SHOE TRACK AND EVERY 500' FEET TO SURFACE

PRODUCTION: ON SHOE TRACK AND EVERY JOINT TO 2157'

WAS WELL COMPLETED AS SHOT HOLE Yes No DETAILS _____

WAS WELL COMPLETED OPEN HOLE? Yes No DETAILS _____

WERE TRACERS USED Yes No TYPE OF TRACER(S) USED _____

02/11/2022

API 47- 103 - 03188

COASTAL FOREST RESOURCES CO. d/b/a COASTAL TIMBERLANDS CO.

Farm name _____

Well number BIG177H2 (511408)

PERFORATION RECORD

Stage No.	Perforation date	Perforated from MD ft.	Perforated to MD ft.	Number of Perforations	Formation(s)

Please insert additional pages as applicable.

STIMULATION INFORMATION PER STAGE

Complete a separate record for each stimulation stage.

Stage No.	Stimulations Date	Ave Pump Rate (BPM)	Ave Treatment Pressure (PSI)	Max Breakdown Pressure (PSI)	ISIP (PSI)	Amount of Proppant (lbs)	Amount of Water (bbls)	Amount of Nitrogen/other (units)

RECEIVED
Office of Oil and Gas
SEP 13 2021

WV Department of
Environmental Protection

Please insert additional pages as applicable.

02/11/2022

4710303188

RECEIVED
Office of Oil and Gas
SEP 13 2021
Department of
Environmental Protection

API # 47-103-03188 Final Formations Well # BIG177H2 (511408)				
Formation Name	Drill Top MD (ftKB)	Drill Top (TVD) (ftKB)	Drill Btm MD (ftKB)	Drill Btm (TVD) (ftKB)
SAND/SHALE	1	1	115	115
COAL	115	115	118	118
SAND/SHALE	118	118	168	168
WAYNESBURG	168	168	172	172
SAND/SHALE	172	172	446	446
MAPLETOWN	446	446	450	450
SAND/SHALE	450	450	510	510
PITTSBURGH	510	510	516	516
SAND/SHALE	516	516	1707	1707
MAXTON	1707	1707	1751	1751
SAND/SHALE	1751	1751	1823	1823
BIG LIME	1823	1823	1876	1876
SAND/SHALE	1876	1876	2205	2205
WEIR	2205	2205	2233	2233
SAND/SHALE	2233	2233	2379	2379
GANTZ	2379	2379	2417	2417
SAND/SHALE	2417	2417	2530	2530
FIFTY FOOT	2530	2530	2575	2575
SAND/SHALE	2575	2575	2601	2601
THIRTY FOOT	2601	2601	2635	2635
SAND/SHALE	2635	2635	2648	2648
GORDON	2648	2648	2693	2693
SAND/SHALE	2693	2693	2735	2735
FORTH SAND	2735	2735	2746	2746
SAND/SHALE	2746	2746	2787	2787
BAYARD	2787	2787	2860	2860
SAND/SHALE	2860	2860	3244	3244
WARREN	3244	3244	3290	3290
SAND/SHALE	3290	3290	3394	3394
SPEECHLEY	3394	3394	3408	3408
SAND/SHALE	3408	3408	3783	3783
BALLTOWN A	3783	3783	3800	3800
SAND/SHALE	3800	3800	4243	4243
RILEY	4243	4243	4256	4256
SAND/SHALE	4256	4256	4895	4885
BENSON	4895	4885	4934	4922
SAND/SHALE	4934	4922	5196	5156
ALEXANDER	5196	5156	5222	5178
SAND/SHALE	5222	5178	5640	5485
ELKS	5640	5485	8172	6405
SONYEA	8172	6405	8614	6556
MIDDLESEX	8614	6556	8757	6606
GENESEE	8757	6606	8999	6690
GENESEO	8999	6690	9063	6712
TULLY	9063	6712	9125	6733
HAMILTON	9125	6733	9472	6823
MARCELLUS	9472	6823	17543	6902

02/11/2022

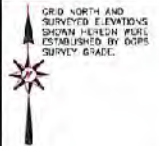

BIG-177 PAD AS-BUILT

PERMITTED WELLS: API# 47-103-02884, 47-103-03117, 47-103-03057, & 47-103-03058
PROPOSED WELLS: BIG177H2, BIG177H5, BIG177H6, BIG177H7, BIG177H8, BIG177H9, & BIG177H15.

**WVDEP OOG
ACCEPTED AS-BUILT**
8/28/2017

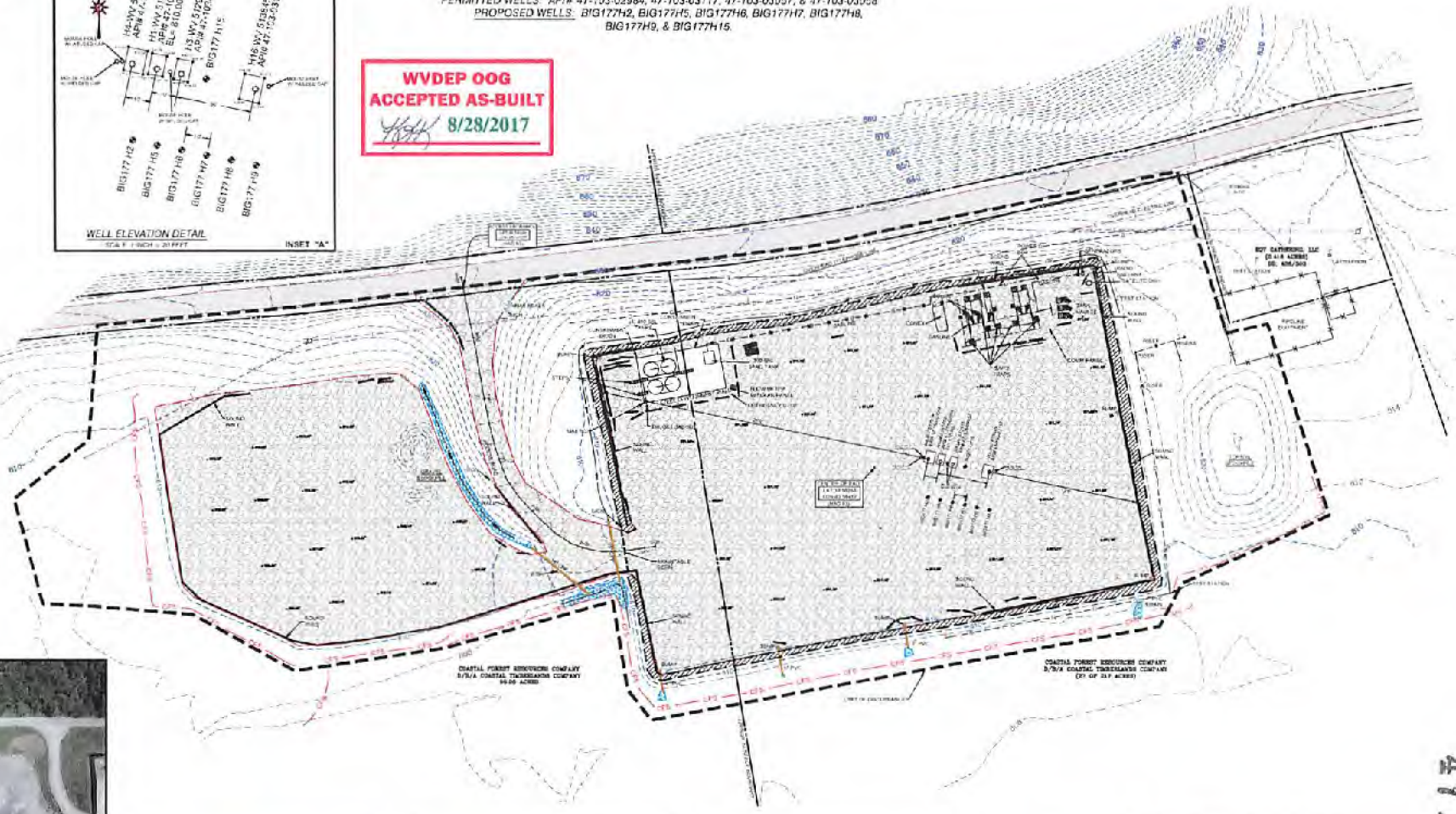

LEGEND

- LIMIT OF DISTURBANCE
- ADJACENT PROPERTY
- FENCE
- EDGE OF CHANNEL
- ELEVATION OR OTHER DIMENSIONS NOTED
- TOP SOIL
- CONTAMINATED SOIL
- GRAVEL
- ASPHALT PAVEMENT
- DRIVE LOCATIONS
- CONDUIT ROUTING
- 8" WATER
- CONDUIT FOR FIBER OPTIC

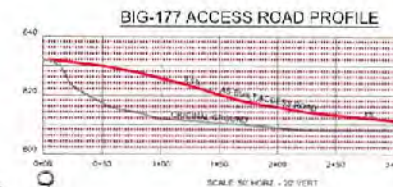

4710303188

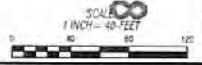

REVISION	DATE	DESCRIPTION
1	3/27/17	UPDATE PERMITTED CHECK
2	3/27/17	UPDATE PERMITTED CHECK
3	8/02/17	UPDATE PERMITTED CHECK
4	7/02/17	UPDATE PERMITTED CHECK
5	8/15/17	ADDED MULTIPLE



**BIG-177 WELL PAD
AS-BUILT SITE PLAN**

DATE: 3/29/17
SCALE: 1"=40'
DRAWN BY: WAW
FILE NO: 4864
SHEET: 3 OF 8

RECEIVED
Office of Oil and Gas
SEP 13 2021
WV Department of
Natural Protection

WVDEP OOG
 ACCEPTED AS-BUILT
 8/28/2017

Temporary Seedings

a. General Conditions Where Practices Apply
 Where exposed soil surfaces are not to be fine-graded or worked for periods longer than 21 days, temporary vegetative cover with sediment controls must be established where runoff will go directly into a stream. Immediately upon construction of the site (site includes road and location), vegetation must be established on road bank and location slopes. A permanent vegetative cover shall be applied to areas that will be left un-worked for a period of more than six months.

b. Seed Mixtures and Planting Dates
 Refer to Tables 2 through 4 for recommended dates to establish vegetative cover and the approved lists of temporary and permanent plant species and planting rates. Table 3 gives recommended types of temporary vegetation, rates of application, and optimum seeding dates. In situations where another cover is desired, consult the local soil conservation district for seeding recommendations.

c. Seed Application
 Apply seed by broadcasting, drilling, or by hydrosed according to the rates indicated in Table 3. Perform all planting operations at right angles to the slope. Necessary site preparation and roughening of the soil surface should be done just prior to seeding. Seeded preparation may not be required on newly disturbed areas.

Permanent Seedings

a. General
 Permanent vegetative cover will be established where no further soil disturbance is anticipated or needed. Soil fertility and pH level should be tested and adjusted according to seed species planted. Handling of permanent vegetative covers must be performed on all disturbed areas after completion of the drilling process. Any site that contains significant amounts of topsoil shall have the topsoil removed and stockpiled when feasible. Topsoil should not be added to slopes steeper than 2:1 unless a good bonding to the sub-layer can be achieved. After proper grading and seedbed preparation, the vegetation will reestablish ground cover for the control of surface water runoff erosion.
 All required seedbed preparation and loosening of soil by disking or other breaking should be performed just prior to seeding. If seedbed preparation is not feasible, 50% more seed shall be added to the recommended rates shown in Tables IV-3 and IV-4.
 When hydroseding, seedbed preparation may not be necessary if adequate site preparation was performed. Incorporate the appropriate amount of lime and/or fertilizer in the slurry mix when hydroseding.

When hydroseding, first mix the lime, fertilizer, and hydro-mulch in the recommended amount of water. Mix the seed and inoculant together within one hour prior to planting, and add to the slurry just before seeding. Apply the slurry uniformly over the prepared site. Assure that application is continuous throughout the seeding operation and the mix is applied within one hour of initial mixing.

b. Lime and Fertilizer
 1. Lime shall be applied to all permanent seedings. The pH of the soil is to be determined and lime applied accordingly. Once the pH is known, select the amount of lime to be applied from Table IV-4.
 2. Fertilizer shall be applied in all permanent seedings. Apply the equivalent of 500 lbs. minimum 10-10-20 fertilizer per acre or use the amount of fertilizer and lime recommended by a certified soil test.
 3. Application for best results and maximum benefits, the lime and fertilizer are to be applied at the time of seedbed preparation.

c. Permanent Seed Mixtures
 Planners should take into consideration the species makeup of the existing pasture and the landowner's future pasture management plans when recommending seed mixtures. Selections from Tables IV-4a and b Permanent Seeding Mixtures Suitable for Establishment in West Virginia.

Notes:
 1. All legumes must be planted with the proper inoculants prior to seeding.
 2. Lactuca Platanis is potentially poisonous to some livestock.
 3. Daily endophyte free varieties of Tall Fescue should be used. Tall Fescue and Crownvetch are also very invasive species non-native to WV.
 4. For unprepared seedbeds or seeding outside the optimum timeframes add 50% more seed to the specified rate. Mixtures in Table 4b are more wildlife and farm friendly. Mixtures listed in bold are suitable for use in shaded woodland settings. Mixtures in italic are suitable for use in filter strips.

d. Seeding for Wildlife Habitat
 Consider the use of the native plants or locally adapted plants when selecting cover types and species for wildlife habitat. Wildlife friendly species or mixes that have multiple values should be considered. The wild life friendly species/mixtures in Table IV-4b. Consider seeding no or low maintenance long-lived plants adaptable to sites which may be difficult to maintain with equipment.

Mulching

a. General Organic Mulches
 The application of straw, hay or other suitable materials to the soil surface to prevent erosion, drive made from wheat or oats is the preferred mulch, the use of hay is permissible, but not encouraged due to the risk of spreading invasive species. Mulch must be applied to all temporary and permanent seedings on all disturbed areas. Depending on site conditions, in critical areas such as waterways or steep slopes, additional or substitute soil protection measures may be used if deemed necessary. Examples include jute mesh and soil stabilization blankets or erosion control matting.
 Areas that have been temporarily or permanently seeded should be mulched immediately following seeding. Mulches conserve desirable soil properties, reduce soil moisture loss, prevent eroding and sealing of the soil surface and provide a suitable microclimate for seed germination.
 Areas that cannot be seeded because of the erosion should be mulched to provide some protection to the soil surface. An organic mulch, straw or hay should be used and the area then seeded as soon as weather or seasonal conditions permit. Do not use flax mulch (cellulose hydrosed) alone for this practice, at normal application rates it will not give the soil protection of other types of mulch.
 Wood cellulose fiber mulch is used in hydroseding operations and applied as part of the slurry. It creates the best seed-soil contact when applied over the top of less a separate operation newly seeded areas. Fiber mulch does not alone provide sufficient protection on highly erodible soils or during less than favorable growing conditions. Fiber mulch should not be used alone during the dry summer months or when used for late fall mulch cover. Use straw mulch during these periods and fiber mulch may be used in leak (leacher) the straw mulch. Fiber mulch is well suited for steep slopes, critical areas and areas susceptible to wind.

b. Chemical Mulches, Soil Binders and Fertilizers
 A wide range of synthetic spray on materials are marketed to stabilize and protect the soil surface. These are mixed with water and sprayed over the mulch and to the soil. They may be used alone in some cases as temporary stabilizers, or in conjunction with fiber mulch, straw or hay.
 When used alone most chemical mulches do not have the capability to insulate the soil or retain soil moisture that organic mulches have.

c. Specifications
 From Table IV-1 select the type of mulch and rate of application that will best suit the conditions at the site.

d. Anchoring
 Depending on the field situation, mulch may not stay in place because of wind action or rapid water runoff. In such cases, mulch is to be anchored mechanically or with mulch nesting.
 1. Mechanical Anchoring
 Apply mulch and pull mulch anchoring tool over the mulch. When a disk is used set the disk straight and pull across slope.
 2. Mulch nesting
 Follow manufacturer's recommendation when positioning and staking the scratch nesting in the soil.

Table IV-1 Recommended Seeding Dates

Planting Dates	Suitability
March 1 - April 15 and August 1 - October 1	Best Seeding Periods
April 15 - August 1	HIGH RISK - moderate stress likely
October 1 - December 1	HIGH RISK - heavy damage to young seedlings
December 1 - March 1	Good seeding period. Dormant seeding

Table 2 Acceptable Fertilization Recommendation

Species	N (lb/acre)	P2O5 (lb/acre)	Example Rec. (lb/acre)
Cool Season Grass	40	80	400 lbs. 10-20-20
Warm Season Legume	30	60	300 lbs. 10-20-20
Temporary Cover	40	80	200 lbs. 15-15-15

Table 3 Temporary Cover

Species	Seeding Rate (lb/acre)	Optimum Seeding Dates	Drainage	pH Range
Annual Ryegrass	40	2/1 - 6/15 or 8/15 - 3/15	Well - Poorly	5.5 - 7.5
Red Fescue	40	3/1 - 6/15 or 8/15 - 3/15	Well - Mod. Well	6.0 - 7.0
Spring Dallis	36	3/1 - 6/15	Well - Poorly	5.5 - 7.0
Summergrass	40	5/15 - 8/15	Well - Poorly	5.5 - 7.5
Winter Rye	168	8/15 - 10/15	Well - Poorly	5.5 - 7.5
Winter Wheat	180	8/15 - 10/15	Well - Mod. Well	5.5 - 7.0
Japanese Millet	30	8/15 - 8/15	Well	4.5 - 7.0
Wheat	3	3/1 - 6/15	Well	4.0 - 7.5
Annual Ryegrass	28	3/1 - 6/15	Well - Poorly	5.5 - 7.5
Spring Dallis	34	3/1 - 6/15	Well - Poorly	5.5 - 7.5

Note: These rates should be increased by 50% if planted April 15 - August 1 and October 1 - March 1.

Table 4a Permanent Seeding Mixtures

Species/Mixture	Seeding Rate (lb/acre)	Soil Drainage preference	pH Range
Crownvetch / Tall Fescue	10 - 15	Well - Mod. Well	5.0 - 7.5
Crownvetch / Perennial Ryegrass	20	Well - Mod. Well	5.0 - 7.5
Fescue or Perennial Poa / Tall Fescue	15	Well - Mod. Well	4.0 - 8.0
Ladino Clover / Sericea lespedeza / Tall Fescue	25	Well - Mod. Well	4.5 - 7.5
Tall Fescue / Endless Blazer / Redtop	40	Well - Mod. Well	5.0 - 7.5
Crownvetch / Tall Fescue / Redtop	30	Well - Mod. Well	5.0 - 7.5
Tall Fescue / Redtop	40	Well - Mod. Well	5.0 - 7.5
Tall Fescue / Sericea lespedeza / Redtop	25	Well - Mod. Well	4.5 - 7.5
Tall Fescue / Redtop	40	Well - Mod. Well	5.0 - 7.5
Tall Fescue / Creeping Red Fescue	50	Well - Poorly	4.5 - 7.5
Perennial Ryegrass / Tall Fescue / Ladino Pasture*	15	Well - Poorly	5.8 - 8.0

* Lactuca Platanis is potentially poisonous to some livestock. All legumes should be planted with proper inoculants prior to seeding. For unprepared seedbeds or seeding outside the optimum time frame, add 50% more seed to the specified rate. Mixtures listed in bold are suitable for use in shaded woodland settings; those in italics are suitable for use in filter strips.

Table 4b Wildlife and Farm Friendly Seed Mixtures

Species/Mixture	Seeding Rate (lb/acre)	Soil Drainage preference	pH Range
KT Blugrass / Redtop	20	Well - Mod. Well	5.5 - 7.5
Ladino Clover or Birdsfoot Trefoil / Timothy / Alfalfa	2 / 10	Well - Mod. Well	6.0 - 8.0
Timothy / Birdsfoot Trefoil	5	Well - Poorly	6.5 - 7.5
Orchardgrass / Ladino Clover / Redtop	20	Well - Mod. Well	5.5 - 7.5
Orchardgrass / Ladino Clover	20	Well - Mod. Well	5.5 - 7.5
Orchardgrass / Perennial Ryegrass	20	Well - Mod. Well	5.5 - 7.5
Creeping Red Fescue / Perennial Ryegrass	10	Well - Mod. Well	5.5 - 7.5
Orchardgrass or KT Blugrass / Birdsfoot Trefoil / Redtop	20	Well - Mod. Well	5.5 - 7.5
Orchardgrass / Ladino Pasture / Perennial Ryegrass / Ladino Pasture*	20	Well - Mod. Well	5.5 - 7.5
Orchardgrass	20	Well - Mod. Well	5.5 - 7.5

* Lactuca Platanis is potentially poisonous to some livestock. All legumes should be planted with proper inoculants prior to seeding. For unprepared seedbeds or seeding outside the optimum time frame, add 50% more seed to the specified rate. Mixtures listed in bold are suitable for use in shaded woodland settings; those in italics are suitable for use in filter strips.

Table IV-5 Lime and Fertilizer Application Table

pH of Soil	Lime in Tons per Acre	Fertilizer, lbs. per Acre (16-20-20 or Equivalent)
Acidic 5.0	1	500
5.0 to 6.0	1	500
Below 5.0	4	500

The pH can be determined with a portable pH testing kit or by sending the soil samples to a soil testing laboratory. When 4 tons of lime per acre are applied it must be incorporated into the soil by disking, backblowing or trucking and over the soil slope.

Table IV-6 Mulch Materials Rates and Uses

Material	Minimum Rates per acre	Coverage	Remarks
Hay or Straw	3 to 5 Tons	Cover 75% to 95% of Surface	Subject to wind blowing or washing unless tied down
Wood Fiber	100 to 150 bales	Cover all	For hydroseding
Pulp Fiber	1000 to 1500 lbs	Disturbed Areas	Cover all
Wood / Cellulose			
Recirculated Paper			

Table IV-6 taken from Natural Resources Conservation Service Manual Critical Area Planting

4710303188

RECEIVED
 Office of Oil and Gas
 SEP 13 2021
 WV Department of
 Environmental Protection

DESCRIPTION DATE REGION

EQT
 Where energy means innovation.

SLS
 Land & Energy Performance
 Certified for the future.

THIS DOCUMENT WAS
 PREPARED BY
 THE LAND AND
 DEVELOPMENT
 FOR EQT

**BIG-177
 CONSTRUCTION DETAILS**

DATE: 3/29/17
 SCALE: NOT TO SCALE
 DRAWN BY: MAR
 FILE NO. 6006
 SHEET 8 OF 8

WW-4A
Revised 6-07

1) Date: September 2, 2021
 2) Operator's Well Number _____
 3) API Well No.: 47 - 103 - 03188

**STATE OF WEST VIRGINIA
 DEPARTMENT OF ENVIRONMENTAL PROTECTION, OFFICE OF OIL AND GAS
 NOTICE OF APPLICATION TO PLUG AND ABANDON A WELL**

4) Surface Owner(s) to be served: (a) Name <u>See attached</u> Address _____ (b) Name _____ Address _____ (c) Name _____ Address _____	5) (a) Coal Operator Name _____ Address _____ (b) Coal Owner(s) with Declaration Name <u>See attached</u> Address _____ (c) Coal Lessee with Declaration Name _____ Address _____
6) Inspector <u>Bryan Harris</u> Address <u>PO Box 157</u> <u>Volga, WV 26238</u> Telephone <u>304-593-6087</u>	

TO THE PERSONS NAMED ABOVE: You should have received this Form and the following documents:

- (1) The application to Plug and Abandon a Well on Form WW-4B, which sets out the parties involved in the work and describes the well its and the plugging work order; and
- (2) The plat (surveyor's map) showing the well location on Form WW-6.

The reason you received these documents is that you have rights regarding the application which are summarized in the instructions on the reverse side. However, you are not required to take any action at all.

Take notice that under Chapter 22-6 of the West Virginia Code, the undersigned well operator proposes to file or has filed this Notice and Application and accompanying documents for a permit to plug and abandon a well with the Chief of the Office of Oil and Gas, West Virginia Department of Environmental Protection, with respect to the well at the location described on the attached Application and depicted on the attached Form WW-6. Copies of this Notice, the Application, and the plat have been mailed by registered or certified mail or delivered by hand to the person(s) named above (or by publication in certain circumstances) on or before the day of mailing or delivery to the Chief.

Well Operator EQT Production Company
 By: Todd Klamer
 Title: Manager - Permitting
 Address: 400 Woodcliff Drive
Canonsburg PA 15317
 Telephone: (724) 746-9023

Commonwealth of Pennsylvania - Notary Seal
Olivia Pishioneri, Notary Public
Allegheny County
 My commission expires **October 25, 2023**
 Commission number **1359968**
 Member, Pennsylvania Association of Notaries

RECEIVED
Office of Oil and Gas

SEP 13 2021

WV Department of
Environmental Protection

Subscribed and sworn before me this 2nd day of September, 2021
Olivia Pishioneri Notary Public
 My Commission Expires October 25, 2023

Oil and Gas Privacy Notice

The Office of Oil and Gas processes your personal information, such as name, address and phone number, as a part of our regulatory duties. Your personal information may be disclosed to other State agencies or third parties in the normal course of business or as needed to comply with statutory or regulatory requirements, including Freedom of Information Act requests. Our office will appropriately secure your personal information. If you have any questions about our use of your personal information, please contact DEP's Chief Privacy Officer at depprivacyofficer@wv.gov.

02/11/2022

471,0303188

Surface Owner:

Coastal Forest Resources Company
P.O. Box 709, 1772 Brushy Fork Road
Buckhannon, WV 26201

Coal Owners:

Coastal Forest Resource Company
P.O. Box 709, 1772 Brushy Fork Road
Buckhannon, WV 26201

Melinda Jo Carpenter
319 Franklin Street
Barnesville, OH 43713

Irrevocable Intervivos Trust of Billy J. Higgins and Frances J. Higgins, dated 1/10/2012
(Co-Trustees: Frances J. Higgins & William P. Higgins)
531 Franklin Terrace
Washington, PA 15301

Deanne Merle Weber
633 Carothers Road
Weirton, WV 26062

WPP LLC
5260 Irwin Road
Huntington, WV 25727

Consol RCPC LLC
1000 Consol Energy Drive, Suite 100
Canonsburg, PA 15317

RECEIVED
Office of Oil and Gas

SEP 13 2021

WV Department of
Environmental Protection

02/11/2022

471,0303188

7015 0920 0001 7634 0050

U.S. Postal Service™ CERTIFIED MAIL® RECEIPT <i>Domestic Mail Only</i>	
For delivery information, visit our website at www.usps.com ®.	
OFFICIAL USE	
Postage	\$
Certified Fee	
Return Receipt Fee (Endorsement Required)	
Restricted Delivery Fee (Endorsement Required)	
Total Postage & Fees	\$ 8.76
Sent To	COASTAL FOREST RESOURCES CO. PO BOX 709 1772 BRUSHY FORK ROAD BUCKHANNON WV 26201
Street & Apt. No., or PO Box No.	
City, State, ZIP+4	
PS Form 3800, J	



RECEIVED
Office of Oil and Gas

SEP 13 2021

WV Department of
Environmental Protection

02/11/2022

Operator's Well
Number

BIG177 H2

INSTRUCTIONS TO SURFACE OWNERS NAMED ON PAGE WW4-A

The well operator named on page WW-4A is applying for a permit from the State to plug and abandon a well. (Note: If the surface tract is owned by more than three persons, then these materials were served on you because your name appeared on the Sheriff's tax ticket on the land or because you actually occupy the surface tract. In either case, you may be the only owner who will actually receive these materials.) See Chapter 22 of the West Virginia Code. Well work permits are valid for 24 months. If you do not own any interest in the surface tract, please forward these materials to the true owner immediately if you know who it is. Also, please notify the well operator and the Office of Oil and Gas.

NOTE: YOU ARE NOT REQUIRED TO FILE ANY COMMENT.

WHERE TO FILE COMMENTS AND OBTAIN ADDITIONAL INFORMATION:

Chief, Office of Oil and Gas
Department of Environmental Protection
601 57th St. SE
Charleston, WV 25304
(304) 926-0450

Time Limits and methods for filing comments. The law requires these materials to be served on or before the date the operator files his Application. You have **FIVE (5) DAYS** after the filing date to file your comments. Comments must be filed in person or received in the mail by the Chief's office by the time stated above. You may call the Chief's office to be sure of the date. Check with your postmaster to ensure adequate delivery time or to arrange special expedited handling. If you have been contacted by the well operator and you have signed a "voluntary statement of no objection" to the planned work described in these materials, then the permit may be issued at any time.

Comments must be in writing. Your comments must include your name, address and telephone number, the well operator's name and well number and the approximate location of the proposed well site including district and county from the application. You may add other documents, such as sketches, maps or photographs to support your comments.

The Chief has the power to deny or condition a well work permit based on comments on the following grounds:

- 1) The proposed well work will constitute a hazard to the safety of persons.
- 2) The soil erosion and sediment control plan is not adequate or effective;
- 3) Damage would occur to publicly owned lands or resources;
- 4) The proposed well work fails to protect fresh water sources or supplies;
- 5) The applicant has committed a substantial violation of a previous permit or a substantial violation of one or more of the rules promulgated under Chapter 22, and has failed to abate or seek review of the violation..."

If you want a copy of the permit as it is issued or a copy of the order denying the permit, you should request a copy from the Chief.

VOLUNTARY STATEMENT OF NO OBJECTION

I hereby state that I have read the instructions to surface owners and that I have received copies of a Notice and Application For A Permit To Plug And Abandon on Forms WW-4A and WW-4B, and a survey plat.

I further state that I have no objection to the planned work described in these materials, and I have no objection to a permit being issued on those materials.

FOR EXECUTION BY A NATURAL PERSON
ETC.

FOR EXECUTION BY A CORPORATION,
RECEIVED
Office of Oil and Gas

Signature

Date

Name
By
Its

SEP 13 2021

Signature

Date
02/11/2022
WV Department of
Environmental Protection

4710303188

7015 0920 0001 7634 0050

**U.S. Postal Service™
CERTIFIED MAIL® RECEIPT**
Domestic Mail Only

For delivery information, visit our website at www.usps.com®.

OFFICIAL USE

Postage	\$	
Certified Fee		
Return Receipt Fee (Endorsement Required)		
Restricted Delivery Fee (Endorsement Required)		
Total Postage & Fees	\$	8.76

Sent To: **COASTAL FOREST RESOURCES CO.
PO BOX 709
1772 BRUSHY FORK ROAD
BUCKHANNON WV 26201**

PS Form 3800, J 40-09 - BIG 177 H2 - NOTIFICATIONS

7015 0920 0001 7634 0029

**U.S. Postal Service™
CERTIFIED MAIL® RECEIPT**
Domestic Mail Only

For delivery information, visit our website at www.usps.com®.

OFFICIAL USE

Postage	\$	
Certified Fee		
Return Receipt Fee (Endorsement Required)		
Restricted Delivery Fee (Endorsement Required)		
Total Postage & Fees	\$	8.76

Sent To: **DEANNE MERLE WEBER
633 CAROTHERS ROAD
WEIRTON WV 26062**

PS Form 3800, J 40-09 - BIG 177 H2 - NOTIFICATIONS

7015 0920 0001 7634 0043

**U.S. Postal Service™
CERTIFIED MAIL® RECEIPT**
Domestic Mail Only

For delivery information, visit our website at www.usps.com®.

OFFICIAL USE

Postage	\$	
Certified Fee		
Return Receipt Fee (Endorsement Required)		
Restricted Delivery Fee (Endorsement Required)		
Total Postage & Fees	\$	8.76

Sent To: **MELINDA JO CARPENTER
319 FRANKLIN STREET
BARNESVILLE OH 43713**

PS Form 3800, J 40-09 - BIG 177 H2 - NOTIFICATIONS

7015 0920 0001 7634 0012

**U.S. Postal Service™
CERTIFIED MAIL® RECEIPT**
Domestic Mail Only

For delivery information, visit our website at www.usps.com®.

OFFICIAL USE

Postage	\$	
Certified Fee		
Return Receipt Fee (Endorsement Required)		
Restricted Delivery Fee (Endorsement Required)		
Total Postage & Fees	\$	8.76

Sent To: **WPP LLC
5260 IRWIN ROAD
HUNTINGTON WV 25727**

PS Form 3800, J 40-09 - BIG 177 H2 - NOTIFICATIONS

7015 0920 0001 7634 0036

**U.S. Postal Service™
CERTIFIED MAIL® RECEIPT**
Domestic Mail Only

For delivery information, visit our website at www.usps.com®.

OFFICIAL USE

Postage	\$	
Certified Fee		
Return Receipt Fee (Endorsement Required)		
Restricted Delivery Fee (Endorsement Required)		
Total Postage & Fees	\$	8.76

Sent To: **BILLY J. HIGGINS, FRANCES J HIGGINS
& WILLIAM P HIGGINS
531 FRANKLIN TERRACE
WASHINGTON PA 15301**

PS Form 3800, J 40-09 - BIG 177 H2 - NOTIFICATIONS

7018 3090 0001 6709 7822

**U.S. Postal Service™
CERTIFIED MAIL® RECEIPT**
Domestic Mail Only

For delivery information, visit our website at www.usps.com®.

OFFICIAL USE

Certified Mail Fee	\$	
Extra Services & Fees (check box, add fee as appropriate)		
<input type="checkbox"/> Return Receipt (hardcopy)	\$	
<input type="checkbox"/> Return Receipt (electronic)	\$	
<input type="checkbox"/> Certified Mail Restricted Delivery	\$	
<input type="checkbox"/> Adult Signature Required	\$	
<input type="checkbox"/> Adult Signature Restricted Delivery	\$	
Postage	\$	8.76
Total Postage and Fees	\$	

Sent To: **CONSOL RCPC LLC
1000 CONSOL ENERGY DRIVE, SUITE 100
CANONSBURG, PA 15317**

PS Form 3800, A 40-09 - BIG 177 H2 - NOTIFICATIONS

RECEIVED
Office of Oil and Gas

SEP 13 2021
WV Department of
Environmental Protection

02/11/2022

API No.	4710303188 47-103-03188
Farm Name	Coastal Forest Resources Co. dba Coastal Timberlands Co.
Well No.	BIG177 H2

**INSTRUCTIONS TO COAL OPERATORS
OWNERS AND LESSEE**

The well operator named on the obverse side of WW-4 (B) is about to abandon the well described in the enclosed materials and will commence the work of plugging and abandoning said well on the date the inspector is notified. Which date shall not be less than five days after the day on which this notice and application so mailed is received, or in due course should be received by the Department of Environmental Protection Office of Oil & Gas.

This notice and application is given to you in order that your respective representatives may be present at the plugging and filling of said well. You are further notified that whether you are represented or not the operator will proceed to plug and fill said well in the manner required by Section 24, Article 6, Chapter 22 of the Code and given in detail on obverse side of this application.

NOTE: If you wish this well to be plugged according to 22-6-24(d) then as per Regulation 35CSR4-13.9 you must complete and return to this office on form OB-16 "Request by Coal Operator, Owner, or Lessee for plugging" prior to the issuance of this plugging permit.

WAIVER

The undersigned coal operator ____/ owner ____/ lessee ____/ of the coal under this well location has examined this proposed plugging work order. The undersigned has no objection to the work proposed to be done at this location, provided, the well operator has complied with all applicable requirements of the West Virginia Code and the governing regulations.

Date: _____

By: _____

Its _____

RECEIVED
Office of Oil and Gas

SEP 13 2021

WV Department of
Environmental Protection

02/11/2022

STATE OF WEST VIRGINIA
DEPARTMENT OF ENVIRONMENTAL PROTECTION
OFFICE OF OIL AND GAS
FLUIDS/ CUTTINGS DISPOSAL & RECLAMATION PLAN

Operator Name EQT Production Company OP Code 306586

Watershed (HUC 10) Fishing Creek Quadrangle Big Run 7.5'

Do you anticipate using more than 5,000 bbls of water to complete the proposed well work? Yes No

Will a pit be used? Yes No

If so, please describe anticipated pit waste: _____

Will a synthetic liner be used in the pit? Yes No If so, what ml? _____

Proposed Disposal Method For Treated Pit Wastes:

- Land Application (if selected provide a completed form WW-9-GPP)
- Underground Injection (UIC Permit Number _____)
- Reuse (at API Number _____)
- Off Site Disposal (Supply form WW-9 for disposal location)
- Other (Explain _____)

Will closed loop system be used? If so, describe: _____

Drilling medium anticipated for this well (vertical and horizontal)? Air, freshwater, oil based, etc. _____

-If oil based, what type? Synthetic, petroleum, etc. _____

Additives to be used in drilling medium? _____

Drill cuttings disposal method? Leave in pit, landfill, removed offsite, etc. _____

-If left in pit and plan to solidify what medium will be used? (cement, lime, sawdust) _____

-Landfill or offsite name/permit number? _____

Permittee shall provide written notice to the Office of Oil and Gas of any load of drill cuttings or associated waste rejected at any West Virginia solid waste facility. The notice shall be provided within 24 hours of rejection and the permittee shall also disclose where it was properly disposed.

I certify that I understand and agree to the terms and conditions of the GENERAL WATER POLLUTION PERMIT issued on April 1, 2016, by the Office of Oil and Gas of the West Virginia Department of Environmental Protection. I understand that the provisions of the permit are enforceable by law. Violations of any term or condition of the general permit and/or other applicable law or regulation can lead to enforcement action.

I certify under penalty of law that I have personally examined and am familiar with the information submitted on this application form and all attachments thereto and that, based on my inquiry of those individuals immediately responsible for obtaining the information, I believe that the information is true, accurate, and complete. I am aware that there are significant penalties for submitting false information, including the possibility of fine or imprisonment.

Company Official Signature 

Company Official (Typed Name) Todd Klaner

Company Official Title Manager - Permitting

RECEIVED
Office of Oil and Gas

SEP 13 2021

Subscribed and sworn before me this 2nd day of September, 2021



Notary Public

WV Department of Environmental Protection

My commission expires October 25, 2023

Commonwealth of Pennsylvania - Notary Seal
Olivia Pishioneri, Notary Public
Allegheny County
My commission expires October 25, 2023
Commission number 1359968
Member, Pennsylvania Association of Notaries

Proposed Revegetation Treatment: Acres Disturbed _____ Prevegetation pH _____

Lime _____ Tons/acre or to correct to pH _____

Fertilizer type _____

Fertilizer amount _____ lbs/acre

Mulch _____ Tons/acre

The BIG177H2 well is located on a Well Pad with other wells in production. No further reclamation activity will occur beyond what was approved in the Well Work Permit for Well Pad stabilization. A copy of the revegetation plan containing this information is attached for reference.

Seed Mixtures

Temporary

Permanent

Seed Type

lbs/acre

Seed Type

lbs/acre

Temporary		Permanent	
Seed Type	lbs/acre	Seed Type	lbs/acre
_____	_____	_____	_____
_____	_____	_____	_____
_____	_____	_____	_____

Attach:

Maps(s) of road, location, pit and proposed area for land application (unless engineered plans including this info have been provided). If water from the pit will be land applied, provide water volume, include dimensions (L, W, D) of the pit, and dimensions (L, W), and area in acres, of the land application area.

Photocopied section of involved 7.5' topographic sheet.

Plan Approved by: Bryan Harris

Comments: _____

Title: Inspector

Date: 9/8/21

Field Reviewed? () Yes () No

RECEIVED
Office of Oil and Gas

SEP 13 2021

WV Department of
Environmental Protection

02/11/2022

EQT Production Water plan
Offsite disposals

4710303188

Waste Management - Meadowfill Landfill

Rt. 2, Box 68 Dawson Drive
Bridgeport, WV 26330
304-326-6027
Permit #SWF-1032-98
Approval #100785WV

Waste Management - Northwestern Landfill

512 E. Dry Road
Parkersburg, WV 26104
304-428-0602
Permit #SWF-1025 WV-0109400
Approval #100833WV

RECEIVED
Office of Oil and Gas

SEP 13 2021

WV Department of
Environmental Protection

02/11/2022

4710303188P



Branden Weimer – Project Specialist, Permitting

400 Woodcliff Dr | Canonsburg, PA 15317
P: 412-997-7940 | branden.weimer@eqt.com

West Virginia Dept. of Environmental Protection

Office of Oil & Gas
Attn: Jeff McLaughlin
601 57th Street, SE
Charleston, WV 25304

September 10, 2021
Well Plug & Abandonment Permit Application
API 47-103-03188
Grant District, Wetzel County, WV

Mr. McLaughlin,

Attached is EQT Production Company's permit application for plug and abandonment of the BIG177H2 well.

EQT Production Company trusts that if any portion of the submitted documentation is found to be inadequate for processing the permit, notification will be made to our permitting department at your earliest convenience. It is EQT Production Company's intent to cooperate fully to provide any additional requested documentation and clarification in a timely manner, such that permitting proceeds in a predictable and logical manner.

Regards,

A handwritten signature in blue ink, appearing to read 'Branden Weimer', is written over a faint, large watermark of the EQT logo.

Branden Weimer
Project Specialist, Permitting
EQT Production Company

RECEIVED
Office of Oil and Gas
SEP 13 2021
WV Department of
Environmental Protection

02/11/2022

WR-35
Rev. 8/23/13

API 47- 103 - 03188 Farm name COASTAL FOREST RESOURCES CO. d/b/a COASTAL TIMBERLANDS CO. Well number BIG177H2 (511408)

Drilling Contractor Falcon Drilling Company LLC
Address 1120 RT 119 NWY NORTH City INDIANA State PA Zip 15701

Logging Company Gyrodata Inc.
Address 73 Noblestown Road City Carnegie State PA Zip 15106

Logging Company Scientific Drilling International
Address 124 Vista Drive City Charleroi State PA Zip 15022

Cementing Company Universal
Address 13549 S. Mosiertown Rd City Meadville State PA Zip 16335

Logging Company Baker Hughes
Address 400 Technology Drive- Suite 100 City Canonsburg State PA Zip 15317

RECEIVED
Office of Oil and Gas

SEP 13 2021

WV Department of
Environmental Protection
02/11/2022



EQT PRODUCTION COMPANY
400 Woodcliff Drive | Canonsburg, PA 15317

CERTIFIED MAIL

Dear Sir or Madam:

Re: Proposed BIG177 H2 Gas Well
Grant District, Wetzel County, West Virginia

Pursuant to Section 22B-1-9 of the West Virginia Code, enclosed please find copies of the following documents:

- Form WW-4A - Notice of Application to Plug and Abandon a Well (1 copy)
- Form WW-4B - Application for a Permit to Plug and Abandon (1 copy)
- Form WW-7 - WV DEP Well Location Form - Certified Copy
- Form WW-9 - Fluids/Cuttings Disposal & Reclamation Plan (1 copy)

This application is being filed by EQT Production with the Administrator of the Office of Oil and Gas of the West Virginia Department of Environmental Protection. If you have no objections to this well being plugged, please sign the Surface Owner Waiver or Coal Party Waiver (Form WW-B) and return one copy to our office in the enclosed prepaid envelope.

Thank you for your cooperation and consideration. Should you have any questions, comments, or require any additional information, please feel free to contact Becky Shrum at (724) 271-7314.

Sincerely,
EQT PRODUCTION COMPANY

Erin Spine
Supervisor - Subsurface Permitting

Enclosures

RECEIVED
Office of Oil and Gas

SEP 13 2021

WV Department of
Environmental Protection

02/11/2022



4710303188

Site Pictures

Coastal Forest Resources Co. dba Coastal Timberlands Co.
BIG 177 H2 47-103-03188



BIG 177 H2 Well Pad Site



BIG 177 Well Pad Site

H15

RECEIVED
Office of Oil and Gas

SEP 13 2021

WV Department of
Environmental Protection

BIRCH RIVER OFFICE

237 Birch River Road
Birch River, WV 26610

phone: 304-649-8606 fax: 304-649-8608

BRIDGEPORT OFFICE

172 Thompson Drive
Bridgeport, WV 26330

phone: 304-848-5035 fax: 304-848-5037

CHARLESTON OFFICE

301 RHI. Boulevard - Suite 5
Charleston, WV 25309

phone: 304-756-2949 fax: 304-756-2948

Topo Quad: Big Run 7.5'

Scale: 1" = 2000'

4710303188

County: Wetzell

Date: June 07, 2021

District: Grant

Project No: 40-34-00-09

47-103-03188 BIG 177 H2

Topo

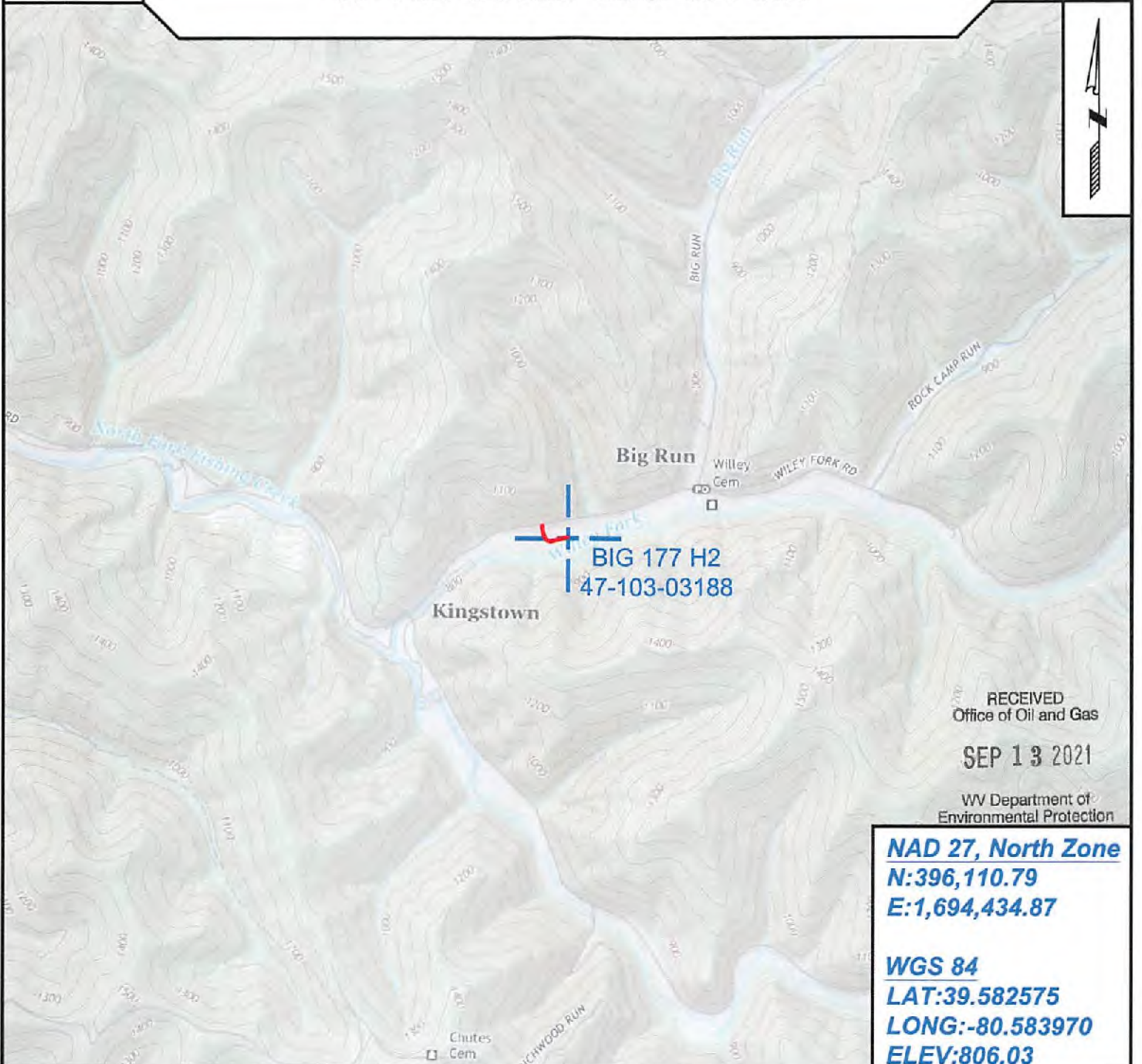

RECEIVED
Office of Oil and Gas

SEP 13 2021

WV Department of
Environmental Protection

NAD 27, North Zone
N:396,110.79
E:1,694,434.87

WGS 84
LAT:39.582575
LONG:-80.583970
ELEV:806.03



SURVEYING AND MAPPING SERVICES PERFORMED BY:

ALLEGHENY SURVEYS, INC.

1-800-482-8606
237 Birch River Road
Birch River, WV 26610
PH: (304) 649-8606
FAX: (304) 649-8608

PREPARED FOR:

EQT Production Company

400 Woodcliff Drive
Canonsburg, PA 15317

02/11/2022



West Virginia Department of Environmental Protection
Office of Oil and Gas
WELL LOCATION FORM: GPS

API: 47-103-03188 WELL NO.: BIG 177 H2

FARM NAME: Coastal Forest Resources Co. dba Coastal Timberlands Co.

RESPONSIBLE PARTY NAME: EQT Production Company

COUNTY: Wetzel DISTRICT: Grant

QUADRANGLE: Big Run 7.5'

SURFACE OWNER: Coastal Forest Resources Co. dba Coastal Timberlands Co.

ROYALTY OWNER: Higgins Family Trust, et al.

UTM GPS NORTHING: 4381511

UTM GPS EASTING: 535728 GPS ELEVATION: 246 m (806 ft)

The Responsible Party named above has chosen to submit GPS coordinates in lieu of preparing a new well location plat for a plugging permit or assigned API number on the above well. The Office of Oil and Gas will not accept GPS coordinates that do not meet the following requirements:

1. Datum: NAD 1983, Zone: 17 North, Coordinate Units: meters, Altitude: height above mean sea level (MSL) – meters.
2. Accuracy to Datum – 3.05 meters
3. Data Collection Method:

Survey grade GPS _____ : Post Processed Differential _____
Real-Time Differential _____

Mapping Grade GPS X : Post Processed Differential X
Real-Time Differential _____

4. **Letter size copy of the topography map showing the well location.**

I the undersigned, hereby certify this data is correct to the best of my knowledge and belief and shows all the information required by law and the regulations issued and prescribed by the Office of Oil and Gas.

RECEIVED
Office of Oil and Gas

SEP 13 2021

WV Department of
Environmental Protection

Signature

PS# 2180
Title

6/9/2021
Date



Stansberry, Wade A <wade.a.stansberry@wv.gov>

RE: [EXTERNAL] Plugging Vertical Well Work Permit API: 47-103-03188, 03191)

1 message

Weimer, Branden <Branden.Weimer@eqt.com>

Mon, Feb 7, 2022 at 10:17 AM

To: "Stansberry, Wade A" <wade.a.stansberry@wv.gov>, "Zavatchan, John" <JZavatchan@eqt.com>, "Klaner, Todd" <TKlaner@eqt.com>, "Spine, Erin" <ESpine@eqt.com>, "Shrum, Becky" <BShrum@eqt.com>, "Wilson, Olivia" <OPishioneri@eqt.com>, Scott Lemley <slemley@wvassessor.com>, "Harris, Bryan O" <bryan.o.harris@wv.gov>

Thanks, Wade.

Branden Weimer | Project Specialist - Permitting | EQT Corporation

400 Woodcliff Drive, Canonsburg, PA 15317

M: (412) 997-7940 | branden.weimer@eqt.com**From:** Stansberry, Wade A <wade.a.stansberry@wv.gov>**Sent:** Monday, February 7, 2022 9:53 AM**To:** Weimer, Branden <Branden.Weimer@eqt.com>; Zavatchan, John <JZavatchan@eqt.com>; Klaner, Todd <TKlaner@eqt.com>; Spine, Erin <ESpine@eqt.com>; Shrum, Becky <BShrum@eqt.com>; Wilson, Olivia <OPishioneri@eqt.com>; Scott Lemley <slemley@wvassessor.com>; Harris, Bryan O <bryan.o.harris@wv.gov>**Subject:** [EXTERNAL] Plugging Vertical Well Work Permit API: 47-103-03188, 03191)

:::This email is from an external source. Please use caution when clicking links or opening attachments:::

I have attached a copy of the newly issued well [permit](#) number. This will serve as your copy.**47-103-03188 - BIG177H2****47-103-03191 - BIG177H15**If you have any questions, then [please](#) contact us here at the Office of Oil and Gas.

Thank you,

Wade A. Stansberry**Environmental Resource Specialist 3****West Virginia Department of Environmental Protection****Office of Oil & Gas****601 57th St. SE****Charleston, WV 25304****(304) 926-0499 ext. 41115****(304) 926-0452 fax****Wade.A.Stansberry@wv.gov****02/11/2022**

2/7/22, 10:25 AM

State of West Virginia Mail - RE: [EXTERNAL] Plugging Vertical Well Work Permit API: 47-103-03188, 03191)

To learn about EQT's environmental, social and governance efforts visit: <https://esg.eqt.com>

02/11/2022