

RETTEW

RETTEW Associates, Inc.
27 Travato Street, Suite 101
Bridgeport, WV 26330
Phone (800) 738-8395
Email: rettetw@rettetw.com
Website: www.rettetw.com

SURFACE HOLE LOCATION (SHL):
UTM (NAD83, ZONE 17, METERS):
NORTHING: 4,389,477.272
EASTING: 527,516.236

LANDING POINT LOCATION (LP):
UTM (NAD83, ZONE 17, METERS):
NORTHING: 4,389,691.852
EASTING: 527,479.574

BOTTOM HOLE LOCATION (BHL):
UTM (NAD83, ZONE 17, METERS):
NORTHING: 4,390,908.415
EASTING: 526,207.452

GRID NORTH
UTM, NAD83 DATUM, ZONE 17, US FT

Latitude: 39°40'00" ← 3,527'
BHL Latitude: 39°42'30" ← 7,764'

LINE	BEARING	DISTANCE	DESCRIPTION	MONUMENT
L1	S 37°24'18" E	462.9'	SHL TO LANDMARK	
L2	S 31°40'54" W	1,219.5'	SHL TO LANDMARK	
L3	S 14°21'50" E	309.73'	SHL TO REF. PNT.	1/2"Ø REBAR/CAP
L4	S 74°54'39" W	217.88'	SHL TO REF. PNT.	1/2"Ø REBAR/CAP
L5	N 09°14'44" W	714.2'	SHL TO LP	
L6	N 46°16'44" W	5,774.9'	LP TO BHL	

TRACT	SURFACE OWNER	TAX PARCEL	ACRES
1	CONSTANCE A. TAYLOR	12-18-00350000	±43.50
2	BRENT PAUL BLAKE, ET AL	12-14-00320003	±85.96
3	WALTER R. DICKIE, JR	12-14-00320001	±2.75
4	LORRAINE M. CRISP	12-18-00040001	±90.07
5	DARLENE ELLEN WOOD & WALTER R. DICKIE, JR	12-14-00210002	±30.00
6	JAMES H. FOGG	12-14-00210001	±66.45
7	BUSTER & BARBARA A. BLAKE	12-14-00120001	±134.46

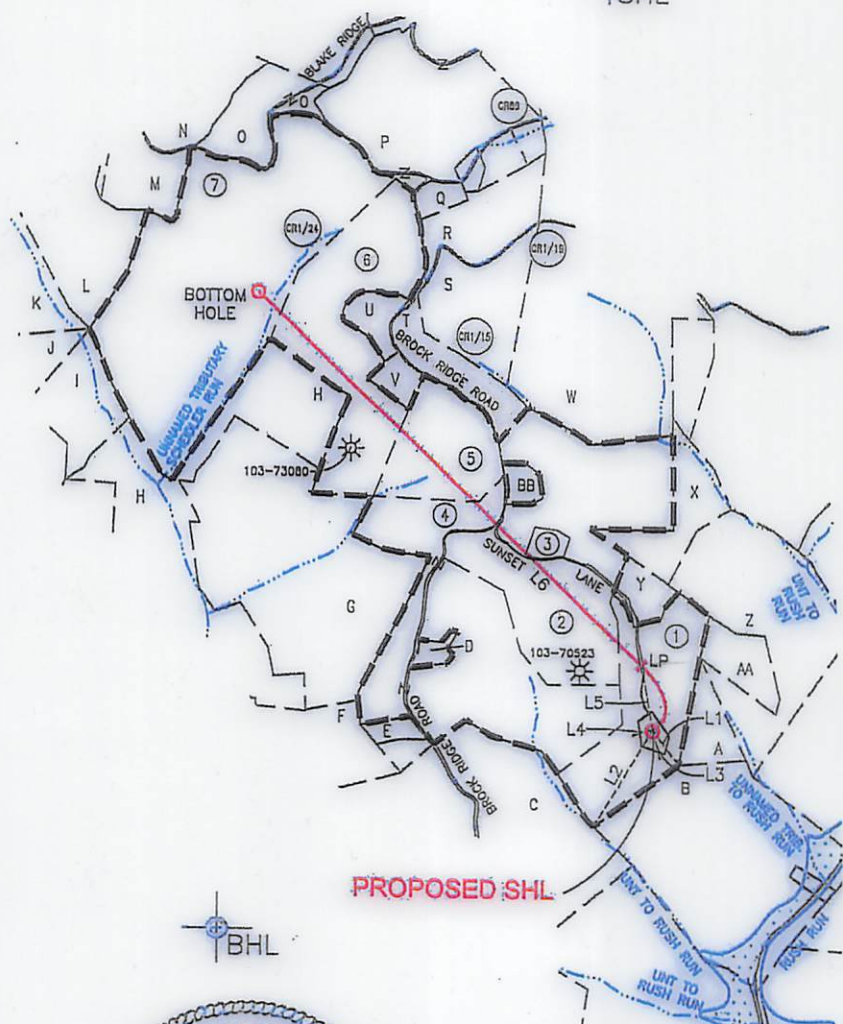
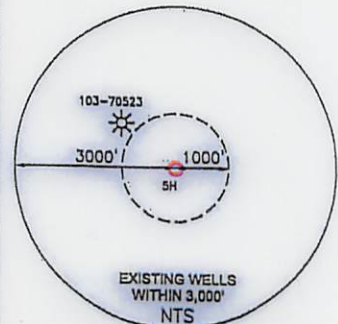
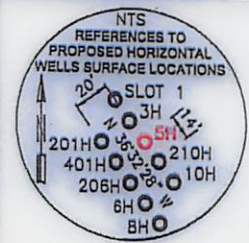
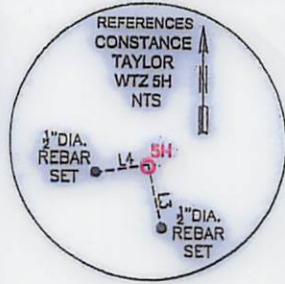

- NOTES ON SURVEY**
- COORDINATES SYSTEM IS UTM, NAD 83 DATUM, ZONE 17, U.S. FOOT AND WELL COORDINATES ESTABLISHED USING SURVEY GRADE GPS.
 - SURFACE AND ROYALTY OWNER INFORMATION AND THEIR BOUNDARIES SHOWN HEREON WERE PLOTTED FROM DEEDS AND/OR TAX PARCEL MAPS PROVIDED BY CLIENT AND FIELD LOCATIONS.
 - THIS PLAT DOES NOT REPRESENT A BOUNDARY SURVEY OF THE PARCELS SHOWN HEREON.
 - NO DWELLINGS AND BUILDINGS WITHIN 625 FEET OF PROPOSED OF CENTER OF PAD.
 - NO WATER WELLS OR DEVELOPED SPRINGS WITHIN 250 FEET OF PROPOSED WELL.
 - NO PERENNIAL STREAMS, LAKES, PONDS, RESERVOIRS OR WETLANDS WITHIN 100 FEET OF THE LIMITS OF DISTURBANCE.
 - NO NATURALLY PRODUCING TROUT STREAM WITHIN 300 FEET OF LIMITS OF DISTURBANCE.

I, THE UNDERSIGNED, HEREBY CERTIFY THAT THIS PLAT IS CORRECT TO THE BEST OF MY KNOWLEDGE AND BELIEF AND SHOWS ALL THE INFORMATION REQUIRED BY LAW AND REGULATIONS ISSUED AND PRESCRIBED BY THE DEPARTMENT OF ENVIRONMENTAL PROTECTION.

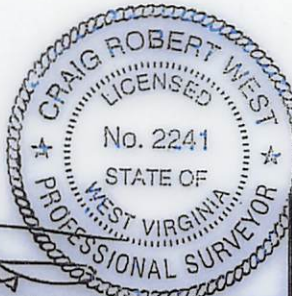

P.S. 2241



(+) DENOTES LOCATION OF WELL ON UNITED STATES TOPOGRAPHIC MAPS
WVDEP
OFFICE OF OIL & GAS
601 57TH STREET
CHARLESTON, WV 25034

MINIMUM DEGREE OF ACCURACY: 1/200
PROVEN SURVEY SOURCE OF GRADE GPS ELEVATION: (NAVD 88, US FT)

COMPANY: **SWN** Production Company, LLC

CONSTANCE TAYLOR WTZ
OPERATOR'S WELL #: 5H
API WELL #: 47 103 03149
STATE COUNTY PERMIT

WELL TYPE: OIL WASTE DISPOSAL PRODUCTION DEEP GAS LIQUID INJECTION STORAGE SHALLOW

WATERSHED: LITTLE FISHING CREEK
DISTRICT: PROCTOR COUNTY: WETZEL
SURFACE OWNER: CONSTANCE A. TAYLOR
OIL & GAS ROYALTY OWNER: CONSTANCE A. TAYLOR
ELEVATION: ±1,426.32 (DESIGN)
QUADRANGLE: WILEYVILLE, WV
ACREAGE: ±43.50
ACREAGE: ±43.50

DRILL DRILL DEEPER REDRILL FRACTURE OR STIMULATE PLUG OFF OLD FORMATION PERFORATE NEW FORMATION

CONVERT PLUG & ABANDON CLEAN OUT & REPLUG OTHER CHANGE (SPECIFY)
TARGET FORMATION: MARCELLUS
ESTIMATED DEPTH: 7,392' TVD 13,584' TMD

WELL OPERATOR: SWN PRODUCTION COMPANY, LLC
ADDRESS: P.O. BOX 1300
CITY: JANE LEW STATE: WV ZIP CODE: 26378
DESIGNATED AGENT: DEE SOUTHALL
ADDRESS: P.O. BOX 1300
CITY: JANE LEW STATE: WV ZIP CODE: 26378

LEGEND:	REVISIONS:	DATE:
○ PROPOSED SURFACE HOLE / BOTTOM HOLE		12-02-2015
⊗ EXISTING / PRODUCING WELLHEAD		
⊗ ABANDONED WELL	--- TIE LINE	
⊗ PLUGGED & ABANDONED WELL	--- LEASE BOUNDARY	
△ CUT CONDUCTOR	--- MARCELLUS DHP	
	--- STREAM	
		DRAWN BY: B. HERMAN
		SCALE: 1" = 2000'
		DRAWING NO: 087569006
		WELL LOCATION PLAT



RETTEW Associates, Inc.
 27 Travato Street, Suite 101
 Bridgeport, WV 26330
 Phone (800) 738-8395
 Email: rettew@rettew.com
 Website: www.rettew.com

ADJOINING OWNERS

TRACT	SURFACE OWNER	TAX PARCEL	ACRES
A	BENJAMIN SHANOWER	12-18-00060000	±10.00
B	TIMOTHY N. WELLS	12-18-00120000	±78.09
C	RICHARD E. & STEPHANIE WILLIAMS	12-18-00110000	±64.00
D	CONSTANCE A. TAYLOR	12-18-00040000	±2.87
E	DAVID F. & ROSANNE POSTLETHWAIT	12-18-00030000	±3.22
F	WANDA HUGGINS	12-18-00010000	±35.00
G	LORRAINE M. CRISP	12-14-00310000	±100.38
H	BUSTER TERRY BLAKE	12-14-00300000	±108.50
I	HEITH M. & DAVID L. HOWELL & ROBERT C. MCCLURE	12-14-00200000	±28.88
J	HARRY E., MICHAEL, & DAVID MCABEE & GARY SPEECE, JR.	12-14-00180000	±28.00
K	MARY C. BENNINGTON	12-14-00170000	±65.00
L	ROBERT C. & MILDRED M. RICHTER	12-14-00100000	±99.19
M	CHARLES E. & SHIRLEY M. SMITH	12-14-00120003	±18.30
N	DONNA & STEVEN WHITE	12-14-00120000	±15.81
O	SHEILA K. WHITE	12-14-00120004	±18.35
P	CHESAPEAKE APPALACHIA LLC.	12-14-00130000	±85.30
Q	QUENTIN ALAN YOCUM, JR.	12-14-00220003	±3.21
R	T&C TRUST	12-14-00220001	±17.87
S	OWEN E. SCHMUCKER	12-14-00220000	±27.25
T	OWEN E. SCHMUCKER	12-14-00210004	±15.00
U	BURL E. & SHIRLEY A. RICHMOND	12-14-00210000	±6.57
V	DAVID L. & CAROLYN S. LONG	12-14-00210003	±5.53
W	CATHERINE L. GODDARD & JAMES M. LEDERGERBER	12-14-00230000	±84.00
X	BRENT PAUL BLAKE, ETAL	12-14-00340000	±18.00
Y	CONSTANCE A. TAYLOR	12-14-00330000	±6.25
Z	ERICK D. & PHYLLIS BECKER	12-18-00070000	±57.13
AA	BENJAMIN SHANOWER	12-18-00070001	±10.37
BB	BRENT PAUL BLAKE	12-14-00320002	±3.23

REVISIONS:

COMPANY: **SWN** Production Company, LLC

OPERATOR'S: CONSTANCE TAYLOR WTZ

WELL #: 5H

LOCATION: PROCTOR DISTRICT, WETZEL COUNTY, WEST VIRGINIA

DATE: 12-02-2015

DRAWN BY: B. HERMAN

SCALE: N/A

DRAWING NO: 087569006

ADJOINING OWNERS

SWN ^{R₂}/_A ^{V⁺}/₀ 01/20/2017