

	PROPERTY OWNER	ACRES	LEASE NUMBER	PARCEL ID
A.	DANIEL & DELLANN R. BOGGESS	0.610	107605-00 thru 107605-01	1-18-18.4
B.	PEARL L. YOHO	0.390	107605-00 thru 107605-01	1-18-18.6
C.	DAVID C. & JOELLEN L. MARLOW	1.270	107605-00 thru 107605-01	1-18-18.2
D.	HG ENERGY LLC.	20.48	107605-00 thru 107605-01	1-18-17
E.	THOMAS D. MCBEE	3.750	99357-00 & 107734-00	1-18-03
F.	GARY BAKER	24.00	107734-00	1-18-33

W #1	N 80°10'35" W	1,549'
W #2	S 80°48'48" W	2,015'
W #3	N 45°58'06" E	1,736'
W #4	N 40°47'16" E	1,878'
W #5	N 31°43'05" E	1,790'
#1	N 39°50'49" E	1,912'

WELL (BOTTOM)  
 MARY MILLER 1H  
 WV-N (NAD 83)  
 N: 438555.11  
 E: 1647285.36  
 UTM (NAD 83)  
 N: 4386582.49  
 E: 530855.15

WELL (BOTTOM)  
 MARY MILLER 1H  
 WV-N (NAD 83)  
 N: 438555.11  
 E: 1647285.36  
 UTM (NAD 83)  
 N: 4386582.49  
 E: 530855.15

WELL (SURFACE)  
 MARY MILLER 1H  
 WV-N (NAD 83)  
 N: 408075.96  
 E: 1655120.37  
 UTM (NAD 83)  
 N: 4385105.41  
 E: 533267.48

WELL (SURFACE)  
 MARY MILLER 1H  
 WV-N (NAD 83)  
 N: 408075.96  
 E: 1655120.37  
 UTM (NAD 83)  
 N: 4385105.41  
 E: 533267.48

NO DWELLINGS FOUND  
 WITHIN 650' OF THE  
 CENTER OF THE WELL PAD  
 NO WATER WELLS FOUND  
 WITHIN 250' OF THE  
 CENTER OF WELL PAD

REFERENCE NOTES  
 Boundaries as shown taken  
 from deeds, tax maps and  
 field locations. A full boundary  
 survey is not expressed nor implied.  
 All bearings are based on true north.  
 Ownership taken from public records  
 Wetzel County, West Virginia  
 NOVEMBER 2014  
 State Plane Coordinates &  
 NAD 83 Lat/Long by differential  
 submeter mapping grade GPS  
 Drafted by EAJL

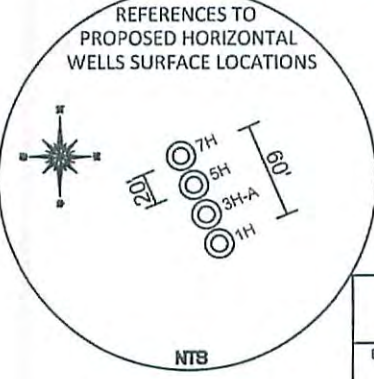

TOP HOLE (UTM NAD 83)	N) 4385105.3
	E) 533267.5
BOTTOM HOLE (UTM NAD 83)	N) 4386579.8
	E) 530853.3

FILE #: AE001  
 DRAWING #: 2454  
 SCALE: PLAT - 1" = 1400'  
 TICK MARK - 1" = 2000'  
 MINIMUM DEGREE OF ACCURACY: 1/200  
 PROVEN SOURCE OF ELEVATION: SUBMETER MAPPING GRADE GPS

I, THE UNDERSIGNED, HEREBY CERTIFY THAT THIS PLAT IS CORRECT TO THE BEST OF MY KNOWLEDGE AND BELIEF AND SHOWS ALL THE INFORMATION REQUIRED BY LAW AND THE REGULATIONS ISSUED AND PRESCRIBED BY THE DEPARTMENT OF ENVIRONMENTAL PROTECTION.

Signed: *[Signature]*  
 L.L.S. #2124 : Ernest J. Benchek III



(+) DENOTES LOCATION OF WELL ON UNITED STATES TOPOGRAPHIC MAPS WVDEP  
 OFFICE OF OIL & GAS  
 601 57TH STREET  
 CHARLESTON, WV 25304  
 Well Type:  Oil  Waste Diposal  Production  Deep  
 Gas  Liquid Injection  Storage  Shallow  
 WATERSHED: FISHING CREEK  
 COUNTY/DISTRICT: WETZEL / CENTER  
 SURFACE OWNER: DALE K. DULANEY  
 OIL & GAS ROYALTY OWNER: PATSY C. FISH, ARTHUR R. & JOAN E. MILLER, CONNIE S. WHITE, KEITH R. MOORE  
 LEASE NUMBERS: \_\_\_\_\_  
 DRILL  CONVERT  DRILL DEEPER  REDRILL  FRACTURE OR STIMULATE   
 PLUG OFF FORMATION  PERFORATE NEW FORMATION  PLUG & ABANDON   
 CLEAN OUT & REPLUG  OTHER CHANGE  (SPECIFY): \_\_\_\_\_  
 TARGET FORMATION: MARCELLUS  
 WELL OPERATOR: Ascent Resources—Marcellus LLC.  
 ADDRESS: 3501 NW 63rd Street  
 CITY: Oklahoma City STATE: OK ZIP CODE: 73116  
 DATE: NOVEMBER 18, 2015  
 OPERATOR'S WELL #: MARY MILLER GRT WZ 1H AS-DRILLED  
 API WELL #: 47 103 STATE COUNTY PERMIT  
 ASBUILT ELEVATION: 1,364'  
 QUADRANGLE: BIG RUN, WV  
 ACREAGE: 156.90 + / 01/08/2016  
 ACREAGE: 583.43 + / -  
 ESTIMATED DEPTH: TVD: 7,509.30' TMD: 17,176'  
 DESIGNATED AGENT: Eric B. Gillespie  
 ADDRESS: 103 Taryn Lane  
 CITY: Cross Lanes STATE: WV ZIP CODE: 25313

Received  
 Office of Oil & Gas  
 NOV 20 2015