

**Martin 3H
Martin
EQT Production Company**



LATITUDE 39° 37' 30" TH: 4,595'
BH: 8,390'
BH: 180'
LONGITUDE 80° 45' 00"

MARTIN 3H
BOTTOM HOLE

TH

N32°40'43"W
4824'

3046
2922
2901
2967

3047
3048
2964
2965

2570
2571

MARTIN 3H
LANDING POINT

FENCE POST

MARTIN 3H

20" WHITE
OAK

N84°W
2149'

N73°54'26"W
1179'

- NOTES ON SURVEY**
1. COORDINATES SYSTEM IS UTM, NAD 83 DATUM, ZONE 17, U.S. FOOT AND WELL COORDINATES ESTABLISHED USING SURVEY GRADE GPS.
 2. SURFACE AND ROYALTY OWNER INFORMATION AND THEIR BOUNDARIES SHOWN HEREON WERE PLOTTED FROM DEEDS AND/OR TAX PARCEL MAPS PROVIDED BY CLIENT AND FIELD LOCATIONS.
 3. THIS PLAT DOES NOT REPRESENT A BOUNDARY SURVEY OF THE PARCELS SHOWN HEREON.
 4. NO DWELLINGS AND BUILDINGS WITHIN 625 FEET OF PROPOSED CENTER OF PAD.
 5. NO WATER WELLS OR DEVELOPED SPRINGS WITHIN 250 FEET OF PROPOSED WELL.
 6. NO PERENNIAL STREAMS, LAKES, PONDS, RESERVOIRS OR WETLANDS WITHIN 100 FEET OF THE LIMITS OF DISTURBANCE.
 7. NO NATURALLY PRODUCING TROUT STREAM WITHIN 300 FEET OF LIMITS OF DISTURBANCE.

LEGEND

- ⊕ Active Well Location
- ⊕ Plugged Well Location
- ⊕ Never Issued
- ⊕ Permit Issued
- ① Tract Identification
- Proposed Gas Well
- Located Corner, as noted
- Surface Tract Lines
- Reference Line
- Lease Boundary
- Creek or Drain
- ⊙ WV County Route
- ⊠ WV State Route

Tract ID.	Acres	Owner
2&7	105	SNS Ventures, LLC et al
3	70.17	Anne L. Spencer et al
4	115.25	Anne L. Spencer et al
5 & 6	120.79	Delmas F. Neff et ux

(⊕) Denotes Location of Well on United States Topographic Maps



I, the undersigned, hereby certify that this plat is correct to the best of my knowledge and belief and shows all the information required by law and the regulations issued and prescribed by the Department of Environmental Protection.

Thomas C. Smit
L. L. S. 687



FILE NO: W2175 (BK 59-37)
DRAWING NO:
SCALE: 1" = 1200'
MINIMUM DEGREE OF ACCURACY: 1:2500
PROVEN SOURCE OF ELEVATION: SG-GPS (OPUS)

STATE OF WEST VIRGINIA
DEPARTMENT OF ENVIRONMENTAL PROTECTION
OIL AND GAS DIVISION

DATE: SEPTEMBER 8 20 17
OPERATORS WELL NO: MARTIN 3H
API WELL NO: H6A
47 - 103 - 02923 F
STATE COUNTY PERMIT

WELL TYPE: OIL GAS LIQUID INJECTION WASTE DISPOSAL
(IF GAS) PRODUCTION: STORAGE DEEP SHALLOW
LOCATION ELEVATION: 920' WATERSHED: LITTLE FISHING CREEK QUADRANGLE: PORTERS FALLS 7.5'
DISTRICT: Green COUNTY: Wetzel
SURFACE OWNER: Charles & Gwendolyn Martin ACREAGE: 54 ±
ROYALTY OWNER: SNS Ventures, LLC et al LEASE NO: 873397 ACREAGE: 105 ±
PROPOSED WORK: DRILL CONVERT DRILL DEEPER FRACTURE OR STIMULATE PLUG OFF OLD FORMATION
 PERFORATE NEW FORMATION OTHER PHYSICAL CHANGE IN WELL (SPECIFY)
 PLUG AND ABANDON CLEAN OUT AND REPLUG TARGET FORMATION: Marcellus ESTIMATED DEPTH: 6,600'

WELL OPERATOR: EQT Production Company DESIGNATED AGENT: Rex C. Ray
ADDRESS: 115 Professional Place PO Box 280 ADDRESS: 115 Professional Place PO Box 280
Bridgeport, WV 26330 Bridgeport, WV 26330

12/22/2017

**Martin 3H
Martin
EQT Production Company**

Tract ID.	Tax Map No.	Parcel No.	County	District	Surface Tract Owner	Acres
1	3	5	Wetzel	Green	Charles W. Martin	1.13
2	3	2.1	Wetzel	Green	Gwendolyn L. Stout	56.49
3	14	12	Wetzel	Magnolia	W. D. Lemon	35.31
4	14	9	Wetzel	Magnolia	W. D. Lemon	91.67
5	9	42	Wetzel	Magnolia	Delmas F. Neff	71.17
6	9	44	Wetzel	Magnolia	Delmas F. Neff	38.15
7	3	2	Wetzel	Green	Gwendolyn L. Stout	45.07
8	3	2.2	Wetzel	Green	Gwendolyn L. & Charles Martin	4.96
9	9	40	Wetzel	Magnolia	Elizabeth W. Hawkins	17.36
10	9	41	Wetzel	Magnolia	Elizabeth W. Hawkins	21.64
11	9	39	Wetzel	Magnolia	Robert B. Litman	24.11
12	3	30.3	Wetzel	Green	Gwendolyn L. Stout	0.73
13	3	30.1	Wetzel	Green	Thomas Dwight	2.13
14	3		Wetzel	Green	N/A	1.36
15	2	33.2	Wetzel	Green	Charles W. Martin	4.02
16	2	21	Wetzel	Green	Delbert L. Leasure	98.57
17	14	8	Wetzel	Magnolia	Delbert L. Leasure	28.17
18	14	7	Wetzel	Magnolia	C.M. & Lucy Maury	36.03
19	2	33	Wetzel	Green	Douglas L. Steele	146.31
20	9	36.2	Wetzel	Magnolia	Ronald A. Dewitt	43.36
21	9	36	Wetzel	Magnolia	Delmas F. Neff	5.99
22	14	11	Wetzel	Magnolia	W. D. Lemon	53.19
23	3	7	Wetzel	Green	Charles W. Martin	10.65
24	3	6	Wetzel	Green	Charles W. Martin	0.32
25	3	26	Wetzel	Green	Kemel E. Greathouse Estate	42.1
26	3	25	Wetzel	Green	Ethel Greathouse Estate	1.03
27	3	24	Wetzel	Green	Kemel Greathouse Estate	1.69
28	14	10	Wetzel	Magnolia	W. D. Lemon	20.62
29	14	3	Wetzel	Magnolia	W.D. Lemon	50.50
30	9	45.1	Wetzel	Magnolia	W.D. Lemon	29.74
31	14	2	Wetzel	Magnolia	Robert B. Litman	63.22
32	3	3	Wetzel	Green	Charles W. Martin	20.2
33	9	43	Wetzel	Magnolia	Doretta R. Rush	4.04
34	9	43.1	Wetzel	Magnolia	Keith R. Pyles	7.13
35	9	29.3	Wetzel	Magnolia	Delmas F. & Linda L. Neff	18.72
36	9	42.1	Wetzel	Magnolia	Delmas F. & Linda L. Neff	0.67
37	9	42.3	Wetzel	Magnolia	Delmas F. & Linda L. Neff	5.56
38	14	4	Wetzel	Magnolia	W. D. Lemon	14.86
39	14	5.2	Wetzel	Magnolia	Tracy Living Trust	100.19

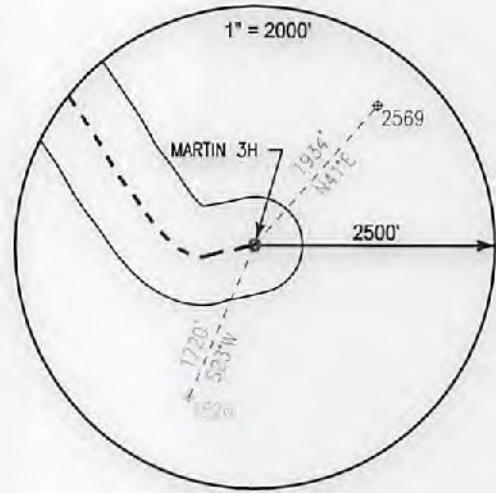

Notes:
MARTIN 3H As-Built coordinates are
 NAD 27 N: 407,779.003 E: 1,643,273.000
 NAD 27 Lat: 39.612698 Long: -80.766243
 NAD 83 UTM N: 4,384,805.679 E: 520,081.144
MARTIN 3H As-Built Landing Point coordinates are
 NAD 27 N: 408,105.913 E: 1,642,139.940
 NAD 27 Lat: 39.613541 Long: -80.770281
 NAD 83 UTM N: 4,384,899.502 E: 519,734.289
MARTIN 3H As-Built Bottom Hole coordinates are
 NAD 27 N: 412,162.884 E: 1,639,537.440
 NAD 27 Lat: 39.624577 Long: -80.779723
 NAD 83 UTM N: 4,386,122.231 E: 518,920.826
 West Virginia Coordinates system of 1927 (North Zone)
 based upon Differential GPS Measurements
 Plat orientation, Corner and well ties are based upon
 the grid north meridian
 Well location references are based upon the grid north
 meridian.
 UTM coordinates are NAD83, Zone 17, Meters.

LEGEND

- ⊕ Active Well Location
- Proposed Gas Well
- Located Corner, as noted
- Surface Tract Lines
- Reference Line
- Lease Boundary
- Creek or Drain
- ⊙ WV County Route
- ⊠ WV State Route

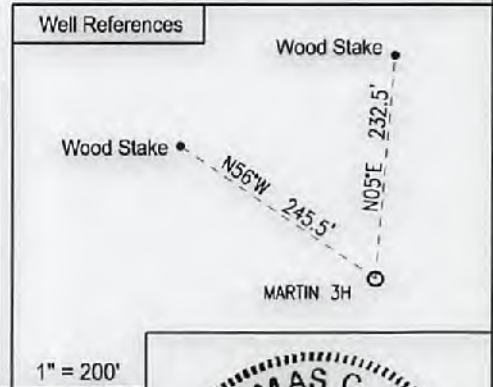
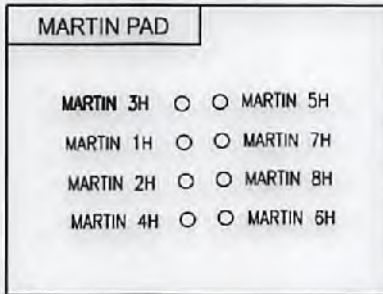

I, the undersigned, hereby certify that this plat is correct to the best of my knowledge and belief and shows all the information required by law and the regulations issued and prescribed by the Department of Environmental Protection.

Thomas C. Smit
 L. L. S. 687

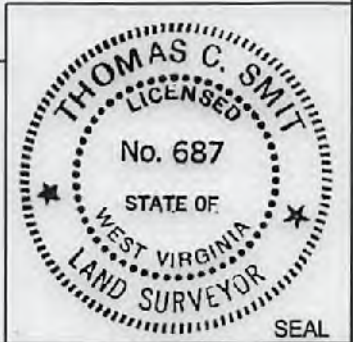

FILE NO: W2174 (BK 59-37)
 DRAWING NO:
 SCALE: 1" = 1000'
 MINIMUM DEGREE OF ACCURACY:
 1:2500
 PROVEN SOURCE OF ELEVATION:
 SG-GPS (OPUS)

STATE OF WEST VIRGINIA
 DEPARTMENT OF ENVIRONMENTAL PROTECTION
 OIL AND GAS DIVISION

DATE: SEPTEMBER 8 20 17
 OPERATORS WELL NO: MARTIN 3H
 API WELL NO: **H6A**
 47 - 103 - 02923 F
 STATE COUNTY PERMIT

WELL TYPE: OIL GAS LIQUID INJECTION WASTE DISPOSAL
 (IF GAS) PRODUCTION: STORAGE DEEP SHALLOW

LOCATION ELEVATION: 920' WATERSHED: LITTLE FISHING CREEK QUADRANGLE: PORTERS FALLS 7.5'
 DISTRICT: Green COUNTY: Wetzel

SURFACE OWNER: Charles & Gwendolyn Martin ACREAGE: 54 ±
 ROYALTY OWNER: SNS Ventures, LLC et al LEASE NO: 873397 ACREAGE: 105 ±

PROPOSED WORK: DRILL CONVERT DRILL DEEPER FRACTURE OR STIMULATE PLUG OFF OLD FORMATION
 PERFORATE NEW FORMATION OTHER PHYSICAL CHANGE IN WELL (SPECIFY)
 PLUG AND ABANDON CLEAN OUT AND REPLUG TARGET FORMATION: Marcellus ESTIMATED DEPTH: 6,600'

WELL OPERATOR: EQT Production Company DESIGNATED AGENT: Rex C. Ray
 ADDRESS: 115 Professional Place PO Box 280 ADDRESS: 115 Professional Place PO Box 280
 Bridgeport, WV 26330 Bridgeport, WV 26330

AS-BUILT