

I, THE UNDERSIGNED, HEREBY CERTIFY THAT THIS PLAT IS CORRECT TO THE BEST OF MY KNOWLEDGE AND BELIEF AND SHOWS ALL THE INFORMATION REQUIRED BY LAW AND THE REGULATIONS ISSUED AND PRESCRIBED BY THE DIVISION OF ENVIRONMENTAL PROTECTION.

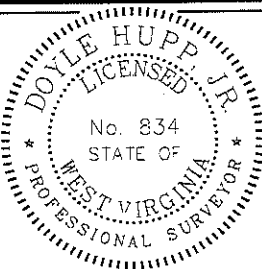

(+) DENOTES LOCATION OF WELL ON UNITED STATES TOPOGRAPHIC MAPS.  
 DATE NOVEMBER 7, 20 11  
 OPERATORS WELL NO. MILLS WETZEL #21H  
 API WELL NO. 47-103-62712H-4  
 STATE COUNTY PERMIT

P.S. 834  
 HUPP Surveying & Mapping  
 P.O. Box 647 Grantsville, WV 26147  
 (304) 354-7035 EMAIL: hupp@frontiernet.net

MINIMUM DEGREE OF ACCURACY 1/2500 FILE NO. W1719 (BK51-49)  
 PROVEN SOURCE OF ELEVATION SG-GPS (OPUS) SCALE 1" = 1000'

STATE OF WEST VIRGINIA  
 DIVISION OF ENVIRONMENTAL PROTECTION  
 OFFICE OF OIL AND GAS

WELL TYPE: OIL  GAS  LIQUID INJECTION  WASTE DISPOSAL  IF "GAS" PRODUCTION  STORAGE  DEEP  SHALLOW

LOCATION: ELEVATION 1335' WATERSHED TRIBUTARY OF PINEY FORK  
 DISTRICT GREEN COUNTY WETZEL QUADRANGLE PINE GROVE 7.5'

SURFACE OWNER WEST VIRGINIA CONSERVATION COMMISSION ACREAGE 5104.5 ±  
 ROYALTY OWNER MILLS WETZEL LAND Inc. LEASE ACREAGE 5104.5± LEASE NO. \_\_\_\_\_

PROPOSED WORK: DRILL  CONVERT  DRILL DEEPER  REDRILL  FRACTURE OR STIMULATE  PLUG OFF OLD FORMATION  PERFORATE NEW FORMATION  PLUG AND ABANDON  CLEAN OUT AND REPLUG  OTHER \_\_\_\_\_

PHYSICAL CHANGE IN WELL (SPECIFY) \_\_\_\_\_ TARGET FORMATION MARCELLUS  
 ESTIMATED DEPTH 7,370 TVD 13,340' MD

WELL OPERATOR STONE ENERGY CORPORATION DESIGNATED AGENT TIM MCGREGOR  
 ADDRESS P.O. BOX 52807 LAFAYETTE, LA 70508 ADDRESS 6000 HAMPTON CENTER SUITE 5 MORGANTOWN, WV 26505

103-0276216A

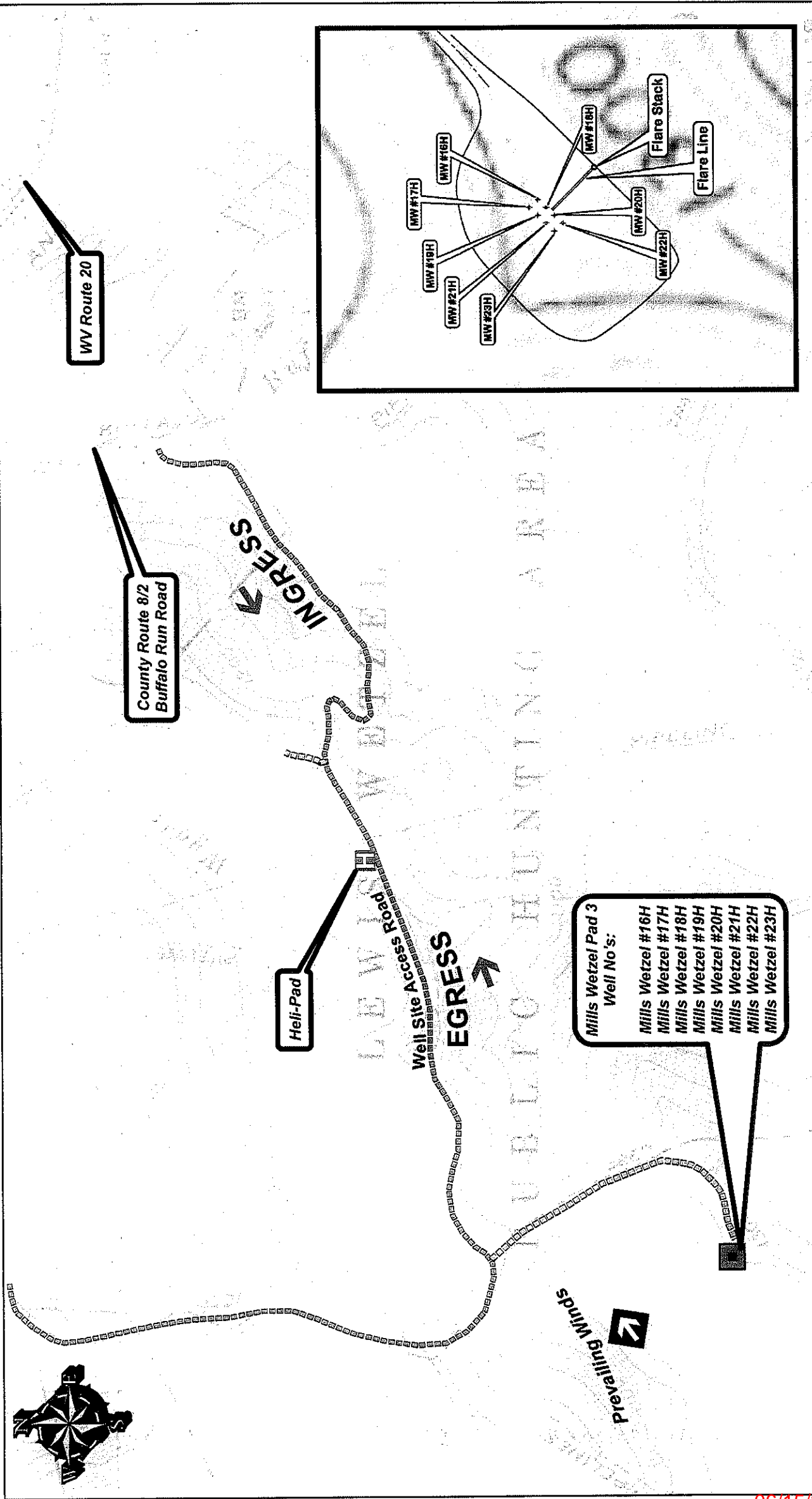
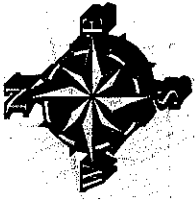

- Mills Wetzel Pad 3**  
Well No's:
- Mills Wetzel #16H
  - Mills Wetzel #17H
  - Mills Wetzel #18H
  - Mills Wetzel #19H
  - Mills Wetzel #20H
  - Mills Wetzel #21H
  - Mills Wetzel #22H
  - Mills Wetzel #23H



1 inch = 1,000 feet

Date: 11/14/2011

**STONE ENERGY - MILLS WETZEL PAD "3"**  
WETZEL COUNTY, WV



06/15/2012