

SURFACE HOLE
 UTM, NAD83, ZONE 17
 N) 4,376,417
 E) 525,999
 NAD 27
 DEC. LAT.) 39.53694
 DEC. LONG.) 80.69763
 LAT.) 39-32-13.0
 LONG.) 80-41-51.5

BOTTOM HOLE
 UTM, NAD83, ZONE 17
 N) 4,376,535
 E) 525,048
 NAD 27
 DEC. LAT.) 39.53803
 DEC. LONG.) 80.70869
 LAT.) 39-32-16.9
 LONG.) 80-42-31.3

**NOTE: BORE PATH
 BASED ON GRID NORTH.**

REFERENCE NOTES
 LEASE AS SHOWN TAKEN
 FROM DEED BOOK 118/339.
 OWNERSHIP TAKEN FROM PUBLIC
 RECORDS OF WETZEL COUNTY,
 WV IN SEPTEMBER, 2009.
 LAT./LONG. BY DIFFERENTIAL
 SUBMETER MAPPING GRADE GPS
 DRAFTED BY: J.N.W.

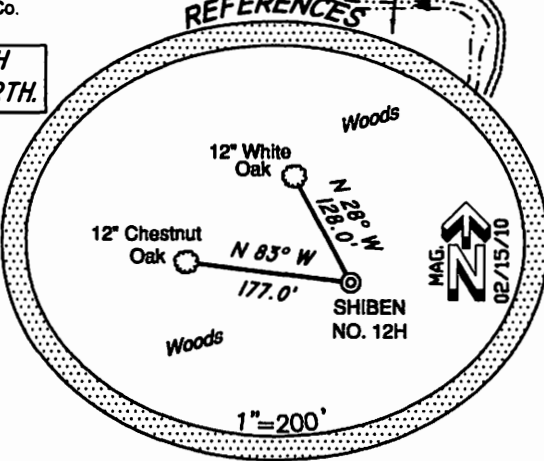
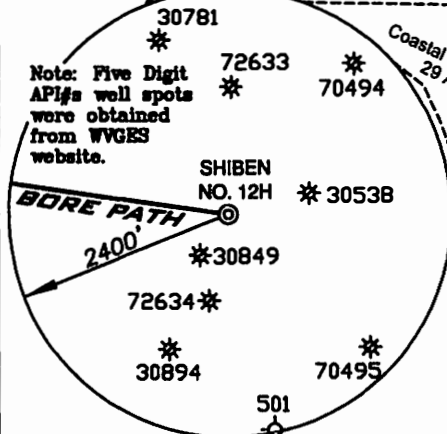

FILENUMBER W090215 (WB16-35)
 DRAWING NUMBER W090215_SHIBEN_12H
 SCALE 1" = 1000'
 MINIMUM DEGREE OF ACCURACY 1/200
 PROVEN SOURCE OF ELEVATION SUBMETER MAPPING GRADE GPS

I THE UNDERSIGNED HEREBY CERTIFY THAT THIS PLAT IS CORRECT TO THE BEST OF MY KNOWLEDGE AND BELIEF AND SHOWS ALL THE INFORMATION REQUIRED BY LAW AND THE REGULATIONS ISSUED AND PRESCRIBED BY THE DEPARTMENT OF ENVIRONMENTAL PROTECTION

P.S. 2122 *Jonathan N. White*

STATE OF WEST VIRGINIA
 DIVISION OF ENVIRONMENTAL PROTECTION
 OFFICE OF OIL AND GAS

DATE: MAY 10, 2010

WELL TYPE: OIL GAS LIQUID INJECTION WASTE DISPOSAL
 (IF "GAS") PRODUCTION STORAGE DEEP SHALLOW
 LOCATION ELEVATION 1071' WATERSHED _____ TRIBUTARY OF PINEY FORK

OPERATORS WELL NO. SHIBEN NO. 12H
 API WELL NO. 47-103-02610H

DISTRICT GREEN COUNTY WETZEL
 QUADRANGLE PINE GROVE 7.5' LEASE NUMBER _____

SURFACE OWNER THELMA WICHTERMAN ACREAGE 156
 OIL & GAS ROYALTY OWNER SHIBEN ESTATES INC. LEASE ACREAGE 500

PROPOSED WORK: DRILL CONVERT DRILL DEEPER REDRILL FRACTURE OR STIMULATE PLUG OFF OLD FORMATION
 PERFORATE NEW FORMATION OTHER PHYSICAL CHANGE (SPECIFY) _____

TARGET FORMATION MARCELLUS PLUG & ABANDON CLEANOUT & REPLUG
 ESTIMATED DEPTH 1053' + Horizontal Leg

WELL OPERATOR GASTAR EXPLORATION USA, INC. DESIGNATED AGENT WILLIAM M. HERLIHY
 ADDRESS 1331 LAMAR, SUITE 1080, HOUSTON, TX 77010 ADDRESS P.O. BOX 273, CHARLESTON, WV 25301-0273

CANCELLED

04/19/2013