

INSTRUCTIONS

1) Attach a photo copy of

th  
mi  
Lo  
we

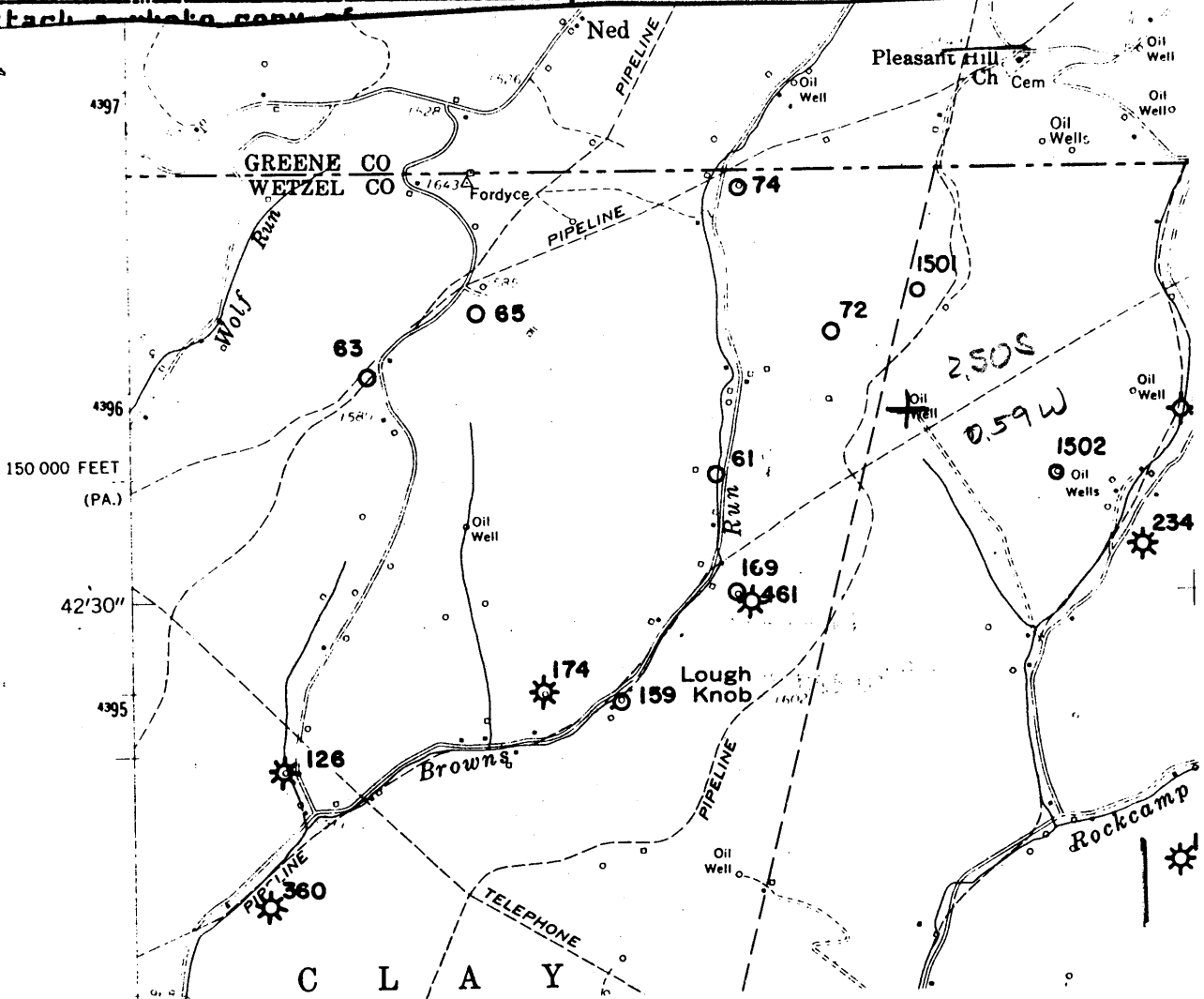

I, the undersigned, hereby certify that this plat is correct to the best of my knowledge and belief.

SIGNED

*Dianne Hostutler*

TITLE

*partner/sec.*

DATE Oct. 26, 1994

OPERATORS WELL NO. Phillips #1

API WELL NO. 103-1646-N

*alc 15' loc  
250S  
281W*

STATE OF WEST VIRGINIA  
DEPARTMENT OF ENERGY  
OIL AND GAS DIVISION

WELL TYPE: OIL  GAS  LIQUID INJECTION  WASTE DISPOSAL   
(IE "GAS" PRODUCTION  STORAGE  DEEP  SHALLOW

LOCATION: ELEVATION 1300 est. WATER SHED (2)  
DISTRICT Church COUNTY Wetzel  
QUADRANGLE Hundred 403  
*Mannington NW*

SURFACE OWNER \_\_\_\_\_ ACREAGE \_\_\_\_\_

OIL & GAS ROYALTY OWNER \_\_\_\_\_ LEASE ACREAGE \_\_\_\_\_  
LEASE NO. \_\_\_\_\_

PRODUCING FORMATION \_\_\_\_\_ TOTAL DEPTH \_\_\_\_\_

WELL OPERATOR CTI Oil & Gas Company DESIGNATED AGENT Dianne Hostutler

ADDRESS P.O. Box 395 ADDRESS P.O. Box 395  
Hundred, WV 26575 Hundred, WV 26575

STATE OF WEST VIRGINIA  
DIVISION OF ENVIRONMENTAL PROTECTION  
SECTION OF OIL AND GAS

WELL REGISTER ASSIGNMENT

This API Number 47-103-01646, issued to C & J OIL & GAS COMPANY is evidence of permission to operate the well that is referenced at the location described on the attached plat, subject to the provisions of Chapters 22 and 22B of the West Virginia Code of 1931, as amended, and all rules and regulations promulgated thereunder. The name and telephone number of the Oil and Gas Inspector for this well is RANDAL MICK -  
304-986-3324.

Spills or emergency discharges must be reported to 1-800-654-3312.

Failure to abide by all statutory and regulatory provisions governing all duties and operations hereunder may result in suspension or revocation of your permits and in addition may result in civil and/or criminal penalties.

The enclosed WR-35 must be completed by you and returned to this office. In addition annual production reports must be submitted on this well and failure to do so may require you to plug the well.

Theodore M. Streit  
Chief

By: 

Title: \_\_\_\_\_

Operator's Well No: PHILLIPS #1

Farm Name: PHILLIPS

API Well Number : 47-103-01646 N

Date Issued : 12/01/94

was 71082

JH Himelrick (3187)