

1) Attach a photo copy of the location of the well on a 7.5 minute Quadrangle with the corresponding longitude and Latitude.

2) Designate the location of the well with the symbol (+).

MAP Ref.

31° 42' 30"

W.V. New Martinsville, (6) N.E.

QUADRANGLE (304)

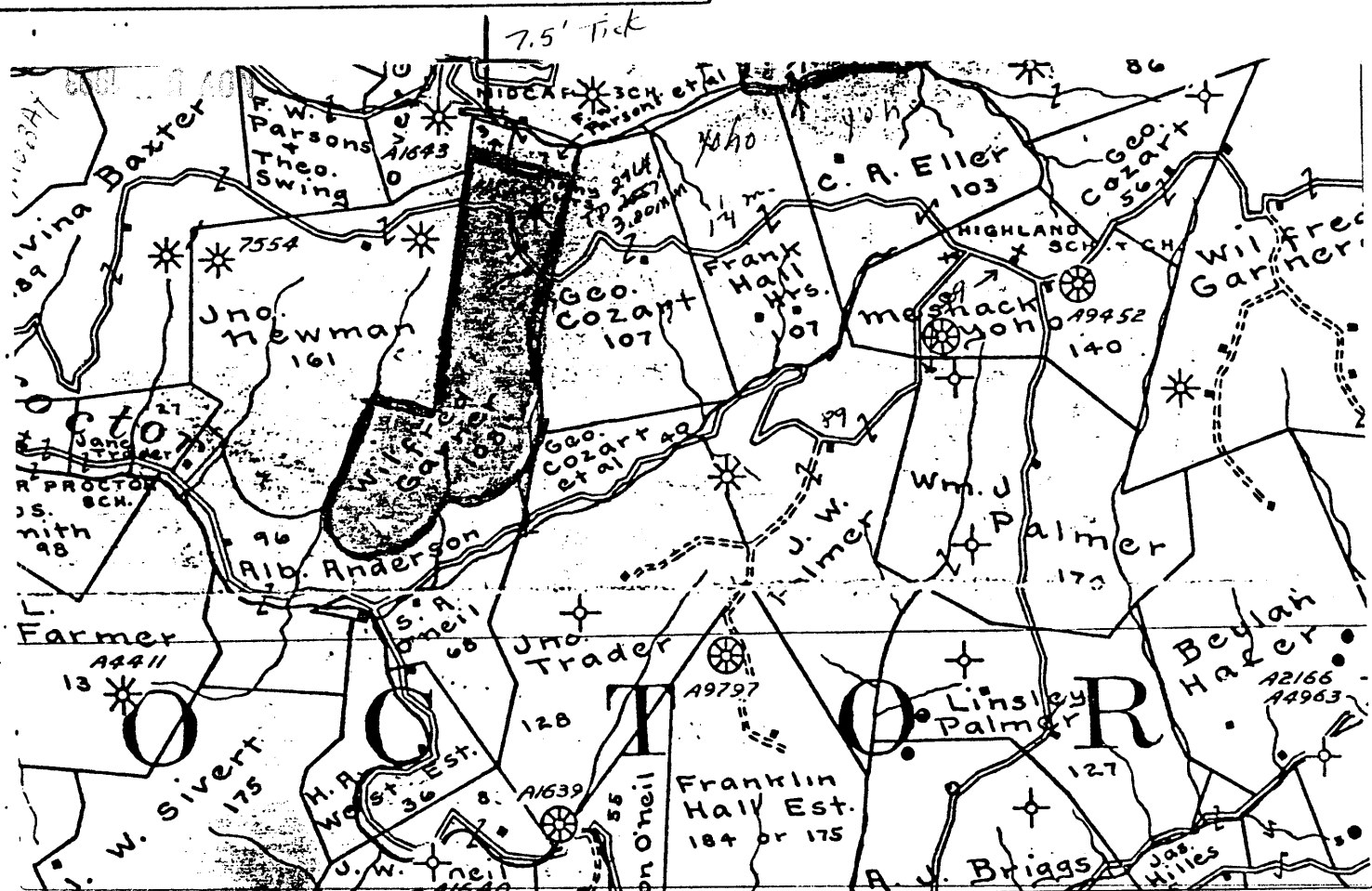

I, the undersigned, hereby certify that this plat is correct to the best of my knowledge and belief.

SIGNED Richard C. ...
TITLE President

Well NAME - Henry GARNER

DATE 1/8, 1993

RECEIVED
WV Department of Energy
Environmental Protection
JAN 26 93
Permitting
Office of Oil & Gas

OPERATORS WELL NO. _____
API WELL NO. 103-1555-N

STATE OF WEST VIRGINIA
DEPARTMENT OF ENERGY
OIL AND GAS DIVISION

TYPE OF WELL: OIL _____ GAS LIQUID INJECTION _____ WASTE DISPOSAL _____
" PRODUCTION STORAGE _____ DEEP _____ SHALLOW _____

LOCATION: ELEVATION 960 EST WATER SHED LEFT Fork of Proctor Creek
DISTRICT Proctor COUNTY Wetzel
QUADRANGLE New Martinsville 509

SURFACE OWNER _____ ACREAGE _____
OIL & GAS ROYALTY OWNER _____ LEASE ACREAGE 102
LEASE NO. _____

PRODUCING FORMATION _____ TOTAL DEPTH 2866

OPERATOR Greensridge Oil Co. DESIGNATED AGENT John Lavelle
ADDRESS R.D.#1 Box 267 ADDRESS RD 1 Box 72
New Freeport, PA 15352 Knob Fork, WV 26579
New Martinsville

Latitude

70° 45'

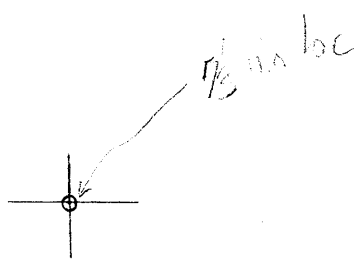

Longitude

Topo Location

7.5' Loc. 0.585 15' Loc. _____
1.946 (calc.) _____

Company Green Ridge Oil Co.
 Farm Henry Garner
 15' Quad New Martinsville
 (sec.)
 7.5' Quad New Martinsville
 District Proctor

WELL LOCATION PLAT

County 103 Permit 1555-11

O'Neil - Garner. No. 450 Well (296A)
(Lease 1,912, Milford M. Garner - 102 acres)

103-1555-1

Proctor Dist., Wetzel Co., W. Va.; on hill south of
Left Fork of Proctor Creek 2.1 miles S 15° E of Proctor
completed June 9, 1903; by _____
purchased June 17, 1903; by Hope Natural Gas Co.; *Copy deeper*
June 10, 1908; elevation _____.

	Top Feet	Bottom Feet
Sand, <u>Gordon</u>	2854	2866

Gordon Sand gas well; 3,041,000 cu. ft.
Rock pressure, 635 lbs.
Deeper drilling was dry.