

2500' 5/28/71 CEN

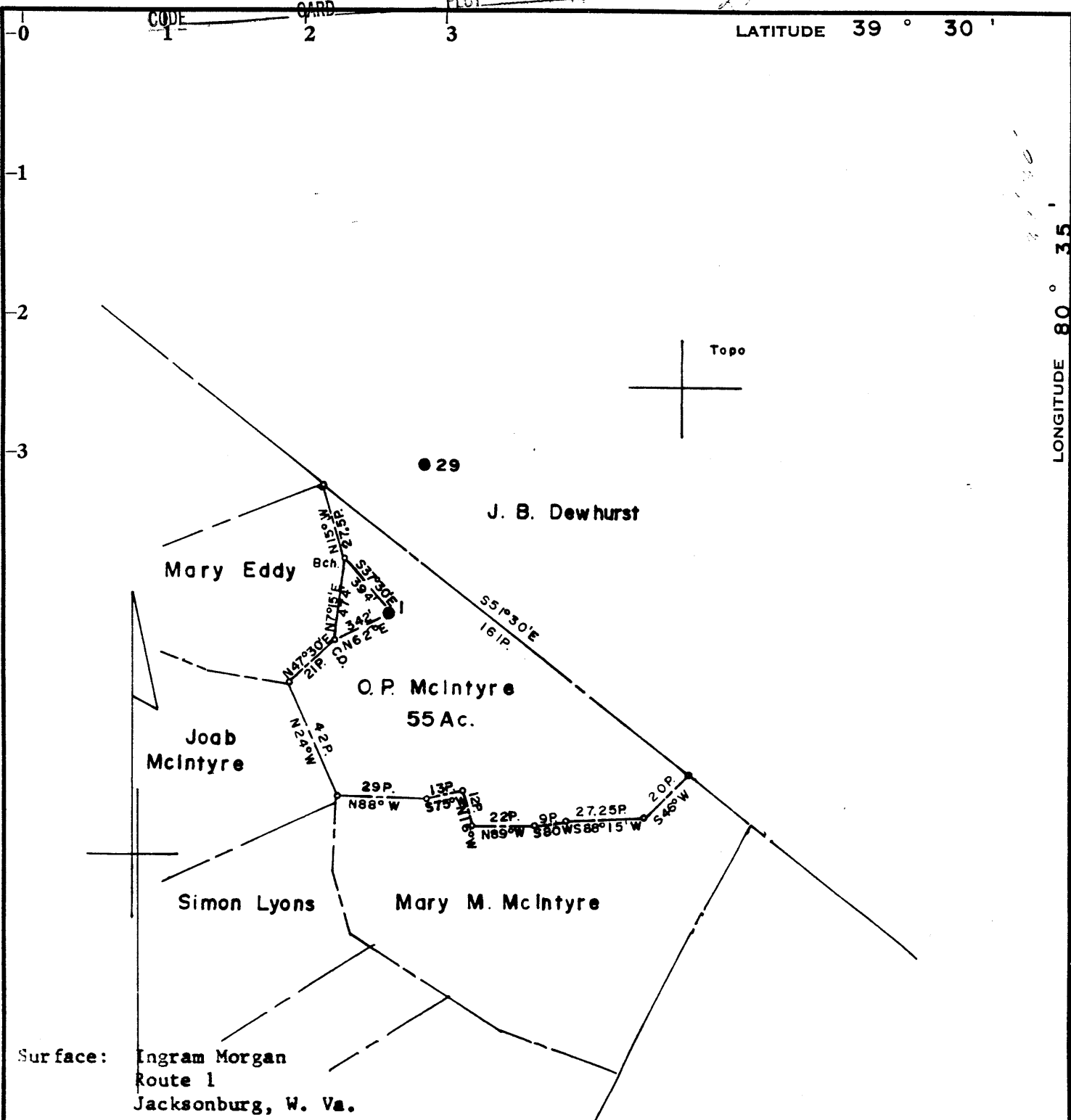

Surface: Ingram Morgan
Route 1
Jacksonburg, W. Va.

Coal: Consolidation Coal Co. Minimum Error of Closure: 1' in 200'

Source of Elevation: J. B. Dewhurst Well No. 29

Elevation: 1072.89' Gr.

Fracture *710-22-84*
6-4-71
 New Location
 Drill Deeper
 Abandonment

I, the undersigned, hereby certify that this map is correct to the best of my knowledge and belief and shows all the information required by paragraph 6 of the rules and regulations of the oil and gas section of the mining laws of West Virginia.

Signed: *A.C. Hilbert*

Map No. N48 Squares: N I S E W I

Company	PENNZOIL UNITED, INC.		
Address	P. O. Box 1588, Parkersburg, W. Va.		
Farm	O. P. McIntyre		
Tract	Acres	55	Lease No. 72453
Well (Farm) No.	1	Serial No.	
Elevation (Spirit Level)	1404.73' Gr.		
Quadrangle	Centerpoint		
County	Wetzel	District	Grant
Engineer	<i>A.C. Hilbert</i>		
Engineer's Registration No.	2534		
File No.	1523	Drawing No.	
Date	May 27, 1971 Scale 1" = 800'		

STATE OF WEST VIRGINIA
DEPARTMENT OF MINES
OIL AND GAS DIVISION
CHARLESTON

WELL LOCATION MAP

FILE NO. *West to Inman Trans to Wet - 1166 Frac*

+ Denotes location of well on United States Topographic Maps, scale 1 to 62,500, latitude and longitude lines being represented by border lines as shown.

OCT 29 1984

- Denotes one inch spaces on border line of original tracing.

2500' 5/28/71 CEN

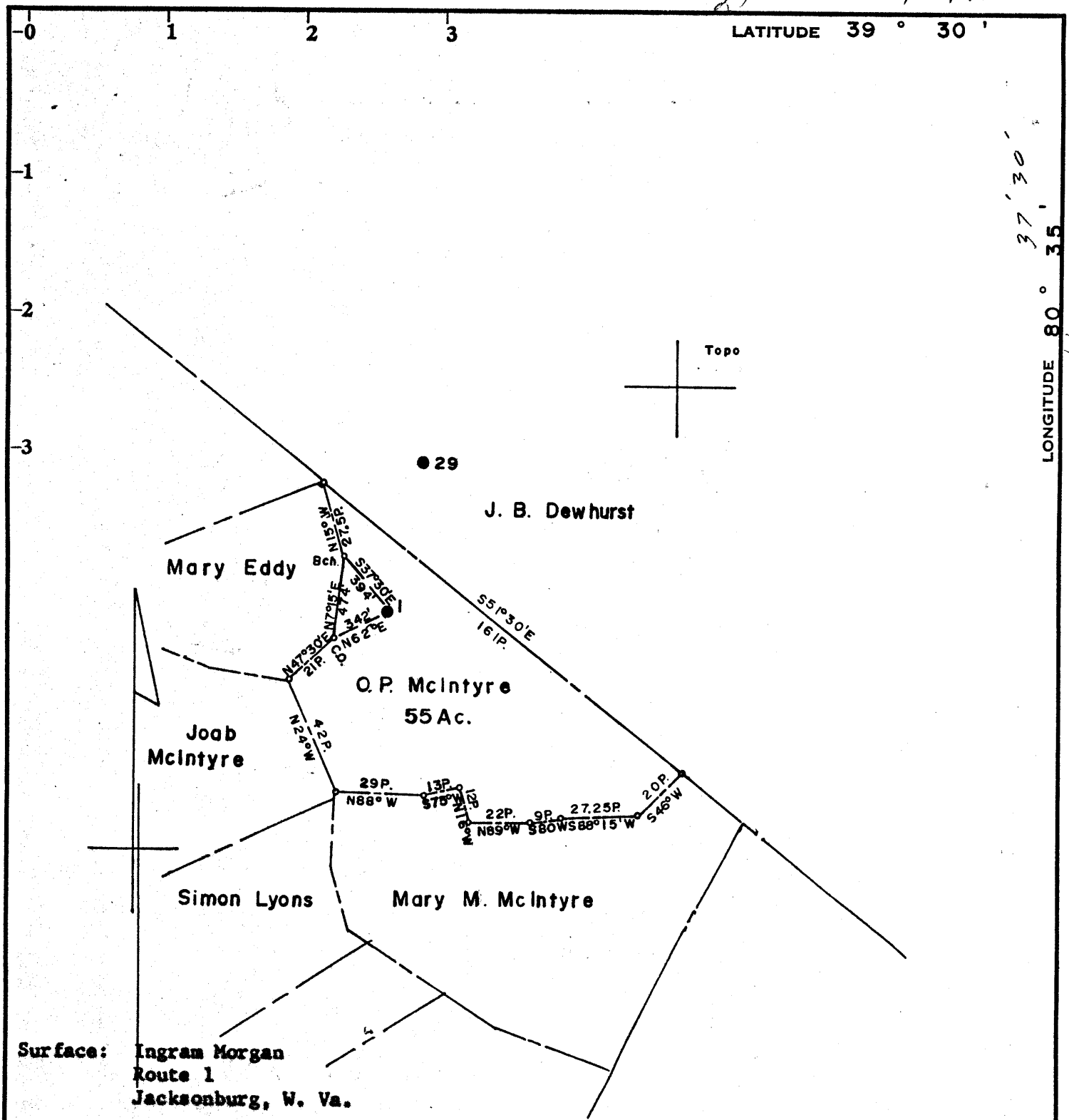

LONGITUDE 80° 35' 37" 30'

Coal: Consolidation Coal Co. Minimum Error of Closure 1' in 200'

Source of Elevation J. B. Dewhurst Well No. 29

Elevation: 1072.89' Gr.

Fracture..... 710-22-84
 New Location.....
 Drill Deeper.....
 Abandonment.....

I, the undersigned, hereby certify that this map is correct to the best of my knowledge and belief and shows all the information required by paragraph 6 of the rules and regulations of the oil and gas section of the mining laws of West Virginia.

Signed: A.C. Hilbert
 Map No. N48 Squares: N 1 S E W 1

Company	PENNZOIL UNITED, INC.		
Address	P. O. Box 1588, Parkersburg, W. Va.		
Farm	O. P. McIntyre		
Tract	Acres	Lease No.	72453
Well (Farm) No.	1	Serial No.	
Elevation (Spirit Level)	1404.73' Gr.		
Quadrangle	Centerpoint		
County	Wetzel	District	Grant
Engineer	<u>A.C. Hilbert</u>		
Engineer's Registration No.	2534		
File No.	1523	Drawing No.	
Date	May 27, 1971		
	Scale	1" = 800'	

STATE OF WEST VIRGINIA
 DEPARTMENT OF MINES
 OIL AND GAS DIVISION
 CHARLESTON

WELL LOCATION MAP

FILE NO. West to Inman Trans. to: West-1166 Frac.

+ Denotes location of well on United States Topographic Maps, scale 1 to 62,500, latitude and longitude lines being represented by border lines as shown.

- Denotes one inch spaces on border line of original tracing.

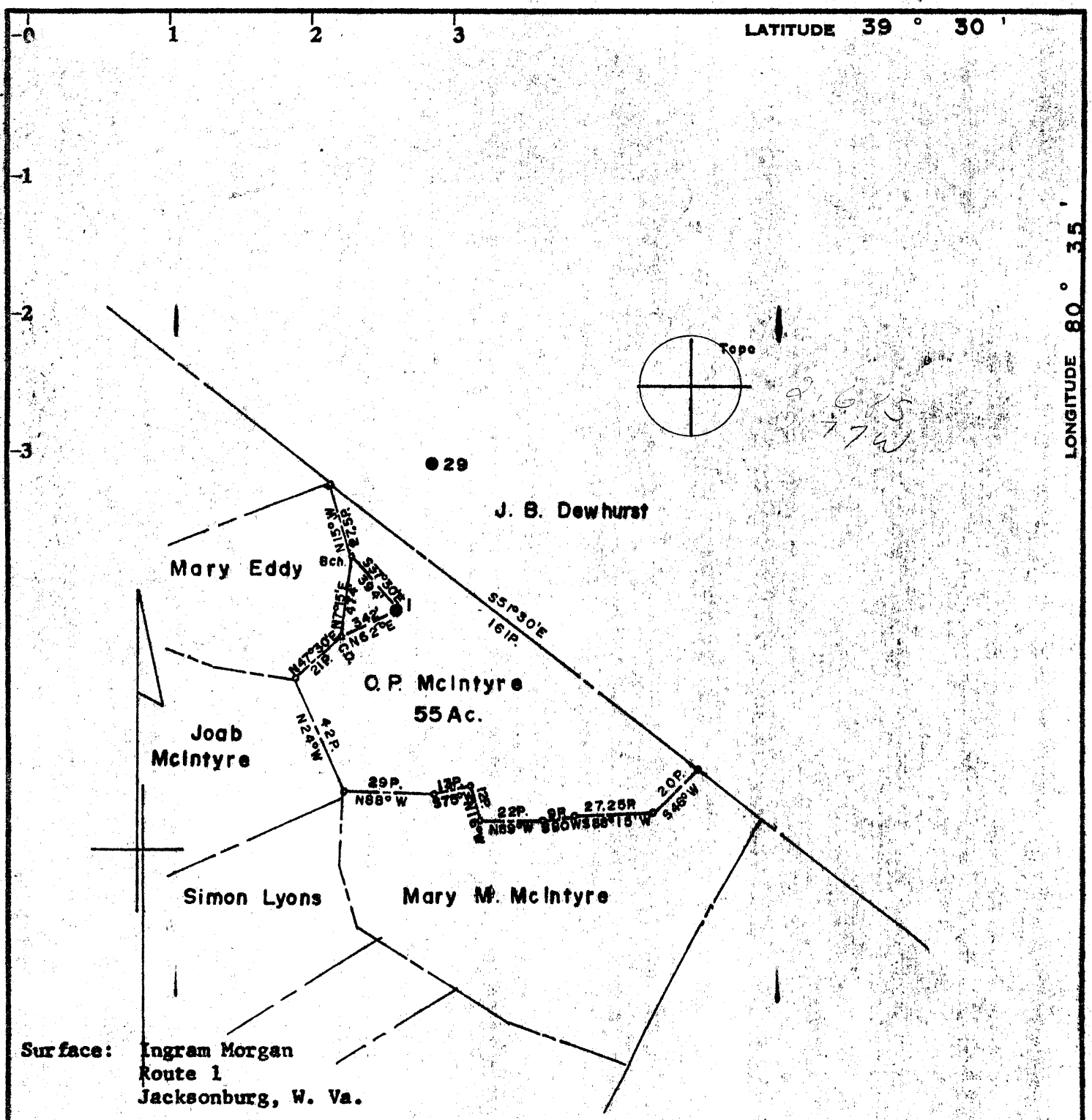

Surface: Ingram Morgan
Route 1
Jacksonburg, W. Va.

Coal: Consolidation Coal Co. Minimum Error of Closure 1' in 200'

Source of Elevation J. B. Dewhurst Well No. 29
Elevation: 1072.89' Gr.

Fracture 6-4-71
New Location
Drill Deeper
Abandonment

I, the undersigned, hereby certify that this map is correct to the best of my knowledge and belief and shows all the information required by paragraph 6 of the rules and regulations of the oil and gas section of the mining laws of West Virginia.

Signed: A. H. Hilbert
Map No. N48 Squares: N 1 S E W 1

Company	PENNZOIL UNITED, INC.		
Address	P. O. Box 1588, Parkersburg, W. Va.		
Farm	O. P. McIntyre		
Tract	Acres	Lease No.	72453
Well (Farm) No.	1	Serial No.	
Elevation (Spirit Level)	1404.73' Gr.		
Quadrangle	Centerpoint <u>NC</u>		
County	Wetzel	District	Grant
Engineer	<u>A. H. Hilbert</u>		
Engineer's Registration No.	2534		
File No.	1523	Drawing No.	
Date	May 27, 1971 Scale 1" = 800'		

STATE OF WEST VIRGINIA
DEPARTMENT OF MINES
OIL AND GAS DIVISION
CHARLESTON

WELL LOCATION MAP

FILE NO. Wet-6-200
now Wetzel 1166W

+ Denotes location of well on United States Topographic Maps, scale 1 to 62,500, latitude and longitude lines being represented by border lines as shown.

— Denotes one inch spaces on border line of original tracing.

SEP 29 1971

PENNZOIL UNITED, Inc.

601 GRAND CENTRAL AVE. • VIENNA, W. VA. 26101 • PHONE 304 422-6565

Mailing Address: P. O. Drawer 1588, Parkersburg, West Virginia 26101

E. NOLL

September 17, 1971

Mr. Robert L. Dodd, Deputy Director
Oil and Gas Division
Department of Mines
2000 Quarrier Street
Charleston, West Virginia 25305

Dear Mr. Dodd:

FRACTURE RECORD

Well Name and No: O. P. McIntire No. 1

District: Grant County: Wetzel

Permit No: WET-6 FRAC ³⁹⁻³⁰ CP 2-32 Completion Date: 9-9-71

Formation fractured: Top - 2284 Material - Sand: 18,000#
Big Injan Bottom - 2301 Fluid: 1,000 gal. acid
715 bbls. water

Rock Pressure: Test After Fracture:
Before fracture - 22# Oil - 13 to 20 BOPD
After fracture - Not Taken Gas - Not Tested

Very truly yours,

PENNZOIL UNITED, INC.

By Fritz Gesch, Jr.
Fritz Gesch, Jr.
District Superintendent

SEP 28 1971



1) Date: October 1, 1984
 2) Operator's Well No. O.P. McIntyre, No. 1
 3) API Well No. 47 - 103 - 0006-FRAC
 State County Permit
 NOW: 47 - 103 - 1166-FRAC

STATE OF WEST VIRGINIA
 DEPARTMENT OF MINES, OIL AND GAS DIVISION
 APPLICATION FOR A WELL WORK PERMIT

- 4) WELL TYPE: A Oil Gas B (If "Gas", Production Underground storage Deep Shallow)
- 5) LOCATION: Elevation: 1404.73' Watershed: Buffalo Run District: Grant County: Wetzel Quadrangle: Centerpoint
- 6) WELL OPERATOR Pennzoil Company 7) DESIGNATED AGENT James A. Crews
 Address P. O. Box 1588 Address P.O. Box 1588
Parkersburg, W. Va. 26102 Parkersburg, W. Va.
- 8) OIL & GAS INSPECTOR TO BE NOTIFIED Name Robert Lowther 9) DRILLING CONTRACTOR:
 Address General Delivery Name _____
Middlebourne, W. Va. 26149 Address _____
- 10) PROPOSED WELL WORK: Drill / Drill deeper / Redrill / Stimulate /
 Plug off old formation / Perforate new formation /
 Other physical change in well (specify) _____
- 11) GEOLOGICAL TARGET FORMATION, Maxton
- 12) Estimated depth of completed well, 2304 feet
- 13) Approximate trata depths: Fresh, _____ feet; salt, _____ feet.
- 14) Approximate coal seam depths: _____ Is coal being mined in the area? Yes / No
- 15) CASING AND TUBING PROGRAM

CASING OR TUBING TYPE	SPECIFICATIONS					FOOTAGE INTERVALS		CEMENT FILL-UP OR SACKS (Cubic feet)	PACKERS
	Size	Grade	Weight per ft.	New	Used	For drilling	Left in well		
Conductor									Kinds Sizes Depths set Packers set Bottom
Fresh water									
Coal									
Intermediate									
Production									
Tubing									
Liners									

RECEIVED
 OCT - 5 1984
 OIL & GAS DIV.
 DEPT. OF MINES

OFFICE USE ONLY
 DRILLING PERMIT

Permit number 47-103-0006-Frac Date October 22, 19 84

This permit covering the well operator and well location shown below is evidence of permission granted to drill in accordance with the pertinent legal requirements subject to the conditions contained herein and on the reverse hereof. Notification must be given to the District Oil and Gas Inspector, (Refer to No. 8) Prior to the construction of roads, locations and pits for any permitted work. In addition, the well operator or his contractor shall notify the proper district oil and gas inspector 24 hours before actual permitted work has commenced.)

The permitted work is as described in the Notice and Application, plat, and reclamation plan, subject to any modifications and conditions specified on the reverse hereof.
 Permit expires October 22, 1986 unless well work is commenced prior to that date and prosecuted with due diligence.

Bond:	Agent:	Plat:	Casing	Fee
<u>112</u>	<u>MU</u>	<u>MU</u>	<u>MU</u>	<u>18064</u>

Margaret J. Hass
 Administrator, Office of Oil and Gas

NOTE: Keep one copy of this permit posted at the drilling location.

See the reverse side of the APPLICANT'S COPY for instructions to the well operator.

File

10/2