

Fracture.....
 New Location.....
 Drill Deeper.....
 Abandonment.....

I, the undersigned, hereby certify that this map is correct to the best of my knowledge and belief and shows all the information required by paragraph 6 of the rules and regulations of the oil and gas section of the mining laws of West Virginia.

Signed: Mustard J.
 Map No. _____ Squares: N S E W

Company CARNEGIE NATURAL GAS CO.
 Address Munhall, Pennsylvania
 Farm Mike Barr
 Tract _____ Acres 1004 Lease No. F-6740-74
 Well (Farm) No. 3 Serial No. 215
 Elevation (Spirit Level) 843
 Quadrangle Littleton
 County Wetzel District Grant
 Engineer Mustard J.
 Engineer's Registration No. 1227
 File No. _____ Drawing No. _____
 Date July 3, 1970 Scale 1" = 80P = 1320'

STATE OF WEST VIRGINIA
 DEPARTMENT OF MINES
 OIL AND GAS DIVISION
 CHARLESTON

WELL LOCATION MAP

FILE NO. WET-5-Proc. Trans.
to wet-1165

+ Denotes location of well on United States Topographic Maps, scale 1 to 62,500, latitude and longitude lines being represented by border lines as shown.

- Denotes one inch spaces on border line of original tracing.

add to 2-10-95
 sent from Chas

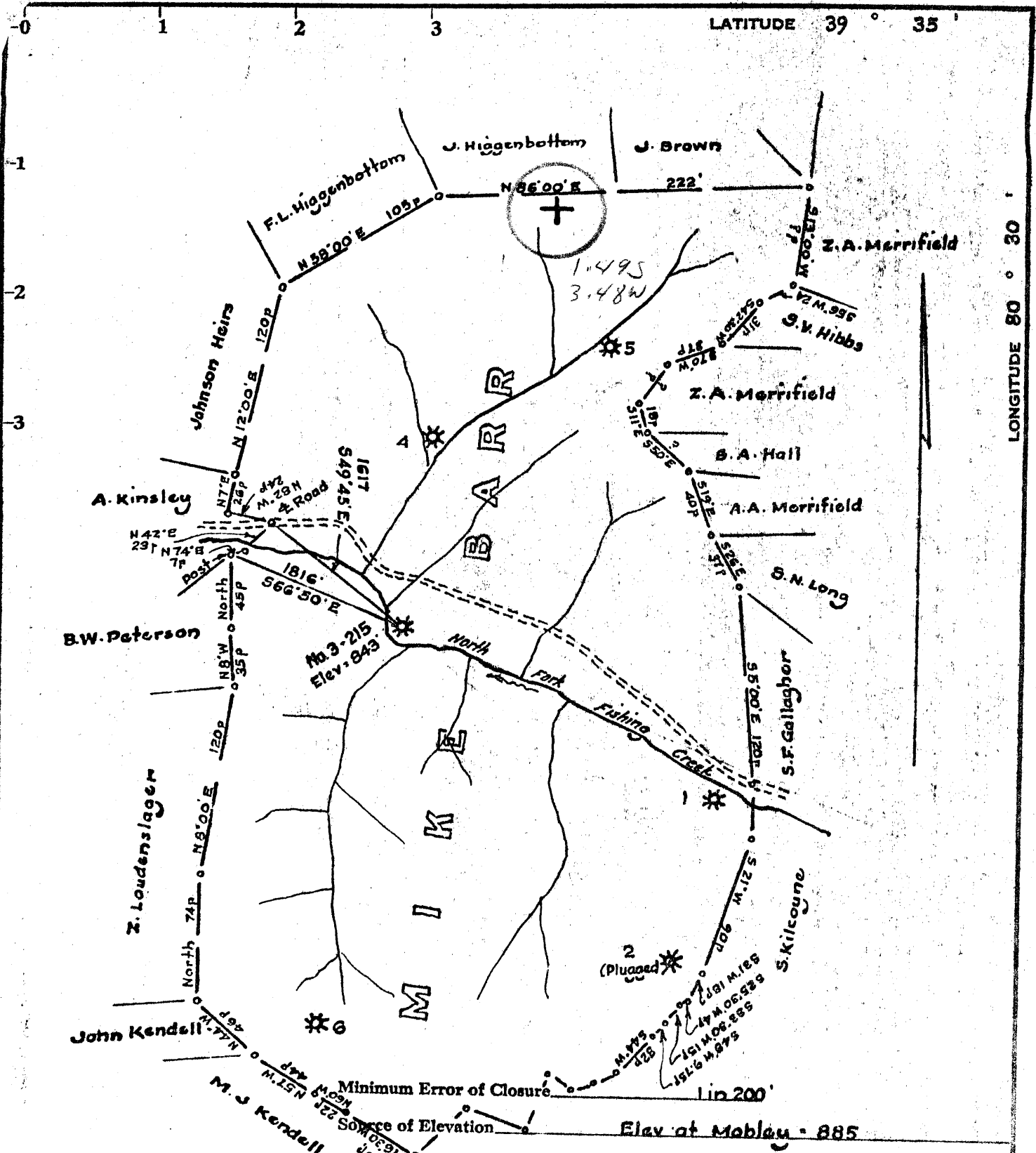

- Fracture.....
- New Location.....
- Drill Deeper.....
- Abandonment.....

I, the undersigned, hereby certify that this map is correct to the best of my knowledge and belief and shows all the information required by paragraph 6 of the rules and regulations of the oil and gas section of the mining laws of West Virginia.

Signed: W. H. Hester
 Squares: N S E W

Company CARNEGIE NATURAL GAS CO.
 Address Munhall, Pennsylvania
 Farm Mike Barr
 Tract _____ Acres 1004 Lease No. E-6740-7A
 Well (Farm) No. 3 Serial No. 215
 Elevation (Spirit Level) 843
 Quadrangle Littleton SE
 County Netzel District Grant
 Engineer W. H. Hester
 Engineer's Registration No. 1227
 File No. _____ Drawing No. _____
 Date July 3, 1970 Scale 1" = 80p = 1320'

STATE OF WEST VIRGINIA
 DEPARTMENT OF MINES
 OIL AND GAS DIVISION
 CHARLESTON

WELL LOCATION MAP

FILE NO. WET-5-3A

+ Denotes location of well on United States Topographic Maps, scale 1 to 62,500, latitude and longitude lines being represented by border lines as shown.

- Denotes one inch spaces on border line of original tracing.



STATE OF WEST VIRGINIA
DEPARTMENT OF MINES
OIL AND GAS DIVISION

Rotary
Spudder
Cable Tools
Storage

Quadrangle Littleton SE

Permit No. WET-5-FRAC - 1165

WELL RECORD

Oil or Gas Well GAS (KIND)

Company Carnegie Natural Gas Company
Address 390 1/2 Main Street, Munhall, Pa. 15120
Farm Mike Barr Acres 100 1/2
Location (waters) North Fork
Well No. 215 Elev. 843
District Grant County Wetzel
The surface of tract is owned in fee by _____
Address _____
Mineral rights are owned by Hope Natural Gas Company
Address Clarksburg, W. Va.
Drilling commenced Cleaning Out 2/19/71
Drilling completed Cleaning Out 4/15/71
Date Shot _____ From _____ To _____
With _____

Casing and Tubing	Used in Drilling	Left in Well	Packers
Size			Kind of Packer
16			
13			Size of
10			Depth set
8 1/4			
6 3/8			
5 3/16			Perf. top <u>2642</u>
4 1/2			Perf. bottom <u>2650</u>
3	<u>2706</u>	<u>2706</u>	Perf. top _____
2			Perf. bottom _____
Liners Used			

Open Flow _____ /10ths Water in _____ Inch
_____ /10ths Merc. in _____ Inch
Volume 21,061 Cu. Ft.
Rock Pressure 362 lbs. 20 hrs.
Oil _____ bbls., 1st 24 hrs.
Attach copy of cementing record.
Tubing GASING CEMENTED 3" SIZE 200 No. Ft. 5/14/71
Amount of cement used (bags) 60
Name of Service Co. Garaton Service, Inc.
WELL ACIDIZED (DETAILS) _____ FEET _____ INCHES _____ FEET _____ INCHES
WELL FRACTURED (DETAILS) Water frac by Dowell, 5/12/71, 561 bbls water, 26,000# sand

RESULT AFTER TREATMENT (Initial open Flow or bbls.) 212,000 FT³ 212,000 cu ft
ROCK PRESSURE AFTER TREATMENT 515 HOURS 16 Hrs
Fresh Water _____ Feet _____ Salt Water _____ Feet _____
Producing Sand _____ Depth _____

Formation	Color	Hard or Soft	Top	Bottom	Oil, Gas or Water	Depth	Remarks
Pgh. Coal			565	572			
Big Dunkard			1100	1125			
1st Salt Sand			1150	1575			
Big Lime			1785	1815			
Big Injun			1845	2070			
Gordon Sand			2638	2678			
lith Sand			2698	2716	Gas	2700	
Total Depth				2789			
P.B. T.D.				2706			

JUN 28 1971



STATE OF WEST VIRGINIA
DEPARTMENT OF MINES
OIL AND GAS DIVISION
WELL RECORD

Rotary
Spudder
Cable Tools
Storage

Quadrangle Littleton SE

Permit No. WET-5-FRAC

Oil or Gas Well GAS
(KIND)

Company Carnegie Natural Gas Company
Address 390 1/2 Main Street, Minhall, Pa. 15120
Farm Mike Barr Acres 100 1/2
Location (waters) North Fork
Well No. 215 Elev. 843
District Grant County Wetzel
The surface of tract is owned in fee by _____
Address _____
Mineral rights are owned by Hope Natural Gas Company
Address Clarksburg, W. Va.
Drilling commenced Cleaning Out 2/19/71
Drilling completed Cleaning Out 4/15/71
Date Shot _____ From _____ To _____
With _____

Casing and Tubing	Used in Drilling	Left in Well	Packers
Size			Kind of Packer _____
16			
13			Size of _____
10			Depth set _____
8 1/4			
6 3/4			
5 3/16			Perf. top <u>2642</u>
4 1/2	2706	2706	Perf. bottom <u>2650</u>
3			Perf. top _____
2			Perf. bottom _____
Liners Used			

Open Flow _____ /10ths Water in _____ Inch
_____ /10ths Merc. in _____ Inch
Volume 21,061 Cu. Ft.
Rock Pressure 362 lbs. 20 hrs.
Oil _____ bbls., 1st 24 hrs.

Attach copy of cementing record.
Tubing _____
Casing CEMENTED 3" SIZE 200 No. Ft. 5/1/71 Date
Amount of cement used (bags) 60
Name of Service Co. Garaton Service, Inc.
COAL WAS ENCOUNTERED AT 565 FEET 8 1/2 INCHES
_____ FEET _____ INCHES FEET _____ INCHES
_____ FEET _____ INCHES FEET _____ INCHES

WELL ACIDIZED (DETAILS) _____
WELL FRACTURED (DETAILS) Water frac by Dowell, 5/12/71, 561 bbls water, 26,000# sand

RESULT AFTER TREATMENT (Initial open Flow or bbls.) 212,000 FT³ 212,000 cu ft 212 MCFGV
ROCK PRESSURE AFTER TREATMENT 515 HOURS 16 Hrs
Fresh Water _____ Feet _____ Salt Water _____ Feet _____
Producing Sand Gordon Depth _____

Formation	Color	Hard or Soft	Top	Bottom	Oil, Gas or Water	Depth	Remarks
Pgh. Coal			565	572			
Big Dunkard			1100	1125			
1st Salt Sand			1450	1575			
Big Lime			1785	1845			
Big Injun			1845	2070			
Gordon Sand			2638	2678			
4th Sand			2698	2716	Gas	2700	
Total Depth				2789			
P.B. T.D.				2706			

JUN 28 1971

OWWO - No new footage drld.

JUL 2 1971
JUL 2 1971



STATE OF WEST VIRGINIA
DEPARTMENT OF MINES
OIL AND GAS DIVISION

Quadrangle Littleton SE

Permit No. 1165

WELL RECORD

Oil or Gas Well Gas
(KIND)

Company Carnegie Natural Gas Co.
Address 3904 Main St., Munhall, Pa.
Farm Mike Barr Acres 1104-3/4
Location (waters) _____
Well No. 215 Elev. 843
District Grant County Wetzel
The surface of tract is owned in fee by William Kilcoyne
Address Smithfield, W. Va.
Mineral rights are owned by Hope Natural Gas Co.
Address Clarksburg, W. Va.
Drilling commenced Dec. 28, 1909
Drilling completed Mar. 10, 1910
Date Shot 1/1/32 From 2968 To 2710
With 25 qts.
Open Flow /10ths Water in Inch _____
/10ths Merc. in Inch _____

Casing and Tubing	Used in Drilling	Left in Well
Size		
16		
13		
10	407	pulled
8 1/4	1185	pulled
6 3/4	1640	1640
5 3/16	1851	1851
3	2789	2789
2		
Liners Used		

Packers _____
Kind of Packer Anchor Spec.
Size of 5-3/16x3
Depth set 1999
Perf. top 2687
Perf. bottom 2707
Perf. top 2769
Perf. bottom 2789

Volume _____ Cu. Ft. CASING CEMENTED _____ SIZE _____ No. Ft. _____ Date _____
Rock Pressure _____ lbs. _____ hrs. _____
Oil _____ bbls., 1st 24 hrs. COAL WAS ENCOUNTERED AT 565 FEET 84 INCHES
WELL ACIDIZED _____ FEET _____ INCHES _____ FEET _____ INCHES
WELL FRACTURED _____ FEET _____ INCHES _____ FEET _____ INCHES

RESULT AFTER TREATMENT

ROCK PRESSURE AFTER TREATMENT

Fresh Water _____ Feet _____ Salt Water _____ Feet _____

Formation	Color	Hard or Soft	Top	Bottom	Oil, Gas or Water	Depth	Remarks
Pgh. Coal			565	572			
Big Dunkard			1100	1125			
1st Salt Sand			1450	1575			
Big Lime			1785	1845			
Big Injun			1845	2070			
Gordon Sand			2638	2678			
4th Sand			2698	2716	Gas	2700	
Total Depth				2789			

APR 26 1971