

LATITUDE 39° 42' 30"

LONGITUDE 80° 30' 00"

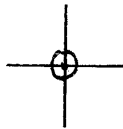

7.5 OGIS topo location

7.5' 10C	<u>2.595</u>	15' 10C	<u>5.475</u>
	<u>1.38W</u>	(calc.)	<u>1.38W</u>

Company _____

Farm _____

Quad LITTLETON ^{NE} 7 1/2'

County WETZEL

District CLAY

WELL LOCATION MAP

File No. 103-1136

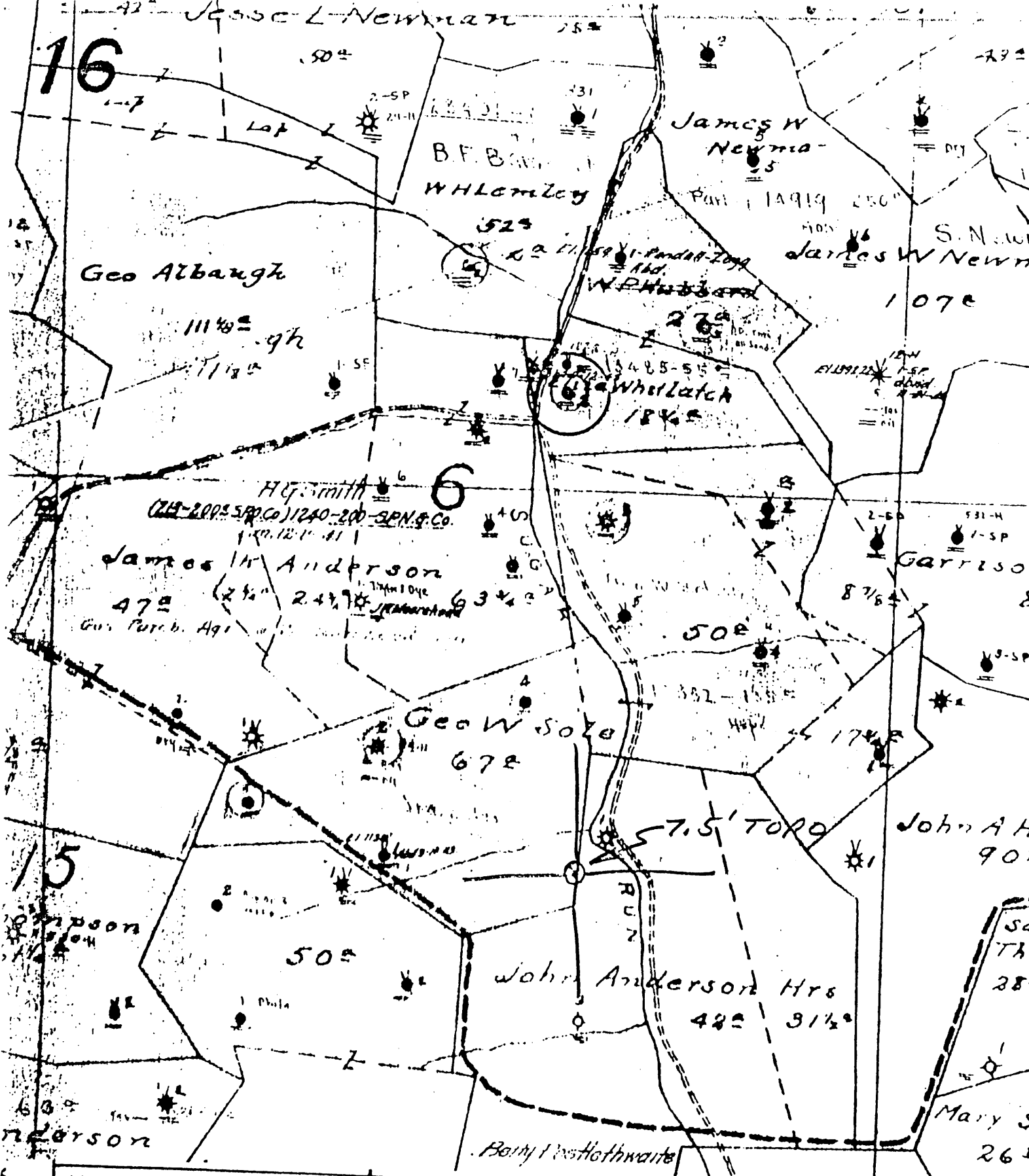

(+) DENOTES LOCATION OF WELL ON UNITED STATES TOPOGRAPHIC MAPS

FORM IV-6
(8-78)
N 79 N16 EC



STATE OF WEST VIRGINIA
DEPARTMENT OF MINES

DATE 1-5-1979
OPERATOR'S WELL NO. 2
API WELL NO. 47-103-1136
STATE COUNTY PERMIT

WELL TYPE: OIL GAS _____ LIQUID INJECTION _____ WASTE DISPOSAL _____
(IF "GAS", PRODUCTION _____ STORAGE _____ DEEP _____ SHALLOW _____)
LOCATION: ELEVATION _____ WATER SHED SUGAR RUN
DISTRICT CLAY COUNTY WETZEL
QUADRANGLE LITTLETON 7.51

SURFACE OWNER _____ ACREAGE _____
OIL & GAS ROYALTY OWNER _____ LEASE NO. _____ LEASE ACREAGE _____

PROPOSED WORK: DRILL _____ CONVERT _____ DRILL DEEPER _____ REDRILL _____ FRACTURE OR
STIMULATE _____ PLUS OFF OLD FORMATION _____ PERFORATE NEW
FORMATION _____ OTHER PHYSICAL CHANGE IN WELL (SPECIFY) _____

PLUS AND ABANDON _____ CLEAN OUT AND REPLUS _____
TARGET FORMATION _____ ESTIMATED DEPTH _____
WELL OPERATOR Pennzoil Company DESIGNATED AGENT James A. Greer
ADDRESS P. O. Box 1588 ADDRESS P. O. Box 1588
Parkersburg, WV 26101 Parkersburg, WV 26101

WW-7
5-02

West Virginia Department of Environmental Protection
Office of Oil & Gas

WELL LOCATION FORM: GPS

API: 47- 103 - 1136 - P WELL NO: No.2
FARM NAME: E. Whitlatch
RESPONSIBLE PARTY NAME: East Resources, Inc.
COUNTY: Wetzel DISTRICT: Clay
QUADRANGLE: Littleton 7.5'
SURFACE OWNER: Ellsworth & Susan Minor
ROYALTY OWNER: East Resources, Inc. et al.
UTM GPS NORTHING: 4,391,087 (NAD 27)
UTM GPS EASTING: 540,649 (NAD 27) GPS ELEVATION: 348 m.

The Responsible Party named above has chosen to submit GPS coordinates in lieu of preparing a new well location plat for a plugging permit on the above well. The Office of Oil & Gas will not accept GPS coordinates that do not meet the following requirements:

1. Datum: NAD 1983, Zone: 17 North, Coordinate Units: meters, Altitude: height above mean sea level (MSL) - meters.
2. Accuracy to Datum - 3.05 meters
3. Data Collection Method:

Survey Grade GPS Post Processed Differential
 Real-Time Differential
Mapping Grade GPS Post Processed Differential
 Real-Time Differential

I the undersigned, hereby certify this data is correct to the best of my knowledge and belief and shows all the information required by law and the regulations issued and prescribed by the Office of Oil and Gas.

Timothy P. Roush
Signature

Professional Surveyor
Title

March 20, 2009
Date

RECEIVED
Office of Oil & Gas
APR 24 2009
WV Department of
Environmental Protection

APR 10 2009

WET 1136 P

Well No. **7507** *E. Whittatch*

Lease No. *blay* Township *Metzel*

Rig built by *A. F. Rice & Bro*

Well drilled by *Andrew Monroe*

Began drilling *Apr 14 1904* Completed *June 14 1904*

Rock Formation	Top	Bottom	Remarks
Conductor		16	Steel
Waple to coal	775	780	578
Pittsburg	878	884	1370
August Sand	1360	1425	2087
Salt	1630	1760	2530
Maya	1897	1955	2965
Little Linn	2047	2062	2976
Second Cave	2062	2067	2981
Big Linn	2067	2115	2992
" of Linn	2115	2335	
Gordon Shaly	2415		
Show of Oil	2461		
2nd Oil	2476		
Pay	2481		
Total Depth			2992

Production 1st shows 30 bbl
2nd 24 " 400 "

Part in	Casing	Record	Left in
10	267	none	267
8 1/2	1373	"	1373
6 1/8	2098	"	2098
4 1/4	2526	"	2526

By G. S. Sidewell