

39°30'

80°35'

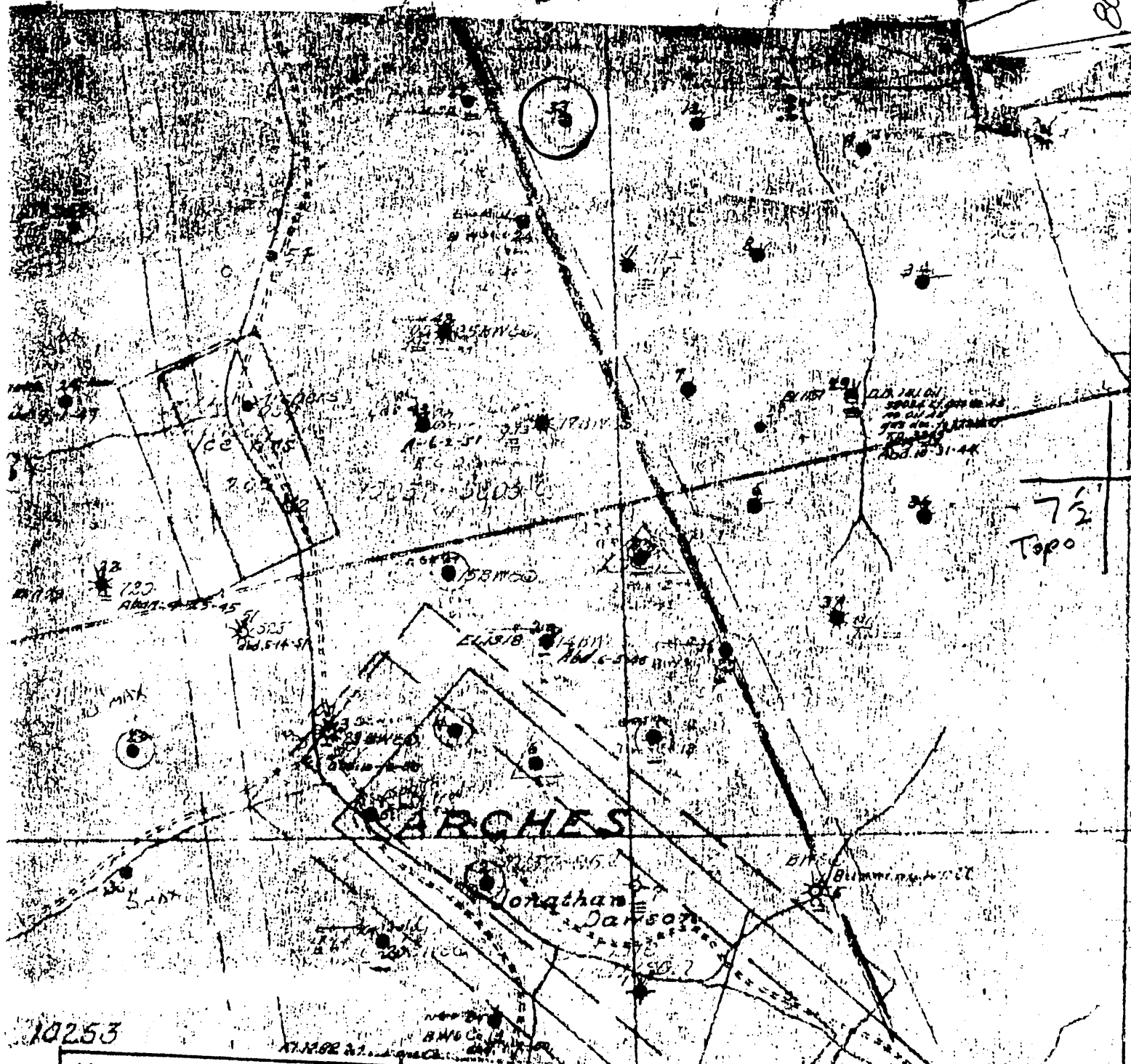

(+) DENOTES LOCATION OF WELL ON UNITED STATES TOPOGRAPHIC MAPS
 FORM IV-6
 (8-78)
 N48 N2 E2



DATE 1-26, 1929
 OPERATOR'S WELL NO. 33
 API WELL NO. 47-103-
 STATE COUNTY PERMIT

STATE OF WEST VIRGINIA
 DEPARTMENT OF MINES
 OIL AND GAS DIVISION

WELL TYPE: OIL GAS LIQUID INJECTION WASTE DISPOSAL
 (IF "GAS", PRODUCTION STORAGE DEEP SHALLOW
 LOCATION: ELEVATION _____ WATER SHED Arches Fork
 DISTRICT Grant COUNTY Wetzel
 QUADRANGLE Folsom 7 1/2

SURFACE OWNER _____ ACREAGE _____
 OIL & GAS ROYALTY OWNER _____ LEASE NO. _____ LEASE ACREAGE _____

PROPOSED WORK: DRILL CONVERT DRILL DEEPER REDRILL FRACTURE OR STIMULATE PLUS OFF OLD FORMATION PERFORATE NEW FORMATION OTHER PHYSICAL CHANGE IN WELL (SPECIFY) _____

PLUS AND ABANDON CLEAN OUT AND REPLUG TARGET FORMATION _____ ESTIMATED DEPTH _____
 WELL OPERATOR Pennzoil Company DESIGNATED AGENT James A. Grant
 ADDRESS P. O. Box 1588 ADDRESS P. O. Box 1588
Parkersburg, WV 26101 Parkersburg, WV 26101

L. G. ROBINSON - 33

LATITUDE 39° 30' 00"

LONGITUDE 80° 35' 00"

7'5 OGIS topo location

7.5' 10C 1.72 S 15' 10C _____
' 0.06 W (calc.) _____

Company _____

Farm _____

Quad Folsom 7 1/2'

County WETZEL

District GRANT

WELL LOCATION MAP

File No. 103-1099

No. 1

SOUTH PENN OIL COMPANY—COMPLETION

SERIAL NO. _____ FARM ROBINSON, L.G. WELL NO. 23
 ELEVATION _____ N. 2 S. X E. 2 W. X
 LEASE NO. 10196 ACRES 1.114 Map 2451
 WATERS OF Arches Fork, Co. Fork Fishing Creek
 DISTRICT Grant COUNTY Netzo 1 STATE W.Va.
 DRILLING COMMENCED _____ COMPLETED 8/24/05 DEPTH 2434

SANDS	TOP	BOTTOM	ELEV. TOP	CASING
Pgm. Coal or Big Lime	1030	1015		10 790
Salt Sand	1260	1220		8 1570
Big Lime	2265	2230		6 2451
Pencil Gave	2230	2205		
Big Injun	2230			
Gas	2422			
1st Bay	2424			

PACKERS AND DEPTH SET _____
 INITIAL PROD. 450 Bbls SAND Big Injun DEPTH 2454
 GAS TEST _____ QUARTS. 12 DEPTH 2431
 SHOT 4/1/03
 REMARKS _____
 REPORTED BY _____ ABANDONED _____

103-1099