

(H) DENOTES LOCATION OF WELL ON UNITED STATES TOPOGRAPHIC MAPS

FILE NO. 325
 MAP NO. N68 N 12 S E W 3
 SCALE 1" = 1000'
 MINIMUM DEGREE OF ACCURACY 1 in 200
 PROVEN SOURCE OF ELEVATION USGS BM - 838'

I THE UNDERSIGNED, HEREBY CERTIFY THAT THIS PLAT IS CORRECT TO THE BEST OF MY KNOWLEDGE AND BELIEF AND SHOWS ALL THE INFORMATION REQUIRED BY LAW AND THE REGULATIONS ISSUED AND PRESCRIBED BY THE DEPARTMENT OF MINES.

(SIGNED) [Signature]
 TIMOTHY P. ROUSH PS 793

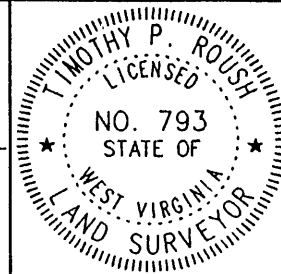

WEST VIRGINIA
 Division of Environmental Protection
 Office of Oil and Gas
 *10 McJunkin Road
 Nitro, West Virginia 25143-2506



DATE October 11, 19 99
 FARM L.S. Hoyt NO. 80
 API WELL NO. 47-103-1001-P

WELL TYPE: OIL GAS LIQUID INJECTION WASTE DISPOSAL
 (IF "GAS") PRODUCTION STORAGE DEEP SHALLOW
 LOCATION: ELEVATION 1,255' WATERSHED Little Fishing Creek
 DISTRICT Center COUNTY Wetzel
 QUADRANGLE Pine Grove

SURFACE OWNER Dallison Lumber Inc. ACREAGE 2099.3 Ac.
 OIL & GAS ROYALTY OWNER The Hoyt Foundation LEASE ACREAGE 2100 Ac.
 LEASE NO. 52265-50

PROPOSED WORK: DRILL CONVERT DRILL DEEPER REDRILL FRACTURE OR STIMULATE PLUG OFF OLD FORMATION PERFORATE NEW FORMATION OTHER PHYSICAL CHANGE IN WELL (SPECIFY) _____

PLUG AND ABANDON CLEAN OUT AND REPLUG
 TARGET FORMATION Gordon ESTIMATED DEPTH 3,207'
 WELL OPERATOR PennzEnergy E&P, LLC DESIGNATED AGENT Michael McCown
 ADDRESS P. O. Box 5519 ADDRESS P. O. Box 5519
Vienna, W.Va. 26105 Vienna, W.Va. 26105

NOV 1 1999

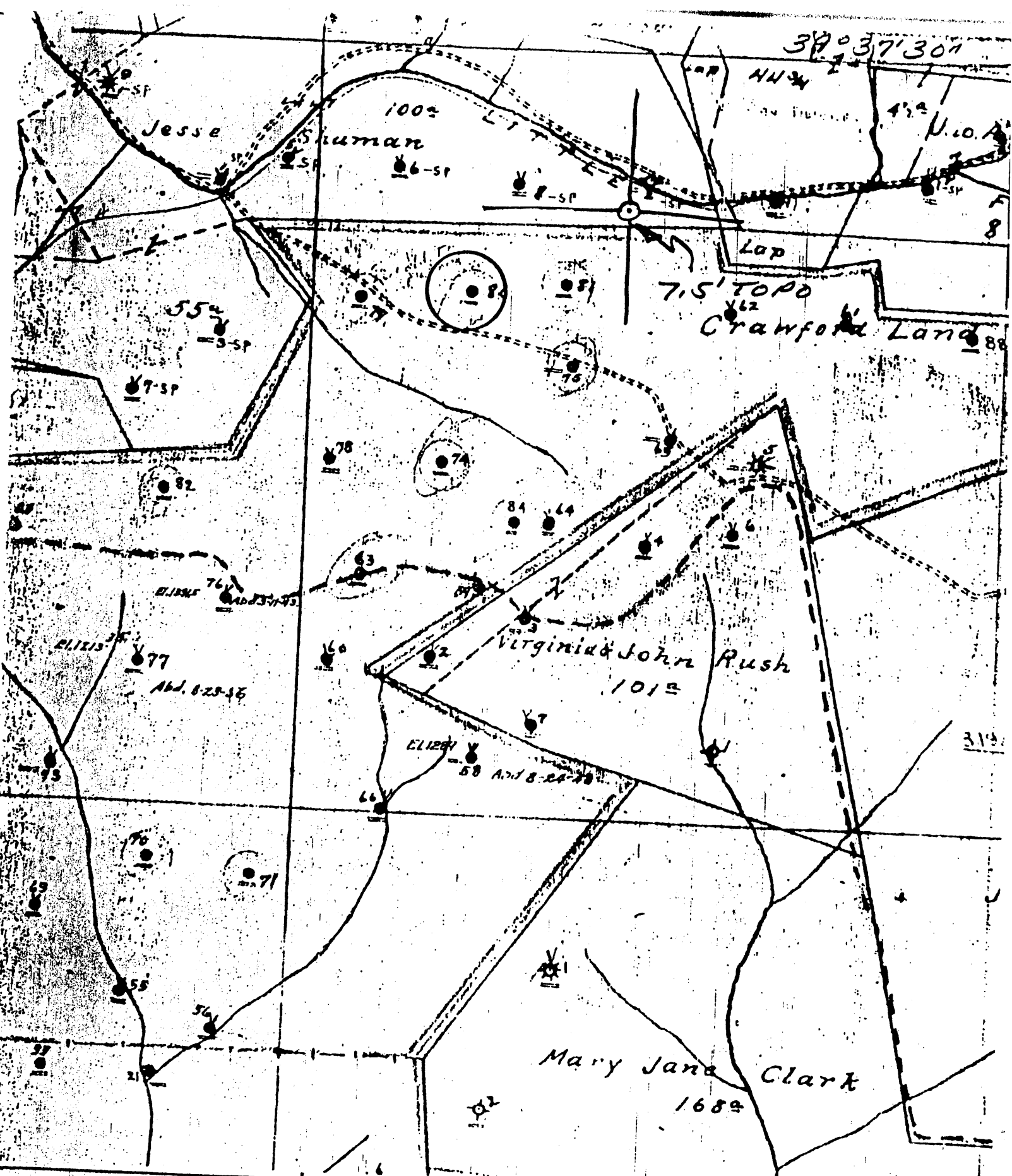

(+) DENOTES LOCATION OF WELL ON UNITED STATES TOPOGRAPHIC MAPS

FORM IV-6
(8-78)
N60N12W1



DATE 1-5- 1979
 OPERATOR'S WELL NO. 80
 API WELL NO. 47-103-
 STATE COUNTY PERMIT 1001

STATE OF WEST VIRGINIA
DEPARTMENT OF MINES
OIL AND GAS DIVISION

WELL TYPE: OIL GAS LIQUID INJECTION WASTE DISPOSAL
 (IF "GAS", PRODUCTION STORAGE DEEP SHALLOW
 LOCATION: ELEVATION 1348.98 WATER SHED LITTLE FISHING CR
 DISTRICT CENTER COUNTY WETZEL
 QUADRANGLE PINE GROVE 7.5'
 SURFACE OWNER _____ ACREAGE _____
 OIL & GAS ROYALTY OWNER _____ LEASE NO. _____ LEASE ACREAGE _____
 PROPOSED WORK: DRILL CONVERT DRILL DEEPER REDRILL FRACTURE OR
 STIMULATE PLUS OFF OLD FORMATION PERFORATE NEW
 FORMATION OTHER PHYSICAL CHANGE IN WELL (SPECIFY) _____

PLUS AND ABANDON CLEAN OUT AND REPLUS
 TARGET FORMATION _____ ESTIMATED DEPTH _____
 WELL OPERATOR Pennzoil Company DESIGNATED AGENT James A. Crews
 ADDRESS P. O. Box 1588 ADDRESS P. O. Box 1588
Parkersburg, WV 26101 Parkersburg, WV 26101

LATITUDE 39° 37' 30"



80° 43' 30"
LONGITUDE

7'5 OGIS topo location

7.5' loc 0.58 s 15' loc _____
 0.95 w (calc.) _____

Company _____

Farm _____

Quad PINE GROVE 7 1/2'

County WETZEL

District CENTER

WELL LOCATION MAP

File No. 103-1001

(040)

Well No. 66655
 Lease No. Grant Township
 Rig built by Geo. W. Crawford
 Well drilled by Williams & Crawford
 Began drilling June 19 1903 Completed Dec 1903

Iron formation Top Bottom Pressure

Conductor		11	
Cottaburg Coal	1135	1144	
Amudash coal	1630	1658	
Big Spring	2355	2570	Height gas
Spring	3156	3181	Gas
Get down	3191	3207	
Total depth		3194	Gas with oil
		3207	

10" bit 12 24 48

Coning Pressure

Pressure	Coning	Pressure	Left in
10"	689	689	
8 1/2"	1644	726	1423
6 7/8"	2027		2227
5 3/4"	2359.7		2359.7

S. J. Taylor

WR-38
28-Oct-99

API # 47-103-01001-P

STATE OF WEST VIRGINIA
DIVISION OF ENVIRONMENTAL PROTECTION
SECTION OF OIL AND GAS

AFFIDAVIT OF PLUGGING AND FILLING WELL

AFFIDAVIT SHOULD BE IN TRIPLICATE, one copy mailed to the Division, one copy to be retained by the Well Operator and the third copy (and extra copies if required) should be mailed to each coal operator at their respective addresses.

Farm name: DALLISON LUMBER, INC. Operator Well No.: L. S. HOYT 80
LOCATION: Elevation: 1,255.00 Quadrangle: PINE GROVE
District: CENTER County: WETZEL
Latitude: 3075 Feet South of 39 Deg. 37 Min. 30 Sec.
Longitude 5025 Feet West of 80 Deg. 38 Min. 34 Sec.

Well Type: OIL X GAS _____

Company: PennzEnergy
P.O. Box 5519
Vienna, WV 26105

Coal Operator DUPECH, Inc.
or Owner 6451 Pleasant St.
Library, PA 15129

Agent: Michael McCown

Coal Operator _____
or Owner _____

Permit Issued: 10/28/99

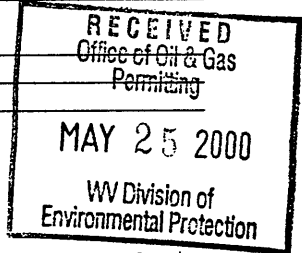

AFFIDAVIT

STATE OF WEST VIRGINIA,
County of Wood ss:

Kenneth Dotson and Jeffrey Klein being first duly sworn according to law depose and say that they are experienced in the work of plugging and filling oil and gas wells and were employed by the above named well operator, and participated in the work of plugging and filling the above well, and Randall Mick Oil and Gas Inspector representing the Director, say that said work was commenced on the 31st day of March, ~~19~~2000 and that the well was plugged and filled in the following manner:

TYPE	FROM	TO	PIPE REMOVED	LEFT
Cement	3190	2670		
45 SKS Cement	2380	2121	2330' 5 3/16" csg.	29'
40 SKS Cement	1670	1526	1644' 6 5/8" csg.	583'
40 SKS Cement	1185	1041	Perfed 1130'-1145'	1SPF
70 SKS Cement	320	140		8 1/4" from 1649' to 226
100 SKS Cement	100	Surf		
6% gel between each plug				

Description of monument: 7" csg ' High
and that the work of plugging and filling said well was completed on the 26 day of April, ~~19~~2000

And further deponents saith not.

Sworn and subscribe before me this 24 day of May, 192000
My commission expires: 10/3/2000

Kenneth Dotson
Jeffrey Klein
Dirk F. Anderson
Notary Public

Oil and Gas Inspector: _____

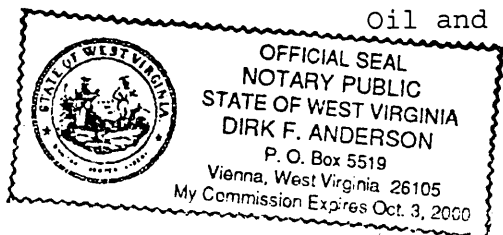

JUN 9 2000

WET 1001-P