

B-1

845

WEST VIRGINIA DEPARTMENT OF MINES

Oil and Gas Section

PRELIMINARY DATA SHEET NO. 1

Quad: Littleton

File No. WET-845

Well No. 1847

PITTSBURGH & WEST VA GAS CO. Company, of CLARKSBURG,

WEST VIRGINIA

J. P. ASHCRAFT

Farm

on ththe

containing 1030 acres.

Location

GRANT

WETZEL

District, in

County, West Virginia.

The surface of the above tract is owned in fee by Marcella Coughlin

#503 Second Street,
Fairmont, West Va.

address, and the mineral rights are owned by

Marcella Coughlin
Shiben Bros.

#503 Second St. Fairmont, West Va.
of New Martinsville, W. Va.

The oil and gas privileges are held under lease by the above named company, and this well is drilled under permit No. issued by the West Virginia Department of Mines, Oil and Gas Section,

(Well Completed Sept. 22nd, 1905)

19

Elevation of surface at top of well, 1290

Spirit
Barometric

The number of feet of the different sized casings used in the well,

15

feet

13"

size. Wood conductor.

505

feet

10

size, csg.

1498

feet

8-1/4"

sized csg.

2221

feet

8-5/8"

size, csg.

feet

sized csg.

feet

size, csg.

feet

sized csg.

packer of

size, set at

packer of

size, set at

in casing perforated at

feet to

feet.

in casing perforated at

feet to

feet.

Coal was encountered at 620-622

feet; thickness

24

inches, and at

1025-1034

feet; thickness

108

inches; and at

feet; thickness

inches.

Liners were used as follows: (Give details)

June 25th, 1931.

Date.

Well Located 1905.
Began Drg. July 20th, 1905.
Comp. Drg. Sept. 22nd, 1905.
Producing from Gordon Sand.

Approved

PITTSBURGH & WEST VA GAS CO. 09/15/2023

Owner.

By

F. E. Briden.

(Title)

WEST VIRGINIA DEPARTMENT OF MINES

Oil and Gas Section

PRELIMINARY DATA SHEET NO. 1

Well No. 1284

Company of PITTSBURGH & WEST VA GAS CO.

Company of PITTSBURGH & WEST VA GAS CO.

on this 2. F. ASHCRAFT

WEST VIRGINIA

1000

County West Virginia

District in

Marietta Coalfield

The surface of the above tract is owned in fee by

1803 Second Street,

address and the mineral rights are owned by

1803 Second St. Leimont, West Va.

Marietta Coalfield

of New Martinsville, W. Va.

Spencer, W. Va.

The oil and gas privileges are held under lease by the above named company, and this well is drilled under

permit No. issued by the West Virginia Department of Mines, Oil and Gas Section

(Well Completed Sept. 2nd, 1903)

is

Spirit

1250

Elevation of surface at top of well

The number of feet of the different sized casings used in the well

12" Wood conductor

10" size gas

8-1/2" size gas

6" size gas

4" size gas

3" size gas

2" size gas

1" size gas

in casing perforated at

in casing perforated at

Coal was encountered at

feet thickness

liners were used as follows: (Give details)

June 23rd, 1903

Date

1903

Approved

09/15/2023

By

(Title)

PITTSBURGH & WEST VA GAS CO.

Owner

L. E. BROWN

B-2

845

WET-845

PITTSBURGH & WEST VA GAS CO. Company

COMPLETION DATA SHEET

CLARKSBURG, WEST VA. Address

NO. 2

Well No. 1847, J. P. Ashcraft farm.

FORMATION RECORD

Grant Dist., Wetzel Co., W.Va.

Name	Color	Character	Oil, Gas or Water	Top	Bottom	Thickness	Total Depth	Remarks
Clay	Light	Soft		00	130	130	130	
Sand		"		130	138	8	138	
Clay	Light	"		138	200	62	200	
Sand	White	"		200	215	15	215	
Clay	Light	"		215	250	35	250	
Red Rock		"		250	265	15	265	
Lime	Gray	Hard		265	285	20	285	
Slate	Dark	Close		285	300	15	300	
Lime-Slate				300	365	65	365	
Red Rock	Red	Soft		365	380	15	380	
Lime	Gray	Hard		380	390	10	390	
Slate-Shells				390	450	60	450	
Lime		Close		450	465	15	465	
Slate				465	495	30	495	
Red Rock		Soft		495	505	10	505	
Slate-Shells				505	595	90	595	
Lime				595	620	25	620	
Native Coal				620	622	2	622	
Sand	White	Soft		622	665	43	665	
Slate	Light	Close		665	720	55	720	
Sand	"	"		720	730	10	730	
Slate				730	830	100	830	
Lime		Close		830	850	20	850	
Slate				850	875	25	875	
Lime		Hard		875	910	35	910	
Lime		"		910	940	30	940	
Lime		"		940	1025	85	1025	
Pgh. Coal				1025	1034	9	1034	
Lime		Hard		1034	1075	41	1075	
Slate				1075	1095	20	1095	
Lime				1095	1145	50	1145	
Slate				1145	1165	20	1165	
Murphy Sand	Gray	Hard		1165	1200	35	1200	
Red Rock				1200	1220	20	1220	
Slate-Lime				1220	1270	50	1270	
Red Rock				1270	1285	15	1285	
Lime		Hard		1285	1295	10	1295	
Red Rock		Soft		1295	1330	35	1330	
Lime		Hard		1330	1345	15	1345	
Slate-Shell				1345	1405	60	1405	
Lime		Hard		1405	1430	25	1430	
Little Dunkard				1430	1445	15	1445	
Slate	Black	Soft		1445	1465	20	1465	
Slate & Shell				1465	1490	25	1490	
Big Dunkard	White			1490	1530	40	1530	

Cont'd to Sheet #2

09/15/2023

COMPLETION DATA SHEET

NO. 2

FORMATION RECORD

Well No. 1847, J. P. Ashcroft farm.
 Grant Dist., Wetzel Co., W. Va.
 CLARKSBURG, WEST VA.
 PITTSBURGH & WEST VA GAS CO. Company

Remarks	Total Depth	Thickness	Bottom	Top	Oil, Gas or Water	Character	Color	Name
	130	130	130	00		Soft	Light	Clay
	138	8	138	130		"		Sand
	200	62	200	138		"	Light	Clay
	215	15	215	200		"	White	Sand
	250	35	250	215		"	Light	Clay
	265	15	265	250		"		Red Rock
	285	20	285	265		Hard	Grey	Lime
	300	15	300	285		Close	Dark	Slate
	365	65	365	300				Lime-Slate
	380	15	380	365		Soft	Red	Red Rock
	390	10	390	380		Hard	Grey	Lime
	450	60	450	390				Slate-Shells
	465	15	465	450		Close		Lime
	495	30	495	465				Slate
	505	10	505	495		Soft		Red Rock
	595	90	595	505				Slate-Shells
	620	25	620	595				Lime
	625	5	625	620				Native Coal
	665	40	665	625		Soft	White	Sand
	720	55	720	665		Close	Light	Slate
	730	10	730	720		"	"	Sand
	830	100	830	730				Slate
	850	20	850	830		Close		Lime
	875	25	875	850				Slate
	910	35	910	875		Hard		Slate
	940	30	940	910		"		Lime
	1025	85	1025	940		"		Lime
	1034	9	1034	1025				Exp. Coal
	1075	41	1075	1034		Hard		Lime
	1095	20	1095	1075				Slate
	1145	50	1145	1095				Lime
	1165	20	1165	1145				Slate
	1200	35	1200	1165		Hard	Grey	Murphy Sand
	1220	20	1220	1200				Red Rock
	1270	50	1270	1220				Slate-Lime
	1285	15	1285	1270				Red Rock
	1295	10	1295	1285		Hard		Lime
	1320	25	1320	1295		Soft		Red Rock
	1345	25	1345	1320		Hard		Lime
	1405	60	1405	1345				Slate-Shell
	1430	25	1430	1405		Hard		Lime
	1445	15	1445	1430				Little Dunkard
	1465	20	1465	1445		Soft	Black	Slate
	1480	15	1480	1465				Slate & Shell
	1530	50	1530	1480				Big Dunkard White

Cont'd to Sheet #2

09/15/2023

AFFIDAVIT IN TRIPLICATE TO TIME AND MANNER OF PLUGGING AND FILLING WELL

(REQUIRED BY SECTION 9, ARTICLE 4, CHAPTER 22 OF THE CODE)

WEST VIRGINIA DEPARTMENT OF MINES OIL AND GAS DIVISION

Robinson & Lutes
COAL OPERATOR OR OWNER
c/o ID. Fred Robinson.
412 Market St. Brownsville, Pa.
ADDRESS

Pittsburgh & West Virginia Gas Co.
NAME OF WELL OPERATOR
Clarkshurg, West Va.
COMPLETE ADDRESS

COAL OPERATOR OR OWNER
ADDRESS

September 1st, 1932
WELL AND LOCATION

Grant District
Wetzel County

COAL OPERATOR OR OWNER
ADDRESS

Well No. 1847
J.P. Ashcraft Farm

AFFIDAVIT TO BE MADE IN TRIPLICATE, ONE COPY TO BE MAILED BY REGISTERED MAIL TO THE DEPARTMENT. ONE COPY TO BE RETAINED BY THE WELL OPERATOR AND THE THIRD COPY (AND EXTRA COPIES IF REQUIRED) TO BE MAILED TO EACH COAL OPERATOR ABOVE NAMED AT THEIR RESPECTIVE ADDRESSES.

AFFIDAVIT

STATE OF WEST VIRGINIA,
COUNTY OF Wetzel } SS:

John Hibbs and David B. Kimble
being first duly sworn according to law depose and say that they are experienced in the work of plugging

and filling oil and gas wells and were employed by Pittsburgh & West Va. Gas Co well operator, and participated in the work of plugging and filling the above well, that said work was commenced on the

8 day of September, 1932, and that the well was plugged and filled in the following manner: (Partial Plugging Report from 3112 feet to 1118 feet)

Manner in which sand was plugged: Total Depth 3112 feet.

1 - 6-5/8 x 3" Spang Anchor Packer and 40 feet of 2" Anchor left in bottom of hole.

Clay 3061 feet to 3053, Cement 3053 to 3046 feet, Mole bridged at 2285 feet, Clay 2285 to 2261 feet, Cement 2261 to 2258 feet, Mole bridged at 1900 feet, Clay 1900 to 1870 feet, Cement 1870 to 1865. Mole bridged at 1687 feet, Clay 1687 to 1592 feet, cement 1592 to 1585 feet, Mole bridged at 1530 feet, Clay 1530 to 1515

Manner in which coal was plugged: Cement 1515 to 1508, clay 1508 to 1125 feet, Cement 1125 to 1118 feet.

8-1/4" Casing cut at 1080 and 1078 feet and pulled up 10" Coal Not Plugged.

This well producing gas from the Coal and reinstated as a gas Well on Jan. 7th, 1932.

Description of monument:

(THE ABOVE DESCRIPTIONS MUST BE IN DETAIL AND IN ACCORDANCE WITH THE PROVISIONS OF SECTION 10, ARTICLE 4, CHAPTER 22 OF THE CODE)

and that the work of plugging and filling said well was completed on the 7 day of December, 1932.

And further deponents saith not.

Sworn to and subscribed before me this 6 day of Sept, 1932

My Commission expires: June 20 1942

John Hibbs
David B. Kimble
Notary Public.
09/15/2023

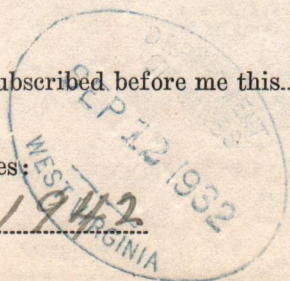
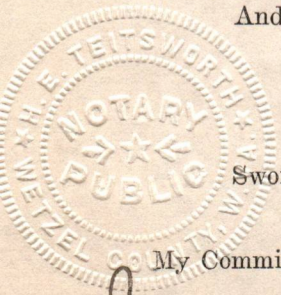

WET-845

AFFIDAVIT IN TRIPLICATE TO TIME AND MANNER OF
PLUGGING AND FILLING WELL
(REQUIRED BY SECTION 9, ARTICLE 4, CHAPTER 22 OF THE CODE)
WEST VIRGINIA DEPARTMENT OF MINES
OIL AND GAS DIVISION

NAME OF WELL OPERATOR: Littaburg & West Virginia Gas Co.
 COMPLETE ADDRESS: Clarksburg, West Va.
 WELL AND LOCATION: September 1st, 1933
 DISTRICT: Grant
 COUNTY: Wayne
 WELL NO.: 1847
 NAME OF WELL OPERATOR: Robinson & Jones
 COMPLETE ADDRESS: 112 Market St., Brownsville, Pa.
 WELL AND LOCATION: September 1st, 1933
 DISTRICT: Grant
 COUNTY: Wayne
 WELL NO.: 1847
 NAME OF WELL OPERATOR: J. A. Aschcraft
 COMPLETE ADDRESS: Rain

AFFIDAVIT

STATE OF WEST VIRGINIA
 COUNTY OF Wayne

John Kippa and David B. Kippa being first sworn according to law before and say that they are experienced in the work of plugging and filling of gas wells and were employed by Littaburg & West Virginia Gas Co. Coal operators and participated in the work of plugging and filling the above well, that said work was commenced on the

day of September, 1933, and that the well was plugged and filled in the following manner:

(Detailed description of plugging and filling process, including cement and clay bridging details.)

Manner in which sand was plugged: Total depth 512 feet.

1 - 8" x 8" Spang Anchor Lasher and 40 feet of 2" anchor left in bottom of hole.

Clay bridged at 502 feet, cement 502 to 504 feet, hole bridged at 532 feet, clay 532 to 534 feet, cement 532 to 534 feet.

Clay bridged at 1200 feet, clay 1200 to 1270 feet, cement 1270 to 1285 feet, hole bridged at 1287 feet, clay 1287 to 1322 feet, cement 1322 to 1335 feet, hole bridged at 1330 feet, clay 1330 to 1372 feet, cement 1372 to 1385 feet, hole bridged at 1385 feet, cement 1385 to 1408 feet, clay 1408 to 1432 feet, cement 1432 to 1438 feet.

8-1/2" casing out at 1080 and 1078 feet and pulled up 107 feet.

Coal not plugged.

This well producing gas from the coal and refracted as a gas well on Sept. 1st, 1933.

Description of monument:

(THE ABOVE DESCRIPTIONS MUST BE IN DETAIL AND IN ACCORDANCE WITH THE PROVISIONS OF SECTION 10, ARTICLE 4, CHAPTER 22 OF THE CODE)

and that the work of plugging and filling said well was completed on the 1st day of September, 1933.

And further deponent says not.

Subscribed and sworn to before me this 1st day of September, 1933.

Notary Public



LOCATION OF WELL NO. 1847 TO BE ABANDONED

PITTSBURGH & W.VA. GAS COMPANY OF PITTSBURGH PA.

LEASE NO. 2814 LESSOR J. P. ASHCRAFT ACRES 1030

DISTRICT GRANT COUNTY WETZEL STATE W.VA.

QTR. QUADRANGLE LITT. S.E. 1-2 DATE OCT. 8 1930 NO. ON LEASE 6

LEASE EXPIRES - F. RESERVATION ELEVATION 1290

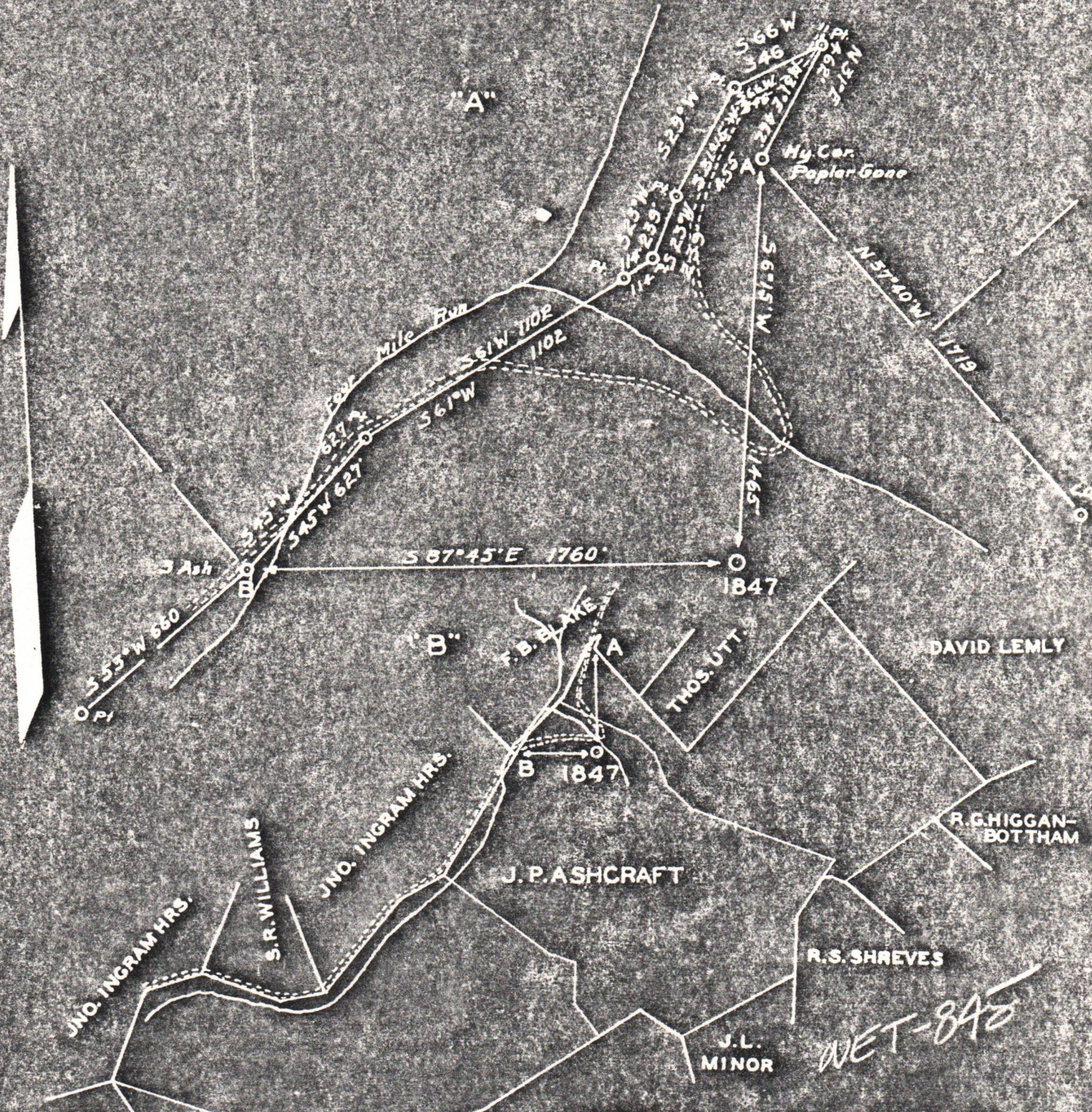

J. & D. K. DULANEY

J. B. HICKS

J. C. LAVELLE

J. B. HICKS

J. L. MINOR

R. S. SHREVES

DAVID LEMLY

R. G. HIGGAN-BOTTHAM

J. P. ASHCRAFT

SCALE - { A 1" = 500'
B 1" = 2000'



NOTARY PUBLIC, I HEREBY CERTIFY THAT THIS MAP IS CORRECT AND SHOWS ALL THE INFORMATION TO THE BEST OF MY KNOWLEDGE AND BELIEF REQUIRED BY THE OIL AND GAS SECTION OF THE MINING LAWS OF WEST VIRGINIA.

James D. Jeffers ENGINEER 09/15/2023

ACKNOWLEDGED BEFORE ME A Notary Public

THIS 24th

DAY OF June 1931

W. C. McMasters, Notary Public
My Commission Expires
March 23, 1935

W. C. McMasters
Notary Public.