



West Virginia Department of Environmental Protection
Office of Oil and Gas
WELL LOCATION FORM: GPS

API: 47-103-00779 P WELL NO.: WV 652786 (Himelrick # 890)

FARM NAME: Himelrick

RESPONSIBLE PARTY NAME: EOT Production Company

COUNTY: Wetzel DISTRICT: Church

QUADRANGLE: Hundred 7.5'

SURFACE OWNER: Ronald W. Goodwin

ROYALTY OWNER: Alex Himelrick et ux

UTM GPS NORTHING: 4,393,527

UTM GPS EASTING: 548,961 GPS ELEVATION: 451 m (1478 ft)

The Responsible Party named above has chosen to submit GPS coordinates in lieu of preparing a new well location plat for a plugging permit or assigned API number on the above well. The Office of Oil and Gas will not accept GPS coordinates that do not meet the following requirements:

1. Datum: NAD 1983, Zone: 17 North, Coordinate Units: meters, Altitude: height above mean sea level (MSL) – meters.
2. Accuracy to Datum – 3.05 meters
3. Data Collection Method:
Survey grade GPS : Post Processed Differential
Real-Time Differential
Mapping Grade GPS : Post Processed Differential
Real-Time Differential
4. Letter size copy of the topography map showing the well location.

I the undersigned, hereby certify this data is correct to the best of my knowledge and belief and shows all the information required by law and the regulations issued and prescribed by the Office of Oil and Gas.

Ben R. Sings
Signature

P.S. 2092
Title

5-8-2012
Date

Topo Quad: Hundred Scale: 1" = 2000' *103-00779P*
 County: Wetzel Date: June 28, 2011
 District: Church Project No: 40-34-00-09

47-103-00779 (WV 652786)

Topo

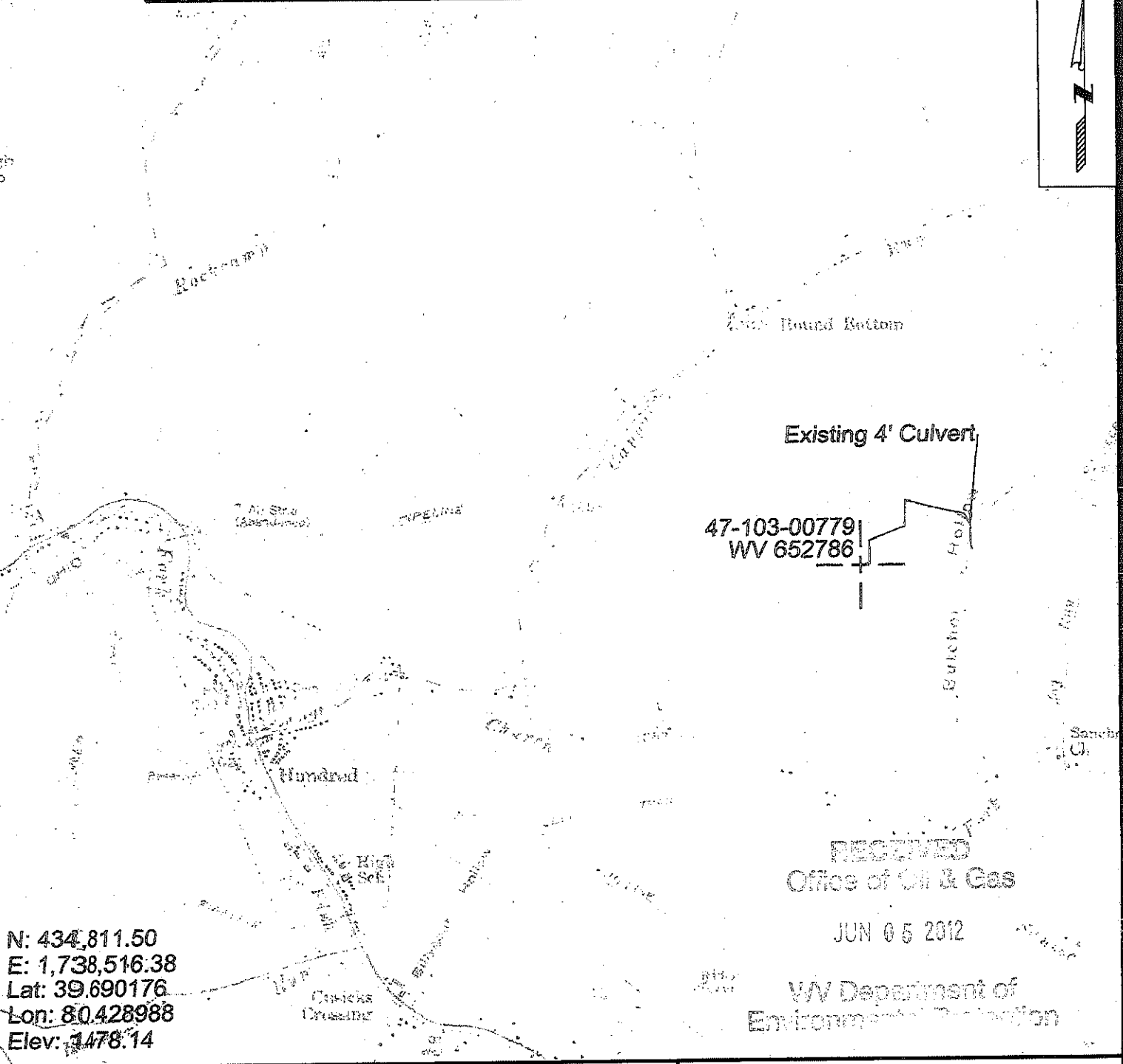
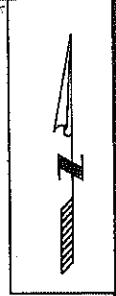

N: 434,811.50
 E: 1,738,516.38
 Lat: 39.690176
 Lon: 80.428988
 Elev: 1478.14



SURVEYING AND MAPPING SERVICES PERFORMED BY:
ALLEGHENY SURVEYS, INC.
 1-800-482-8606
 P.O. BOX 438
 BIRCH RIVER, WV 26610
 PH: (304) 649-8606
 FAX: (304) 649-8608

PREPARED FOR:
EQT Production Company
 1710 Pennsylvania Ave.
 Charleston, WV 25302