

1177

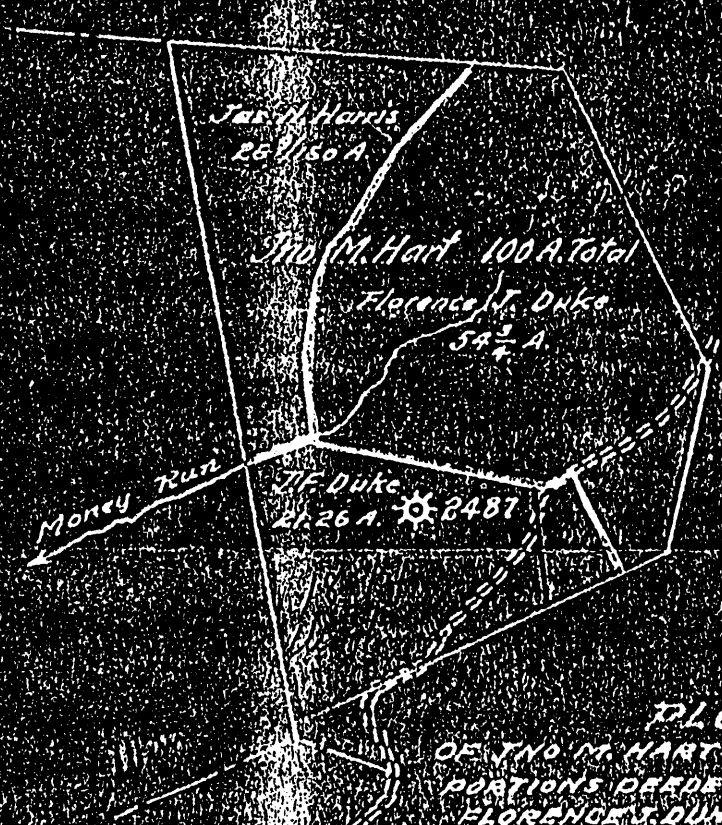

PLOT
 OF JNO. M. HART FARM SHOWING
 PORTIONS DEEDED TO J.F. DUKE
 FLORENCE T. DUKE & JNO. H. HARRIS
 GREEN DISTRICT, WETZEL COUNTY, WEST VA.
 1918
 Dec. 31-1918
 J.F. Duke 2487
 Jno. M. Hart 2487

103-0744

LATITUDE 39° 37' 30"

LONGITUDE 80° 42' 30"

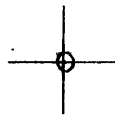

7'5 OGIS topo location

7.5' 10C 2.18 S 15' 10C _____
' 0.87 W (calc.) _____

Company _____

Farm _____

Quad PINE GROVE 7 1/2'

County WETZEL

District GREEN

WELL LOCATION MAP

File No. 103-0744

(035)

Division IUKA

248 Fourth Ave., Pittsburgh, Pa.

Record of Well No. 2487 on J. M. Hart, Farm 100 Acres
 Iuka Field Green District Wetzol County West Va. State
 Rig Commenced October 15th, 1919, Completed October 18th, 1919
 Drilling Commenced November 17th, 1919, Completed December 20th, 1919
 Cost per foot \$2.25 Contractor T. C. Rawe, Address Now Martinsville, W. Va.
 Drillers' Names E. F. Morgan, M. R. Rawe, and Otto Fry,

BOILER			ENGINE			RIG			
I. P.	No.	Name of Maker	H. P.	No.	Name of Maker	New	Old	Height	Name of Builder

CONDUCTOR AND CASING USED IN DRILLING

Factor	13 inch	10 inch	8 1/2 inch	6 3/4 inch	6 1/2 inch	5 1/2 inch	5 1/4 inch	5 inch	4 inch
4'		485'	1424'	1774'	11"				

CONDUCTOR AND CASING LEFT IN WELL

Factor	13 inch	10 inch	8 1/2 inch	6 3/4 inch	6 1/2 inch	5 1/2 inch	5 1/4 inch	5 inch	4 inch	3 inch

OIL WELL

GAS WELL

When Shot	Size of Torpedo	1st Day's Production	Tubing	Rods	Tanks	Size of Packer	Depth Set	Packed with	1st Minutes Pressure	Rock Pressure

FORMATION	FORMATION			REMARKS
	Top	Bottom	Thickness	
Red Rock,	0	200		(Pittsburgh Coal)
Slate, (black)	200	345	145	
Coal, (black-soft)	345	350	5	
Slate, (black-soft)	350	450	100	
Lime, (Gray-hard)	450	476	26	
Coal, (black-soft)	476	480	4	
Slate, (white-med-)	480	520	40	
Red rock, (red- soft)	520	595	75	
Coal, (black-soft)	595	598	3	
Lime, (Gray- hard)	598	610	12	
Red-rock, (red- med-)	610	710	100	
Lime, (pink-hard)	710	750	40	
Slate, (Gray- soft)	750	800	50	
Lime, (white-hard)	800	827	27	
Coal, (black-soft)	827	830	3	
Lime, (white-hard)	830	850	20	
Slate, (gray- soft)	850	910	60	
Lime, (gray-hard)	910	924	14	
Pgh. Coal, (Coal-)	922	924	2	
Slate, (white-med.)	935	950	15	
Lime, (white-hard)	950	960	10	
Slate, (lead- med)	960	995	35	
Red rock, (red-soft)	995	1025	30	
Slate, (gray-soft)	1025	1055	30	
Lime, (gray-hard)	1055	1070	15	
Red rock, (red- soft)	1070	1100	30	
Slate, (dark-soft)	1100	1150	50	
Lime, (gray-hard)	1150	1175	25	
Red rock, (Red- soft)	1175	1225	50	

Examined above information and measurements and found to be correct by _____ Examined and approved by _____
 Contractor _____ Supervisor _____

NOTE: The above blank must be filled out carefully by the Contractor, with a complete and accurate record of the Well, and accompany, when presented to the bill for drilling.
 All formations and known sands must be given by their proper name, with steel line measurements, and under the head of "Remarks" must be recorded in what at what depth Oil, Gas or Water was found, the quantity of same, the quality of the sand, and thickness of pay.
 Make no memoranda of boiler and engine if owned by contractor.

(Over)

FORMATION.	TOP.	BOTTOM.	THICKNESS.	REMARKS.
Little Dunkard,	1245	1375	130	* Gas and light show
Lime, (-hard)	1370	1385		* of oil at 1248'
Slate, (black-soft)	1385	1390	5	* Water at 1365' one
pink rock, (pink-soft)	1390	1420	30	* bailer an hr. (from
Big Dunkard, (-hard)	1420	1450	30	*
White, (Slate-	1450	1452	2	*
Lime, (white-	1455	1480	25	*
Slate, (white-	1480	1490	10	*
Gas Sand, (dark-soft)	1490-	1530	40	*
Slate, (white-soft)	1530	1555	25	*
Lime, (white-hard)	1555	1570	15	*
1st. Salt Sand, (-soft)	1570	1592	22	* Show of oil.
Slate, (white-soft)	1595	1600	5	*
Salt Sand, (bottom-	1600	1628	28	*
Slate, (white-soft)	1628	1650	22	*
2nd. Salt Sand, (-hard)	1650	1680	30	* Open Flow Test.
Slate, (dark-	1680	1756	76	* 40/10 water in 8" pipe
3rd. Salt Sand, (-	1756	1800	44	*
Slate, (black-soft)	1800	2022	222	* Spring gauge test
Maxon Sand, white-soft)	2022	2060	34	* fuel line. (2")
1st. pay,	2041	2044	3	*
2nd. pay,	2054	2064	10	* line Pres. 525 #
Total Depth,	2066'			* 1st. Min. 300 #
				* 2nd. Min. 375 #
				* 3rd. Min. 400 #
				* 4th. Min. 425 #
				* 5th. Min. 450 #
				* Rock Pres. 650 # in
				* one hour.

WELL RECORD

Co.

WELL No. *744*
 FARM *744*
 DISTRICT *744*
 COUNTY *W. Va.*
 STATE *W. Va.*

OWNED BY

DIVISION

DATE *191*

ENTERED W. R. BOOK FOLIO *2044-5*

BY *W. R. Black*

Well - 744

