

LATITUDE 39° 37' 30"



LONGITUDE 80° 27' 30"

7.5 OGIS topo location

7.5' loc 0.28 S 15' loc _____
 0.43 W (calc.) _____

Company _____

Farm _____

Quad GLOVER GAP 7 1/2'

County WETZEL

District CHURCH

WELL LOCATION MAP

File No. 103-0733

(047)

THE MANUFACTURERS LIGHT & HEAT CO.

LOCATION FOR WELL No. 2229.

Lease No. 2733 for 118 Acres, HUNDRED District

DESCRIPTION

Well No. 4 on farm of MARY TENSARDEN

District CHAURON County WETZEL State W.VA.

320 feet from WEST line of JAS. HIGGINBOTTOM Farm

418 feet from NORTH line of G. ADAMS Farm

570 feet from NORTH line of W. T. ... Farm

570 feet from WEST line of well on ... Farm

As shown on Sketch below. Scale of sketch; 1" equals 800 feet

Location made Nov 21, 1912 Signed J. J. ... ENGR.

Reservation around Buildings, 200 Feet. J. J. ... H.F. WILSON

SPECIAL CONDITIONS:-
FISHER OIL CO. OWNS OIL.
AGREEMENT No. 313.
DRILL FOR GAS.

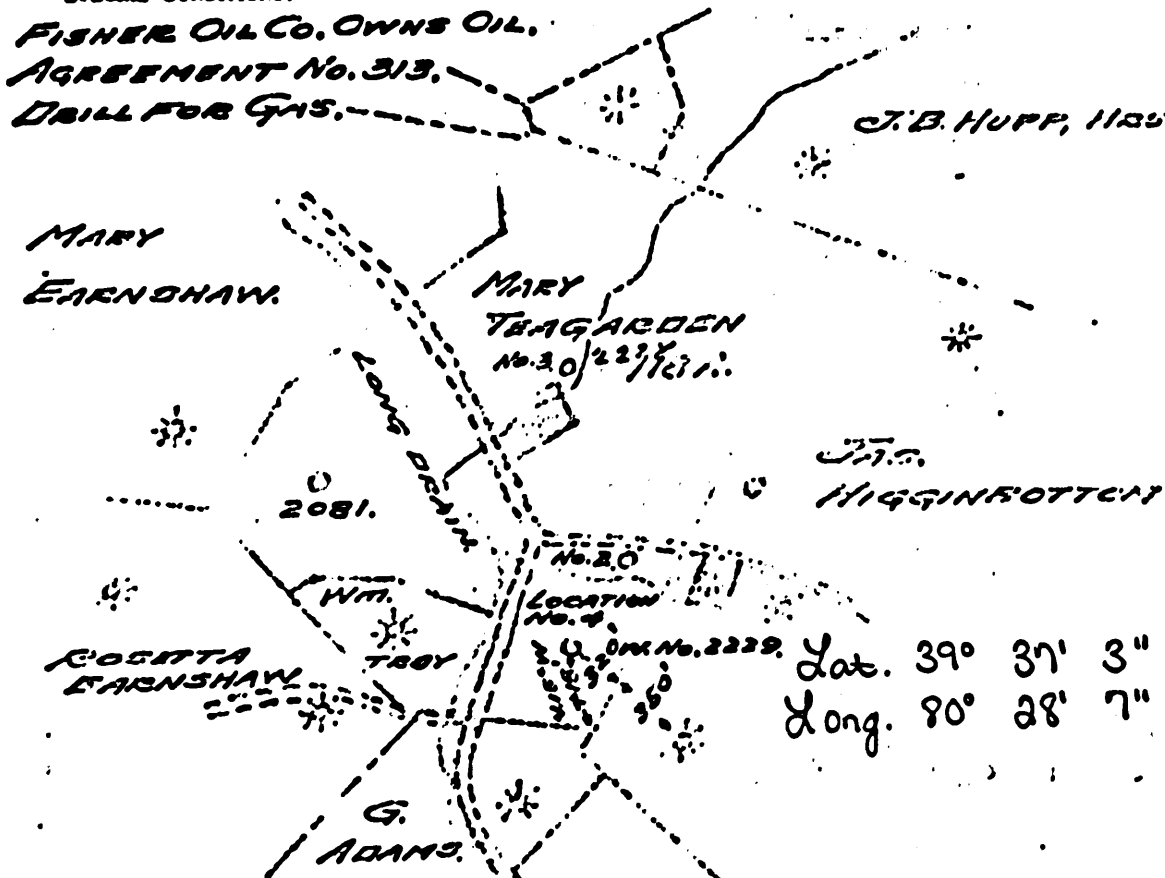

Lat. 39° 37' 3"
 Long. 80° 28' 7"

WET-733

H.F. Wilson Dis't. Supt. Pittsburgh, Pa., ... 1912
HUNDRED, 118

You are hereby authorized to commence work on above well at once, as well must be commenced by ... 1912, and must be completed by ... 1912

... and material incident to above well must be charged to this

District of West Va. 200 Fourth Ave., Pittsburgh, Pa. Company
 Record of Well No. 2229 on Mary A. Teagarden Farm 118
 Field Church Wetzel County West Va. State
 Rig Commenced Feb. 4, 1918, Completed Feb. 8, 1918.
 Drilling Commenced April 4, 1918, Completed May 7, 1918.
 Cost per foot \$2.00 Contractor T. B. Foley Address Pittsburgh, Pa.
 Driller's Names C. B. Thomas W. R. Thomas

BOILER			ENGINE			RIG			
No.	Name of Maker	H.P.	No.	Name of Maker	Year	Old	Height	Name of Builder	
					Yes		82	Jno. Craig	

CONDUCTOR AND CASING USED IN DRILLING									
1 1/2 inch	2 inch	3 inch	4 inch	5 inch	6 inch	8 inch	10 inch	12 inch	14 inch
		300	1410	2143					

CONDUCTOR AND CASING LEFT IN WELL									
1 1/2 inch	2 inch	3 inch	4 inch	5 inch	6 inch	8 inch	10 inch	12 inch	14 inch
		None	1410	2143					2"
									2362

OIL WELL					GAS WELL					
When Shot	Size of Torpedo	1st Day's Production	Tubing	Code	Tank	Size of Packer	Depth Set	Packed with	1st Minute Pressure	Rock Pressure
						6 5/8"x2"	2362	2"	30 #	165 #

FORMATION	Top		Bottom	Thickness	REMARKS
	Feet	Feet			
ay, Lime & Slate	0	560	560		
uff Sand	560	585	15		dash
pletown Coal	823	829	6		
ttsburgh Coal	930	940	10		
rphy Sand	1050	1074	24		white
ttle Dunkard Sand	1327	1300	63		
" "	1410	1465	55		
" Sand	1613	1623	10		
ale	1630	1645	15		Water at 1705, 1 double section bailer per hour
ost Salt Sand	1690	1795	105		Water at 1710, 3 double section bailers per hour, exhausted to 2 P.H.
cond Salt Sand <i>hard</i>	1915	1990	75		Little gas 2108
von Sand <i>hard</i>	2060	2117	57		
ttle Lime	2120	2130	10		
" Lime	2133	2210	77		
" Injun Sand	2210				Gas 2220 to 2230, test 71/10 water in 2" opg., blowed down to 38/10 water in 2" opg. 281, 568 am ft
al depth		2361			

Examined above and found to be correct by *T.B. Foley* Contractor. Examined and approved by *H. H. Walsh* Superintendent of Co.
 NOTE: The above blank must be filled out carefully by the Contractor, with a complete and accurate record of the Well, and accompany, when presented for payment
 All formations and known sands must be given by their proper names, with steel line measurements, and under the head of "Remarks" must be recorded in what sand and
 at what depth Oil, Gas or Water was found, the quantity of same, the quality of the sand, and thickness of pay.
 Make no measurements of hole and casing if owned by contractor.



WET-733

0002 0563

THE MANUFACTURERS LIGHT & HEAT CO.
Company

Record of Well No. **2229** on Farm _____ Acres _____
 Field _____ District Turnable _____ County _____ State _____
 Rig Commenced 19 _____ Completed 19 _____
 Drilling Commenced 19 _____ Completed 19 _____
 Contractor _____ Address _____
 Driller's Name _____

CASING AND TUBING RECORD

Used in Bore	Conductor	12"	16"	21"	27"	34"	42"	54"	60"

Size	Depth Set	Type Packer	Date	Type Explosive	Amount	DEPTH		Volume Before Ca. Ft.	Volume After Ca. Ft.
						Top	Bottom		

VOLUME AND PRESSURE

Date	Reading in Inches	Liquid	Size Orifice	Volume	Sand	PRESSURE IN MIN.					24 Hr. R. P.	Max. R. P.	M-W	
						1	5	10	20	60				

TOTAL INITIAL OPEN FLOW _____ CUBIC FEET PER 24 HOURS

FORMATION	TOP	BOTTOM	THICKNESS	REMARKS
Slate & Limestone white	585	670	85	Shale black
Red Rock	670	675	5	Limestone white
Slate & Limestone	675	820	48	Slate white
Limestone & slate	820	930	101	lumpy limestone
Slate & Limestone	940	1050	110	Limestone white
Limestone	1074	1095	21	Limestone white
Limestone shells	1095	1115	20	Slate & shale
Slate white	1115	1125	10	Slate, shale & limestone
Red rock	1125	1165	40	Slate shaly & limestone
Slate dark	1165	1140	25	Slate lath
Limestone pink	1140	1150	10	Slate white
Slate white	1150	1163	13	
Red Rock	1163	1170	7	
Slate white	1170	1185	15	
Limestone white	1185	1195	10	
Slate white	1195	1206	11	
Limestone white	1206	1210	4	
Red Rock	1210	1225	15	
Limestone & Red Rock	1225	1260	35	
Slate & Limestone	1260	1290	30	
Sand	1290	1320	30	
Slate	1320	1327	7	
Red Rock	1327	1390	63	
Slate black	1390	1410	20	
Shale black	1410	1465	55	
Limestone	1465	1485	20	
Shale black	1485	1500	15	
Limestone white	1500	1525	25	
Limestone white	1525	1540	15	

NET-733

Examined above information and measurements and found to be correct by _____ Contractor _____ Field Superintendent _____

NOTE: The above blank must be filled out carefully by the contractor, with a complete and accurate record of the well, and accompany when presented for payment of the bill for drilling. All formations and known sands must be given by their proper name, with steel line measurements, and under the heading "Remarks" must be recorded in what sand and at what depth Oil, Gas or Water was found, the quantity of same, the quality of the sand, and thickness of pay.

0002 0564