

Lauke

THE MANUFACTURERS LIGHT & HEAT CO.

Location for Well No. 3030 To be drilled for Gas

Lease No. 7670 on 100 Acres, of 100 District

DESCRIPTION

Well No. 1 on farm of Wm. & Helen Ritter
District Center County Wetzel State W. Va.
155 feet from N.E. line of Pat Clark Farm
300 feet from N.W. line of Chas. Ritter lease Farm
feet from _____ line of _____ Farm
feet _____ of well _____ Farm

As shown on Sketch below: Scale of sketch; 1" equals 1320 feet

Location made July 16 1925 Signed W. F. Kays, Eng.

Reservation around Buildings 200 Feet. J. J. Foley

SPECIAL AGREEMENT Lease expires Oct 7-1925 T. G. Burson

SPECIAL CONDITIONS: M.L. & H. Co. own Tractly under 34 1/100 Acres

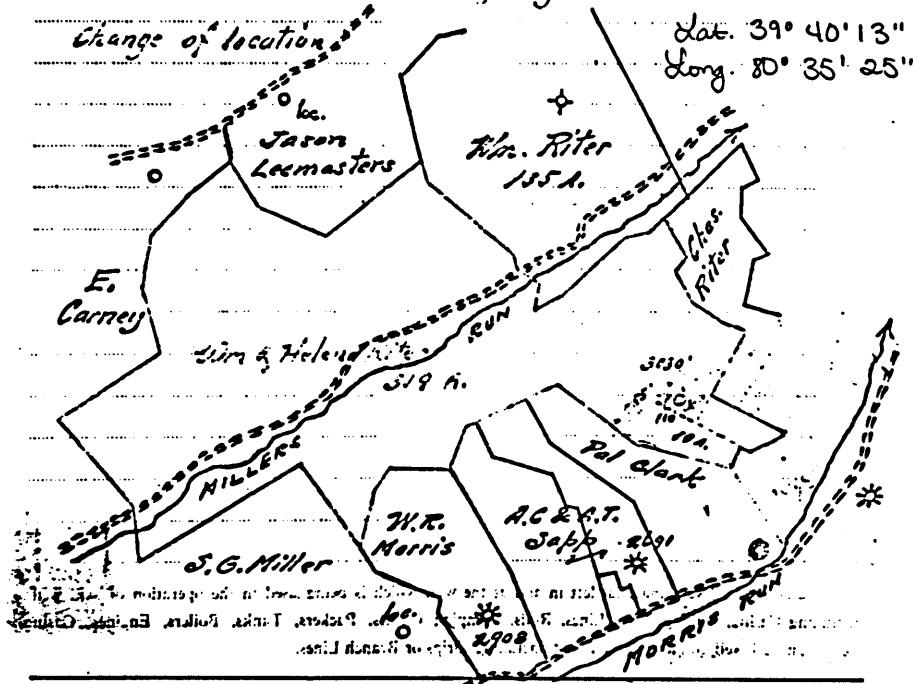

T. G. Burson Foreman Pittsburgh, Pa. July 22 1925
Hundred, W. Va.

You are hereby authorized to commence work on above well at once, as well must be commenced by at once 1925 and must be completed by as soon as possible 1925

All charges for labor and material incident to above well must be charged to this Well No. 3030, and when work is completed report must be filled out on reverse side of this sheet and forwarded to Pittsburgh Office. Retain one copy of this order for your files.

Approved _____
H. J. Jura WET-725

0002497

The Manufacturers Light & Heat Company 1130
 District Office 248 Fourth Ave., Pittsburgh, Pa.
 Record of Well No. 3030 on Wm. Ritter Farm 319 Acres
 Hundred Field Center ^{District} Wetzel County W. Va. State
 Rig Commenced July, 30 1925 Completed Aug. 7 1925
 Drilling Commenced Aug. 10 1925 Completed Dec. 12 1925
 Cost per Foot \$2.00 Contractor F. G. Burson, (Mrs. L. & H. C. Address)
 Driller's Names L. Butcher, W. C. Lemley

BOILER			ENGINE			RIG		
H. P.	No.	Name of Maker	H. P.	No.	Name of Maker	New	Old	Name of Builder

CONDUCTOR AND CASING USED IN DRILLING									
Conductor	12 inch	10 inch	8 1/2 inch	6 3/4 inch	6 inch	5 1/2 inch	5 inch	4 inch	3 inch
13x16'		299'7"	1466'1"	2005'11"		2142'4"			

CONDUCTOR AND CASING LEFT IN WELL									
Conductor	12 inch	10 inch	8 1/2 inch	6 3/4 inch	6 inch	5 1/2 inch	5 inch	4 inch	3 inch
13x16'		299'7"	1466'1"	2005'11"		2142'4"			

OIL WELL					GAS WELL					
When Shot	Size of Turbine	1st Day's Production	Tubing	Reds	Tanks	Size of Packer	Depth Set	Packed with	1st Minute Pressure	Rock Pressure
			Top	Bottom	Thickness				0	155.1HR

FORMATION	Top	Bottom	Thickness	REMARKS
Clay	0	20	20	yellow soft
Fairview Coal	712	715	3	black soft
Mapletown Coal	935	940	5	black soft
Pgh. Coal	1040	1046	6	black soft
Red Rock	1084	1092	8	red soft
Red Rock	1160	1180	20	red soft
Red Rock	1200	1230	30	red soft
Red Rock	1280	1285	5	red soft
Red Rock	1293	1305	10	red soft
Little Dunkard	1440	1461	21	white hard
Big Dunkard	1515	1560	45	white hard
Has Sand	1605	1720	55	light hard
1st Salt Sand	1778	1791	13	light hard
2nd Salt Sand	1830	1882	52	light hard
3rd Salt Sand ^{light hard}	1915	3016	101	Water at 1960.4 Bailer per Hour Hole full water at 1985
Maxon Sand	2162	2183	21	light hard
Little Lime	2193	2205	12	light hard
Pencil Cave	2205	2209	4	black soft
Big Lime	2209	2265	56	light hard
Big Injun ^{light hard}	2265	2500	235	Show of Oil @ 2275 to 2285 Gas @ 2307 to 2310
Gantz Sand	2835	2850	15	light hard
Pink Rock	3075	3078	3	pink soft
Gordon Stray ^{white hard}	3078	3096	20	Gas @ 3093 to 3095
Gordon Sand	3102	3110	8	light hard
Sand	3113	3125	12	light hard
Total Depth	3283			
Lime broken light hard	3164	3200	36	
Slate light soft	3200	3207	7	
Lime light hard	3207	3216	9	

Examined above information and measurements and found to be correct by Mrs. Light & Heat Co. Contractor
 Examined and approved by _____
 NOTE: The above work must be checked carefully by the Contractor, with a complete and accurate record of the Well, and accompany when presented for payment.
 All formations and known sands must be given by their proper name, with actual line measurements, and under the heading of "Remarks" must be recorded in what sand and at what depth Oil, Gas or Water was found, the quantity of same, the quality of the sand, and thickness of pay.
 Make no memorandum of boiler and engine if owned by contractor.

WET-725

0002 0500

Division _____ Company _____
 Record of well No. 3070 on _____ Farm _____ Acres _____
 Field _____ District _____ County _____ State _____
 Rig Commenced 19 _____ Completed 19 _____
 Drilling Commenced 19 _____ Completed 19 _____
 Contractor _____ Address _____
 Driller's Name _____

CASING AND TUBING RECORD									
Conductor	1 1/2"	1 3/4"	2"	2 1/4"	2 3/4"	3"	3 1/2"	4"	4 1/2"
Used in Drilling									
Left in Well									

PACKER RECORD			SHOOTING RECORD						
Size	Depth Set	Type Packer	Date	Type Explosive	Amount	DEPTH		Volume Before Co. Ft.	Volume After Co. Ft.
						Top	Bottom		

VOLUME AND PRESSURE														
Date	Reading in Inches	Liquid	Size Orifice	Volume	Sand	PRESSURE IN MIN.					11 Hours R. P.	Max. R. P.	Notes	
						1	5	10	20	60				

TOTAL INITIAL OPEN FLOW _____ CUBIC FEET PER 24 HOURS

FORMATION	TOP	BOTTOM	THICKNESS	REMARKS			
Slate & Lime	20	320	300	Lime light hard	1465	1485	20
Slate light soft	320	400	80	Slate dark soft	1495	1505	10
Lime light hard	400	450	50	Pink Rock pink soft	1505	1500	4
Slate & Lime light	450	580	130	Slate light soft	1520	1515	10
Sand light hard	580	600	20	Slate & Lime light	1520	1520	0
Slate & Lime light	600	712	112	Sand light	1620	1615	25
Lime light hard	715	760	45	Lime light hard	1625	1665	26
Red Rock red soft	760	765	5	Slate light soft	1720	1728	8
Slate & Lime light	765	815	50	Sand light hard	1725	1750	30
Lime light hard	815	860	45	Slate dark soft	1750	1775	10
Red Rock Red soft	860	865	5	Slate dark soft	1790	1797	6
Maple Lime light hard	865	935	70	Sand light hard	1797	1824	27
Lime & Slate soft	940	1040	100	Slate dark soft	1811	1830	19
Lime stone light hard	1045	1084	38	Slate light soft	1832	1915	33
Sand light hard	1092	1112	20	Slate & Lime light	2025	2100	75
Lime light hard	1112	1150	38	Gritty Lime light hard	2100	2128	28
Slate light soft	1150	1160	10	Slate dark soft	2128	2138	10
Lime light hard	1180	1200	20	Gritty Lime light hard	2138	2160	22
Lime light hard	1230	1280	50	Slate black soft	2160	2162	2
Slate light soft	1285	1295	10	Slate black soft	2183	2193	10
Slate light soft	1305	1312	7	Slate & Lime light	2500	2835	335
Red Rock red soft	1312	1317	5	Gantz light hard	2835	2850	15
Lime stone light hard	1317	1355	38	Slate & Shells light	2850	2935	85
Red Rock red soft	1355	1360	5	Pink rock pink soft	2835	2842	7
Sand light hard 1360	1360	1400	40	Slate & Shells light	2912	3075	163
Slate dark soft	1400	1420	20	Slate light soft	3098	3102	4
Lime white hard	1420	1440	20	Slate light soft	3110	3113	3
Slate dark soft	1461	1465	4	Slate & Shells light	3125	3164	39

Examined above information and measurements and found to be correct by _____ Contractor _____ Examined and Approved by _____ Field Superintendent _____

NOTE--The above blank must be filled out carefully by the contractor, with a complete and accurate record of the well, and accompany, when presented for payment of the bill for drilling. All formations and known sands must be given by their proper name, with steel line measurements, and under the head of "Remarks" must be recorded in what sand and in what depth Oil Gas or Water was found, the quantity of same, the quality of the sand, and thickness of bed.

WET-725

0002-0501