

HOPE NATURAL GAS COMPANY

LOCATION FOR WELL No. 4112

c. 2

Instructions

Measure
 D. H. Cox B. Grant Farm, on waters of *St. Luking Creek*
 District, *Stetson* County, West Virginia
 Lease No. 528 Acres 1100 N. 9 S. 1 E. 1 W.
 Scale one inch equals 800 feet Location made in Pittsburgh Jan 6 1916 Sent to Clarksburg Jan 6 1916
 Location to be 400 feet from D. H. Cox farm and 400 feet from county line

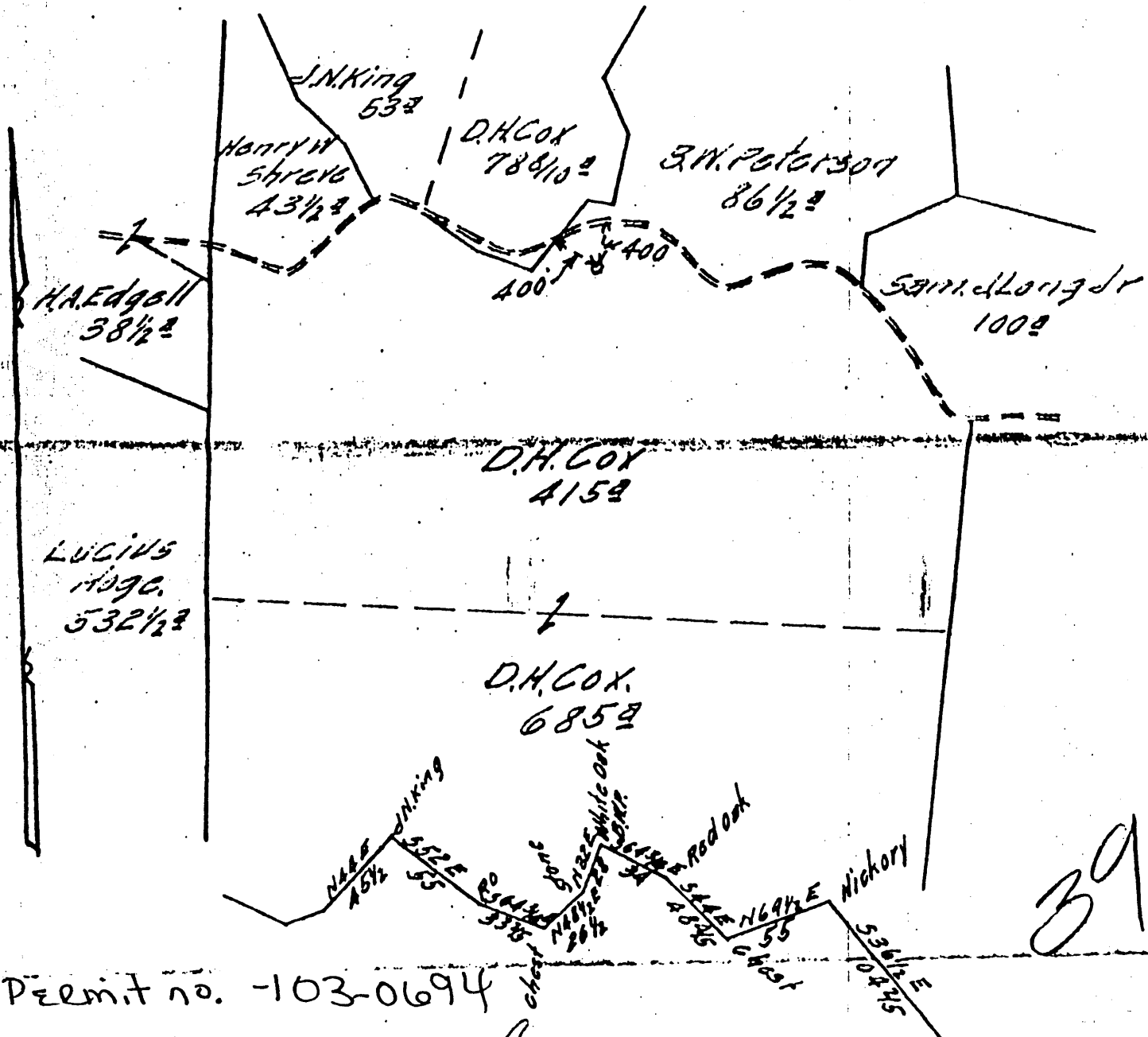

Permit no. -103-0694

TITLE RESERVE *None*

SPECIAL INSTRUCTIONS: COMPLETE WELL ON OR BEFORE

Same Lease on which are Located Well No. 18-19-25-3482

Location made 1-12-16 by *G.H. Cunningham* As per plat, except as noted. On field map

1-13-16 Returned to Pittsburgh 1-13-16

Location changed on account of

Authorized by

Date

Signed

Hope Natural Gas Company

Well No. 4112

D. H. Cox

Farm

May 31st

District Pine Grove District

Commenced December 27th, 1928

N. 9 S. E. 1 W.

REPAIRS

Completed May 1st, 1929

CASING AND TUBING RECORD

Size	Before Repairs	Pulled	Put in Well	After Repairs	Disposition of Amount Pulled
10"	573'8"	none	none	573'8"	
8 1/2"	1804'0	none	none	1804'0	
4" Tubg	2078-1	2078-1	none	none	To Hastings Whse Stock.
6-5/8	none	none	2125-4	2125-4	6-5/8" SHOE RUN BY 2125 ST. A. L.
5-3/16	none	none	2795-0	2795-0	5 3/16" SHOE RUN BY 2795 ST. A. L.
2 1/2" Tubg	none	none	3051-11	3051-11	(1700 to Pine Grove Whse)

SHOOTING RECORD

Date	Quarts	Top of Shell	Bottom of Shell	Diameter	Sand	TEST BEFORE SHOT			TEST AFTER SHOT			Test Taken After Shot No. Holes	By Whom Shot
						Reading	Liquid	Opening	Reading	Liquid	Opening		
3-23-29	20	3009	3019	3 1/2	Gord	12/10	W	2	15/10	W	2	26	M. T. Co
3-24-29	10	2981	2986	3 1/2	Gord	12/10	W	2	18/13	W	2	26	do

RECORD OF ANY DEEPER DRILLING

Formation	Top	Bottom	Names of Drillers	Time
Commenced drilling at depth of	2067-6		J. H. Calvert	98
Maxon	2028	2073	Ottie B. Stockpole	50
Little Lime	2086	2095	W. H. Martin	51
Pencil Cave	2095	2099	S. W. Yoho	32
Big Line	2099	2156		
Big Injun	2166	2431	Names of Tool Dressers	Time
Fifty Foot (shells)	2713	2740	J. E. Carson	36
Thirty Foot	2766	2795	G. A. Nolan	62
Red Rock	2836	2870	H. E. Ketsel	98
Gordon Str (Shells)	2956	2966	I. H. Wright PACKER RECORD (ALSO NOTE BELOW IF ANY PACKERS ARE PULLED)	
Gordon (Hard)	2968	3027	Size	Kind
Total Depth	3076	3076	5-3/16X2	Anchor & Wall
			Anchor	115

OIL AND GAS DISCOVERIES IN DEEPER DRILL

Oil at none Ft. in _____
 Gas at 2975-2982 to 2984 Ft. in Gordon

VOLUME AND PRESSURE TEST

BEFORE REPAIRS					AFTER REPAIRS	
Reading	Liquid	Opening	Rock or Mineral	Sands Gas From	Reading	Liquid
6/10	water	2"	90	Maxon	115966	

AFTER REPAIRS

VOLUME TEST

Date of Test	Opening	PITOT TUBE		OPEN FLOW	Sands Gas From
		Reading	Liquid Used		
5-18-29	1" Op	6/10	water (show of gas)	98	Pittsburg - Leak from Maxon Sand
5-18-29	1" Casing	6/10	water		Maxon
5-18-29	1 1/2" Tubing	6-0/10	water (show of gas)		INJUN - LEAK
5-18-29	2" Tubg	16/10	Water (show of gas)		Leak from Gordon Sand

Date of Test	Opening	PRESSURE TEST											
		1 Min.	2 Min.	3 Min.	4 Min.	5 Min.	6 Min.	7 Min.	8 Min.	9 Min.	10 Min.	30 Min.	60 Min.
5-18-29	8 1/2" Casing	2	6	6	8	9	10	11	12	15	16	20	36
6-27-29	2" Tubing	6	22	26	32	35	36	36	36	36	40	48	64

OIL: From Sand 2 1/2" 1st perf on bottom, 2 perf 3021, 3rd perf at 29
 Estimated Production Bbl per Day 1-2" RAL Nipple one joint above packer
 Remarks: 1-2" Plug on bottom.

Permit no
103-0694

1978 State Ex.

3076
2067
1009 - new ftg