

LATITUDE 39° 37' 30"

80° 27' 30"

LONGITUDE

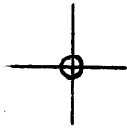

7'5 OGIS topo location

7.5' 10C 2.08S 15' 10C _____
 1.37W (calc.) _____

Company _____

Farm _____

Quad GLOVER GAP 7 1/2'

County WETZEL

District GRANT

WELL LOCATION MAP

File No. 103 - 0685

(047)

CONTRACTORS PLAN FOR LOCATION OF WELL NO. 2648

Pittsburgh Pa May 25th 1912

Dear Sir:-

HOPE NATURAL GAS COMPANY have under consideration the drilling of a well on the J. B. Hinerman farm, on the waters of Wiley Fork, Grant District, Putzel County, West Virginia, and would be pleased to receive bids for drilling same. Located one-half mile east of Coburn; Smithfield being the nearest railroad station.

J. B. Corrin,
Asst. Supt.,

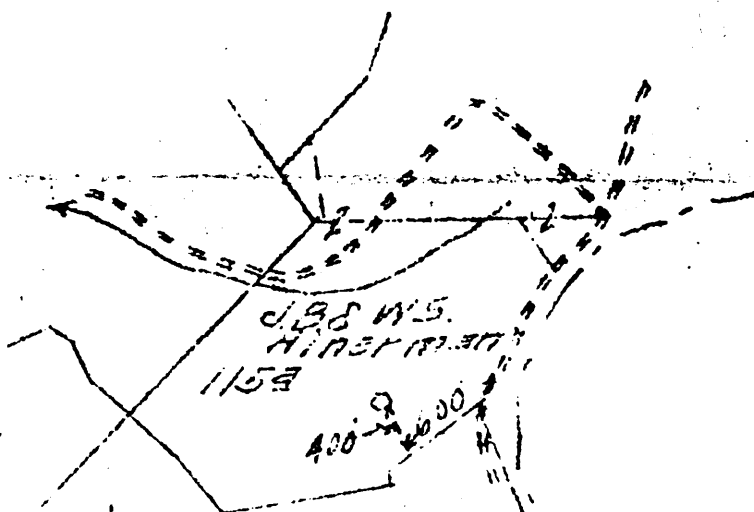

WET-685

Mr. J. B. Corrin, Asst. Supt.,
Box 1756 Pittsburgh Penna.

Dear Sir:-

I will drill the above well according to specifications of contract for \$ _____ per foot.

Date:

Address:

Wet-685

Well No. 2648

Littleton

District

Located on J. B. Hinerman

Farm

District Grant

County Wetzel

State W. Va.

Location Made 5-28-1912

First Work Done 6-10-12

Rig Commenced 6-24-12

Rig Completed 7-5-12

Drilling Commenced 9-5-12

Drilling Completed 10-15-12

Rig Contractor A. G. Edinger

Drilling Contractor Chas. L. Tagua

Drillers C. B. Heald, & T. E. Lucas

H. K. M. B. Co. Tools. String No.

NOV 1 1912 H.H.S.

Tool Dressers Nute Hibbs, Wm. Lemley

ENTERED
 WELL BOOK NOV 13 1912 G.A.K.
 LEASE RECORD
 LEASE BOOK
 WALL MAP OCT 23 1912 J.C.I.
 LINE MAP NOV 2 1912 H.H.S.
 LOCATION BOOK
 CONTRACTORS PLAT
 CONTRACTOR
 TITLE

FORMATION	TOP	BOTTOM	Steel Line Measurements	Water Found Depth	Oil Found Depth	Gas Found Depth
Native Coal	875	879	S.L.			
Pittsburg Coal	975	982	"			
Little Dunkard	1321	1348	"			
Big Dunkard	1448	1513	"			
Gas Sand	1648	1683	"			
First Salt	1751	1820	"	1770		
Second Salt	1875	1915	"			
Maxon Salt	2087		"			
Little Lime						
Pencil Cave						
Big Lime						
Big Injun						
Squaw						
Perea						
Gantz						
Fifty Foot						
Thirty Foot						
Gordon Stray						
Gordon						
Fourth						
Fifth						
Bayard						
Total Depth		2105				

Sand from 1954 to 1991.
 42/10 Mercury thru 2" Op

Salt { 2089
 2101

Wed-685

SIZE	Charged to Well		Put in Well		Pulled Out		Left in Well		Transferred Before Completing		Left at Well Not in Use		If more than two strings of casing are left in hole, give reasons for leaving additional strings
	Feet	In.	Feet	In.	Feet	In.	Feet	In.	Feet	In.	Feet	In.	
13" Csg.	136	2	123		None		123		None		13	2	
10" "	1344	6	1281		"		1281		"		63	6	
8 1/2" "	1775	4	1550		"		1550		"		225	4	
6 5/8" "													
5 3/16" "													
8" Tbg.	2164	2	2111	2	"		2111	2	"		60		

PACKER RECORD

SIZE	KIND	Amount Anchor	Amount Above Anchor	REMARKS
5 1/2 x 8 1/4	Anchor	60	2051 2	Perforation in gas pay

SHOOTING RECORD (If shot before or upon completion of well)

DATE	Gauge	Top of Shell	Bottom of Shell	Diameter	Sand	Test Before Shot			Test After Shot			Test Taken After Shot No. Hops	By Whom Shot	
						Reading	Liquid	Opening	Reading	Liquid	Opening			

CEMENTING RECORD

Date Cemented..... Size Hole Cemented..... Size Casing Cemented.....
 Top Pittsburg Coal..... Top Cementing..... Amount Cement Used.....
 Bottom Pittsburg Coal..... Bottom Cementing..... Amount Sand Used.....
 Mr..... of..... Coal Company on ground when coal was cemented
 Remarks:..... Signature of persons who cemented well

Not cemented

Approved by

W. S. Lemley
 Foreman