



# HOPE NATURAL GAS COMPANY.

LOCATION FOR WELL No. 2224

DISTRICT

*Greenwell* Farm, or parts of *Greenwell* District, *Greenwell* County, West Va.

Lease No. *15654* Acres *156* N. *9* S. *7* E. *7* W. *7*  
Scale, one inch equals *800* feet Sent to *11/10/11* 4-25-11

Location to be *600 feet from Milburn Britton corner*  
*100 feet from County Road.*

Permit no. *103-0684*

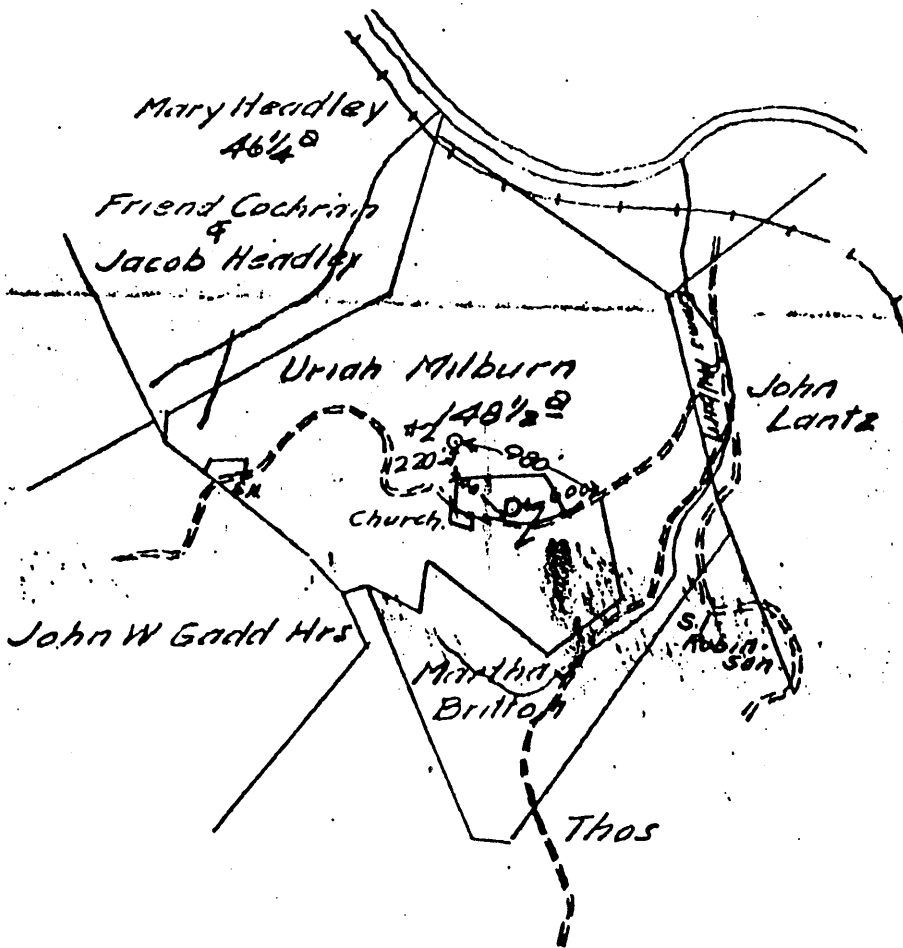

RESERVE

SPECIAL INSTRUCTIONS

Location made *5-1-11* by *P. Bentt* as per plat, except as noted. On field map

*5-24-11* Returned to Pittsburgh *5-24-11*

Location changed on account of *32 tract not being leased*

Authorized by *J. B. Davis* Date *5-24-11* Signed by *R. H. Bradley*

